

© Copyright Christchurch City Council / Aerial Photography Creative Commons Attribution 3.0 New Zealand License

Original size mm

100

50

30

10

0

0

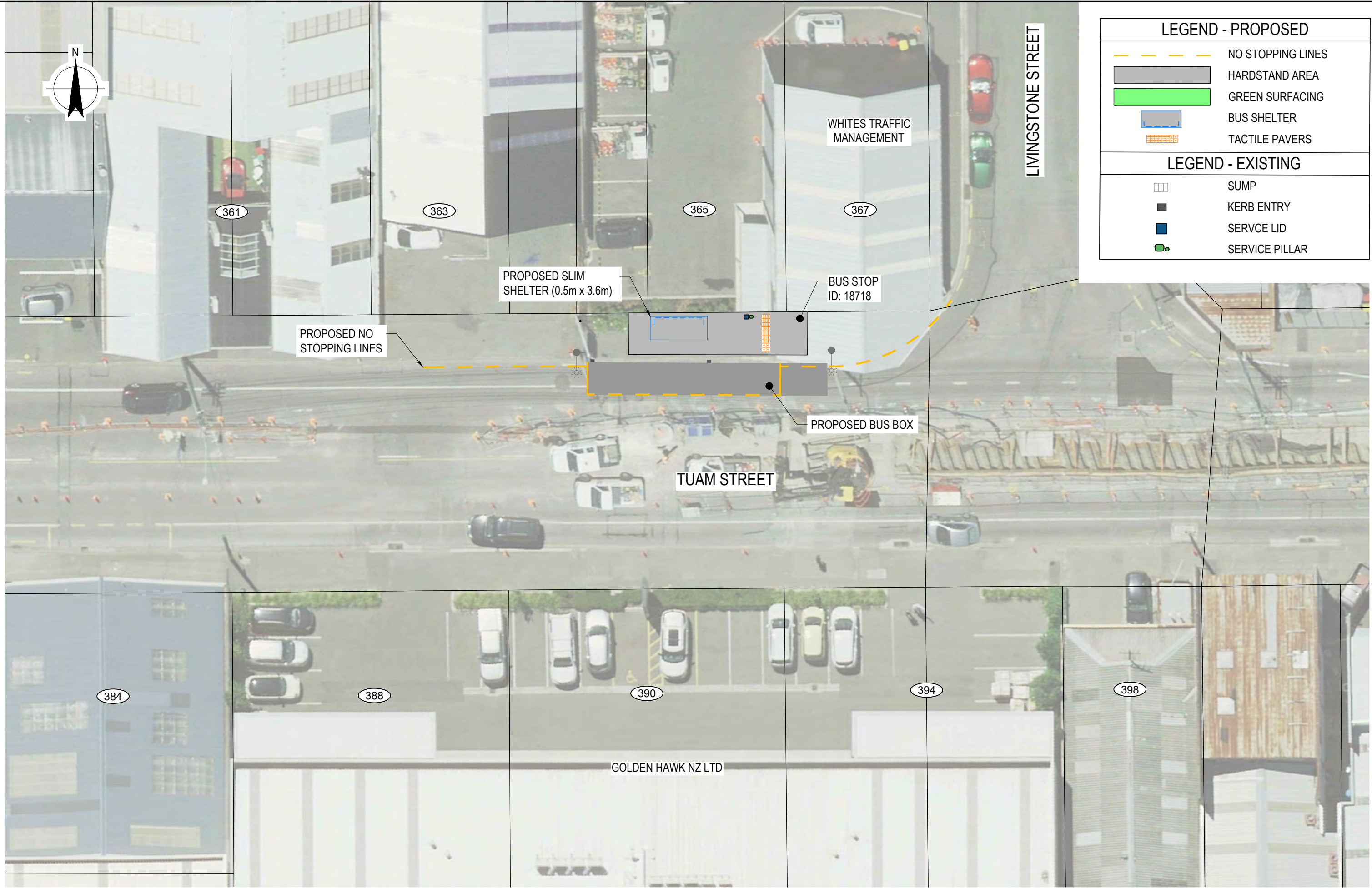

LEGEND - PROPOSED	
	NO STOPPING LINES
	HARDSTAND AREA
	GREEN SURFACING
	BUS SHELTER
	TACTILE PAVERS
LEGEND - EXISTING	
	SUMP
	KERB ENTRY
	SERVICE LID
	SERVICE PILLAR

PROPOSED SLIM SHELTER (0.5m x 3.6m)

PROPOSED NO STOPPING LINES

WHITES TRAFFIC MANAGEMENT

BUS STOP ID: 18718

PROPOSED BUS BOX

TUAM STREET

LIVINGSTONE STREET



TUAM STREET - BUS STOP UPGRADES

BUS STOP ID: 18718 (TUAM ST NEAR FITZGERALD AVE)

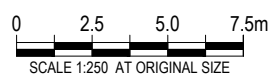

For Board Approval

DESIGNED BY: O. MUNAN

APPROVED BY: G. RYAN

Original Plan Size: A3

ISSUE. 01 16/06/2023

12606239-04-SK201

GHD

© Copyright Christchurch City Council / Aerial Photography Creative Commons Attribution 3.0 New Zealand License

Original size mm

100

50



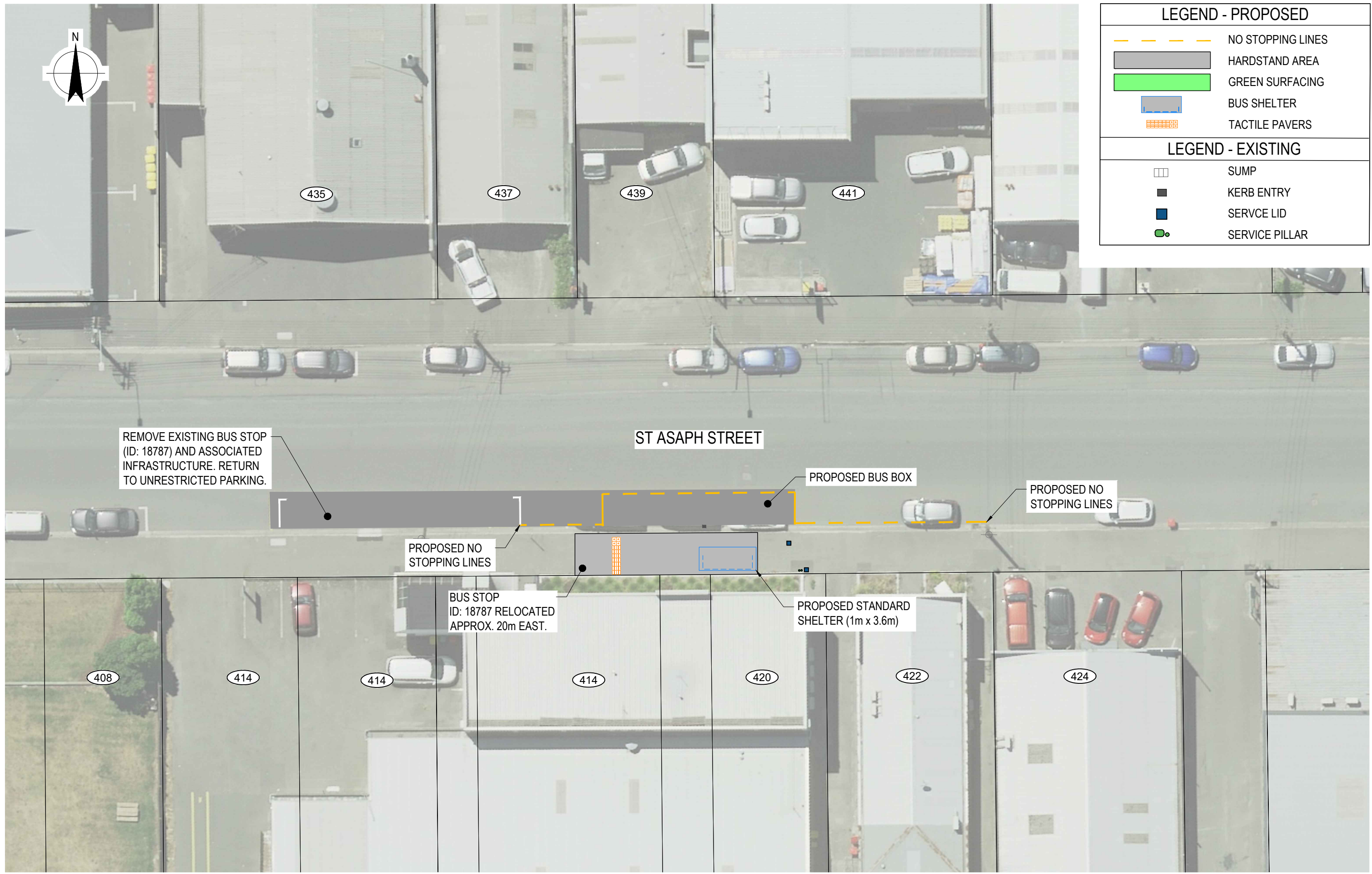

30

10





0



LEGEND - PROPOSED

-  NO STOPPING LINES
-  HARDSTAND AREA
-  GREEN SURFACING
-  BUS SHELTER
-  TACTILE PAVERS

LEGEND - EXISTING

-  SUMP
-  KERB ENTRY
-  SERVICE LID
-  SERVICE PILLAR

© Copyright Christchurch City Council / Aerial Photography Creative Commons Attribution 3.0 New Zealand License

Original size mm

100

50

30

10

0

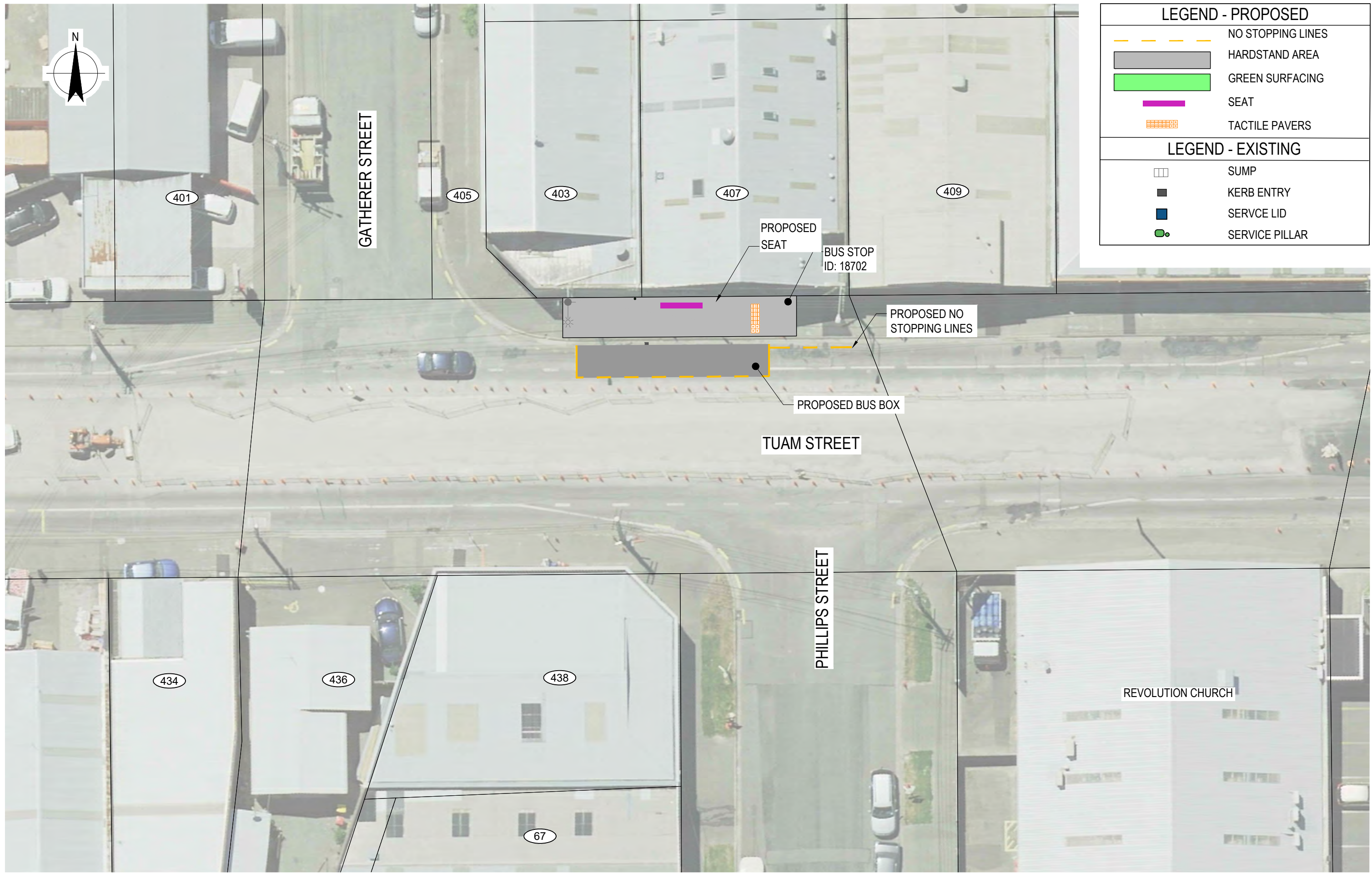

LEGEND - PROPOSED	
	NO STOPPING LINES
	HARDSTAND AREA
	GREEN SURFACING
	SEAT
	TACTILE PAVERS
LEGEND - EXISTING	
	SUMP
	KERB ENTRY
	SERVICE LID
	SERVICE PILLAR



TUAM STREET - BUS STOP UPGRADES

BUS STOP ID: 18702 (TUAM ST NEAR PHILLIPS ST)

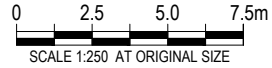

For Board Approval

DESIGNED BY: O. MUNAN

APPROVED BY: G. RYAN

Original Plan Size: A3

ISSUE. 01 16/06/2023

12606239-04-SK203 GHD

© Copyright Christchurch City Council / Aerial Photography Creative Commons Attribution 3.0 New Zealand License

Original size mm

100

50

30

10

0

0

0

0

0

0

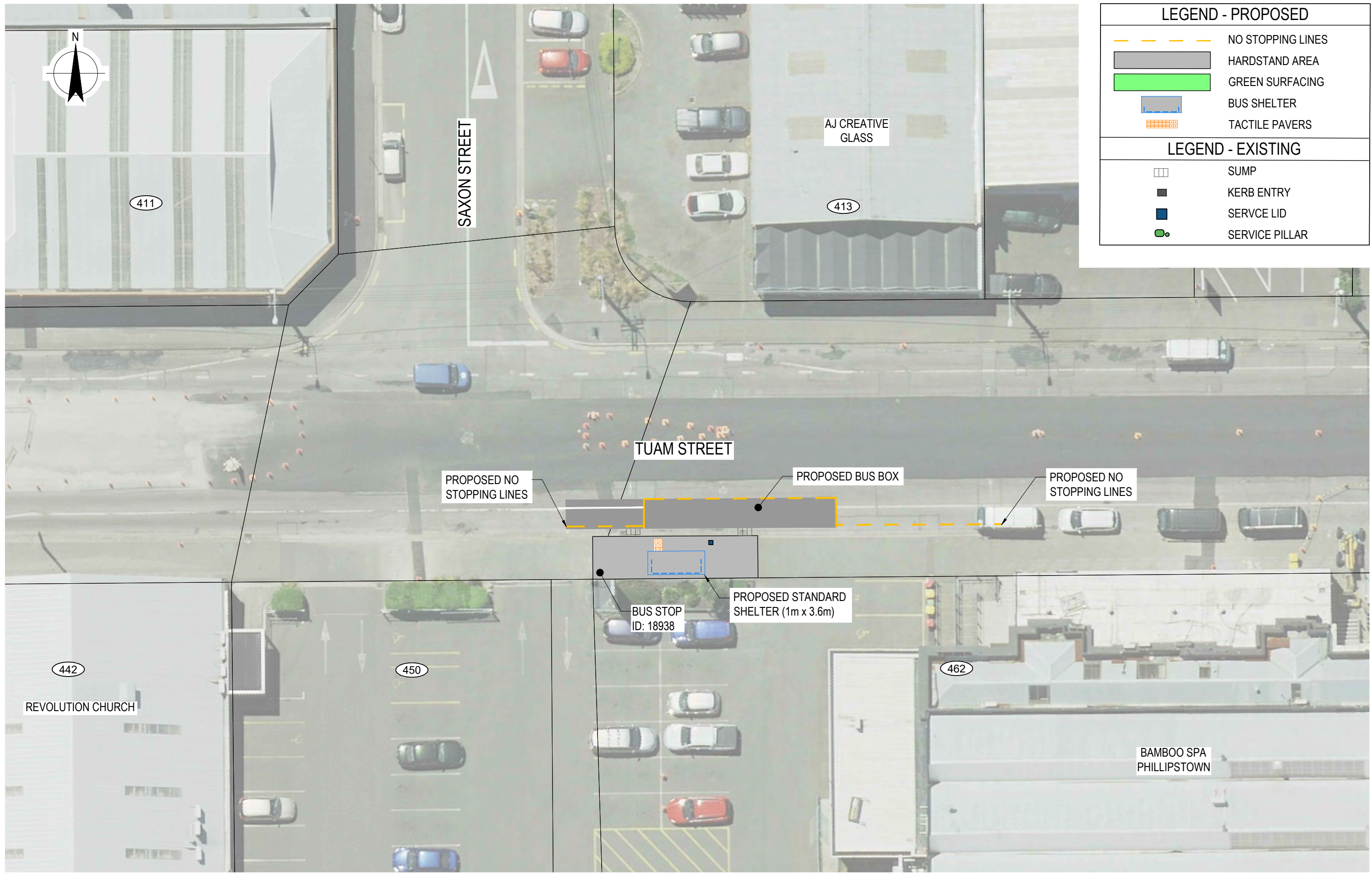

LEGEND - PROPOSED	
	NO STOPPING LINES
	HARDSTAND AREA
	GREEN SURFACING
	BUS SHELTER
	TACTILE PAVERS
LEGEND - EXISTING	
	SUMP
	KERB ENTRY
	SERVICE LID
	SERVICE PILLAR



TUAM STREET - BUS STOP UPGRADES

BUS STOP ID: 18938 (TUAM ST NEAR SAXON ST)

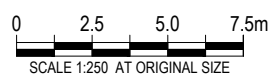

For Board Approval

DESIGNED BY: O. MUNAN

APPROVED BY: G. RYAN

Original Plan Size: A3

ISSUE. 01 16/06/2023

12606239-04-SK204

GHD