Waihoru Spreydon-Cashmere-Heathcote Community Board AGENDA

Notice of Meeting Te Pānui o te Hui:

The ordinary meeting of the Waihoru Spreydon-Cashmere-Heathcote Community Board will be held on:

Date: Thursday 11 June 2026
Time: 4 pm
Venue: Linwood Boardroom, Gate B,
180 Smith Street, Woolston

Membership Ngā Mema

Chairperson	Keir Leslie
Deputy Chairperson	Sophie Bond
Members	Melanie Coker
	Will Hall
	Nathaniel Herz Jardine
	Kate Hodgins
	Roy Kenneally
	Tim Lindley
	Tim Scandrett

4 June 2026

Principal Advisor

Joshua Wharton
Manager Community Governance
Team
Tel: +64 3 941 5391
Joshua.Wharton@ccc.govt.nz

Meeting Advisor

Jonathon Jones
Community Board Advisor
Tel: 941 5563
Jonathon.Jones@ccc.govt.nz

Website: www.ccc.govt.nz

Note: The reports contained within this agenda are for consideration and should not be construed as Council policy unless and until adopted. If you require further information relating to any reports, please contact the person named on the report.

To watch the meeting live, or a recording after the meeting date, go to:

<https://www.youtube.com/@waihorospreydon-cashmere-h3561/streams>

To view copies of Agendas and Minutes, go to:

<https://www.ccc.govt.nz/the-council/meetings-agendas-and-minutes/>



What is important to us?

Our Strategic Framework is a big picture view of what the Council is aiming to achieve for our community

Our focus this Council term 2022–2025

Strategic Priorities



Be an **inclusive and equitable city which puts people at the centre** of developing our city and district, prioritising wellbeing, accessibility and connection.



Champion Ōtautahi-Christchurch and collaborate to build our role as a leading New Zealand city.



Build trust and confidence in the Council through meaningful partnerships and communication, listening to and working with residents.

Adopted by the Council on 5 April 2023



Reduce emissions as a Council and as a city, and invest in **adaptation and resilience**, leading a city-wide response to climate change while protecting our indigenous biodiversity, water bodies and tree canopy.



Manage ratepayers' money wisely, delivering quality core services to the whole community and addressing the issues that are important to our residents.



Actively balance the needs of **today's residents** with the **needs of future generations**, with the aim of leaving no one behind.

Our goals for this Long Term Plan 2024–2034

Draft Community Outcomes



Collaborative and confident

Our residents have the opportunity to actively participate in community and city life, have a strong sense of belonging and identity, and feel safe.



Green and liveable

Our neighbourhoods and communities are accessible and well connected, supporting our goals to reduce emissions, build climate resilience and protect and regenerate the environment, especially our biodiversity, water bodies and tree canopy.

To be adopted by the Council as part of the Long Term Plan 2024–2034



A cultural powerhouse

Our diverse communities are supported to understand and protect their heritage, pursue their arts, cultural and sporting interests, and contribute to making our city a creative, cultural and events 'powerhouse'.



Thriving and prosperous

Our city is a great place for people, business and investment where we can all grow our potential, where enterprises are innovative and smart, and where together we raise productivity and reduce emissions.

Our intergenerational vision

A place of opportunity for all.

**Open to new ideas, new people,
new investment and new ways
of doing things – a place where
anything is possible.**



Ngāi Tahu has rangatiratanga over its takiwā – the Council is committed to partnering with Ngāi Tahu to achieve meaningful outcomes that benefit the whole community

Part A	Matters Requiring a Council Decision
Part B	Reports for Information
Part C	Decisions Under Delegation

TABLE OF CONTENTS NGĀ IHIRANGI

Karakia Tīmatanga	4
Waiata	4
C 1. Apologies Ngā Whakapāha	4
B 2. Declarations of Interest Ngā Whakapuaki Aronga	4
C 3. Confirmation of Previous Minutes Te Whakaāe o te hui o mua	4
B 4. Public Forum Te Huinga Whānui	4
B 5. Deputations by Appointment Ngā Huinga Whakaritenga.....	4
B 6. Presentation of Petitions Ngā Pākikitanga	5

STAFF REPORTS

C 7. 29A Huntsbury Avenue - Proposed No Stopping Restrictions	19
C 8. Proposed No Stopping Restrictions - Dobson Street - Selwyn Street	25
C 9. Orion Easement over Reserve - 41R Truscotts Road	33
C 10. Sacred Heart School Parking Restrictions.....	39
C 11. Waihoru Spreydon Cashmere Heathcote Discretionary Response Fund 2025/26, Cashmere Technical Football Club Incorporated, Heathcote Valley Community Association, Somerfield Residents Association, St Peter's Indoor Bowling Club	45
C 12. Waihoru Spreydon-Cashmere-Heathcote Community Board Area Report - June 2026	55
B 13. Elected Members' Information Exchange Te Whakawhiti Whakaaro o Te Kāhui Amorangi.....	94

Karakia Whakamutunga

Actions Register Ngā Mahinga Tuwhera

Karakia Tīmatanga

Kia tau te mauri o runga	<i>May the essence of above settle here</i>
Kia tau te mauri o raro	<i>May the essence of below settle here</i>
Paiheretia te ture wairua	<i>Bind together that we can't see and bind that we can see</i>
Paiheretia te ture tangata	<i>And have them guide us at this time</i>
Hei pou arahi i a tātou i tēnei wā	<i>May the thought be true</i>
Kia tika te whakaaro	<i>May the words be true</i>
Kia tika te kupu	
Tīhei Mauri Ora!	

Waiata

Nei rā te tai ō mihi	Heartfelt greetings and best wishes
Ki a tatou e ngā iwi	To all of us who have gathered here
Kua tae mai mātou	We have arrived here today
Hei tautoko	To show our collective support
Ki te kaupapa o te rā	For the purpose of the occasion
He waka eke noa	We are all in this together
Nā te Kaunihera o Ōtautahi e	On behalf of the Christchurch City Council

1. Apologies Ngā Whakapāha

Apologies will be recorded at the meeting.

2. Declarations of Interest Ngā Whakapuaki Aronga

Members are reminded of the need to be vigilant and to stand aside from decision-making when a conflict arises between their role as an elected representative and any private or other external interest they might have.

3. Confirmation of Previous Minutes Te Whakaāe o te hui o mua

That the minutes of the Waihoru Spreydon-Cashmere-Heathcote Community Board meetings held on [Thursday, 21 May 2026](#) (refer page 6) and on [Thursday, 14 May 2026](#) (refer page 9) be confirmed.

4. Public Forum Te Huinga Whānui

A period of up to 30 minutes will be available for people to speak for up to five minutes on any issue that is not the subject of a separate hearing process.

Public Forum presentations will be recorded in the meeting minutes

5. Deputations by Appointment Ngā Huinga Whakaritenga

Deputations may be heard on a matter or matters covered by a report on this agenda and approved by the Chairperson.

Deputations will be recorded in the meeting minutes.

6. Presentation of Petitions Ngā Pākikitanga

There were no petitions received at the time the agenda was prepared.

To present to the Community Board, refer to the [Participating in decision-making](#) webpage or contact the meeting advisor listed on the front of this agenda.

**Waihoru
Spreydon-Cashmere-Heathcote Community Board
OPEN MINUTES**

Date: Thursday 21 May 2026
Time: 4.02 pm
Venue: Linwood Boardroom, Gate B,
180 Smith Street, Woolston

Present

Chairperson	Keir Leslie
Deputy Chairperson	Sophie Bond
Members	Melanie Coker
	Nathaniel Herz Jardine - via audio/visual link
	Kate Hodgins
	Roy Kenneally
	Tim Lindley
	Tim Scandrett

Principal Advisor

Joshua Wharton
Manager Community Governance Team
Tel: +64 3 941 5391
Joshua.Wharton@ccc.govt.nz

Meeting Advisor

Jonathon Jones
Community Board Advisor
Tel: 941 5563
Jonathon.Jones@ccc.govt.nz
Website: www.ccc.govt.nz

To watch meetings, live, or previous recordings, go to:

<https://www.youtube.com/@waihorospreydon-cashmere-h3561/streams>

To view copies of Agendas and Minutes, go to:

<https://www.ccc.govt.nz/the-council/meetings-agendas-and-minutes/>



-
- Part A** Matters Requiring a Council Decision
Part B Reports for Information
Part C Decisions Under Delegation
-

Karakia Tīmatanga

Waiata: The Board sang a waiata to open the meeting.

The agenda was dealt with in the following order.

1. Apologies Ngā Whakapāha

Part C

Community Board Resolved SCBCC/2026/00044

That the apology from Will Hall for absence be accepted.

Keir Leslie/Tim Scandrett

Carried

2. Declarations of Interest Ngā Whakapuaki Aronga

Part B

There were no declarations of interest recorded.

3. Deputations by Appointment Ngā Huinga Whakaritenga

Part B

3.1 Paula Jameson

Paula Jameson, local resident, Emeritus Professor at the University of Canterbury and President of the Summit Road Society spoke regarding Item 4, Grant of Easement Cracroft Reserve.

After a question from a member the Chairperson thanked Paula for her presentation.

Nathaniel Herz Jardine joined the meeting at 4.18 pm during consideration of Item 3.2.

3.2 Richard Waugh

Rev. Dr Richard Waugh QSM, local resident spoke regarding Item 4, Grant of Easement Cracroft Reserve.

The Chairperson thanked Rev. Dr Waugh for his presentation.

3.3 Friends of Cracroft Reserve

Quentin McDonald spoke on behalf of Friends of Cracroft Reserve regarding Item 4, Grant of Easement Cracroft Reserve.

After a question from a member the Chairperson thanked Quentin for his presentation.

3.4 Jeff Gibson, Manatū Taonga Ministry for Culture & Heritage

Jeff Gibson, Pou Taki, Kaupapa Whakataki, Director Portfolio Delivery spoke on behalf of Manatū Taonga Ministry for Culture & Heritage joined by Lucy Jackson, Senior Communications Advisor, Manatū Taonga Ministry for Culture & Heritage regarding Item 4, Grant of Easement Cracroft Reserve.

After questions from members the Chairperson thanked the presenters for their presentation.

4. Grant of Easement Cracroft Reserve

The Board considered the deputations on this item (refer Items 3.1, 3.2, 3.3 and 3.4 above).

Community Board Resolved SCBCC/2026/00045

Officer Recommendations accepted without change

Part C

That the Waihoru Spreydon-Cashmere-Heathcote Community Board:

1. Receives the information in the Grant of Easement Cracroft Reserve Report.
2. Notes that the decision in this report is assessed as medium significance based on the Christchurch City Council's Significance and Engagement Policy.
3. Approves pursuant to section 48 of the Reserves Act 1977 the grant of an easement in gross over Lots 6 and 7 DP 6163, being part of the Record of Title CB385/51, to Manatū Taonga Ministry for Culture and Heritage for the location of the Erebus Memorial in Cracroft Reserve, as shown in **Attachment A** to the report on the meeting agenda.
4. Delegates authority to the Manager Property Consultancy to do all things necessary and make any decisions at his sole discretion that are consistent with the intent of this report to implement the resolutions above, including but not limited to finalising the easement.

Tim Scandrett/Tim Lindley

Carried

Karakia Whakamutunga

Meeting concluded at 5.03 pm.

CONFIRMED THIS 11th DAY OF JUNE 2026

**KEIR LESLIE
CHAIRPERSON**

Waihoro
Spreydon-Cashmere-Heathcote Community Board
OPEN MINUTES

Date: Thursday 14 May 2026
Time: 4.02 pm
Venue: Linwood Boardroom, Gate B,
180 Smith Street, Woolston

Present

Chairperson	Keir Leslie
Deputy Chairperson	Sophie Bond
Members	Melanie Coker
	Will Hall
	Nathaniel Herz Jardine
	Kate Hodgins
	Roy Kenneally
	Tim Lindley
	Tim Scandrett

Principal Advisor

Joshua Wharton
Manager Community Governance Team
Tel: +64 3 941 5391
Joshua.Wharton@ccc.govt.nz

Meeting Advisor

Jonathon Jones
Community Board Advisor
Tel: 941 5563
Jonathon.Jones@ccc.govt.nz
Website: www.ccc.govt.nz

To watch meetings, live, or previous recordings, go to:

<https://www.youtube.com/@waihorospreydon-cashmere-h3561/streams>

To view copies of Agendas and Minutes, go to:

<https://www.ccc.govt.nz/the-council/meetings-agendas-and-minutes/>



-
- Part A** Matters Requiring a Council Decision
Part B Reports for Information
Part C Decisions Under Delegation
-

Karakia Tīmatanga

Waiata: The Board sang a waiata to open the meeting.

The agenda was dealt with in the following order. Where no voting record is shown, the item was carried unanimously by those present.

1. Apologies Ngā Whakapāha

Part C
Community Board Decision

There were no apologies received.

2. Declarations of Interest Ngā Whakapuaki Aronga

Part B
There were no declarations of interest recorded.

3. Confirmation of Previous Minutes Te Whakaāe o te hui o mua

Part C
Community Board Resolved SCBCC/2026/00037

That the minutes of the Waihoru Spreydon-Cashmere-Heathcote Community Board meeting held on Thursday, 16 April 2026 be confirmed.

Nathaniel Herz Jardine/Kate Hodgins

Carried

4. Public Forum Te Huinga Whānui

Part B

4.1 Neighbours Aotearoa Programme update

Leeza Green, Christchurch Community Weaver spoke on behalf of the Neighbours Aotearoa Programme and provide an update on the programme with a focus on the Waltham project.

The Chairperson thanked Leeza Green for her presentation.

Attachments

A Leeza Green - Neighbours Aotearoa Programme - Documents tabled to the Board

4.2 Port Hills Park Trust update

Sam Hampton spoke on behalf of the Port Hills Park Trust and presented an update regarding the Trust's activities.

The Chairperson thanked Sam Hampton for his presentation.

Part B

That the Waihoru Spreydon-Cashmere-Heathcote Community Board:

1. Refers the issues raised in the presentation to staff for investigation and response to the Board.

Attachments

A Sam Hampton - Port Hills Park Trust - Presentation to the Board

4.3 Sumner Surf Life Saving Club update

Per Tonisca, Club Captain and Huntly Quinn, Club President spoke on behalf of the Sumner Surf Life Saving Club regarding an update about the club's activities.

After questions from members the Chairperson thanked Per Tonisca and Huntly Quinn for their presentation.

Attachments

A Sumner Surf Lifesaving Club - Presentation to the Board

4.4 Large Oak Tree in Remuera Reserve

Adrian Ramsay, local resident spoke regarding the shading impact of a large Oak tree in Remuera Reserve.

After questions from members the Chairperson thanked Adrian Ramsay for his presentation.

Part B

That the Waihoru Spreydon-Cashmere-Heathcote Community Board:

1. Refers the issues raised to staff for investigation and response to the Board.

5. Deputations by Appointment Ngā Huinga Whakaritenga

Part B

5.1 Opawa Road - Proposed Parking Restrictions - Marie Fenton

Marie Fenton, local resident spoke regarding Item 9 - Opawa Road - Proposed Parking Restrictions report on the agenda.

The Chairperson thanked Marie Fenton for her presentation.

5.2 Opawa Road - Proposed Parking Restrictions - Workers at Emerge Aotearoa

Tracie Palmer, Public Service Association Organiser spoke along with David Taylor and Jono Bannan, workers at Emerge Aotearoa regarding Item 9 - Opawa Road - Proposed Parking Restrictions report on the agenda.

Tracie tabled a list of workers that opposed the proposed parking restrictions.

The Chairperson thanked the presenters for their presentation.

Attachments

A Tracie Palmer - Document of names tabled to the Board

6. Presentation of Petitions Ngā Pākikitanga

Part B

There was no presentation of petitions.

7. Correspondence

Officer Recommendations Ngā Tūtohu

That the Waihoru Spreydon-Cashmere-Heathcote Community Board:

1. Receives the information in the correspondence report dated 14 May 2026 from Joseph Tyro, Chair, Te Hapū o Ngāti Wheke Inc regarding the proposal of the Redcliffs Te Rae Kura Residents' Association in relation to Te Ana o Hineraki and Moncks Cave.

Community Board Resolved SCBCC/2026/00038

Part B

That the Waihoru Spreydon-Cashmere-Heathcote Community Board:

1. Receives the information in the correspondence report dated 14 May 2026 from Joseph Tyro, Chair, Te Hapū o Ngāti Wheke Inc regarding the proposal of the Redcliffs Te Rae Kura Residents' Association in relation to Te Ana o Hineraki and Moncks Cave.
2. Receives the information in the correspondence report dated 14 May 2026 from Federico Tomasetto, local resident in relation to a formal crossing investigation in Huntsbury (Major Aitken Drive to Parklands Drive) and refers the issues raised to staff for investigation and response to the Board.

Keir Leslie/Tim Scandrett

Carried

Attachments

A Correspondence (Tabled) - Federico Tomasetto - Formal Crossing Investigation.docx

8. Licence for Outdoor Dining - 2 Esplanade Sumner

Community Board Resolved SCBCC/2026/00039

Officer Recommendations accepted without change

Part C

That the Waihoru Spreydon-Cashmere-Heathcote Community Board:

1. Receives the information in the Licence for Outdoor Dining – 2 Esplanade Report.
2. Notes that the recommendation in this report is assessed as low significance based on the Christchurch City Council's Significance and Engagement Policy.
3. Notes that public consultation has been completed in accordance with the Reserves Act 1977 and that no objections or submissions were received.
4. Approves the granting of a licence over 101m² of land at 2 Esplanade (Pt Lot 1 DP 12446), at an annual licence fee set in accordance with the Council's current Outdoor Dining

policy to the applicant, or their nominee being the owner(s) of the café/restaurant located in the ground floor of the 5 Marriner Street development.

5. Requests that the Manager Property Consultancy take all steps necessary to give effect to the above resolutions, including completing negotiations and finalising and administering the licence documentation, and making any minor amendments required to give effect to these resolutions.

Will Hall/Tim Lindley

Carried

9. Opawa Road - Proposed Parking Restrictions

Community Board Comment

1. The Board considered the deputations on this item refer Item 5.1 and 5.2 above.

Community Board Resolved SCBCC/2026/00040

Officer Recommendations accepted without change

Part C

That the Waihoru Spreydon-Cashmere-Heathcote Community Board:

1. Receives the information in the Opawa Road - Proposed Parking Restrictions Report.
2. Notes that the decisions in this report are of low significance in relation to the Christchurch City Council's Significance and Engagement Policy 2019. The level of significance was determined by low number of people affected.
3. Under Clause 6(2) of the Christchurch City Council Traffic and Parking Bylaw 2017 revokes any previous resolutions pertaining to traffic controls made pursuant to any bylaw to the extent that they are in conflict with the parking or stopping restrictions described in resolutions 4 to 6 below.
4. Approves that in accordance with Clause 7 of the Christchurch City Council Traffic and Parking Bylaw 2017 and as detailed on Attachment A (Opawa Road, Proposed Parking Improvements, TG153030, dated 15/04/2026) to the report on the meeting agenda, that the stopping of vehicles be prohibited at any time on:
 - a. the northeast side of Opawa Road, commencing at a point 27 metres northeast of Brabourne Street and extending in a northeast direction for a distance of 98 metres.
 - b. the northeast side of Opawa Road, commencing at a point 182 metres northeast of Brabourne Street and extending in a northeast direction for a distance of 108 metres;
 - c. the southwest side of Opawa Road, commencing at a point 27 metres northeast of Brabourne Street and extending in a northeast direction for a distance of 11 metres;
 - d. the southwest side of Opawa Road, commencing at a point 48 metres northeast of Brabourne Street and extending in a northeast direction for a distance of 6 metres;
 - e. the southwest side of Opawa Road, commencing at a point 62 metres northeast of Brabourne Street and extending in a northeast direction for a distance of 6 metres;

- f. the southwest side of Opawa Road, commencing at a point 77 metres northeast of Brabourne Street and extending in a northeast direction for a distance of 7 metres;
 - g. the southwest side of Opawa Road, commencing at a point 91 metres northeast of Brabourne Street and extending in a northeast direction for a distance of 8 metres;
 - h. the southwest side of Opawa Road, commencing at a point 108 metres northeast of Brabourne Street and extending in a northeast direction for a distance of 15 metres;
 - i. the southwest side of Opawa Road, commencing at a point 131 metres northeast of Brabourne Street and extending in a northeast direction for a distance of 5 metres;
 - j. the southwest side of Opawa Road, commencing at a point 185 metres northeast of Brabourne Street and extending in a northeast direction for a distance of 6 metres;
 - k. the southwest side of Opawa Road, commencing at a point 199 metres northeast of Brabourne Street and extending in a northeast direction for a distance of 6 metres;
 - l. the southwest side of Opawa Road, commencing at a point 215 metres northeast of Brabourne Street and extending in a northeast direction for a distance of 6 metres;
 - m. the southwest side of Opawa Road, commencing at a point 232 metres northeast of Brabourne Street and extending in a northeast direction for a distance of 6 metres;
 - n. the southwest side of Opawa Road, commencing at a point 248 metres northeast of Brabourne Street and extending in a northeast direction for a distance of 11 metres;
 - o. the southwest side of Opawa Road, commencing at a point 269 metres northeast of Brabourne Street and extending in a northeast direction for a distance of 6 metres;
 - p. the southwest side of Opawa Road, commencing at a point 281 metres northeast of Brabourne Street and extending in a northeast direction for a distance of 15 metres;
4. Approves that in accordance with Clause 7 of the Christchurch City Council Traffic and Parking Bylaw 2017 and as detailed on Attachment A to the report on the meeting agenda (Opawa Road, Proposed Parking Improvements, TG153030, dated 15/04/2026) that the parking of vehicles be restricted to a maximum period of ten minutes on the southwest side of Opawa Road, commencing at a point 123 metres northeast of Brabourne Street, and extending in a northeast direction for a distance of 8 metres. This restriction is to apply at all times.
5. Approves that in accordance with Clause 7 of the Christchurch City Council Traffic and Parking Bylaw 2017 and as detailed on Attachment A to the report on the meeting agenda (Opawa Road, Proposed Parking Improvements, TG153030, dated 15/04/2026) that the parking of vehicles be restricted to a maximum period of 120 minutes on the southwest side of Opawa Road, commencing at a point 136 metres northeast of Brabourne Street, and extending in a northeast direction for a distance of 23 metres. This restriction is to apply from 8am to 6pm, Monday to Friday.

6. Approves that these resolutions take effect when parking signage and/or road markings that evidence the restrictions described in this staff report are in place (or removed in the case of revocations).

Nathaniel Herz Jardine/Tim Scandrett

Carried

For 7 (Melanie Coker, Nathaniel Herz Jardine, Tim Scandrett, Kate Hodgins, Sophie Bond, Tim Lindley, Will Hall)

Against 2 (Keir Leslie, Roy Kenneally)

Abstain 0

TOTAL 9

10. Waihoru Spreydon-Cashmere-Heathcote Community Board - Tree Planting Plans (Various Parks)

Community Board Resolved SCBCC/2026/00041

Officer Recommendations accepted without change

Part C

That the Waihoru Spreydon-Cashmere-Heathcote Community Board:

1. Receives the information in the Waihoru Spreydon-Cashmere-Heathcote Community Board - Tree Planting Plans (Various Parks) Report.
2. Notes that the decision in this report is assessed as low significance based on the Christchurch City Council's Significance and Engagement Policy.
3. Approves the Urban Forest Tree Planting Plan for Addington Park as shown in Attachment A to the report on the meeting agenda.
4. Approves the Urban Forest Tree Planting Plan for Centaurus Park as shown in Attachment A to the report on the meeting agenda.
5. Approves the Urban Forest Tree Planting Plan for Centennial Park as shown in Attachment A to the report on the meeting agenda.
6. Approves the Urban Forest Tree Planting Plan for Cooks Reserve as shown in Attachment A to the report on the meeting agenda.
7. Approves the Urban Forest Tree Planting Plan for Cornelius O'Connor Reserve as shown in Attachment A to the report on the meeting agenda.
8. Approves the Urban Forest Tree Planting Plan for Curries Reserve as shown in Attachment A to the report on the meeting agenda.
9. Approves the Urban Forest Tree Planting Plan for Disraeli Reserve as shown in Attachment A to the report on the meeting agenda.
10. Approves the Urban Forest Tree Planting Plan for Hastings Reserve as shown in Attachment A to the report on the meeting agenda.

11. Approves the Urban Forest Tree Planting Plan for Kennaway Reserve as shown in Attachment A to the report on the meeting agenda.
12. Approves the Urban Forest Tree Planting Plan for Heathcote Domain as shown in Attachment A to the report on the meeting agenda.
13. Approves the Urban Forest Tree Planting Plan for Longley Reserve as shown in Attachment A to the report on the meeting agenda.
14. Approves the Urban Forest Tree Planting Plan for Taylors Mistake Beach as shown in Attachment A to the report on the meeting agenda.

Tim Scandrett/Melanie Coker

Carried

**11. Waihoru Spreydon Cashmere Heathcote Discretionary Response Fund 2025/26 Cashmere High School Board of Trustees, Matuku Community Theatre Incorporated, Sumner Community Residents Association Incorporated, Opawaho Trust
Community Board Resolved SCBCC/2026/00042**

Officer Recommendations accepted without change

Part C

That the Waihoru Spreydon-Cashmere-Heathcote Community Board:

1. Receives the information in the Waihoru Spreydon Cashmere Heathcote Discretionary Response Fund 2025/26 Cashmere High School Board of Trustees, Matuku Community Theatre Incorporated, Sumner Community Residents Association Incorporated, Opawaho Trust. report.
2. Notes that the decisions in this report are assessed as low significance based on the Christchurch City Council's Significance and Engagement Policy.
3. Approves a grant of \$2,000 from its 2025/26 Discretionary Response Fund to Cashmere High School Board of Trustees towards the cost of competing at the Future Problem Solving 2026 International Conference (World Finals).
4. Approves a grant of \$6,505 from its 2025/26 Discretionary Response Fund to Matuku Community Theatre Inc towards costume storage and makeup replacement.
5. Approves a grant of \$3,000 from its 2025/26 Discretionary Response Fund to Sumner Community Residents' Association Inc towards their website upgrade.
6. Approves a grant of \$10,000 from its 2025/26 Discretionary Response Fund to Opawaho Trust towards the Waltham Youth Mentoring Programme for youth worker wages.

Nathaniel Herz Jardine/Kate Hodgins

Carried

12. Waihoru Spreydon-Cashmere-Heathcote Community Board Area Report - May 2026

Community Board Resolved SCBCC/2026/00043

Officer Recommendations accepted without change

Part B

That the Waihoru Spreydon-Cashmere-Heathcote Community Board:

1. Receives the information in the Waihoru Spreydon-Cashmere-Heathcote Community Board Area Report - May 2026.

Keir Leslie/Nathaniel Herz Jardine

Carried

13. Elected Members' Information Exchange Te Whakawhiti Whakaaro o Te Kāhui Amorangi

Part B

Members exchanged information on matters of interest to the Board.

- Upcoming Council decision on burial ground land in Heathcote Ward.
- ANZAC rugby game held in Sumner; noted plans for new Sports Pavillon.
- Tree branch issue.
- Visit to Somerfield Community Hall request for solar panels.
- Mother of All Cleanups event held on 9 May 2026 organised by Avon-Heathcote Estuary Ihutai Trust.
- Return of Litter Boom in Heathcote River.
- Street berm issues on Rose Street.
- St Martins Croquet lawn.
- Heritage property in Sydenham.
- Imminent installation of pedestrian refuge in Hoon Hay.
- Council decision on Apollo Stadium to zone for mixed use and open space.
- Residential assistance scheme.
- Attendance at Council Food Resilience workshop.
- Dog Control Act Hearings Panel.

Karakia Whakakapi

Meeting concluded at 5.50 pm.

CONFIRMED THIS 11th DAY OF JUNE 2026

KEIR LESLIE
CHAIRPERSON

7. 29A Huntsbury Avenue - Proposed No Stopping Restrictions

Reference Te Tohutoro: 26/933800

Responsible Officer(s) Te Pou Matua: Toni Dakers, Traffic Engineer

Accountable ELT Member Pouwhakarae: Brent Smith, General Manager City Infrastructure

1. Purpose and Origin of the Report Te Pūtake Pūrongo

- 1.1 The purpose of this report is for the Waihoru Spreydon-Cashmere-Heathcote Community Board to approve the installation of No Stopping Restrictions on the inside of the curve adjacent to 29A Huntsbury Avenue.
- 1.2 This report has been written in response to concerns raised by an adjacent resident about parked vehicles causing drivers to cross the centreline in advance of the bend, where visibility is impeded due to the winding alignment and steep grade.
- 1.3 The recommended option is to install No Stopping Restrictions in accordance with Attachment A.

2. Officer Recommendations Ngā Tūtohu

That the Waihoru Spreydon-Cashmere-Heathcote Community Board:

1. Receives the information in the 29A Huntsbury Avenue - Proposed No Stopping Restrictions Report.
2. Notes that the decision in this report are assessed as low significance based on the Christchurch City Council's Significance and Engagement Policy.
3. Under Clause 6(2) of the Christchurch City Council Traffic and Parking Bylaw 2017 revokes any previous resolutions pertaining to traffic controls made pursuant to any bylaw to the extent that they are in conflict with the parking or stopping restrictions described in Resolutions 4 and 5 below.
4. Approves that in accordance with Clause 7 of the Christchurch City Council Traffic and Parking Bylaw 2017, that the stopping of vehicles be prohibited at any time on the east side of Huntsbury Avenue, commencing at a point 53 metres south of its intersection with Parklands Drive (measured from an extension of the southern kerblines), and extending in a southerly direction for a distance of 49 metres, as detailed on Attachment A (TP367401, dated 18/05/2026).
5. Approves that these resolutions take effect when parking signage and/or road markings that evidence the restrictions described in this staff report are in place (or removed in the case of revocations).

3. Executive Summary Te Whakarāpopoto Matua

- 3.1 Safety concerns have been raised by a local resident about vehicles being parked on the inside of the bend outside 29A Huntsbury Avenue. When vehicles are parked in this location, uphill traffic is required to cross the centreline to manoeuvre around them. This has resulted in reports of near misses as visibility is constrained due to the road alignment and steep grade.

- 3.2 Drivers turning right into the five properties on the outside of the bend (30A to 30E) are also required to wait further back (downhill) for a safe gap in traffic, in a location where visibility is not optimal.
- 3.3 Implementing the noted recommendations will lead to a reduction in the likelihood of a crash by improving sightlines and clearance for through traffic and residents accessing adjacent properties.
- 3.4 The recommended option is to install No Stopping Restrictions in accordance with Attachment A.

4. Background/Context Te Horopaki

- 4.1 Huntsbury Avenue is a Local Road providing access to residential properties as well as Huntsbury Track. Access to the track is located at the top of the hill.
- 4.2 A regular presence of cyclists is observed on this section of road due to the track access.
- 4.3 This road is also serviced by Bus Route 27 – the Northwood / Huntsbury route. Buses come every 20 minutes on weekdays to 6pm and every 30 minutes during evenings and weekends.
- 4.4 On the uphill approach to this curve, the marked traffic lane varies from approximately 3.5m to 3.7m wide. This is insufficient for through traffic to pass a parked vehicle without travelling over the centreline.
- 4.5 Furthermore, when drivers are parked on the immediate approach to this bend, residents waiting to turn right to access properties on the northwest side of the road (particularly 30A to 30E) are required to wait further back (downhill) in a location where forward visibility is not optimal.
- 4.6 A low parking demand is generally observed on the bend itself, however vehicles were observed to park on the immediate approach to the bend (up to two vehicles).
- 4.7 The road widens outside 29 Huntsbury Avenue, providing adequate width to safely accommodate on-street parking immediately downhill of the proposed No Stopping Restrictions.
- 4.8 A search of the NZ Transport Agency Crash Analysis System has been undertaken, there has been one crash reported in this location within the last five years. This was a non-injury crash involving a collision with a parked vehicle.
- 4.9 No crashes have been reported that involve conflicting vehicles or property access, however the issue was raised by an adjacent resident in response to near misses between opposing traffic. This is particularly a concern due to the presence of cyclists on Huntsbury Avenue, who at times are observed to travel downhill at high speeds.

Options Considered Ngā Kōwhiringa Whaiwhakaaro

- 4.10 The following reasonably practicable options were considered and are assessed in this report:
 - 4.10.1 Mark No Stopping Restrictions in accordance with Attachment A.
 - 4.10.2 Do nothing

Options Descriptions Ngā Kōwhiringa

- 4.11 **Preferred Option:** Mark No Stopping Restrictions in accordance with Attachment A

4.11.1 Option Advantages

- Improves safety for through traffic by restricting parking on the inside of the bend where visibility to oncoming traffic is constrained.

- Ensures drivers will not have to cross the centreline in advance of the curve.
- Provides clear space for local residents to wait within the marked traffic lane to turn right into their properties.

4.11.2 Option Disadvantages

- Removal of on-street parking

4.12 Alternative Option - Option 2: Do nothing

4.12.1 Option Advantages

- Retains on-street parking

4.12.2 Option Disadvantages

- Does not address any of the concerns raised by adjacent residents and assessed through staff investigations relating to the risk of conflict between opposing traffic.

5. Financial Implications Ngā Hīraunga Rauemi

Capex/Opex Ngā Utu Whakahaere

	Recommended Option	Option 2 - Do Nothing
Cost to Implement	Approximately \$340 for line marking	n/a
Maintenance/Ongoing Costs	Will be added to and covered by the area maintenance contract	n/a
Funding Source	Traffic Operations Team Operational budget	n/a
Funding Availability	Funding available	n/a
Impact on Rates	Negligible	n/a

6. Considerations Ngā Whai Whakaaro

Risks and Mitigations Ngā Mōrearea me ngā Whakamātautau

6.1 None identified.

Legal Considerations Ngā Hīraunga ā-Ture

6.2 Statutory and/or delegated authority to undertake proposals in the report:

6.2.1 Part 1, Clause 7 of the Christchurch City Council Traffic and Parking Bylaw 2017 provides Council with the authority to install parking or stopping restrictions by resolution.

6.2.2 Clause 6(2) of the Christchurch City Council Traffic and Parking Bylaw 2017 provides Council with the authority to subsequently amend or revoke any resolution made under this bylaw at any time.

6.2.3 The Community Boards have delegated authority from the Council to exercise the delegations as set out in the Delegations Register. The list of delegations for the Community Boards includes the resolution of stopping and traffic control devices.

6.2.4 The installation of any signs and/or markings associated with traffic control devices must comply with the Land Transport Rule: Traffic Control Devices 2004.

6.3 Other Legal Implications:

6.3.1 There is no other legal context, issue, or implication relevant to this decision.

- 6.3.2 This specific report has not been reviewed and approved by the Legal Services Unit however the report has been written using a general approach previously approved of by the Legal Services Unit, and the recommendations are consistent with the policy and legislative framework outlined in this report.

Strategy and Policy Considerations Te Whai Kaupapa here

- 6.4 The required decision:
- 6.4.1 Aligns with the [Christchurch City Council's Strategic Framework](#).
- 6.4.2 The recommendations in this report are consistent with the Christchurch Suburban Parking Policy.
- 6.4.3 The decisions in this report are assessed as low significance based on the Christchurch City Council's Significance and Engagement Policy. The level of significance was determined by the low level of impact and low number of people affected by the recommended decision.
- 6.5 The community engagement and consultation outlined in this report reflect the assessment.
- 6.6 This report supports the [Council's Long Term Plan \(2024 - 2034\)](#):
- 6.7 Transport
- 6.7.1 Activity: Transport
- Level of Service: 10.0.6.2 Reduce the number of death and serious injury crashes on the local road network - Five year rolling average <95 crashes per year
 - Level of Service: 10.0.6.1 Reduce the number of death and serious injury crashes on the local road network (DIA 1) - 4 less than previous FY

Community Impacts and Views Ngā Mariu ā-Hāpori

- 6.8 Affected property owners and residents were advised of the recommended option by letter drop. Eight letters were delivered.
- 6.9 Four submissions were received, all supportive of the proposal.
- 6.10 The Team Leader Parking Compliance supports the preferred option.
- 6.11 The decision affects the following wards/Community Board areas:
- 6.11.1 Cashmere Ward.
- 6.11.2 Waihoru Spreydon-Cashmere-Heathcote Community Board.

Impact on Mana Whenua Ngā Whai Take Mana Whenua

- 6.12 The decision does not involve a significant decision concerning ancestral land or a body of water or other elements of intrinsic value, therefore this decision does not specifically impact Mana Whenua, their culture and traditions.
- 6.13 The decision does not involve a matter of interest to Mana Whenua and will not impact on our agreed partnership priorities with Ngā Papatipu Rūnanga.



Climate Change Impact Considerations Ngā Whai Whakaaro mā te Āhuarangi

- 6.14 The proposals in this report are unlikely to contribute significantly to adaptation to the impacts of climate change or emissions reductions.

7. Next Steps Ngā Mahinga ā-muri

- 7.1 If approved, staff will arrange for the new line markings to be installed.

Attachments Ngā Tāpirihanga

No.	Title	Reference	Page
A  	Site Plan: 29A Huntsbury Avenue Proposed No Stopping Restrictions	26/1046828	24

In addition to the attached documents, the following background information is available:

Document Name - Location / File Link
Not applicable

Signatories Ngā Kaiwaitohu

Author	Toni Dakers - Traffic Engineer
Approved By	Kathy Graham - Acting Operations Manager Stephen Wright - Head of Transport & Waste Management

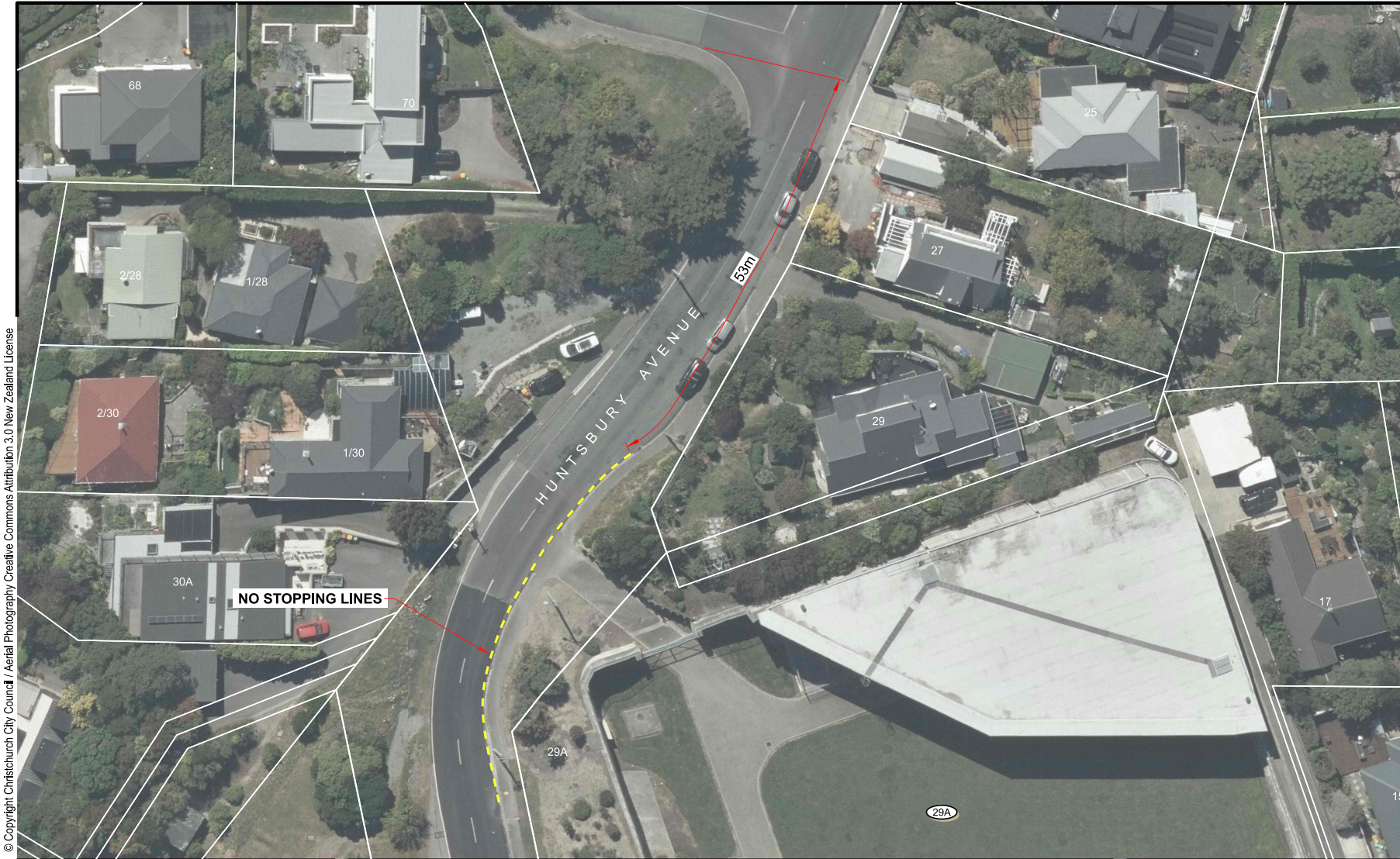

8. Proposed No Stopping Restrictions - Dobson Street - Selwyn Street

Reference Te Tohutoro: 26/995522

Responsible Officer(s) Te Pou Matua: Benjamin Zmijewski, Senior Transportation Engineer

Accountable ELT Member Pouwhakarae: Brent Smith, General Manager City Infrastructure

1. Purpose and Origin of the Report Te Pūtake Pūrongo

- 1.1 The purpose of this report is for the Waihoru Spreydon-Cashmere-Heathcote Community Board to approve no stopping restrictions at the intersection of Dobson Street and Selwyn Street in Spreydon.
- 1.2 This report has been written in response to safety concerns due to vehicles parking close to the Dobson Street-Selwyn Street intersection. This can lead to drivers having difficulty completing turning movements at the intersection thereby increasing the chance of a collision.

2. Officer Recommendations Ngā Tūtohu

That the Waihoru Spreydon-Cashmere-Heathcote Community Board:

1. Receives the information in the Proposed No Stopping Restrictions - Dobson Street - Selwyn Street Report.
2. Notes that the decision in this report are assessed as low significance based on the Christchurch City Council's Significance and Engagement Policy.
3. Under Clause 6(2) of the Christchurch City Council Traffic and Parking Bylaw 2017 revokes any previous resolutions pertaining to traffic controls made pursuant to any bylaw to the extent that they are in conflict with the parking or stopping restrictions described in resolutions four to seven below.

Dobson Street – No stopping restrictions

4. Approves that in accordance with Clause 7 of the Christchurch City Council Traffic and Parking Bylaw 2017, that the stopping of vehicles be prohibited at any time on the north-western side of Dobson Street, commencing at its intersection with Selwyn Street and extending in a south-westerly direction for a distance of 10 metres, as detailed on Attachment A.
5. Approves that in accordance with Clause 7 of the Christchurch City Council Traffic and Parking Bylaw 2017, that the stopping of vehicles be prohibited at any time on the south-eastern side of Dobson Street, commencing at its intersection with Selwyn Street and extending in a south-westerly direction for a distance of 10 metres, as detailed on Attachment A.

Selwyn Street – No stopping restrictions

6. Approves that in accordance with Clause 7 of the Christchurch City Council Traffic and Parking Bylaw 2017, that the stopping of vehicles be prohibited at any time on the south-western side of Selwyn Street, commencing at its intersection with the northern kerb line of Dobson Street and extending in a north-westerly direction for a distance of 22 metres, as detailed on Attachment A.

7. Approves that in accordance with Clause 7 of the Christchurch City Council Traffic and Parking Bylaw 2017, that the stopping of vehicles be prohibited at any time on the south-western side of Selwyn Street, commencing at its intersection with the southern kerb line of Dobson Street and extending in a south-easterly direction for a distance of 19 metres, as detailed on Attachment A.
8. Approves that these resolutions take effect when parking signage and/or road markings that evidence the restrictions described in this staff report are in place (or removed in the case of revocations).

3. Executive Summary Te Whakarāpopoto Matua

- 3.1 Safety concerns have been raised at the intersection of Dobson Street and Selwyn Street due to vehicles parking close to the intersection.
- 3.2 The recommended option is to Install No Stopping restrictions in accordance with Attachment A. The length of No Stopping restrictions in this option is the minimum length needed to improve turning movements between Dobson Street and Selwyn Street.
- 3.3 Implementing the noted recommendations will lead to a reduction in the risk of a crash between vehicles turning at the intersection.
- 3.4 Accessibility outcomes for people walking along the south-western side of Selwyn Street will also be improved by reducing the chance of vehicles blocking the kerb cutdowns.
- 3.5 The recommendations in this report will help to achieve the desired community outcomes of a well-connected and accessible city through improved road safety.

4. Background/Context Te Horopaki

- 4.1 Dobson Street and Selwyn Street is an uncontrolled T-intersection, with priority given to Selwyn Street.
- 4.2 Selwyn Street is a collector road with approximately 7,000 vehicles per day. Dobson Street is a local road, cul-de-sac with approximately 200 vehicles per day.
- 4.3 Residents have noted that vehicles can sometimes be parked on Dobson Street within 6m of the intersection with Selwyn Street. This can interrupt vehicle turning movements into and out of Dobson Street. Additionally, vehicles were noted to block the kerb cutdowns for people walking along Selwyn Street.
- 4.4 Although the Land Transport (Road User) Rule 2004 prevents people from parking within 6m of an intersection, Council often installs No Stopping restrictions to further reinforce this rule.
- 4.5 There are existing No Stopping restrictions on Selwyn Street to achieve safe intersection sight distance so that drivers can exit Dobson Street safely.
- 4.6 Parking demand on Dobson Street has increased recently due to the completion of nearby multi-unit residential developments.
- 4.7 All other side streets intersecting Selwyn Street from the south-west (Cheviot Street, Rosebery Street etc.) have intersection threshold treatments such as raised coloured paving, no stopping lines, or kerb build outs.
- 4.8 This proposal removes a similar amount of on-street parking on Dobson Street to achieve similar levels of safety as the surrounding traffic environment in nearby streets.

Options Considered Ngā Kōwhiringa Whaiwhakaaro

4.9 The following reasonably practicable options were considered and are assessed in this report:

- 4.9.1 Option 1 - Install No Stopping restrictions on Dobson Street
- 4.9.2 Option 2 - Do Nothing

Options Descriptions Ngā Kōwhiringa

4.10 **Preferred Option:** Option 1 - Install No Stopping restrictions at the intersection of Dobson Street and Selwyn Street

4.10.1 **Option Description:** Install No Stopping restrictions Dobson Street to improve visibility, safety, and vehicle manoeuvrability.

4.10.2 Option Advantages

- Reduces the likelihood of unsafe or obstructive parking
- Improves consistency of driver parking behaviour
- Reduces the likelihood of vehicle conflict for turning movements

4.10.3 Option Disadvantages

- A minor reduction in the amount of available on-street parking.

4.11 Option 2 - Do Nothing

4.11.1 **Option Description:** Retain the existing on-street parking layout near the Dobson Street and Selwyn Street intersection without introducing additional parking restrictions.

4.11.2 Option Advantages

- Existing on-street parking supply remains unchanged.

4.11.3 Option Disadvantages

- Vehicles may occasionally cause turning movement difficulty and complexity for drivers entering or exiting Dobson Street
- Vehicles may occasionally block kerb cutdowns thereby impacting accessibility for people walking along the south-western side of Selwyn Street.
- Ongoing potential for complaints from residents and road users.

5. Financial Implications Ngā Hiraunga Rauemi

Capex/Opex Ngā Utu Whakahaere

	Recommended Option	Option 2 – Do Nothing
Cost to Implement	\$750	\$0
Maintenance/Ongoing Costs	Covered by existing maintenance contract	N/A
Funding Source	Traffic Operations - Road Markings and Signs Budget	N/A
Funding Availability	Available	N/A
Impact on Rates	N/A	N/A

6. Considerations Ngā Whai Whakaaro

Risks and Mitigations Ngā Mōrearea me ngā Whakamātautau

6.1 None identified.

Legal Considerations Ngā Hiraunga ā-Ture

6.2 Statutory and/or delegated authority to undertake proposals in the report:

6.2.1 Part 1, Clause 7 of the Christchurch City Council Traffic and Parking Bylaw 2017 provides Council with the authority to install parking or stopping restrictions by resolution.

6.2.2 Clause 6(2) of the Christchurch City Council Traffic and Parking Bylaw 2017 provides Council with the authority to subsequently amend or revoke any resolution made under this bylaw at any time.

6.2.3 The Community Boards have delegated authority from the Council to exercise the delegations as set out in the Delegations Register. The list of delegations for the Community Boards includes the resolution of stopping and traffic control devices.

6.2.4 The installation of any signs and/or markings associated with traffic control devices must comply with the Land Transport Rule: Traffic Control Devices 2004.

6.3 Other Legal Implications:

6.3.1 There is no other legal context, issue, or implication relevant to this decision.

6.3.2 This specific report has not been reviewed and approved by the Legal Services Unit however the report has been written using a general approach previously approved of by the Legal Services Unit, and the recommendations are consistent with the policy and legislative framework outlined in this report.

Strategy and Policy Considerations Te Whai Kaupapa here

6.4 The required decisions

6.4.1 Align with the [Christchurch City Council's Strategic Framework](#).

6.4.2 The recommendations in this report are consistent with the Christchurch Suburban Parking Policy.

6.4.3 The decisions in this report are assessed as low significance based on the Christchurch City Council's Significance and Engagement Policy. The level of significance was determined by the low level of impact and low number of people affected by the recommended decision.

6.5 The community engagement and consultation outlined in this report reflect the assessment.

6.6 This report supports the [Council's Long Term Plan \(2024 - 2034\)](#):

6.7 Transport

6.7.1 Activity: Transport

- Level of Service: 10.0.6.2 Reduce the number of death and serious injury crashes on the local road network - Five year rolling average <95 crashes per year
- Level of Service: 10.0.6.1 Reduce the number of death and serious injury crashes on the local road network (DIA 1) - 4 less than previous FY

Community Impacts and Views Ngā Mariu ā-Hāpori

- 6.8 Nearby property owners and residents were advised of the initial option by letter. This letter and attached plan were delivered on Friday 10 April 2026.
- 6.9 Three residents opposed the initial option due to concerns about the loss of on-street parking and reduced ability to park in front of their homes. One resident supported the initial option.
- 6.10 The residents that opposed the initial option noted that on-street parking demand is increasing on Dobson Street due to the completion of nearby multi-unit developments, with concerns that additional restrictions could further increase parking pressure.
- 6.11 Following feedback from residents, staff prepared a revised plan that reduced the extents of the proposed no stopping restrictions while still addressing safety concerns related to vehicle turning movements at the nearby intersection.
- 6.12 All submitters were updated and sent the revised plan for further comment.
- 6.13 All submitters supported the revised proposal which then became the recommended option of this report.
- 6.14 Feedback from residents also requested ongoing monitoring and enforcement of illegal parking behaviour in the area, including at nearby bus stops and existing no stopping lines.
- 6.15 The Team Leader Parking Compliance supports the preferred option.
- 6.16 The decision affects the following wards/Community Board areas:
 - 6.16.1 Waihoru Spreydon-Cashmere-Heathcote Community Board

Impact on Mana Whenua Ngā Whai Take Mana Whenua

- 6.17 The decision does not involve a significant decision concerning ancestral land or a body of water or other elements of intrinsic value, therefore this decision does not specifically impact Mana Whenua, their culture and traditions.
- 6.18 The decision does not involve a matter of interest to Mana Whenua and will not impact on our agreed partnership priorities with Ngā Papatipu Rūnanga.
- 6.19 The proposal involves a minor reduction in the amount of on-street parking, so is unlikely to be a matter of interest to Mana Whenua.

Climate Change Impact Considerations Ngā Whai Whakaaro mā te Āhuarangi

- 6.20 The proposals in this report are unlikely to contribute significantly to adaptation to the impacts of climate change or emissions reductions.
- 6.21 The proposals relate to prohibiting on-street parking near an intersection for safety purposes. This is unlikely to have any significant impact on emissions.

7. Next Steps Ngā Mahinga ā-muri

- 7.1 If approved, the parking restrictions will be implemented four to six weeks after the contractor receives the request. However, this timeline for implementation is subject to other factors outside of Council's control, such as contractor resourcing and work prioritisation.

Attachments Ngā Tāpirihanga

No.	Title	Reference	Page
A 	Attachment A - Dobson Street Selwyn Street - Proposed No Stopping Restrictions	2026/0997933	31

In addition to the attached documents, the following background information is available:

Document Name - Location / File Link
Not applicable

Signatories Ngā Kaiwaitohu

Author	Ben Zmijewski - Senior Transportation Engineer
Approved By	Kathy Graham - Acting Operations Manager Stephen Wright - Head of Transport & Waste Management



© Copyright Christchurch City Council / Aerial Photography Creative Commons Attribution 3.0 New Zealand License

Christchurch
City Council

Dobson Street
Proposed No Stopping Restrictions
For Board Approval

Original Plan Size: A4
Drawn: VMI Issue 2 20/04/2026
Designed: BZ Drawing: TG153050
Approved: LB Project:

9. Orion Easement over Reserve - 41R Truscotts Road

Reference Te Tohutoro: 26/927882

Responsible Officer(s) Te Barry Woodland, Property Consultant; Katharine Jones, Project
Pou Matua: Manager, Transport

Accountable ELT Brent Smith, General Manager City Infrastructure
Member Pouwhakarae:

1. Purpose and Origin of the Report Te Pūtake Pūrongo

- 1.1 The purpose of this report is to seek the Community Board's delegated approval to grant an easement in gross to Orion for underground cabling through Council reserve land at 41R Truscotts Road, Heathcote, associated with the Heathcote Expressway Major Cycle Route (MCR).
- 1.2 The report is staff generated arising from a request from Orion for Council to grant an easement over their electrical infrastructure.

2. Officer Recommendations Ngā Tūtohu

That the Waihoru Spreydon-Cashmere-Heathcote Community Board:

1. Receives the information in the Orion Easement over Reserve - 41R Truscotts Road report.
2. Notes that the decision in this report is assessed as low significance based on the Christchurch City Council's Significance and Engagement Policy.
3. Approves the grant of an easement in favour of Orion New Zealand Limited to convey electricity at 41R Truscotts Road described as Lot 33 DP 328231 and held in Record of Title 115151.
4. Notes that (3) will be subject to the consent of the Minister of Conservation pursuant to Section 48(1)(d) of the Reserves Act 1977. In this regard endorse the Chief Executive, acting under a delegation from the Council, to exercise the Minister of Conservation's consent to the easement, as delegated to the Council from the Minister under the Instrument of Delegation for Territorial Authorities dated 12 June 2013.
5. Delegates authority to the Manager Property Consultancy to do all things necessary and make any decisions at his sole discretion that are consistent with the intent of this report to implement the resolution above including but not limited to finalising the documentation in relation to (3) above.

3. Executive Summary Te Whakarāpopoto Matua

- 3.1 Orion require a retrospective easement to be granted by Council for an underground cable installed to facilitate overhead lighting along a section of the Heathcote Expressway MCR in Truscotts Road, Heathcote.
- 3.2 The intended alignment of the cable was to be installed across Council owned fee simple land (61R Truscotts Road) and then within legal road. An easement agreement has been entered into with Orion over this intended alignment under staff delegation.

- 3.3 During installation the section of the cable originally intended to be installed within legal road was re-routed into adjacent Council administered reserve (41R Truscotts Rad) to avoid close proximity to an adjacent Mobil pipeline.
- 3.4 This reserve is held subject to the Reserves Act 1977 for which the delegation to approve the grant of easements sits with the community board, which is the purpose of this report.

4. Background/Context Te Horopaki

Orion Cable Alignment

- 4.1 As part of the process to provide lighting along the Heathcote Expressway MCR Orion has installed underground cabling along a short section of Truscotts Road from Ferrymead Park Drive.
- 4.2 As is their current practice for infrastructure located on private land, Orion has requested that Council grant an easement over their infrastructure.
- 4.3 The original planned cable alignment traversed Council owned fee simple land at 61R Truscotts Road before exiting onto and continuing along legal (Truscotts) road, shown (indicatively) as the dotted red line in figure 1 below. An Easement Agreement, based on the easement plan shown in figure 2, has been entered into with Orion under staff delegation.

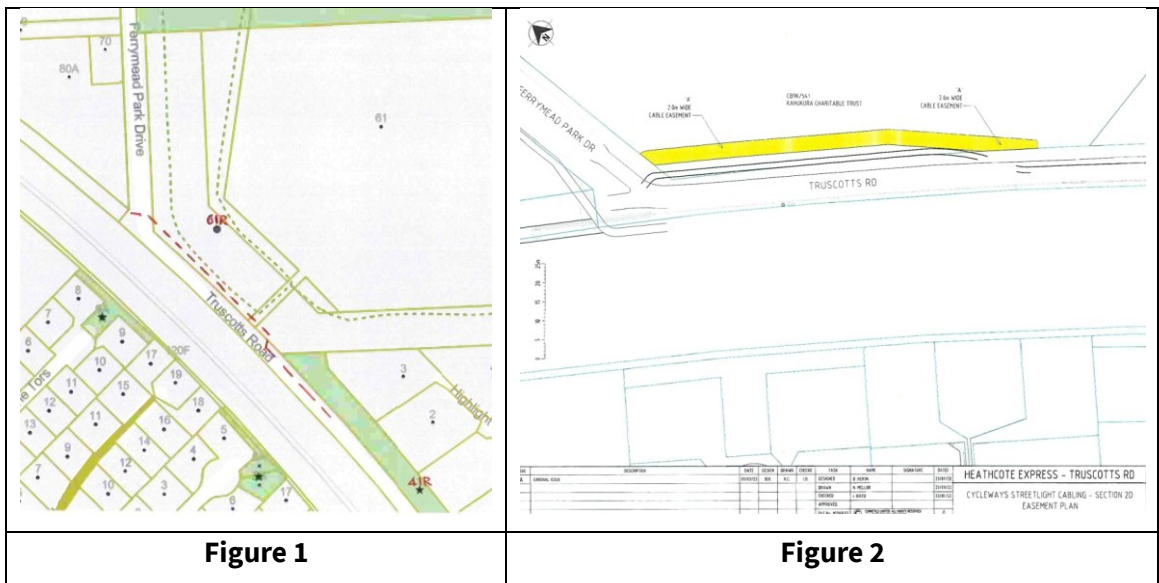

- 4.4 However, on receipt of as-built plans from Orion, it subsequently became apparent that the cable had been re-routed slightly to avoid an adjacent high pressure Mobil pipeline (situated in legal road). As a consequence the cable alignment originally intended to be located within legal road is now situated just within the boundary of 41R Truscotts Road indicated by the blue line in figure 3, and indicatively by the red dotted line in figure 4, below.



- 4.5 The land (41R Truscotts Road) is described as Lot 33 DP 328231 and held in Record of Title 115151. It is held and administered by Council as a Local Purpose (Waterway) Reserve subject to the Reserves Act 1977.
- 4.6 There is no delegation for staff to grant easements over land held subject to the Reserves Act. This delegated approval resides with community boards and is the purpose of this report.

Statutory Process – Reserves Act 1977

- 4.7 Given that the installation of the underground cable is related to the cycleway lighting it is appropriate for Council to use section 48(1)(d) of the Act to grant a registered easement over the reserve ‘for an electrical installation or work’.
- 4.8 The installation of the underground cable will have negligible impact on the reserve and is a common arrangement throughout the city.
- 4.9 Registration of the easement in favour of Orion will create a property interest on the title which exists in perpetuity until surrendered by the easement holder. This is a common and low risk process.
- 4.10 Typically, the easement Grantee would be required to pay the Grantor a one-off compensation sum. In this case no compensation will be charged to Orion as the cable is a benefit to Council as it provides power to the cycleway lighting. The easement will be granted on otherwise standard conditions.
- 4.11 Section 48 (3) of the Act provides that it is not necessary to seek the community’s views or to consult over the proposal where the reserve is not being materially altered or permanently damaged. As the cable is located underground there is no requirement for public notification.
- 4.12 Staff recommend that the Community Board exercise its delegation to approve the granting of the easement to Orion subject to the Council’s Chief Executive in turn exercising the Minister of Conservation’s delegated consent to the easement.
- 4.13 On the basis that the grant of easement over 41R Truscotts Road is approved by the Community Board staff will then seek to register the Orion easements over 61R and 41R Truscotts Road simultaneously within the same e-dealing.
- 4.14 The following related memos/information were circulated to the meeting members:

Date	Subject
	Not applicable

- 4.15 The following related information session/workshops have taken place for the members of the meeting:

Date	Subject
	Not applicable

Options Considered Ngā Kōwhiringa Whaiwhakaaro

- 4.16 The following reasonably practicable options were considered and are assessed in this report:

- 4.16.1 Approve the grant of easement to Orion.
- 4.16.2 Do not approve the grant of easement to Orion.

- 4.17 The following options were considered but ruled out:

- 4.17.1 No other options were considered. The decision is limited to approving or not approving the grant of easement.

Options Descriptions Ngā Kōwhiringa

- 4.18 **Option 1 (Preferred Option):** Council approve the grant and registration of an easement to Orion.

Advantages	Disadvantages
The cable provides power to the cycleway lighting	Creates a permanent property right for Orion over the reserve
Orion's infrastructure will be protected and the easement recorded on the property title	

- 4.19 **Option 2:** Council do not approve the grant of easement to Orion.

Advantages	Disadvantages
There are no practical advantages with this option	The cable will remain unrecorded on the property title
	It would likely create an adversarial issue with Orion as the cable is already installed

Analysis Criteria Ngā Paearu Wetekina

- 4.20 The decision in this report is relatively simple – to approve or not approve the grant of an easement over the reserve in favour of Orion noting that the installed cable does not materially alter or permanently damage the reserve. As such further analysis over and above that which is outlined in the consideration of options above was not deemed necessary.

5. Financial Implications Ngā Hiraunga Rauemi

Capex/Opex Ngā Utu Whakahaere

	Recommended Option	Option 2 – Do not approve
Cost to Implement	Easement Costs: survey, legal and registration costs – estimated at \$11,500 plus GST	Nil
Maintenance/Ongoing Costs	Nil – Orion's cost	Nil

Funding Source	Transport: CPMS# 23100	N/A
Funding Availability	Yes. Operational Budget	N/A
Impact on Rates	Nominal	N/A

5.1 Note: the costs noted above (\$11,500 plus GST) are expected to cover off the process of registering the easements over both 61R and 41R Truscotts Road concurrently.

6. Considerations Ngā Whai Whakaaro

Risks and Mitigations Ngā Mōrearea me ngā Whakamātautau

6.1 There are no risks associated with this Council decision. The cable has already been installed and the registration of the easement will be dealt with on a business-as-usual basis.

Legal Considerations Ngā Hīraunga ā-Ture

6.2 Statutory and/or delegated authority to undertake proposals in the report:

6.2.1 The Community Board holds a delegation to grant easements over Council owned land governed under the Reserves Act 1977.

6.2.2 The Board also has the mandate to signal support for the Chief Executive to exercise the delegation on behalf of the Minister of Conservation, being the granting of a new easement over reserve land in accordance with section 48(1)(d) of the Act.

6.3 Other Legal Implications:

6.3.1 Aside from the standard easement processing, there is no legal context, issue, or implication relevant to this decision.

Strategy and Policy Considerations Te Whai Kaupapa here

6.4 The required decision:

6.4.1 Aligns with the [Christchurch City Council's Strategic Framework](#) as it promotes positive community participation and outcomes, encourages resilient (safe and healthy) communities and contributes to a liveable (well-connected and accessible) city. The easement to Orion is integral to these outcomes.

6.4.2 Is assessed as low significance based on the Christchurch City Council's Significance and Engagement Policy given that the proposed easement is an integral element of the Heathcote Expressway MCR, the development of which has been widely publicised and is fully consented. Also, the reserve is not materially altered or affected such that public notification is not required under the Reserves Act.

6.4.3 Is consistent with Council's Plans and Policies. Although there is no policy regarding granting easements over reserves to an external organisation it is common practice if alternative solutions have been investigated and are not practicable.

6.5 This report supports the [Council's Long Term Plan \(2024 - 2034\)](#):

6.6 Transport

6.6.1 Activity: Transport

- Level of Service: 10.5.42 Increase the infrastructure provision for active and public modes - >= 635 kilometres (total combined length)

Community Impacts and Views Ngā Mariu ā-Hāpori

6.7 The decisions in this report are operational in nature and do not directly impact any specific group or individuals.

- 6.7.1 The decision affects the Waihoru Spreydon-Cashmere-Heathcote Community Board area.

Impact on Mana Whenua Ngā Whai Take Mana Whenua

- 6.8 The decision involves a significant decision in relation to ancestral land, a body of water or other elements of intrinsic value, therefore this decision does specifically impact Mana Whenua, their culture, and traditions.
- 6.9 The decision involves a matter of interest to Mana Whenua and could impact on our agreed partnership priorities with Ngā Papatipu Rūnanga.
- 6.10 In this context the wider Heathcote Expressway MCR project was the subject of comprehensive public consultation at the project planning stage and is fully consented. It is noted that there are no specific natural or cultural overlays noted in the District Plan for 41R Truscotts Road and that the underground cable is insitu and has no material impact on the land.

Climate Change Impact Considerations Ngā Whai Whakaaro mā te Āhuarangi

- 6.11 The decision (to grant an easement to Orion) will have no impact on climate change or emissions reduction given the nature of the underground installation. However, the easement (as an integral part of the cycleway) will likely contribute to some positive impacts resulting from promoting increased cycle use in the city.

7. Next Steps Ngā Mahinga ā-muri

- 7.1 On the basis that the Board approve the Officer Recommendations staff will request the Chief Executive to exercise the Minister of Conservation's delegated consent to the easement and then prepare the documentation necessary to facilitate registration of the easement.

Attachments Ngā Tāpirihanga

There are no attachments to this report.

In addition to the attached documents, the following background information is available:

Document Name - Location / File Link
Not applicable

Signatories Ngā Kaiwaitohu

Authors	Barry Woodland - Property Consultant Katharine Jones - Project Manager
Approved By	Angus Smith - Manager Property Consultancy Stephen Wright - Head of Transport & Waste Management

10. Sacred Heart School Parking Restrictions

Reference Te Tohutoro: 26/337180

Responsible Officer(s) Te Pou Matua: Ashley Beaton, Community Travel Advisor

Accountable ELT Member Pouwhakarae: Brent Smith, General Manager City Infrastructure

1. Purpose and Origin of the Report Te Pūtake Pūrongo

- 1.1 For the Waihoru Spreydon-Cashmere-Heathcote Community Board to approve the installation of P3 parking and changes to the bus stop outside Sacred Heart School in accordance with Attachment A.
- 1.2 This report has been written in response to concerns raised by Sacred Heart School who have found that the current bus stop is underutilised and the current parking at pick up and drop off times are inadequate.
- 1.3 The scheme for approval will improve safety around the school, as it will reduce hazardous stopping behaviours and improve the efficiency of student pick-ups and drop-offs.

2. Officer Recommendations Ngā Tūtohu

That the Waihoru Spreydon-Cashmere-Heathcote Community Board:

1. Receives the information in the Sacred Heart School Parking Restrictions Report.
2. Notes that the decision in this report are assessed as low significance based on the Christchurch City Council's Significance and Engagement Policy.
3. In accordance with Clause 6(2) of the Christchurch City Council Traffic & Parking Bylaw 2017, revokes any previous resolutions pertaining to traffic controls made pursuant to any bylaw to the extent that they are in conflict with the parking or stopping restrictions described in resolutions 4 to 6 below.
4. Approves in accordance with Clause 7 of the Christchurch City Council Traffic & Parking Bylaw 2017, that the parking of all vehicles be restricted to a maximum of three minutes on the south-west side of Spencer Street commencing at a point 48 meters northwest of its intersection with Poulson Street (Measured from an extension of the kerbline) and extending in a nor 'westerly direction for a distance of 16 meters as detailed in **Attachment A** (TG153017, dated 16/03/2026). This restriction is to apply from 8:15am to 9:15am, and from 2:30pm to 3:30pm on Monday, Tuesday, Thursday, and Friday only
5. Approves in accordance with Clause 7 of the Christchurch City Council Traffic & Parking Bylaw 2017, that a bus stop be installed on the south-west side of Spencer Street commencing at a point 48 meters northwest of its intersection with Poulson Street and extending in a nor 'westerly direction for a distance of 16 meters as detailed in **Attachment A** (TG153017, dated 16/03/2026). This restriction is to apply from 8:30am – 3:30pm on a Wednesday only.
6. Approves that these resolutions take effect when road markings and parking signage that evidence the restrictions described in this staff report are installed.

3. Executive Summary Te Whakarāpopoto Matua

- 3.1 Concerns have been raised by Sacred Heart School regarding the lack of use of the bus stop outside their Spencer Street entrance, and how the space could be more effectively used as parent/caregiver parking. The bus stop is currently only used on Wednesdays during school hours.
- 3.2 This report recommends the conversion of the existing bus stop on Spencer Street adjacent to Sacred Heart School to P3 parking restrictions during pick-up and drop-off times. The proposed restriction would limit the parking of all vehicles to a maximum of three minutes during school pick-up and drop-off periods (8:15am – 9:15am and 2:30pm – 3:30pm) on Monday, Tuesday, Thursday, and Friday only.

4. Background/Context Te Horopaki

- 4.1 A bus stop is currently in place on Spencer Street adjacent to Sacred Heart School.
- 4.2 The current bus stop parking restrictions are in place on weekdays from 8:30am – 3:30pm. This arrangement has been found to be impractical for users of the area, as the bus stop is only used on a Wednesday during school hours (8:30am - 3:30pm).
- 4.3 The installation of parking restrictions at this location aim to increase the quantity of parking spaces outside Sacred Heart School during pickup and drop off times, whilst also retaining the bus stop as it is required by the school. It also aims to reduce hazardous parking behaviours, thus improving safety for students.
- 4.4 Approval is required from the Waihoru Spreydon-Cashmere-Heathcote Community Board.
- 4.5 If approved, the recommendations will be implemented within the current financial year (generally around four weeks after the contractor receives the request, but this is subject to other factors such as resourcing and prioritisation beyond Council's control).

Options Considered Ngā Kōwhiringa Whaiwhakaaro

- 4.6 The following reasonably practicable options were considered and are assessed in this report:
 - 4.6.1 Install parking restrictions on Spencer Street on the existing bus stop at pickup and drop off times on a Monday – Tuesday and Thursday – Friday.
 - 4.6.2 Maintain the status quo.

Options Descriptions Ngā Kōwhiringa

- 4.7 **Install parking restrictions on Spencer Street on the existing bus stop at pickup and drop off times on a Monday – Tuesday and Thursday – Friday.**
 - 4.7.1 Option Advantages
 - Increases the space available for pickup and drop off parking for Sacred Heart School.
 - Maintains access for the bus on the Wednesday, when the stop is currently utilised.
 - Uses the existing yellow lines painted on the road (reducing cost).
 - Responds to the concerns raised by Sacred Heart School.
 - 4.7.2 Option Disadvantages
 - Cost incurred by installing the restrictions (minimal).

4.8 Option 2: Maintain the status quo.

4.8.1 Option Advantages

- No physical sign and/or road marking changes required.

4.8.2 Option Disadvantages

- The underutilised bus stop will remain.
- Does not respond to the concerns raised by Sacred Heart School.

5. Financial Implications Ngā Hīraunga Rauemi

Capex/Opex Ngā Utu Whakahaere

	Recommended Option	Option 2 – Do nothing
Cost to Implement	\$700	n/a
Maintenance/Ongoing Costs	Covered by the existing maintenance contract.	Covered by the existing maintenance contract.
Funding Source	Traffic Operations Team traffic signs and markings budget.	n/a

6. Considerations Ngā Whai Whakaaro

Risks and Mitigations Ngā Mōrearea me ngā Whakamātautau

6.1 None identified.

Legal Considerations Ngā Hīraunga ā-Ture

6.2 Statutory and/or delegated authority to undertake proposals in the report:

6.2.1 Part 1, Clause 7 of the Christchurch City Council Traffic and Parking Bylaw 2017 provides Council with the authority to install parking or stopping restrictions by resolution.

6.2.2 Clause 6(2) of the Christchurch City Council Traffic and Parking Bylaw 2017 provides Council with the authority to subsequently amend or revoke any resolution made under this bylaw at any time.

6.2.3 The Community Boards have delegated authority from the Council to exercise the delegations as set out in the Delegations Register. The list of delegations for the Community Boards includes the resolution of stopping and traffic control devices.

6.2.4 The installation of any signs and/or markings associated with traffic control devices must comply with the Land Transport Rule: Traffic Control Devices 2004.

6.3 Other Legal Implications:

6.3.1 There is no other legal context, issue, or implication relevant to this decision.

6.3.2 This specific report has not been reviewed and approved by the Legal Services Unit however the report has been written using a general approach previously approved of by the Legal Services Unit, and the recommendations are consistent with the policy and legislative framework outlined in this report.

Strategy and Policy Considerations Te Whai Kaupapa here

6.4 The required decisions:

6.4.1 Align with the [Christchurch City Council’s Strategic Framework](#).

- 6.4.2 Are consistent with the Christchurch Suburban Parking Policy.
- 6.4.3 Are assessed as low significance based on the Christchurch City Council’s Significance and Engagement Policy. The level of significance was determined by the low level of impact and low number of people affected by the recommended decision.
- 6.5 This report supports the [Council's Long Term Plan \(2024 - 2034\)](#):
- 6.6 Transport
 - 6.6.1 Activity: Transport
 - Level of Service: 10.3.3 Maintain customer satisfaction with the ease of use of Council on-street parking facilities - >=50%

Community Impacts and Views Ngā Mariu ā-Hāpori

- 6.7 Sacred Heart School was consulted and supports the proposal.
- 6.8 Given the minor nature of the proposed change to an existing bus stop and the limited number of people affected, no additional community consultation was undertaken.
- 6.9 The Team Leader Parking Compliance supports the preferred option.
- 6.10 The decision affects the following wards/Community Board areas:
 - 6.10.1 Spreydon Ward

Impact on Mana Whenua Ngā Whai Take Mana Whenua

- 6.11 The decision does not involve a significant decision concerning ancestral land or a body of water or other elements of intrinsic value, therefore this decision does not specifically impact Mana Whenua, their culture and traditions.
- 6.12 The decision does not involve a matter of interest to Mana Whenua and will not impact on our agreed partnership priorities with Ngā Papatipu Rūnanga.



Climate Change Impact Considerations Ngā Whai Whakaaro mā te Āhuarangi

- 6.13 The proposals in this report are unlikely to contribute significantly to adaptation to the impacts of climate change or emissions reductions.
- 6.14 This is a minor proposal that is principally intended to address road safety in this location. Due to the minor nature of the works, it is not intended to have any impact on climate change.

7. Next Steps Ngā Mahinga ā-muri

- 7.1 If approved, staff will arrange for the Parking restrictions to be installed.

Attachments Ngā Tāpirihanga

No.	Title	Reference	Page
A  	Sacred Heart Parking Plan	26/547242	44

In addition to the attached documents, the following background information is available:

Document Name – Location / File Link
Not applicable

Signatories Ngā Kaiwaitohu

Authors	Ashley Beaton - Community Travel Advisor Tanya Smith - Travel Planning Assistant
Approved By	Sarah Anderson - Team Leader Travel Demand Management Kathy Graham - Acting Operations Manager Stephen Wright - Head of Transport & Waste Management

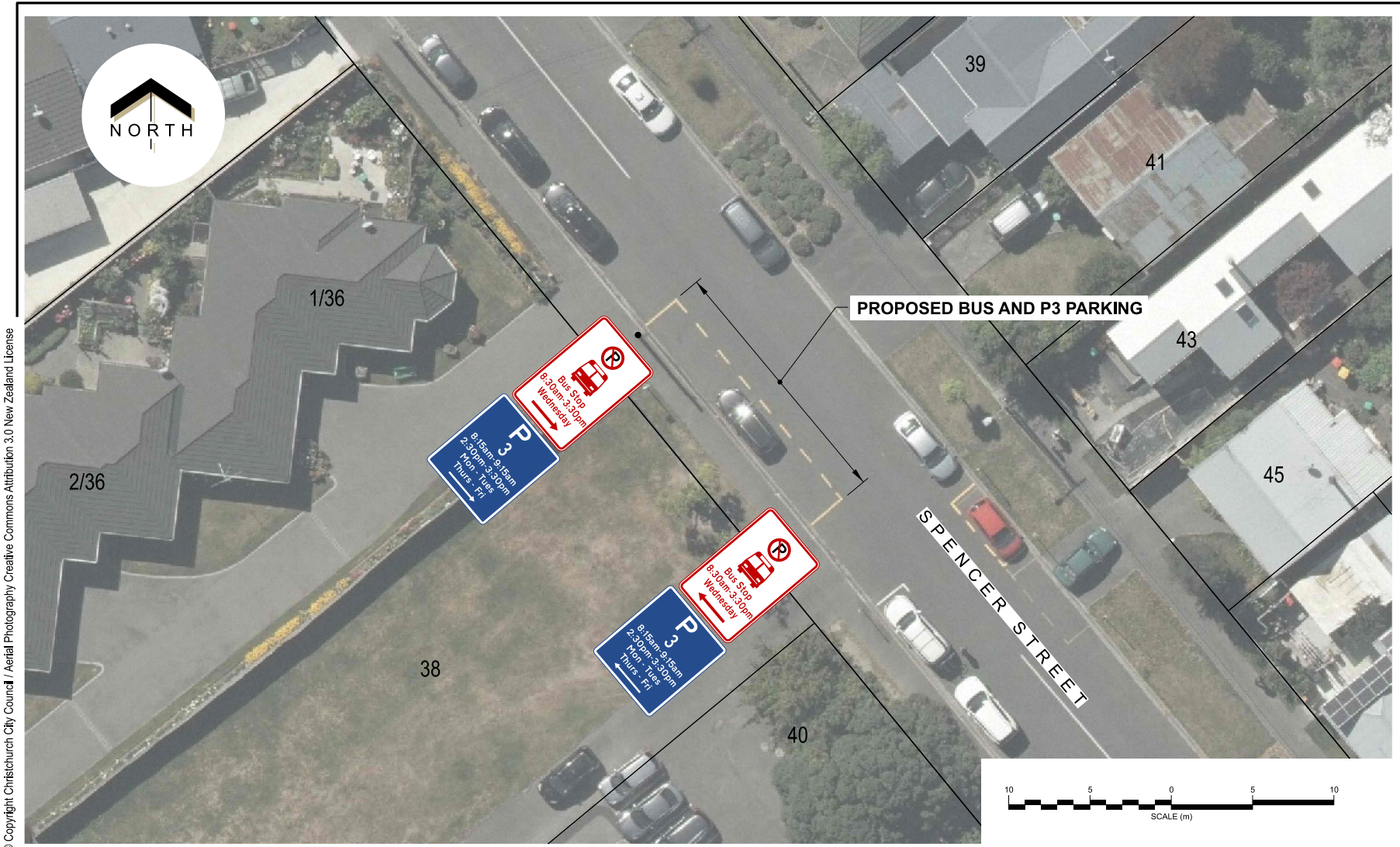

Spencer Street - Sacred Heart School
 Bus and P3 School Parking
 For Board Approval

Original Plan Size: A4
 Drawn: MJR Issue 1 16/03/2026
 Designed: AB Drawing: TG153017
 Approved: LB Project:

11. Waihoru Spreydon Cashmere Heathcote Discretionary Response Fund 2025/26, Cashmere Technical Football Club Incorporated, Heathcote Valley Community Association, Somerfield Residents Association, St Peter's Indoor Bowling Club

Reference Te Tohutoro: 26/976640

Responsible Officer(s) Te Nime Ah Kam-Sherlock, Community Recreation Advisor
Pou Matua: Heather Davies, Community Development Advisor

Accountable ELT Andrew Rutledge, General Manager Citizens and Community
Member Pouwhakarae:

1. Purpose and Origin of the Report Te Pūtake Pūrongo

- 1.1 The purpose of this report is for the Waihoru Spreydon-Cashmere-Heathcote Community Board to consider four applications for funding from its 2025/26 Discretionary Response Fund from the organisations listed below.

Project Name	Organisation	Amount Requested	Amount Recommended
Facility Hire	Cashmere Technical Football Club Incorporated	\$17,392	\$17,356.00
Heathcote Valley Community Magazine and Food Forest Project	Heathcote Valley Community Association	\$6,360.00	\$6,360.00
Printing the Quarterly Newsletter	Somerfield Residents Association	\$1,772.00	\$1,772.00
St Peter's Indoor Bowls Club Expenses	St Peter's Indoor Bowling Club	\$765.00	\$365.00

- 1.2 The report is staff generated.

2. Officer Recommendations Ngā Tūtohu

That the Waihoru Spreydon-Cashmere-Heathcote Community Board:

1. Receives the information in the Waihoru Spreydon Cashmere Heathcote Discretionary Response Fund 2025/26, Cashmere Technical Football Club Incorporated, Heathcote Valley Community Association, Somerfield Residents Association, St Peter's Indoor Bowling Club report.
2. Notes that the decisions in this report are assessed as low significance based on the Christchurch City Council's Significance and Engagement Policy.
3. Approves a grant of \$17,356.00 from its 2025/26 Discretionary Response Fund to Cashmere Technical Football Club Incorporated towards facilities and venue hire.

4. Approves a grant of \$6,360.00 from its 2025/26 Discretionary Response Fund to Heathcote Valley Community Association towards magazine printing, installation of taps and pea straw.
5. Approves a grant of \$1,772.00 from its 2025/26 Discretionary Response Fund to Somerfield Residents Association for Printing the Quarterly Newsletter.
6. Approves a grant of \$365.00 from its 2025/26 Discretionary Response Fund to St Peter's Indoor Bowling Club towards event related costs.

3. Executive Summary Te Whakarāpopoto Matua

- 3.1 The purpose of the Discretionary Response Fund is to assist community groups where the project and funding request falls outside other Council funding criteria and/or closing dates. This fund is also for emergency funding for unforeseen situations.
- 3.2 The applications have been assessed by staff, and a recommendation has been made taking into account the nature of the request, the benefit to the community and the alignment to Council strategies and Board priorities.
- 3.3 As part of the assessment process, staff allocate a priority rating to each project.
 - **Priority One** - These projects meet all eligibility criteria and contribute significantly to the Funding Outcomes and Priorities (Highly recommended for funding)
 - **Priority Two** - Meets all eligibility criteria and contributes of the Funding Outcomes and Priorities (Recommended for funding)
 - **Priority Three** - Meets all eligibility criteria and contributes to Funding Outcomes and Priorities but to a lesser extent than Priority 2 applications (Not recommended for funding)
 - **Priority Four** - Meets all eligibility criteria but has a minimal contribution to Funding Outcomes and Priorities; or Insufficient information provided by applicant (both in the application and following request for further information from assessor; or Other funding sources are more appropriate (Not recommended for funding)
- 3.4 Details of the project and the staff rationale for their recommendation is included in the attached Decision Matrix (refer to **Attachments A, B, C and D**).

4. Background/Context Te Horopaki

- 4.1 Each year Community Boards establish a Discretionary Response Fund. This fund opens for applications on 1 July and closes on 30 June, or earlier if all funds have been exhausted.
- 4.2 Applications recommended for funding will support community-focused projects that contribute to the strengthening of community wellbeing in the Christchurch City area.

Options Considered Ngā Kōwhiringa Whaiwhakaaro

- 4.3 The following reasonably practicable options were considered and are assessed in this report:
 - 4.3.1 Approve staff recommendations as per the attached decision matrixes.
 - 4.3.2 Allocate a different level of funding than the staff recommendations.

Options Descriptions Ngā Kōwhiringa

- 4.4 **Preferred Option:** Approve staff recommendations as per the attached decision matrixes.
 - 4.4.1 Option Advantages

- The applications have been reviewed by staff, and recommendations have been made after considering the nature of the request, the benefit to the community, and how well it aligns with Council strategies and Board priorities.
- 4.4.2 Option Disadvantages
- Staff have not identified any disadvantages with their recommendations.
- 4.5 **Alternative Option** - Allocate a different level of funding than the staff recommendations
- 4.5.1 Option Advantages
- The Community Board may grant more or less to the applicant based on their knowledge of the community.
- 4.5.2 Option Disadvantages
- Increasing the funding amounts (from the staff recommendation) will have an impact on funding available for future applications. Once the fund is exhausted, no further applications can be considered until the next year's Discretionary Response Fund is established.
 - Decreasing the funding amounts (from the staff recommendation) may cause consequence or missed opportunity for the applicants detailed in this report.

Analysis Criteria Ngā Paearu Wetekina

- 4.6 Applications must be from eligible not-for-profit groups whose activities provide opportunities in the areas of community, social, recreation, sports, arts, environment or heritage to the wider community or to specifically defined communities of interest.
- 4.7 Applications will support community-focused projects that contribute to the strengthening of community wellbeing in the Community Board area.
- 4.8 The Discretionary Response Fund does not cover applications relating to:
- Activities or initiatives where the primary purpose is to promote religious ministry, political objectives or commercial interests.
 - Projects or initiatives that will lead to ongoing operational costs to the Council.
 - Debt servicing or re-financing costs.
 - Stock or capital market investment.
 - Gambling or prize money.
 - Payment of fines, court costs, or mediation costs.
 - Payment for IRD penalties or retrospective tax payments.
 - Funding of individuals (some exceptions allowed where sub-streams of this fund identify this in their criteria e.g. Youth Development Fund)

5. Financial Implications Ngā Hiraunga Rauemi

- 5.1 The total funding pool for the Waihoru 2025/26 Discretionary Response Fund was \$120,339.00
- 5.2 To date, 23 applications have been approved totalling \$94,486.00
- 5.3 There is currently a balance of \$25,853.00 remaining in the fund.
- 5.4 If staff recommendations are accepted, there will be a balance of **\$0.00** to cover all new applications until 30 June 2026.

6. Considerations Ngā Whai Whakaaro

Risks and Mitigations Ngā Mōrearea me ngā Whakamātautau

- 6.1 Staff consider any potential risks as part of the assessment process. Where a risk is identified, this will be included in the staff comments on the Decision Matrix and suggested mitigation actions included.

Legal Considerations Ngā Hiraunga ā-Ture

- 6.2 Statutory and/or delegated authority to undertake proposals in the report:
- 6.2.1 Community Boards have delegated authority to allocate the Discretionary Response Fund for their Board area.
- 6.3 Other Legal Implications:
- 6.3.1 There is no legal context, issue, or implication relevant to this decision.

Strategy and Policy Considerations Te Whai Kaupapa here

- 6.4 The required decisions
- 6.4.1 Align with the [Christchurch City Council's Strategic Framework](#). In particular, the strategic priority of 'being an inclusive and equitable city', and 'managing ratepayers' money wisely'. The recommendations are consistent with the Strengthening Communities Together Strategy.
- 6.4.2 Are assessed as low significance based on the Christchurch City Council's Significance and Engagement Policy. The level of significance was determined by the number of people affected and/or with an interest.
- 6.4.3 Are consistent with Council's Plans and Policies. Including the 2026-28 Community Board Plan.
- 6.5 This report supports the [Council's Long Term Plan \(2024 - 2034\)](#):

Community Impacts and Views Ngā Mariu ā-Hāpori

- 6.6 Due to the assessment of low significance, no further community engagement and consultation is required.

Impact on Mana Whenua Ngā Whai Take Mana Whenua

- 6.7 The decisions do not involve a significant decision in relation to ancestral land, a body of water or other elements of intrinsic value, therefore the decisions do not specifically impact Mana Whenua, their culture, and traditions.
- 6.8 The decisions do not involve a matter of interest to Mana Whenua and will not impact on our agreed partnership priorities with Ngā Papatipu Rūnanga.

Climate Change Impact Considerations Ngā Whai Whakaaro mā te Āhuarangi









- 6.9 The proposals in this report are unlikely to contribute significantly to adaptation to the impacts of climate change or emissions reductions.

7. Next Steps Ngā Mahinga ā-muri

- 7.1 Following the Board's decision, groups will be notified of the outcome. Where an application has been approved, a Funding Agreement will be signed by the group and payment made

thereafter. Successful applicants are required to provide an accountability report on completion of the project.

Attachments Ngā Tāpirihanga

No.	Title	Reference	Page
A  	Decision Matrix - Cashmere Technical Football Club Inc	26/1086670	50
B  	Decision Matrix - Heathcote Valley Community Association	26/1009822	51
C  	Decision Matrix - Somerfield Residents Association	26/1087523	52
D  	Decision Matrix - St Peters Indoor Bowling Club	26/1016144	53

Signatories Ngā Kaiwaitohu

Authors	Nime Ah Kam-Sherlock - Community Recreation Advisor Heather Davies - Community Development Advisor
Approved By	Josh Wharton - Manager Community Governance, Spreydon-Cashmere-Heathcote

WAIHORU SPREYDON-CASHMERE-HEATHCOTE DISCRETIONARY RESPONSE FUND 2025/26 DECISION MATRIX

Organisation Name	Project	Request Budget	Staff Recommendation	Priority
<p>Cashmere Technical Football Club Incorporated</p> <p>Application Number: DRF25/26_00042_SCH</p> <p>Physical address 43 Hargood St, Woolston</p> <p>Funding History (past three years) Nil</p>	<p>Facility Hire</p> <p>Facility hire support at Garrick Memorial Park to improve community sport accessibility.</p>	<p>Total Cost of Project: \$69,570</p> <p>Total Amount Requested: \$17,392</p> <p>Percentage of project requested: 25%</p> <p>Contribution sought towards: Rent/Venue Hire - \$17,392</p> <p>Other sources of funding: \$26,088.56 - Funds on hand \$26,088.56 - User/Registration Fees</p>	<p>\$17,356</p> <p>That the Waihoru Spreydon-Cashmere-Heathcote Community Board approves a grant of \$17,392 from its 2025/26 Discretionary Response Fund to Cashmere Technical Football Club Incorporated towards facilities and venue hire.</p>	<p>2</p>

CCC Strategy Alignment

Strengthening Communities Together Strategy, Physical Recreation & Sport Strategy

Outcomes that will be achieved through this project

- Providing functional operating space for ~1,800 club players and the opposing teams that travel from across Ōtautahi to compete
- Ongoing financial sustainability
- Security of the invaluable green space at Garrick Park

Staff Assessment

Cashmere Technical Football Club (CTFC) is recognised as the South Island’s largest sports club, currently supporting approximately 1,800 members across its football programme.

Since its formation in 2012 following the merger of Cashmere Wanderers and Woolston Technical, the club has maintained a long-standing operational base at Garrick Memorial Park, alongside its second primary playing venue at Centennial Park.

CTFC continues to experience significant pressure in relation to the availability of suitable green space to meet demand across its growing player base. Both Garrick Park and Centennial Park are essential to the delivery of football activities and the continued delivery of participation opportunities across all levels of the game.

Due to the public nature of the *potential* sale of the Woolston Club’s Garrick Park, Class 4 gaming funding that had previously supported facility costs over the past 10 years has now been declined. This has resulted in a funding gap in relation to ongoing sports field rental costs.

CTFC is therefore seeking a contribution toward the rent of the grounds and facility at Garrick Park, specifically a three-month contribution within a 12-month period that will support their winter activity until a decision on the potential sale of the Park is solidified. The request reflects the club’s continued reliance on the venue as a key community sporting asset and the need to maintain sustainable access arrangements in support of its large and growing membership base.

Rationale for staff recommendation

- This application has come to the Waihoru Community Board as a majority of the members of Cashmere Technical Football Club come from within the Spreydon-Cashmere-Heathcote Community Board area, and they will be the primary beneficiaries of any potential grant received, relating to this application.
- Enables CTFC to deliver football training sessions and matches for approximately 1,800 members and the opposing teams that travel from across Ōtautahi to compete.
- Supports Council priorities around active recreation, inclusion, and participation in sport.
- Supports ongoing access to essential playing space at Garrick Memorial Park for a high-demand community sports club

WAIHORU SPREYDON-CASHMERE-HEATHCOTE DISCRETIONARY RESPONSE FUND 2025/26 DECISION MATRIX

Organisation Name	Project	Request Budget	Staff Recommendation	Priority
<p>Heathcote Valley Community Association</p> <p>Application Number: DRF25/26_00044_SCH</p> <p>Physical address 45 Bridle Path Rd, Heathcote Valley</p> <p>Funding History (past three years) 25/26 SCH - \$18,000 - Community Wellbeing & Resilience – Strengthening Communities Fund 24/25 SCH - \$18,000 - Community Wellbeing & Resilience - Strengthening Communities Fund 24/25 DRF - \$4,000 - Community Magazine 25/26 - \$100,000 - Ferrymead Park Community Pumptrack</p>	<p>Heathcote Valley Community Magazine & Food Forest Project</p> <p>Printing the quarterly Heathcote Valley Community Association (HVCA) magazine.</p> <p>Installation of four taps at Heathcote Valley Food Forest in Birdsey Reserve and pea straw for mulching and plant protection.</p>	<p>Total Cost of Project: \$6,560</p> <p>Total Amount Requested: \$6,360</p> <p>Percentage of project requested: 97%</p> <p>Contribution sought towards: Printing of the Heathcote Valley Community Magazine - \$4,000 Pea Straw for the Heathcote Valley Food Forest - \$298 Tap Installation for the Heathcote Valley Food Forest - \$2,062</p> <p>Other sources of funding: Sponsorship and advertising - \$150.00</p>	<p>\$6,360</p> <p>That the Waihoru Spreydon-Cashmere-Heathcote Community Board approves a grant of \$6,360 from its 2025/26 Discretionary Response Fund to Heathcote Valley Community Association towards magazine printing, installation of taps and pea straw.</p>	<p>2</p>

CCC Strategy Alignment

Strengthening Communities Together Strategy, Physical Recreation & Sport Strategy, Multicultural Strategy

Outcomes that will be achieved through this project

1. The Heathcote Valley Community is a connected and engaged community. Our magazine provides important information about upcoming community events and opportunities. These include activities at the Heathcote Valley Community Centre, our local church, school, environmental initiatives and learning opportunities.
2. Key information around disaster preparedness. Our magazine will be used to support our disaster preparedness project and help support our residents to become more resilient and prepared in the case of unexpected events.
3. The food forest connects people with a shared interest in growing food and reducing food scarcity. It also provides the community with a beautiful natural meeting space and healthy food.

Staff Assessment

HVCA produce a substantial and informative community magazine, that is an important form of communication for them. It is produced quarterly and contains a considerable amount of information of relevance, interest and importance to people living in the valley.

It is key point of reference for community events, the community association, community groups, the church, the community garden, the food forest, community planting projects, school and marae. It helps increase cultural capacity, is a form of connection to elected council representatives, has community emergency preparedness information and wellbeing contacts. Other forms of communication include e-mail, social media and community notice boards.

The digital distribution of the magazine does not reach everyone in the community. There is a large population of older adults that are not active in the digital world and do not use a computer or e-mail. The distribution of printed copies ensures all residents have access to the magazine. Sponsorship and advertising help to pay for printing but it is not enough to cover the cost.

The Heathcote Valley Food Forest is located in Birdsey Reserve. It is a community initiative to establish a forest of plantings that produce a variety of fruits, berries, herbs, etc. The plantings are permanent and sustainable and do not need to be replanted each season. It is a place for everyone to enjoy and provides a point of community connection. This project supports HVCA overall commitment to caring for their environment and helps combat food scarcity as the produce is shared within the community. The group have permission from parks to install four taps at the site of the food forest.

Rationale for staff recommendation

- The magazine is a key form of communication, printed copies ensure it is accessible to all residents.
- The magazine will be used to communicate information about the community emergency preparedness plan the group are beginning to work on.
- The food forest is a well-supported community and fits with Councils Food Resilience Policy.

WAIHORU SPREYDON-CASHMERE-HEATHCOTE DISCRETIONARY RESPONSE FUND 2025/26 DECISION MATRIX

Organisation Name	Project	Request Budget	Staff Recommendation	Priority
<p>Somerfield Residents Association</p> <p>Application Number: DRF25/26_00049_SCH</p> <p>Physical address 95 Studholme St, Somerfield</p> <p>Funding History (past three years) 2025/26 - \$1,400 - Somerfield Residents Association Community Newsletter Printing - SCF S-C-H 2024/25 - \$1,000 - Somerfield Residents Association Community Newsletter Printing - SCF S-C-H</p>	<p>Somerfield Community Newsletters Printing of quarterly newsletter</p>	<p>Total Cost of Project: \$1,772</p> <p>Total Amount Requested: \$1,772</p> <p>Percentage of project requested: 100%</p> <p>Contribution sought towards: Newsletter Printing - \$1,772</p> <p>Other sources of funding: Nil</p>	<p>\$1,772</p> <p>That the Waihoru Spreydon-Cashmere-Heathcote Community Board approves a grant of \$1,772 from its 2025/26 Discretionary Response Fund to Somerfield Residents Association towards printing the newsletter.</p>	<p>2</p>

CCC Strategy Alignment

Strengthening Communities Together Strategy

Outcomes that will be achieved through this project

Over 8,000 residents who live in Somerfield will receive a newsletter four times per year. Enhanced community contact and information about what is going on in the wider neighbourhood,
Sharing information about events, news and activities and encouraging participation in them.
Helpful emergency response information from SCERT.
Updates on safety and roading upgrades as applicable.

Staff Assessment

Somerfield Residents Association values good communication, when it comes to addressing concerns that affect them. To ensure this happens they produce, print, and deliver a newsletter four times a year to 3,000 homes in the Somerfield area. The association also covers Lower Cashmere following the winding up of Lower Cashmere Residents Association last year.

The newsletter has information about what the residents' association are doing and what is happening in the community. It contains details about activities and events, happening in the Somerfield community and neighbouring areas. Somerfield Community Emergency Response Team (SCERT) also use the newsletter to share information and advice about emergency community preparedness. This group have processes and procedures in place to be able to set up community emergency response hub up when needed. Feedback from residents supports the value of a printed newsletter and people are also invited to make their contributions about community.

This request is for funding to print the newsletter. The printing cost per newsletter is \$443, this covers 3,000 double sided, folded, black and white copies. Four newsletters are printed over the year total request is \$1,772.00.

Rationale for staff recommendation

- The printed newsletter keeps residents informed about community preparedness, local activities and the association's work, fostering a more informed and engaged citizen.
- The newsletter provides a platform for resident contributions, promoting a sense of community ownership and encouraging resident participation in local affairs.
- This grant would cover the group's newsletter printing for the full 2026-27 Financial year. As such, they will not be making a 2026/27 SCF application. Support for future printing costs for this group (*and others similar*) can be addressed via internal budgets.

WAIHORU SPREYDON-CASHMERE-HEATHCOTE DISCRETIONARY RESPONSE FUND 2025/26 DECISION MATRIX

Organisation Name	Project	Request Budget	Staff Recommendation	Priority
<p>St Peter's Indoor Bowling Club</p> <p>Application Number: DRF25/26_00043_SCH</p> <p>Physical address Fisher Ave, Beckenham</p> <p>Funding History (past three years) FY24/25 DRF SCH - \$665 - To assist bowling club pay the rental for hire the parish centre facilities to play indoor bowls. -</p>	<p>St Peter's Indoor Bowls Club Expenses St Peter's Indoor Bowls Club - Tournament Expenses, Name Badges, Championship Badges & Bars</p>	<p>Total Cost of Project: \$765</p> <p>Total Amount Requested: \$765</p> <p>Percentage of project requested: 100%</p> <p>Contribution sought towards: Prizes - Grocery Vouchers - \$400 Catering - \$70 New Name Tags - \$60 Championship Badges/Bars - \$235</p> <p>Other sources of funding: Nil</p>	<p>\$365</p> <p>That the Waihoru Spreydon-Cashmere-Heathcote Community Board approves a grant of \$365 from its 2025/26 Discretionary Response Fund to St Peter's Indoor Bowling Club towards event related costs, excluding prizes - grocery vouchers.</p>	<p>2</p>

CCC Strategy Alignment

Strengthening Communities Together Strategy, Physical Recreation & Sport Strategy

Outcomes that will be achieved through this project

- Outdoor bowlers will be able to play indoor bowls in a warm facility during winter months.
- Bringing club members and other bowlers from throughout Canterbury together.
- Host a tournament for bowlers from throughout canterbury.

Staff Assessment

St Peter's Bowling Club plan to deliver a community indoor bowls programme and host a tournament during the period from 03/03/2026 - 29/09/2026.

These sessions bring together approximately 60 participants from across Canterbury during the winter months in a warm, indoor environment, and are designed to provide a regular, structured space for members to participate in and enjoy the game of indoor bowls.

To support the delivery of the programme, funding will contribute towards essential event-related costs, including identification name tags for 16 club members, updating the club honours board to reflect championship results from the past ten years, providing catering for participants, and supplying grocery hamper prizes for the top four teams.

The club currently has a membership of 16 individuals, each contributing an annual subscription fee of \$65.00. These membership fees cover affiliation fees with Canterbury Bowls, enabling members to participate in Canterbury Championship events.

Rationale for staff recommendation

- The application aligns with Council's Physical Recreation and Sport Strategy.
- It supports regular weekly participation, helping to reduce social isolation and strengthen connections among club members through a consistent community activity.
- The project helps preserve and celebrate the club's history.

12. Waihoru Spreydon-Cashmere-Heathcote Community Board Area Report - June 2026

Reference Te Tohutoro: 26/881972

Responsible Officer(s) Te Pou Matua: Josh Wharton, Community Governance Manager

Accountable ELT Member Pouwhakarae: Andrew Rutledge, General Manager Citizens and Community

1. Purpose of Origin of the Report Te Pūtake Pūrongo

- 1.1 This report provides the Board with an overview of initiatives and issues current within the Community Board area.

2. Officer Recommendations Ngā Tūtohu



That the Waihoru Spreydon-Cashmere-Heathcote Community Board:

1. Receives the information in the Waihoru Spreydon-Cashmere-Heathcote Community Board Area Report - June 2026.

3. Community Support, Governance and Partnership Activity

3.1 Community Governance Projects

Activity	Detail	Timeline	Strategic Alignment
ANZAC Day Memorial Services	<p>The Governance team supported elected members' attendance at several ANZAC Day memorial services across the Board's area at:</p> <ul style="list-style-type: none"> • War Memorial, Heathcote Valley • 19th Battalion and Armoured Regiment Memorial, Victoria Park • Sumner, RSA Memorial Gates • Waltham Gates • Sydenham Cemetery <p>A note of sincere thanks was emailed to the Board from the Guardians of the 19th Battalion & Armoured Regiment Memorial, for their continued support in the local community alongside local schools, Scouts and other groups. It was mentioned their contributions enhance the Anzac Day ceremonies at the Memorial site (Victoria Park).</p> 	25 April 2026	Strengthening Communities Together Strategy <i>Objective 2.1: Encourage communities to create and sustain a sense of local identity and ownership.</i>

<p>Proposed National Erebus Memorial</p>	<p>On 21 May 2026 the Board approved to grant an easement at Cracroft Reserve in Cashmere to Manatū Taonga Ministry for Culture and Heritage for the location of the National Erebus Memorial.</p>  <p>View facing south towards the entrance of the National Erebus Memorial design in Cracroft Reserve, Christchurch. Design by Studio Pacific Architecture, April 2026.</p> <p>View from above of the National Erebus Memorial design in Cracroft Reserve, Christchurch. Design by Studio Pacific Architecture, April 2026.</p>	<p>21 May 2026</p>	<p>Strengthening Communities Together Strategy <i>Objective 2.3: Support the community activation and kaitiakitanga of public places and spaces.</i> <i>Objective 3.3: Provide well-informed support and advice to staff and elected members for effective decision making and community engagement.</i></p>
<p>Ōmōkihi rebuild update</p>	<p>Ōmōkihi South Library remains on track to reopen by the end of the year, with major construction milestones complete.</p>  <p>A café has now also been selected to operate from the site, from within a competitive pool of applicants.</p>	<p>May 2026</p>	<p>2026-28 Draft Waihoru Community Board Plan <i>Priority 5: Activation of Ōmōkihi and Surrounds</i></p>
<p>Strengthening Communities Fund - Waihoru</p>	<p>Throughout the Month of May applications were invited for the annual Strengthening Communities Funding Round. https://ccc.govt.nz/culture-and-community/community-funding/scfund</p>	<p>May 2026</p>	<p>Strengthening Communities Together Strategy <i>Objective 3.4: Increase volunteering</i></p>

	<p>This application window is now closed, and our Advisors will assess applications and peer review before bringing recommendations to the Board.</p> 		<p><i>opportunities across the Council and the wider community and support the organisations providing such opportunities.</i></p>
<p>Coastal Adaptation Planning</p>	<p>Staff have met with the Council’s Climate Hazards Adaptation Planning team, who will then come to the Boards information session in May to detail the process that the Adaptation planning will take place over the coming few years from Taylor’s Mistake to the Lower Heathcote areas.</p> <p>Staff will continue to work closely with the involved communities and elected members, with an intention to slowly introduce conversations about this important piece of work, over the coming weeks and months.</p>	<p>28 May 2026</p>	<p>Strengthening Communities Together Strategy <i>Objective 2.3: Support the community activation and kaitiakitanga of public places and spaces.</i></p>
<p>Garden Awards Update</p>	<p>The Edible & Sustainable and Community Pride Garden Awards 2026 will be held on 16 June 2026 at The Old Stone House, Cracroft with proceedings beginning at 5.30pm. Invitations to award recipients have been distributed and staff are working in preparation of the awards event. For those unable to attend the event will have their certificates posted.</p> 	<p>16 June 2026</p>	<p>Strengthening Communities Together Strategy <i>Objective 2.1: Encourage communities to create and sustain a sense of local identity and ownership.</i></p>
<p>Hoon Hay Fiesta 2026</p>	<p>The date has been confirmed for the 2026 Hoon Hay Fiesta, which will be held on Thursday 12 November at Hoon Hay Park.</p>	<p>12 Nov 2026</p>	<p>Strengthening Communities Together Strategy <i>Objective 2.1: Encourage communities to create and sustain a sense of local identity and ownership.</i> <i>Objective 2.3: Support the community activation and</i></p>

	<p>Stallholder and food vendor registrations will open shortly. Waihoru staff are continuing to work alongside the planning and delivery committee in support of the event, with the first planning hui to take place on Thursday 21 May at Rowley Community Centre.</p> 		<p><i>kaitiakitanga of public places and spaces.</i></p>
<p>Hoon Hay Network Meeting</p>	<p>The Hoon Hay Network Meeting brings together local community organisations, support agencies, and neighbourhood groups to strengthen connections across the Hoon Hay and Spreydon communities.</p> <p>Waihoru staff attended the hui on 27 April 2026, providing an update on Strengthening Communities Fund and sharing the positive progress and excitement around Ōmōkihi being on track to open at the end of 2026.</p>	<p>Ongoing</p>	<p>Strengthening Communities Together Strategy <i>Objective 2.1: Encourage communities to create and sustain a sense of local identity and ownership.</i></p>
<p>Walk ‘n’ Talk Programmes</p>	<p>The Beckenham Walk ‘n’ Talk programme for the month of May included the following locations and dates:</p> <ul style="list-style-type: none"> • Thursday 7 May – Local walk, meeting at the corner of Birdwood Avenue and Malcolm Avenue • Thursday 14 May – Walk n Talk: Around the Horseshoe Lake • Thursday 21 May – Local walk, meeting at the corner of Birdwood Avenue and Malcolm Avenue • Thursday 28 May – Parakiore Recreation and Sport Centre 	<p>Ongoing</p>	<p>Strengthening Communities Together Strategy <i>Objective 1.4: Harness the strengths of diverse communities and address issues of social exclusion.</i></p>

	<p>Staff are currently working on the Walk ‘n’ Talk programme for the second half of 2026.</p> 		
--	---	--	--

3.2 Community Funding Summary

3.2.1 Strengthening Communities Fund 2026/27

Applications were received during the month of May. Staff assessments will be undertaken in June and presented to the Community Board in the decision meeting on 13 August 2026.

3.2.2 Community Board Discretionary Response Fund 2025/26

As of 15 May 2026, available balance of the Discretionary Response Fund at the time of writing this report is **\$25,853.00**

The 2025/26 Discretionary Response Fund Spreadsheet as of 15 May 2026 is attached for record purposes – see **Attachment A**.

3.2.3 Youth Development Fund Applications

The following Youth Development Fund applications were approved by the Board since the last Area Report:

Name	Event	Amount
Joshua Seaman	Premier Invitational Football Tournament, Gold Coast, Australia, 29 September – 1 October 2026	\$500
Kye Saotome-Ripley	U19 Volleyball Inter-provincial Championships, Wellington, 20 May – 1 June 2026	\$300
Cody Hawke	U19 Junior World Mountain Bike Cross Country Championships, Val di Sole – Trentino, Italy, 24 August – 30 August 2026	\$500
AVAILABLE BALANCE (at time of writing):		\$5,050.00

The Youth Development Fund Matrixes are attached below for record purposes – see **Attachment B**

3.2.4 Off the Ground Fund Applications

There has been no Off the Ground Fund applications approved since the last Area Report.

Available balance of the Off the Ground Fund at the time of writing this report is **\$2,700.00**

3.2.5 **Summer with your Neighbours - Reimbursement**

The total amount allocated to the Summer with your Neighbours Fund is **\$3,790.00**.

Applicants had until the 10 April 2026 to hold their gathering and submit a Small Subsidy and Evaluation Form for reimbursement.

As of **15 May 2026**, at the time of writing this report, the current balance which was claimed for reimbursement is **\$2,185.87**.

The amount of funds unclaimed sits at **\$1,604.13**. We have a couple of applicants who were unable to hold their event within this timeframe and have been given an extension until the end of May to hold their event to make sure that any final reimbursement can happen before the end of financial year (\$195.00).

3.3 **Community Events and Activities**

3.3.1 **Open Christchurch** – is an annual, one-weekend-only architecture festival that opens the doors of the city's most exceptional buildings to the public. The 2026 festival took place from 1–3 May 2026, showcasing 52 open buildings, guided walks, and special activities. Several of the events took place in across the Waihoru area showcasing the architecture in the area, including:



Redcliffs Village Library

Architects: Young Architects, 2017
The simple gable form suggests an open book; its friendly scale makes for a welcoming volunteer library that celebrates its surroundings. The red palette echoes the cliffs of the area while the translucent polycarbonate street-facing wall allows the library to glow like a lantern – or beacon of knowledge and community – at night. Learn more from knowledgeable volunteers. 2018 Canterbury Small Project Architecture Award Winner



St Martins Community Centre and Library

Architects: Plus Architecture, 2016
Humble, comfortable and ready for everyday use, this post-quake build nestles into its residential context. With a library and a range of versatile spaces, it serves as a key hub in the community. The brick façade, reclaimed from local houses damaged in the quakes, speaks not only to reuse and the community's investment in the space but also to the original library's origins – it was founded by a bricklayer. 2017 Canterbury Public Architecture Award Winner



3.3.2 **Participation Culture Workshops** – two
Participation Cultural Workshops were held at the Hoon Hay Community Centre on 6 and 20 May 2026 by Neighbours Aotearoa. The workshops were an opportunity to hear about Participation Culture and learn about applying the principles in the local Community.



3.4 **Participation in and Contribution to Decision Making**

3.4.1 **Report back on other Activities contributing to the Community Board Plan**

- **Christchurch Regeneration Acceleration Facility (CRAF)** – on 28 April 2026, Council staff advised and shared photos of several CRAF projects in the Spreydon, Somerfield, Waltham, Beckenham area. CRAF is a funding package of \$40million from Treasury for transport projects in Christchurch. The targeted roading and transport improvements were identified through a review of the streets in the area by transport engineers and by asking the local community what improvements they wanted to see in their area.



Above: Lyttelton Street school bus bay



Above: West Spreydon School raised crossing



Above: West Spreydon School raised crossing



Above: Somerfield Street pedestrian safety



Above: Selwyn Street pedestrian safety project



Above: Selwyn Street pedestrian safety project



Above: Somerset Street and Selwyn Street intersection



Above: Selwyn Street pedestrian safety project

- **Port Hills Newsletter** – on 19 May 2026, Council’s Regional Parks team shared the latest version of their Port Hills newsletter, which shares information to the community about volunteer activities on the Port Hills – see **Attachment C**.



3.4.2 Council Engagement and Consultations

- [Torrens Reserve play space renewal](#) was open for consultation from 28 April to 17 May 2026. This is a mostly 'like-for-like' renewal meaning the new equipment will be replaced with the same or similar available equipment. Feedback was gathered from Spreydon School to determine the type of play equipment for the reserve. Council used this to help develop the draft concept plan. The matter is scheduled to come to the Board for a decision in July 2026.
- Early feedback on Council’s [Gambling and TAB Venues Policy review](#) opened on 13 May and will close on 14 June 2026. This early engagement is to update the Council on the current views on the policy as it’s been a while since Council last checked in with the community.

3.5 Governance Advice

3.5.1 **Public Participation** - the Board received the following **public forum** presentations at its 14 May 2026 meeting:

- Leeza Green, Christchurch Community Weaver spoke on behalf of the Neighbours Aotearoa Programme to provide an update on the programme with a focus on the Waltham project.
- Sam Hampton spoke on behalf of the Port Hills Park Trust and presented an update regarding the Trust’s activities.
- Per Tonisca, Club Captain and Huntly Quinn, Club President spoke on behalf of the Sumner Surf Life Saving Club regarding an update about the club’s activities.
- Adrian Ramsay, local resident spoke regarding the shading impact of a large Oak tree in Remuera Reserve.

The Board received the following **deputations** at its 14 May 2026 meeting:

- Marie Fenton, local resident spoke regarding Item 9 - Opawa Road - Proposed Parking Restrictions report on the agenda.
- Tracie Palmer, Public Service Association Organiser spoke along with David Taylor and Jono Bannan, workers at Emerge Aotearoa regarding Item 9 - Opawa Road - Proposed Parking Restrictions report on the agenda.

The Board received the following **deputations** at its 21 May 2026 meeting:

- Paula Jameson, local resident spoke regarding Item 4 - Grant of Easement Cracroft Reserve.
- Richard Waugh, local resident spoke regarding Item 4 - Grant of Easement Cracroft Reserve.
- Quentin McDonald spoke on behalf of Friends of Cracroft Reserve regarding Item 4 - Grant of Easement Cracroft Reserve.
- Jeff Gibson, Pou Taki, Kaupapa Whakataki, Director Portfolio Delivery spoke on behalf of Manatū Taonga Ministry for Culture & Heritage regarding Item 4 - Grant of Easement Cracroft Reserve.

The Board received the following **correspondence** at its 14 May 2026 meeting:

- Joseph Tyro, Chair, Te Hapū o Ngāti Wheke Inc regarding the proposal of the Redcliffs Te Rae Kura Residents' Association in relation to Te Ana o Hineraki and Moncks Cave.
- Federico Tomasetto, local resident in relation to a formal crossing investigation in Huntsbury (Major Aitken Drive to Parklands Drive)

3.5.2 **Customer Service Request (CSR) Report the Spreydon-Cashmere-Heathcote Wards**

– a report on open and completed tickets (requests for service) in April 2026 can be found at **Attachment D** to this report. The report provides an overview of the number of CSRs that have been received, including the types of requests being received and a breakdown of how they are being reported.

[Snap Send Solve](#) is the smartphone app the Council offers to help make reporting issues easy, and it is still possible to [report issues online](#), by calling Council on 03 941 8999 or visiting one of the Council's [Service centres](#).

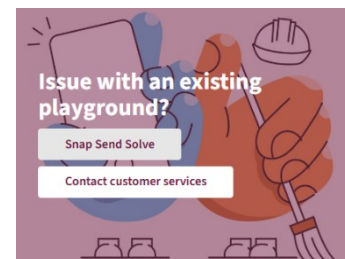

4. Advice Provided to the Community Board Ngā Kupu Tohutohu ka hoatu ki te Poari Hapori

4.1 **Start Work Notices (SWN)** - SWN relating to the Board area is separately circulated to the Board. SWN are for works being carried out by the Council and can be found at [this link](#). The [traffic updates page](#) is a more comprehensive map of planned road works and closures as other agencies also carry out work on the roads. Recent SWN relating to the Board area are:

- Simeon Street reseal (*circulated 23 April 2026*)
- Whitewash Head Road - retaining walls renewal (*circulated 24 April 2026*)
- Kaiwara Street and Blakiston Street - water service upgrades (*circulated 28 April 2026*)
- Taylors Mistake Road - new retaining wall (*circulated 28 April 2026*)

- Hoon Hay Road – pedestrian improvements (*circulated 7 May 2026*)
 - St Martins Road - pedestrian improvements (*circulated 12 May 2026*)
 - Colombo Street / Strickland Street / Somerfield Street – safety improvements - Night works - (*circulated 15 May 2026*)
- 4.2 **Graffiti Snapshot Report** – The monthly report for April 2026 can be found as **Attachment E** to this report. The Council also provides information on graffiti, including tips to prevent it, and about becoming a Graffiti Programme volunteer, at [this link](#).
- 4.3 **Community Facilities Update** – The monthly summary update for April 2026 can be found as **Attachment F** to this report. The summary provides a monthly update of Council community facilities in Board areas with a focus on maintenance, renewals, investigations, and operational matters.
- 4.4 **Memoranda** - memoranda related to matters of relevance to the Board have been separately circulated for the Board’s information and are listed below.
- Memo - Response to Correspondence - Collins Street Cycleway (*circulated 5 May 2026*) – see **Attachment G**
 - Memo - Waltham Park Play Space Renewal and Multi-Sport Court Installation (*circulated 18 May 2026*) – see **Attachment H**
 - Memo - Lincoln Road transport and three waters upgrade - contractor appointed (*circulated 19 May 2026*) – refer <https://www.newsline.ccc.govt.nz/news/story/contractor-appointed-for-lincoln-road-upgrade>
- 4.5 **Staff advice to the Board** – the following staff advice has been received by the Board since the last Area Report:
- On 17 April 2026 the Board was advised of the removal of two trees in Ferrymead Park as part of the Ferrymead Regional Park Development Plan. Staff held off as long as possible but need to have these two additional trees removed at this stage to make room for further restoration planting and enhancement of a seating area along the path.



- On 1 May 2026 the Board was advised of the Council decision on the next area for coastal hazards adaptation planning: [Next area for adaptation planning confirmed : Newsline](#). The Council will begin the next adaptation planning process in the Lower Ōpāwaho Heathcote to Taylors Mistake area, following a decision by councillors at the Policy and Planning Committee meeting.

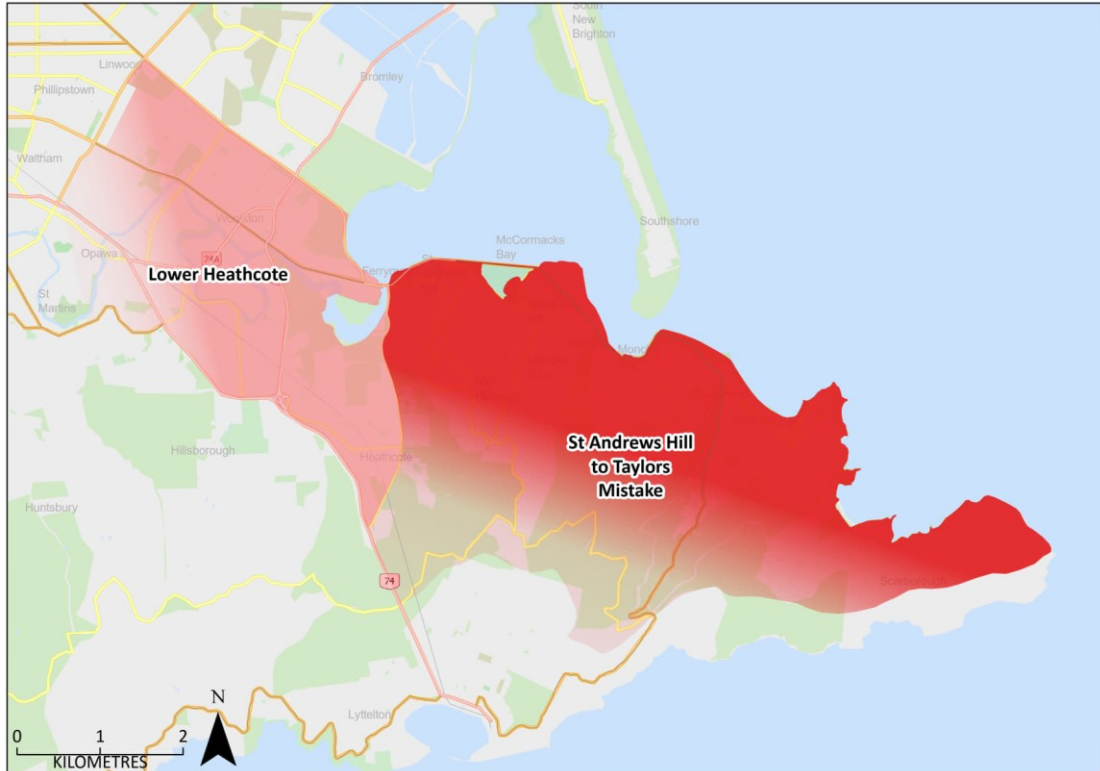





- On 5 May 2026 the Board received advice in response to correspondence the Board received on 11 September 2025 from Sean Eustace via Melanie Coker in relation to cycleway safety on Collins Street in Addington. Staff's conclusion is that there are no current plans to make any changes to the Collins Street intersection priorities. The layouts were thoroughly considered during the detailed design stage for this route. However, this may be revisited as the planned linked route to the south is progressed in future. The advice is set out in a memo to the Board – see **Attachment G**.
- On 6 May 2026 staff updated the Board on the completion of the Whaka Tce Retaining Wall Project. Staff informed the Board that the contractor (Higgins) received some nice messages from local residents at completion of the works.





- On 7 May 2026 the Board received advice in response to a public forum on 11 December 2025 from Frances Rankin about accessibility issues at Kaiwara Reserve. Staff advised that funding had been allocated this financial year (2025-26) for the path in Kaiwara Reserve and that staff are working to ensure correct alignment to connect to the street network.

Attachments Ngā Tāpirihanga

No.	Title	Reference	Page
A  	Discretionary Response Fund Allocation Matrix 11 June Meeting 2026	26/1016033	71
B  	Youth Development Fund Matrices - Joshua Seaman, Kye Saotome-Ripley and Cody Hawke	26/1045087	73
C  	Port Hills Newsletter - Winter 2026	26/1057986	76
D  	Hybris Ticket Report - Waihoru - April 2026	26/1057193	81
E  	Graffiti Snapshot - April 2026	26/1056724	82
F  	Community Facilities Summary Report April 2026	26/813385	84
G  	Memo Response to Correspondence - Collins Street Cycleway Priorities	26/1054231	85
H  	Memo - Waltham Park Play Space Renewal and Multi-Sport Court Installation	26/1056765	88

Signatories Ngā Kaiwaitohu

Authors	Jonathon Jones - Community Board Advisor Nime Ah Kam-Sherlock - Community Recreation Advisor Heather Davies - Community Development Advisor Abbey McMillan - Support Officer
Approved By	Josh Wharton - Manager Community Governance, Spreydon-Cashmere-Heathcote Matthew McLintock - Manager Community Governance Team John Filsell - Head of Community Support and Partnerships

	Allocation 2025-26	
Waihoru Spreydon-Cashmere-Heathcote Discretionary Response Fund	Amounts	Board Approval
Carry forward unspent 2024/25 Discretionary Response Fund	\$42,598.00	
2025/26 Discretionary Response Fund established from 2025/26 SCF	\$77,741.00	14/08/25
TOTAL 2025/26 DISCRETIONARY RESPONSE FUND	\$120,339.00	
Waltham Community Event(s) 2025/26	\$4,500.00	
Summer with Your Neighbours 2025/26	\$4,000.00	
Hoon Hay Fiesta 2025	\$8,000.00	
Community Awards 2025-26	\$3,000.00	
Youth Development Fund 2025/26	\$10,000.00	
Communicating with the Community	\$2,500.00	
Off the Ground Fund	\$3,000.00	
Cashmere High School Board of Trustees, National Readers Cup Challenge 2025	\$500.00	14/08/25
Cashmere Heathcote River Day Trust Board - Ōpāwaho Heathcote River Day – Annual Event in 2026	\$2,413.00	11/12/25
Library Knit Group - Venue Hire	\$1,350.00	11/12/25
Sumner Bays Union Trust - Sumner Community Christmas Carols	\$1,397.00	12/02/26
Canterbury Westland Free Kindergarten Association Inc - Outdoor Climbing Equipment	\$3,000.00	12/02/26
The Youth and Cultural Development Society Incorporated - FRESH Pool Parties Pioneer Pool	\$12,000.00	12/02/26
Suburbs Rugby Football Club Incorporated	\$2,985.00	16/04/26
Hoon Hay Community Association Incorporated	\$2,567.00	16/04/26
Opawa Community Garden	\$1,837.00	16/04/26
Christchurch South Community Patrol Incorporated	\$4,597.00	16/04/26
Pioneer Basketball Club Incorporated	\$2,835.00	16/04/26
Kereru Sports & Cultural Club Incorporated	\$2,500.00	16/04/26
Cashmere High School Board of Trustees, Future Problem Solving International Conference	\$2,000.00	14/05/26
Matuku Community Theatre Incorporated	\$6,505.00	14/05/26
Sumner Community Residents' Association Incorporated	\$3,000.00	14/05/26
Opawaho Trust	\$10,000.00	14/05/26
Discretionary Response Fund Balance	\$25,853.00	
Youth Development Fund	\$10,000.00	Approved
Zara Harrington, World Salsa Solo 2025 in Gold Coast, Australia	\$300.00	01/09/25
Melina Panapa, XP National Gymnastics Championships, Auckland	\$300.00	10/09/25
Leo O'Neill, New Zealand Secondary Schools Orienteering Team, Brisbane, Australia	\$350.00	11/09/25

Zelia Hallam, Artistic Swimming New Zealand Nationals, Wellington	\$300.00	15/09/25
Liam Joy, Hoop Nations Basketball Tournament, Tauranga	\$300.00	10/11/25
Kieran Funcke, Fiji Service Project, Fiji	\$500.00	09/02/26
Grace Bradley, CTK National Korfball Association Cup, Taiwan	\$500.00	09/02/26
Brooke Goldsmith, AON NZ Surf Life Saving Championships 2026, Eastern Bay of Plenty	\$300.00	09/02/26
Aimee Wright, Fiji Service Project, Fiji	\$500.00	16/03/26
Viennaeverly Pitman, Teina Kotiro NZ Maori Rugby League Tournament	\$300.00	08/04/26
Joshua Seaman, Premier Invitational Football Tournament	\$500.00	05/05/26
Kye Saotome-Ripley, U19 Volleyball Inter-provincial Championships	\$300.00	05/05/26
Youth Development Fund Balance - Available for allocation	\$5,550.00	

Off The Ground Fund	\$3,000.00	Approved
Christchurch South Community Patrol Incorporated	\$300.00	11/11/25
Off The Ground Fund Balance - Available for allocation	\$2,700.00	

**Waihoru Spreydon-Cashmere-Heathcote Youth Development Fund
2025/26**

Application ID	YDF25/26_00052_SCH
Applicant	Kye Saotome-Ripley
Age	17
School (if applicable)	Cashmere High School
Ward	Spreydon
Purpose	Volleyball Inter-Provincial Championships
Date(s) of Activity	29/05/2026 - 01/06/2026
Total Cost	\$1,210
Amount Requested	\$600
Funding Other	\$245 - Selling Dumplings
Staff Recommendation	That the Waihoru Spreydon-Cashmere-Heathcote makes a grant of \$300 from its 2025-26 Youth Development Fund to Kye Saotome-Ripley towards Volleyball Inter-Provincial Championship expenses, excluding food.
Application Summary	<p>Kye Saotome-Ripley (Kye) is a Year 13 student at Cashmere High School who has recently been selected for the Canterbury Under 19's volleyball team.</p> <p>The team will be competing at the Inter-Provincial Championships at Akau Tangi Sports Centre in Wellington from 29/05/2026 - 1/06/2026.</p> <p>Having played volleyball for the past five years, Kye has become a dedicated and hardworking member of his school team. This year, his team won the Canterbury Senior Championships, and Kye was proud to be recognised as one of ten players selected for the tournament team.</p> <p>Kye is excited for the opportunity to compete at a higher level and is aiming to do his best for the team, continue improving his skills, and hopefully come away with a win at the Inter-Provincial Championships competition.</p> <p>Kye earned his place in the Canterbury Under 19's team through a competitive trial process, where he was selected as one of ten players to represent the region.</p>

(Office admin)

Approved by the Board via email	Date: 5 May 2026 TRIM 26/933371
--	------------------------------------

**Waihoru Spreydon-Cashmere-Heathcote Youth Development Fund
2025/26**

Application ID	YDF25/26_00037_SCH
Applicant	Joshua Seaman
Age	14
School (if applicable)	Cashmere High School
Ward	Cashmere
Purpose	Premier Invitational Football tournament
Date(s) of Activity	29/09/2026 - 01/10/2026
Total Cost	\$3,900
Amount Requested	\$2,000
Funding Other	\$386.56 – Raffle \$55.81 – CTFC Fun Day
Staff Recommendation	That the Waihoru Spreydon-Cashmere-Heathcote approves a grant of \$500 from its 2025-26 Youth Development Fund to Joshua Seaman towards Premier Invitational Football tournament expenses, excluding food.
Application Summary	<p>Joshua Matthew Seaman (Joshua), a Year 10 student at Cashmere High School, has been selected to compete at the Premier Invitational Football Tournament on the Gold Coast from 29/09/2026 - 01/10/2026. The event brings together top teams from across Australia and New Zealand for a week of elite competition, development, and memorable experiences.</p> <p>Joshua has been playing football with his local club - Cashmere Technical Football Club, since the age of four and has competed in the top-level academy team for his age group for the past three years.</p> <p>This will be Cashmere Technical Football Club’s first year taking an under 15’s team to the Premier Invitational Football Tournament. The club applied to attend and was required to submit recent team results so selectors could determine whether the team was a suitable fit for the competition.</p> <p>Joshua says his “ultimate goal is to play professional football in New Zealand. He would love to play for the Cashmere Tech first team and then move on to the A-League.”</p>

(Office admin)

Approved by the Board via email	Date: 5 May 2026 TRIM 26/933371
--	------------------------------------

Waihoru Spreydon-Cashmere-Heathcote Youth Development Fund 2025/26

Application ID	YDF25/26_00055_SCH
Applicant	Cody Hawke
Age	16
School (if applicable)	
Ward	Cashmere
Purpose	Cody Hawke will represent New Zealand in the U19 Junior World Mountain Bike Cross Country Championships
Date(s) of Activity	24/08/2026 - 30/08/2026
Total Cost	\$13,680
Amount Requested	\$750
Funding Other	\$500.00 - Single Track Club \$3,000.00 - Give a little page \$2,000.00 - Small jobs in the community Pending - Inspire Foundation, E B Foundation, Sport Canterbury
Staff Recommendation	That the Waihoru Spreydon-Cashmere-Heathcote makes a grant of \$500 from its 2025-26 Youth Development Fund to Cody Hawke towards 2026 U19 Junior World Mountain Bike Cross Country Championships, excluding food.
Application Summary	<p>Cody Shannon Hawke (Cody), 16 years of age, has been selected to represent New Zealand in the U19 Junior World Mountain Bike Cross Country Championships that will take place in Val di Sole – Trentino, Italy from 24/08/2026 - 30/08/2026.</p> <p>Cody has been bike racing since the age of eight, after being introduced to the sport through riding alongside his dad. Cycling has become a huge part of Cody's life, and he continues to enjoy learning and developing as an athlete.</p> <p>Participation in this event will help Cody gain valuable experience racing on the international stage, giving him key skills and knowledge that he hopes to pass on to other young riders within the groups he is involved in.</p> <p>Cody says his, “long-term goal is to compete internationally at the World Mountain Bike Championships and the UCI MTB World Series in Europe.”</p> <p>To be selected for the World Championships, athletes had to either finish in the top three at the National Championships held in Rotorua in March 2026, or place in the top three at the Oceania Continental Championships held in February and March 2026.</p>

(Office admin)

Approved by the Board via email	Date: 18 May 2026 TRIM 26/1035452
--	--------------------------------------

Parks

Kia ora koutu,



Happy Volunteers: the team from FIS Global after a busy afternoon releasing plants from long grass at Latters Spur

The United Nations has designated 2026 as the International Volunteer Year (IVY 2026). The Park Ranger Team appreciates all the mahi of the many volunteers who give up their time to plant and care for the young plants. Over the years, restoration planting areas in the Port Hills have benefitted from many hours of work provided by volunteers. Planting days are always well attended. It is a testament of how valued tree planting is to the Christchurch community when so many people turn out during the colder months. Spring and autumn plant care is the often-overlooked work that is vital to the survival of the young plants. Many volunteers come back time and time again to cut back the grass from around the plants and remove cages when they are no longer needed. All volunteers bring energy and enthusiasm to the work that makes the time spent working with every one of them a joy and a privilege. Their work is noticed and commented upon by many and is appreciated by all who work and play throughout the reserves around the Port Hills.

The autumn was damp and chilly at times. However, the weather on the maintenance days behaved as we tackled the abundance of grass which continued to grow very well through the season. The new plants had a good start to life on the hills with the frequent rain that fell throughout the year. The following photos show a selection of hardworking volunteers at work.

Volunteers at work Autumn 2026



Belinda enjoyed a morning searching for buried plants at Mahoe Nui, Evans Pass



A perfect autumn day at Dry Bush



The group from MacPac enjoying time away from the office while tending plants they planted last winter at Greenwood



A group of enthusiastic friends: back at Huntsbury track after removing a load of old cages from Dry Bush



Two tramping clubs at Greenwood: Bishopdale and Over 40's working hard to restore the bush around remnant trees



Deirdre and Andy checking the young plants at Eastside Bush

Volunteer Spotlight: FIS Global

A team from FIS Global has been providing plant care to one site on the hills for several years. Their reason for volunteering is:

*“As a group, we volunteer for plant maintenance on the Port Hills because it allows us to **give back to our local community** and enhance the plantings and wildlife in this beautiful area.*

This opportunity not only helps our community but also provides a fun and rewarding experience for all involved. By gathering together, we can contribute to a mission that benefits both our environment and our fellow Cantabrians, making it a fulfilling half-day of toil that we all enjoy.”



Map showing areas of restoration planting

Keen to plant native trees?

Volunteer planting days run from 1pm to 3pm.

- Saturday 6th June [Barnett Park](#)
- Saturday 13th June [Dry Bush](#)
- Saturday 20th June [Eastside Bush \(Victoria Park\) – Followed by BBQ](#)

Barnett Park: Meet in the dog walking paddock accessed from the gate at the end of Bay View Road, Redcliffs. Look for the park ranger truck on the opposite side of the paddock. On-street parking. Please keep access ways clear for residents.

Dry Bush: Park at the top of Huntsbury Avenue and walk up Huntsbury 4WD track to site (1.3km approx. 25 minutes), or park on the Summit Road and walk down Huntsbury Track to Dry Bush (0.8km approx. 10 minutes). Look for the park ranger truck near the cattle stop at the fenced bush. There is no parking on Huntsbury Track.

Eastside Bush: Meet in the car park behind the Victoria Park Visitor Centre, next to Park Ranger HQ.

Come prepared for all weather and wear sturdy footwear for hill work. Spades and gloves will be provided by the rangers, but feel free to bring your own.

For more information, please visit ccc.govt.nz/port-hills-reserves-volunteer-days or contact Fiona Fenton on 027 506 1425 or fiona.fenton@ccc.govt.nz



Dry Bush: blue tipped stakes marking this winter's planting spots

Thank you

Thanks to all volunteers – your contribution is much appreciated!

Fiona, Di and the Port Hills Ranger Team

Christchurch City Council
53 Hereford St, Christchurch Central City, Christchurch



Ticket Report

01 04 2026 - 25 04 2026

Filter by Ward

Spreydon-Cashmere-Heathcote

Filter by month

2026 (Year) + April (Month)

3397

Reported Tickets last month

90.93%

Resolved within SLA

Channels

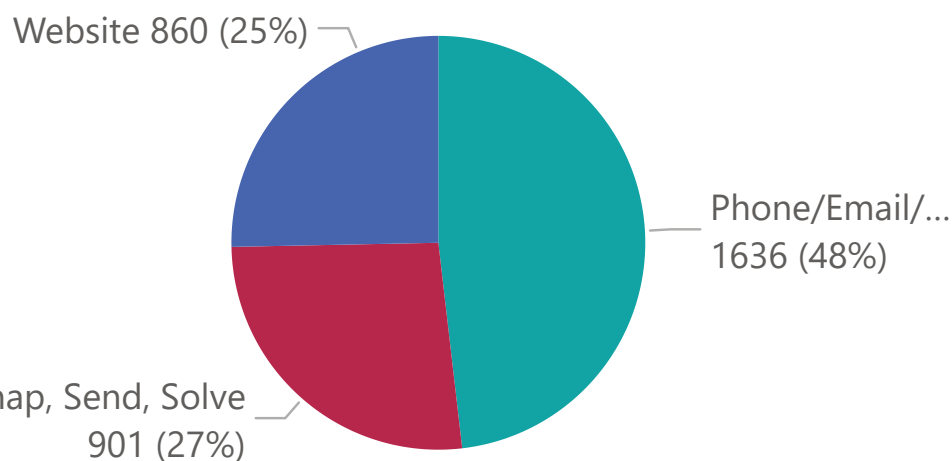

Status as of Report Date

Closed/Resolved

64.23%

Open

32.53%

Programmed Work

3.24%

Top 10 Incident Categories

Cashmere Heathcote Spreydon

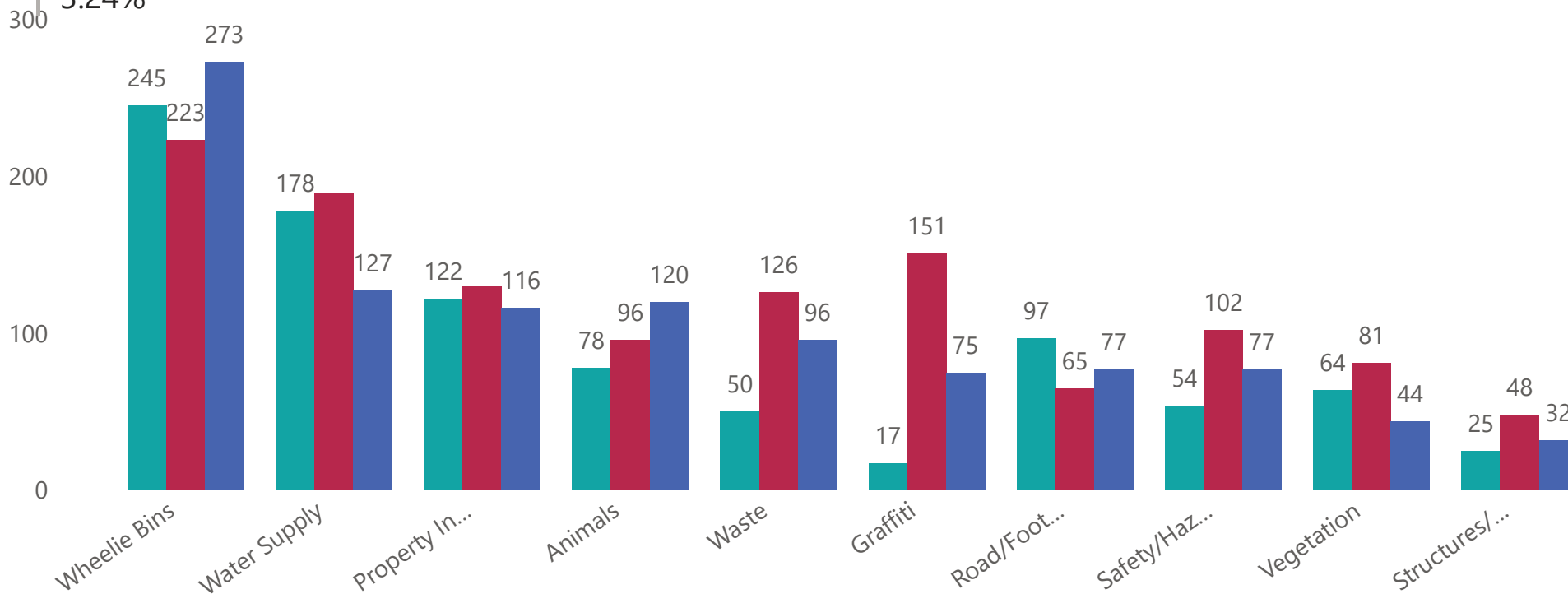

Top 10 Object Categories

# Tickets	ObjectCategory	+/- Previous Month
301	Damaged Bin	-16
300	Water Leak	-276
236	Litter	-332
232	Bin Not Collected	18
169	Graffiti - Fence, building or structure	-182
162	Residential Property Files	-29
124	Dog Registration	39
122	Residential LIM	-17
102	Trees	-131
84	Sweeping	45

Report date:
30 Apr 2026

GRAFFITI SNAPSHOT April 2026

Ward and Suburb Insights



Ward Reporting

These statistics exclude non-CCC utility cabinets and include graffiti incidents that may have been reported more than once

Ward	Graffiti reported April 2026	Graffiti reported March 2026	% Monthly Change
Central	578	576	0%
Linwood	206	226	-9%
Heathcote	169	245	-31%
Spreydon	97	149	-35%
Burwood	83	54	54%
Coastal	71	58	22%
Riccarton	52	59	-12%
Hornby	41	30	37%
Innes	39	56	-30%
Banks Peninsula	34	42	-19%
Papanui	32	60	-47%
Halswell	29	7	314%
Fendalton	25	11	127%
Cashmere	24	38	-37%
Harewood	14	27	-48%
Waimairi	12	6	100%
Unknown	1		
Total	1507	1644	-8%

Reporting Hot Spots

Streets/Locations with the most reported graffiti
(Excluding non- CCC Utility cabinets)

Suburb	Reports made April 2026	Reports made March 2026
Central City	466	435
Linwood	101	92
Sydenham	82	177
Woolston	64	77
Waltham	57	58
Addington	52	87
Wainoni	51	49
North Linwood	40	45
Riccarton	33	44
New Brighton	32	41
Spreydon	29	16
Hornby	28	16
Lytelton	25	35
Avonside	24	28
Dallington	22	7
Opawa	22	18
Bromley	21	29
Papanui	21	42
Sockburn	18	2
St Albans	18	38
Hornby	16	10

Monthly Draw Winner:



Ward Removal

Graffiti removed

Ward	Graffiti cleaned mtrs2 April 2026	Graffiti cleaned mtrs2 March 2026
Central	1288	845
Heathcote	738	732
Linwood	461	406
Spreydon	224	311
Burwood	141	217
Coastal	137	276
Banks Peninsula	99	65
Fendalton	97	18
Papanui	71	66
Harewood	60	320
Riccarton	58	84
Cashmere	57	57
Waimairi	48	3
Innes	46	140
Hornby	36	131
Halswell	18	14
Total	3578	3685

Removal Hot Spots

Locations with the most graffiti removed (m2)

Street	Cleaned Graffiti sqm
Tuam Street, Mata to Manchester	94
Montreal Street	72
Gloucester Street	60
Tuam Street	50
Hagley Park South	36
St Asaph Street, Barbadoes to Duke	28
Margaret Mahy Family Playground	27
Rauora Park	25
Welles Street \ Manchester Street, Central City	24
Colombo Street \ Bath Street, Central City	23
Cathedral Square, Worcester to Colombo	21
Montreal Street, Cashel to Hereford	21
Madras Street \ Allen Street, Central City	20
Montreal Street, Gloucester to Armagh	20
Willow Street \ Oxford Terrace, Central City	20
Armagh Street	20
Gressons Lane \ Barbadoes Street, Central City	18
Willow Street, Oxford to End	15
Barbadoes Street, Gloucester to Gressons	13
High Street	13
St Asaph Street, Mata to Manchester	13
Cathedral Square	12
Godley Statue Reserve	12
Worcester Street \ Manchester Street, Central City	11
Oxford Terrace, Montreal to Cambridge	11
Oxford Terrace, Colombo to Manchester	10

GRAFFITI SNAPSHOT

April 2026

Further Insights

Reporter Type	Reports made April
Non Volunteer	962
Individual Volunteer	453
Friend Volunteer	27
Group Volunteer	65
Total	1645

% of Reports made by Volunteers



Direct reports to Snap send Solve

888

(Inc. 135 Graffiti on a traffic light pole or cabinet, or water pump cabinets)

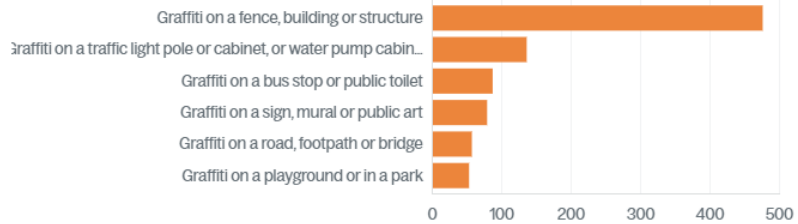

Cabinet Art - 80 Park Terrace

Artist - Frankie Bakker - 'Fans' explores display and identity. The fans act as both spectacle for courtship and as a shield, reflecting the tension between exposure and protection. The work mirrors human behaviour and how we perform, present, and seek connection through display.

Community Facilities Summary Report – April 2026

Area	Facilities Updates
Te Pātaka o Rākaihautū Banks Peninsula	<ul style="list-style-type: none"> • Diamond Harbour stage rigging safety review completed; replacement options being assessed. • Kaituna Hall lease discussions ongoing. • Le Bons Bay Hall refurbishment planning continues. • Little Akaloa water infrastructure works completed. • Little River facility improvements completed; storage and lease matters progressing. • Pigeon Bay accessibility improvements completed. • Port Levy water upgrades completed. • Kāwhiu Lyttelton Recreation Centre accessibility and maintenance items under review. • Peninsula resilience and solar initiatives progressing.
Waitai Coastal-Burwood-Linwood	<ul style="list-style-type: none"> • North New Brighton remediation planning progressing. • The future of the South New Brighton Community Hall is being investigated • Heat pumps were installed into the Bromley Community Centre
Waimāero Fendalton-Waimairi-Harewood	<ul style="list-style-type: none"> • Fendalton facility renewal scope under review. • Ouruhia Hall refurbishment underway.
Waipuna Halswell-Hornby-Riccarton	<ul style="list-style-type: none"> • Hei Hei replacement facility planning continues. • Templeton Hall remediation works progressing.
Waipapa Papanui-Innes-Central	<ul style="list-style-type: none"> • Mairehau Public Library accessibility works progressing. • Shirley Road consenting and procurement progressing. • Phillipstown occupation and handover arrangements underway.
Waihoru Spreydon-Cashmere-Heathcote	<ul style="list-style-type: none"> • Christchurch South Community Gardens repairs under review. • Somerfield governance / consent matters progressing.
General Programme Update	<ul style="list-style-type: none"> • Multicultural Recreation & Community Centre upgrade works underway. • Ongoing citywide maintenance and capital delivery are continuing. • Renewable energy and resilience initiatives progressing.

Memos

Christchurch
City Council 

Memo

Date: 11 February 2026
From: Toni Dakers, Traffic Engineer
To: Jonathon Jones, Community Board Advisor
Cc:
Reference: 25/2055949

Response to Correspondence - Collins Street Cycleway Priorities

1. Purpose of this Memo Te take o tēnei Pānui

- 1.1 The purpose of this memo is to respond to correspondence from Sean Eustace tabled at the Waihoru Spreydon-Cashmere-Heathcote Community Board meeting on 11 September 2025.
- 1.2 This correspondence relates to a request to change the priority at the Collins Street T-intersections to give major cycleway users priority over side road traffic. Specifically comparing this to the layout at the Centennial Avenue / Huia Street intersection.
- 1.3 A copy of the correspondence is provided in the meeting minutes (item 7C): [Agenda of Waihoru Spreydon-Cashmere-Heathcote Community Board - Thursday, 11 September 2025](#)
- 1.4 The information in this memo is not confidential and can be made public.

2. Update He Pānui

Cycle Lane vs Cycle Path

- 2.1 A cycle path (a path that's not on the road carriageway or is separated from the carriageway by some form of physical separation) is not considered to be part of the carriageway. Based on current law, any vehicle entering the road carriageway from a 'non roadway' (i.e. from the cycle path) must give way to the traffic on the carriageway.
- 2.2 So, when the Collins Street cycle pathway meets a T-intersection, the pathway users by default have to give way to the traffic on the carriageway until it is safe to re-enter the carriageway (cross the intersection).
- 2.3 The existing signage and markings on the Collins Street cycle route reflect this priority.
- 2.4 This differs from an on-road painted cycle lane which has a legal status as a 'Traffic lane' and therefore motorists need to give way to cyclists using the cycle lane.

Existing Intersection Priority and Layout

- 2.5 The layout and priority at the Collins Street intersections was considered thoroughly during the design stage of the Major Cycle Route (MCR) programme. The design team weighed up all the information, including safety and legality factors as well as forecasts of use. At the time it was decided not to provide a variation to the usual prioritisation described in 2.1-2.2 above.
- 2.6 An aerial view of the layout at the Collins Street / Emerson Street intersection is show in Figure 1 below:

Page 1

Memos



Figure 1: MacAulay Street /Collins Street and Emerson Street / Collins Street intersections

- 2.7 The Centennial Avenue / Huia Street intersection, along with several other T-intersections on the South Express MCR continues the pathways priority where the side road traffic is required to give way to cycle path users. This South express MCR was delivered more recently and has some differences to the environment compared with Collins Street. An aerial view of the layout at the Centennial Avenue / Huia Street intersection is shown in Figure 2 below.

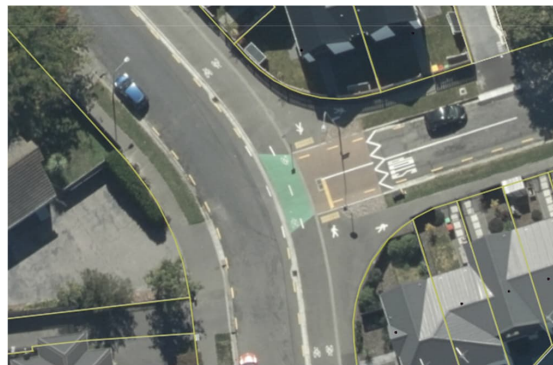

Figure 2: Centennial Avenue / Huia Street intersection

- 2.8 The most notable difference with the Collins Street route is the Emerson Street / Collins Street intersection. This intersection has a layout which results in poor intervisibility between traffic approaching on Emerson Street and southbound cycle path users. This increases the risk of collisions. If changes were to be made to the current or expected priorities, physical changes would be required to manage this risk. The general layout at the Emerson Street / Collins Street intersection is shown in the photos below.



Photos: Emerson Street / Collins Street intersection

Memos



- 2.9 At this stage there are no plans to make any changes to the priorities on Collins Street. However, this may be revisited as the planned linked route to the south is progressed in future.
- 2.10 A search of the NZ Transport Agency Crash Analysis System has been undertaken. No crashes have been reported on Collins Street or at the intersections of Macaulay Street / Collins Street or Emerson Street / Collins Street within the last five years to indicate an inherent road layout or operational issue.

3. Conclusion Whakakapinga

- 3.1 There are no current plans to make any changes the Collins Street intersection priorities. The layouts were thoroughly considered during the detailed design stage for this route. However, this may be revisited as the planned linked route to the south is progressed in future.

Attachments Ngā Tāpirihanga

There are no attachments to this memo.

Signatories Ngā Kaiwaitohu

Author	Toni Dakers - Traffic Engineer
Approved By	Kathy Graham - Team Leader Traffic Operations Stephen Wright - Head of Transport & Waste Management

Memos

Christchurch
City Council

Memo

Date: 14 May 2026
From: Holly Whitaker- Project Manager Community Parks Play and Recreation
To: Waihoru Spreydon - Cashmere - Heathcote Community Board
Cc: Bridie Gibbings - Manager Operations - Community Parks Development
Reference: 26/658106

Waltham Park Play Space Renewal and Multi-Sport Court Installation

1. Purpose of this Memo Te take o tēnei Pānui

- 1.1 The purpose of this memo is to inform the Waihoru- Spreydon - Cashmere Heathcote Community Board of the upcoming consultation for the Waltham Park Play Space Renewal and Multi-Court Installation.
- 1.2 The information in this memo is not confidential and can be made public.

2. Update He Pānui

- 2.1 Waltham Park is located in the Heathcote Ward and is adjacent to Waltham Road and Waltham Pool.

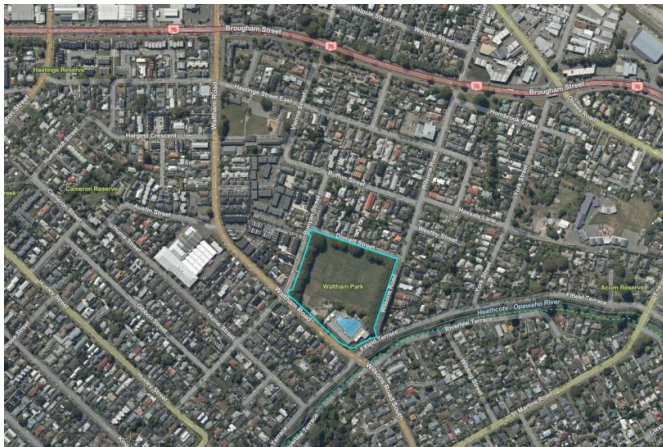

Memos

Christchurch City Council



- 2.2 The play space is being renewed based on its age and condition.
- 2.3 The basketball court is being removed and replaced with a multi-sport court.

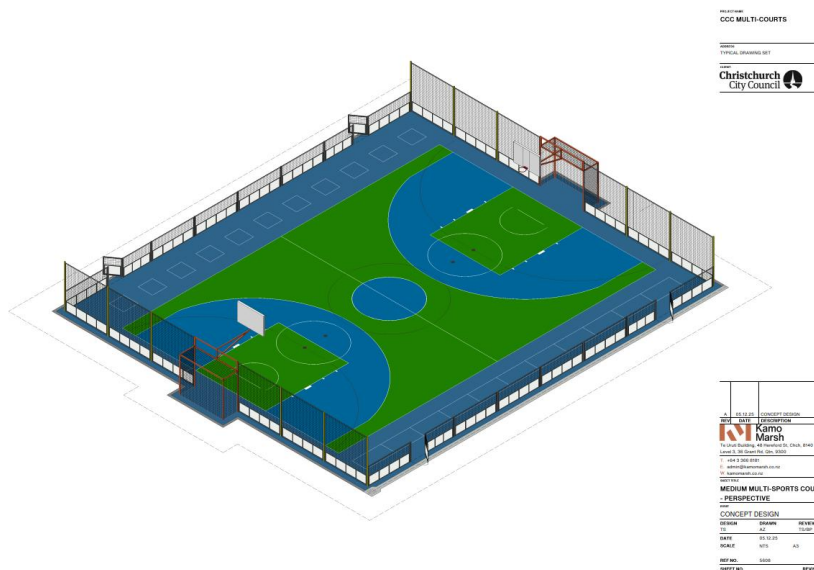

- 2.4 The existing skate facility is being retained; however, the bowl feature is proposed for renewal in future years, with additional space reserved for potential expansion, subject to funding availability.
- 2.5 The budget for the project is \$593,000.
- 2.6 Early engagement was undertaken in 2024 and included meetings with key stakeholders including Waltham Rugby Club, Waltham Cottage, the Ōtautahi Skaters Association and local schools (Hillview Christian School and Waltham School). Park visitors and play space users were asked which type of play equipment they liked the most with a token box activity. The

Attachment H Item 12

Memos

Christchurch
City Council

tokens were collected over the summer holidays at Waltham Pool. All feedback was taken into consideration to create the draft play space plan.

- 2.7 Climbing and sliding emerged as the most popular forms of play and therefore the largest play item incorporates these features.



- 2.8 The significance of the whenua and its proximity to the Ōpāwaho awa/river has influenced the design and theming of play equipment. Mana Whenua have expressed support for this symbolism.
- 2.9 The layout has been significantly influenced by District Plan noise setback requirements relating to skateboarding and basketball activities, as well as setback requirements associated with the sports field.
- 2.10 Crime Prevention Through Environmental Design principles have been taken into account and efforts have been made to improve passive surveillance by opening up sightlines into recreational spaces. In future year the wings of the toilets will be removed to reduce hiding spaces and improve sightlines.



- 2.11 Accessibility has been considered in the design of the overall space and inclusive play items have been selected to provide play options for all abilities.
- 2.12 The project also includes upgrades to seating, pathways, bins, water fountains and planting, along with the provision of additional shade through installation of a shade umbrella.
- 2.13 The presence of contaminated soil on the site and the requirements to obtain Archaeological Authority and Resources Consent adds to the complexity and costs associated with the project.

Memos

Christchurch
City Council 

3. Conclusion Whakakapinga

- 3.1 Once consultation is complete the design will be amended as required. Staff will then present the final concept to the Community Board for approval. Detailed design and consent applications can then be completed, with construction planned for Autumn 2027.

Attachments Ngā Tāpirihanga

No.	Title	Reference
A	Waltham Park playspace renewal and multi-sport court-concept for consultation	26/1005744

Signatories Ngā Kaiwaitohu

Author	Holly Whitaker - Project Manager - Community Parks
Approved By	Bridie Gibbings - Manager Operations - Parks Development



Memos

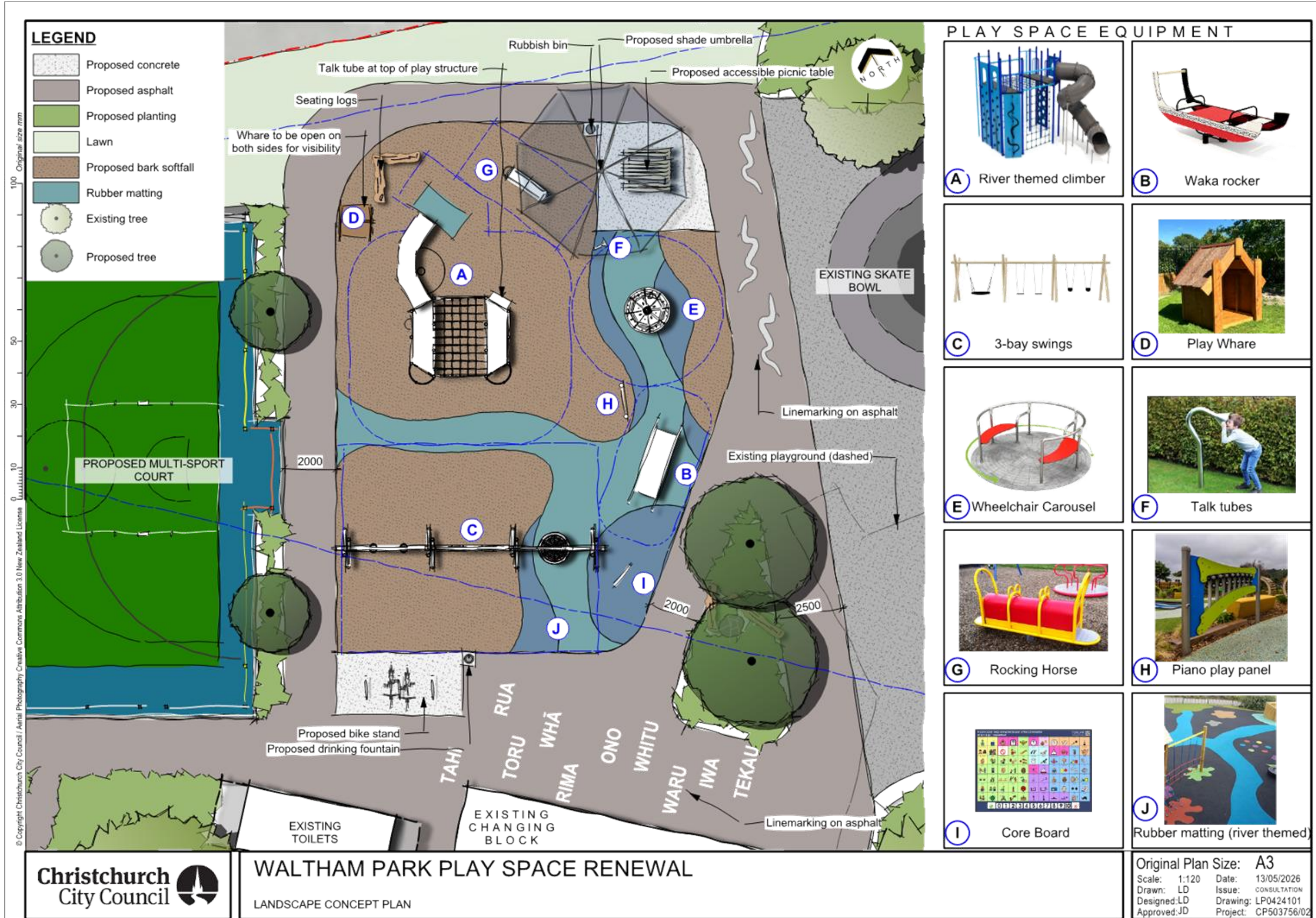

13. Elected Members' Information Exchange Te Whakawhiti Whakaaro o Te Kāhui Amorangi

This item provides an opportunity for Board Members to update each other on recent events and/or issues of relevance and interest to the Board.

Karakia Whakamutunga

Tukuna te wairua kia rere ki te taumata Ko te matatika te mātāpono hei arahi i ngā mahi Ka arotahi te tira kia eke panuku, kia eke Tangaroa Haumi e, hui e, tāiki e	<i>May the spirit be released to soar to its zenith. Ethics is the principle that guides our work. As we focus on the success for our community Bring together! Gather together and bind together!</i>
---	--

Actions Register Ngā Mahinga

When decisions are made at meetings, these are assigned to staff as **actions** to implement. The following lists detail any actions from this meeting that were:

- Open at the time the agenda was generated.
- Closed since the last ordinary meeting agenda was generated.

Open Actions Ngā Mahinga Tuwhera

REPORT TITLE/AGENDA SECTION	MEETING DATE	ACTION DUE DATE	UNIT	TEAM
Public Forum - Traffic safety issues in Main Road Redcliffs	12 March 2026	11 June 2026	Transport & Waste	Traffic Operations
Public Forum - Road safety issues with cyclists on Sumner Hills	11 December 2025	18 June 2026	Transport & Waste	Traffic Operations
Centaurus Road/St Martins Road - Pedestrian Safety Improvements	12 February 2026	30 June 2026	Transport & Waste	Traffic Operations
Hoon Hay Road/Lewis Street - Pedestrian Improvements	12 February 2026	30 June 2026	Transport & Waste	Traffic Operations
Public Forum - Basketball court at Ti Rakau Reserve	10 July 2025	30 June 2026	Parks	Parks & Recreation Planning
Public Forum - Spokes Canterbury	12 June 2025	30 June 2026	Transport & Waste	Asset Planning
Redcliffs Village - Coastal Pathway safety improvements.	15 February 2024	30 June 2026	Transport & Waste	City Streets Maintenance
Richmond Hill Road - Proposed Parking Changes and Pedestrian Improvements	11 September 2025	30 June 2026	Transport & Waste	Traffic Operations
Public Forum - Old stone tram shelter Sumner	11 September 2025	3 July 2026	Transport & Waste	Asset Management
Sumner Valley Riding School Trust - proposed new lease	10 April 2025	15 July 2026	F&P Unit	Property Consultancy
Barnett Park play space renewal and tree planting plan	16 April 2026	16 July 2026	Parks	Botanic and Garden Parks
Barnett Park play space renewal and tree planting plan	16 April 2026	16 July 2026	Parks	Community Parks
Land disposal - NZTA SH76 Brougham St Corridor Improvements	16 April 2026	16 July 2026	F&P Unit	Property Consultancy
Orion Easement Centennial Park	16 April 2026	16 July 2026	F&P Unit	Property Consultancy
Public Forum - Coastal Pathway markings	16 April 2026	16 July 2026	Transport & Waste	Traffic Operations
Subdivision Roding Approval - Worsleys Road	16 April 2026	16 July 2026	Transport & Waste	Asset Planning
Sumner Tennis Club Proposed Lease: Post-Consultation Report	16 April 2026	16 July 2026	Parks	Residential Red Zone
Grant an Easement over Waterworks Reserve 109 Scruttons Road Heathcote Christchurch.	15 February 2024	1 August 2026	F&P Unit	Property Consultancy
Correspondence	14 May 2026	13 August 2026	Transport & Waste	Traffic Operations
Licence for Outdoor Dining - 2 Esplanade Sumner	14 May 2026	13 August 2026	Parks	Planning & Policy
Opawa Road - Proposed Parking Restrictions	14 May 2026	13 August 2026	Transport & Waste	Traffic Operations
Public Forum - Large Oak Tree in Remuera Reserve	14 May 2026	13 August 2026	Parks	Botanic and Garden Parks
Public Forum - Port Hills Park Trust update	14 May 2026	13 August 2026	Parks	Regional Parks
Waihoru Spreydon-Cashmere-Heathcote Community Board - Tree Planting Plans (Various Parks)	14 May 2026	13 August 2026	Parks	Botanic and Garden Parks
Cashmere - Penruddock Roundabout	12 February 2026	31 August 2026	Transport & Waste	Asset Planning
Beach Hospitality Limited - Landlord Consent to Improvements and Request for Further Lease	13 March 2025	1 September 2026	F&P Unit	Property Consultancy
215 Taylors Mistake Road - Road Stopping Application	12 March 2026	11 September 2026	F&P Unit	Property Consultancy
Sumner Tennis and Squash Club Application to lease 8-14 Heberden Avenue and 140 Nayland Street	11 May 2023	31 December 2026	F&P Unit	Property Consultancy
Grant of Easement Cracroft Reserve	21 May 2026	28 February 2027	F&P Unit	Property Consultancy

Actions Closed Since the Last Meeting Ngā Mahinga kua Tutuki nō Tērā Hui

Actions closed from 7 May 2026 to 3 June 2026.

REPORT TITLE/AGENDA SECTION	MEETING DATE	DUE DATE	ACTION CLOSURE DATE	UNIT	TEAM
Waihoru Spreydon Cashmere Heathcote Discretionary Response Fund 2025/26 Cashmere High School Board of Trustees, Matuku Community Theatre Incorporated, Sumner Community Residents Association Incorporated, Opawaho Trust.	14 May 2026	13 August 2026	19 May 2026	CS&P	CS&P - Governance (Spr-Cas-Hea)
Rose Street / Beechworth Avenue Intersection Proposed No Stopping Restrictions	16 April 2026	16 July 2026	21 May 2026	Transport & Waste	Traffic Operations
Stolen Bikes Christchurch and Canterbury	16 April 2026	16 July 2026	21 May 2026	Transport & Waste	Travel Demand Management
Public Forum - Acknowledging and Celebrating the Cultural Heritage of Te Rae Kura/Redcliffs	12 March 2026	11 June 2026	3 June 2026	Parks	Management
Spreydon, Somerfield, Waltham, Beckenham CRAF - Lyttelton Street safety improvements	10 July 2025	26 June 2026	3 June 2026	Transport & Waste	Project Management
Spreydon, Somerfield, Waltham, Beckenham CRAF - Selwyn Street pedestrian and cycle safety improvements	10 July 2025	26 June 2026	3 June 2026	Transport & Waste	Project Management
Spreydon, Somerfield, Waltham, Beckenham CRAF - Strickland Street/Somerfield Street safety improvements	28 August 2025	26 June 2026	3 June 2026	Transport & Waste	Project Management