

---

## Waimāero

### Fendalton-Waimairi-Harewood Community Board

### AGENDA

---

#### Notice of Meeting Te Pānui o te Hui:

The ordinary meeting of the Waimāero Fendalton-Waimairi-Harewood Community Board will be held on:

**Date:** Monday 16 February 2026  
**Time:** 4.30 pm  
**Venue:** Boardroom, Fendalton Service Centre,  
Corner Jeffreys and Clyde Roads, Fendalton

---

#### Membership Ngā Mema

Chairperson	Jason Middlemiss
Deputy Chairperson	Nicola McCormick
Members	David Cartwright
	James Gough
	Aaron Keown
	Lucy Keown
	Sam MacDonald
	Ben Spittle
	Bridget Williams

---

10 February 2026

#### Principal Advisor

Maryanne Lomax  
Manager Community Governance  
Tel: 941 6730  
[maryanne.lomax@ccc.govt.nz](mailto:maryanne.lomax@ccc.govt.nz)

#### Meeting Advisor

Aidan Kimberley  
Community Board Advisor  
Tel: 941 6566  
[aidan.kimberley@ccc.govt.nz](mailto:aidan.kimberley@ccc.govt.nz)  
**Website:** [www.ccc.govt.nz](http://www.ccc.govt.nz)

**Note:** The reports contained within this agenda are for consideration and should not be construed as Council policy unless and until adopted. If you require further information relating to any reports, please contact the person named on the report.

**To watch the meeting live, or a recording after the meeting date, go to:**

<https://www.youtube.com/@fendaltonwaimairiharewoodc6878/streams>

**To view copies of Agendas and Minutes, go to:**

<https://www.ccc.govt.nz/the-council/meetings-agendas-and-minutes/>



# What is important to us?

Our Strategic Framework is a big picture view of what the Council is aiming to achieve for our community

## Our focus this Council term 2022–2025

### Strategic Priorities



Be an inclusive and equitable city which puts people at the centre of developing our city and district, prioritising wellbeing, accessibility and connection.



Champion Ōtautahi-Christchurch and collaborate to build our role as a leading New Zealand city.



Build trust and confidence in the Council through meaningful partnerships and communication, listening to and working with residents.

Adopted by the Council on 5 April 2023



Reduce emissions as a Council and as a city, and invest in adaptation and resilience, leading a city-wide response to climate change while protecting our indigenous biodiversity, water bodies and tree canopy.



Manage ratepayers' money wisely, delivering quality core services to the whole community and addressing the issues that are important to our residents.



Actively balance the needs of today's residents with the needs of future generations, with the aim of leaving no one behind.

## Our goals for this Long Term Plan 2024–2034

### Draft Community Outcomes



#### Collaborative and confident

Our residents have the opportunity to actively participate in community and city life, have a strong sense of belonging and identity, and feel safe.



#### Green and liveable

Our neighbourhoods and communities are accessible and well connected, supporting our goals to reduce emissions, build climate resilience and protect and regenerate the environment, especially our biodiversity, water bodies and tree canopy.

To be adopted by the Council as part of the Long Term Plan 2024–2034



#### A cultural powerhouse

Our diverse communities are supported to understand and protect their heritage, pursue their arts, cultural and sporting interests, and contribute to making our city a creative, cultural and events 'powerhouse'.



#### Thriving and prosperous

Our city is a great place for people, business and investment where we can all grow our potential, where enterprises are innovative and smart, and where together we raise productivity and reduce emissions.

## Our intergenerational vision

A place of opportunity for all.

Open to new ideas, new people, new investment and new ways of doing things – a place where anything is possible.



Ngāi Tahu has rangatiratanga over its takiwā – the Council is committed to partnering with Ngāi Tahu to achieve meaningful outcomes that benefit the whole community

Part A	Matters Requiring a Council Decision
Part B	Reports for Information
Part C	Decisions Under Delegation

## TABLE OF CONTENTS NGĀ IHIRANGI

Karakia Tīmatanga .....	4
C 1. Apologies Ngā Whakapāha .....	4
B 2. Declarations of Interest Ngā Whakapuaki Aronga .....	4
C 3. Confirmation of Previous Minutes Te Whakaāe o te hui o mua .....	4
B 4. Public Forum Te Huinga Whānui .....	4
B 5. Deputations by Appointment Ngā Huinga Whakaritenga.....	4
B 6. Presentation of Petitions Ngā Pākikitanga .....	4

## STAFF REPORTS

C 7. Tree Planting Plan for Yaldhurst Bush .....	21
C 8. Urban Forest Tree Planting for Parkham, Waterford, Glenturret, Grayshott, Englefield, Darroch, Grant Armstrong, Derwent Lassiter and Greendale Reserves.....	29
C 9. Tree Removals - Styx Drain Naturalisation.....	39
C 10. Kotare Street / Puriri Street - Pedestrian Crossing Improvements .....	47
C 11. Wairakei Road Intersections.....	53
A 12. Poynder Avenue and Garden Road bridges - No Stopping Restrictions and Footpaths .....	61
C 13. Property Disposal, Millstead Oaks Subdivision, Casebrook. ....	69
C 14. Waimāero Fendalton-Waimairi-Harewood Community Board Area Report - February 2026 .....	79
B 15. Elected Members' Information Exchange Te Whakawhiti Whakaaro o Te Kāhui Amorangi.....	94

## Karakia Whakamutunga

## Actions Register Ngā Mahinga Tuwhera

## Karakia Tīmatanga

Whakataka te hau ki te uru Whakataka te hau ki te tonga Kia mākinakina ki uta Kia mātaratara ki tai E hī ake ana te atakura He tio, he huka, he hau hū Tihei Mauri Ora	Cease the winds from the west Cease the winds from the south Let the breeze blow over the land Let the breeze blow over the ocean Let the red-tipped dawn come with a sharpened air. A touch of frost, a promise of a glorious day.
--	--

### 1. Apologies Ngā Whakapāha

Apologies will be recorded at the meeting.

### 2. Declarations of Interest Ngā Whakapuaki Aronga

Members are reminded of the need to be vigilant and to stand aside from decision-making when a conflict arises between their role as an elected representative and any private or other external interest they might have.

### 3. Confirmation of Previous Minutes Te Whakaāe o te hui o mua

That the minutes of the Waimāero Fendalton-Waimairi-Harewood Community Board meeting held on [Monday, 8 December 2025](#) be confirmed (refer page 5).

### 4. Public Forum Te Huinga Whānui

A period of up to 30 minutes will be available for people to speak for up to five minutes on any issue that is not the subject of a separate hearing process.

Public Forum presentations will be recorded in the meeting minutes.

### 5. Deputations by Appointment Ngā Huinga Whakaritenga

Deputations may be heard on a matter or matters covered by a report on this agenda and approved by the Chairperson.

Deputations will be recorded in the meeting minutes.

### 6. Presentation of Petitions Ngā Pākikitanga

There were no petitions received at the time the agenda was prepared.

To present to the Community Board, refer to the [Participating in decision-making](#) webpage or contact the meeting advisor listed on the front of this agenda.



Waimāero  
Fendalton-Waimairi-Harewood Community Board  
OPEN MINUTES

**Date:** Monday 8 December 2025  
**Time:** 4.35 pm  
**Venue:** Boardroom, Fendalton Service Centre,  
Corner Jeffreys and Clyde Roads, Fendalton

**Present**

Chairperson	Jason Middlemiss
Deputy Chairperson	Nicola McCormick
Members	David Cartwright
	James Gough (via audio/visual link)
	Aaron Keown
	Lucy Keown
	Sam MacDonald (via audio/visual link)
	Ben Spittle
	Bridget Williams

**Principal Advisor**

Maryanne Lomax  
Manager Community Governance  
Tel: 941 6730  
[maryanne.lomax@ccc.govt.nz](mailto:maryanne.lomax@ccc.govt.nz)

**Meeting Advisor**

Aidan Kimberley  
Community Board Advisor  
Tel: 941 6566  
[aidan.kimberley@ccc.govt.nz](mailto:aidan.kimberley@ccc.govt.nz)

**Website:** [www.ccc.govt.nz](http://www.ccc.govt.nz)

To watch meetings, live, or previous recordings, go to:

<https://www.youtube.com/@fendaltonwaimairiharewoodc6878/streams>

To view copies of Agendas and Minutes, go to:

<https://www.ccc.govt.nz/the-council/meetings-agendas-and-minutes/>



**Part A Matters Requiring a Council Decision**

**Part B Reports for Information**

**Part C Decisions Under Delegation**

**Karakia Tīmatanga**

Whakataka te hau ki te uru Whakataka te hau ki te tonga Kia mākinakina ki uta Kia mātaratara ki tai E hī ake ana te atakura He tio, he huka, he hauhūnga Tīhei mauri ora	Cease the winds from the west Cease the winds from the south Let the breeze blow over the land Let the breeze blow over the ocean Let the red-tipped dawn come with a sharpened air. A touch of frost, a promise of a glorious day.
--	--

The agenda was dealt with in the following order. Where no voting record is shown, the item was carried unanimously by those present.

**1. Apologies Ngā Whakapāha**

**Part C**

There were no apologies.

**2. Declarations of Interest Ngā Whakapuaki Aronga**

**Part B**

There were no declarations of interest recorded.

**3. Confirmation of Previous Minutes Te Whakaāe o te hui o mua**

**Part C**

**Community Board Resolved FWHB/2025/00062**

That the minutes of the Waimāero Fendalton-Waimairi-Harewood Community Board meeting held on Monday, 10 November 2025 be confirmed.

Nicola McCormick/David Cartwright

**Carried**

**4. Public Forum Te Huinga Whānui**

**Part B**

**4.1 Northwood Residents' Association**

Clive Smith spoke on behalf of the Northwood Residents' Association regarding a planned roading layout for Northwood Boulevard.

**Attachments**

A Northwood Residents Association - PowerPoint Presentation

## 5. Deputations by Appointment Ngā Huinga Whakaritenga

### Part B

#### 5.1 Owen Ladbrook

Owen Ladbrook, local resident, addressed the Board regarding item 14 – Proposed P120 Parking Restrictions – Staveley Street.

#### 5.2 Mark Smith

Mark Smith, local business owner, addressed the Board regarding item 14 – Proposed P120 Parking Restrictions – Staveley Street.

#### 5.3 Sarah Zhen

Sarah Zhen, local business owner, addressed the Board regarding item 14 – Proposed P120 Parking Restrictions – Staveley Street.

#### 5.4 Leah Huang

Leah Huang, local business owner, addressed the Board regarding item 14 – Proposed P120 Parking Restrictions – Staveley Street.

#### 5.5 Rudi van den Brink

Rudi van den Brink, local resident, addressed the Board regarding item 12 – Athol Terrace, Proposed No Stopping Restrictions

## 6. Presentation of Petitions Ngā Pākikitanga

### Part B

There was no presentation of petitions.

## 14 Proposed P120 Parking Restrictions - Staveley Street

Staff joined the table to present the report and answer questions from the Board.

This item was then adjourned to allow time for staff to gather further information, during which time the Community Board considered item 9. on the agenda.

## 9. Tree Removal in Bishopdale Mall

Community Board Resolved FWHB/2025/00063

Officer recommendations accepted without change.

### Part C

That the Waimāero Fendalton-Waimairi-Harewood Community Board:

1. Receive the information in the Tree Removal in Bishopdale Mall Report.
2. Notes that the decision in this report is assessed as low significance based on the Christchurch City Council's Significance and Engagement Policy.
3. Notes that the road stopping, tree removals, and carpark reconfiguration with associated landscaping to facilitate the redevelopment are interdependent.
4. Notes that the Public Works Act 1981 will be used to stop the road, and that this process will be enacted under the delegated authority of the Property Consultancy Manager.
5. Notes that the decisions in this report are conditional upon the developer entering into a sale and purchase agreement, together with a development agreement for the carpark, to purchase the portion of road to be stopped.
6. The board approves the removal of the trees located within the carpark (ID's 98396, 98375, 98373 and four Pseudopanax) and reconfiguration of the carpark with additional Tree planting subject to the following conditions:
  - a. The developer entering into a Sale and Purchase Agreement and a Project Development Agreement for the carpark works.
  - b. The developer obtaining all necessary approvals and consents for the supermarket extension (as required under the S&P).
  - c. Detailed carpark design meeting Council's infrastructure and urban tree design standards—including provision for adequate tree planting and soil volume to meet the Council's Urban Forest Plant target of 20% canopy cover—and being approved by both the Transport Unit and the Urban Forest Manager.
  - d. The developer provide for all additional tree planting required to meet the Council's Tree Replacement policy.

Sam MacDonald/David Cartwright

**Carried**

## 14. Proposed P120 Parking Restrictions - Staveley Street

### Community Board Comment

In response to community feedback, the Community Board incorporated the following changes into the option proposed by staff:

- Parking in four of the existing angled parking spaces will be restricted to a maximum period of 30 minutes between the hours of 8am-8pm.
- Parking in the remainder of the angled parking spaces will be restricted to a maximum period of 120 minutes between the hours of 8am-8pm.
- Staff will monitor the effectiveness of the changes over the next 12 months and report back to the Board.

The Board also requested staff advice on the possibility of installing a mobility parking space.

### Officer Recommendations Ngā Tūtohu

That the Waimāero Fendalton-Waimairi-Harewood Community Board:

1. Receives the information in the Proposed P120 Parking Restrictions - Staveley Street Report.
2. Notes that the decision in this report are assessed as low significance based on the Christchurch City Council's Significance and Engagement Policy.
3. Under Clause 6(2) of the Christchurch City Council Traffic and Parking Bylaw 2017 revokes any previous resolutions pertaining to traffic controls made pursuant to any bylaw to the extent that they are in conflict with the parking or stopping restrictions described in resolutions 0 and 0 below.
4. Approves that, in accordance with Clause 7 of the Christchurch City Council Traffic and Parking Bylaw 2017, a bicycle parking area is resolved on the northern side of Staveley Street, commencing at a point 62 metres east of its intersection with Withells Road and extending in an easterly direction for a distance of three metres as detailed in **Attachment A** (TG151651, Issue 1, dated 25/11/2025).
5. Approves that, in accordance with Clause 7 of the Christchurch City Council Traffic and Parking Bylaw 2017, the parking of vehicles be restricted to a maximum period of 120 minutes, and be further restricted by way of 60 degree angle parking, on the northern side of Staveley Street, commencing at a point 67 metres east of its intersection with Withells Road and extending in an easterly direction for a distance of 39 metres as detailed in **Attachment A** (TG151651, Issue 1, dated 25/11/2025).
6. Approves that these resolutions take effect when parking signage and/or road markings that evidence the restrictions described in this staff report are in place (or removed in the case of revocations).

### Community Board Resolved FWHB/2025/00064

### Part C

That the Waimāero Fendalton-Waimairi-Harewood Community Board:

1. Receives the information in the Proposed P120 Parking Restrictions - Staveley Street Report.

2. Notes that the decision in this report are assessed as low significance based on the Christchurch City Council's Significance and Engagement Policy.
3. Under Clause 6(2) of the Christchurch City Council Traffic and Parking Bylaw 2017 revokes any previous resolutions pertaining to traffic controls made pursuant to any bylaw to the extent that they are in conflict with the parking or stopping restrictions described in resolutions 4 and 5 below.
4. Approves that, in accordance with Clause 7 of the Christchurch City Council Traffic and Parking Bylaw 2017, a bicycle parking area is resolved on the northern side of Staveley Street, commencing at a point 62 metres east of its intersection with Withells Road and extending in an easterly direction for a distance of three metres as detailed in **Attachment A** (TG151651, Issue 1, dated 25/11/2025).
5. Approves that, in accordance with Clause 7 of the Christchurch City Council Traffic and Parking Bylaw 2017, the parking of vehicles be restricted to a maximum period of 30 minutes between the hours of 8am to 8pm for the four car parking spaces at the western end of the parking area, and the remainder of the car parking spaces be restricted to a maximum period of 120 minutes between the hours of 8am to 8pm, and be further restricted by way of 60 degree angle parking, on the northern side of Staveley Street, commencing at a point 67 metres east of its intersection with Withells Road and extending in an easterly direction for a distance of 39 metres as detailed in **Attachment A** (TG151651, Issue 1, dated 25/11/2025, with necessary amendments to reflect the P30 restrictions).
6. Approves that these resolutions take effect when parking signage and/or road markings that evidence the restrictions described in this staff report are in place (or removed in the case of revocations).
7. Requests staff to report back to the Community Board within 12 months on the effectiveness of the changes.
8. Requests advice from staff on installing a mobility parking space to service the Staveley Street shops.

Aaron Keown/Ben Spittle

Carried

## 7. Proposed Road Names - 130 Styx Mill Road and 244 Gardiners Road Community Board Resolved FWHB/2025/00065

**Officer recommendations accepted without change.**

### Part C

That the Waimāero Fendalton-Waimairi-Harewood Community Board:

1. Receives the information in the Proposed Road Names - 130 Styx Mill Road and 244 Gardiners Road Report.
2. Notes that the decision in this report is assessed as low significance based on the Christchurch City Council's Significance and Engagement Policy.
3. Approves the following new lane names for 130 Styx Mill Road (RMA/2022/487)
  - a. Lane 1 - Millhouse Lane
  - b. Lane 2 - Flaxmere Lane
4. Approves the following new road/lane names for 244 Gardiners Road (RMA/2023/2182)
  - a. Road 1 - Donnithorne Road
  - b. Lane 1 - Cinnamon Lane

Lucy Keown/David Cartwright

**Carried**

## 8. Proposed Road Name - 132 Claridges Road, Styx Community Board Resolved FWHB/2025/00066

**Officer recommendations accepted without change.**

### Part C

That the Waimāero Fendalton-Waimairi-Harewood Community Board:

1. Receives the information in the Proposed Road Name - 132 Claridges Road, Styx Report.
2. Notes that the decision in this report is assessed as low significance based on the Christchurch City Council's Significance and Engagement Policy.
3. Approves the following new lane name for 132 Claridges Road (RMA/2025/694)
  - a. Lane 1 - Claridgewood Lane

Bridget Williams/Nicola McCormick

**Carried**

## 10. Community Parks Rolling Renewal Programme

### Community Board Comment

The Community Board asked if there is any opportunity to bring forward the renewal of the Elmwood Park play space. Staff undertook to consider this and provide advice during the next six months.

### Community Board Resolved FWHB/2025/00067

**Officer recommendations accepted without change.**

### Part C

That the Waimāero Fendalton-Waimairi-Harewood Community Board:

1. Receives the information in the Community Parks Rolling Renewal Programme Report.
2. Notes that the decision in this report is assessed as low significance based on the Christchurch City Council's Significance and Engagement Policy.
3. Approves the Waimaero Fendalton-Waimairi-Harewood Community Boards Community Parks Rolling Renewal Programme (Attachment A).

David Cartwright/Lucy Keown

**Carried**

## 11. Dedication of Local Purpose Reserve (Road) 3 R Tulett Park Drive Casebrook

### Community Board Decided FWHB/2025/00068

**Officer recommendations accepted without change.**

### Part A

That the Waimāero Fendalton-Waimairi-Harewood Community Board recommends that the Council:

1. Receives the information in the Dedication of Local Purpose Reserve (Road) 3 R Tulett Park Drive Casebrook Report.
2. Notes that the decision in this report is assessed as low significance based on the Christchurch City Council's Significance and Engagement Policy.
3. Resolves pursuant to Section 111 of the Reserves Act 1977 to dedicate the Local Purpose Reserve (Road) containing 203m<sup>2</sup> described as 3R Tulett Park Drive Lot 160 DP 499649 Certificate of Title 768569 as road.
4. Authorises the Manager Property Consultancy to take all steps necessary to complete all necessary documentation to conclude the dedication of Lot 160 DP 499649 Certificate of Title 768569 as road.

Aaron Keown/David Cartwright

**Carried**



## 12. Athol Terrace - Proposed No Stopping Restrictions

Community Board Resolved FWHB/2025/00069

Officer recommendations accepted without change.

### Part C

That the Waimāero Fendalton-Waimairi-Harewood Community Board:

1. Receives the information in the Athol Terrace - Proposed No Stopping Restrictions Report.
2. Notes that the decision in this report are assessed as low significance based on the Christchurch City Council's Significance and Engagement Policy.
3. In accordance with Clause 6(2) of the Christchurch City Council Traffic and Parking Bylaw 2017 revokes any previous resolutions pertaining to traffic controls made pursuant to any bylaw to the extent that they are in conflict with the parking or stopping restrictions described in resolutions 4 – 7 below.
4. Approves that in accordance with Clause 7 of the Christchurch City Council Traffic and Parking Bylaw 2017 that the parking of vehicles be restricted to a maximum period of 15 minutes, on the south western side of Athol Terrace, commencing at a point 33 metres north west of its intersection with Peer Street and extending in a north westerly direction for a distance of 54 metres, as detailed on Attachment A to this report on the meeting agenda (Plan TG149452 Issue 1 dated 18/11/25). This restriction is to apply 8am-6pm, 7 days.
5. Approves that in accordance with Clause 7 of the Christchurch City Council Traffic and Parking Bylaw 2017, that the stopping of vehicles be prohibited at any time on the south western side of Athol Terrace, commencing at a point 87 metres north west of its intersection with Peer Street and extending in a north westerly direction for a distance of 23 metres, as detailed on Attachment A to the report on the meeting agenda (Plan TG149452 Issue 1 dated 18/11/25).
6. Approves that in accordance with Clause 7 of the Christchurch City Council Traffic and Parking Bylaw 2017, that the stopping of vehicles be prohibited at any time on the south western side of Athol Terrace, commencing at a point 119 metres north west of its intersection with Peer Street and extending in a north westerly direction for a distance of 9 metres, as detailed on Attachment A to the report on the meeting agenda (Plan TG149452 Issue 1 dated 18/11/25).
7. Approves that in accordance with Clause 7 of the Christchurch City Council Traffic and Parking Bylaw 2017 that the parking of vehicles be restricted to a maximum period of 15 minutes, on the south western side of Athol Terrace, commencing at a point 39 metres south east of its intersection with Brodie Street and extending in a south easterly direction for a distance of 39 metres, as detailed on Attachment A to the report on the meeting agenda (Plan TG149452 Issue 1 dated 18/11/25). This restriction is to apply 8am-6pm, 7 days.
8. Approves that these resolutions take effect when parking signage and/or road markings that evidence the restrictions described in this staff report are in place (or removed in the case of revocations).

Sam MacDonald/Aaron Keown

**Carried**

### 13. Clyde Road Parking Restrictions

**Community Board Resolved FWHB/2025/00070**

**Officer recommendations accepted without change.**

#### Part C

That the Waimāero Fendalton-Waimairi-Harewood Community Board:

1. Receives the information in the Clyde Road Parking Restrictions Report.
2. Notes that the decision in this report are assessed as low significance based on the Christchurch City Council's Significance and Engagement Policy.
3. Revokes any previous resolutions pertaining to traffic controls made pursuant to any bylaw to the extent that they are in conflict with the parking or stopping restrictions described in resolutions 4 below.
4. Approves that **the parking of all vehicles be restricted to a maximum period of 3 minutes**, in accordance with Clause 8 of the Christchurch City Council Traffic & Parking Bylaw 2017, on the east side of Clyde Road commencing at a point 211 metres north of its intersection with Fendalton Road and extending in a northerly direction for a distance of 45 metres as detailed in **Attachment A** (TG151649, Issue 1, dated 01/09/2025). This is to apply between **8:30am – 9:30am and 2:30pm – 3:30pm on School Days Only**.
5. Approves that these resolutions take effect when parking signage and/or road markings that evidence the restrictions described in this staff report are in place.

David Cartwright/Bridget Williams

**Carried**

### 15. Waimāero Fendalton-Waimairi-Harewood - Better-Off Fund Applications for Consideration - Anglican Diocese of Christchurch - Parish of Merivale St Albans; Riccarton Sports Hub Trust

**Community Board Resolved FWHB/2025/00071**

**Officer recommendations accepted without change.**

#### Part C

That the Waimāero Fendalton-Waimairi-Harewood Community Board:

1. Receives the information in the Waimāero Fendalton-Waimairi-Harewood - Better-Off Fund Applications for Consideration - Anglican Diocese of Christchurch - Parish of Merivale St Albans; Riccarton Sports Hub Trust Report.
2. Notes that the decisions in this report are assessed as low significance based on the Christchurch City Council's Significance and Engagement Policy.
3. Approves a grant of \$38,000 from its Better-Off Fund to the Anglican Diocese of Christchurch - Parish of Merivale St Albans towards the purchase of a community van for use by groups in the Waimāero Fendalton-Waimairi-Harewood Community Board area.

4. Approves a grant of \$12,000 from its Better-Off Fund to the Riccarton Sports Hub Trust towards expenses towards technical services required for the facility upgrade at the Upper Riccarton Domain.

Nicola McCormick/Ben Spittle

**Carried**

**16. Fendalton-Waimairi-Harewood 2025-2026 Discretionary Response Fund Applications - Burnside Squash Rackets Club Incorporated, St Margaret's Church, Yaldhurst School, Anglican Diocese of Christchurch Parish of Burnside Harewood, Kiribati Federation Aotearoa Incorporated**  
**Community Board Resolved FWHB/2025/00072**

**Officer recommendations accepted without change.**

**Part C**

That the Waimāero Fendalton-Waimairi-Harewood Community Board:

1. Receives the information in the report: Fendalton-Waimairi-Harewood 2025-2026 Discretionary Response Fund Applications - Burnside Squash Rackets Club Incorporated, St Margaret's Church, Yaldhurst School, Anglican Diocese of Christchurch Parish of Burnside Harewood, Kiribati Federation Aotearoa Incorporated.
2. Notes that the decisions in this report are assessed as low significance based on the Christchurch City Council's Significance and Engagement Policy.
3. Approves a grant of \$12,000 from its 2025/26 Discretionary Response Fund to Burnside Squash Rackets Club Incorporated towards replacement of their squash court flooring.
4. Approves a grant of \$5,000 from its 2025/26 Discretionary Response Fund to St Margaret's Presbyterian Church (Bishopdale) towards the purchase and installation of heat pumps for the community hall.
5. Approves a grant of \$4,526 from its 2025/26 Discretionary Response Fund to Yaldhurst School Tōtara Tūkaha towards costs associated with the installation of a swipe card system for the pool to allow safe community access.
6. Approves a grant of \$2,900 from its 2025/26 Discretionary Response Fund to the Anglican Diocese of Christchurch Parish of Burnside Harewood towards Kia Ora Burnside - Connect@Kendal.
7. Approves a grant of \$1,500 from its 2025/26 Discretionary Response Fund to Kiribati Federation Aotearoa Incorporated towards the Saturday Night Sport Project.

Aaron Keown/Lucy Keown

**Carried**

## 17. Governance Matters

### Community Board Resolved FWHB/2025/00073

**Officer recommendations accepted without change.**

#### Part C

That the Waimāero Fendalton-Waimairi-Harewood Community Board:

1. Receives the information in the Governance Matters Report.
2. Notes that the decision in this report is assessed as low significance based on the Christchurch City Council's Significance and Engagement Policy.
3. Adopts the following schedule of Ordinary Meetings in for the 2025-28 term:

Date	Time	Location
16 February 2026	4.30 pm	Boardroom, Fendalton Library and Service Centre
16 March 2026	4.30 pm	Boardroom, Fendalton Library and Service Centre
20 April 2026	4.30 pm	Boardroom, Fendalton Library and Service Centre
18 May 2026	4.30 pm	Boardroom, Fendalton Library and Service Centre
22 June 2026	4.30 pm	Boardroom, Fendalton Library and Service Centre
20 July 2026	4.30 pm	Boardroom, Fendalton Library and Service Centre
17 August 2026	4.30 pm	Boardroom, Fendalton Library and Service Centre
21 September 2026	4.30 pm	Boardroom, Fendalton Library and Service Centre
19 October 2026	4.30 pm	Boardroom, Fendalton Library and Service Centre
16 November 2026	4.30 pm	Boardroom, Fendalton Library and Service Centre
7 December 2026	4.30 pm	Boardroom, Fendalton Library and Service Centre
15 February 2027	4.30 pm	Boardroom, Fendalton Library and Service Centre
15 March 2027	4.30 pm	Boardroom, Fendalton Library and Service Centre
19 April 2027	4.30 pm	Boardroom, Fendalton Library and Service Centre
17 May 2027	4.30 pm	Boardroom, Fendalton Library and Service Centre
21 June 2027	4.30 pm	Boardroom, Fendalton Library and Service Centre

19 July 2027	4.30 pm	Boardroom, Fendalton Library and Service Centre
16 August 2027	4.30 pm	Boardroom, Fendalton Library and Service Centre
20 September 2027	4.30 pm	Boardroom, Fendalton Library and Service Centre
18 October 2027	4.30 pm	Boardroom, Fendalton Library and Service Centre
15 November 2027	4.30 pm	Boardroom, Fendalton Library and Service Centre
6 December 2027	4.30 pm	Boardroom, Fendalton Library and Service Centre
21 February 2028	4.30 pm	Boardroom, Fendalton Library and Service Centre
20 March 2028	4.30 pm	Boardroom, Fendalton Library and Service Centre
18 April 2028	4.30 pm	Boardroom, Fendalton Library and Service Centre
15 May 2028	4.30 pm	Boardroom, Fendalton Library and Service Centre
19 June 2028	4.30 pm	Boardroom, Fendalton Library and Service Centre
17 July 2028	4.30 pm	Boardroom, Fendalton Library and Service Centre
21 August 2028	4.30 pm	Boardroom, Fendalton Library and Service Centre
18 September 2028	4.30 pm	Boardroom, Fendalton Library and Service Centre

4. Authorises the Community Governance Manager, in consultation with the Community Board Chairperson, to amend the meeting schedule as required including adding or removing ordinary meetings.
5. Agrees that Board Information Sharing Sessions/Workshops will take place on an as-required basis, typically on the first Monday of each month or following ordinary Board meetings.
6. Agrees to hold meetings with local School Principals twice a year, with the schedule to be confirmed by the Community Governance Manager.
7. Establishes a Waimāero Fendalton-Waimairi-Harewood Community Board Submissions Committee for the duration of the 2025-28 electoral term as follows:
  - a. Term of Reference being to respond to submission opportunities on behalf of the Waimāero Fendalton-Waimairi-Harewood Community Board as they arise.
  - b. James Gough, Lucy Keown, Nicola McCormick, Jason Middlemiss, Ben Spittle and Bridget Williams are appointed as members of the Submissions Committee.
  - c. Ben Spittle is appointed Committee Chairperson and Lucy Keown is appointed Deputy Chairperson of the Submissions Committee.
  - d. The quorum of the Submissions Committee is three members.

- e. The Submissions Committee is granted delegated authority to lodge submissions on behalf of the Waimāero Fendalton-Waimairi-Harewood Community Board.
  - f. Any submissions made by the Submissions Committee will be reported to the Waimāero Fendalton-Waimairi-Harewood Community Board for record keeping purposes.
  - g. The Community Governance Manager and Submissions Committee Chairperson are authorised to convene meetings of the Submissions Committee.
  - h. The Chairperson of the Submissions Committee, in consultation with the remaining Committee members, is delegated the authority to make submissions on behalf of the Community Board without calling a Submissions Committee meeting when responding to minor, uncontroversial submission opportunities. If the Committee Chairperson is unavailable, this delegation may be exercised by the Community Board Chairperson.
- 8. Appoints a Recess Committee, with all Fendalton-Waimairi-Harewood Community Board members being members of the Committee, with a quorum of two. The Community Board Chairperson and Deputy Chairperson will also be Chairperson and Deputy Chairperson of the Recess Committee, except if neither is available the Committee will elect a Chairperson for that meeting.
  - 9. Authorises the Recess Committee to exercise the delegated powers of the Waimāero Fendalton-Waimairi-Harewood Community Board for the period between its final ordinary meeting of each calendar year up until the date of the Board's first ordinary meeting the following calendar year, to enable decision-making over any urgent business that is unable to wait until ordinary meetings commence.
  - 10. Notes that any such delegation exercised by the Board's Recess Committee will be reported to the Board for record purposes.
  - 11. Notes that any meeting convened of the Recess Committee will be publicly notified and the details forwarded to all Board members.
  - 12. Appoints Nicola McCormick as the Board's representative to the Riccarton Bush Trust.
  - 13. Appoints Nicola McCormick and Lucy Keown as the Board's representatives to the Airport Noise Liaison Committee.
  - 14. Appoints Bridget Williams and Lucy Keown as the Board's representatives to the Keep Christchurch Beautiful Committee.
  - 15. Appoints David Cartwright as the Board's representative to the McLean Institute for 12 Months, then Ben Spittle for the remainder of the term.
  - 16. Appoints Jason Middlemiss as the Board's representative on the Waimakariri-Eyre-Cust River Rating District Liaison Committee.

Bridget Williams/Jason Middlemiss

**Carried**

## 18. Waimāero Fendalton-Waimairi-Harewood Community Board Area Report - December 2025

Community Board Resolved FWHB/2025/00074

Officer recommendations accepted without change.

### Part B

That the Waimāero Fendalton-Waimairi-Harewood Community Board:

1. Receives the information in the Waimāero Fendalton-Waimairi-Harewood Community Board Area Report - December 2025.

David Cartwright/Ben Spittle

Carried

## 19. Elected Members' Information Exchange Te Whakawhiti Whakaaro o Te Kāhui Amorangi

### Part B

Members exchanged information on matters of interest to the Community Board.

### Karakia Whakamutunga

Meeting concluded at 5.53 pm.

CONFIRMED THIS 16<sup>TH</sup> DAY OF FEBRUARY 2026

JASON MIDDLEMISS  
CHAIRPERSON





## 7. Tree Planting Plan for Yaldhurst Bush

Reference Te Tohutoro: 25/1270615

Responsible Officer(s) Te Pou Matua: Toby Chapman (Urban Forest Manager)

Accountable ELT Member Pouwhakarae: Andrew Rutledge, General Manager Citizens and Community

### 1. Purpose and Origin of the Report Te Pūtake Pūrongo

- 1.1 The purpose of this report is to seek approval for the planting of new trees within Yaldhurst Bush using the attached tree planting plan.
- 1.2 The report is in response to the adoption of the Urban Forest Plan which seeks to increase canopy cover across the city by 40% and to establish a network of native forest patches across the city.

### 2. Officer Recommendations Ngā Tūtohu

That the Waimāero Fendalton-Waimairi-Harewood Community Board:

1. Receives the information in the Tree Planting Plan for Yaldhurst Bush Report.
2. Notes that the decision in this report is assessed as low significance based on the Christchurch City Council's Significance and Engagement Policy.
3. Approves the planting of trees within Yaldhurst Bush in alignment with the planting plans labelled as attachments A and B to the report in the agenda.

### 3. Executive Summary Te Whakarāpopoto Matua

- 3.1 The Urban Forest Plan was adopted in 2023 and includes objective to increase canopy cover within our parks from 23% to 40% by 2070, establish a network of native forest patches to support viable populations of native wildlife across the city, and provide accessible areas of urban wilderness/nature. To meet this objective, Council has implemented an Urban Forest Tree Planting program which requires trees to be planted by 2040 so they grow large enough to meet the canopy cover target by 2070.
- 3.2 As part of the Urban Forest Tree Planting program, staff have developed a plan to plant new trees in Yaldhurst Bush (**Refer to Attachments A and B**).

### 4. Background/Context Te Horopaki

- 4.1 As part of the Urban Forest Plan, we have also prepared a draft Native Forest Patch Network Plan for the Waimāero Fendalton-Waimairi-Harewood Community Board area (**Attachment C**) to create a strategic network of native forests across the city. This is still a working/draft document but provides helpful context.
- 4.2 This network of native forest patches aims to support viable populations of native bush birds and other wildlife, enhance ecosystem connectivity, and provide accessible natural areas

- aligning with the city's Biodiversity Strategy and Open Space Strategy. We hope it will also encourage community engagement in biodiversity conservation and foster a deeper understanding of ecological needs.
- 4.3 Many of the native forest plantings established in Ōtautahi - Christchurch have been relatively small compared to the few large blocks that have begun to be established since the early 2000s. As well as not supporting viable populations of wildlife in their own right, small plantings inevitably suffer from 'edge effects' like wind, heat, noise, weeds, pest animals, and artificial light. Some of these edge effects penetrate further than 50 metres inside habitats.
  - 4.4 Our Native Forest Patch Network Plan envisions more than 130 native forest patches averaging around six hectares each. 42 of these will be larger patches (>6.25 ha) that will provide core wildlife breeding habitat, and 93 will be smaller patches (1.50 ha – 6.25 ha) that act as food sources and stepping stones for wildlife.
  - 4.5 Around two-thirds of these patches, like Yaldhurst, simply build on existing native forest plantings in parks and stormwater sites. This approach serves to maintain the general character of our public spaces, whilst allowing the plantings to be extended and enriched to provide more optimum habitat and wilderness experiences.
  - 4.6 Native forest and woodland planting began at Yaldhurst Bush in the mid-1990s to create a 'living museum' that recreated vegetation that would have occurred on the Canterbury Plains prior to the arrival of Europeans. Restoration was supported by the community, including Yaldhurst Primary School children who have had a long association with the park.
  - 4.7 In 1998, Yaldhurst Bush was adopted as a 'Native Trees Please!' project - one of 30 significant 'Turning Point 2000' projects to celebrate and commemorate the year 2000 in Ōtautahi-Christchurch and Canterbury.
  - 4.8 This project was based on the concept of re-establishing representative native Aotearoa-New Zealand plant species that existed originally on the various floodplain surfaces throughout Ōtautahi-Christchurch. At the time, each of the city's six community board areas were to establish one native tree grove that focussed on one dominant tree species and appropriate companion planting. The wider project aimed to provide valuable educational resources for schools as well as developing Christchurch's landscape heritage for present and future generations.
  - 4.9 Yaldhurst Bush was favoured for native plantings in the former Fendalton-Waimairi Community Board area, as the site and soil type had its own distinct characteristics that were quite different from the northern, eastern and southern areas of the city. While the conditions were relatively harsh, it was believed that with good preparation and after care, it would be possible to establish a range of plants typical of those that originally grew on these soil types. Species suggested for the site included ti kouka/cabbage tree, kohuhu, kowhai, kanuka, kiokio, olearia and coprosma species.
  - 4.10 The project emphasised that the primary aim was not to establish an attractive 'garden setting' (although it was thought that this may well occur eventually) but rather to develop a 'living museum' of plant life and associated ecosystems that commemorated the past for the benefit of the present and future generations.
  - 4.11 Plantings now cover approximately 3.7 hectares (60%) of the reserve, and unplanted areas are currently maintained as mown grass and are used informally for passive recreation.
  - 4.12 An ecological restoration plan (**Attachment B**) has been prepared for Yaldhurst Bush, and this has informed the planting plan (**Attachment A**) that has been developed for the site as part of the Urban Forest Tree Planting program. Together with the draft Native Forest Patch Network

plan, the emphasis is on not only increasing canopy cover within the reserve and the wider area, but also supporting the city-wide native forest patch network (**Refer Attachments C**).

- 4.13 Yaldhurst Bush is located in a low canopy area making planting in these areas a priority for Council and the Urban Forest Plan.
- 4.14 The planting plan proposes to increase the cover from 25,600m<sup>2</sup> to 27,600 m<sup>2</sup> which will increase the canopy cover in Yaldhurst Bush from 42% to 89% at maturity.
- 4.15 The images below show the proposal for the planting and what modelling estimates it to look like once the trees have reached maturity:



Image one: Aerial view of the existing bush



Image two: Aerial view of the bush with the proposed new trees included at maturity





Image three: Aerial view showing placement of new trees

- 4.1 Staff and/or contractors will maintain plantings for the first 36 months - ensuring their establishment - before being handed over to Council's operational maintenance teams who will manage the site under a 'natural areas' maintenance regime. This will predominantly focus on weed control - including pest plants. Other ongoing management activities are discussed in the Yaldhurst Bush Ecological Restoration Plan, and may include:
- Any ongoing monitoring of lizard population as required by Lizard Management Plans.
  - Control of woody weeds and vines throughout planted areas (E.g., grey willow, sycamore, Chilean mayten, cherry, North Island lacebark, old man's beard, ivy).
  - Removal and disposal off-site - or re-use - of plant guards.
  - Control of grass and herbaceous weeds around the periphery of the forest areas, and particularly along pathways for aesthetic reasons.
  - Periodic removal and disposal off-site of rubbish and debris.
  - Stripping and of dead cabbage tree leaves from trees alongside paths to reduce risk of arson.
  - Once habitat is established and supporting wildlife populations (including lizards), mammalian predator control can be carried out as part of Council's Parks Operational Pest Animal Management Plan (longer term)
- 4.2 The plan has been developed using a recession plane to help reduce shading impact. While we cannot avoid shading all together, this model does assist in ensuring it is managed to the same extent as would occur if a resident's neighbour was constructing a new building.
- 4.3 While the [Kōrero Mai webpage](#) was viewed 61 times no submissions were received.
- 4.4 The following reasonably practicable options were considered and are assessed in this report:
- 4.4.1 Approve the Yaldhurst Bush planting plan and implementation.
  - 4.4.2 Decline the Yaldhurst Bush Planting Plan.

### Options Descriptions Ngā Kōwhiringa

4.5 **Preferred Option:** Approve the Yaldhurst Bush planting plan and implementation.

4.5.1 **Option Description:** Approve the plan in its current form.

4.5.2 Option Advantages

- Supports the Urban Forest Plan objectives and targets by increasing canopy cover in Yaldhurst Bush to 89% once trees reach maturity.
- Supports the Urban Forest Plan target to increase canopy cover in rural areas to 15%.

4.5.3 Option Disadvantages

- Some may see the planting of trees presents a loss of open space.

4.6 Decline the Yaldhurst Bush Planting Plan.

4.6.1 **Option Description:** Decline the plan and require no trees to be planted.

4.6.2 Option Advantages

- Open space within the bush would be retained.
- Council would save costs that are associated with the planting.

4.6.3 Option Disadvantages

- The local area will be deprived of the benefits that trees provide.

### Analysis Criteria Ngā Paearu Wetekina

4.7 Alignment with the Urban Forest Plan.

## 5. Financial Implications Ngā Hīraunga Rauemi

### Capex/Opex Ngā Utu Whakahaere

	Recommended Option	Option 2 – Decline plan
Cost to Implement	\$200,000	\$0
Maintenance/Ongoing Costs	Included in implementation costs	Not Applicable
Funding Source	Urban Forest Implementation capital budget	Not Applicable
Funding Availability	Yes	Not Applicable
Impact on Rates	Nil	Not Applicable

5.1 This planting will be funded through the Urban Forest Tree Planting program which is currently funded through the Better Off Fund.

## 6. Considerations Ngā Whai Whakaaro

### Risks and Mitigations Ngā Mōrearea me ngā Whakamātautau

6.1 The availability of trees can be challenging. If not all trees and plants are available, staff will push planting out to 2027-28.

### Legal Considerations Ngā Hīraunga ā-Ture

6.2 Statutory and/or delegated authority to undertake proposals in the report:

- 6.2.1 Under the Reserves Act, Community Boards have the delegation to “determine to plant, maintain and remove trees on reserves within the policy set by the Council”.

6.3 Other Legal Implications:

- 6.3.1 There is no legal context, issue, or implication relevant to this decision.

**Strategy and Policy Considerations Te Whai Kaupapa here**

6.4 The required decision:

- 6.4.1 Aligns with the [Christchurch City Council’s Strategic Framework](#) with a particular focus on a green, liveable city.
- 6.4.2 Is assessed as low significance based on the Christchurch City Council’s Significance and Engagement Policy. The level of significance was determined by assessing the impact the decision will have on the city which is low.
- 6.4.3 Is consistent with Council’s Plans and Policies. The planting plan forms a key component of the implementation of the Councils Urban Forest Plan.

6.5 This report supports the [Council's Long Term Plan \(2024 - 2034\)](#):

6.6 Parks, Heritage and Coastal Environment

6.6.1 Activity: Parks and Foreshore

- Level of Service: 6.8.2.1 Increasing tree canopy in Parks - A net increase in total number of trees is achieved (1:2 replacement policy), with a minimum of 50% of the trees being medium to very large species.

**Community Impacts and Views Ngā Mariu ā-Hāpori**

- 6.7 Consultation started on the 8 May and ran until 26 May 2025.
- 6.8 An email was sent to 13 key stakeholders. An email was also sent to 79 subscribers.
- 6.9 The [Kōrero Mai webpage](#) was viewed 61 times throughout the consultation period.
- 6.10 No submissions were received during the consultation period.

**Impact on Mana Whenua Ngā Whai Take Mana Whenua**

- 6.11 The decision does not involve a significant decision in relation to ancestral land, a body of water or other elements of intrinsic value, therefore this decision does not specifically impact Mana Whenua, their culture, and traditions.
- 6.12 The planting is in alignment with the Councils Urban Forest Plan which sought feedback from Mana Whenua and is in alignment with the Iwi Management Plan.
- 6.13 The decision does not involve a matter of interest to Mana Whenua and will not impact on our agreed partnership priorities with Ngā Papatipu Rūnanga.



**Climate Change Impact Considerations Ngā Whai Whakaaro mā te Āhuarangi**

- 6.14 The decisions in this report are likely to:
- 6.14.1 Contribute positively to adaptation to the impacts of climate change.
- 6.14.2 Contribute positively to emissions reductions.
- 6.15 Tree planting will assist Council in offsetting its emissions and coping with the impacts of climate change.

7. Next Steps Ngā Mahinga ā-muri

- 7.1 Once the plan has been approved, staff will proceed with sourcing trees and schedule the reserves for planting.

Attachments Ngā Tāpirihanga

No.	Title	Reference	Page
A 	Yaldhurst Bush Tree Planting Plan 2025 <i>(Under Separate Cover)</i>	25/1270771	
B 	Yaldhurst Bush Ecological Restoration Plan 2025 <i>(Under Separate Cover)</i>	25/793384	
C 	Draft Native Forest Patch Network Plan - Fendalton Waimairi Harewood <i>(Under Separate Cover)</i>	26/136689	

In addition to the attached documents, the following background information is available:

Document Name - Location / File Link
Not applicable

Signatories Ngā Kaiwaitohu

Authors	Toby Chapman - Manager Urban Forest Antony Shadbolt - Team Leader Biodiversity
Approved By	Rupert Bool - Head of Parks





## 8. Urban Forest Tree Planting for Parkham, Waterford, Glenturret, Grayshott, Englefield, Darroch, Grant Armstrong, Derwent Lassiter and Greendale Reserves

Reference Te Tohutoro: 25/2427996

Responsible Officer(s) Te Pou Matua: Toby Chapman (Urban Forest Manager)

Accountable ELT Member Pouwhakarae: Andrew Rutledge, General Manager Citizens and Community

### 1. Purpose and Origin of the Report Te Pūtake Pūrongo

- 1.1 The purpose of this report is to seek approval for the planting of new trees within Parkham, Waterford, Glenturret, Grayshott, Englefield, Darroch, Grant Armstrong, Derwent, Lassiter and Greendale Reserves.
- 1.2 The report is in response to the adoption of the Urban Forest Plan which seeks to increase canopy cover across the city.
- 1.3 The decisions in this report are of low significance in relation to the [Christchurch City Council's Significance and Engagement Policy 2019](#). The level of significance was determined by the low number of people affected and the low level of impact.

### 2. Officer Recommendations Ngā Tūtohu

That the Waimāero Fendalton-Waimairi-Harewood Community Board:

1. Receives the information in the Urban Forest Tree Planting for Parkham, Waterford, Glenturret, Grayshott, Englefield, Darroch, Grant Armstrong, Derwent Lassiter and Greendale Reserves
2. Notes that the decision in this report is assessed as low significance based on the Christchurch City Council's Significance and Engagement Policy.
3. Approves the Urban Forest Tree Planting plans for Parkham, Waterford, Glenturret, Grayshott, Englefield, Darroch, Grant Armstrong, Derwent Lassiter and Greendale Reserves as set out in the report in the agenda.

### 3. Executive Summary Te Whakarāpopoto Matua

- 3.1 The Urban Forest Plan was adopted in 2023 and includes an objective of increasing canopy cover within our parks from 23% to 40% by 2040. To meet this objective, Council has implemented an Urban Forest Tree Planting program.
- 3.2 As part of the Urban Forest Tree Planting program, staff have developed a plan to plant new trees in Parkham Reserve, Waterford Reserve, Glenturret and Grayshott Park, Englefield Reserve, Darroch Reserve, Grant Armstrong Park, Derwent Reserve, Lassiter Reserve and Greendale Reserve.
- 3.3 All plantings will follow our general guidelines for planting including the use of recession planes to assist in determining the size and location of trees.

4. Background/Context Te Horopaki

- 4.1 Planting plans were developed for all of the parks and reserves as part of the Urban Forest Tree Planting Program with an emphasis on increasing canopy cover both within the reserve and within the wider area.
- 4.2 Six of the parks are located within the Harewood ward (Darroch, Englefield, Glenturret and Greyshott, Lassiter and Waterford), one is in the Fendalton ward (Derwent) and two are in the Waimairi Ward (Parkham and Derwent).
- 4.3 If the plans are approved they will result in a total of 385 new specimen trees within the Community Board area.
- 4.4 Two of the areas that have been consulted on are also being considered for further storm water management. Staff will work closely with the Council’s three waters team to coordinate the planting in Darroch reserve and Glenturret and Grayshott parks.
- 4.5 In general the feedback for the planting has been positive with most in favour of the planting. Based on the feedback received staff are not recommending any changes to the plans as they have been consulted.
- 4.6 Staff will use the feedback to inform species selection including a greater number of native trees in selected parks and investigating whether sites will be appropriate for fruit trees.
- 4.7 Staff will also engage with the local schools to see if they would be interested in assisting with the planting.
- 4.8 The Images below provide an overview of each of the parks and the proposed planting locations.

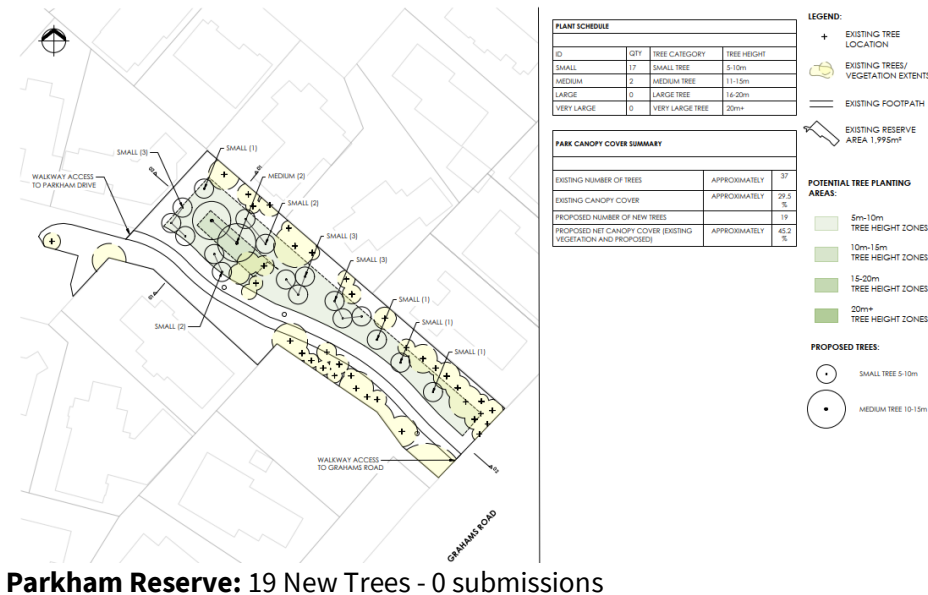

### Waterford Reserve – 30 New Trees – 1 submission



## Glenturret and Grayshott Parks - 108 New Trees – 2 Submissions



Englefield Reserve - 46 New Trees – 3 Submissions

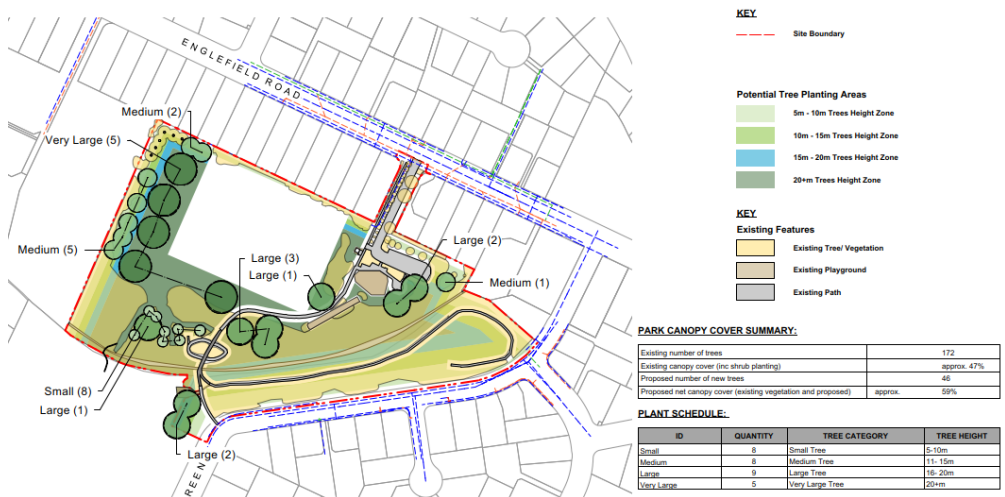

Darroch Reserve - 60 New Trees – 0 Submissions





Derwent Reserve – 12 New Trees – 0 Submissions



Lassiter Reserve – 6 New Trees – 0 Submissions



Greendale Park- 16 New Trees - 4 Responses

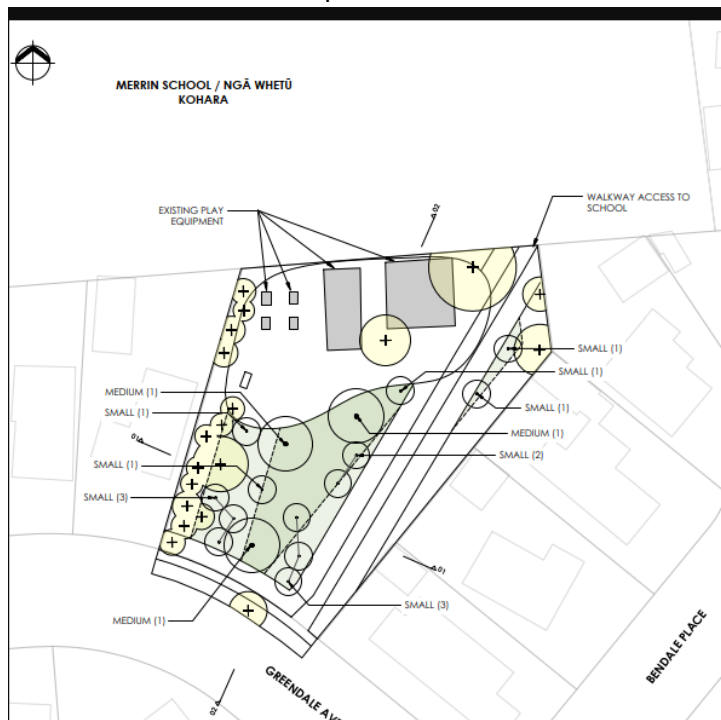

The table below provides a summary of the results from each park:

Park Name	Summary of Planting	Summary of feedback
Parkham Reserve	<ul style="list-style-type: none"> <li>17 Small trees</li> <li>2 Medium Tree</li> <li>Future canopy cover 45%</li> </ul>	No Submissions
Waterford	<ul style="list-style-type: none"> <li>21 Small Trees</li> <li>9 Medium trees</li> </ul>	1 Submission raised concerns about the existing trees and are worried that more trees will exacerbate issues such as leaf litter and damage to footpaths.
Glenturret and Grayshott parks	<ul style="list-style-type: none"> <li>64 Small trees</li> <li>27 Medium trees</li> <li>8 Large trees</li> <li>9 Very large trees</li> </ul>	2 Submissions, once expressed a desire to see a variety of species both evergreen and deciduous, the other wanted to ensure that space remained for operational tasks such as dredging was not hindered.
Englefield	<ul style="list-style-type: none"> <li>8 Small trees</li> <li>8 Medium trees</li> <li>9 Large trees</li> <li>5 Very large trees</li> </ul>	3 Submissions were received that highlighted a need for good aftercare, avoid willow mulch, retain existing walnut tree, plant native trees.
Darroch Reserve	<ul style="list-style-type: none"> <li>3 Medium trees</li> <li>52 Large trees</li> <li>5 Very large trees</li> </ul>	0 submissions were received

Grant Armstrong Reserve	<ul style="list-style-type: none"> <li>• 64 Small trees</li> <li>• 13 Medium trees</li> <li>• 7 Large trees</li> <li>• 4 Very large trees</li> </ul>	3 Submissions were received that highlighted a desire for more natives, consideration for fruit trees, engagement with the local school for planting and one submitter would like the park left as it is.
Derwent Reserve	<ul style="list-style-type: none"> <li>• 8 Small trees</li> <li>• 4 Medium trees</li> </ul>	0 Submissions
Lassiter Reserve	<ul style="list-style-type: none"> <li>• 3 Small trees</li> <li>• 3 Medium trees</li> </ul>	0 Submissions received
Greendale Reserve	<ul style="list-style-type: none"> <li>• 13 Small trees</li> <li>• 3 Medium trees</li> </ul>	4 Submissions were received that highlighted a desire to plant fruit trees and to work with the local school, ensure that the parks pathways remain wide enough and also protect the open space in the park.

### Options Considered Ngā Kōwhiringa Whaiwhakaaro

4.9 The following reasonably practicable options were considered and are assessed in this report:

4.9.1 Approve the planting as per the Consulted plans.

4.9.2 Decline the planting plans.

4.10 The following options were considered but ruled out:

4.10.1 Alter the plans and reconsult – Based on the largely positive feedback for these plans, staff do not feel this is necessary.

4.10.2 Do not approve the two parks that are being considered for three water projects – Staff will be able to work directly with the Three Waters team without having to come back for separate approval.

### Options Descriptions Ngā Kōwhiringa

4.11 **Preferred Option:** Approve the proposed plans.

4.11.1 **Option Description:** Approve the plans in their current form.

4.11.2 Option Advantages

- More trees will be planted within our parks.

4.11.3 Option Disadvantages

- Some of the tree planting may present a loss of open space.

4.12 Decline the planting plans.

4.12.1 **Option Description:** Decline the plans and require no trees to be planted.

4.12.2 Option Advantages

- Some open space would be retained.

4.12.3 Option Disadvantages

- No new trees would be added to the parks.

### Analysis Criteria Ngā Paearu Wetekina

4.13 Increase in canopy for the city.

4.14 Feedback from the consultation.

## 5. Financial Implications Ngā Hīraunga Rauemi

### Capex/Opex Ngā Utu Whakahaere

	Recommended Option	Option 2 – Decline Planting
Cost to Implement	\$200,000 (including 7 years maintenance)	\$0
Maintenance/Ongoing Costs	\$0	Not Applicable
Funding Source	Urban Forest Capital Fund	Not Applicable
Funding Availability	yes	Not Applicable
Impact on Rates	nil	Not Applicable

## 6. Considerations Ngā Whai Whakaaro

### Risks and Mitigations Ngā Mōrearea me ngā Whakamātautau

6.1 The availability of trees can be challenging. If not all trees and plants are available, staff will push planting out to 2027.

### Legal Considerations Ngā Hīraunga ā-Ture

6.2 Statutory and/or delegated authority to undertake proposals in the report:

6.2.1 Under the Reserves Act, Community Boards have the delegation to “determine to plant, maintain and remove trees on reserves within the policy set by the Council”

6.3 Other Legal Implications:

6.3.1 There is no legal context, issue, or implication relevant to this decision.

### Strategy and Policy Considerations Te Whai Kaupapa here

6.4 The required decision:

6.4.1 Aligns with the [Christchurch City Council’s Strategic Framework](#) with a particular focus on a green, liveable city.

6.4.2 Is assessed as low significance based on the Christchurch City Council’s Significance and Engagement Policy. The level of significance was determined by assessing the impact the decision will have on the city which is low.

6.4.3 Is consistent with Council’s Plans and Policies. The planting plan forms a key component of the implementation of the Councils Urban Forest Plan.

6.5 This report supports the [Council's Long Term Plan \(2024 - 2034\)](#):

6.6 Parks, Heritage and Coastal Environment

6.6.1 Activity: Parks and Foreshore

- Level of Service: 6.8.2.1 Increasing tree canopy in Parks - A net increase in total number of trees is achieved (1:2 replacement policy), with a minimum of 50% of the trees being medium to very large species



## Community Impacts and Views Ngā Mariu ā-Hāpori

- 6.7 Consultation started on 13 October and ran until 2 November 2025.
- 6.8 Project details including links to the tree planting plan [Kōrero mai | Let's Talk page](#) were advertised via:
- An email sent to 31 key stakeholders, including local schools, residents' associations and community organisations.
  - Leaflets delivered to properties in close proximity to the parks.
  - Signs installed at park entrances.
- 6.9 The tree planting plan [Kōrero mai | Let's Talk](#) page had 326 views throughout the consultation period.

## Summary of Submissions Ngā Tāpaetanga

- Darroch Reserve
- 6.10 No submissions were received.
- 6.11 One 5-star rating was received by quick poll.
- Derwent Lassiter Reserve
- 6.12 No submissions or quick poll responses were received.
- Englefield Reserve
- 6.13 Submissions were made by three individuals. [All submissions are available on our Kōrero mai webpage.](#)
- 6.14 Five 5-star ratings, one 2-star rating and one 1-star rating was received by quick poll.
- Grant Armstrong Reserve
- 6.15 Submissions were made by three individuals. [All submissions are available on our Kōrero mai webpage.](#)
- 6.16 Three 5-star ratings and one 1-star rating was received by quick poll.
- Glenturret and Grayshott Reserve
- 6.17 Submissions were made by two individuals. [All submissions are available on our Kōrero mai webpage.](#)
- 6.18 One 5-star rating was received by quick poll.
- Greendale Reserve
- 6.19 Submissions were made by four individuals. [All submissions are available on our Kōrero mai webpage.](#)
- 6.20 One 5-star rating and two 4-star ratings were received by quick poll.
- Parkham Reserve
- 6.21 No submissions or quick poll responses were received.
- Waterford Reserve
- 6.22 Submissions were made by one individual. [All submissions are available on our Kōrero mai webpage.](#)
- 6.23 Four 5-star ratings, one 2-star rating and three one-star ratings were received by quick poll.

### Impact on Mana Whenua Ngā Whai Take Mana Whenua

- 6.1 The decision does not involve a significant decision in relation to ancestral land, a body of water or other elements of intrinsic value, therefore this decision does not specifically impact Mana Whenua, their culture, and traditions.
- 6.2 The planting is in alignment with the Council's Urban Forest Plan which sought feedback from Mana Whenua and is in alignment with the Iwi Management Plan.
- 6.3 The decision does not involve a matter of interest to Mana Whenua and will not impact on our agreed partnership priorities with Ngā Papatipu Rūnanga.

### Climate Change Impact Considerations Ngā Whai Whakaaro mā te Āhuarangi

- 6.4 The decisions in this report are likely to:
  - 6.4.1 Contribute positively to adaptation to the impacts of climate change.
  - 6.4.2 Contribute positively to emissions reductions.
- 6.5 Tree planting will assist Council in offsetting its emissions and coping with the impacts of climate change.

## 7. Next Steps Ngā Mahinga ā-muri

- 7.1 Staff will work with the Three Waters team to ensure planting does not impact their storm water management works within Darroch reserve and Glenturret and Grayshott parks.
- 7.2 If approved, staff will begin ordering trees and assigning them to parks ready for planting during the next planting season.

## Attachments Ngā Tāpirihanga

There are no attachments to this report.

In addition to the attached documents, the following background information is available:

Document Name – Location / File Link
Not applicable

## Signatories Ngā Kaiwaitohu

Author	Toby Chapman - Manager Urban Forest
Approved By	Rupert Bool - Head of Parks

## 9. Tree Removals - Styx Drain Naturalisation

Reference Te Tohutoro: 25/2664755

Responsible Officer(s) Te Olga Naumova, Project Manager

Pou Matua: Melissa Thompson, Arboricultural Advisor

Accountable ELT

Member Pouwhakarae: Brent Smith, General Manager City Infrastructure

### 1. Purpose and Origin of the Report Te Pūtake Pūrongo

- 1.1 The purpose of this report is to seek approval to remove four healthy and structurally sound trees along Redbrook 1 Drainage Reserve (Map 3) to enable construction work on the Styx Drain Naturalisation, which is a sub-project under the SW Highsted Wetland, Highams Basin and Pūharakekenui – Styx Stream to proceed.
- 1.2 As the project spans three distinct land types —Council Parks, Council Property, and Crown-owned land—the authority to approve tree removals within each area has been delegated to the respective governing body.
- 1.3 In total, the project will require the removal of **42** trees, most of which (**32**) are located on Crown land. For full details on all the removals including those that are to be approved by other delegated authorities, see the appended tree survey.
- 1.4 The map below depicts the three different areas that are covered by the project. **Map 3** depicts the area with the trees that require the Community Board delegated authority to proceed with the tree removal.



- 1.5 This report is written in response to the Council's delegation to the Community Board under Part D, Sub-Part 1 of the Delegations Register, seeking approval for the removal of four healthy, structurally sound trees (Map 3) prior to commencement of works.

## 2. Officer Recommendations Ngā Tūtohu

That the Waimāero Fendalton-Waimairi-Harewood Community Board:

1. Receives the information in the Tree Removals - Styx Drain Naturalisation Report.
2. Notes that the decision in this report is assessed as medium significance based on the Christchurch City Council's Significance and Engagement Policy.
3. Approves the removal of four (healthy, structurally sound) trees, within Map 3, located at 143R Styx Mill Road (Redbrook 1 Drainage Reserve) to allow the Styx Drain Naturalisation project to proceed.
4. Approves, in accordance with the Tree Policy, the minimum replacement of **84** specimen-grade trees (>25L) to occur within the sites (Maps 1, 2, 3) as part of the project to replace more than what is lost across Maps 1, 2 and 3, with **108** specimen grade trees and **240** revegetation grade trees planned for.

## 3. Executive Summary Te Whakarāpopoto Matua

- 3.1 A comprehensive tree survey was undertaken within Maps 1, 2 and 3 in March 2023, again in February 2025 and most recently in November 2025 to inform decision on tree retention, removal and replacement planting.
  - 3.1.1 The survey identified **42** trees requiring removal due to factors such as poor health, structural integrity concerns, previous failures, weed species, covered in ivy or for project related reasons such as proximity to the proposed design, drain realignment and the construction plan.
- 3.2 The project is designed to manage runoff from 300 hectares of new and existing residential development, and requires extensive earthworks and reconfiguration of the landscape, including removal of the existing timber-lined drain, and installation of floodwater storage, flush basins and wetlands.
  - 3.2.1 The removal of **42** trees will allow the project to proceed, after which an extensive restoration plan will be implemented, including the planting of over **108** specimen grade (>25L) trees, **240** revegetation grade trees, and substantial underplanting.
- 3.3 Approval is sought from the Waimāero Fendalton-Waimairi-Harewood Community Board to proceed with the removal of the identified **4** trees within Map 3, ensuring alignment with Council's ecological objectives, safety considerations, and the overall enhancement vision for the wider area.

## 4. Background/Context Te Horopaki

- 4.1 The Styx Drain naturalisation is a sub-project under the SW Highsted Wetland, Highams Basin and Pūharakekenui, which will mitigate impacts from 150 hectares of new residential development and retrofit treatment associated with 150 hectares of existing residential area.
  - 4.1.1 The scheme for this area was approved with the adoption of the *Styx Stormwater Management Plan – Blueprint for Surface Water Management* on 31 August 2012.
  - 4.1.2 The project aims to enhance stormwater retention and treatment within the catchment, incorporating floodwater storage, flush basins, and wetlands.
- 4.2 Running through all sites, 138R (Map 1), Crown owned reserve (Map 2), and 143R Styx Mill Road (Map 3), is an existing timber-lined drain that will be removed and replaced with channel banks and enhanced landscape and ecological features that support riparian planting, drain realignment, and channel variation (width and depth) to enhance the diversity of the area's ecological values.
  - 4.2.1 Construction work will involve extensive earthworks including the removal of former plantings in fair and poor condition due to age, species characteristics, and absence of proactive tree management over time, as well as trees in fair condition due to their proximity to the drain, and for project related reasons.
- 4.3 The project is located south/west of the Styx Mill Conservation Reserve and will increase amenity value and recreational opportunities for the community in time.
- 4.4 Formerly the land at 138R Styx Mill Road (Map 1) was a privately owned rural lifestyle property, acquired by Council for the purpose of developing a stormwater treatment facility.
  - 4.4.1 The area (Map 1) is not a reserve or open to the public, and the site will remain closed until after the area is developed.
  - 4.4.2 The Manager Property Consultancy is authorised under Part A, Sub-Part 3, Section 6 of Council's Delegations Register to approve **6** tree removals on land that is not classified as a park, reserve, or public open space (138R Styx Mill Road, Map 1), and approval is being sought via internal staff approval processes.
- 4.5 The Project Manager will notify the Crown of intended works, including **(32)** tree removals within Map 2 (Crown land parcel), a minimum of 10 days prior to start of work.
- 4.6 Redbrook 1 Drainage Reserve (Utility Park) located at 143R Styx Mill Road (Map 3) is open to the public. However, the area will be closed during construction.
  - 4.6.1 The Waimāero Fendalton-Waimairi-Harewood Community Board has the authority to approve the removal of **4** healthy and structurally sound trees (within Map 3) due to their proximity to the existing timber lined drain, and for project/construction related reasons. Community Board approval is being sought via this Decision Report.
    - Refer below for images of the **4** healthy and structurally sound trees (within Map 3) proposed for removal.





### Options Considered Ngā Kōwhiringa Whaiwhakaaro

4.7 The following reasonably practicable options were considered and are assessed in this report:

- 4.7.1 **Option 1: Tree removal** – undertake the combined removal of **42** trees within Maps 1, 2 and 3. Specifically, **4** trees within Map 3 for approval by the Waimāero Fendalton-Waimairi-Harewood Community Board under this Decision Report. This will allow construction work on the Styx Drain Naturalisation project, a sub-project under the SW Highsted Wetland, Highams Basin and Pūharakekenui, and as approved via the *Styx Stormwater Management Plan – Blueprint for Surface Water Management* on 31 August 2012 (*Attachment 2*) to proceed. The project, and removal of trees, will facilitate the replanting of more ecologically appropriate tree species to enhance habitats and connectivity for aquatic and bird life, and in time improve and provide access for maintenance and recreational use.
- 4.7.2 **Option 2: Tree retention** – do nothing. If no action is taken, the construction plan will require redesigning to accommodate the trees, causing delays to the project that is scheduled to commence early 2026. Further, the area will remain dominated by weed species trees, aging ex-farmland trees, and trees in poor health or structural condition. This will continue to limit habitat quality for native wildlife, and restrict opportunities for riparian planting. Access for maintenance and recreational use will remain constrained, with increased management of tree risks or failures, control of weed species likely, and ongoing repairs to the timber lined drain.

4.8 The following options were considered but ruled out:

- 4.8.1 The option to selectively remove trees whilst retaining others was considered yet ruled out as it was deemed impractical due to the dense and intertwined canopy cover and root systems. Further many trees were found to be in poor health and condition, or otherwise located near the timber lined drain planned for removal, therefore making retention unviable.

### Options Descriptions Ngā Kōwhiringa

4.9 **Preferred Option:** Option 1 – Tree Removal

- 4.9.1 **Option Description:** specifically, and for the purpose of this Decision Report, Council seeks approval for the removal of **4** trees within Redbrook 1 Drainage Reserve (Utility Park) located at 143R Styx Mill Road (Map 3) to enable the Styx Drain Naturalisation project, a sub-project under the SW Highsted Wetland, Highams Basin and Pūharakekenui, and as approved via the *Styx Stormwater Management Plan – Blueprint for Surface Water Management* on 31 August 2012 to proceed.

- In addition, the removal of **6** structurally unsound and unhealthy trees (Map 1) will be removed under Council Delegated Authority (*Attachment A*).
- A further **32** trees (Map 2) on Crown owned land, will be notified to the Crown by the Project Manager, a minimum of 10 days prior to commencement of works, and as required under Section 161(1)(c) of the Local Government Act.
- Approval is sought from the Waimāero Fendalton-Waimairi-Harewood Community Board to remove **4** healthy and structurally sound trees, as identified in Map 3, due to their proximity to the drain, and for project related reasons.

#### 4.9.2 Option Advantages

- Removing the trees will enable the Styx Drain Naturalisation project, a sub-project under the SW Highsted Wetland, Highams Basin and Pūharakekenui, and as approved via the *Styx Stormwater Management Plan – Blueprint for Surface Water Management* on 31 August 2012 (*Attachment 2*) to proceed without delay and as planned, without additional costs incurred in redesigning the stormwater retention, treatment and floodwater storage areas, flush basins, and wetlands.
- In time, the landscape enhancements and planting that includes over **108** specimen grade (>25L) trees, **240** revegetation grade trees, and substantial underplanting's, will strengthen ecological value, improve habitat connectivity for birds and aquatic species, reduce emissions, enhance water quality, provide improved access for maintenance purposes, and increased connectivity for recreational use.

#### 4.9.3 Option Disadvantages

- Loss of tree canopy cover in the short term.

### 4.10 **Option 2:** Option 1 – Tree Retention

#### 4.10.1 **Option Description:** Retain the trees – do nothing.

#### 4.10.2 Option Advantages

- No direct costs incurred with tree removal.
- Canopy would be retained for a longer period.

#### 4.10.3 Option Disadvantages

- The project is designed to manage runoff from approximately 150 hectares of new and 150 hectares of existing residential development. Retaining the trees would either prevent these critical works going ahead or result in redesigning of the project to accommodate the trees. The existing stormwater assets are unlikely to accommodate the project's intended capacity, compromising stormwater management in future.
- Access for maintenance and recreational use will remain limited.
- Ongoing management of tree health, risks associated with structural tree failures, control of weed species, and ongoing repairs to the timber lined drain would be required.
- Habitat quality and attractants for native birds and aquatic species would remain limited compared to the benefits a restored riparian environment would provide.

## Analysis Criteria Ngā Paearu Wetekina

4.11 Not applicable

## 5. Financial Implications Ngā Hīraunga Rauemi

### Capex/Opex Ngā Utu Whakahaere

	Recommended Option	Option 2 – Tree retention
Cost to Implement	\$5,000	\$0
Maintenance/Ongoing Costs	Not applicable	Achievable in existing maintenance contract
Funding Source	CAPEX	Not applicable
Funding Availability	\$1,200,000 project budget	Not applicable
Impact on Rates	Not applicable	Not applicable

5.1 The cost for the tree removals comes from a similar tendered price from a contractor.

## 6. Considerations Ngā Whai Whakaaro

### Risks and Mitigations Ngā Mōrearea me ngā Whakamātautau

6.1 There is potential risk of community objection to the proposed tree removals, which could result in the Styx Drain Naturalisation project not to go ahead, meaning the upstream Styx Drain upgrade would not continue into the Styx Reserve.

6.1.1 To mitigate this risk, Council proposed sufficient replanting along the Styx Drain Naturalisation route (Map 1, 2 and 3).

6.2 Council acknowledge and consider community values and concerns, whilst reflecting the importance and benefits of this project to the wider community and ecological environment.

### Legal Considerations Ngā Hīraunga ā-Ture

6.3 Statutory and/or delegated authority to undertake proposals in the report:

6.3.1 Council's Delegations Register, Part D (Sub-Part 1), Section 42, delegates Community Boards the powers to remove **4** healthy and structurally sound trees (Map 3); and,

6.3.2 Council notifies the Waimāero Fendalton-Waimairi-Harewood Community Board, under Part B, Sub-Part 3, Section 19, of the Delegations Register, of the intent to remove **38** structurally unsound and unhealthy trees (Maps 1 and 2) that will be carried out under this delegation.

6.3.3 The proposed removal of trees in in line with Council's Tree Policy:

- Section 4.7 states:

*Approval by Council for the removal of trees to facilitate projects on Council land will take into account the value of the project to the community, including public health and/or the local environment and considerations taken for retaining existing trees compared with the loss of the benefits provided by the trees.*

6.3.4 Global Consent RMA/2021/2059 can be used to remove the trees.

6.4 Other Legal Implications:

6.4.1 There is no legal context, issue, or implication relevant to this decision.



### Strategy and Policy Considerations Te Whai Kaupapa here

6.5 The required decision:

6.5.1 Aligns with the [Christchurch City Council's Strategic Framework](#).

6.5.2 Is assessed as medium significance based on the Christchurch City Council's Significance and Engagement Policy. The level of significance was determined by Olga Naumova (Project Manager).

6.5.3 Is consistent with Council's Plans and Policies.

6.6 This report supports the [Council's Long Term Plan \(2024 - 2034\)](#), Volume 2, Infrastructure Strategy to provide:

6.6.1 *A green, liveable city: Our neighbourhoods and communities are accessible and well-connected, supporting our goals to reduce emissions, build climate resilience and protect and regenerate the environment, especially our biodiversity, water bodies and tree canopy.*

6.6.2 *An inclusive and equitable city which puts people at the centre of developing our city and district, prioritising wellbeing, accessibility and connection.*

6.6.3 *Protection and enhancement of reserves and native biodiversity.*

6.6.4 *Fit-for-purpose infrastructure, such as roads, footpaths and wharves, that enable access to local areas, sites of significance, waterways, and coastal waters.*

6.7 If the preferred option is approved, the Council's Tree Policy, Section 19, will be met, and exceeded, whereby a minimum of two trees will be planted across the project (Maps 1, 2 and 3), for every tree removed, replacing the canopy which is lost within 20 years.

### Community Impacts and Views Ngā Mariu ā-Hāpori

6.8 The decision affects the following Community Board area:

6.8.1 Waimāero Fendalton-Waimairi-Harewood Community Board

### Impact on Mana Whenua Ngā Whai Take Mana Whenua

6.9 The decision does not involve a significant decision in relation to ancestral land, a body of water or other elements of intrinsic value, therefore this decision does not specifically impact Mana Whenua, their culture, and traditions.

6.10 The decision does not involve a matter of interest to Mana Whenua and will not impact on our agreed partnership priorities with Ngā Papatipu Rūnanga.

6.11 This report relates to the removal of 4 exotic tree species with no cultural significance, and the trees removed would be replaced in accordance with Council's Tree Policy.

### Climate Change Impact Considerations Ngā Whai Whakaaro mā te Āhuarangi

6.12 The decisions in this report are likely to:

6.12.1 Contribute positively to adaptation to the impacts of climate change in time.

6.12.2 Contribute positively to emissions reductions in the long term.

6.13 While removal of 4 trees will return their stored carbon to the atmosphere in the short term, replacement of two trees for every one tree removed, as required by the Council's Tree Policy, will gradually replace that which has been taken.



6.13.1 Across the site (Maps 1, 2 and 3) a total of 42 trees are proposed for removal, with a minimum replanting requirement under the Tree Policy of 84 trees. Exceeding these

requirements, the project plans to plant **108** specimen-grade (>25L) trees, **240** revegetation grade trees, and numerous underplanting's.

## 7. Next Steps Ngā Mahinga ā-muri

- 7.1 If the preferred option to remove **4** structurally sound and healthy trees for project related reasons is approved by the Waimāero Fendalton-Waimairi-Harewood Community Board, a contractor can commence site works to remove the trees.
- 7.2 Construction work, including the removal of **38** structurally unsound and unhealthy trees (Maps 1 and 2) is planned for February 2026.
- 7.3 If the preferred option is approved, a combined total replanting of **108** specimen grade (>25L) trees, along with **240** revegetation grade trees within the same location (Maps 1, 2 and 3), will take place in accordance with the Council's Tree Policy, and is planned to be completed during the 2026 and 2027 planting seasons.

## Attachments Ngā Tāpirihanga

No.	Title	Reference	Page
A 	Internal Memo - Tree Removals Styx Drain Naturalisation (Under Separate Cover)	25/2100325	
B 	Approved Scheme - Styx Stormwater Management Plan – Blueprint for Surface Water Management (31 August 2012) (Under Separate Cover)	12/664735	

In addition to the attached documents, the following background information is available:

Document Name – Location / File Link
Not applicable

## Signatories Ngā Kaiwaitohu

<b>Author</b>	Melissa Thompson - Aboricultural Advisor
<b>Approved By</b>	Olga Naumova - Project Manager Gavin Hutchison - Head of Three Waters

## 10. Kotare Street / Puriri Street - Pedestrian Crossing Improvements

Reference Te Tohutoro: 25/2377684

Responsible Officer(s) Te Pou Matua: Gautham Praburam, Traffic Engineer

Accountable ELT Member Pouwhakarae: Brent Smith, General Manager City Infrastructure

### 1. Purpose and Origin of the Report Te Pūtake Pūrongo

- 1.1 The purpose of this report is to seek the approval of the Waimāero Fendalton-Waimairi-Harewood Community Board for the construction of a 1.8-metre-wide pedestrian path and an accessible crossing point with tactile pavers to cross Puriri Street near its intersection with Kotare Street.
- 1.2 This report has been written in response to feedback received from a road user regarding the absence of an appropriate crossing point and kerb cutdown to adequately serve pedestrians in this area.
- 1.3 The recommended option is to construct a pedestrian path with tactile pavers as shown in **Attachment A**.

### 2. Officer Recommendations Ngā Tūtohu

That the Waimāero Fendalton-Waimairi-Harewood Community Board:

1. Receives the information in the Kotare Street / Puriri Street - Pedestrian Crossing Improvements Report.
2. Notes that the decision in this report is assessed as low significance based on the Christchurch City Council's Significance and Engagement Policy.
3. Approves the pedestrian paths, kerb alignment changes and tactile pavers at the intersection of Kotare Street and Puriri Street as detailed in plan TG148390, dated 10/09/2025 and attached to this report as **Attachment A**.

### 3. Executive Summary Te Whakarāpopoto Matua

- 3.1 The Kotare Street / Puriri Street intersection is located near key educational institutions and local community facilities. As a result, pedestrian activity in the area is relatively high.
- 3.2 While a pedestrian refuge island is provided on Kotare Street, there is currently no kerb cutdown on the eastern side of Puriri Street to support safe and accessible crossing movements across Puriri Street.
- 3.3 The proposal involves removing the existing western kerb cutdown and constructing a new pedestrian path with kerb cutdowns and tactile paving on both sides of Puriri Street, connecting to the existing footpath network.
- 3.4 The proposed works will better align with pedestrian desire lines, improve accessibility for mobility-impaired users, and provide a safer and more convenient crossing facility for all pedestrians.

#### 4. Background/Context Te Horopaki

- 4.1 Improving safety and accessibility on local roads across Christchurch is a priority for the Council. Providing safe and inclusive infrastructure is essential to ensure people can travel safely, regardless of how they are travelling.
- 4.2 Kotare Street and Puriri Street are located within the Fendalton suburb of Christchurch. Under the Christchurch City Council's District Plan, Kotare Street is classified as a Minor Arterial road, while Puriri Street is classified as a Local Road.
- 4.3 The Kotare Street / Puriri Street intersection is located in close proximity to several key trip generators, including the University of Canterbury, Medbury School, Fendalton Park and a childcare centre. These land uses generate consistent pedestrian movements throughout the day, including school-aged children, students, families, and mobility-impaired users. As a result, pedestrian activity in the vicinity of the intersection is generally high.
- 4.4 A pedestrian refuge island is currently present on Kotare Street near its intersection with Puriri Street, to assist pedestrians crossing Kotare Street. However, there is currently no kerb cutdown on the eastern side of Puriri Street to support safe, convenient, and accessible crossing movements across Puriri Street. This limits the overall effectiveness of the existing crossing infrastructure.
- 4.5 A kerb cutdown is present on the western side of Puriri Street; however, it is positioned around 10m south of the intersection. Installing a new cutdown opposite this point would not be appropriate, as it does not align with observed pedestrian desire lines. In addition, the presence of a power pole / streetlight pole at this location significantly constrains the available space, preventing the installation of a compliant and accessible kerb cutdown.
- 4.6 The proposed works involve the removal of the existing kerb cutdown on the western side of Puriri Street and the construction of a new 1.8-metre-wide pedestrian path, including kerb cutdowns and tactile paving on both sides of Puriri Street. The proposed path will connect directly with the existing footpath network and provide a formalised and accessible crossing point aligned with pedestrian movement patterns.
- 4.7 Overall, the proposed improvements are intended to better align pedestrian infrastructure with established desire lines, improve accessibility for mobility scooter users and other mobility-impaired pedestrians, and provide a safer and more convenient crossing facility for all users.
- 4.8 The recommended option is to construct a pedestrian path with tactile pavers as shown in **Attachment A**.

#### Options Considered Ngā Kōwhiringa Whaiwhakaaro

- 4.9 The following reasonably practicable options were considered and are assessed in this report:
  - 4.9.1 Construct a pedestrian path and cutdowns with tactile pavers to help pedestrians to cross Puriri Street.
  - 4.9.2 Do Nothing.

#### Options Descriptions Ngā Kōwhiringa

- 4.10 **Preferred Option:** Construct a pedestrian path with tactile pavers and cutdowns to help pedestrians to cross Puriri Street.

- 4.10.1 **Option Description:** This option involves the removal of the existing kerb cutdown and pedestrian path on the western side of Puriri Street and the construction of a new 1.8-metre-wide pedestrian path, with kerb cutdowns and tactile paving provided on both sides of Puriri Street. The new path will connect directly to the existing footpath network and deliver a formalised, accessible crossing point aligned with pedestrian desire lines.
- 4.10.2 Option Advantages
- Safe and accessible facility for pedestrians to cross Puriri Street near its intersection with Kotare Street.
- 4.10.3 Option Disadvantages
- Cost to Council.
- 4.11 **Option 2: Do Nothing**
- 4.11.1 **Option Description:** Do Nothing
- 4.11.2 Option Advantages
- No cost to Council.
- 4.11.3 Option Disadvantages
- Lack of a safe and accessible crossing point for pedestrians wishing to cross Puriri Street near its intersection with Kotare Street.

## 5. Financial Implications Ngā Hīraunga Rauemi

### Capex/Opex Ngā Utu Whakahaere

	Recommended Option	Option 2 – Do Nothing
Cost to Implement	\$8700	\$0
Maintenance/Ongoing Costs	Covered by the existing maintenance contract	\$0
Funding Source	Accessibility Improvements Fund	N/A

## 6. Considerations Ngā Whai Whakaaro

### Risks and Mitigations Ngā Mōrearea me ngā Whakamātautau

- 6.1 None identified.

### Legal Considerations Ngā Hīraunga ā-Ture

- 6.2 Statutory and/or delegated authority to undertake proposals in the report:
- 6.2.1 Section 331 of the Local Government Act 1974 provides Council with the authority to install footpaths by resolution.
- 6.2.2 The Community Boards have delegated authority from the Council to exercise the delegations as set out in the Register of Delegations. The list of delegations for the Community Boards includes the resolution of footpaths, kerbs and channels.
- 6.3 Other Legal Implications:
- 6.3.1 There is no other legal context, issue, or implication relevant to this decision.

- 6.3.2 This specific report has not been reviewed and approved by the Legal Services Unit however the report has been written using a general approach previously approved of by the Legal Services Unit, and the recommendations are consistent with the policy and legislative framework outlined in this report.

### Strategy and Policy Considerations Te Whai Kaupapa here

- 6.4 The required decision:
- 6.4.1 Aligns with the [Christchurch City Council's Strategic Framework](#).
- 6.4.2 The decisions in this report are assessed as low significance based on the Christchurch City Council's Significance and Engagement Policy. The level of significance was determined by the low level of impact and low number of people affected by the recommended decision.
- 6.5 This report supports the [Council's Long Term Plan \(2024 - 2034\)](#):
- 6.6 Transport
- 6.6.1 Activity: Transport
- Level of Service: 10.0.2 Increase the share of non-car modes in daily trips -  $\geq 37\%$  of trips undertaken by non-car modes
  - Level of Service: 10.5.42 Increase the infrastructure provision for active and public modes -  $\geq 635$  kilometres (total combined length)
  - Level of Service: 16.0.10 Maintain the perception (resident satisfaction) that Christchurch is a walking friendly city -  $\geq 85\%$  resident satisfaction

### Community Impacts and Views Ngā Mariu ā-Hāpori

- 6.7 Community consultation was not considered necessary for this project, as the proposed works do not introduce any new restrictions or change how road users access or use the surrounding road network and infrastructure. The project only involves upgrades to existing pedestrian facilities.
- 6.8 The decision affects the following wards/Community Board areas:
- 6.8.1 Fendalton Ward.

### Impact on Mana Whenua Ngā Whai Take Mana Whenua

- 6.9 The decision does not involve a significant decision concerning ancestral land or a body of water or other elements of intrinsic value, therefore this decision does not specifically impact Mana Whenua, their culture and traditions.
- 6.10 The decision does not involve a matter of interest to Mana Whenua and will not impact on our agreed partnership priorities with Ngā Papatipu Rūnanga.

### Climate Change Impact Considerations Ngā Whai Whakaaro mā te Āhuarangi

- 6.15 The proposals in this report are unlikely to contribute significantly to adaptation to the impacts of climate change or emissions reductions.
- 6.16 This is a minor proposal that is primarily aimed at addressing concerns related to pedestrian safety and accessibility at this location. Due to the minor nature of the works, it is not expected to have any impact on climate change.

7. Next Steps Ngā Mahinga ā-muri

- 7.1 If approved, the recommendations will be implemented within the current financial year (generally around four weeks after the contractor receives the request, but this is subject to other factors such as resourcing and prioritisation beyond Council’s control).

Attachments Ngā Tāpirihanga

No.	Title	Reference	Page
A 	Puriri Street Kotare Street - Pedestrian Crossing Improvements	26/16809	52

In addition to the attached documents, the following background information is available:

Document Name – Location / File Link
Not applicable

Signatories Ngā Kaiwaitohu

Author	Gautham Praburam - Traffic Engineer
Approved By	Kathy Graham - Team Leader Traffic Operations Stephen Wright - Manager Operations (Transport)



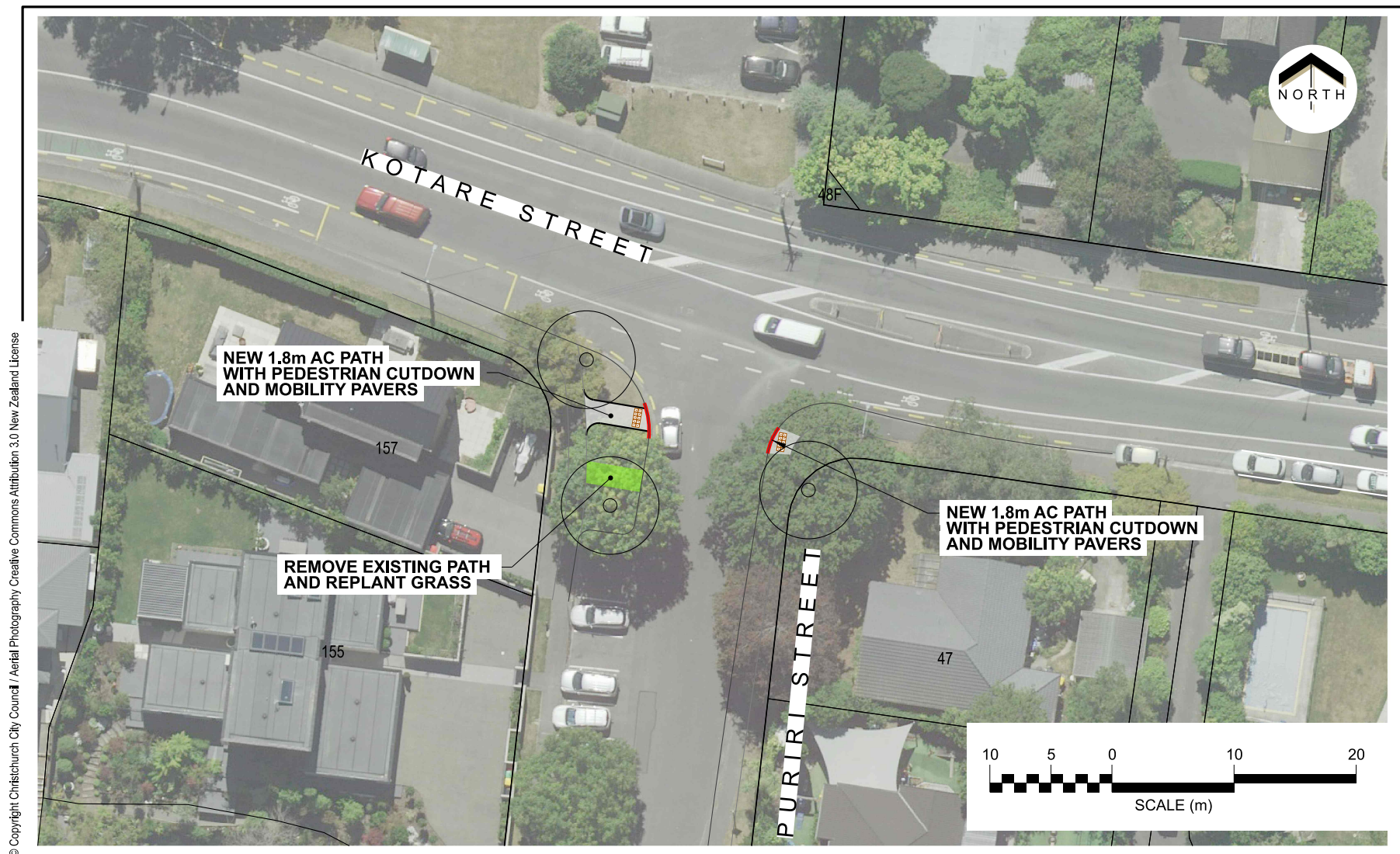



## 11. Wairakei Road Intersections

Reference Te Tohutoro: 26/103031

Responsible Officer(s) Te Pou Matua: Gemma Dioni, Principal Advisor

Accountable ELT Member Pouwhakarae: Brent Smith, General Manager City Infrastructure

### 1. Purpose and Origin of the Report Te Pūtake Pūrongo

- 1.1 This report is for the Waimāero Fendalton-Waimairi-Harewood Community Board to approve right turn phases from Grahams Road into Wairakei Road and from Wairakei Road into Idris Road, as well as changes to the layout at the Wairakei Road Railway Crossing.
- 1.2 The report has been written in response to requests to support the nearby three waters and roading projects in the northwest of the city.
- 1.3 Only minor hardware changes are required to facilitate the phase changes at the Grahams Road intersection, which includes changing the signal lanterns on the Grahams Road approaches.
- 1.4 At the Idris Road/Wairakei Road intersection, we are undertaking a full upgrade of the traffic signals. This includes underground cables, new signal poles and lanterns, as these critical assets are at the end of their working life and need to be replaced before a right turn phase can be introduced. The upgrade will also include minor safety improvements at the Idris Road/Wairakei Road intersection for people walking and crossing. This will be through the new kerb cutdowns to align with new pole locations and road markings. This will provide increased separation between crossings. Cycle marking changes are also proposed, which include new advanced cycle stop boxes and hook turn boxes.
- 1.5 At the Wairakei Road Railway Crossing, we are undertaking a full upgrade of the traffic signals. This includes underground cables, new signal poles and lanterns, as these critical assets are at the end of their working life and need to be replaced. Completing this work prior to the road being resurfaced will minimise any re-work through trenching across the new surface. In addition, we will also make changes to the entrance into Jeffreys Road to increase the amount of waiting space for people using the Puari ki Pū-harakeke-nui Northern Line cycleway.

### 2. Officer Recommendations Ngā Tūtohu

That the Waimāero Fendalton-Waimairi-Harewood Community Board:

1. Receives the information in the Wairakei Road Intersections Report.
2. Notes that the decision in this report is assessed as low significance based on the Christchurch City Council's Significance and Engagement Policy.
3. Approves, pursuant to Section 331 and 334 of the Local Government Act 1974:
  - a. All kerb alignments and road markings changes on Idris Road and Wairakei Road as detailed in **Attachment A** of this report.
  - b. All kerb alignments and road markings changes on Jeffreys Road and Wairakei Road as detailed in **Attachment B** of this report.

- c. The installation of hardware to facilitate traffic signal control of the right turn movement from Wairakei Road (east) into Idris Road (north).
- d. The installation of hardware to facilitate traffic signal control of the right turn movements from Grahams Road into Wairakei Road.
- 4. Notes that staff will review the operation of the intersections following completion of the three waters and roading projects to determine whether the right turn phases should be retained.

### 3. Executive Summary Te Whakarāpopoto Matua

- 3.1 The Council's Three Waters and Transport teams are delivering a number of renewals and capital projects in the northwest of the city. While this work is essential to keep the three waters network operational and to deliver the transport improvements and maintenance work, it is likely to affect how people drive around the local road network. The signal upgrades outlined in this report aim to keep traffic flowing through the wider area while these works are in place.
- 3.2 At the Idris Road/Wairakei Road intersection and the Grahams Road/Wairakei Road intersection, it is proposed to provide a right turn phase. This is either through a hardware upgrade or a full upgrade. To minimise any re-work when the carriageway is resurfaced along Wairakei Road, it is also proposed to upgrade the Railway Cycleway crossing, where the assets are at the end of their working life.

### 4. Background/Context Te Horopaki

- 4.1 Traffic signal lanterns are to be changed at the Grahams Road/Wairakei Road intersection to facilitate controlled right-turn movements from both Grahams Road approaches.
- 4.2 A full upgrade of the traffic signals is required at the Idris Road/Wairakei Road intersection as these critical assets are at the end of their working life. There is therefore an opportunity to include minor improvements as part of the work to improve safety for people walking and crossing at this intersection. These improvements include:
  - 4.2.1 Altering the kerb cut downs to provide separation between the crossing points. Tactile paving will be adjusted to suit the new crossing alignments.
  - 4.2.2 Addition of new advanced stop boxes and hook turn boxes for people cycling.
- 4.3 A full upgrade of the traffic signals is required at the Wairakei Road/Railway Crossing intersection as these critical assets are at the end of their working life. There is an opportunity to include improvements for people using the Puari ki Pū-harakeke-nui Northern Line cycleway by increasing the waiting area. This cycleway crossing is heavily utilised by commuters and school children. This improvement requires the re-alignment of the kerbs on Jeffreys Road, and information has been sent to residents at the northern end of Jeffreys Road seeking feedback on the changes.

### Options Considered Ngā Kōwhiringa Whaiwhakaaro

4.4 The following reasonably practicable options were considered and are assessed in this report:

4.4.1 Introduce right turn green arrows from Grahams Road into Wairakei Road and Wairakei Road into Idris Road. Introduce improvements to the layout at the Wairakei Road/Jeffreys Road intersection at the Railway Crossing.

4.4.2 Do nothing.

### Options Descriptions Ngā Kōwhiringa

4.5 **Preferred Option:** Introduce right turn green arrows from Grahams Road into Wairakei Road and Wairakei Road into Idris Road.

4.5.1 Option advantages

- Improve the ability for drivers to turn right from the eastern approach.
- At the Idris Road/Wairakei Road intersection:
  - Provide separation between the crossing points.
  - Introduce advanced stop boxes and hook turn boxes for people cycling.
- At the Jeffreys Road/Wairakei Road intersection:
  - Increase the waiting area for people using the cycleway crossing.
  - Widen the crossing point to allow more people to cross through the crossing phase.

4.5.2 Option disadvantages

- Cost to Council
- Potential impact on intersection efficiency, as the right turn phasing changes are likely to introduce additional delay to movements on other intersection approaches.

4.6 **Option 2:** Do nothing

4.6.1 **Option description:** Do nothing

4.6.2 Option advantages

- No cost to Council

4.6.3 Option disadvantages

- Does not improve the ability for drivers to turn right from Wairakei Road and Grahams Road when traffic management is in place at worksites, which could affect people's driving routes.
- At the Idris Road/Wairakei Road intersection:
  - Does not provide separation between the crossing points.
- At the Jeffreys Road/Wairakei Road intersection:
  - Does not Increase the waiting area for people using the cycleway crossing.
  - Does not widen the crossing point to allow more people to cross through the crossing phase.

## 5. Financial Implications Ngā Hīraunga Rauemi

### Capex/Opex Ngā Utu Whakahaere

	Recommended Option	Option 2 Do Nothing
Cost to Implement	\$2.1m approx	\$0
Maintenance/Ongoing Costs	To be covered under the Traffic Signals Maintenance contract. Would reduce the cost of maintenance in the medium-term due to new assets being provided.	\$0
Funding Source	#37293 Delivery Package - Traffic Signals Renewals	\$0
Funding Availability	Funding available in the above-named budget.	\$0
Impact on Rates	None	\$0

- 5.1 The cost are high-level estimates and are not tendered prices.
- 5.2 The traffic signals require renewal at the Idris Road/Wairakei Road site and the Wairakei Road/Railway Crossing site, as the cables are at the end of their working life. As part of the traffic signal renewal, it is proposed to undertake further improvements.

## 6. Considerations Ngā Whai Whakaaro

### Risks and Mitigations Ngā Mōrearea me ngā Whakamātautau

- 6.1 There is a risk that not completing the work now and having to undertake it at a more reactive time during the delivery of the northwest three waters and roading programme, would compound the impacts on people driving around the network when there are other road closures and traffic management in place. Completing this work now, ahead of major works, should lessen the impact on the local community. Completing this work ahead of the scheduled resurfacing will also minimise any redundant works through trenching to lay cables and ducts.

### Legal Considerations Ngā Hīraunga ā-Ture

- 6.2 Statutory and/or delegated authority to undertake proposals in the report:

*Local Government Act 1974*

6.2.1 Section 331 provides authority to approve concept plans for forming or upgrading footpath, kerbs and channels.

6.2.2 The installation of any signs and/or markings associated with traffic control devices must comply with the Land Transport Rule: Traffic Control Devices 2004.

- 6.3 Other Legal Implications:

6.3.1 There is no other legal context, issue, or implication relevant to this decision.

6.3.2 This specific report has not been reviewed and approved by the Legal Services Unit however the report has been written using a general approach previously approved of by the Legal Services Unit, and the recommendations are consistent with the policy and legislative framework outlined in this report.

### Strategy and Policy Considerations Te Whai Kaupapa here

- 6.4 The required decision:

6.4.1 Is assessed as low significance based on the Christchurch City Council's Significance and Engagement Policy. The level of significance was determined by the low level of impact and low number of people affected by the recommended decision.

- 6.4.2 The recommended option is consistent with the Council's Plans and Policies, in particular:
- LTP Activity Plan - Level of Service target to reduce the number of deaths or serious injuries (DSI) from all crashes by 40% in 2030.
  - The changes made align with the safe and healthy streets for everyone goal in the draft Ōtautahi Christchurch Future Transport Strategy 2024-2054.
  - Improving safety on local roads is a priority for the Council.
- 6.5 Transport
- 6.5.1 Activity: Transport
- Level of Service: 10.0.6.1 Reduce the number of death and serious injury crashes on the local road network (DIA 1) - 4 less than previous FY
  - Level of Service: 10.0.6.2 Reduce the number of death and serious injury crashes on the local road network - Five year rolling average <95 crashes per year
  - Level of Service: 10.5.1 Limit deaths and serious injury crashes per capita for cyclists and pedestrians - <=12 crashes per 100,000 residents
  - Level of Service: 10.5.3 More people are choosing to travel by cycling - >=13,000 average daily cyclist detections
  - Level of Service: 10.5.2 Improve the perception (resident satisfaction) that Christchurch is a cycling friendly city - >=67%
  - Level of Service: 16.0.10 Maintain the perception (resident satisfaction) that Christchurch is a walking friendly city - >=85% resident satisfaction

### Community Impacts and Views Ngā Mariu ā-Hāpori

- 6.6 Due to the very minor nature of improvements at the Idris Road/Wairakei Road intersection and the Grahams Road/Wairakei Road intersection, consultation has not been undertaken.
- 6.7 Due to the localised nature of the changes at the Wairakei Road/Jeffreys Road intersection, consultation letters were delivered to 11 properties at the northern end of Jeffreys Road. At the time of writing this report, no feedback has been received.
- 6.8 The decision affects the following wards/Community Board areas:
- 6.8.1 Waimāero Fendalton-Waimairi-Harewood Community Board.

### Impact on Mana Whenua Ngā Whai Take Mana Whenua

- 6.9 The decision does not involve a significant decision concerning ancestral land or a body of water or other elements of intrinsic value, therefore this decision does not specifically impact Mana Whenua, their culture and traditions.
- 6.10 The decision does not involve a matter of interest to Mana Whenua and will not impact on our agreed partnership priorities with Ngā Papatipu Rūnanga.





### Climate Change Impact Considerations Ngā Whai Whakaaro mā te Āhuarangi

- 6.11 The proposals in this report are unlikely to contribute significantly to adaptation to the impacts of climate change or emissions reductions.
- 6.12 This is a minor proposal that is principally intended to improve accessibility and safety for people crossing at the intersection.

7. Next Steps Ngā Mahinga ā-muri

7.1 If approved, staff will proceed with construction.

Attachments Ngā Tāpirihanga

No.	Title	Reference	Page
A  	Idris Road / Wairakei Road Intersection Changes	26/126048	59
B  	Jeffreys Road / Wairakei Road Intersection Changes	26/126040	60

In addition to the attached documents, the following background information is available:

Document Name – Location / File Link
Not applicable

Signatories Ngā Kaiwaitohu

Author	Gemma Dioni - Principal Advisor Transportation Safety
Approved By	Jann Kuhlmann - Team Leader Real Time Operations Stephen Wright - Manager Operations (Transport)

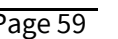



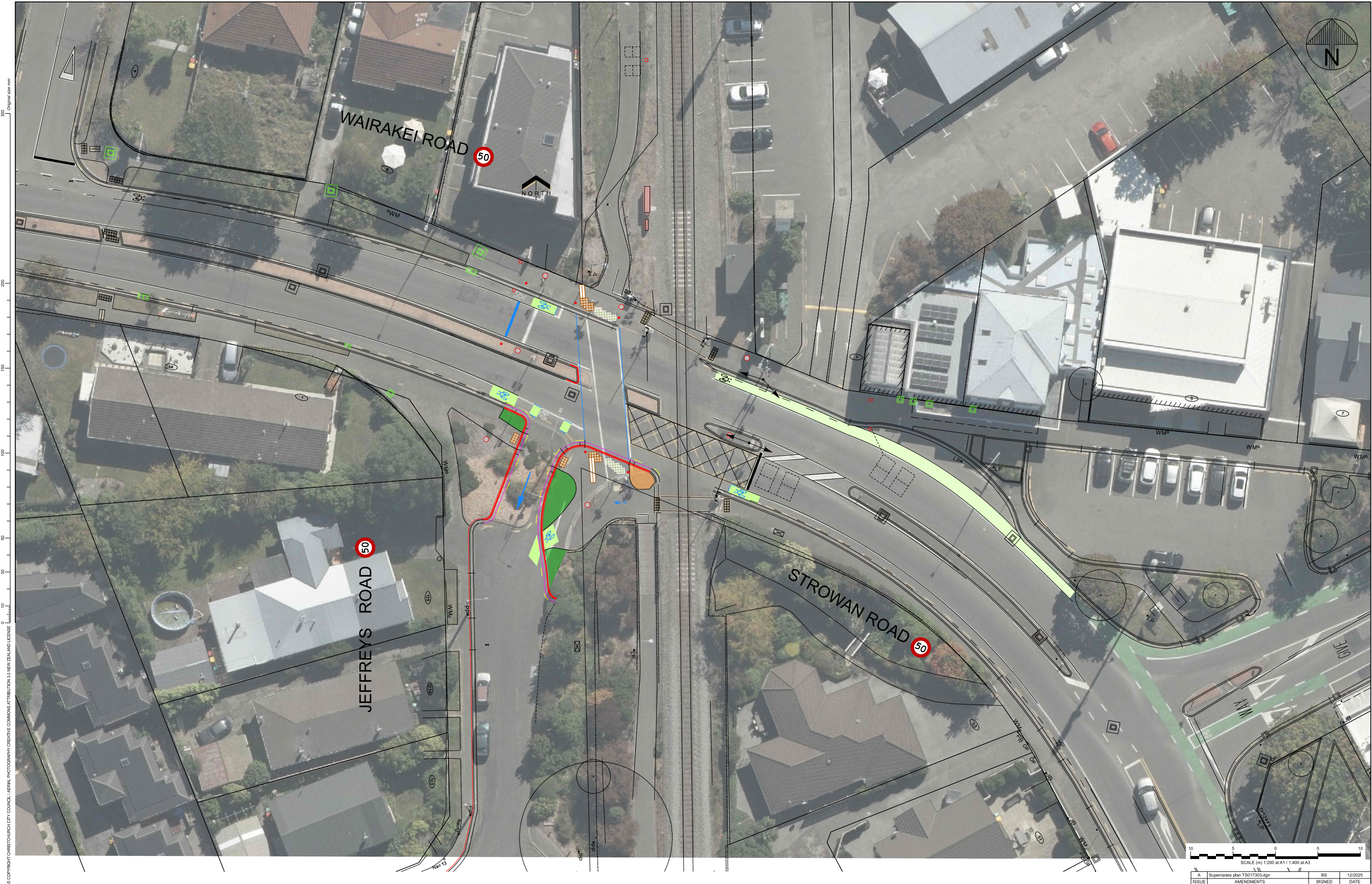

<div>Christchurch City Council</div> <div>TECHNICAL SERVICES &amp; DESIGN</div>	C.D.D.		NAME		SIGNED	DATE	APPROVED		CONSULTANT
	BENCH MK.		B Stinson				FOR TENDER		
	DESIGNED				DATE	SIGNED			
	DES. REVIEW								
	DRAWN		V Inwood		DATE	SIGNED			
	DRAW. CHECK								
	FILE LOCATION				FOR CONSTRUCTION				
	DRAIN. REF.		S:\Data\Ogri\W8\Traffic\ts1400\ts141601.dgn		DATE	SIGNED			
	SAP WBS		PRINTED ON: 20/01/2026 BY: jrw@cc						
	CONSULTANT PROJECT REF.		CONSULTANT FILE REF.						
PROJECT TITLE		WAIRAKEI ROAD / RAILWAY CYCLEWAY INTERSECTION							
DRAWING TITLE		TRAFFIC SIGNALS AND PAVEMENT MARKINGS							
DOCUMENT NUMBER		ORIGINAL SHEET SIZE		SCALES					
CAD DRAWING FILE REF. TS141601		A1		1:200 @ A1 1:400 @ A3					
TSD PROJECT FILE NUMBER		INTERSECTION NUMBER							
		302							



## 12. Poynder Avenue and Garden Road bridges - No Stopping Restrictions and Footpaths

Reference Te Tohutoro: 25/2258197

Responsible Officer(s) Te Pou Matua: Sandra Novais – Transport Project Manager

Accountable ELT Member Pouwhakarae: Brent Smith, General Manager City Infrastructure

### 1. Purpose and Origin of the Report Te Pūtake Pūrongo

- 1.1 The purpose of this report is for the Waimaero-Fendalton-Waimairi-Harewood Community Board to retrospectively approve the kerb alignments, footpaths and no stopping restrictions on Poynder Avenue and Garden Road bridges.
- 1.2 The report is staff generated to support the works that were recently completed along the bridges.

### 2. Officer Recommendations Ngā Tūtohu

That the Waimāero Fendalton-Waimairi-Harewood Community Board:

1. Receives the information in the Poynder Avenue and Garden Road bridges - No Stopping Restrictions and Footpaths Report.
2. Notes that the decision in this report is assessed as low significance based on the Christchurch City Council's Significance and Engagement Policy.
3. Revokes any previous resolutions pertaining to traffic controls made pursuant to any Bylaw to the extent that they conflict with the traffic controls and parking and stopping restrictions described in resolutions 5 to 8 below.
4. Make the following resolutions relying on its powers under the Christchurch City Council Traffic and Parking Bylaw 2017 and Part 21 of the Local Government Act 1974.

#### Poynder Avenue

5. Approves all kerb alignments, footpaths and road markings on Poynder Avenue commencing at its intersection with Rossall Street, and extending in a south westerly direction for 45 metres, as detailed on plan TG151698, Issue 1, dated 20/11/2025 and attached to this report as **Attachment A**.
6. Approves, pursuant to Clause 7 of the Christchurch City Council Traffic and Parking Bylaw 2017, that the stopping of vehicles be prohibited at all times as detailed on plan TG151698, Issue 1, dated 20/11/2025 and attached to this report as **Attachment A**:
  - a. On the western side of Poynder Avenue, commencing at its intersection with Rossall Street and extending in a southerly direction and then in a westerly direction for a distance of 45 metres.
  - b. On the eastern side of Poynder Avenue, commencing at its intersection with Rossall Street and extending in a south westerly direction up to its intersection with Wairarapa Terrace.

- c. On the southern side of Poynder Avenue, commencing at its intersection with Wairarapa Terrace and extending in a westerly direction for a distance of 21 metres.
- d. On the northeastern side of Wairarapa Terrace, commencing at its intersection with Poynder Avenue and extending in a southerly direction for a distance of six metres.
- e. On the southwestern side of Wairarapa Terrace, commencing at its intersection with Poynder Avenue and extending in a southerly direction for a distance of eight metres.

#### Garden Road

- 7. Approves all kerb alignments, footpaths and road markings on Garden Road commencing at its southern intersection with Wairarapa Terrace, and extending in a northerly direction for a distance of 52 metres, as detailed on plan TG151697, Issue 1, dated 20/11/2025 and attached to this report as **Attachment B**.
- 8. Approves, pursuant to Clause 7 of the Christchurch City Council Traffic and Parking Bylaw 2017, that the stopping of vehicles be prohibited at all times as detailed on plan TG151697, Issue 1, dated 20/11/2025 and attached to this report as **Attachment B**:
  - a. On the western side of Garden Road, commencing at its southern intersection with Wairarapa Terrace and extending in a northerly direction for a distance of 48 metres.
  - b. On the eastern side of Garden Road, commencing at its northern intersection with Wairarapa Terrace and extending in a northerly direction for a distance of 27 metres.
  - c. On the northern side of Wairarapa Terrace, commencing at its northern intersection with Garden Road and extending in an easterly direction for a distance of 19 metres.
- 9. Approves that these resolutions take effect when road marking that evidence the restrictions described in this staff report are in place (or removed in the case of revocations).

### 3. Executive Summary Te Whakarāpopoto Matua

- 3.1 The bridge renewal works on Poynder Avenue and Garden Road were practically completed in October 2024. A final on-site inspection of the completed works after 12 months of defects liability period was undertaken on 30 October 2025.
- 3.2 Following the inspection, the Traffic Operations team identified that no-stopping restrictions had been installed on site without formal resolution or approval and advised that a report seeking retrospective approval of these restrictions would need to be presented to the Community Board for consideration and approval.
- 3.3 The recommended option is to approve the kerb alignments, footpaths and no stopping restrictions on Poynder Avenue and Garden Road bridges in accordance with **Attachment A** and **Attachment B**.

### 4. Background/Context Te Horopaki

- 4.1 The Garden Road and Poynder Avenue bridges were identified as having exceeded their design life, and a project was initiated to renew both the bridges.
  - 4.1.1 A memo was submitted to the Community Board outlining the need for the bridge renewals, along with plans for the proposed works.
  - 4.1.2 The replacement works for the Garden Road and Poynder Avenue bridges (including the completion of the defects liability period) were completed in October 2025.

- 4.2 During the final site inspection undertaken on 30<sup>th</sup> October 2025, it was identified that the new footpaths, no-stopping restrictions and changes to the kerb alignments along the bridges that had been implemented had not been formally approved by the Community Board.
  - 4.2.1 Prior to the renewal works, the Poynder Avenue bridge did not have footpaths on either side, while the Garden Road bridge had a footpath only on one side.
  - 4.2.2 As part of the renewal works, footpaths were installed on both sides of the Poynder Avenue bridge and on one side of the Garden Road bridge to meet minimum levels of service.
- 4.3 The provision of footpaths improves pedestrian and cyclist safety, enhances accessibility and connectivity.
- 4.4 Previously, neither bridge had kerbside parking restrictions, despite limited visibility, narrow traffic lanes, and the absence of road shoulders. These conditions create safety risks and increase the potential for parked vehicles to obstruct traffic movements.
  - 4.4.1 No stopping restrictions were installed to mitigate these risks and improve safety.
- 4.5 This report seeks to formally resolve and obtain approval for the kerb alignments, footpaths, and no-stopping restrictions implemented as part of the bridge renewal works.

### Options Considered Ngā Kōwhiringa Whaiwhakaaro

- 4.6 The following reasonably practicable options were considered and are assessed in this report:
  - 4.6.1 Option 1 (“Preferred Option”) – Approve the kerb alignments, footpaths and no stopping restrictions on Poynder Avenue and Garden Road bridges.
  - 4.6.2 Option 2 – Remove the no stopping restrictions on Poynder Avenue and Garden Road bridges.
- 4.7 The following option was considered but ruled out:
  - 4.7.1 Remove the kerbs and footpaths on Poynder Avenue and Garden Road bridges - this option was ruled out as the infrastructure would not meet the Christchurch City Council Construction Standards Specifications for bridges in urban areas.

### Options Descriptions Ngā Kōwhiringa

- 4.8 **Preferred Option:** Option 1 – Approve the kerb alignments, footpaths and no stopping restrictions on Poynder Avenue and Garden Road bridges.
  - 4.8.1 **Option Description:** This option formally resolves the kerb alignments, footpaths and no stopping restrictions on Poynder Avenue and Garden Road bridges which were installed as part of the Delivery Package - Bridge Renewals project. These layouts are shown on **Attachment A** and **Attachment B**.
  - 4.8.2 **Option Advantages**
    - Improves safety for pedestrians.
    - Improves safety and accessibility for vehicular traffic.
  - 4.8.3 **Option Disadvantages**

- Restricts parking along the bridge. However, it needs to be noted that vehicles were not observed to be parked in this location prior to the installation of the restrictions.

4.9 **Option 2:** Remove the no stopping restrictions on Poynder Avenue and Garden Road bridges.

4.9.1 **Option Description:** This option removes the parking restriction over the bridges, but retains the layouts with kerbs, footpaths, etc.

4.9.2 **Option Advantages**

- Retains parking
- The retention of footpaths improves safety for pedestrians

4.9.3 **Option Disadvantages**

- Costs involved with the removal of line markings
- Reduced safety for vehicular traffic due to narrowing and reduced visibility

## 5. Financial Implications Ngā Hīraunga Rauemi

### Capex/Opex Ngā Utu Whakahaere

	Preferred Option (1)	Option 2
Cost to Implement	\$0	\$3,000
Maintenance/ Ongoing Costs	Negligible	n/a
Funding Source	Delivery Package - Bridge Renewals (37102)	Delivery Package - Bridge Renewals (37102)
Current Funding Availability (bridge renewals project) - CAPEX	\$3,000,000	\$3,000,000
Impact on Rates	None	<0.01%

## 6. Considerations Ngā Whai Whakaaro

### Risks and Mitigations Ngā Mōrearea me ngā Whakamātautau

6.1 If these resolutions are not approved:

- 6.1.1 The legalities relating to the issues of the road space, including parking will not be able to be enforced.
- 6.1.2 There is the risk of potential safety implications through non-compliance with onsite traffic restrictions if they cannot be enforced.

### Legal Considerations Ngā Hīraunga ā-Ture

6.2 Statutory and/or delegated authority to undertake proposals in the report:

- 6.2.1 Part 1, Clauses 7 and 8 of the Christchurch City Council Traffic and Parking Bylaw 2017 provide Council with the authority to install parking or stopping restrictions, designate an area to be a parking area and the restrictions that apply in that area by resolution.
- 6.2.2 The installation of any signs and/or markings associated with traffic control devices must comply with the Land Transport Rule: Traffic Control Devices 2004.
- 6.2.3 Section 331 of the Local Government Act 1974 provides Council with the authority to install footpaths by resolution.

- 6.2.4 The Community Boards have delegated authority from the Council to exercise the delegations as set out in the Register of Delegations. The list of delegations for the Community Boards includes the resolution of footpaths, kerbs and channels.
- 6.3 Other Legal Implications:
- 6.3.1 There is no legal context, issue, or implication relevant to this decision.
- 6.3.2 This specific report has not been reviewed and approved by the Legal Services Unit however the report has been written using a general approach previously approved of by the Legal Services Unit, and the recommendations are consistent with the policy and legislative framework outlined in this report.

### Strategy and Policy Considerations Te Whai Kaupapa here

- 6.4 The required decision:
- 6.4.1 Aligns with the [Christchurch City Council's Strategic Framework](#).
- 6.4.2 Is assessed as low significance based on the Christchurch City Council's Significance and Engagement Policy. The level of significance was determined by the low level of impact and low number of people affected by the recommended decision.
- 6.4.3 Is consistent with Council's Plans and Policies.
- 6.5 This report supports the [Council's Long Term Plan \(2024 - 2034\)](#):
- 6.6 Transport
- 6.6.1 Activity: Transport
- Level of Service: 10.0.2 Increase the share of non-car modes in daily trips - >=37% of trips undertaken by non-car modes

### Community Impacts and Views Ngā Mariu ā-Hāpori

- 6.7 Project information, including the scope of works for the renewal of the Poynder Avenue and Garden Road bridges, was provided to the Community Board via a memo.
- 6.8 In addition, a letter drop was undertaken before construction to inform residents in the vicinity of Poynder Avenue and Garden Road bridges about the proposed works.
- 6.9 A Newsline article and social media posts, including plans of the bridge renewals, were also published to inform the wider community.
- 6.10 There have been no complaints received from members of the public since the no parking restrictions were implemented in October 2025.
- 6.11 The residents directly affected by the no parking implementation have been consulted and have not expressed any concerns and are content with the result.
- 6.12 At this stage, formal consultation seeking feedback from the community was not considered necessary
- 6.12.1 The change is limited in scope and is supported by affected properties
- 6.12.2 On-street parking is available directly adjacent to the proposed restrictions
- 6.12.3 There does not appear to be high on-street parking demand in this area

6.12.4 Vehicles were not observed to be parked in this location prior to the installation of the no-stopping restrictions.

6.13 The decision affects the following wards/Community Board areas:

6.13.1 Waimaero-Fendalton-Waimairi-Harewood Community Board.

#### Impact on Mana Whenua Ngā Whai Take Mana Whenua

6.14 The decision does not involve a significant decision in relation to ancestral land, a body of water or other elements of intrinsic value, therefore this decision does not specifically impact Mana Whenua, their culture, and traditions.

6.15 The decision does not involve a matter of interest to Mana Whenua and will not impact on our agreed partnership priorities with Ngā Papatipu Rūnanga.



#### Climate Change Impact Considerations Ngā Whai Whakaaro mā te Āhuarangi

6.16 The proposals in this report are unlikely to contribute significantly to adaptation to the impacts of climate change or emissions reductions.

### 7. Next Steps Ngā Mahinga ā-muri

7.1 If approved, staff will arrange for the final changes and removal and/or maintenance of new paint marking, as required.

### Attachments Ngā Tāpirihanga

No.	Title	Reference	Page
A 	Poynder Avenue bridge improvements	25/2399551	67
B 	Garden Road bridge improvements	25/2399553	68

In addition to the attached documents, the following background information is available:

Document Name – Location / File Link

### Signatories Ngā Kaiwaitohu

Author	Sandra Novais - Project Manager
Approved By	Jim Stainwall - Team Leader Project Management Transport Jacob Bradbury - Manager Planning & Delivery Transport



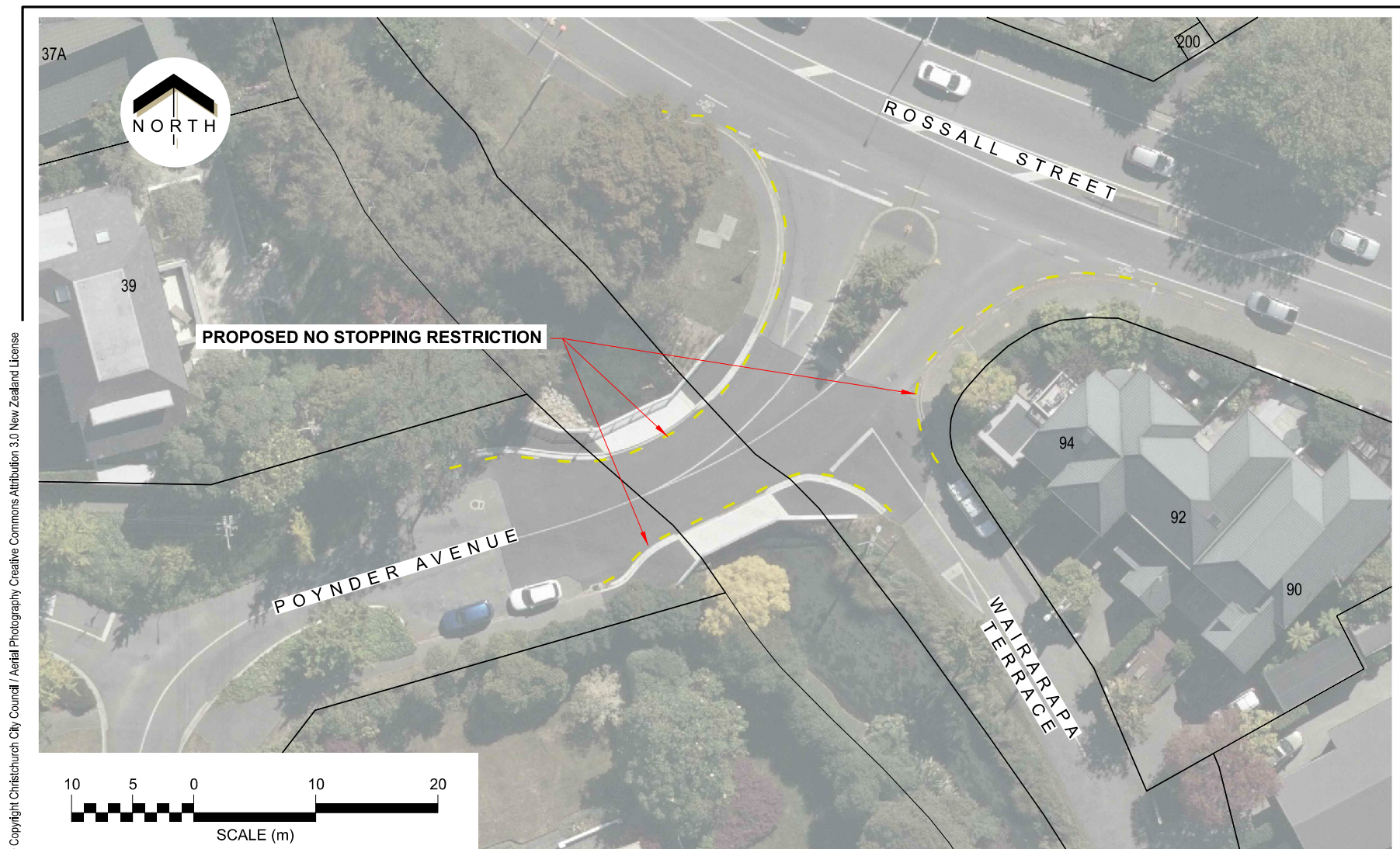



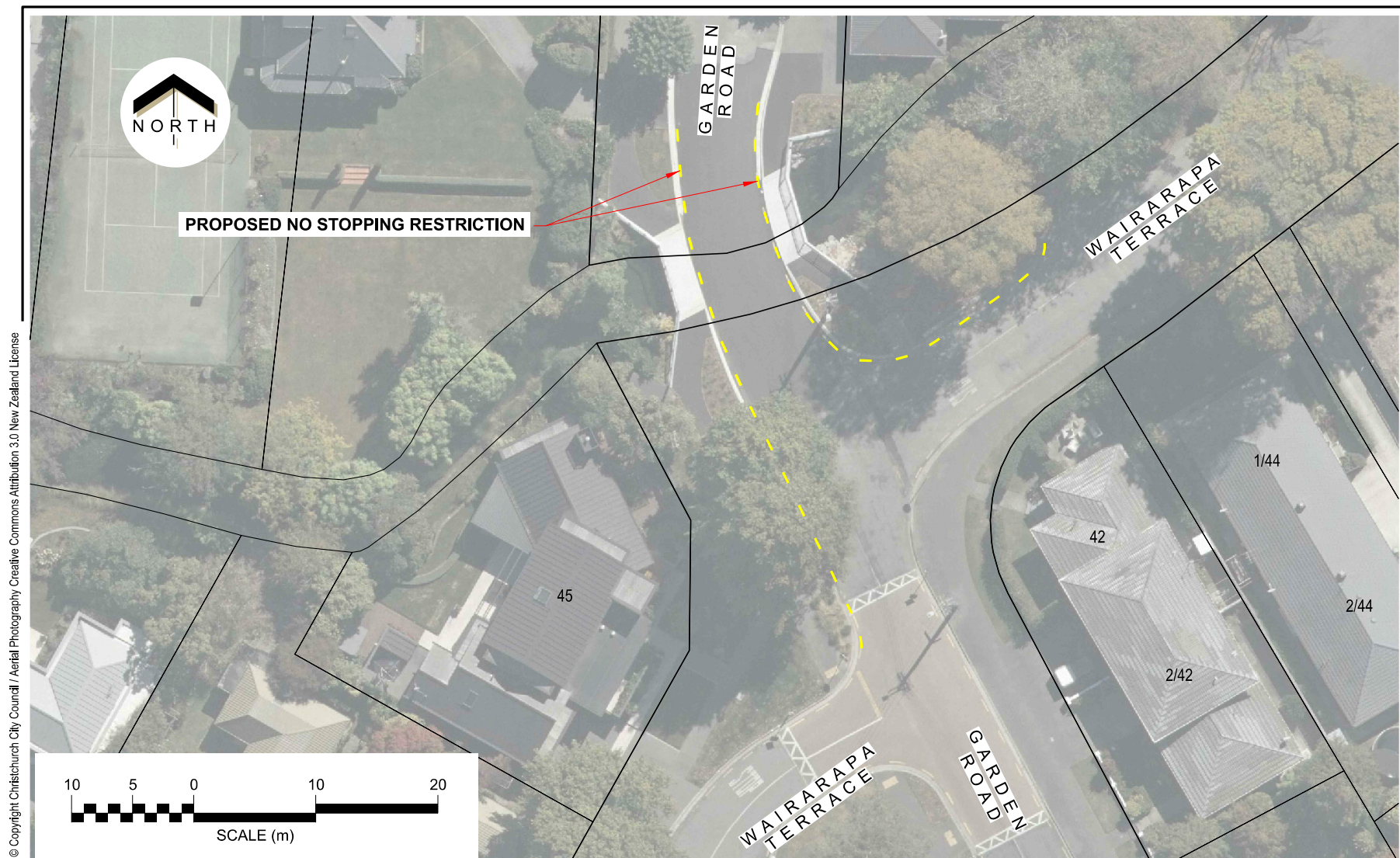

Christchurch  
City Council

**Garden Road**  
Proposed No Stopping Restrictions  
For Board Approval

Attachment B

**Original Plan Size: A4**  
Drawn: MJR Issue 1 20/11/2025  
Designed: MW Drawing: TG151697  
Approved: BH Project:

Item 12

Attachment B

## 13. Property Disposal, Millstead Oaks Subdivision, Casebrook.

Reference Te Tohutoro: 25/2303090

Responsible Officer(s) Te Pou Matua: Stuart McLeod, Property Consultant

Accountable ELT Member Pouwhakarae: Anne Columbus, General Manager Corporate Services/Chief People Officer

### 1. Purpose and Origin of the Report Te Pūtake Pūrongo

- 1.1 The purpose of this report is to seek the Community Boards recommendation to Council to dispose of a narrow strip of land within the Millstead Oaks subdivision.
- 1.2 The origin of this report results from the completion of the Millstead Oaks subdivision and the subsequent need to practically manage ongoing costs of land maintenance.

### 2. Officer Recommendations Ngā Tūtohu

That the Waimāero Fendalton-Waimairi-Harewood Community Board:

1. Receives the information in the Property Disposal, Millstead Oaks Subdivision, Casebrook. Report.
2. Notes that the decision in this report is assessed as low significance based on the Christchurch City Council's Significance and Engagement Policy.
3. Recommends that the Council resolves to transfer:
  - a. section 2 RPS6694 to the owner of Lot 40 DP 602661 and issue one amalgamated title and
  - b. section 3 RPS6694 to the owner of Lot 41 DP 602661 and issue one amalgamated title and
  - c. section 4 RPS6694 to the owner of Lot 42 DP 602661 and issue one amalgamated title and
  - d. section 5 RPS6694 to the owner of Lot 43 DP 602661 and issue one amalgamated title
4. Authorises the Manager Property Consultancy to undertake all actions, negotiate and conclude all the agreements necessary to facilitate the recommendations above on terms and conditions acceptable to him at his sole discretion.

### 3. Executive Summary Te Whakarāpopoto Matua

- 3.1 Council acquired the boxed drain contained within Section 1 SO 570152 to facilitate the naturalisation of the Styx Drain and enable the Millstead Oaks subdivision.
- 3.2 All subdivision, road formation and reserve works have been completed, leaving a 140-metre long and 3.5-metre wide strip of land not required by council for its works and therefore to be resolved.
- 3.3 It is proposed that section 1 will vest as road, section 6 will vest as Local Purpose (Utility) Reserve and sections 2–5 will be transferred to each of their respective adjoining owners to the west. All sections are shown on scheme plan RPS6694.

#### 4. Background/Context Te Horopaki

- 4.1 The Styx Mill Drain was one of the old style boxed drains common throughout Christchurch and although Council has statutory rights to maintain drains of this nature these rights do not confer ownership. Given the Council's desire to naturalise the Styx Drain it was logical for Council to take ownership of it to enable development.
- 4.2 In the first quarter of 2023 Council compulsorily acquired the land identified as Section 1 SO 570152 that contained the boxed Styx drain and was held in the historic Deeds Register with its owner being long deceased.
- 4.3 This drain extended through the (now) formed Redbrook Road to the north and adjoins Council utility reserve to the south. Section 1 is to vest as road, Section 6 will vest as Local Purpose (Utility) Reserve and it is planned to transfer sections 2-5 to their respective adjoining owners to the west.



4.3.1



Item 13

4.4 This strip of land falls within the Upper Styx Outline Development Plan (attached), which includes land for residential sections, roads and utility reserves. Specifically this portion of the

boxed drain is intended for road, residential development and reserve.

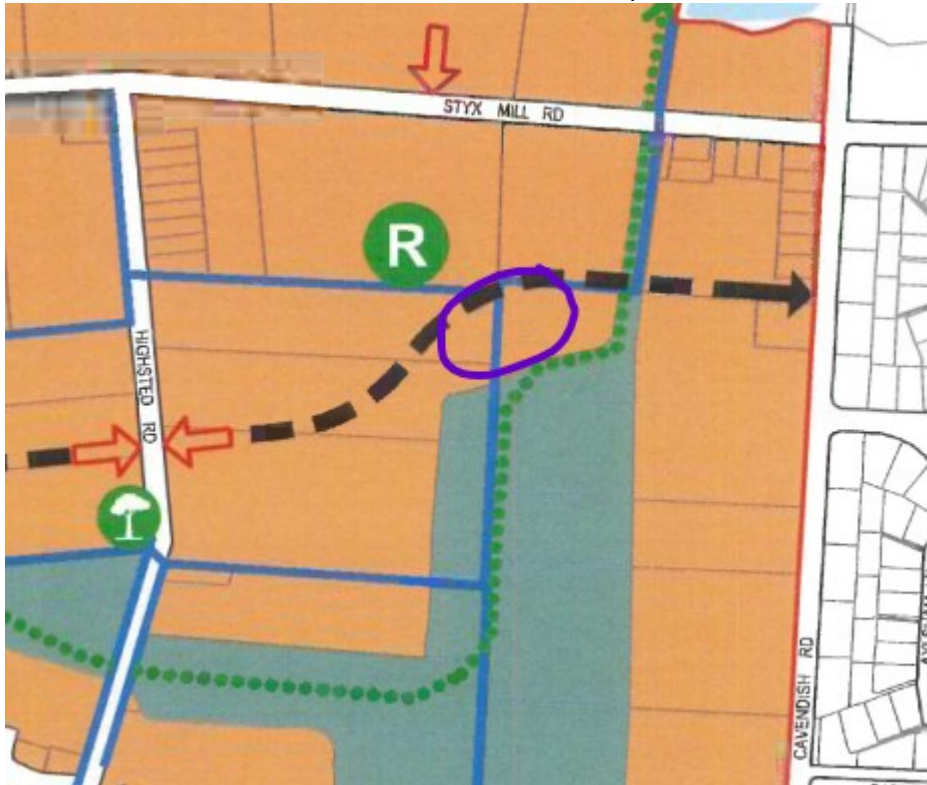

- 4.5 By taking ownership, the Council was able to divert and naturalise the Styx Drain and investigate whether to fully fill the old drain or if it was required provide subsoil drainage in the form of a piped easement, the later was the case.
- 4.6 This subsoil drainage work was to be completed by either the developer or the Council dependent on timing, as it transpired the developer completed the drainage works at its cost which allowed its development to proceed in a timely manner.
- 4.7 The subsoil drain is now operative and will be protected by way of easement, however, this strip of land remains problematic for the Council for the following reasons;
  - Due to its elongated and restricted width, it provides little meaningful public access. There are alternative points of access to the Council reserves from Redbrook Road.
  - It is too narrow for contactors mowers to safely manoeuvre.
  - Council could be liable for 50% share of fencing costs for up to 140 linear metres of fencing.
- 4.8 To mitigate these issues and with development having been completed on the strips eastern boundary it is proposed to transfer the strip of land to each of the (now) four adjoining owners on the western side for a nominal consideration, however staff have no delegation to dispose of property, a decision by the full Council is required.
- 4.9 A nominal consideration is justified given the issues outlined in paragraph 4.7, these issues justify a significant discount on any perceived value. In addition, we cannot force the adjoining owners to purchase the land, the nominal consideration has been an incentive for them to accept the Council proposal that has little or no added benefit for them.

#### Options Considered Ngā Kōwhiringa Whaiwhakaaro

- 4.10 The following reasonably practicable options were considered and are assessed in this report:
  - 4.10.1 Dispose of the land to owners on the western boundary.

- 4.10.2 Retain ownership.
- 4.11 The following options were considered but ruled out:
- 4.11.1 Dispose of the land to the properties on its eastern boundary – This option was ruled out because the land to the eastern side has already been built on and fenced.
- 4.11.2 Lease or licence the land to adjoining owners – This option was ruled out because it does not provide a permanent solution.

### Options Descriptions Ngā Kōwhiringa

- 4.12 **Preferred Option:** Dispose of the land.
- 4.12.1 **Option Description:** Dispose of the land to the owners of four sections on its western side.
- 4.12.2 Option Advantages
- No cost of maintenance.
  - No cost of fencing.
  - Disposal of a thin strip of land that has little or no practical access.
  - The subsoil drain can be protected by way of registered easement.
- 4.12.3 Option Disadvantages
- Cost of survey and associated staff costs.
- 4.13 **Option Description:** Retain ownership.
- 4.13.1 **Option Description:** Hold the land in Council ownership.
- 4.13.2 Option Advantages
- 100% control of the land.
- 4.13.3 Option Disadvantages
- Ongoing maintenance cost.
  - Costs of fencing.
  - Due to its elongated and restricted width, it provides little or no practical access.
  - Potential problems i.e. fly dumping, antisocial behaviour

### Analysis Criteria Ngā Paearu Wetekina

- 4.14 The criteria for the above options were analysed by comparing any need to retain the land against the benefits of disposal and what that means at a practical operational level.

## 5. Financial Implications Ngā Hīraunga Rauemi

### Capex/Opex Ngā Utu Whakahaere

	Recommended Option	Option 2 – Council ownership	Option 3 - <enter text>
Cost to Implement	\$10,000	Nil	
Maintenance/Ongoing Costs	Nil	Estimated \$10,500 immediate fencing costs \$1150 p/a mowing costs	



Funding Source	Three waters operational budget	Three Waters operational budget	
Funding Availability	LTP 2024-2034	LTP 2024-2034	
Impact on Rates	<0.01%	<0.01%	

## 6. Considerations Ngā Whai Whakaaro

### Risks and Mitigations Ngā Mōrearea me ngā Whakamātautau

- 6.1 Because the pipe work for the subsoil drain will be protected by an easement that gives rights to access the pipe should maintenance be required, there is no risk associated with the disposal of this land.

### Legal Considerations Ngā Hīraunga ā-Ture

- 6.2 Statutory and/or delegated authority to undertake proposals in the report:
- 6.2.1 The Council has full capacity to carry on or undertake any activity as prescribed in s12 of the Local Government Act 2002. There is however no staff delegation to dispose of land.
- 6.3 Other Legal Implications:
- 6.3.1 There is no legal context, issue, or implication relevant to this decision Strategy and Policy Considerations.
- 6.4 The required decisions:
- 6.4.1 Align with the [Christchurch City Council's Strategic Framework](#). Community Outcomes – Manage ratepayers' money wisely.
- 6.4.2 Are assessed as low significance based on the Christchurch City Council's Significance and Engagement Policy. The level of significance was determined by evaluation of the need to retain ownership of the land given its size situation and shape.
- 6.4.3 Are consistent with Council's Plans and Policies. Disposal of Surplus Property – There is no other logical purchaser.
- 6.5 This report is consistent with the [Council's Long Term Plan \(2024 - 2034\)](#).

### Community Impacts and Views Ngā Mariu ā-Hāpori

- 6.6 There are no community impacts in this decision. The significance was assessed as being of low significance and therefore community views are unknown.
- 6.7 The decision affects the following wards/Community Board areas:
- 6.7.1 Harewood ward.
- 6.8 The Community Boards view has not been canvassed ahead of this report.

### Impact on Mana Whenua Ngā Whai Take Mana Whenua

- 6.9 The decision does not involve a significant decision in relation to ancestral land, a body of water or other elements of intrinsic value, therefore this decision does not specifically impact Mana Whenua, their culture, and traditions.

- 6.10 The decision does not involve a matter of interest to Mana Whenua and will not impact on our agreed partnership priorities with Ngā Papatipu Rūnanga.
- 6.11 The land has no customary uses or ongoing mana whenua activities and does not impact Mana Whenua.



### **Climate Change Impact Considerations Ngā Whai Whakaaro mā te Āhuarangi**

- 6.12 The decisions in this report are likely to:
- 6.12.1 Have no impact on the adaptation to the impacts of climate change.
  - 6.12.2 Have no impact to emissions reductions.
- 6.15 The proposals in this report are unlikely to contribute significantly to adaptation to the impacts of climate change or emissions reductions.
- 6.16 No significant impacts are anticipated because there is no change in the nature of the land, it is only the underlying ownership that changes.

## **7. Next Steps Ngā Mahinga ā-muri**

- 7.1 Survey the land.
- 7.2 Transfer to the adjoining owners and.
- 7.3 Issue titles.

## **Attachments Ngā Tāpirihanga**

No.	Title	Reference	Page
A 	304/7050 SO 570152 Diagram	25/2349079	76
B 	304/7050 Upper Styx ODP	25/2349184	77

In addition to the attached documents, the following background information is available:

Document Name – Location / File Link
Not applicable

## **Signatories Ngā Kaiwaitohu**

<b>Author</b>	Sarah Stuart - Property Consultant
<b>Approved By</b>	Angus Smith - Manager Property Consultancy Gavin Hutchison - Head of Three Waters Brent Smith - General Manager City Infrastructure

T 1/3

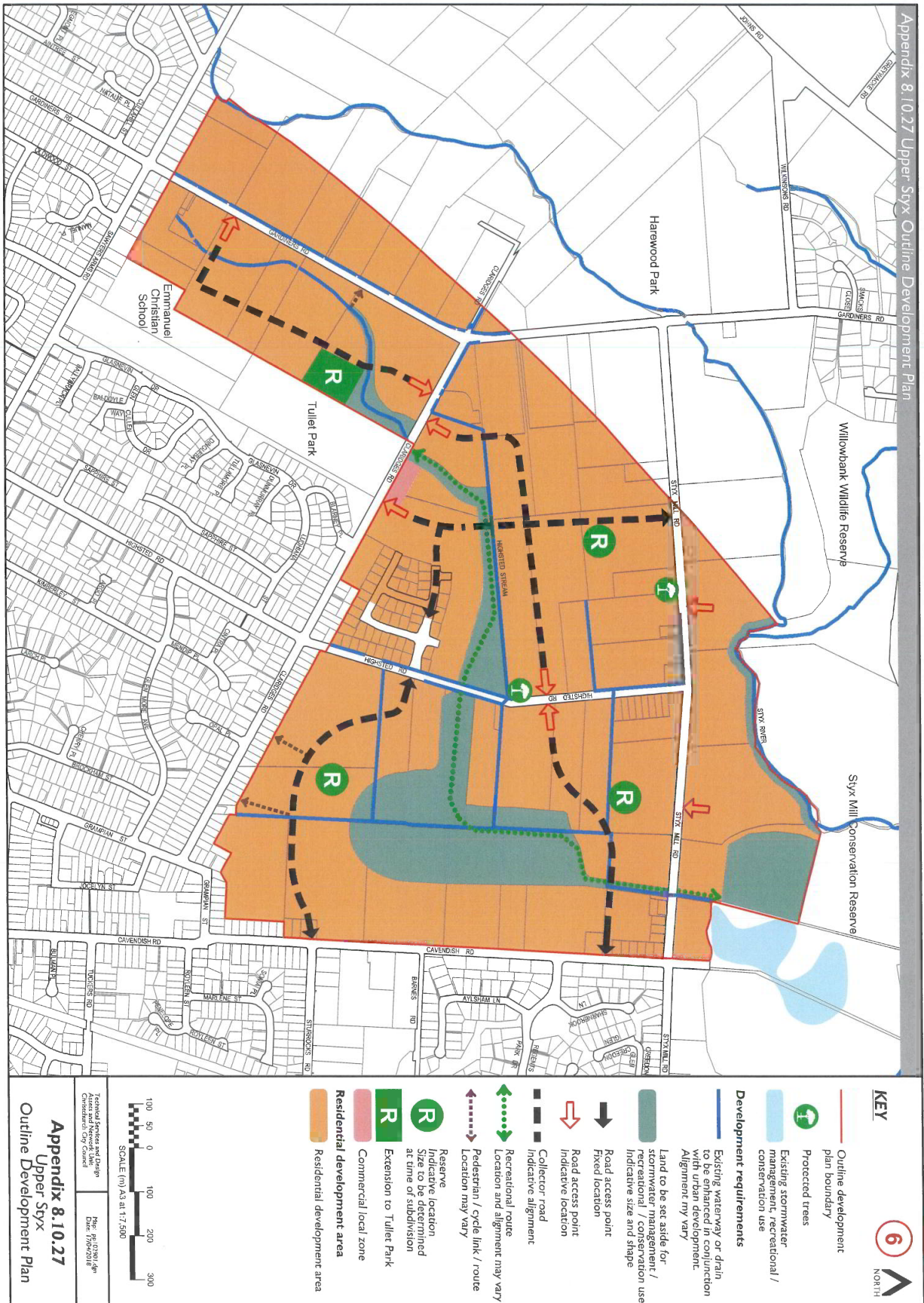





## 14. Waimāero Fendalton-Waimairi-Harewood Community Board Area Report - February 2026

Reference Te Tohutoro: 26/55629

Responsible Officer(s) Te Maryanne Lomax, Community Governance Manager,  
Pou Matua: maryanne.lomax@ccc.govt.nz

Accountable ELT Andrew Rutledge, General Manager Citizens and Community  
Member Pouwhakarae:

### 1. Purpose of Origin of the Report Te Pūtake Pūrongo

- 1.1 This report provides the Board with an overview of initiatives and issues current within the Community Board area.
- 1.2 This report is staff-generated monthly.

### 2. Officer Recommendations Ngā Tūtohu

That the Waimāero Fendalton-Waimairi-Harewood Community Board:

1. Receives the information in the Waimāero Fendalton-Waimairi-Harewood Community Board Area Report - February 2026.

### 3. Community Support, Governance and Partnership Activity

#### 3.1 Community Governance Projects

##### 3.1.1 Summer with your Neighbours

Summer with your Neighbours events are well underway, with events taking place during the period of 25 October 2025 to 30 March 2026.

The Board approved funding towards 31 events at their meeting held on Monday 8th September 2025.

Following the events taking place, the applicants are required to complete a form on which they are asked to identify the benefits of their event being held, from some of the forms returned thus far we have heard:

- “Having a close neighbourly bond for support” - Zara, from the Fendalton Ward area.
- “New neighbours meeting everyone” - Peter, from the Waimairi Ward area.
- “Connections with our neighbours” - Truss, from the Harewood Ward Area.



Event at Papparika Reserve, Bishopdale

3.1.2 **Fendalton-Waimairi-Harewood Community Liaison Meeting - End of year 'Thank You' Breakfast**

The annual thankyou breakfast saw around 30 people gather in the Ōrauwhata Bishopdale Community Hall.

We started with a cultural quiz testing knowledge about NZ and other cultures. The winning table got to go and get their breakfast first.

The Community Board Deputy Chair, Nicola McCormick, talked about the great contribution the organisations all make to our communities, thanking them all for their hard work and the care they give. Our communities are so much better off because of the work they do in and with them.

The rest of the session was spent networking and sharing. Some key new connections were made and partnership projects discussed. A few keen people popped out afterwards to have a go on the outdoor table tennis table installed on the Bishopdale Village Green.

The table tennis table was the result of a request from the public. The Community Board provided funding through the Better-Off Fund and the library next door has some bats and balls available for use.





### 3.1.3 Coutts Island Residents Preparedness Meeting

Our Community Development Adviser, Natalie Dally, attended the Belfast Area Residents' Association (BARA) meeting on 20 January 2026 at the Belfast Rugby Clubrooms for residents of Coutts Island to look at an area evacuation plan. A survey was circulated prior to the meeting to find out what residents wanted to know.

It was a very successful meeting with speakers and attendees from Regional and Local Civil Defence Emergency Management, Environment Canterbury and Fire and Emergency New Zealand. It was a chance to get an overview of how things work and who is responsible for and will do, what, in the event of flooding and fires in the area.

The main takeaway, as always, is to make sure you have your own household evacuation plans and preparations in place for any eventuality. You have to do what's right for your safety in any emergency, don't wait for any official response.

Civil Defence and FENZ both have resources to help with this planning and FENZ will come out and work through things with you. When an event triggers a civil defence response, there will be notices on websites. Mobile alerts will be sent out when there are emergency events to those phones in the area of the event (as dictated by cell phone tower connections).

The next steps from here will be looking at a community evacuation/emergency response plan. BARA will be co-ordinating this and involving the appropriate people in the development of this as it progresses. The team from the Belfast Community Network were also on hand to offer their support in terms of developing the plan based on their experiences and how they could help. They have delivered the Belfast Area Response Plan (BERP) to Coutts Island residents as part of this.



### 3.1.4 Burnside & Bryndwr Community Engagement - Key Findings and Next Steps

Between June and September 2025, the Burnside Bryndwr Community Network (BBCN) undertook a community engagement process to better understand how residents connect, participate, and access information and activities across Burnside and Bryndwr.

Feedback was gathered from over 1,400 residents, including families, long-term residents, newcomers, and Mandarin-speaking households. This included hearing directly from just under 600 young people through school-based surveys and engagement. Survey material was delivered to approximately 5,500 households, supported by schools, libraries, and community partners.

### Key findings

Overall, the engagement confirms strong community foundations, alongside clear opportunities to strengthen inclusion and participation.

Key themes included:

- Strong neighbourhood friendliness and connection, particularly where informal neighbour networks exist.
- High value is placed on parks, libraries, schools, sports, and cultural activities.
- Uneven awareness of local activities and services, especially among newcomers, younger adults, and Mandarin-speaking residents.
- Common barriers to participation include time, cost, transport, safety concerns, language, and access to information.
- Young people seek safe, flexible, and creative spaces, and more influence over activities and spaces.
- Families valuing affordable, practical supports and family-friendly events, particularly outside school hours.
- Mandarin-speaking residents prefer bilingual or Mandarin-first communication and clearer pathways into community life.

### Local differences

While many themes were shared across Burnside and Bryndwr, some local differences were noted. Bryndwr respondents reported stronger informal neighbour connections and greater cultural diversity, while Burnside respondents included more long-term residents and highlighted communication gaps despite strong local facilities. These differences reinforce the value of flexible, place-based approaches rather than a one-size-fits-all response.

### Community voices

Short quotes below illustrate the themes raised across the engagement:

- *“We need spaces where we can just be ourselves.”* (Youth)
- *“More community events would help people meet each other.”* (Resident)
- *“Receiving community news in my language makes it easier to participate.”* (Mandarin-speaking resident)

### Indicative next steps

The findings provide a strong evidence base to inform future planning. BBCN intends to explore and support, alongside partners where appropriate, actions to strengthen connection, inclusion, and participation.

#### 3.1.5 **Englefield Nature Play Space Renewal - Fixtures installed/Play started**

The community-led renewal of the Nature Play Space at Englefield Reserve saw stepping logs, tables, a where and balance beams installed mid-December.

The Styx Living Laboratory Trust cleaned up a heap of willow cuttings regrowth and some weed eating around the area has seen the space come more alive especially as the local community is ‘discovering’ this new addition to the community.

There will be an official ‘welcome to the community’ event held in conjunction with the advisory group, particularly the Northwood Residents Association, in the coming months.

Pūtahi Belfast School will be using the space as an activity area for school projects etc when they come back to school for the 2026 year. Their leadership team who helped with the consultation will have a special visit to the space to kick this off. Both the resident associations and school will be informal, community-based kaitiakitanga of the site.

Discussions around educational/interactive signage for the space is ongoing, allowing the design and content to be further informed by the use of the space. There has been no shortage of ideas and excitement for additions and steady use of the space in the afternoons.





### 3.2 Community Funding Summary

- 3.2.1 A status report on the Board's 2025-26 Discretionary Response Fund and Youth Development Fund as at 20 January 2026 is attached (refer to **Attachment A**).
- 3.2.2 Youth Development Funds approved under delegation of Community Governance Manager:
- Sione Havea - China Study Tour - \$400
  - Cameron Smillie - Auckland Orchestra Summer School - \$150

### 3.2.3 Gordon Scout Den - Heat Pump/Air Conditioning Replacement

The Community Board provided some funding through their Better-Off Fund to the Gordon Scout group following the vandalism at their facility where their heat pump/air conditioning units were stripped.

They now have new pumps and have had them mounted high on the wall to deter further issues. They have cages coming for extra projects. They also have two new cameras mounted on the rear of the building - these have already helped to catch a couple of people who cut through the LPG cage and stole their gas bottles. They will also be installing additional lighting.



### 3.2.4 Youth Development Fund report back - Full Force Hip Hop Crew

The Waimāero Fendalton-Waimairi-Harewood Community Board provided funding from their Youth Development Fund to Barnaby Domigan from Burnside to participate in the Hip Hop Unite World Championships in Prague. Please see feedback below from the manager of the team:

The crew really had a fabulous time on this trip. They learnt to push themselves under pressure and overcome nerves and were exposed to numerous top level crews from Europe and South Africa. It was really interesting to see the preference for the high energy, cheerful hip hop styles in Europe, in contrast to the more "gansta" and aggressive styles and also the focus on very relaxed moves. The competition itself was extremely professionally run. Being part of Team NZ was an amazing

experience. The children got to know the other NZ dancers and proudly performed a waiata and haka during the opening of the finals session. The children also participated in two workshops with dancers from Brazil and Portugal.

We were really pleased with how everyone danced. We entered a cadet crew of 9-12 year olds, a cadet duo aged 10 and 12, and an adult duo which included my daughter Keisha who coaches the children, along with another dance teacher from Swam Selwyn. Everyone made it to the semifinal round and our cadet duo made it to finals! Results were: The Cherries (adult duo) 8th, Full Force (cadet crew 9th), and Force Field 6th in each of their divisions.

As well as the dance experience, the children found time to do some sightseeing. We were all amazed at the history in Prague with some buildings dating back to the Medieval Period. We visited a castle, markets, and a famous bridge, as well as fitting in some shopping. One family also visited a Jewish concentration camp. An added bonus was that some of the children had family or friends living in Poland, Switzerland, The Netherlands and Dubai and several of them came to watch the children compete and spend time with them. Our 9 year old reserve met her Polish grandparents for only the second time, which was very special!

On our return to NZ, the crew started preparing for their Christmas in the Park performance. They performed last night in front of 10s of thousands of people and had a fabulous experience. They have the dance school recital in two weeks and start preparing for the 2026 HHU nationals this week. World Champs are in NZ next year.

The other crews from our dance school have been very supportive of Full Force and I can see that their success has really impacted these dancers who are now training harder and aiming higher than ever before. They know now that anything is possible with the right mindset and hard work.

Once again, a huge thank you for your contributions to this amazing experience.



*Barnaby Domigan - third from the left.*

### 3.3 Participation in and Contribution to Decision Making

#### 3.3.1 Report back on other Activities contributing to Community Board Plan

The final monitoring report for the Board's 2023-25 Board Plan was included in the July 2025 Area Report. The Board held a workshop on 2 February 2026 to begin developing the 2026-28 Community Board Plan.

#### 3.3.1 Council Engagement and Consultation

- **Radcliffe Road improvements** - consultation is open regarding planned upgrades for Radcliffe Road in Belfast. Council is proposing to:
  - install a footpath from the railway line to the Christchurch Northern Corridor shared path, as well as up Blakes Road
  - make safety improvements to the intersection with Blakes Road
  - upgrade the rail crossing









You can view the consultation information and provide feedback by visiting <https://letstalk.ccc.govt.nz/radcliffe-road> Feedback closes on 17 February 2026.
- A full list of open consultations city-wide is available at <https://letstalk.ccc.govt.nz/>

## 4. Advice Provided to the Community Board Ngā Kupu Tohutohu ka hoatu ki te Poari Hapori

- 4.1 Customer Service Request Report - Hybris monthly report for December 2025 attached, providing an overview of the number of Customer Service Requests that have been received, including the types of requests being received and a breakdown of how they are being reported (refer to **Attachment B**).
- 4.2 Fendalton-Waimairi-Harewood Graffiti Snapshot - December 2025 (refer to **Attachment C**).
- 4.3 SWN - Harewood Road - traffic signals and water upgrades (*circulated 8 December 2025*)
- 4.4 SWN - Harewood Road - traffic signals and water upgrades - Super week information (*circulated 15 December 2025*)
- 4.5 SWN - Greers Road - road rehabilitation (*circulated 19 December 2025*)
- 4.6 SWN - Hyde Park - play space construction (*circulated 12 January 2026*)
- 4.7 SWN - Idris Road/Wairakei Road - signal upgrades (*circulated 23 January 2026*)
- 4.8 Road maintenance letter - School Road (*circulated 16 January 2026*)
- 4.9 Road maintenance letter - Papanui Road (*circulated 16 January 2026*)
- 4.10 Road maintenance letter - Ilam Road marking changes (*circulated 16 January 2026*)
- 4.11 Road maintenance letter - Wilkinsons Road (*circulated 23 January 2026*)
- 4.12 Road maintenance letter - Sapphire Street (*circulated 23 January 2026*)
- 4.13 Road maintenance letter - Cleland Street (*circulated 23 January 2026*)
- 4.14 Road maintenance letter - Clissold Street (*circulated 23 January 2026*)
- 4.15 Road maintenance letter - School Road amended (*circulated 23 January 2026*)
- 4.16 Road maintenance letter - Marshlands Road (*circulated 23 January 2026*)

- 4.17 Road maintenance letter - Grahams Road (*circulated 23 January 2026*)  
4.18 MEMO - Wairakei Road intersections (refer to **Attachment D**)

### Attachments Ngā Tāpirihanga

No.	Title	Reference	Page
A  	Fendalton-Waimairi-Harewood Board Funding Update - February 2025	26/56615	88
B  	Fendalton-Waimairi-Harewood Hybris Ticket Report - December 2025	26/123219	89
C  	Fendalton-Waimairi-Harewood Graffiti Snapshot - December 2025	26/150526	90
D  	Wairakei Road Intersections - Memo to Elected Members - January 2026	26/149785	92

### Signatories Ngā Kaiwaitohu

<b>Author</b>	Maryanne Lomax - Manager Community Governance, Fendalton-Waimairi-Harewood
<b>Approved By</b>	Matthew McLintock - Manager Community Governance Team John Filsell - Head of Community Support and Partnerships



Board Funding Update

as at 21/01/2026

Fendalton-Waimairi-Harewood Discretionary Response Fund	Allocation 2025-26	Board Approval (Date)
Budget 2025-26		
Carried Over from 2024-25	\$ 52,654	
Remaining Funds from SCF 2025-26	\$ 112,854	
Total for 2025-26 Financial Year	\$ 165,508	
Allocations made		
Youth Development Fund - Opening Balance allocation	\$ 12,000	
Allocations made (by the Board)		
Delegation: Community Governance Manager Fendalton-Waimairi-Harewood to approve YDF applications up to \$500		
Anna Lee School of Dance (Barnaby Domigan - Hip Hop Unite World Champs)	\$ 200	13-Aug-25
Olivia Zeng (Youth American Grand Prix Competition - Sydney)	\$ 250	13-Aug-25
Neve Hendry (Rhythmic Gymnastics National Championships)	\$ 100	13-Aug-25
Jordan Whittleston (Johor Cup Hockey Tournament)	\$ 400	26-Aug-25
Hamish Giddens (Royal Ballet School London)	\$ 500	26-Aug-25
Charlie Helmore (Spirit of Adventure)	\$ 250	15-Sept-25
Empire Senior Marching Team (National Marching Event in Wellington)	\$ 150	24-Oct-25
Jessica Willetts (NZ Secondary Schools Touch Tournament in Rotorua)	\$ 200	24-Oct-25
Sione Havea (China Study Tour)	\$ 400	5-Dec-25
Cameron Smillie (Auckland Orchestra Summer School)	\$ 150	16-Jan-26
Youth Development Fund Balance - Available for allocation	\$ 9,400	
Discretionary Response Fund - Total Allocation	\$ 165,508	
Celebrate Bishopdale 2025 (Board Project)	\$ 8,000	11-Aug-25
2025-26 Youth Development Fund (Board Project)	\$ 12,000	11-Aug-25
Summer with your Neighbours (Board Project)	\$ 3,500	11-Aug-25
Garden Pride Awards 2026	\$ 3,750	11-Aug-25
Youth Events and Activities (Board Project)	\$ 6,000	11-Aug-25
Community Liaison Meetings (Board Project)	\$ 2,000	11-Aug-25
Youth Achievement Event (Board Project)	\$ 2,500	11-Aug-25
St Mark's Presbyterian Church (Chairs and handrail)	\$ 4,000	11-Aug-25
St Christopher's Anglican Church (Security cameras)	\$ 2,000	11-Aug-25
Avonhead Community Trust (Community Expo)	\$ 1,748	8-Sept-25
Burnside Squash Rackets Club Inc (Court flooring)	\$ 12,000	8-Dec-25
St Margaret's Presbyterian Church Bishopdale (Heat pumps)	\$ 5,000	8-Dec-25
Yaldhurst School Tōtara Tūkaha (Community pool swipe card system)	\$ 4,526	8-Dec-25
Anglican Diocese of Christchurch Parish of Burnside Harewood (Kia Ora Burnside - Connect@Kendal)	\$ 2,900	8-Dec-25
Kiribati Federation Aotearoa Inc (Saturday Night Sport project)	\$ 1,500	8-Dec-25
Discretionary Response Fund Balance	\$ 94,084	

Ticket Report  
01 12 2025 - 31 12 2025

Filter by Ward

Fendalton-Waimairi-Harewood

Filter by month

2025 (Year) + December (Month)

2718

# Reported Tickets last month

83.55%

Resolved within SLA

Channels

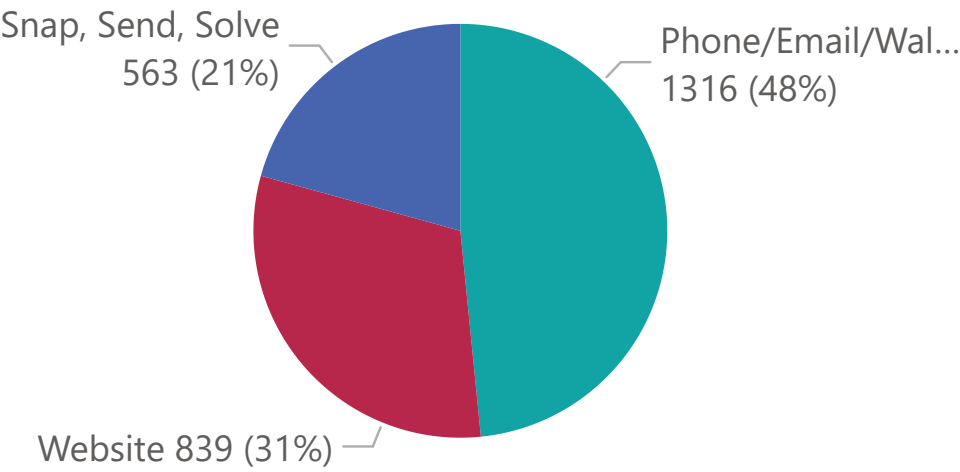

Status as of Report Date

Closed/Resolved

73.47%

Open

24.36%

Programmed Work

2.17%

Top 10 Incident Categories

Fendalton Harewood Waimairi

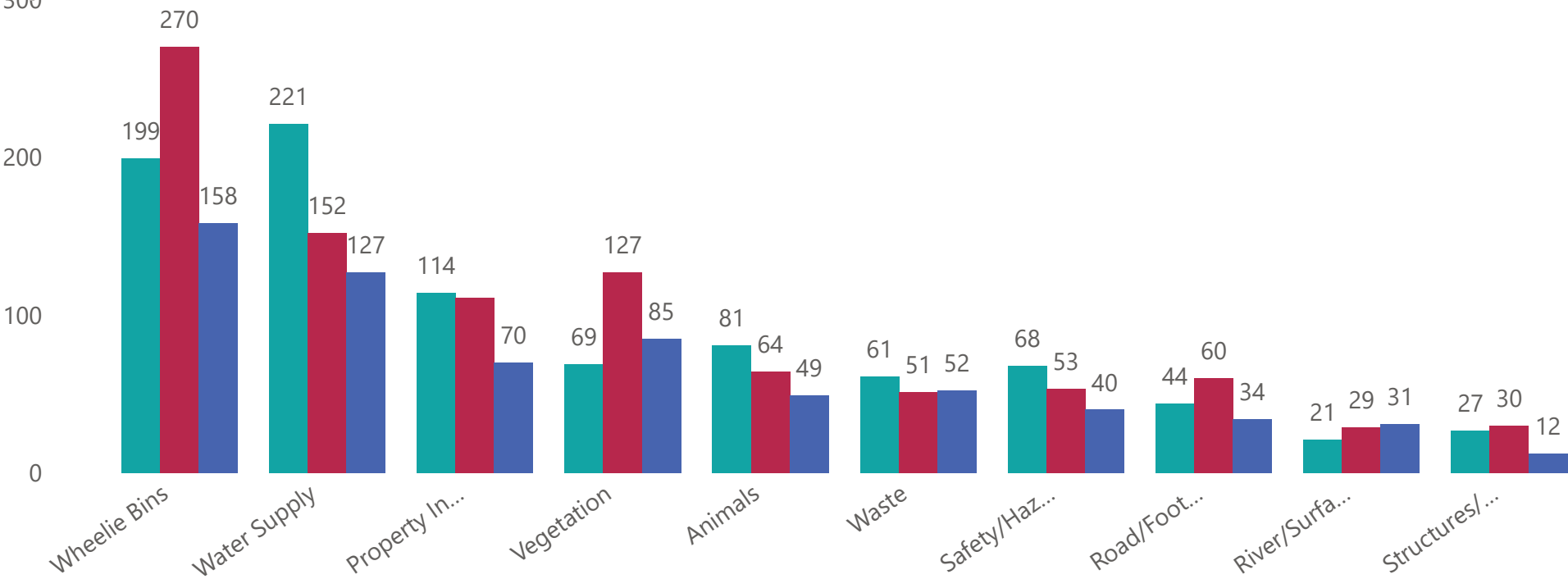

Top 10 Object Categories

# Tickets	ObjectCategory	+/- Previous Month
303	Water Leak	21
244	Bin Not Collected	-14
214	Damaged Bin	-55
186	Trees	48
127	Litter	-32
115	Residential LIM	-4
106	Residential Property Files	-90
82	Water Supply	20
64	Blockage/Water Not Draining	32
61	Missing Bin	4

Report date:  
13 Jan 2026

## Graffiti Insight

Fendalton-Waimairi-Harewood

December 2025

graffiti  
PROGRAMME

### By Ward

Ward	# of Tickets - Latest Month	# of Tickets - Previous Month	% Monthly Change	Cleaned Graffiti Square Metres
Fendalton	24	27	11% ●	58
Waimairi	6	15	60% ●	1
Harewood	24	20	20% ●	91

### By Suburb

Suburb	# of Tickets - Latest Month	# of Tickets - Previous Month	% Monthly Change	Cleaned Graffiti Square Metres
Bishopdale	8	8	0% ○	25
Bryndwr	4	7	-43% ●	7
Belfast	3	9	-67% ●	2
Harewood	3	5	-40% ●	1
Burnside	5	2	-60% ●	7
Fendalton	11	5	120% ●	31
Avonhead	2	6	-67% ●	6
Ilam	4	3	33% ●	2
Merivale	4	3	33% ●	12
Russley	0	4	-100% ●	
Styx	7	3	133% ●	4

Reporter Type	Total
Non Volunteer	40
Individual Volunteer	9
Friend Volunteer	2
Group Volunteer	3

## Graffiti Insight

Fendalton-Waimairi-Harewood  
Map View

December 2025

graffiti  
PROGRAMME

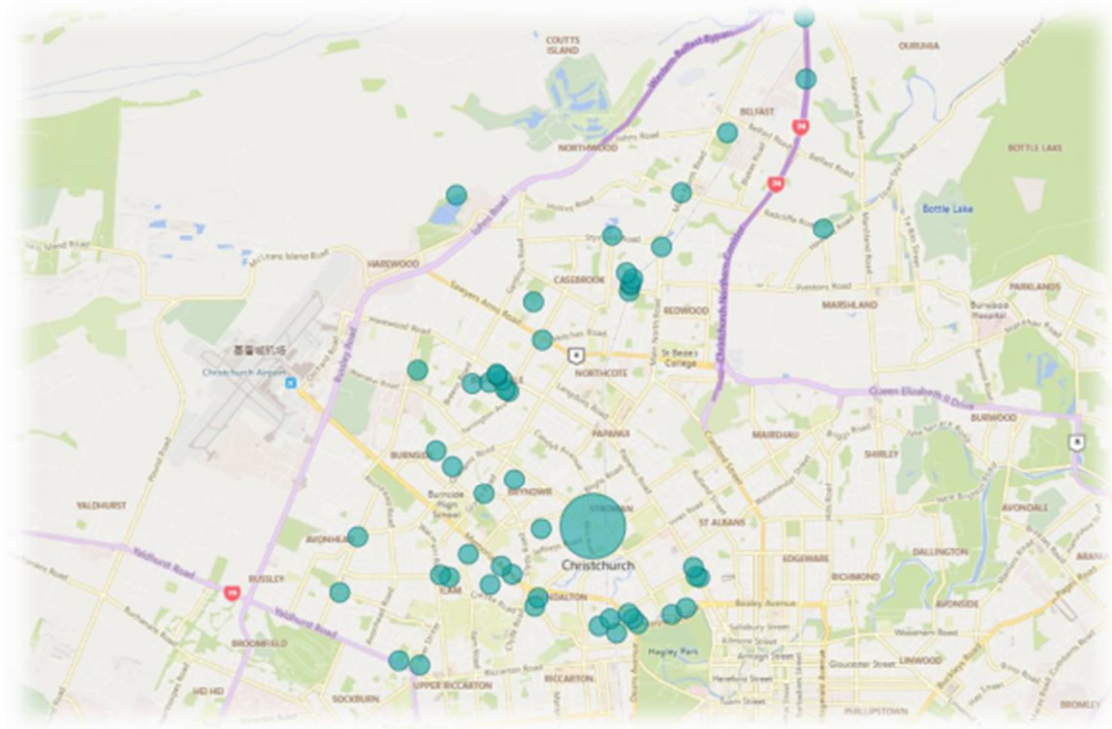

## Yearly Overview



Item 14

Attachment C

Memos



# Memo

Date: January 2026  
From: Gemma Dioni, Principal Advisor Transport  
To: Mayor and Councillors  
Waimāero Fendalton-Waimairi-Harewood Community Board  
Waipapa Papanui-Innes-Central Community Board  
Cc: Executive Leadership Team  
Reference: 26/125034

## Wairakei Road Intersections

### 1. Purpose of this Memo Te take o tēnei Pānui

- 1.1 The purpose of this memo is to advise you of an upcoming programme of works on Wairakei Road to support the infrastructure upgrades in the city's northwest.
- 1.2 The information in this memo is not confidential and can be made public.

### 2. Update He Pānui

- 2.1 We're upgrading water infrastructure and roads in the city's northwest to make sure these essential services continue to meet the needs of our growing communities. To support these works, it is proposed to introduce a right turn phase from Grahams Road into Wairakei Road and from Wairakei Road into Idris Road, as well as changes to the layout at the Wairakei Road Railway Crossing.
- 2.2 Only minor hardware changes are required to facilitate the phase changes at the Grahams Road/Wairakei Road intersection, which includes changing the signal lanterns on the Grahams Road approaches.
- 2.3 At the Idris Road/Wairakei Road intersection, we are undertaking a full upgrade of the traffic signals. This includes underground cables, new signal poles and lanterns, as these critical assets are at the end of their working life and need to be replaced before a right turn phase can be introduced. The upgrade will also include minor safety improvements for people walking and crossing. This will be through new kerb cutdowns to align with new pole locations and improved road markings. This will provide increased separation between crossings.
- 2.4 At the Wairakei Road Railway Crossing, we are undertaking a full upgrade of the traffic signals. This includes underground cables, new signal poles and lanterns, as these critical assets are at the end of their working life and need to be replaced. Completing this work prior to the road being resurfaced will minimise any re-work through trenching across the new surface. In addition, we will also make changes to the entrance into Jeffreys Road to increase the amount of waiting space for people using the Puari ki Pū-harakeke-nui Northern Line cycleway.
- 2.5 A contractor has been engaged for the work at these locations. You may see some activity this week while they complete some on-site investigations to help with the cable design and identifying new signal pole locations.

**Memos**



- 2.6 It is proposed to commence the upgrade works at the Idris Road/Wairakei Road intersection on 2 February 2026. This will be followed by works starting at the Railway Crossing the following week. The changes to the lanterns at the Grahams Road/Wairakei Road intersection will be completed last, as this will only be one night of work.
- 2.7 Residents and businesses will be informed of the works occurring, and we will continue to update the local community, so they are aware of the impacts on their journeys.

**3. Conclusion Whakakapinga**

- 3.1 Staff have identified an opportunity to deliver improvements on Wairakei Road to support drivers travelling on the network through the nearby three waters and roading projects being delivered in the northwest of the city. In addition, we will upgrade signal assets that are at the end of life and prior to the carriageway being resurfaced.

**Attachments Ngā Tāpirihanga**

There are no attachments to this memo.

**Signatories Ngā Kaiwaitohu**

<b>Authors</b>	Gemma Dioni - Principal Advisor Transportation Safety Nikki Douglas - Senior Communications Advisor
<b>Approved By</b>	Stephen Wright - Manager Operations (Transport)



## 15. Elected Members' Information Exchange Te Whakawhiti Whakaaro o Te Kāhui Amorangi

This item provides an opportunity for Board Members to update each other on recent events and/or issues of relevance and interest to the Board.

### Karakia Whakamutunga

Unuhia, unuhia Unuhia ki te uru tapu nui Kia wātea, kia māmā, te ngākau, Te tinana te wairua i te ara takatā Koia rā e Rongo, whakairia ake ki runga Kia tina! TINA! Hui e! TĀIKI E!	<i>Draw on, draw on, Draw on the supreme sacredness To clear, to free the heart, the body and the spirit of mankind Rongo, suspended high above us (i.e. in 'heaven') Draw together! Affirm!</i>
---	--

Actions Register Ngā Mahinga

When decisions are made at meetings, these are assigned to staff as **actions** to implement. The following lists detail any actions from this meeting that were:

- Open at the time the agenda was generated.
- Closed since the last ordinary meeting agenda was generated.

Open Actions Ngā Mahinga Tuwhera

REPORT TITLE/AGENDA SECTION	MEETING DATE	ACTION DUE DATE	UNIT	TEAM
Waimakariri Stopbanks	6 March 2023	27 February 2026	Three Waters	Asset Planning Water & Wastewater
Waimāero Fendalton-Waimairi-Harewood - Better-Off Fund Applications for Consideration - Anglican Diocese of Christchurch - Parish of Merivale St Albans; Riccarton Sports Hub Trust	8 December 2025	9 March 2026	Community Support & Partnerships	Governance (Fen-Wai-Har)
Easement Over Recreation Reserve - 82 Glenturret Drive	8 September 2025	8 April 2026	Facilities & Property Unit	Property Consultancy
Public Forum - Nicholas Tyler	9 June 2025	1 May 2026	Transport & Waste	Traffic Operations
Proposed P120 Parking Restrictions - Staveley Street	8 December 2025	14 December 2026	Transport & Waste	Traffic Operations
Bryndwr Road Street Renewal	8 September 2025	30 June 2027	Transport & Waste	Project Management

Actions Closed Since the Last Meeting Ngā Mahinga kua Tutuki nō Tērā Hui

REPORT TITLE/AGENDA SECTION	MEETING DATE	DUE DATE	ACTION CLOSURE DATE	UNIT	TEAM
Public Forum - Mark Smith	9 June 2025	5 January 2026	15 December 2025	Transport & Waste	Traffic Operations
23 Holmwood Rd - Road Stopping Application	11 August 2025	30 January 2026	3 February 2026	Facilities & Property Unit	Property Consultancy
Groynes Boat Hire- Proposed New Licence- The Groynes	8 September 2025	8 December 2025	8 December 2025	Facilities & Property Unit	Property Consultancy
Athol Terrace - Proposed No Stopping Restrictions	8 December 2025	9 March 2026	16 January 2026	Transport & Waste	Traffic Operations
Clyde Road Parking Restrictions	8 December 2025	9 March 2026	20 January 2026	Transport & Waste	Travel Demand Management
Community Parks Rolling Renewal Programme	8 December 2025	9 March 2026	16 December 2025	Parks	Community Parks
Fendalton-Waimairi-Harewood 2025-2026 Discretionary Response Fund Applications - Burnside Squash Rackets Club Incorporated, St Margaret's Church, Yaldhurst School, Anglican Diocese of Christchurch Parish of Burnside Harewood, Kiribati Federation Aotearoa Incorporated	8 December 2025	9 March 2026	9 December 2025	Community Support & Partnerships	Governance (Fen-Wai-Har)
Governance Matters	8 December 2025	9 March 2026	10 December 2025	Community Support & Partnerships	Governance (Fen-Wai-Har)
Proposed Road Name - 132 Claridges Road, Styx	8 December 2025	9 March 2026	15 December 2025	Planning & Consents	Resource Consents
Proposed Road Names - 130 Styx Mill Road and 244 Gardiners Road	8 December 2025	9 March 2026	15 December 2025	Planning & Consents	Resource Consents
Tree Removal in Bishopdale Mall	8 December 2025	9 March 2026	2 February 2026	Parks	Botanic and Garden Parks