

**Waipapa Papanui-Innes-Central Community Board  
Information Session/Workshop  
MINUTES ATTACHMENTS**

---

**Date:** Thursday 12 June 2025  
**Time:** 6.07 pm  
**Venue:** Board Room, Papanui Service Centre,  
Corner Langdons Road and Restell Street, Papanui

---

<b>TABLE OF CONTENTS NGĀ IHIRANGI</b>	<b>PAGE</b>
<b>2. Lancaster Park Development - update on playspace development</b>	
A. Staff Presentation - Lancaster Park Development .....	3
<b>3. Project Update on Grassmere Infrastructure Projects</b>	
A. Staff Presentation - Grassmere Infrastructure Projects.....	12

---



# Lancaster Park Development Project update

12 June 2025

## Community Centre and changing rooms

- four months into construction
- estimated completion October 2025



## Multi-sport zone and cricket practice nets

1. Multi-sport zone suitable for basketball and futsal
2. Fully enclosed 2-bay artificial turf cricket practice nets for general public use
3. Separate natural turf practice cricket block to be built by and for Lancaster Park Cricket Club

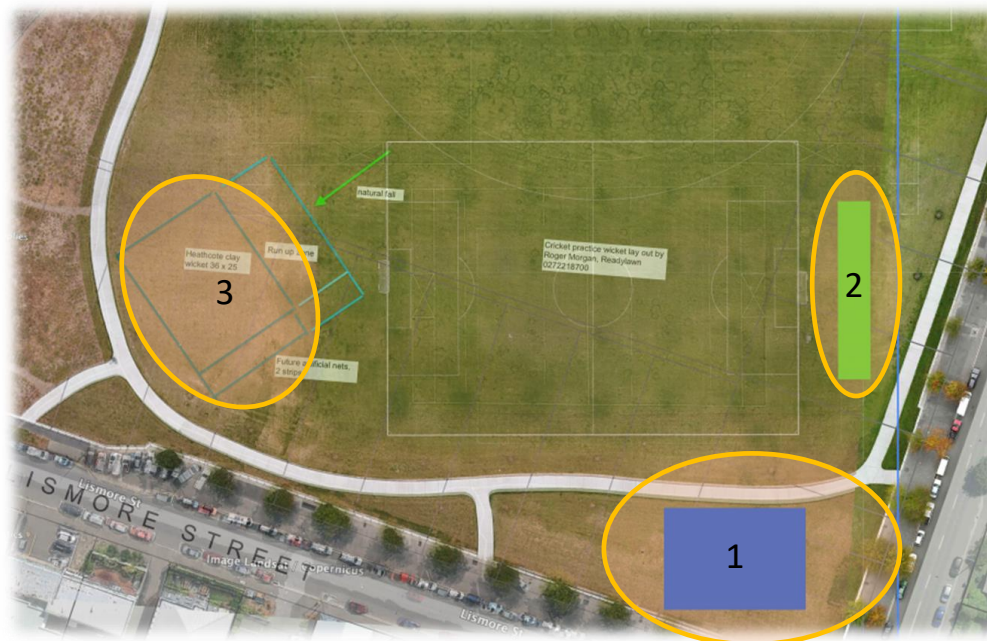



## Play space development

### Current Status

- Consultation taken into consideration for the design include:
  - Lancaster Park public consultation in August 2022
  - Cross Reserve Play Space Renewal consultation in April 2025
- The concept design represents the vision for the new play space, incorporating
  - Community and stakeholder feedback,
  - interpretative elements capturing the rich sporting history of Lancaster Park as well as
  - play opportunities catering to all age groups and all abilities



## Play space development

- An analysis of the available space has helped to structure the various play areas:
  - Passive recreation areas will invite visitors to gather and relax hosting picnic tables and shade
  - A junior zone will be focused on play options for younger children
  - A senior zone will cater for a wider range of children and allow “high-energy” play
  - A senior/adult zone caters for older children (teenagers) that appreciate some separation from younger children
- These play areas are indicative and may shift subject to changes to the concept design.
- The play space design will be aligned with Community Centre and wider landscaping.

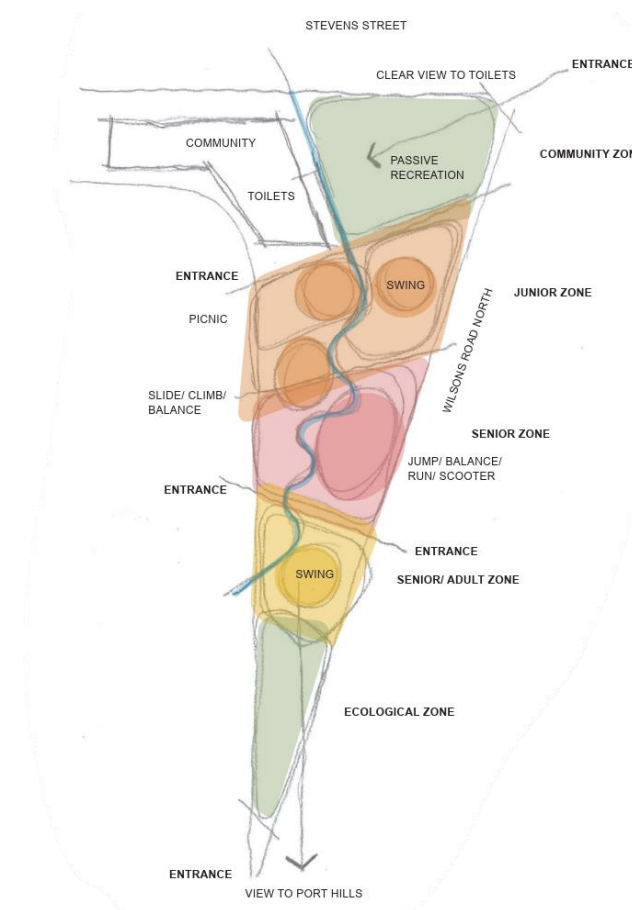

## Play space development – Draft Concept Design

### LANCASTER PARK PLAYSPACE CONCEPT

#### MAIN PLAY SPACE CONCEPT PLAN

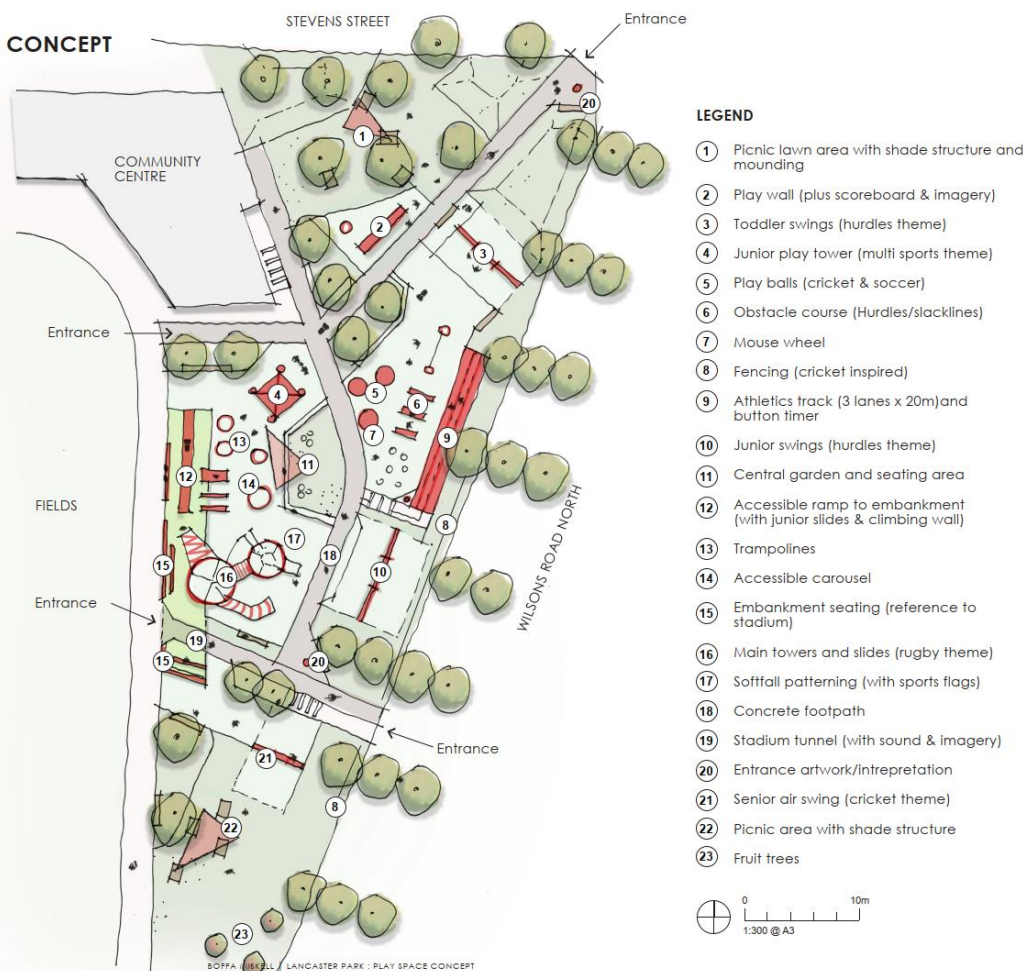



## Play space development – Draft Concept Design



## Play space development - Next steps

<ul style="list-style-type: none"><li>• Consultation<ul style="list-style-type: none"><li>• Determine engagement strategy</li><li>• Share concept design in line with strategy</li></ul></li><li>• Updates to concept design (as required)</li></ul>	Jun-Aug 2025
<ul style="list-style-type: none"><li>• Re-vised concept design<ul style="list-style-type: none"><li>• Community Board approval of concept design</li></ul></li><li>• Developed design<ul style="list-style-type: none"><li>• Incorporate feedback</li><li>• Investigate play equipment options</li><li>• Work with suppliers on bespoke equipment</li><li>• Refine playground layout and equipment placement</li></ul></li><li>• Detailed Design<ul style="list-style-type: none"><li>• Finalise design and prepare detailed drawings and specifications</li></ul></li></ul>	Sep-Nov 2025
<ul style="list-style-type: none"><li>• Procurement<ul style="list-style-type: none"><li>• Procurement of play equipment, furniture,...</li><li>• Construction works</li></ul></li></ul>	Dec 2025 - Mar 2026
<ul style="list-style-type: none"><li>• Construction works</li></ul>	TBC - 2026



# Any questions?

# Project Update

## Grassmere Infrastructure Projects

Waipapa Papanui-Innes-Central Community Board  
12 June 2025

# Agenda

## ▪Grassmere Development Background

- East Papanui Outline Development Plan
- Enabling Infrastructure Projects
- Infrastructure Acceleration Funding

## ▪EIP 1 – Collector Road

## ▪EIP 2 – Grassmere to Mays Water Supply Main

## ▪EIP 3 – Grassmere to Mays Water Supply Link

## ▪EIP 6 – Grassmere Wastewater Storage Facility



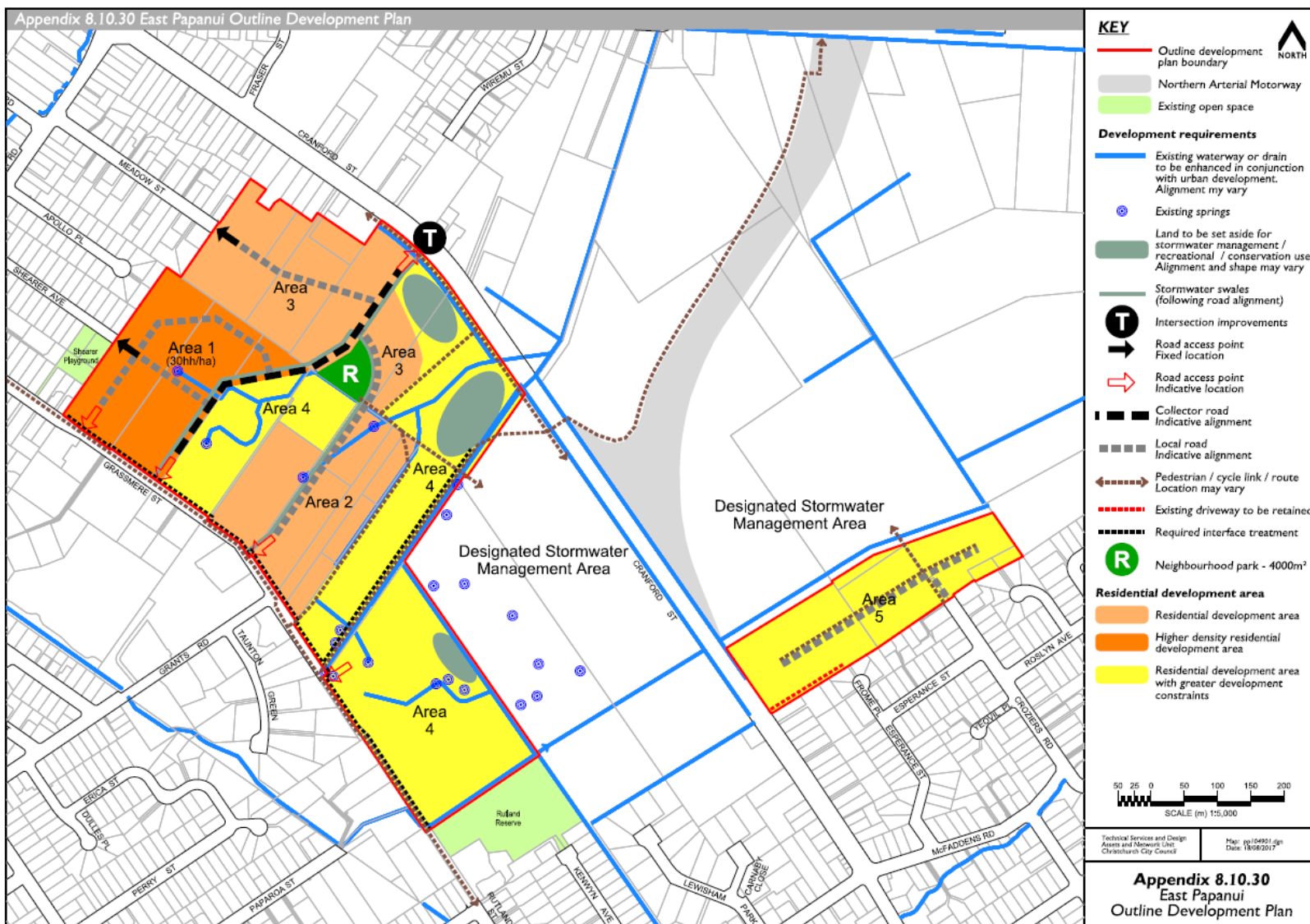







# Anticipated Project Timelines

- EIP 2 – Grassmere to Mays Water Supply Main
  - Subject to other Central Zone Water Supply Pump Station Shutdowns
  - End of June -> July 2025
- EIP 3 – Grassmere to Mays Water Supply Link
  - Subject to traffic management approval
  - 30 June – October 2025
  - Approximately five week impact on Cycleway



- EIP 6 – Grassmere Wastewater Storage Facility
  - February 2026 – Mid 2027

# Purpose of Storage Facility



- Discharges to Stream currently around 1.8 times per year
- Following installation of storage discharges are expected to be less than once every two years



# Concept Layout of Storage Facility

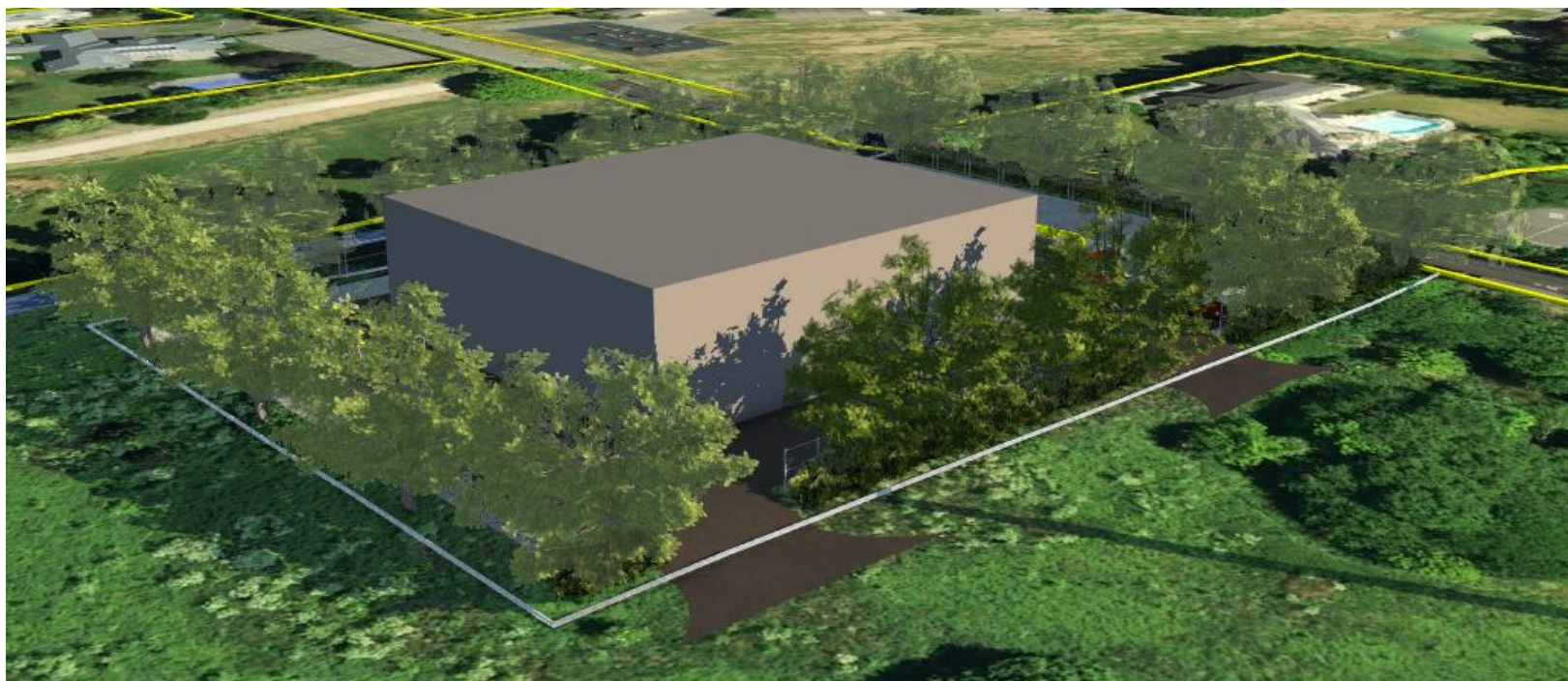



# Concept Layout of Storage Facility

