Waipuna Halswell-Hornby-Riccarton Community Board AGENDA

Notice of Meeting Te Pānui o te Hui:

An ordinary meeting of the Waipuna Halswell-Hornby-Riccarton Community Board will be held on:

Date: Thursday 10 April 2025
Time: 4.30 pm
Venue: Rārākau: Riccarton Centre,
199 Clarence Street, Christchurch

Membership Ngā Mema

Chairperson	Marie Pollisco
Deputy Chairperson	Helen Broughton
Members	Sarah Brunton
	Henk Buunk
	Tyla Harrison-Hunt
	Andrei Moore
	Debbie Mora
	Mark Peters

4 April 2025

Principal Advisor

Bailey Peterson
Manager Community Governance
Tel: 941 6743
Bailey.Peterson@ccc.govt.nz

Meeting Advisor

Faye Collins
Community Board Advisor
Tel: 941 5108
faye.collins@ccc.govt.nz

Website: www.ccc.govt.nz

Note: The reports contained within this agenda are for consideration and should not be construed as Council policy unless and until adopted. If you require further information relating to any reports, please contact the person named on the report.

To watch the meeting live, or a recording after the meeting date, go to:

<https://www.youtube.com/@waipunahalswell-hornby-ric5806/streams>

To view copies of Agendas and Minutes, go to:

<https://www.ccc.govt.nz/the-council/meetings-agendas-and-minutes/>



What is important to us?

Our Strategic Framework is a big picture view of what the Council is aiming to achieve for our community

Our focus this Council term 2022–2025

Strategic Priorities



Be an inclusive and equitable city which puts people at the centre of developing our city and district, prioritising wellbeing, accessibility and connection.



Champion Ōtautahi-Christchurch and collaborate to build our role as a leading New Zealand city.



Build trust and confidence in the Council through meaningful partnerships and communication, listening to and working with residents.

Adopted by the Council on 5 April 2023



Reduce emissions as a Council and as a city, and invest in adaptation and resilience, leading a city-wide response to climate change while protecting our indigenous biodiversity, water bodies and tree canopy.



Manage ratepayers' money wisely, delivering quality core services to the whole community and addressing the issues that are important to our residents.



Actively balance the needs of today's residents with the needs of future generations, with the aim of leaving no one behind.

Our goals for this Long Term Plan 2024–2034

Draft Community Outcomes



Collaborative and confident

Our residents have the opportunity to actively participate in community and city life, have a strong sense of belonging and identity, and feel safe.



Green and liveable

Our neighbourhoods and communities are accessible and well connected, supporting our goals to reduce emissions, build climate resilience and protect and regenerate the environment, especially our biodiversity, water bodies and tree canopy.

To be adopted by the Council as part of the Long Term Plan 2024–2034



A cultural powerhouse

Our diverse communities are supported to understand and protect their heritage, pursue their arts, cultural and sporting interests, and contribute to making our city a creative, cultural and events 'powerhouse'.



Thriving and prosperous

Our city is a great place for people, business and investment where we can all grow our potential, where enterprises are innovative and smart, and where together we raise productivity and reduce emissions.

Our intergenerational vision

A place of opportunity for all.

Open to new ideas, new people,
new investment and new ways
of doing things – a place where
anything is possible.



Ngāi Tahu has rangatiratanga over its takiwā – the Council is committed to partnering with Ngāi Tahu to achieve meaningful outcomes that benefit the whole community

Waipuna Halswell-Hornby-Riccarton **Our priorities 2023-25**

- | | |
|------------------|---|
| Halswell | Advocate for a fenced dog park for the Halswell Ward. |
| Halswell | Advocate for safe, accessible pedestrian connections to significant community destinations in the Halswell Ward. |
| Halswell | Support initiatives that provide safe recreation spaces and opportunities for youth in Halswell to come together. |
| Hornby | Advocate for the development and implementation of a Hornby Masterplan. |
| Hornby | Advocate for the revitalisation of greenspaces in the Hornby Ward including the increase of tree canopy in the ward. |
| Hornby | Support the transition of the Hornby Community Care Centre to full ownership for the Hornby Community Care Trust. |
| Riccarton | Advocate for liveable neighbourhoods in the Riccarton Ward. |
| Riccarton | Support initiatives that provide for social cohesion, community connectedness and safety in the Riccarton Ward. |
| Riccarton | Support initiatives that provide things to do, places to go for youth in the Riccarton Ward. |

Part A	Matters Requiring a Council Decision
Part B	Reports for Information
Part C	Decisions Under Delegation

TABLE OF CONTENTS NGĀ IHIRANGI

Karakia Tīmatanga	5
C 1. Apologies Ngā Whakapāha	5
B 2. Declarations of Interest Ngā Whakapuaki Aronga	5
C 3. Confirmation of Previous Minutes Te Whakaāe o te hui o mua	5
B 4. Public Forum Te Huinga Whānui	5
B 5. Deputations by Appointment Ngā Huinga Whakaritenga.....	5
B 6. Presentation of Petitions Ngā Pākikitanga	5
JOINT COMMUNITY BOARD MEETINGS	
C 7. Joint Meeting - Waipuna Halswell-Hornby-Riccarton & Waipapa Papanui- Innes-Central Community Boards Minutes - 27 March 2025	19
STAFF REPORTS	
C 8. Proposed Road Names - 179 Milns Road.....	31
C 9. Planting along the upper edge of the Ngā Puna Wai embankment.....	37
C 10. Extraordinary Vacancy Waipuna Halswell-Hornby-Riccarton Community Board - resignation of Gamal Fouda	43
C 11. Waipuna Halswell-Hornby-Riccarton Community Board Discretionary Response Fund Application - Afghan Womans Group	45
B 12. Waipuna Halswell-Hornby-Riccarton Community Board Area Report - April 2025	49
B 13. Elected Members' Information Exchange Te Whakawhiti Whakaaro o Te Kāhui Amorangi.....	63
Karakia Whakamutunga	

Karakia Tīmatanga

Whakataka te hau ki te uru Whakataka te hau ki te tonga Kia mākinakina ki uta Kia mātaratara ki tai E hī ake ana te atakura He tio, he huka, he hauhūnga Tīhei Mauri Ora	Cease the winds from the west Cease the winds from the south Let the breeze blow over the land Let the breeze blow over the ocean Let the red-tipped dawn come with a sharpened air. A touch of frost, a promise of a glorious day.
--	---

1. Apologies Ngā Whakapāha

Apologies will be recorded at the meeting.

2. Declarations of Interest Ngā Whakapuaki Aronga

Members are reminded of the need to be vigilant and to stand aside from decision-making when a conflict arises between their role as an elected representative and any private or other external interest they might have.

3. Confirmation of Previous Minutes Te Whakaāe o te hui o mua

That the minutes of the Waipuna Halswell-Hornby-Riccarton Community Board meeting held on [Thursday, 13 March 2025](#) be confirmed (refer page 6).

4. Public Forum Te Huinga Whānui

A period of up to 30 minutes will be available for people to speak for up to five minutes on any issue that is not the subject of a separate hearings process.

4.1 Hornby Menzshed

Representatives of the Hornby Menzshed will address the Board regarding options for future location of the Hornby Menzshed.

4.2 Peter Simmonds

Peter Simmonds will address the Board regarding upgrading the intersection of Matipo and Maxwell Streets and pedestrian crossing on Matipo Street opposite Westfield Mall.

5. Deputations by Appointment Ngā Huinga Whakaritenga

Deputations may be heard on a matter or matters covered by a report on this agenda and approved by the Chairperson.

Deputations will be recorded in the meeting minutes.

6. Presentation of Petitions Ngā Pākikitanga

There were no petitions received at the time the agenda was prepared.

**Waipuna
Halswell-Hornby-Riccarton Community Board
OPEN MINUTES**

Date: Thursday 13 March 2025
Time: 4.35 pm
Venue: Rārākau: Riccarton Centre,
199 Clarence Street, Christchurch

Present

Chairperson	Marie Pollisco
Deputy Chairperson	Helen Broughton
Members	Sarah Brunton
	Henk Buunk
	Gamal Fouda (via audio/visual link)
	Tyla Harrison-Hunt
	Andrei Moore (via audio/visual link)
	Debbie Mora
	Mark Peters

Principal Advisor

Bailey Peterson
Manager Community Governance
Tel: 941 6743
Bailey.Peterson@ccc.govt.nz

Meeting Advisor

Faye Collins
Community Board Advisor
Tel: 941 5108
faye.collins@ccc.govt.nz

Website: www.ccc.govt.nz

To watch meetings, live, or previous recordings, go to:

<https://www.youtube.com/@waipunahalswell-hornby-ric5806/streams>

To view copies of Agendas and Minutes, go to:

<https://www.ccc.govt.nz/the-council/meetings-agendas-and-minutes/>



-
- Part A** Matters Requiring a Council Decision
Part B Reports for Information
Part C Decisions Under Delegation
-

Karakia Tīmatanga

The Board Chairperson acknowledged the recent passing of longtime Halswell resident and advocate Ron Fensom and extended the Board's sympathies to his family.

The agenda was dealt with in the following order.

1. Apologies Ngā Whakapāha

Part C

Community Board Resolved HHRB/2025/00008

That the apologies from Helen Broughton for lateness and from Debbie Mora for an early departure, be accepted.

Mark Peters/Sarah Brunton

Carried

2. Declarations of Interest Ngā Whakapuaki Aronga

Part B

There were no declarations of interest recorded.

3. Confirmation of Previous Minutes Te Whakaāe o te hui o mua

Part C

Community Board Resolved HHRB/2025/00009

That the minutes of the Waipuna Halswell-Hornby-Riccarton Community Board meeting held on Thursday, 13 February 2025 be confirmed.

Henk Buunk/Mark Peters

Carried

4. Public Forum Te Huinga Whānui

Part B

4.1 Takaro Avenue, Sockburn

Luke Chandler, local resident, addressed the Board regarding Takaro Avenue, Sockburn suggesting that no stopping restrictions be put in place around the bend on Takaro Avenue and at the intersection of Takaro Avenue and Middlepark Road.

After questions from members the Chairperson thanked Mr Chandler for his presentation.

Part B

That the Waipuna Halswell-Hornby-Riccarton Community Board:

1. Refers the issues raised in the presentation to staff to investigate and provide advice on the provision of parking restrictions around the bend in Takaro Avenue and at the intersection of Takaro Avenue and Middlepark Road to improve visibility.

Attachments

- A Presentation - Luke Chandler, Takaro Avenue proposed no stopping restrictions

4.2 Halswell Quarry Park Management Plan

Adele Geradts, Secretary Halswell Residents' Association, addressed the Board regarding the Halswell Quarry Park Management Plan. In particular Ms Geradts asked whether there had been any investigation of placement of old farm machinery etc at Halswell Quarry to act as play equipment as provided for in 9.5 of the Halswell Quarry Park Management Plan. In addition the Association suggested a review of the Plan be undertaken due to changes in the area since it was put in place.

After questions from members the Chairperson thanked Ms Geradts for her presentation.

Part B

That the Waipuna Halswell-Hornby-Riccarton Community Board refers the matters raised in the presentation to staff for investigation to provide advice on:

1. Whether there has been any placement of old farm machinery etc at Halswell Quarry Park to act as play equipment as provided for in 9.5 of the Halswell Quarry Park Management Plan.
2. Whether any review on the Halswell Quarry Park Management Plan is proposed in the near future.

4.3 Harvard Avenue Traffic Plan and Branston Street traffic movements

Derek Phelps, Chairperson, and Kieran Brewster, local resident, spoke on behalf of the Greater Hornby Residents' Association, regarding Harvard Avenue and Branston Street traffic movements.

The Association requests investigation of a one way exit system from Harvard Avenue onto Corsair Drive to improve traffic flow, together with a change to a 30km per hour speed limit. Further the Association seeks reclassification of Amyes Road from minor arterial to collector road with heavy traffic restrictions to address heavy vehicle traffic on Branston Street and measures to address anti-social road use in the vicinity.

After questions from members the Chairperson thanked Mr Phelps and Mr Brewster for their presentation.

Part B

That the Waipuna Halswell-Hornby-Riccarton Community Board refers the matters raised in the presentation to staff for investigation to provide advice on:

1. Ways to improve the traffic flow out of Harvard Avenue, including the possible implementation of a one way exit system from Harvard Avenue onto Corsair Drive and a 30km per hour speed limit.

2. The possible reclassification of Amyes Road from minor arterial to collector road with heavy traffic restrictions to alleviate heavy vehicle traffic on Branston Street.
3. Any measures to address anti-social road use in the vicinity of Branston Street.

4.4 Riccarton issues and Board meetings

Garth Wilson, local resident, addressed the Board regarding various matters related to Riccarton noting that responses to matters raised at an earlier meeting are still outstanding. Mr Wilson is concerned about the use of scooters in and around Riccarton in particular them being a hazard on the footpath.

Mr Wilson asked for transparency around attendance and voting at Board meetings.

After questions from members the Chairperson thanked Mr Wilson for his presentation.

Helen Broughton joined the meeting at 5.07pm during item 4.4.

5. Deputations by Appointment Ngā Huinga Whakaritenga

Part B

5.1 Wigram Road artificial turf sports field consultation and development

Ian Ebbs, South West Sport and Recreation Hub Incorporated (SWISH), addressed the Board in relation to the Wigram Road artificial turf sports field consultation and development Report (Item 7 of these minutes refers).

Mr Ebbs spoke in support of the proposal and noted that he considers it likely that further artificial turf sports fields will be required in the South West area in future.

After questions from members the Chairperson thanked Mr Ebbs for his presentation.

5.2 Wigram Road artificial turf sports field consultation and development

Angela Pryor, General Manager Christchurch Netball Centre, and Jacinda Valentine, Mainland Netball, addressed the Board in relation to the Wigram Road artificial turf sports field consultation and development Report (Item 7 of these minutes refers).

They requested that there be development of a masterplan for the Ngā Puna Wai facility to maximise its use.

After questions from members the Chairperson thanked Ms Pryor and Ms Valentine for their presentation.

5.5 Wigram Road artificial turf sports field consultation and development

Marc Duff, local resident, addressed the Board in relation to the Wigram Road artificial turf sports field consultation and development Report (Item 7 of these minutes refers) and suggested that an alternate location be considered for the installation of the first artificial turf fields in Christchurch.

After questions from members the Chairperson thanked Mr Duff for his presentation.

5.6 Wigram Road artificial turf sports field consultation and development

Tony Smail, CEO Canterbury Rugby Football Union, addressed the Board in support of the recommendations in the Wigram Road artificial turf sports field consultation and development Report (Item 7 of these minutes refers).

After questions from members the Chairperson thanked Mr Smail for his presentation.

5.7 Wigram Road artificial turf sports field consultation and development

Martin Field-Dodgson, CEO Mainland Football, spoke to the Board in support of the recommendations in the Wigram Road artificial turf sports field consultation and development Report (Item 7 of these minutes refers).

After questions from members the Chairperson thanked Mr Dodgson for his presentation.

5.8 Wigram Road artificial turf sports field consultation and development

Craig Bowen, President Halswell United Football Club, addressed the Board in relation to the Wigram Road artificial turf sports field consultation and development Report (Item 7 of these minutes refers).

Mr Bowen indicated support for the proposal but advised that he considers that additional artificial turf sports fields will also be required in the South West area in future.

After questions from members the Chairperson thanked Mr Bowen for his presentation.

5.3 Bus stop upgrades on Murphys, Main South, and Halswell Junction Roads

Nicole Drewett, and Richard Scott, local residents, addressed the Board in relation to the Bus stop upgrades on Murphys, Main South, and Halswell Junction Roads Report (Item 8 of these minutes refers) in particular they expressed concern about the proposed location of a new bus stop adjacent to 33 Murphys Road.

After questions from members the Chairperson thanked Ms Drewett and Mr Scott for their presentation.

Attachments

A Presentation - Nicole Drewett, Proposed bus stops

5.4 Bus stop upgrades on Murphys, Main South, and Halswell Junction Roads

Karen Coleman addressed the Board in relation to the Bus stop upgrades on Murphys, Main South, and Halswell Junction Roads Report (Item 8 of these minutes refers) in particular she asked that the seat proposed to be installed adjacent to 66 Halswell Junction Road be relocated closer to 62 Halswell Junction Road and the place where passengers board buses.

After questions from members the Chairperson thanked Ms Coleman for her presentation.

Attachments

A Presentation - Karen Coleman, Bus seat location

Debbie Mora left the meeting at 6.20pm during item 5.4.

The meeting adjourned at 6.21pm and reconvened at 6.24pm.

6. Presentation of Petitions Ngā Pākikitanga

Part B

There was no presentation of petitions.

8. Bus stop upgrades on Murphys, Main South, and Halswell Junction Roads Community Board Consideration

Staff in attendance spoke to the accompanying report.

The Board took into consideration the deputations from Nicole Drewett and Richard Scott (5.3 of these minutes refers) and Karen Coleman (5.4 of these minutes refers).

The Board discussed opportunities for the proposed bus stop adjacent to 33 Murphys to be relocated and it was agreed that staff would meet with effected residents and Board members on site to explore options.

The Board noted staff advice that the proposed seat to be installed adjacent to 66 Halswell Junction Road could be moved closer to the boundary of 62 Halswell Junction Road.

Officer Recommendations Ngā Tūtohu

That the Waipuna Halswell-Hornby-Riccarton Community Board:

1. Receives the information in the Bus stop upgrades on Murphys, Main South, and Halswell Junction Roads Report.
2. Notes that the decision in this report is assessed as low significance based on the Christchurch City Council's Significance and Engagement Policy.

New bus stops at Murphys-Skibbereen-Caulfield intersection (Attachment A)

3. Pursuant to Clause 7 of the Christchurch City Council Traffic and Parking Bylaw 2017:

Outbound – outside 33 Murphys Road

- a. Approves that the stopping of all vehicles be prohibited at any time, on the south side of Murphys Road commencing at a point 70 metres north of its intersection with Skibbereen Drive and extending in a southerly direction for a distance of 8 metres.
- b. Approves that a bus stop be installed on the southern side of Murphys Road commencing at a point 62 metres north of its intersection with Skibbereen Drive and extending in a southerly direction for a distance of 14 metres.

Inbound – outside 32 Murphys Road

- a. Approves that the stopping of all vehicles be prohibited at any time, on the north side of Murphys Road commencing at a point 35 metres north of its intersection with Caulfield Avenue and extending in a southerly direction for a distance of 2 metres.
- b. Approves that a bus stop be installed on the northern side of Murphys Road commencing at a point 33 metres north of its intersection with Caulfield Avenue and extending in a southerly direction for a distance of 14 metres.
- c. Approves that the stopping of all vehicles be prohibited at any time, on the north side of Murphys Road commencing at a point 19 metres north of its intersection with Caulfield Avenue and extending in a southerly direction for a distance of 12 metres.

4. Approves that directional and warning tactile pavers, a seat, hardstand areas, and bus stop signs are installed at these bus stops, as shown on **Attachment A**.
5. Approves the removal of one street tree (Tree ID 143928) outside 2 Caulfield Avenue on Murphys Road, as shown on **Attachment A**.
6. Approves the replacement planting of trees on Caulfield Avenue outside Murphys Drainage Reserve, as shown on **Attachment A**.
7. Pursuant to Clause 7 of the Christchurch City Council Traffic and Parking Bylaw 2017:
 - a. Approves that the stopping of all vehicles be prohibited at any time, on the south side of Murphys Road commencing at a point 16 metres north of its intersection with Skibbereen Drive and extending in a southerly direction for a distance of 9 metres.

Bus stop 53589 - 18 McDermott Place on Murphys Road (Attachment B)

8. Pursuant to Section 339(1) of the Local Government Act 1974:
 - a. Approves that a bus passenger shelter be installed on the north side of Murphys Road commencing at a point 49 metres south of its intersection with Halswell Junction Road and extending in a southerly direction for a distance of approximately 3.6 metres.
9. Approves that directional and warning tactile pavers and hardstand area are installed at the bus stop, as shown on **Attachment B**.

Bus stop 17847 - 175 Main South Road on Racecourse Road (Attachment C)

10. Pursuant to Clause 7 of the Christchurch City Council Traffic and Parking Bylaw 2017:
 - a. Approves that a bus stop on the southern side of Racecourse Road commencing at a point 118 metres west of its intersection with Main South-Epsom-Blenheim Roundabout and extending in a westerly direction for a distance of 13 metres be revoked.
 - b. Approves that the stopping of all vehicles be prohibited at any time, on the south side of Racecourse Road commencing at a point 87 metres west of its intersection with Main South-Epsom-Blenheim Roundabout and extending in a westerly direction for a distance of 4 metres.
 - c. Approves that a bus stop be installed on the southern side of Racecourse Road commencing at a point 91 metres west of its intersection with Main South-Epsom-Blenheim Roundabout and extending in a westerly direction for a distance of 14 metres.
11. Approves that directional and warning tactile pavers, a seat, green surfacing, and bus stop sign are installed at the bus stop, as shown on **Attachment C**.

Bus stop 38068 – 66 Halswell Junction Road (Attachment D)

12. Approves that a seat and a hardstand area be installed at the bus stop, as shown on **Attachment D**.
13. Revokes any previous resolutions pertaining to parking or stopping restrictions and traffic controls made pursuant to any bylaw to the extent that they conflict with the parking or stopping restrictions and traffic controls described in resolutions 3-12 above.

Community Board Resolved HHRB/2025/00010

Part C

That the Waipuna Halswell-Hornby-Riccarton Community Board:

1. Receives the information in the Bus stop upgrades on Murphys, Main South, and Halswell Junction Roads Report.
2. Notes that the decision in this report is assessed as low significance based on the Christchurch City Council's Significance and Engagement Policy.

Bus stop 53589 - 18 McDermott Place on Murphys Road (Attachment B)

8. Pursuant to Section 339(1) of the Local Government Act 1974:
 - a. Approves that a bus passenger shelter be installed on the north side of Murphys Road commencing at a point 49 metres south of its intersection with Halswell Junction Road and extending in a southerly direction for a distance of approximately 3.6 metres.
9. Approves that directional and warning tactile pavers and hardstand area are installed at the bus stop, as shown on **Attachment B** to the report on the meeting agenda.

Bus stop 17847 - 175 Main South Road on Racecourse Road (Attachment C)

10. Pursuant to Clause 7 of the Christchurch City Council Traffic and Parking Bylaw 2017:
 - a. Approves that a bus stop on the southern side of Racecourse Road commencing at a point 118 metres west of its intersection with Main South-Epsom-Blenheim Roundabout and extending in a westerly direction for a distance of 13 metres be revoked.
 - b. Approves that the stopping of all vehicles be prohibited at any time, on the south side of Racecourse Road commencing at a point 87 metres west of its intersection with Main South-Epsom-Blenheim Roundabout and extending in a westerly direction for a distance of 4 metres.
 - c. Approves that a bus stop be installed on the southern side of Racecourse Road commencing at a point 91 metres west of its intersection with Main South-Epsom-Blenheim Roundabout and extending in a westerly direction for a distance of 14 metres.
11. Approves that directional and warning tactile pavers, a seat, green surfacing, and bus stop sign are installed at the bus stop, as shown on **Attachment C** to the report on the meeting agenda.

Bus stop 38068 - 66 Halswell Junction Road (Attachment D)

12. Approves that a seat and a hardstand area be installed at the bus stop, as shown on **Attachment D** to the report on the meeting agenda to be located as close as practicable to the boundary between 66 and 62 Halswell Junction Road.
13. Revokes any previous resolutions pertaining to parking or stopping restrictions and traffic controls made pursuant to any bylaw to the extent that they conflict with the parking or stopping restrictions and traffic controls described above.

New bus stops at Murphys-Skibbereen-Caulfield intersection

14. Notes that staff will meet with Board members and affected residents to discuss options for location of an additional bus stop on Murphys Road.

Andrei Moore/Tyla Harrison-Hunt

Carried

10. Orion Easement over Upper Riccarton War Memorial Park - 372 Riccarton Road

Community Board Resolved HHRB/2025/00011 Officer recommendations accepted without change

Part C

That the Waipuna Halswell-Hornby-Riccarton Community Board:

1. Receives the information in the Orion Easement over Upper Riccarton War Memorial Park - 372 Riccarton Road Report.
2. Notes that the decision in this report is assessed as low significance based on the Christchurch City Council's Significance and Engagement Policy.
3. Approves the relocation of the Link Box and connecting cables to the new position illustrated in Figure 3 at 4.6 and as shown on Attachment A (Easement Plan) and Attachment B (Landscape Plan) to the report on the meeting agenda.
4. Approves the grant of an easement in favour of Orion New Zealand Limited to convey electricity and install a Link Box at 372 Riccarton Road described as Reserve 4620 and held in Record of Title CB327/121.
5. Notes that (4) will be subject to the consent of the Minister of Conservation pursuant to Section 48(1) of the Reserves Act 1977. In this regard endorses the Chief Executive, acting under delegation from the Council, to exercise the Minister of Conservation's consent to the easement, as delegated to the Council from the Minister under the Instrument of Delegation for Territorial Authorities dated 12 June 2013.
6. Delegates authority to the Manager Property Consultancy to do all things necessary and make any decisions at his sole discretion that are consistent with the intent of this report to implement the resolutions above including but not limited to concluding and signing all documentation in relation to (4) above.

Tyla Harrison-Hunt/Mark Peters

Carried

7. Wigram Road artificial turf sports field consultation and development Community Board Consideration

Staff in attendance spoke to the accompanying report.

Members took into consideration all the deputations received on this item (items 5.1, 5.2, 5.5, 5.6, 5.7 and 5.8 above refers).

The Board discussed the need for provision of a range of improved playing surfaces in the south west area to cater for demand arising from growth in the area.

Officer Recommendations Ngā Tūtohu

That the Waipuna Halswell-Hornby-Riccarton Community Board:

1. receives the information in the Wigram Road artificial turf sports field consultation and development Report;
2. notes that the decision in the report is assessed as low significance based on the Christchurch City Council's Significance and Engagement Policy;
3. approves Option 1 (see 4.6 in the report on the meeting agenda) for locating two full size, floodlit artificial turf sports fields and associated car parking and changing facilities at Ngā Puna Wai on the land at 141 and 189 Wigram Road.

Community Board Resolved HHRB/2025/00012

Part C

That the Waipuna Halswell-Hornby-Riccarton Community Board:

1. receives the information in the Wigram Road artificial turf sports field consultation and development Report;
2. notes that the decision in the report is assessed as low significance based on the Christchurch City Council's Significance and Engagement Policy;
3. approves Option 1 (see 4.6 in the report on the meeting agenda) for locating two full size, floodlit artificial turf sports fields and associated car parking and changing facilities at Ngā Puna Wai on the land at 141 and 189 Wigram Road.
4. Requests staff advice on any proposals for improving playing surfaces at Halswell Domain to ensure availability for year-round usage.
5. Requests staff advice on the number of intended artificial turfs in the south-west area as part of the Sport Field Network Plan, noting the extensive growth and demand in the south-west area and usage from surrounding Selwyn residents.
6. Requests staff advice on the updating of the master plan for the wider Ngā Puna Wai facility and surrounding roads, noting the significant changes to the facility since opening.
7. Request staff investigate optimising the use of the artificial turfs by including but not limited to provision of a warm up area.

Andrei Moore/Sarah Brunton

Carried

Item 3 - Minutes of Previous Meeting 13/03/2025

9. Bus layover for bus route 7 - Opouira Knights Stream Park

Community Board Resolved HHRB/2025/00013 Officer recommendations accepted without change

Part C

That the Waipuna Halswell-Hornby-Riccarton Community Board:

1. Receives the information in the Bus layover for bus route 7 - Opouira Knights Stream Park Report.
2. Notes that the decision in this report is assessed as low significance based on the Christchurch City Council's Significance and Engagement Policy.

Bus Layover for route 7 on Richmond Avenue (Attachment A, TG149102, Issue 1, 19.02.2025)

3. Pursuant to Clause 7 of the Christchurch City Council Traffic and Parking Bylaw 2017

- a. Approves that the stopping of all vehicles be prohibited at any time, on north side of Richmond Avenue commencing at a point 241 metres west of its intersection with Denali Street and extending in a south-easterly direction for a distance of 8 metres.
 - b. Approves that a bus stop be installed on north side of Richmond Avenue commencing at a point 233 metres west of its intersection with Denali Street and extending in a south-easterly direction for a distance of 14 metres.
 - c. Approves that the stopping of all vehicles be prohibited at any time, on north side of Richmond Avenue commencing at a point 219 metres west of its intersection with Denali Street and extending in a south-easterly direction for a distance of 11 metres.
4. Approves the installation of a bus parking sign (R6-53), as shown in **attachment A to the report on the meeting agenda, TG149102, Issue 1, 19.02.2025.**
 5. Approves that any previous resolutions pertaining to parking and stopping restrictions made pursuant to any bylaw to the extent that they conflict with the parking and stopping restrictions described in clauses 3 – 4 above are revoked.
 6. Approves that these resolutions, described in clauses 3 – 4 above, take effect when parking signage and/or road markings that evidence the restrictions described in the staff report are in place (or removed in the case of revocations).

Andrei Moore/Sarah Brunton

Carried

11. Quarry View Park - New Play Space and Tree Planting

Community Board Resolved HHRB/2025/00014 Officer recommendations accepted without change

Part C

That the Waipuna Halswell-Hornby-Riccarton Community Board:

1. Receives the information in the Quarry View Park - New Play Space and Tree Planting Report.
2. Notes that the decision in this report is assessed as low significance based on the Christchurch City Council's Significance and Engagement Policy.
3. Approves the landscape plan for the play space and tree planting at Quarry View Park (Lot 36 DP 452601, Record of Title: 578845) in accordance with the concept plan attached to the report on the meeting agenda (Attachment A).

Andrei Moore/Mark Peters

Carried

12. Progress on Waipuna Halswell-Hornby-Riccarton Community Board Plan Priorities 2023-25

Community Board Resolved HHRB/2025/00015 Officer recommendation accepted without change

Part C

That the Waipuna Halswell-Hornby-Riccarton Community Board:

1. Receives the information in the Progress on Waipuna Halswell-Hornby-Riccarton Community Board Plan Priorities 2023-25 Report.

Andrei Moore/Sarah Brunton

Carried

13. Waipuna Halswell-Hornby-Riccarton - Better-Off Fund Application for Consideration - Community Development Network Trust

Community Board Resolved HHRB/2025/00016 Officer recommendations accepted without change

Part C

That the Waipuna Halswell-Hornby-Riccarton Community Board:

1. Receives the information in the Waipuna Halswell-Hornby-Riccarton - Better-Off Fund Application for Consideration - Community Development Network Trust Report.
2. Notes that the decisions in this report are assessed as low significance based on the Christchurch City Council's Significance and Engagement Policy.
3. Approves a grant of \$119,500 from its Better-Off Fund to Community Development Network Trust towards the Mobile Youth Centre.

Tyla Harrison-Hunt/Sarah Brunton

Carried

14. Waipuna Halswell-Hornby-Riccarton Community Board Area Report - March 2025

Community Board Resolved HHRB/2025/00017 Officer recommendation accepted without change

Part B

That the Waipuna Halswell-Hornby-Riccarton Community Board:

1. Receives the information in the Waipuna Halswell-Hornby-Riccarton Community Board Area Report - March 2025.

Mark Peters/Henk Buunk

Carried

Gamal Fouda left the meeting at 7.50pm following consideration of item 14.

15. Elected Members' Information Exchange Te Whakawhiti Whakaaro o Te Kāhui Amorangi

Part B

The following information was exchanged:

- It was advised that new initiatives are being considered around the recording of votes at Council meetings.

- It was advised that the need for no drop off zones and parking areas for scooters is being investigated to improve accessibility.
- There was an acknowledgement of the good work of the Oak Development Trust.
- It was noted that there is concern about some seeding plants having possible adverse effects on neighbouring properties.
- The cut-off date for Summer with your neighbours is at the end of March.
- The Board Chairperson and Deputy Chairperson spoke on the Boards submissions at hearings on the Dog Control Bylaw Review, the Trade Wastes and the Parks and Reserves Bylaw Review.
- It was noted that some residents have suggested that the Board consider implementation of a sustainable gardens award scheme.
- A local resident has expressed concern about birds on a neighbouring property.
- It was noted that “Hello Hornby” event will be held on Saturday 15 March 2025.

Tyla Harrison-Hunt left the meeting at 8.17pm during item 15.

Karakia Whakamutunga

Meeting concluded at 8.19pm.

CONFIRMED THIS 10TH DAY OF APRIL 2025

MARIE POLLISCO
CHAIRPERSON

7. Joint Meeting - Waipuna Halswell-Hornby-Riccarton & Waipapa Papanui-Innes-Central Community Boards Minutes - 27 March 2025

Reference Te Tohutoro: 25/648691

Responsible Officer(s) Te Pou Matua: Faye Collins, Community Board Advisor

Accountable ELT Member Pouwhakarae: Andrew Rutledge, General Manager Citizens and Community

1. Purpose of Report Te Pūtake Pūrongo

The Joint Meeting - Waipuna Halswell-Hornby-Riccarton & Waipapa Papanui-Innes-Central Community Boards held a meeting on 27 March 2025. The Minutes of the meeting are attached for the confirmation of the Waipuna Halswell-Hornby-Riccarton Community Board.

2. Recommendation Te Tūtohu Waipuna Halswell-Hornby-Riccarton Community Board

That the Waipuna Halswell-Hornby-Riccarton Community Board confirms the Minutes from the Joint Meeting - Waipuna Halswell-Hornby-Riccarton & Waipapa Papanui-Innes-Central Community Boards held on 27 March 2025.

Attachments Ngā Tāpirihanga

No.	Title	Reference	Page
A 	Minutes Joint Meeting - Waipuna Halswell-Hornby-Riccarton & Waipapa Papanui-Innes-Central Community Boards - 27 March 2025	25/607805	20

Signatories Ngā Kaiwaitohu

Author
Faye Collins - Community Board Advisor

**Waipuna Halswell-Hornby-Riccarton Community
Board and Waipapa Papanui-Innes-Central
Community Board
OPEN MINUTES**

Date: Thursday 27 March 2025
Time: 4.02 pm
Venue: Rārākau: Riccarton Centre,
199 Clarence Street, Christchurch

Present

Chairperson	Marie Pollisco	Emma Norrish
Deputy Chairperson	Helen Broughton	Simon Britten (via audio/visual link)
Members	Henk Buunk	Pauline Cotter (via audio/visual link)
	Gamal Fouda (via audio/visual link)	Sunita Gautam (via audio/visual link)
	Tyla Harrison-Hunt	Ali Jones (via audio/visual link)
	Andrei Moore	Jake McLellan (via audio/visual link)
	Debbie Mora	John Miller (via audio/visual link)
	Mark Peters	Emma Twaddell (via audio/visual link)

Principal Advisor

Bailey Peterson
Manager Community Governance
Tel: 941 6743
Bailey.Peterson@ccc.govt.nz

Meeting Advisor

Faye Collins
Community Board Advisor
Tel: 941 5108
faye.collins@ccc.govt.nz

Website: www.ccc.govt.nz

-
- Part A Matters Requiring a Council Decision**
Part B Reports for Information
Part C Decisions Under Delegation
-

Karakia Tīmatanga

The agenda was dealt with in the following order.

1. Apologies Ngā Whakapāha

Part C

Joint Community Board Resolved JM-WH/2025/00001

That the Waipuna Halswell-Hornby-Riccarton Community Board resolved that the apologies from Sarah Brunton for absence and from Debbie Mora for an early departure, be accepted.

Mark Peters/Henk Buunk

Carried

Joint Community Board Resolved JM-WH/2025/00002

That the Waipapa Papanui-Innes-Central Community Board resolved that the apologies from Victoria Henstock for absence and from Emma Twaddell for a late arrival, be accepted.

Ali Jones/John Miller

Carried

2. Declarations of Interest Ngā Whakapuaki Aronga

Part B

There were no declarations of interest recorded.

3. Deputations by Appointment Ngā Huinga Whakaritenga

Part B

3.1 Riccarton CRAF - Deans Avenue pedestrian safety improvements

The scheduled deputation did not go ahead.

3.2 Riccarton CRAF - Deans Avenue pedestrian safety improvements

Grant Read, local resident, addressed the Board in relation to the Riccarton CRAF – Deans Avenue pedestrian safety improvements report (Item 4 of these minutes refers) and showed a PowerPoint presentation.

Mr Read wants to see improvements for pedestrians crossing Deans Avenue but expressed concern that the recommended proposals could make crossing more difficult.

After questions from members the Chairperson thanked Mr Read for his presentation.

Attachments

A Presentation - Grant Read, Deans Avenue pedestrian safety improvements

Emma Twaddell joined the meeting at 4.15pm during Item 3.2.

3.5 Riccarton CRAF - Deans Avenue pedestrian safety improvements

Joseph Fullerton, Secretary of Greater Ōtautahi and local resident spoke on behalf of Greater Ōtautahi and in a personal capacity in support of Option 1 in the Riccarton CRAF – Deans Avenue pedestrian safety improvements report (Item 4 of these minutes refers).

The group is aware of current difficulties of crossing Riccarton Road and supports the proposal and any future proposals for traffic calming measures.

Mr Fullerton outlined the impacts of traffic noise on local residents and expects that the traffic calming measures will slow traffic and address this issue.

After questions from members the Chairperson thanked Mr Fullerton for his presentation.

3.3 Riccarton CRAF - Deans Avenue pedestrian safety improvements

Tony McPherson, Chairperson and Todd Davis spoke on behalf of the Deans Avenue Precinct Society in relation to the Riccarton CRAF – Deans Avenue pedestrian safety improvements report (Item 4 of these minutes refers) and showed a PowerPoint presentation.

The Society is supportive of proposed safety improvements but considers that Deans Avenue needs to be looked at as a whole and that ongoing monitoring and reporting is required to ensure that any decision can be subsequently reaffirmed.

After questions from members the Chairperson thanked Mr McPherson and Mr Davis for their presentation.

Attachments

- A Presentation - Deans Avenue Precinct Society, Deans Avenue pedestrian safety improvements

3.6 Riccarton CRAF - Deans Avenue pedestrian safety improvements

Cody Cooper, local road user, addressed the Board in relation to the Riccarton CRAF – Deans Avenue pedestrian safety improvements report (Item 4 of these minutes refers).

Mr Cooper highlighted that Christchurch Regeneration Acceleration Funding was made available some time ago and asked that it be used without delay to support the proposals for pedestrian safety improvements on Deans Avenue.

After questions from members the Chairperson thanked Mr Cooper for his presentation.

**4. Riccarton CRAF - Deans Avenue pedestrian safety improvements
Community Boards Consideration**

Staff in attendance spoke to the accompanying report and showed a PowerPoint presentation. Staff tabled a set of updated recommendations advising that these are not a change to what is being recommended but is a re-ordering of the recommendations to ensure that each Board is considering the relevant recommendations.

The Boards took into consideration the deputations from Grant Read, Greater Ōtautahi, Joseph Fullerton, Deans Avenue Precinct Society and Cody Cooper (3.2, 3.5, 3.3 and 3.6 of these minutes refers).

Board members discussed the need for speed humps in association with the pedestrian crossing.

The meeting adjourned at 5.55 pm and reconvened at 6.14 pm.

Officer Recommendations Ngā Tūtohu

That the Waipuna Halswell-Hornby-Riccarton Community Board and Waipapa Papanui-Innes-Central Community Board:

1. Receives the information in the Riccarton CRAF - Deans Avenue pedestrian safety improvements Report.
2. Notes that the decision in this report is assessed as low significance based on the Christchurch City Council's Significance and Engagement Policy.
3. Revokes any previous resolutions pertaining to traffic controls made pursuant to any Bylaw to the extent that they are in conflict with the parking or stopping restrictions described in recommendations 4-6 below.
4. Approves all kerb alignments, paths, islands, road surface treatments, traffic calming features and road markings on Deans Avenue, commencing at its intersection with Freyberg Avenue and extending in a southerly direction until its intersection with Mayfair Street as detailed on plan TP364701, sheet 1, dated 05.03.2025, and attached to this report as **Attachment A**.
5. Approves pursuant to Clause 7 of the Christchurch City Council Traffic and Parking Bylaw 2017, that the stopping of vehicles be prohibited at all times:
 - a. On the western side of Deans Avenue, commencing at a point approximately 153 meters south of its intersection with Freyberg Avenue and extending in a southerly direction for a distance of 36 metres, as detailed on plan TP364701, sheet 1, dated 05.03.2025, and attached to this report as **Attachment A**.
 - b. On the western side of Deans Avenue, commencing at a point approximately 194 meters south of its intersection with Freyberg Avenue and extending in a southerly direction for a distance of 8 metres, as detailed on plan TP363401, sheet 1, dated 05.03.2025, and attached to this report as **Attachment A**.
 - c. On the eastern side of Deans Avenue, commencing at a point approximately 146 meters south of its intersection with Freyberg Avenue and extending in a southerly direction for a distance of 29 metres, as detailed on plan TP363401, sheet 1, dated 05.03.2025, and attached to this report as **Attachment A**.
6. Approves pursuant to Clause 7 of the Christchurch City Council Traffic and Parking Bylaw 2017, that the stopping of vehicles be prohibited at all times:
 - a. On the western side of Deans Avenue, commencing at its intersection with Brockworth Place and extending in a northerly direction for a distance of 26 metres, as detailed on plan TP363401, sheet 1, dated 05.03.2025, and attached to this report as **Attachment A**.
 - b. On the western side of Deans Avenue, commencing at its intersection with Brockworth Place and extending in a southerly direction for a distance of 23 metres, as detailed on plan TP363401, sheet 1, dated 05.03.2025, and attached to this report as **Attachment A**.
 - c. Approves that these resolutions 4-6 take effect when signage and/or road markings that evidence the restrictions described in the staff report are in place (or removed in the case of revocations).

Community Board Resolved JM-WH/2025/00003 Officer recommendations accepted without change

Part C

That the Waipapa Papanui-Innes-Central Community Board:

1. Receive the information in the Riccarton CRAF – Deans Avenue pedestrian safety improvements Report.
2. Notes that the decision in this report is assessed as low significance based on the Christchurch City Council’s Significance and Engagement Policy.
3. Notes the centre of Deans Avenue is the boundary between the Waipuna Halswell Hornby Riccarton Community Board and the Waipapa Papanui Innes Central Community Board. The west side of Deans Avenue comes under the jurisdiction of the Waipuna Community Board while the east side comes under the jurisdiction of the Waipapa Community Board.
4. Approve, in principle, the project as detailed on plan TP364701, sheet 1, dated 5 March 2025 and attached to this report as **Attachment A**.
5. Revokes any previous resolutions pertaining to traffic controls made pursuant to any Bylaw to the extent that they are in conflict with the parking or stopping restrictions described in recommendation 6 below.
6. To give effect to Resolution (4) above:
 - a. Approve, pursuant to section 334 of the Local Government Act 1974:
 - i. The removal of an existing tree located; and
 - ii. The installation of a pedestrian crossing facility; and
 - iii. Permanent fencing surrounding the pedestrian facility

in the central median on Deans Avenue in the location as indicated on TP364701, sheet dated 5 March 2025, and attached to this report as **Attachment A**.

- b. Approves all kerb alignments, paths, islands, road surface treatments, traffic calming features and road markings on Deans Avenue, commencing at its intersection with Freyberg Avenue and extending in a southerly direction until its intersection with Mayfair Street as detailed on plan TP364701, sheet 1, dated 5 March 2025 and attached to this report as **Attachment A**.
- c. Approves that these resolutions take effect when signage and/or road markings that evidence the restrictions described in the staff report are in place (or removed in the case of revocations).
- d. Revokes any previous resolutions pertaining to traffic controls made pursuant to any Bylaw to the extent that they are in conflict with the parking or stopping restrictions described in recommendations “e” below.
- e. Approves pursuant to Clause 7 of the Christchurch City Council Traffic and Parking Bylaw 2017, that the stopping of vehicles be prohibited at all times:
 - i. On the eastern side of Deans Avenue, commencing at a point approximately 146 metres south of its intersection with Freyberg Avenue and extending in a southerly direction for a distance of 29 metres, as detailed on plan

TP363401, sheet 1, dated 5 March 2025 and attached to this report as
Attachment A.

- f. Approves pursuant to section 319 of the Local Government Act 1974, that the existing southbound lane merger on Deans Avenue, commencing at a point approximately 52 metres south of its intersection with Brockworth Place (south end), is relocated to a point approximately 16 metres south of its intersection with Freyberg Avenue on Deans Avenue.

Pauline Cotter/Sunita Gautam

Carried

Ali Jones requested that her vote against the resolutions be recorded.

The Waipapa Papanui-Innes-Central Community Board left the meeting at 6.25pm during consideration of Item 4.

Community Board Resolved JM-WH/2025/00004

That the Waipuna Halswell-Hornby-Riccarton Community Board:

1. Receive the information in the Riccarton CRAF – Deans Avenue pedestrian safety improvements Report.
2. Notes that the decision in this report is assessed as low significance based on the Christchurch City Council’s Significance and Engagement Policy.
3. Notes the centre of Deans Avenue is the boundary between the Waipuna Halswell Hornby Riccarton Community Board and the Waipapa Papanui Innes Central Community Board. The west side of Deans Avenue comes under the jurisdiction of the Waipuna Community Board while the east side comes under the jurisdiction of the Waipapa Community Board.
4. Approve, in principle, the project as detailed on plan TP364701, sheet 1 dated 5 March 2025 and attached to this report as **Attachment A** excluding the speed hump shown on the west side of Deans Avenue.
5. Revokes any previous resolutions pertaining to traffic controls made pursuant to any Bylaw to the extent that they are in conflict with the parking or stopping restrictions described in recommendation 6 below.
6. To give effect to Resolution (4) above:
 - a. Approve, pursuant to section 334 of the Local Government Act 1974:
 - i. The removal of an existing tree located; and
 - ii. The installation of a pedestrian crossing facility; and
 - iii. Permanent fencing surrounding the pedestrian facilityin the central median on Deans Avenue in the location as indicated on plan TP364701, sheet 1, dated 5 March 2025 and attached to this report as **Attachment A.**
 - b. Approves all kerb alignments, paths, islands, road surface treatments, traffic calming features and road markings on Deans Avenue, commencing at its intersection with Freyberg Avenue and extending in a southerly direction until its intersection with Mayfair Street as detailed on plan TP364701, sheet 1, dated 05.03.2025, and attached to this report as **Attachment A** but excluding the speed hump shown on the west side of Deans Avenue.

- c. Approves that these resolutions take effect when signage and/or road markings that evidence the restrictions described in the staff report are in place (or removed in the case of revocations).
- d. Revokes any previous resolutions pertaining to traffic controls made pursuant to any Bylaw to the extent that they are in conflict with the parking or stopping restrictions described in recommendation “e” below.
- e. Approves pursuant to Clause 7 of the Christchurch City Council Traffic and Parking Bylaw 2017, that the stopping of vehicles be prohibited at all times:
 - i. On the western side of Deans Avenue, commencing at a point approximately 153 meters south of its intersection with Freyberg Avenue and extending in a southerly direction for a distance of 36 metres, as detailed on plan TP364701, sheet 1, dated 5 March 2025, and attached to this report as **Attachment A**.
 - ii. On the western side of Deans Avenue, commencing at a point approximately 194 meters south of its intersection with Freyberg Avenue and extending in a southerly direction for a distance of 8 metres, as detailed on plan TP363401, sheet 1, dated 5 March 2025, and attached to this report as **Attachment A**.
 - iii. On the western side of Deans Avenue, commencing at its intersection with Brockworth Place and extending in a northerly direction for a distance of 26 metres, as detailed on plan TP363401, sheet 1, dated 5 March 2025, and attached to this report as **Attachment A**.
 - iv. On the western side of Deans Avenue, commencing at its intersection with Brockworth Place and extending in a southerly direction for a distance of 23 metres, as detailed on plan TP363401, sheet 1, dated 5 March 2025, and attached to this report as **Attachment A**.

Tyla Harrison-Hunt/Marie Pollisco

Carried

Helen Broughton requested that her vote against the resolutions be recorded.

Community Board Resolved JM-WH/2025/00005

That the Waipuna Halswell-Hornby-Riccarton Community Board:

1. Requests that staff investigate a corridor study to be undertaken for the section of Deans Avenue between Riccarton Avenue and Moorhouse Avenue, including Freyberg Avenue, Palazzo Lane, and Brockworth Place, including the following:
 - a. An assessment of traffic flow, safety, access, and amenity for both residents and park users, including intersections and mid-block crossing points.
 - b. Identification of opportunities to improve pedestrian and cyclist safety at informal crossing points and other high-use locations beyond the current project site.
 - c. Review of resident access and egress issues, including turning movements and visibility from side streets such as Palazzo Lane and Brockworth Place.
 - d. Consideration of future traffic calming, signage, lane configurations, and possible intersection treatments to support both movement and safety objectives.

- e. Acknowledgment that the masterplan is to complement and not delay the implementation of the Deans Avenue pedestrian safety improvements currently proposed.
2. Requests that staff undertake a review of the crossing facility and associated safety improvements 12 months after implementation, including:
 - a. Pedestrian usage at the new crossing and adjacent points
 - b. Feedback from residents and emergency services.and report the findings of the review to the Community Board.

Tyla Harrison-Hunt/Marie Pollisco

Carried

Attachments

- A Tabled recommendations - Riccarton CRAF - Deans Avenue pedestrian safety improvements
- B Presentation - Riccarton CRAF - Deans Avenue pedestrian safety improvements

Andrei Moore and Debbie Mora left the meeting at 6.42pm following the consideration of Item 4.

3. Deputations by Appointment Continued Ngā Huinga Whakaritenga

Part B

3.4 Riccarton CRAF - Brockworth Place Street renewal

Claire Mulcock, Secretary, spoke on behalf of the Deans Avenue Precinct Society in support of the recommendations in the Riccarton CRAF - Brockworth Place Street renewal Report (Item 5 of these minutes refers). Ms Mulcock suggested that the road layout at the southern end of Brockworth Place be wide enough to have space for three lanes of traffic with lines and arrows painted on the road.

The Society considers that stop or give way signs in this environment are not necessary.

In addition the society does not consider that grass berms should be put in, in places where residents are unlikely to maintain them.

After questions from members the Chairperson thanked Ms Mulcock for her presentation.

Attachments

- A Presentation - Deans Avenue Precinct Society, Brockworth Place street renewal

5. Riccarton CRAF - Brockworth Place street renewal

Community Board Consideration

Staff in attendance spoke to the accompanying report.

The Board took into consideration the deputation the Deans Avenue Precinct Society (3.4 of these minutes refers).

Community Board Resolved JM-WH/2025/00006 Community Board recommendations accepted without change

Part C

That the Waipuna Halswell Hornby Riccarton Community Board:

1. Receives the information in the Riccarton CRAF - Brockworth Place street renewal Report.
2. Notes that the decision in this report is assessed as low significance based on the Christchurch City Council's Significance and Engagement Policy.
3. Approves the following recommendations required for the implementation of the project, relying on its powers under the Christchurch City Council Traffic and Parking Bylaw 2017 and Part 21 of the Local Government Act 1974.
4. Approves all kerb alignments, road surface treatment, road markings, landscaping and street trees on Brockworth Place, commencing at its southern intersection with Deans Avenue, and extending in a westerly direction to its western end (hammerhead), as shown in Attachment A to the report on the meeting agenda (Plan TP363202, Issue 1, dated 05/02/2025).
5. Approves, pursuant to Clause 6 of the Christchurch City Council Traffic and Parking Bylaw 2017, that a Stop control be placed against Brockworth Place at its southern intersection with Deans Avenue, as shown in Attachment A to the report on the meeting agenda (Plan TP363202, Issue 1, dated 05/02/2025).
6. Approves, pursuant to Clause 7 of the Christchurch City Council Traffic and Parking Bylaw 2017, as shown in Attachment A to the report on the meeting agenda (Plan TP363202, Issue 1, dated 05/02/2025) that the stopping of vehicles be prohibited at any time on the southern side of Brockworth Place commencing at its southern intersection with Deans Avenue, and extending in a westerly direction for a distance of 19 metres.
7. Approves, pursuant to Clause 7 of the Christchurch City Council Traffic and Parking Bylaw 2017, as shown in Attachment A to the report on the meeting agenda (Plan TP363202, Issue 1, dated 05/02/2025) that the stopping of all vehicles be prohibited at all times on the southern side of Brockworth Place commencing at a point 132 metres west of its southern intersection with Deans Avenue, and extending in a westerly direction for a distance of 35 metres.
8. Approves, pursuant to Clause 7 of the Christchurch City Council Traffic and Parking Bylaw 2017, as shown in Attachment A to the report on the meeting agenda (Plan TP363202, Issue 1, dated 05/02/2025) that the stopping of vehicles be prohibited at any time on the southern side of Brockworth Place commencing at a point 205 metres west of its southern intersection with Deans Avenue, and extending in a westerly direction then northerly direction and easterly direction for a distance of 30 metres.
9. Approves, pursuant to Clause 7 of the Christchurch City Council Traffic and Parking Bylaw 2017, as shown in Attachment A to the report on the meeting agenda (Plan TP363202, Issue 1, dated 05/02/2025) that the stopping of vehicles be prohibited at any time on the northern side of Brockworth Place commencing at its southern intersection with Deans Avenue, and extending in a westerly direction for a distance of 31 metres.
10. Approves, pursuant to Clause 7 of the Christchurch City Council Traffic and Parking Bylaw 2017, as shown in Attachment A to the report on the meeting agenda (Plan TP363202, Issue 1, dated 05/02/2025) that the stopping of all vehicles be prohibited at all times on the northern side of Brockworth Place commencing at a point 135 metres west of its southern intersection with Deans Avenue, and extending in a westerly direction then northerly direction for a distance of 30 metres.
11. Approves, pursuant to Clause 7 of the Christchurch City Council Traffic and Parking Bylaw 2017, as shown in Attachment A to the report on the meeting agenda (Plan TP363202, Issue 1, dated 05/02/2025) that the stopping of vehicles be prohibited at any time on the northern side of Brockworth Place commencing at a point 45 metres east of its western end

(hammerhead), and extending in an easterly direction then northerly direction for a distance of 39 metres.

12. Revokes any previous resolutions pertaining to traffic controls made pursuant to any bylaw to the extent that they are in conflict with the traffic controls described in 5 to 11 above.
13. Approves that these resolutions take effect when parking signage and/or road marking that evidence the restrictions described in 5 to 11 above are in place (or removed in the case of revocations).

Tyla Harrison-Hunt/Henk Buunk

Carried

Mark Peters requested that his vote against the resolutions be recorded.

Karakia Whakamutunga

Meeting concluded at 7.08 pm.

CONFIRMED THIS 10th DAY OF APRIL 2025

MARIE POLLISCO
CHAIRPERSON
WAIPUNA HALSWELL-HORNBY-RICCARTON COMMUNITY BOARD

EMMA NORRISH
CHAIRPERSON
WAIPAPA PAPANUI-INNES-CENTRAL COMMUNITY BOARD

8. Proposed Road Names - 179 Milns Road

Reference Te Tohutoro: 25/465546

Responsible Officer(s) Te Pou Matua: Sean Ward, Team Leader Planning

Accountable ELT Member Pouwhakarae: John Higgins, General Manager Strategy, Planning & Regulatory Services

1. Purpose and Origin of the Report Te Pūtake Pūrongo

- 1.1 The purpose of this report is for the Waipuna Halswell-Hornby-Riccarton Community Board to approve the proposed road names at 179 Milns Road.
- 1.2 The report is staff-generated resulting from a naming request received from the developer.

2. Officer Recommendations Ngā Tūtohu

That the Waipuna Halswell-Hornby-Riccarton Community Board:

1. Receives the information in the Proposed Road Names - 179 Milns Road Report.
2. Notes that the decision in this report is assessed as low significance based on the Christchurch City Council's Significance and Engagement Policy.
3. Approves the following new road names for 179 Milns Road (RMA/2022/2381)
 - a. Road 1 - Bethia Road
 - b. Road 2 - Archibald Place
 - c. Road 3 - Beadel Road

3. Detail Te Whakamahuki

Introduction Te Whakatkinga

- 3.1 A road naming request has been submitted by Capture Land Ltd on behalf of the developer. A preferred name and alternative names have been put forward for the roads.
- 3.2 The recommended road names have been checked against existing road names in Christchurch and bordering districts, for duplication, alternative spelling, or other similarities in spelling or pronunciation to avoid the potential for confusion. The proposed names are considered sufficiently different to existing road names.
- 3.3 The recommended road names have been checked against the Council's Naming Policy dated 15 November 2023 and are considered to be consistent with this policy. The specific criteria for assessing a name from clause 2 is set out below.
 - 3.3.1 A traditional or Māori name which is acceptable to the Rūnanga or Iwi; this may be a name reflecting the physical characteristics of an area, an activity or event associated with the area or of a notable ancestor.
 - 3.3.2 A feature of historical, social, cultural, environmental or physical importance in the area (e.g., Carlton Mill Road or Carlton Mill Reserve*).
 - 3.3.3 The name of a notable family, person or event associated with the locality or with the wider Christchurch area.

- 3.3.4 A name in recognition of a person's service. This can be for community service, conservation, sport, the arts, science and research or other sphere of activity.
- 3.3.5 Consistency with a common or established theme for naming in a subdivision or locality.
- 3.3.6 A name that reflects the diverse cultures and communities of the locality or of Christchurch generally.
- 3.3.7 The name of an event or activity strongly associated with the immediate location including an informal name for the area that is (or was historically) in common usage.
- 3.3.8 A name associated with a person, event or activity of significance to Christchurch including names associated with people, events, or places of national and international significance.
- 3.4 The criteria for names that are not suitable for approval from clause 6 are set out below.
 - 3.4.1 Names of people, flora, fauna or geographical features not associated with the area, e.g., names of native trees which are not present in the area or views that cannot be identified, except where the name continues a current naming theme in the locality.
 - 3.4.2 Currently trading commercial organisations except for sponsorship names for facilities and leased parks.
 - 3.4.3 Anagrams, amalgamations or derivatives of people's names.
 - 3.4.4 Names of living persons.
 - 3.4.5 Names related to the developer of a subdivision.
 - 3.4.6 Name of a person, club or organisation associated with a privately owned building on Council land, where the club or organisation does not hold the ground lease for the building.
 - 3.4.7 Names for roads which may cause confusion because they are associated with another geographical location or feature e.g., Parklands Drive which is not located in the Parklands suburb.
- 3.5 The recommended road names have also been checked against the Australia and New Zealand Standard AS/NZA 4819:2011 Rural and Urban Addressing. The names are considered to be consistent with the Standard.
- 3.6 Under the Roads and Right-of-Way Naming Policy, the names considered must be requested by the developer. There is no ability to consider alternative names without first checking whether there are any duplications or similarities with other road and right-of-way names.
- 3.7 Consultation has been undertaken with Land Information New Zealand who have raised no concerns with the proposed names.
- 3.8 Consultation under the policy with rūnanga is not required because the roads to be named are not collector roads and/or site(s) of significance under the District Plan (clause 3 of the Naming Policy).
- 3.9 No addresses of neighbouring properties are affected by the proposed road naming (clause 12.2 of the Naming Policy).
- 3.10 The names requested have been accompanied by an explanation of the background of the names, which is summarised below.

Assessment of Significance and Engagement Te Aromatawai Whakahirahira

- 3.11 The decisions in this report are assessed as low significance based on the Christchurch City Council's Significance and Engagement Policy.
- 3.12 The level of significance was determined by the number of people affected and/or with an interest.
- 3.13 Due to the assessment of low significance, no further community engagement and consultation is required.

Proposed Names

- 3.14 The proposed roads are shown in **Attachment A**.
- 3.15 The proposed names are themed for local history.
- 3.16 Road 1 - Bethia Road
- 3.17 Bethia Robertson (1835-1879) married John Miln in 1859. John Miln was one of the early settlers in Halswell and they became a well known and respected Halswell family. They both lived at Te Repo Estate. This subdivision is believed to be within the original Te Repo Estate. Bethia passed away in 1879 at age 44.
- 3.18 Road 2 - Archibald Place
- 3.19 Private James Archibald (1897-1916) was a local soldier who was a casualty of World War I, passing away in 1916. He was the son of James and Ethel Archibald, a local family. His name appears on the Halswell War Memorial.
- 3.20 Road 3 - Beadel Road
- 3.21 Charles Pitt Beadel (1842-1891), who was a member of the Halswell Road Board from 1883 until 1890 and manager of Sir John Cracroft Wilson's Cashmere Estate. A memorial gate was installed in memory of Charles at the Halswell Churchyard (St Mary Anglican Church Cemetery) after Charles passed away in 1891.



Alternative Names

- 3.22 Bougen Road/Place - Robert Bougen was a long-time local resident, blacksmith, and served as a member of the Halswell School Board in the 1890s, holding the office of secretary. This name recognizes his contributions to the community.
- 3.23 Binzian Road/Place - Binzian Mill, near Durning in Perthshire, Scotland, is the birthplace of John Miln, one of the early settlers in Halswell. Miln first purchased land in Halswell in 1853, being Te Repo Estate. This subdivision is believed to be within the original Te Repo Estate, where John Miln lived until his passing.
- 3.24 Columnar Street - There were two main types of stone that came out of the nearby Halswell Quarry. One being Olivine Hawaiite (which is more commonly called Halswell Stone) and Columnar Basalt. There were significant amounts of Columnar Basalt excavated from the quarry. The Columnar basalt was often crushed and used as road metal in roads around Christchurch.
- 3.25 Officers Note: *If any alternative names are chosen, the appropriate road type for the road will be used.*

Assessment of Names

- 3.26 The proposed name is considered to be consistent with the policy.
- 3.27 Notwithstanding, the discretion lies with the Community Board to approve any of the above name options, including the alternative names.

Attachments Ngā Tāpirihanga

No.	Title	Reference	Page
A  	Proposed Road Names - 179 Milns Road	25/359300	35

Signatories Ngā Kaiwaitohu

Authors	Leashelle Miller - Planner Level 2 Sean Ward - Team Leader Planning
Approved By	Mark Stevenson - Acting Head of Planning & Consents

Christchurch City Council
RMA/2022/2381
Approved Resource Consent Plan
04/08/2023 White, Francis

Page 1 of 1

AMENDMENT	DATE	DESCRIPTION

- NOTES:
- Areas and dimensions are subject to final survey and deposit of plans.
 - Service easements to be created as required.
 - This plan has been prepared for subdivision consent purposes only. No liability is accepted if the plan is used for any other purpose.
 - This plan has been prepared for the use of our client and no liability is accepted in relation to any other parties.
 - Any measurements taken from information which is not dimensioned on the electronic copy are at the risk of the recipient.
 - This plan is subject to the granting of subdivision and/or resource consents and should be treated as a proposal until such time as the necessary consents have been granted by the relevant authorities.

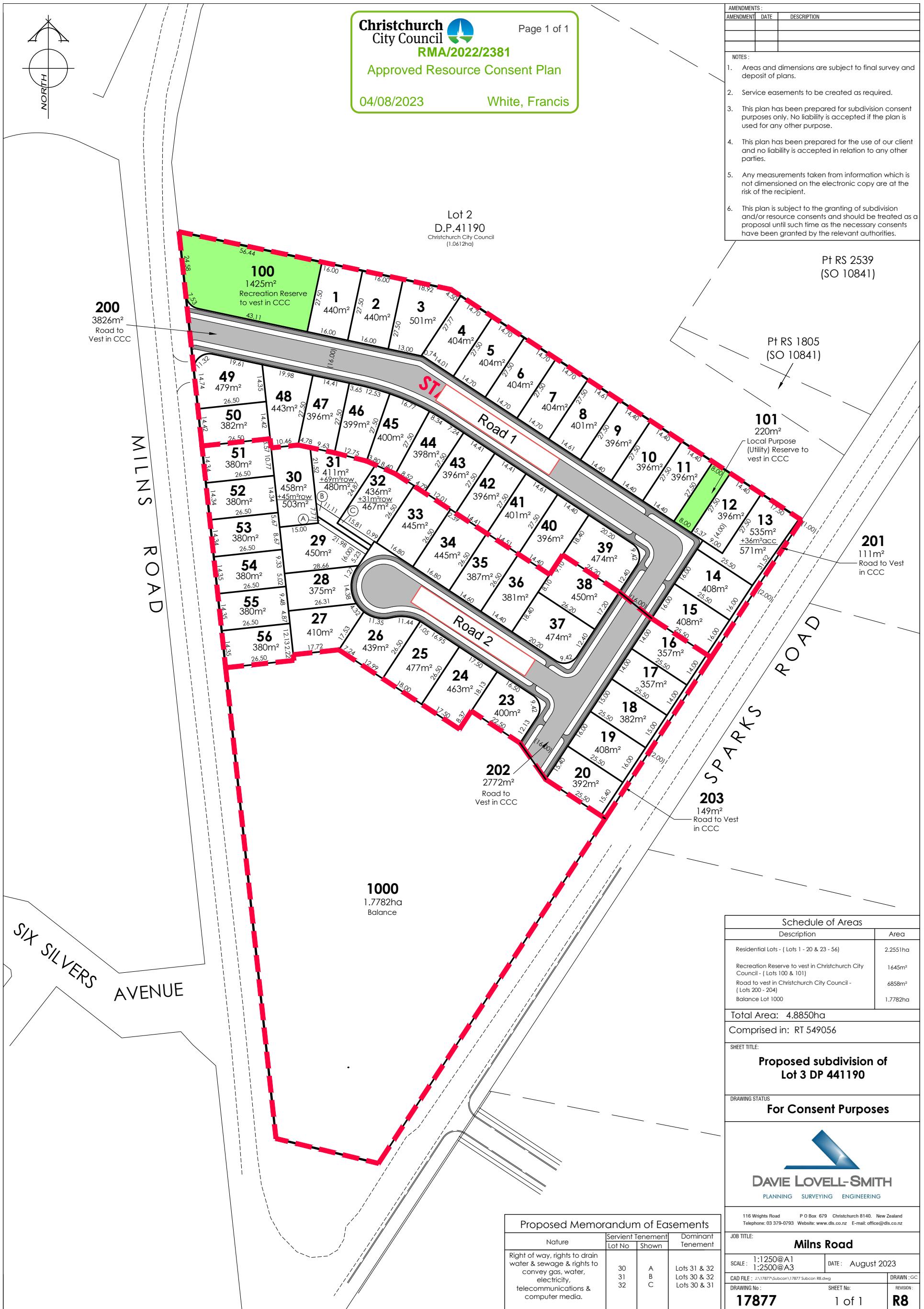

Lot 2
D.P.41190
Christchurch City Council
(1.0612ha)

Pt RS 2539
(SO 10841)

Pt RS 1805
(SO 10841)

101
220m²
Local Purpose
(Utility) Reserve to
vest in CCC

201
111m²
Road to Vest
in CCC

202
2772m²
Road to
Vest in CCC

203
149m²
Road to Vest
in CCC

Schedule of Areas	
Description	Area
Residential Lots - (Lots 1 - 20 & 23 - 56)	2.2551ha
Recreation Reserve to vest in Christchurch City Council - (Lots 100 & 101)	1645m ²
Road to vest in Christchurch City Council - (Lots 200 - 204)	6858m ²
Balance Lot 1000	1.7782ha

Total Area: 4.8850ha
Comprised in: RT 549056

SHEET TITLE:
**Proposed subdivision of
Lot 3 DP 441190**

DRAWING STATUS:
For Consent Purposes

DAVIE LOVELL-SMITH
PLANNING SURVEYING ENGINEERING

116 Wrights Road P O Box 679 Christchurch 8140, New Zealand
Telephone: 03 379-0793 Website: www.dls.co.nz E-mail: office@dls.co.nz

JOB TITLE:
Milns Road

SCALE: 1:1250@A1
1:2500@A3
DATE: August 2023
DRAWING No: **17877** SHEET No: 1 of 1 REVISION: **R8**

Proposed Memorandum of Easements			
Nature	Servient Tenement		Dominant Tenement
	Lot No	Shown	
Right of way, rights to drain water & sewage & rights to convey gas, water, electricity, telecommunications & computer media.	30	A	Lots 31 & 32 Lots 30 & 32 Lots 30 & 31
	31	B	
	32	C	

Christchurch City Council
RMA/2024/131
Approved Resource Consent Plan
18/07/2024 White, Francis
Page 1 of 3

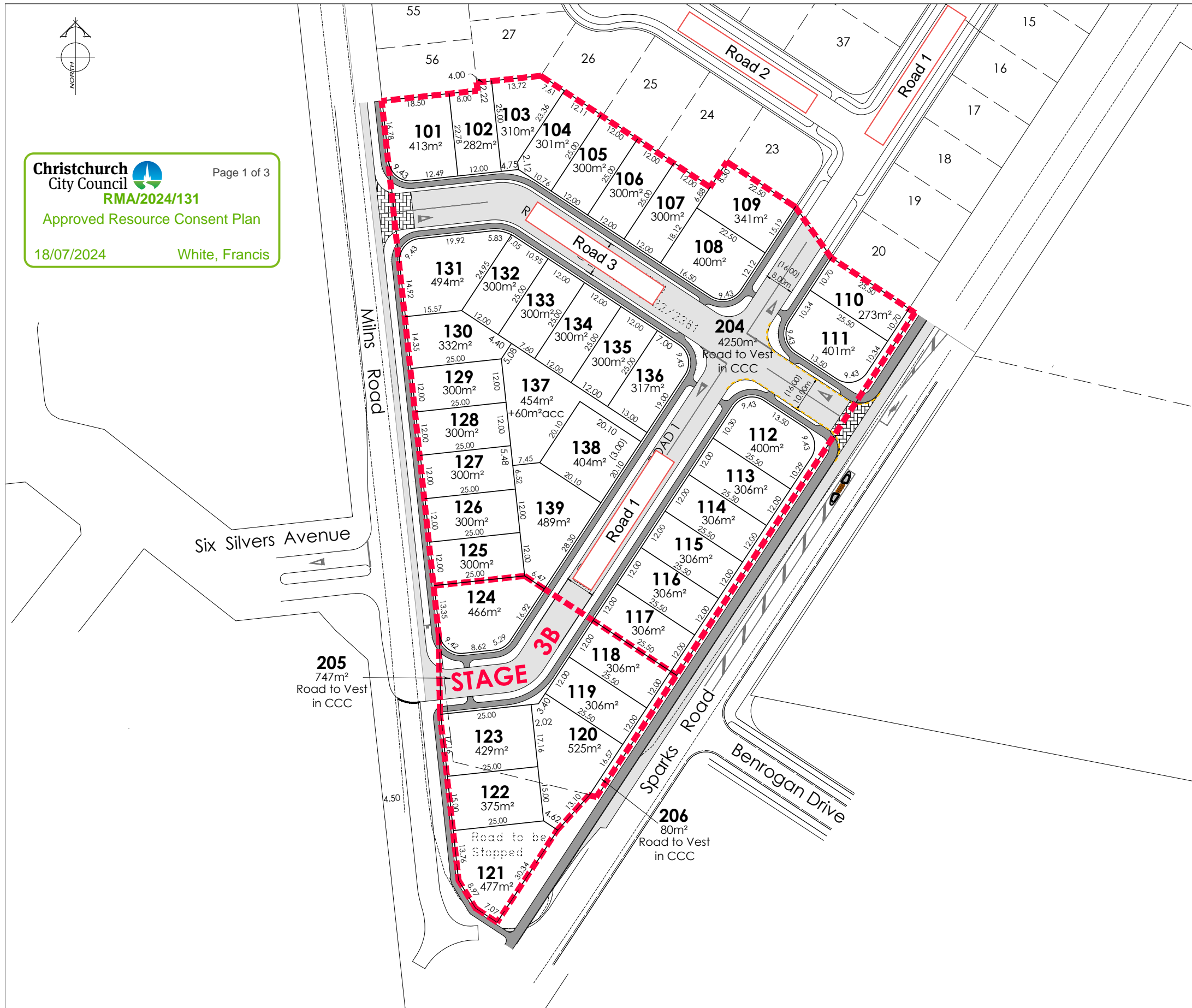

AMENDMENT	DATE	DESCRIPTION
R1	20.10	EXTERNAL BDY UPDATED INTERMS TSS
R2	13.12	EXTERNAL BDY UPDATED INTERMS TSS
R3	05.03	LOT 204 AMENDED & LOT 206 ADDED

- NOTES:
- 1) Areas and dimensions are subject to final survey and deposit of plans.
 - 2) Service easements to be created as required.
 - 3) This plan has been prepared for subdivision consent purposes only. No liability is accepted if the plan is used for any other purpose.
 - 4) This plan has been prepared for the use of our client and no liability is accepted in relation to any other parties.
 - 5) Any measurements taken from information which is not dimensioned on the electronic copy are at the risk of the recipient.
 - 6) This plan is subject to the granting of subdivision and/or resource consents and should be treated as a proposal until such time as the necessary consents have been granted by the relevant authorities.

Schedule of Areas	
Description	Area
Residential Lots - (Lots 101 - 139)	1.3693ha
Road to vest in Christchurch City Council - (Lot 204, 205 & 206)	5077m ²
Total Area:	1.8772ha
Comprised in: RT Yet to be issued	

DAVIE LOVELL-SMITH
PLANNING SURVEYING ENGINEERING
116 Wrights Road P O Box 679 Christchurch 8140. New Zealand
Telephone: 03 379-0793 Website: www.dls.co.nz E-mail: office@dls.co.nz

JOB TITLE:
179 Milns Road - STAGE 3

SHEET TITLE:
Proposed subdivision of lot 1000 RMA/2022/2381 & Road to be stopped

DRAWING STATUS:
For Subdivision Consent

SCALE: 1:500@A1 DATE: March 2024

CAD FILE: J:\17877\Subcon\PHASE I\17877 Subcon Phase 2 R3.dwg REVISION:
DRAWING No: **E17877** SHEET No: 1 OF 1

R3

9. Planting along the upper edge of the Ngā Puna Wai embankment

Reference Te Tohutoro: 25/524298

Responsible Officer(s) Te Pou Matua: Toby Chapman (Urban Forest Manager)

Accountable ELT Member Pouwhakarae: Andrew Rutledge, General Manager Citizens and Community

1. Purpose and Origin of the Report Te Pūtake Pūrongo

- 1.1 The purpose of this report is to seek approval for the planting of a hedge and specimen trees along the top edge of the embankment encircling the Nga Puna Wai athletics track.
- 1.2 The primary purpose of the planting is to provide shelter from the North Easterly wind which has caused issues for the athletic events.

2. Officer Recommendations Ngā Tūtohu

That the Waipuna Halswell-Hornby-Riccarton Community Board:

1. Receives the information in the Planting along the upper edge of the Ngā Puna Wai embankment Report.
2. Notes that the decision in this report is assessed as low significance based on the Christchurch City Council's Significance and Engagement Policy.
3. Approve the planting of a hedge and individual specimen trees along the top of the embankment within Nga Pua Wai.

3. Executive Summary Te Whakarāpopoto Matua

- 3.1 The athletics track at Nga Puna Wai is home to a large number of regular athletic events including national, international and local schools.
- 3.2 An ongoing issue that has been raised by the users of the track is the wind, specifically the North Easterly.
- 3.3 Staff have engaged with Council's Recreational staff and the General Manager of the Athletics Canterbury to look at additional planting on the embankment to provide shelter from the wind.
- 3.4 Three options were considered for the type of planting with the preferred option being made up of a hedge and specimen tree planting evenly distributed along the North East section of the embankment.

4. Background/Context Te Horopaki

- 4.1 The Nga Puna Wai athletics field is a space that is used regularly throughout the year.
- 4.2 The site is used for the Colgate games, International track meets and a large number of school events throughout the year as well as regular training.

- 4.3 Due to the location of the site and its exposure to the elements, the athletics club are often having to compete with windy conditions causing a number of issues with different events.
- 4.4 As a result, the Athletics club have requested that Council investigate a long term solution to provide shelter from the wind with a particular focus on the North Eastern section.
- 4.5 Staff visited the site and discussed a range of different planting options with recreation staff and the General Manager of Athletic Canterbury Ian Thomas.
- 4.6 Staff assessed the existing vegetation on site to determine the long term prospects of it getting tall enough to provide sufficient shelter. Due to a combination of soil, wind exposure and species, it is highly unlikely that the trees will reach the necessary height to provide sufficient shelter.
- 4.7 Staff therefore recommend establishing a more favourable growing medium for planting along the upper edge of the embankment followed by planting of species that are well suited to windy conditions.
- 4.8 A concern that was raised during the site meeting was the usability of the embankment which is often heavily utilised by spectators during events. A large number of the groups for these events will also setup Gazebos along the top of the embankment to provide a space for the teams to leave gear and provide shade to spectators.
- 4.9 It was made clear that any planting would need to be completed in a way that did not compromise the way the embankment is used.
- 4.10 Two options were considered for the site:
 - 4.10.1 Planting of a hedge
 - 4.10.2 Planting of a hedge with specimen trees planted directly in front of the hedge at 6m spacing
- 4.11 The first option to simply plant a hedge would provide shelter to the embankment however; to gain the necessary wind protection over the rest of the track, the hedge would need to be allowed to grow high (15m+). While the hedging species has the capacity to grow to this height, the ongoing maintenance would be particularly costly as access would be challenging, particularly on the lower embankment side.
- 4.12 The second option allows for a hedge to be planted similar to option one however the hedge will be maintained at 2.5m tall. This height will be much easier to maintain and will provide good shelter to those on the embankment. In the same alignment as the hedge, specimen trees will be planted at 6m intervals. As these trees mature they will provide shelter above the hedge and to a greater height. The specimen trees will have the added benefit of providing shade for spectators in the summer months.

4.13 The two images below provide a visual representation of the planting at maturity:

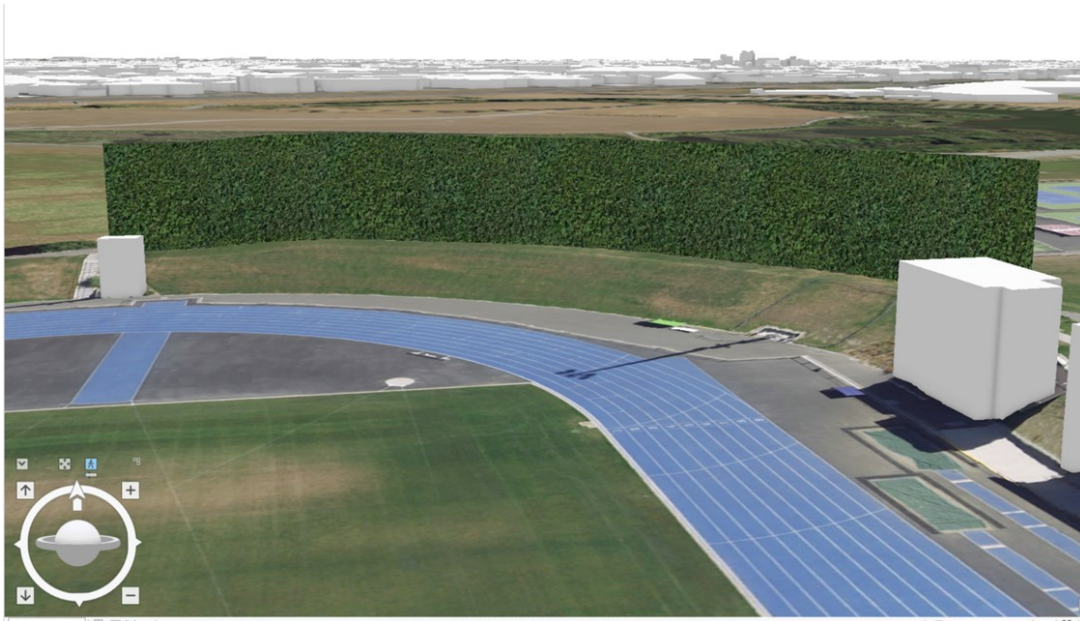

Image: Depicts option 1 at maturity

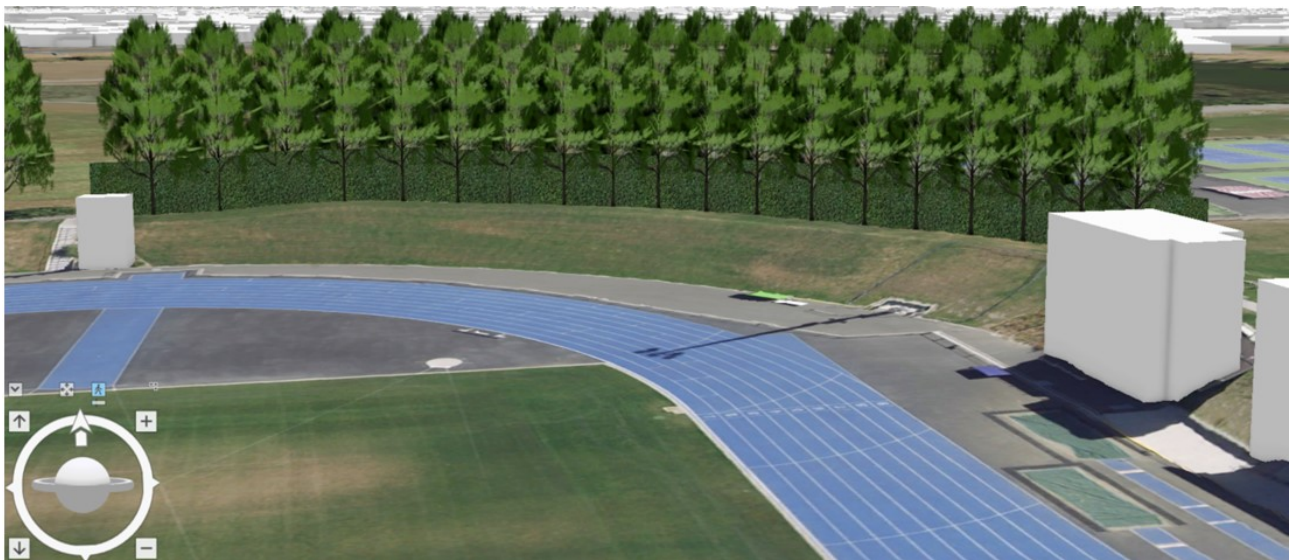

Image 2: Depicts option 2 at maturity

4.14 The following related memos/information were circulated to the meeting members:

Date	Subject

4.15 The following related information session/workshops have taken place for the members of the meeting:

Date	Subject

Options Considered Ngā Kōwhiringa Whaiwhakaaro

4.16 The following reasonably practicable options were considered and are assessed in this report:

4.16.1 Planting of a hedge and specimen trees along the North Eastern edge of the embankment.

4.16.2 Planting of just a hedge along the North Easter edge of the embankment.

4.17 The following options were considered but ruled out:

4.17.1 No planting on the embankment- Wind shelter would not be provided.

4.17.2 Planting a hedge and trees along the entire embankment – Staff feel it would be best to start with the North Eastern section first and come back to the board at a later date if there is a desire for the rest of the embankment to be planted.

Options Descriptions Ngā Kōwhiringa

4.18 **Preferred Option:** Hedge and Tree Planting.

4.18.1 **Option Description:** Approve the planting of a hedge and specimen trees.

4.18.2 **Option Advantages**

- Hedge will provide shelter and shade to the spectators on the embankment.
- The specimen trees will provide wind protection to the track below

4.18.3 **Option Disadvantages**

- Establishment .

4.19 Hedge only.

4.19.1 **Option Description:** Simply planting a hedge and allowing it to grow to 15m+.

4.19.2 **Option Advantages**

- Hedge will provide shelter from the wind to the spectators and the field.
- Lower establishment cost due to no specimen trees being planted

4.19.3 **Option Disadvantages**

- Future maintenance costs will be high
- Hedge will not provide shade to spectators in the middle of the day.

Analysis Criteria Ngā Paearu Wetekina

4.20 Shelter provided to the embankment and field.

5. Financial Implications Ngā Hīraunga Rauemi

Capex/Opex Ngā Utu Whakahaere

	Recommended Option	Option 2 – Hedge only	Option 3 – No planting
Cost to Implement	\$30k	\$17K	\$0
Maintenance/Ongoing Costs	\$2k per annum	\$2k per annum	\$0
Funding Source	Urban Forest Tree Planting program	Urban Forest Tree Planting program	N/A

Funding Availability	Yes	Yes	Yes
Impact on Rates	Nil	Nil	Nil

6. Considerations Ngā Whai Whakaaro

Risks and Mitigations Ngā Mōrearea me ngā Whakamātautau

- 6.1 The site is a hostile site for the trees to grow and even with suitable species and improved soil, there is a chance that we may suffer some tree loss.

Legal Considerations Ngā Hiraunga ā-Ture

- 6.2 Statutory and/or delegated authority to undertake proposals in the report:

6.2.1 Under the Reserves Act, Community Boards have the delegation to “*determine to plant, maintain and remove trees on reserves within the policy set by the Council*”

- 6.3 Other Legal Implications:

6.3.1 There is no legal context, issue, or implication relevant to this decision.

Strategy and Policy Considerations Te Whai Kaupapa here

- 6.4 Parks, Heritage and Coastal Environment

6.4.1 *Activity: Parks and Foreshore*

6.4.2 *Level of Service: 6.8.2.1 Increasing tree canopy in Parks - A net increase in total number of trees is achieved (1:2 replacement policy), with a minimum of 50% of the trees being medium to very large species <Is/Are> assessed as <high/medium/low> significance based on the Christchurch City Council’s Significance and Engagement Policy. The level of significance was determined by <enter text>.*

6.4.3 Is Consistent with Council’s Plans and Policies.

- 6.5 This report supports the [Council's Long Term Plan \(2024 - 2034\)](#):

- 6.6 Parks, Heritage and Coastal Environment

6.6.1 *Activity: Parks and Foreshore*

- *Level of Service: 6.8.2.1 Increasing tree canopy in Parks - A net increase in total number of trees is achieved (1:2 replacement policy), with a minimum of 50% of the trees being medium to very large species*

Community Impacts and Views Ngā Mariu ā-Hāpori

- 6.7 Feedback from the General Manager of the Athletics club has been positive.

- 6.8 The decision affects the following wards/Community Board areas:

- 6.9 Waipuna Halswell-Hornby-Riccarton Community Board

Impact on Mana Whenua Ngā Whai Take Mana Whenua

- 6.10 The decisions do not involve a significant decision in relation to ancestral land, a body of water or other elements of intrinsic value, therefore this decision does not specifically impact Mana Whenua, their culture, and traditions.

- 6.11 The decision does not involve a matter of interest to Mana Whenua and will not impact on our agreed partnership priorities with Ngā Papatipu Rūnanga.

Climate Change Impact Considerations Ngā Whai Whakaaro mā te Āhuarangi

6.12 The decisions in this report are likely to:

6.12.1 Contribute **positively** to adaptation to the impacts of climate change by reducing the urban 'heat island' effect

6.13 Contribute **positively** to emissions reductions, due to the inherent ability of trees to sequester carbon. This will assist in the Council's offsetting objectives.

7. Next Steps Ngā Mahinga ā-muri

7.1 Once approved, staff will work with the athletics club to find a suitable time to undertake works without disrupting their use.

Attachments Ngā Tāpirihanga

There are no attachments to this report.

In addition to the attached documents, the following background information is available:

Document Name - Location / File Link
Not applicable

Signatories Ngā Kaiwaitohu

Author	Toby Chapman - Manager Urban Forest
Approved By	Rupert Bool - Acting Head of Parks

10. Extraordinary Vacancy Waipuna Halswell-Hornby-Riccarton Community Board - resignation of Gamal Fouda

Reference Te Tohutoro: 25/668821

Responsible Officer(s) Te Pou Matua: Bailey Peterson, Community Governance Manager

Accountable ELT Member Pouwhakarae: Andrew Rutledge, General Manager Citizens and Community

1. Purpose and Origin of the Report Te Pūtake Pūrongo

- 1.1 The purpose of this report is to provide information to the Board in respect of the extraordinary vacancy arising from the recent resignation of Community Board member Gamal Fouda.
- 1.2 The report is staff-generated following receipt of notice from the Chief Executive of the resignation of Community Board member Gamal Fouda on Monday 31 March 2025.

2. Context Te Horopaki

- 2.1 The Board received notice, given under section 117(2) of the Local Electoral Act 2001, from the Chief Executive on 31 March 2025 that Community Board member Gamal Fouda has resigned from the Waipuna Halswell-Hornby-Riccarton Community Board effective immediately.
- 2.2 This creates an extraordinary vacancy on the Community Board. Where a vacancy occurs within 12 months of the next triennial local government election, a by-election is not required, and the Board has the option to either leave the vacancy unfilled or appoint a person to fill the vacancy for the remainder of the triennial term.
- 2.3 The next triennial elections are on 11 October 2025.
- 2.4 There are five scheduled Board meetings remaining until the 2025 elections.

3. Legal Considerations Ngā Whai Whakaaro

- 3.1 Statutory authority to undertake the proposals in the report are detailed in the Local Electoral Act 2001:

Section 117 of the Local Electoral Act 2001- Extraordinary vacancy in local authority or community board – provides that:

(2) If a vacancy occurs in the office of a member of a local authority or in the office of an elected member of a community board 12 months or less than 12 months before the next triennial general election, the chief executive of the local authority concerned must notify the local authority or community board of the vacancy immediately.

(3) On receiving notice under subsection (2) the local authority or community board must, at its next meeting (other than an extraordinary meeting) or, if that is not practicable, at its next subsequent meeting (other than an extraordinary meeting), determine by resolution –

- (a) that the vacancy will be filled by the appointment by the local authority or community board of a person named in the resolution who is qualified to be elected as a member; or

- (b) that the vacancy is not to be filled.

If for any reason the person specified in the resolution is unavailable, or otherwise unable to be notified of the appointment, a further vacancy occurs in that office.

Section 118 of the Local Electoral Act 2001– Notice of intention to fill vacancy by appointment- provides that

(1) If, under section 117(3)(a) or section 117A, a local authority or community board resolves that a vacancy will be filled by the appointment of a person by the local authority or community board, it must immediately, unless the vacancy is for the office of mayor, give public notice of—

- (a) the resolution; and
- (b) the process or criteria by which the person named in the resolution was selected for appointment.

(2) The local authority or community board must, at a meeting held not later than the expiry of the prescribed period, by resolution confirm the appointment described in the resolution under subsection (1); and the person appointed is for all purposes to be treated as having been elected to fill the vacancy on the date on which that resolution is made.

(3) For the purposes of subsection (2), the expiry of the prescribed period is 30 days after the date of notification of the resolution under subsection (1).

(4) If for any reason the person specified in the resolution is unavailable or otherwise unable to be confirmed in the appointment, a further vacancy occurs in that office.

Section 119 of the Local Electoral Act 2001- Notice of intention to leave vacancy unfilled provides

- If, under section 117(3)(b), a local authority or local board or community board resolves not to fill a vacancy, it must immediately give public notice of its decision.<Enter Heading>

Attachments Ngā Tāpirihanga

There are no attachments to this report.

Signatories Ngā Kaiwaitohu

Authors	Faye Collins - Community Board Advisor Bailey Peterson - Manager Community Governance, Halswell-Hornby-Riccarton Jo Daly - Council Governance Advisor
Approved By	John Filsell - Head of Community Support and Partnerships Andrew Rutledge - General Manager Citizens and Community

11. Waipuna Halswell-Hornby-Riccarton Community Board Discretionary Response Fund Application - Afghan Womans Group

Reference Te Tohutoro: 25/593350

Responsible Officer(s) Te
Pou Matua: Marie Byrne, Community Development Advisor

Accountable ELT
Member Pouwhakarae: Andrew Rutledge, General Manager Citizens and Community

1. Purpose and Origin of the Report Te Pūtake Pūrongo

- 1.1 The purpose of this report is for the Waipuna Halswell-Hornby-Riccarton Community Board to consider an application for funding from its 2024/25 Discretionary Response Fund from the organisation listed below.

Funding Request Number	Organisation	Project Name	Amount Requested	Amount Recommended
DRF202425027_HHR	Afghan Womans Group	Eid Celebration for Afghan Families	\$1,700	\$1,200

- 1.2 There is currently a balance of \$53,787 remaining in the fund.

2. Officer Recommendations Ngā Tūtohu

That the Waipuna Halswell-Hornby-Riccarton Community Board:

1. Receives the information in the Waipuna Halswell-Hornby-Riccarton Community Board Discretionary Response Fund Application - Afghan Womans Group Report.
2. Notes that the decisions in this report are assessed as low significance based on the Christchurch City Council's Significance and Engagement Policy.
3. Approves a grant of \$1,200 from its 2024/25 Discretionary Response Fund to Afghan Womans Group towards the Eid Celebration for Afghan Families.

3. Key Points Ngā Take Matua

Strategic Alignment Te Rautaki Tīaroaro

- 3.1 The recommendations above are aligned with the Council's Strategic Framework and in particular the strategic priority "Be an inclusive and equitable city". The project also aligns with Te Haumako Te Whitingia Strengthening Communities Together Strategy, the Multicultural Strategy and Our Heritage, Our Taonga Heritage Strategy.
- 3.2 The recommendations are consistent with the Strengthening Communities Together Strategy.

Decision Making Authority Te Mana Whakatau

- 3.3 The Community Board has the delegated authority to determine the allocation of the Discretionary Response Fund for each community.
- 3.3.1 Allocations must be consistent with any Council-adopted policies, standards or criteria.

3.3.2 The Fund does not cover:

- Legal or environmental court challenges against the Council, Council Controlled Organisations, or Community Board decisions.
- Projects or initiatives that change the scope of a Council project or lead to ongoing operational costs to the Council (though Community Boards can recommend to the Council that it consider a grant for this purpose).

Assessment of Significance and Engagement Te Aromatawai Whakahirahira

- 3.4 The decisions in this report are assessed as low significance based on the Christchurch City Council’s Significance and Engagement Policy.
- 3.5 The significance level was determined by the number of people affected and/or with an interest.
- 3.6 Due to the assessment of low significance, no further community engagement and consultation is required.

Discussion Kōrerorero

3.7 At the time of writing, the balance of the 2024/25 Discretionary Response Fund is:

Total Budget 2024/25	Granted To Date	Available for allocation	Balance If Staff Recommendation adopted
\$152,866	\$99,079	\$53,787	\$52,587

- 3.8 Based on the current Discretionary Response Fund criteria, the application above is eligible for funding.
- 3.9 The attached Decision Matrix provides detailed information for this application. This includes organisational details, project details, financial information, and a staff assessment.

Attachments Ngā Tāpirihanga

No.	Title	Reference	Page
A 	Waipuna Halswell-Hornby-Riccarton Community Board Discretionary Response Fund Application Matrix - Afghan Womans Group	25/602691	47

Signatories Ngā Kaiwaitohu

Author	Marie Byrne - Community Development Advisor
Approved By	Bailey Peterson - Manager Community Governance, Halswell-Hornby-Riccarton

2024/25 WAIPUNA HALSWELL-HORNBY-RICCARTON DISCRETIONARY RESPONSE FUND DECISION MATRIX

Organisation Name	Project	Request Budget	Staff Recommendation	Priority
<p>Afghan Womans Group</p> <p>Application Number: DRF2024/25027_HHR</p> <p>Physical address Blenheim Rd, Riccarton</p> <p>CCC Funding History (past three years) NA</p>	<p>Eid Celebration for Afghan families</p> <p>The Afghan Womans Group request funding hold an event to celebrate Eid, which is the festival following the end of Ramadan. The proposed event is open to women and their children only. Culturally, these celebrations are for woman and children - without men. The event is planned to be held at the Christchurch Multicultural Centre on 11 April 2025.</p> <p>It will consist of music, dancing, performers, games and food,</p>	<p>Total Cost of Project: \$3,100</p> <p>Total Amount Requested: \$1,700</p> <p>Percentage of project requested: 55%</p> <p>Contribution sought towards: Decorations- \$400 Entertainment- \$500 Hall hire- \$250 Additional materials- \$150 Volunteer recognition- \$400</p> <p>Other sources of funding: Funds On Hand Donations In Kind</p>	<p>Recommended Amount \$1,200</p> <p>That the Waipuna Halswell-Hornby-Riccarton Community Board makes a grant of \$1,200 from its 2024/25 Waipuna Halswell-Hornby-Riccarton Discretionary Response Fund to the Afghan Womans Group towards the Eid Celebration for Afghan families project.</p>	<p>2</p>

CCC Strategy Alignment

Strengthening Communities Together Strategy, Multicultural Strategy

Outcomes that will be achieved through this project

The ability for Afghani women in Christchurch to join together with other Afghani women and their children to celebrate an important cultural event in a safe environment. Some of these lost family members on 15 March 2019. Afghani women new to Christchurch will get to meet other women and have fun. This is one of the only ways for us to get together. Maintain the traditions of our culture.

Staff Assessment

The Afghan Womans Group is an informal group of Afghani Women and their children which primarily gets together to reduce social isolation. A number of the women lost family members in the 15 March tragedy and have been forced to pick up new roles in the family unit that they were previously unfamiliar with. Amongst others there can be a tendency to stay within the home and not socialise. The Afghan Womans Group arranges activities and outings for the women that reduces the loneliness. The Eid event they are organising will be run by and for the women and children only and therefore a culturally safe place for the women to celebrate. While there are other Eid celebrations taking place, these involve men. Eid is a celebration marking the end of Ramadan. While it marks the end of a religious festival, the event is more of a cultural event rather than the promotion of religious causes. It is planned to be held at the Multicultural Centre with music, dancing, food and entertainment. Previously the group has applied for funding under different umbrella groupings, however they have recently become sufficiently organised to open their own bank account.

Rationale for staff recommendation

This event will provide an opportunity to reduce social isolation in Muslim women. The planning of the event will also build the skill levels of the women running the event.

12. Waipuna Halswell-Hornby-Riccarton Community Board Area Report - April 2025

Reference Te Tohutoro: 25/242386

Responsible Officer(s) Te Pou Matua: Bailey Peterson, Community Governance Manager

Accountable ELT Member Pouwhakarae: Andrew Rutledge, General Manager Citizens and Community

1. Purpose of Origin of the Report Te Pūtake Pūrongo

- 1.1 This report provides the Board with an overview of initiatives and issues current within the Community Board area.
- 1.2 This report is staff-generated monthly.

2. Officer Recommendations Ngā Tūtohu

That the Waipuna Halswell-Hornby-Riccarton Community Board:

1. Receives the information in the Waipuna Halswell-Hornby-Riccarton Community Board Area Report - April 2025.

3. Community Support, Governance and Partnership Activity

3.1 Community Governance Projects

Activity	Detail	Timeline	Strategic Alignment
Summer with your neighbours	Summer with your neighbours is about bringing people closer together and celebrating the unique and diverse mix of each neighbourhood. Summer with your neighbours events are currently underway, with events to be held before 30 April 2025.	Ongoing	Strengthening Communities Together Strategy
Community Pride Garden Awards 2025	Staff have organised an award ceremony in April and have invited the Board and recipients.	Ongoing	Strengthening Communities Together Strategy
Community Service and Youth Service Awards 2025	Nominations for the Community Service and Youth Service Awards 2025 were open from 7 March until 6 April 2025.	Ongoing	Strengthening Communities Together Strategy

	<p>More information is available at www.ccc.govt.nz/csa</p> 		
<p>Wycola Skate Park Workshops</p>	<p>The Christchurch City Council conducted two community workshops to inform the redesign of Wycola Skate Park, aiming to enhance safety and functionality.</p> <p>These workshops engaged local school children, residents and skateboarders, gathering valuable input to ensure the renewed park meets community needs. Key outcomes included incorporating diverse skate features, improving safety through design, and integrating cultural elements. This collaborative approach reflects the council's commitment to community involvement in public space development.</p> <p><i>Please see photos under 3.3.1.</i></p>	<p>Completed</p>	<p>Strengthening Communities Together Strategy</p>
<p>Culture Galore 2025</p>	<p>The Culture Galore event, scheduled for Saturday, 8 March 2025, at Ray Blank Park in Ilam, was cancelled following careful consideration of weather forecasts predicting significant rainfall on the day. This decision, while extremely difficult, was made to prioritise the safety of attendees, ground conditions and minimise financial risks associated with late cancellations. Postponement was not a viable option due to the scale of the event and the logistical and financial implications. Staff engaged extensively with participating groups and performers, with 99% of them expressing understanding and appreciation for the early decision made on Friday. While staff and the committee were understandably disappointed given the significant work and planning involved, they acknowledged the importance of acting in the best interest of all stakeholders. Planning is already underway for Culture Galore to return in 2026 at a new location, with further details to be shared in due course.</p>	<p>Completed</p>	<p>Strengthening Communities Together Strategy</p>

3.2 Community Funding Summary

3.2.1 For information, a summary is provided on the status of the Board's 2024-25 funding as at March 2025 (refer **Attachment A**).

3.2.2 Youth Development Fund

Under authority delegated by the Community Board the following allocations were made in March 2025:

- \$500 to Canterbury Pasifika Volleyball Association Incorporated towards Luisa Senetenari participating in the Polynesian Volleyball USA Tour in Las Vegas, USA.
- \$500 to Stella Crossan towards competing at the Asia Pacific Canoe Sprint Cup 2025 in Japan.
- \$1,000 to Badminton Canterbury Inc towards Katrina Huang, Marco Sun, Elaine Liu, Iris Gu, Dinuli Withanaarachchi, Roslynn Roby George, Zooni Butterfly Ahuja, Aidan Hu, Eben Anil, Ray Gao, Theodore Ling, Janie Wang, Georgia Barrett-Dobson, Kate Duffield, Kelly Shen and Alvin Zeng Wei competing at the New Zealand Junior Team Badminton Championships, in Palmerston North.

3.2.3 Off the Ground Fund

Under authority delegated to the Community Governance Manager the following allocation was made in March 2025:

- \$392 to Vy Tran towards the Migrant Information Centre Vietnamese Beef Noodle (Pho Bo) workshop.

3.3 Participation in and Contribution to Decision Making

3.3.1 **Report back on other Activities contributing to Community Board Plan [for items not included in the above table but are included in Community Board Plan]**

- **Wycola Skate Park Workshops**

As noted under 3.1 Community Governance Projects.





- **ANZAC Day Services 2025**

Local services being held on Friday 25 April include:

- **20th Battalion Association Commemoration ANZAC Service**, Jane Deans Close, Riccarton, 9am.
- **Halswell ANZAC Service**, Halswell Memorial site adjacent to the Halswell Domain, Halswell Road, 9am.
- **Hornby ANZAC Service**, War Memorial site in the grounds of Hornby Primary School, 190 Waterloo Road, 9am.
- **UCSA hosted ANZAC Service**, Matariki Quad, University of Canterbury, 20 Kirkwood Avenue, 10am.
- **Templeton RSA ANZAC Service**, 38 Kirk Road, Templeton, 11am.
- **Wigram ANZAC Service**, Air Force Museum of New Zealand, 45 Harvard Avenue, 12noon.

- **Connect 2025**

On Friday, 28th February, Connect 2025 took place at Harrington Park in the early evening. This event aims to welcome new residents to the area and introduce them to local activities and community groups.

Organised by Oak Development Trust, the event is made possible through the dedication of volunteers and the support of local businesses and community partnerships.

A range of engaging activities entertained attendees, including Pedalmania with their unique and quirky bikes, sack racing, stone painting, and an exciting tug-of-war finale, where the children claimed victory over the adults. The Riccarton Community Garden were also present, further enhancing the community spirit.

The Community thoroughly enjoyed the event, with one participant particularly appreciating the Human Bingo activity. This interactive game encouraged social connections by having attendees find others who met specific criteria, such as sharing the same birth month or recently watching a movie.



- **Hello Hornby**

The Hello Hornby event, held on March 15 2025, at Wycla Park, was a resounding success, surpassing last year's festivities. Organised by a dedicated committee of community volunteers with the support of Hornby Community Care Trust. The event benefited from superb weather, attracting hundreds of attendees. The day featured continuous on-stage entertainment, free activities, local group displays, a baking competition, a chocolate wheel, and rides on the Noddy Train, creating a vibrant atmosphere that celebrated community spirit and engagement.



3.3.2 **Council Engagement and Consultation.**

- **Draft Dog Control Bylaw and Policy 2024; Draft Parks and Reserves Bylaw 2025 and Draft Trade Waste Bylaw 2025**

Late last year the Council consulted on proposed changes to its Dog Control Policy and Bylaw, Draft Parks and Reserves Bylaw 2025, and Draft Trade Waste Bylaw 2025

The Board made submissions on all three and the Board Chairperson and Deputy Chairperson spoke to these submissions at hearings on 12 March 2025.

- **Halswell Schools Safety Improvements**

The objective of this programme is to improve safety for children travelling to schools located within Halswell, one of the fastest growing suburbs in Christchurch. There are three schools that are the focus of this programme, Halswell School Knights Stream School and Oaklands School.

Public consultation opened on 27 March and closes on 28 April 2025.

- **Tree Planting Plans**

There are more than 1200 parks and reserves across Ōtautahi Christchurch and Banks Peninsula with targets to increase tree canopy cover over the next 50 years. Trees define our parks, neighbourhoods, and streets and are an essential part of Ōtautahi Christchurch's character and identity.

The Council are undertaking an ambitious tree planting program across the city to increase the canopy cover.

Consultation was open from 6 to 24 March 2025 and included Tree Planting plans for Arden, Bermuda, Lomax, Ridder and Waterloo Reserves.

3.4 Governance Advice

3.4.1 Notice of Motion - Installation of crossing points on Sabys Road, Halswell

At its 15 February 2024 meeting the Board requested that staff investigate and provide a report to the Board on the installation of two mid-block crossing points on Sabys Road using low-cost materials.

Staff have now advised that this work is being considered as part of the work programme.

3.4.2 Wilmers Road, Hornby - Footpath Request

At its 13 July 2023 meeting the Board requested that staff investigate the lack of a footpath on Wilmers Road between Awatea Road and Schofield Lane, Hornby and provide advice on whether a footpath can be installed.

Staff have now advised that this will be considered as part of the new Footpath work programme.

3.4.3 Milns Road, Halswell - Pedestrian access

At its 13 July 2023 meeting the Board requested that staff investigate extending the footpath from the end of the existing footpath and the roadway on Milns Road, Halswell, to facilitate pedestrian access.

Staff have now advised:

This will be assessed when the property on the north side goes through subdivision. This subdivision will involve piping the open drain on the north side, road widening, new kerb and channel and new footpath. As part of this connections to existing footpaths can be made/improved.

4. Advice Provided to the Community Board Ngā Kupu Tohutohu ka hoatu ki te Poari Hapori

4.1 Report on Ruapuna Community Liaison Committee 2024

A Report on the Ruapuna Community Liaison Committee 2024 has been received and is attached (Attachment B).

4.2 Metro Bus route

Metro bus Route 7 is set to become a ‘turn up and go’ service. There are five new buses servicing Route 7 Halswell-Queenspark which will run every 10 minutes from 5.30am to 6.30pm on weekdays and every 15 minutes outside of those hours, starting from Monday 28 April 2025.

Route 7 is already one of Metro’s most popular services, connecting the Southwest of the city to the Northeast via the central city. The route covers several communities including Halswell, Addington, Edgware, Shirley, Avondale, Parklands and Queenspark. It’s a convenient way to get to Ngā Puna Wai, Hillmorton and Christchurch Hospitals, the Palms and upcoming developments such as the Parakiore Recreation and Sports Centre in the city.



4.3 Community Patrols

Community Patrols of New Zealand is dedicated to helping build safer communities in partnership with NZ Police and other organisations. Patrols in the Board area include the Halswell, Hornby and Riccarton Community Patrols. Their Monthly Patrol Statistics can be found on the Community Patrols of New Zealand website:

[Halswell Community Patrol Inc statistical information](#)

[Hornby Community Patrol Inc statistical information](#)







[Riccarton Community Patrol Inc statistical information](#)

4.4 Customer Service Requests/Hybris Report

For the Board’s information, attached is a copy of the February 2025 Hybris Report (see **Attachment C**).

The report provides an overview of the number of Customer Service Requests that have been received, including the types of requests being received and a breakdown of how they are being reported.

Attachments Ngā Tāpirihanga

No.	Title	Reference	Page
A  	Waipuna Halswell-Hornby-Riccarton Community Board Funding Update - March 2025	25/592984	57
B  	Report on Ruapuna Liasion Committee 2024	25/539103	60
C  	Halswell-Hornby-Riccarton Hybris Ticket Report - February 2025	25/592986	62

Signatories Ngā Kaiwaitohu

Authors	Noela Letufuga - Support Officer Faye Collins - Community Board Advisor Helen Miles - Community Recreation Advisor Marie Byrne - Community Development Advisor Bailey Peterson - Manager Community Governance, Halswell-Hornby-Riccarton
Approved By	Bailey Peterson - Manager Community Governance, Halswell-Hornby-Riccarton Matthew McLintock - Manager Community Governance Team John Filsell - Head of Community Support and Partnerships

Waipuna Halswell-Hornby-Riccarton Community Board Funding 2024-25			
2024-25	Discretionary Response Fund	Allocated	Funds Remaining
25/07/2024	2024-25 SCF Allocation	\$123,555	
13/09/2024	2023-24 DRF and other fund carry over	\$29,311	
	Total DRF Fund	\$152,866	
25/07/2024	Allocation to 2024-25 Off The Ground Fund	\$3,000	
25/07/2024	Allocation to 2024-25 Youth Development Fund	\$10,000	
25/07/2024	Board Project - 2024 Anzac Day Expenses	\$1,500	
25/07/2024	Board Project - Community Pride Garden Awards	\$3,500	
25/07/2024	Board Project - Community Service & Youth Service Awards	\$4,000	
25/07/2024	Board Project - Community Leadership Opportunities	\$2,000	
25/07/2024	Board Project - Culture Galore 2024	\$12,000	
25/07/2024	Board Project - Engaging with the Community	\$3,000	
25/07/2024	Board Project - Summer with your Neighbours	\$4,000	
15/08/2024	Awatea Athletics Incorporated towards its Volunteer and Coach Support project.	\$2,000	
15/08/2024	Bangaliana Christchurch towards venue hire and entertainment costs for the Durga Festival, Eastern Indian Cultural Community Day in October 2024.	\$800	
15/08/2024	Hornby Good Companions Club towards the Bus Trips project.	\$1,500	
12/09/2024	South Hornby School towards Shade and Privacy Umbrellas.	\$7,000	
10/10/2024	Canterbury Tamil Society Inc towards the running costs, excluding food costs, of the Canterbury Tamil Academy.	\$5,000	
14/11/2024	Halswell Community Church towards the running costs of the Family Fun Day project, excluding food costs.	\$2,000	
14/11/2024	Halswell Tennis Club towards the establishment of the Halswell Charitable Tennis Trust and development of a scope and concept plan for the court facility renewal and development.	\$7,000	
14/11/2024	South West Ministries Trust trading as Living Waters Christian Centre towards the running costs of the Halswell Twilight Market, excluding food costs.	\$2,000	
14/11/2024	St Christopher's Anglican Church - Avonhead towards the Community Christmas Carols event.	\$1,250	
14/11/2024	The Middleton Matipo Charitable Trust towards We Heart Harrington voluntary community upkeep of parks in Riccarton.	\$951	
12/12/2024	Hornby Day Care Trust towards the flooring component of the laundry and kitchen upgrade.	\$4,250	
12/12/2024	Hornby Presbyterian Community Church towards venue hire costs for the Templeton Tots programme.	\$2,310	
12/12/2024	Jox Blue Blades Rowing Society Incorporated towards the costs of purchasing two Coxboxes for the St Thomas Rowing squad.	\$2,590	
12/12/2024	BetterMan Charitable Trust towards administration and the development and action of their social media plan.	\$4,000	
12/12/2024	Allocation to 2024-25 Youth Development Fund.	\$5,000	
12/12/2024	Awatea Athletics Incorporated towards the Awatea Athletics - Community Development & Administration project.	\$7,000	
13/02/2025	Hornby Community Patrols Inc towards its anniversary commemorations.	\$1,428	
		\$99,079	\$53,787

2024-25	Youth Development Fund	Allocated	Funds Remaining
25/07/2024	Discretionary Response Fund Allocation	\$10,000	
12/12/2024	Discretionary Response Fund Allocation	\$5,000	
	Total YDF Fund	\$15,000	
26/07/2024	St Thomas of Canterbury College towards Micha Sula, Xavier Reweti, Zeke Faga-leti, Luke Waikawau, Isshin Nakao, Jackson Stewart, Xavier Lynch, Meihana Pauling, Ashton Clark, Caleb Foleni and Ramsay Sula to participate in the New Zealand Secondary Schools Rugby League Tournament 2024 to be held in Auckland.	\$550	
29/07/2024	Zion-Tūkaha Journey-Reign Roberts towards participating in the Aotearoa National Māori Rugby League Tamariki Tournament in Rotorua.	\$200	
29/07/2024	Adele Dunning towards participating in the New Zealand Irish Dancing National Championships in Wellington.	\$200	
29/07/2024	Micah Pomare towards participating in the Hillary Challenge National Final at the Hillary Outdoors Tongariro Centre.	\$200	
30/07/2024	Halswell United Association Football Club Incorporated towards Charlize Forde, Lio Gunther, Malia Forde and Jade O'Connor to participate in the Premier Football Invitational Tournament to be held in Gold Coast Australia from 20th to 22nd September 2024.	\$1,000	
2/08/2024	Wen-Qi Toh towards participating in the Taekwon-Do National Championships 2024 in Palmerston North.	\$150	
2/08/2024	Misha Worboys towards participating in the Taekwon-Do National Championships 2024 in Palmerston North.	\$150	
2/08/2024	Shahin Ahmadi towards participating in the Taekwon-Do National Championships 2024 in Palmerston North.	\$150	
8/08/2024	Villa Maria College towards Rubi-Lee Holmes and Lola O'Connor participating in the New Zealand Secondary Schools Football Gary Sowden Tournament in Blenheim.	\$200	
12/08/2024	South Island Pasifika and Sports Association Incorporated towards Raymo Ma'anaima, Cooper Paulo, Thomas Christensen, Nu'u'uli Failauga Latu participating in the Queensland League Carnival in Brisbane, Australia.	\$400	
12/08/2024	Oscar Calder towards participating in the New South Wales Under 16 State Club Championships in Sydney, Australia.	\$250	
12/08/2024	Caleb Paton towards participating in the Premier Football Invitational Tournament on the Gold Coast, Australia.	\$250	
12/08/2024	Tanisha Sandri towards participating in the Australasian Majors Cheerleading Competition 2024 in Brisbane, Australia.	\$250	
19/08/2024	Bethany Crossan towards participating in Hui-ā-Tau 2024 in Whakātane.	\$300	
20/08/2024	Josiah Taula-Lesatele towards competing in the Deaf International Basketball Federation 3v3 World Cup 2024 in Washington DC, United States of America.	\$500	
29/08/2024	Kate Littlejohn towards participating in the Netball New Zealand Open Championships in Auckland.	\$250	
29/08/2024	Lucas Bennetts towards participating in the National Young Performer Awards in Palmerston North.	\$250	
10/09/2024	Avonhead Primary School towards Jayden Stevens participating in the New Zealand Chess Federation National Interschool Tournament in Wellington.	\$100	
25/09/2024	Ysabella Ebuon towards participating in the 2024 World Taekwondo Poomsae Championships in Hong Kong.	\$500	

26/09/2024	Farron Raasch towards participating in the XP New Zealand Gymnastics Championships in Palmerston North.	\$250	
1/10/2024	Ariyah Downes towards representing New Zealand in the Hong Kong 2024 World Taekwondo Poomsae Championships.	\$500	
17/10/2024	Hazel Topp towards participating in the Moana Oceania Soil Judging competition to be held in Rotorua.	\$300	
17/10/2024	Hope Anderson-Gardner towards participating in the Hīkoi ki Waitangi to be held in Waitangi.	\$300	
21/11/2024	Lucinda Pearse towards representing New Zealand at the World Olympic Gymnastics Academy (WOGA) Classic in Texas, USA.	\$500	
21/11/2024	Halswell United Association Football Club Incorporated toward costs for Brooke Yates, Alexis Barrett, and Amelia Bunn participating in the U17 Western Springs Football Tournament in Auckland.	\$450	
22/11/2024	Lucy Mason towards attending the Youth Futsal Championships 2024 in Wellington.	\$300	
28/01/2025	Ocean Simard towards participating in the Under 24 Ultimate Frisbee World Championships 2025 in Logroño, Spain.	\$500	
21/02/2025	St Thomas of Canterbury College towards Cairo Horgan, Andre Simpson, Harry Gallagher, Sam McGuigan, and Luca Damiani participating in the Maadi Regatta at Lake Karapiro.	\$750	
25/02/2025	Hillmorton High School for students Hunter Hooson, Lucca Taiulu, Madison McKenzie, Maia Hodgman, Luke McIntosh, Keisha Byrne, Riley Annan, Yasin van Staden, Logan Hargrove, and Patrick Sitar to participate in a Japanese cultural exchange.	\$1,500	
25/02/2025	Ilaisa Veaila towards participating in the Secondary Schools Volleyball Nationals in Palmerston North.	\$350	
24/03/2025	Canterbury Pasifika Volleyball Association Incorporated for Luisa Senetenari towards participating in the Polynesian Volleyball USA Tour in Las Vegas, USA.	\$500	
24/03/2025	Stella Crossan towards participating in the Asia Pacific Canoe Sprint Cup 2025 in Japan.	\$500	
24/03/2025	Badminton Canterbury Inc for Katrina Huang, Marco Sun, Elaine Liu, Iris Gu, Dinuli Withanaarachchi, Roslynn Roby George, Zooni Butterfly Ahuja, Aidan Hu, Eben Anil, Ray Gao, Theodore Ling, Janie Wang, Georgia Barrett-Dobson, Kate Duffield, Kelly Shen and Alvin Zeng Wei towards participating in the New Zealand Junior Team Badminton Championships, in Palmerston North.	\$1,000	
		\$13,550	\$1,450
2024-25	Off the Ground Fund	Allocated	Funds Remaining
25/07/2024	Discretionary Response Fund Allocation	\$3,000	
	Total OTG Fund	\$3,000	
19/08/2024	Rachel Smith towards the Pride Skate Event.	\$400	
5/09/2024	Vivienne Bearpark towards the Halswell Community Garden Open Day.	\$400	
5/03/2025	Vy Quoc Tran towards a Vietnamese Beef Noodle (Pho Bo) workshop.	\$392	
		\$1,192	\$1,808

Report on Ruapuna Community Liaison Committee 2024

Membership Changes

On 4 May 2024, our long standing committee member, John Mitchell, representing the Christchurch Speedway Club, passed away after a short illness. John had been involved in the Environment Court case in relation to Ruapuna and was an inaugural member of the Community Liaison Committee. John was always present at meetings and a sincere, hard working representative for the Speedway. He has been replaced by Allan Daly.

With Jimmy Chen's retirement, the Christchurch City Council position has been taken up by Henk Buunk from the Waipuna-Halswell-Hornby-Riccarton Community Board

Warwick Wright, a local resident, has replaced Sara Hamett as the third community representative along with John Cunningham and Tracey Riley for the Templeton Residents Association.

Mark Wederell and Chris Protheroe continue to represent the Canterbury Car Club

Committee Activity

Since the previous report in 2022 both the Canterbury Car Club, which operates the Ruapuna Raceway and the Christchurch Speedway Club, which operates the motorcycle speedway, have maintained noise levels in accord with the provisions of the Christchurch District Plan. The Car Club in particular has sought to actively manage its activity days so as to have more 'quiet' days and less 'noisy' days, as provided for by the District Plan. This is a voluntary action on the part of the club and part of its resolve to minimise the noise effects of Ruapuna and assist in maintaining good relations with the adjoining community.

As previously reported, the clubs have completed those measures which are viable to physically reduce noise at Ruapuna, such as the new sound system which is lower in height and directed at its audience, not the wider neighbourhood. Currently the most significant noise issue at Ruapuna is legally permissible noise which complies with the District Plan. Despite being legal it is still annoying to members of the surrounding community, particularly under certain weather conditions.

The committee has discussed this and has sought to move beyond the physical effects of noise to the psychological. The committee has also endorsed a long term goal of zero noise complaints in relation to Ruapuna.

To attain a goal of zero complaints, the wider community would need to see a mutual benefit from the operation of Ruapuna and therefore not seek to complain, even though there were negative connotations when they heard the noise. Obviously those who attend Ruapuna do not view the noise negatively and so ways for the community to also view it positively need to be explored. Charitable events by the community at Ruapuna is one approach being undertaken.

The Car Club and Speedway members attend open days with the nearby Templeton community and a media release of the Ruapuna committee meetings goes in the Templeton newsletter. Mark Wederell, General Manager of the Ruapuna Motorsport Park attended a meeting of the Templeton Residents Association and spoke there about Ruapuna and its

activities. This included ways in which Ruapuna could be used for wider community activities such as cycling, duathlons and school events.

An aim of the Committee is to ensure that Templeton and its neighbourhood are provided with information about events at Ruapuna so that people can make informed choices in relation to the likely noise, such as going elsewhere for a time.

It may seem that the committee's agendas are relatively light but this is due, at least in part, to the high level of compliance by both the car and speedway clubs, the low number of complaints and the manner in which they are responded to. The committee does provide for continued face to face meeting between Templeton residents and the Ruapuna speedway and car clubs. It has been vigilant on the need to continued communication and helped foster good relationships between Ruapuna and the wider community.

Laurie McCallum
Independent Chairperson
Ruapuna Community Liaison Committee

Ticket Report

01 02 2025 - 28 02 2025

Filter by Ward

Halswell-Hornby-Riccarton

Filter by month

2025 (Year) + February (Month)

3256

Reported Tickets last month

90.45%

Resolved within SLA

Channels

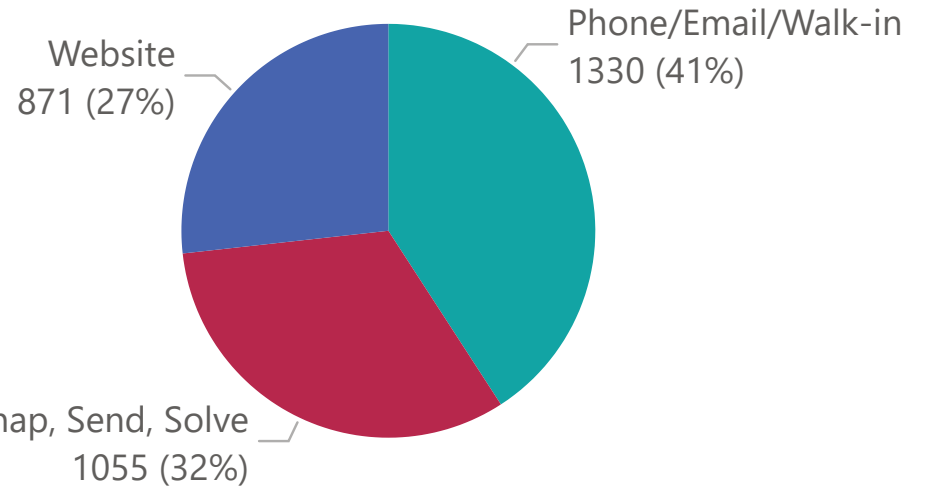

Status as of Report Date

Closed/Resolved

69.35%

Open

28.69%

Programmed Work

1.97%

Top 10 Incident Categories

● Halswell ● Hornby ● Riccarton

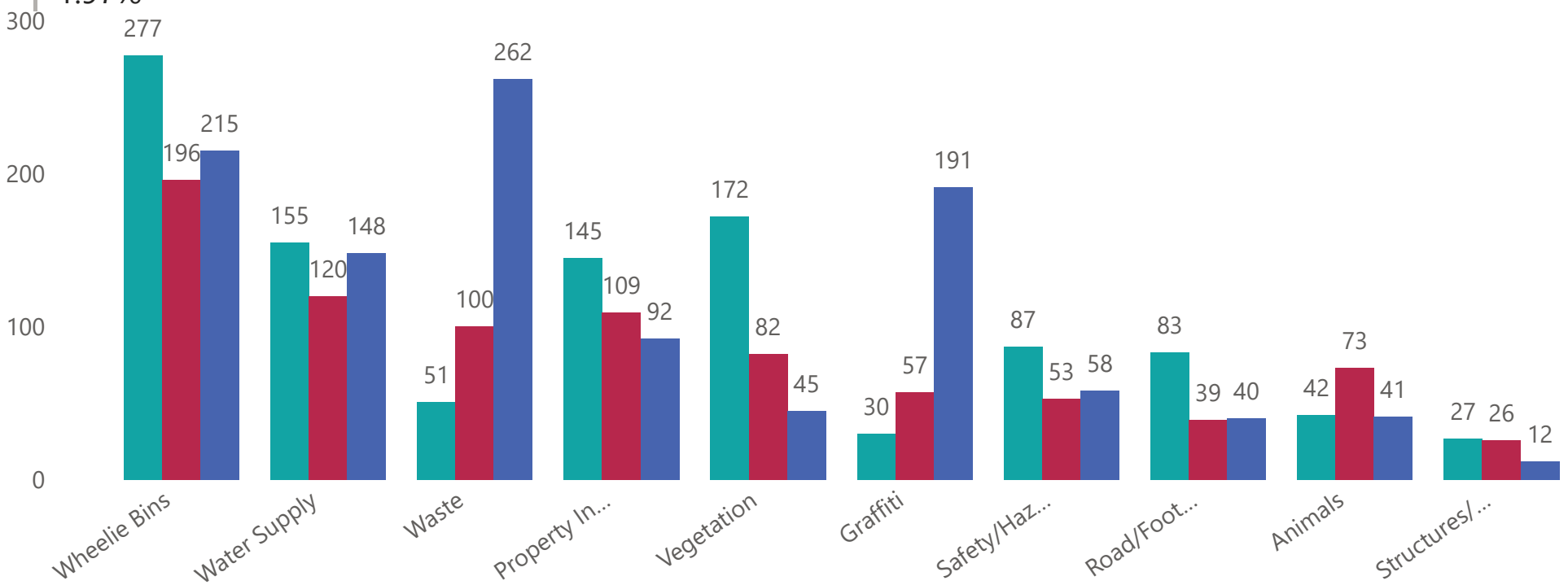

Top 10 Object Categories

# Tickets	ObjectCategory	+/- Previous Month
349	Litter	-224
263	Water Leak	-61
258	Damaged Bin	-14
249	Bin Not Collected	-21
162	Graffiti - Utility box, pole, railway	-42
143	Residential LIM	34
113	Garden/Landscaped Area	-7
112	Trees	-42
98	Residential Property Files	18
74	Grass	-25

Report date:
02 Mar 2025

13. Elected Members' Information Exchange Te Whakawhiti Whakaaro o Te Kāhui Amorangi

This item provides an opportunity for Board Members to update each other on recent events and/or issues of relevance and interest to the Board.

Karakia Whakamutunga

Unuhia, unuhia Unuhia ki te uru tapu nui Kia wātea, kia māmā, te ngākau, Te tinana te wairua i te ara takatā Koia rā e Rongo, whakairia ake ki runga Kia tina! TINA! Hui e! TĀIKI E!	<i>Draw on, draw on, Draw on the supreme sacredness To clear, to free the heart, the body and the spirit of mankind Rongo, suspended high above us (i.e. in 'heaven') Draw together! Affirm!</i>
---	--