

**Waihoru**  
**Spreydon-Cashmere-Heathcote Community Board**  
**MINUTES ATTACHMENTS**

---

**Date:** Thursday 10 October 2024  
**Time:** 4 pm  
**Venue:** Boardroom, Beckenham Service Centre,  
66 Colombo Street, Beckenham

---

<b>TABLE OF CONTENTS NGĀ IHIRANGI</b>	<b>PAGE</b>
<b>4.1. Public Forum - Cashmere Residents Emergency Support Team (CREST) update</b>	
A. Cashmere Resident's Emergency Support Team presentation .....	3
<b>5.1. Deputations by Appointment - New Deed of Lease-Physiosouth Limited at Pioneer Recreation and Sport Centre</b>	
A. Physiosouth photos.....	11
<b>5.2. Deputations by Appointment - Purau Reserve Landscape Concept Plan</b>	
A. James Duder Purau Reserve presentation.....	13
<b>5.3. Deputations by Appointment - Purau Reserve Landscape Concept Plan</b>	
A. Ian Anderson - Purau Reserve presentation.....	19
<b>9. Purau Reserve Landscape Concept Plan</b>	
A. Purau Reserve Landscape Concept Plan presentation.....	26

---



# Cashmere Residents' Emergency Support Team

Community Board Update  
October 2024

Hato Hone St John and  
Cashmere Residents' Emergency Support Team  
invite you to a free

### 3 Steps for Life awareness session



7pm-8pm Tuesday 24 September

Rata Room, Cashmere Presbyterian Church

Register at [cashmereemergencyhub@gmail.com](mailto:cashmereemergencyhub@gmail.com) or

text 027 3466 134 by Monday 16 September

#### The 3 Steps for Life

1 Calling 111



2 Starting CPR



3 Using an AED



#### Did you know?

- Applying timely CPR and rapid defibrillation can increase a patient's chances of survival by up to 40%.
- Performing CPR and using an AED is easy.
- By performing CPR and using an AED, you can help save a life.







































Some food for thought...

Nuisance to neighbours



## Some food for thought...



How it was in 1981.

How was the reserve formed?

Why was the reserve formed?

Where is my submission?

Submissions received on Purau Reserve Landscape Development Plan, April 2024

Organisations / Businesses

ID	Submitter feedback	Name - Organisation
17152	See attachment	Quetin McDonald - Ōpāwaho Heathcote River Network

Individuals

ID	Overall, do you support the plan for Purau Reserve?	What do you like about the plan for Purau Reserve and why?	What don't you like about the plan for Purau Reserve and why?	Is there anything else we need to know?	Name

I could not find my submission –  
James Duder  
Lisa Duder

Both answered overall support =  
‘No’



## What is the purpose of CCC Parks ?

What are the objectives of this plan to meet that purpose?

Objectives:

- Stormwater management plan and minimizing risk of erosion to neighbouring properties
- A plan for the outcome including Local Native plantings to restore biodiversity.
- A plan for transition from current state to desired state (removal, planting, Shade, water etc)
- An ongoing management and maintenance plan.

## Submission on the Purau Reserve Proposal

Ian Anderson

12 / 28 Overdale Drive

30 years in Cashmere, 10 at this address

- Sharing four pictures
- Posing some questions
- Making a request



This photo from two days ago shows part of our boundary with the Reserve.  
The boundary is 3 – 4 metres beyond the ground level edge of the vegetation  
The lower plantings are our natives and other plants for bank stability  
We are in a constant battle with Elms and Oaks invading our property by up to 10 metres crowding out our plants  
The trees are not yet in full leaf – when they are they crowd out the light to anything below





The trees have grown considerably in the ten years we've been in this house  
Our neighbour has indicated their height when he moved in 15 years ago



This council document highlights the invasion of Council's un-managed exotic trees into our property



This summer aerial photo on Google shows the density of the canopy  
The council land is narrow  
30% of the canopy overhangs neighbouring properties  
In summer there is very little light or moisture in the valley



## My questions

1. Did the community understand that the Council plan is for most existing trees to stay?
2. Did Lucas & Associates know that when doing the planting plan?
3. How will the proposed plantings on the steep banks survive in the dark and without water?
4. Why were the existing self-seeded trees in the reserve not explicitly addressed in the consultation and proposals by Council staff?
5. What is Council strategy for current and future self-seeded trees?
6. Why are self-seeded Sycamore trees explicitly identified for removal but not Wattles, Pines, Elms, or Oaks?
7. What responsibility will Council take for nuisance effects of self-seeded trees on neighbours?
8. Why do Council staff put equal weight to each piece of feedback without assessing the degree to which the respondent is affected or has depth of expertise?
9. Why do Council staff make a recommendation based on a rough calculation from only 22 respondents (unweighted) when such a small number has no statistical validity?

## My requests

1. Establish a plan to transition the Reserve from exotics to natives.
2. Develop the plan using experts rather than the 'reckons' of neighbours.
3. Ensure Council is committed and resourced to manage the trees in the Reserve so they thrive and don't cause undue nuisance to neighbours.



# Purau Reserve Landscape Concept Plan

Presenters:

Bridie Gibbings, Manager Operations –Parks  
Development

Krystle Anderson, Engagement Advisor

Emma Petersen Välimäki, Landscape  
Architect

# Background

---

- The Friends of Purau Reserve have actively volunteered in Purau reserve since mid-2020
- The Friends worked in partnership with a former Community Partnership Ranger
- September 2023 Council received complaints from neighbouring property owners regarding vegetation and tree removal in the reserve



## Concerns - Residents

- Removal of mature trees (approx. 7) that necessitated removal by arborist contractor
- Removed plum tree and a number of other trees
- Change to the look and feel of the reserve
- Potential bank destabilisation and erosion resulting from plant removal
- Lack of say in reserves development



10/11/2024

# Concerns – Friends of Purau Reserve

---

- No plan to work towards

---

10/11/2024

# Actions

---

- Stop-work notice issued
- Geotechnical assessment report issued
- Early engagement
- Concept plan developed
- Consultation
- Concept plan amended following feedback

---

10/11/2024



## Engagement – Initial survey March 24

- We heard from 102 individuals and three community groups:
  - Friends of Purau Reserve
  - Friends of Ernle Clark Reserve
  - Karitane Valley Residents Association

### Community views on how important it is to plant more trees and shrubs in Purau Reserve

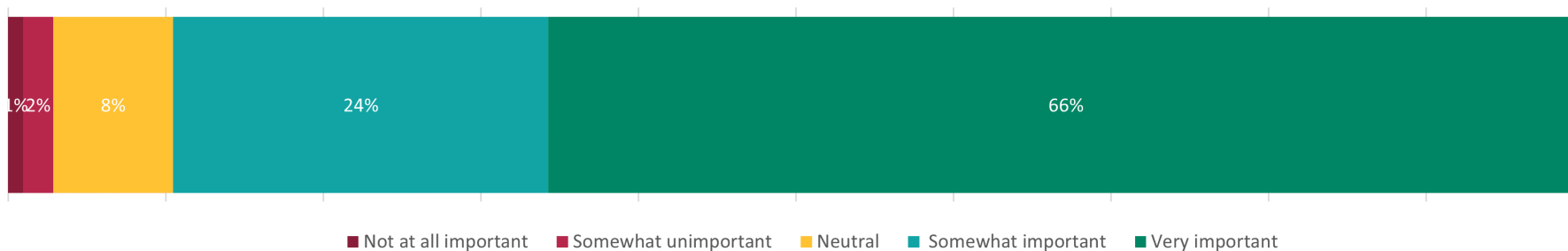

10/11/2024

# Engagement

Item 9

Attachment A

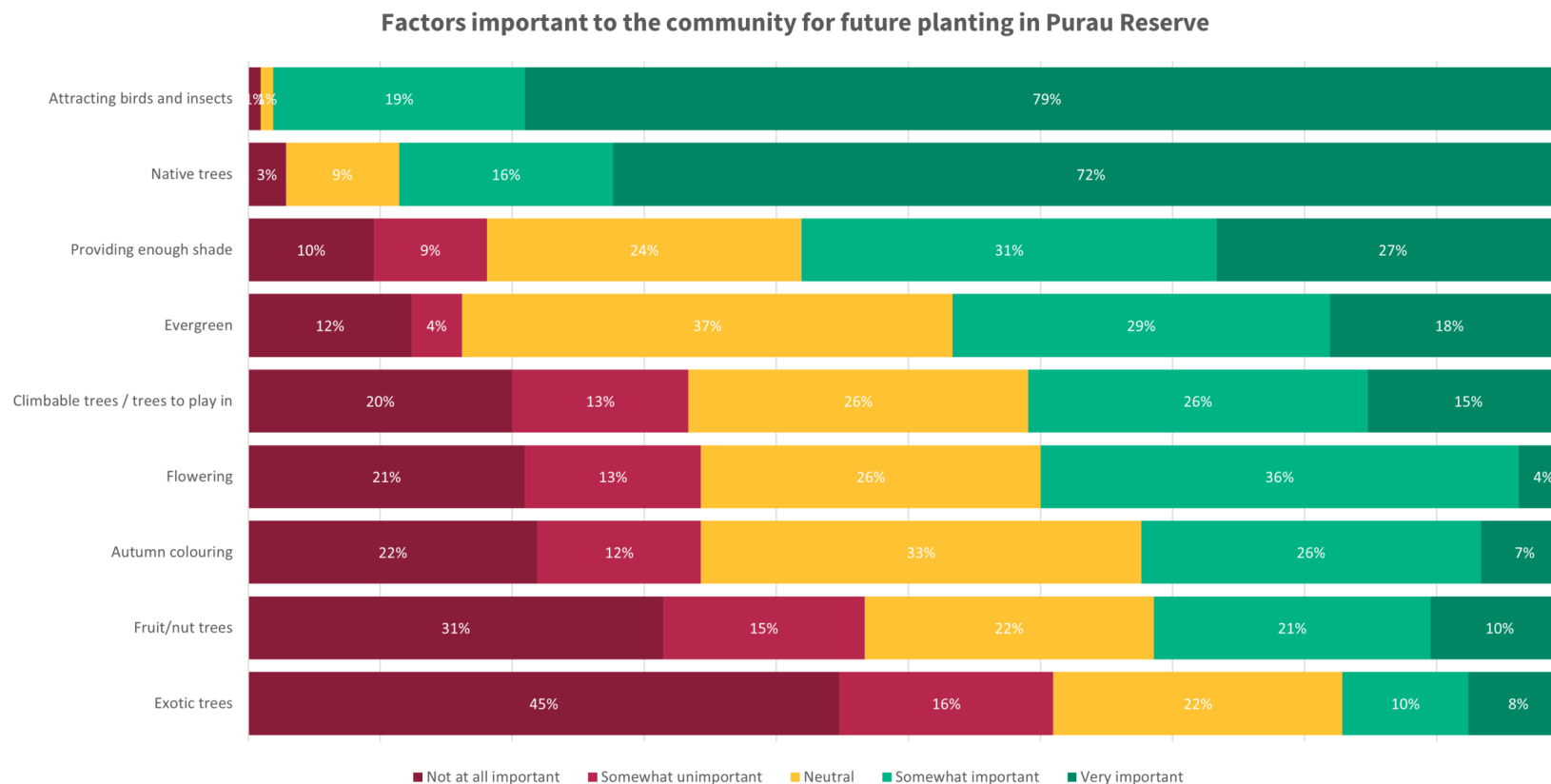

10/11/2024

# Engagement

Factors concerning to the community for future planting in Purau Reserve

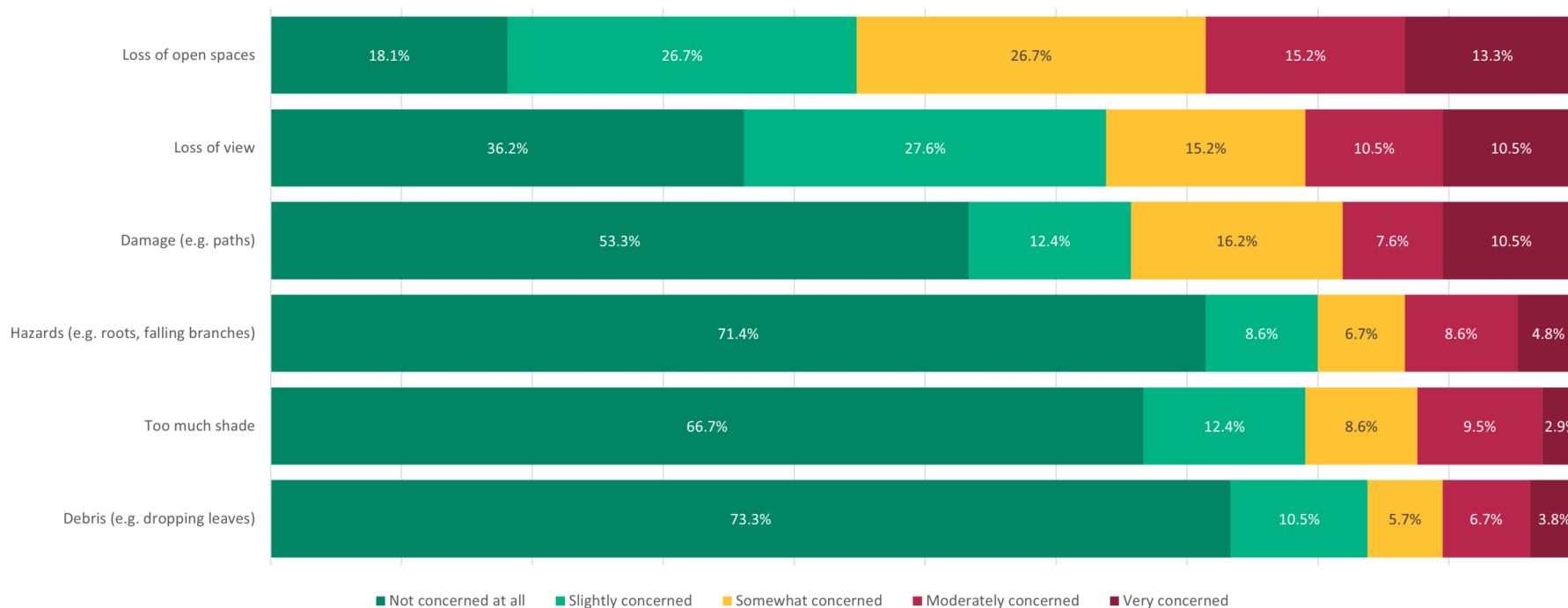

10/11/2024



# Consultation on the Draft Landscape Plan

Submissions were made by 21 individuals and the Opāwaho Heathcote River Network

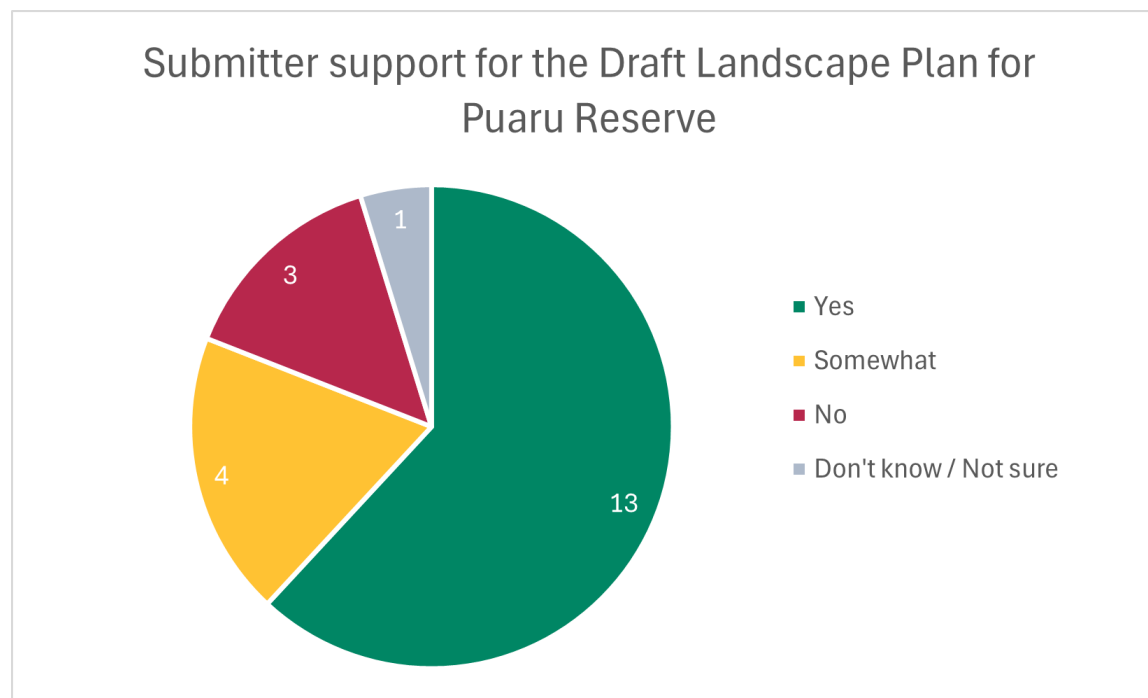

10/11/2024

# Plan

- Plant Composition Overall plant list:
  - Native species: 63%
  - Exotic species: 37%
- Hillside planting:
  - Native species: 100%
- Gully planting:
  - Native species: 80%
  - Exotic species: 20%
- Specimen trees:
  - Exotic species: 100%
- Fruit trees:
  - Exotic species: 100%

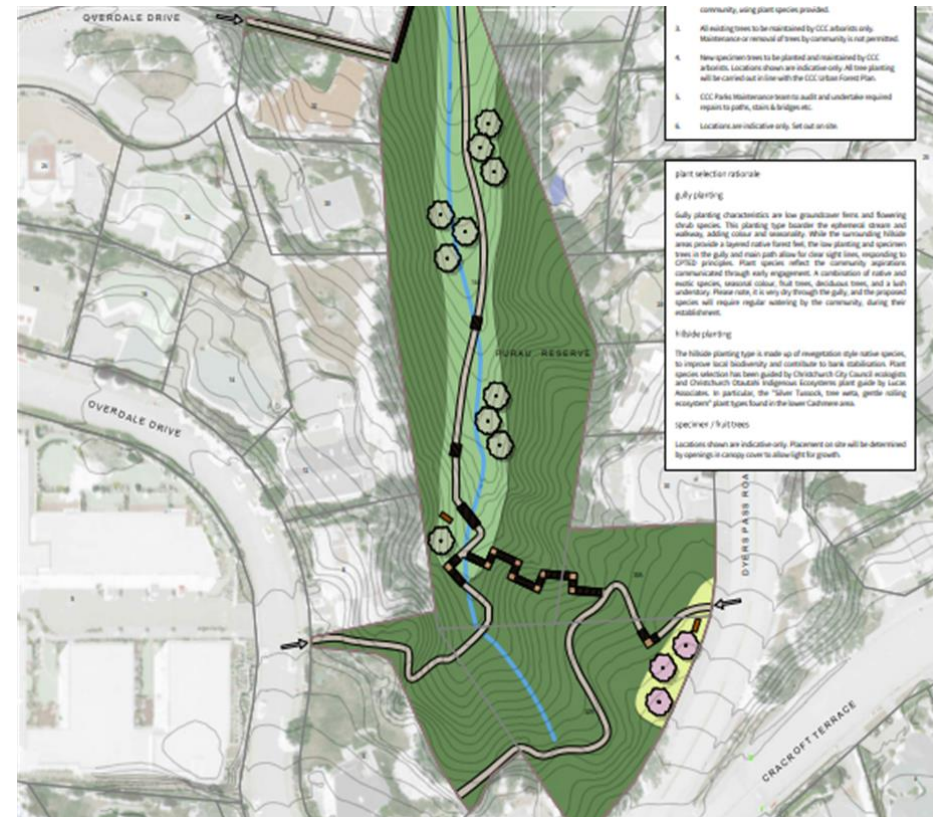

10/11/2024

## Updates to the landscape concept plan

- Move the fruit trees from inside the reserve to the Dyers Road reserve entranceway berm
- Remove the Ginko biloba tree
- Add Popocarpus totara to the plant species list

10/11/2024

