

---

## Waipuna Halswell-Hornby-Riccarton Community Board AGENDA

---

### Notice of Meeting:

An ordinary meeting of the Waipuna Halswell-Hornby-Riccarton Community Board will be held on:

**Date:** Thursday 11 May 2023  
**Time:** 4.30 pm  
**Venue:** Horoea Room, Rārākau: Riccarton Centre,  
199 Clarence Street, Christchurch

---

### Membership

Chairperson	Helen Broughton
Deputy Chairperson	Marie Pollisco
Members	Sarah Brunton
	Henk Buunk
	Gamal Fouda
	Tyla Harrison-Hunt
	Andrei Moore
	Debbie Mora
	Mark Peters

---

8 May 2023

Matthew McLintock  
Manager Community Governance Team  
941 6231  
Matthew.McLintock@ccc.govt.nz  
[www.ccc.govt.nz](http://www.ccc.govt.nz)

Note: The reports contained within this agenda are for consideration and should not be construed as Council policy unless and until adopted. If you require further information relating to any reports, please contact the person named on the report.

**To watch the meeting live, or a recording after the meeting date, go to:**

[https://www.youtube.com/channel/UCQN\\_yNuZzfRhDJ2scAEjCvA](https://www.youtube.com/channel/UCQN_yNuZzfRhDJ2scAEjCvA)

**To view copies of Agendas and Minutes, go to:**

<https://www.ccc.govt.nz/the-council/meetings-agendas-and-minutes/>





## Ōtautahi-Christchurch is a city of opportunity for all

Open to new ideas, new people and new ways of doing things – a city where anything is possible

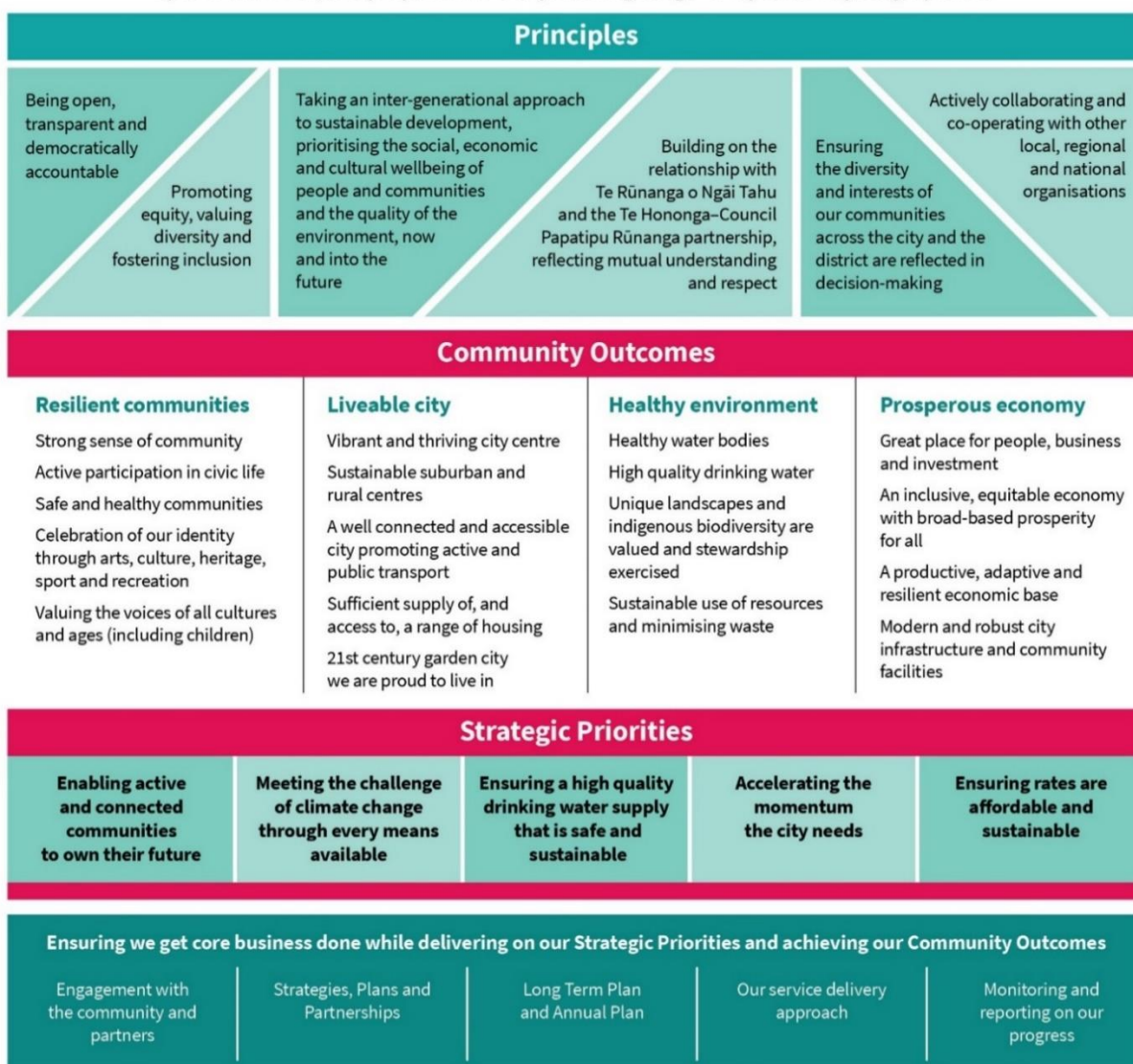

Part A	Matters Requiring a Council Decision
Part B	Reports for Information
Part C	Decisions Under Delegation

## TABLE OF CONTENTS

Karakia Tīmatanga .....	4
C 1. Apologies Ngā Whakapāha .....	4
B 2. Declarations of Interest Ngā Whakapuaki Aronga .....	4
C 3. Confirmation of Previous Minutes Te Whakaāe o te hui o mua .....	4
B 4. Public Forum Te Huinga Whānui .....	4
B 5. Deputations by Appointment Ngā Huinga Whakaritenga.....	5
B 6. Presentation of Petitions Ngā Pākikitanga .....	5

## STAFF REPORTS

C 7. Proposed Road Names - 430 Sparks Road .....	15
C 8. Waipuna Halswell-Hornby-Riccarton 2023-25 Community Board Plan.....	19
C 9. Halswell-Hornby-Riccarton 2022-23 Discretionary Response Fund Applications - Otautahi Eritrean Association Incorporated and Hornby Community Patrols Inc .....	75
B 10. Waipuna Halswell-Hornby-Riccarton Community Board Area Report - May 2023 .....	81
C 11. Waipuna Halswell-Hornby-Riccarton Community Board - Community Service and Youth Service Awards 2023 .....	103
B 12. Elected Members' Information Exchange Te Whakawhiti Whakaaro o Te Kāhui Amorangi.....	107
C 13. Resolution to Exclude the Public.....	108

Karakia Whakamutunga

## Karakia Tīmatanga

Whakataka te hau ki te uru Whakataka te hau ki te tonga Kia mākinakina ki uta Kia mātaratara ki tai E hī ake ana te atakura He tio, he huka, he hauhūnga Tīhei Mauri Ora	Cease the winds from the west Cease the winds from the south Let the breeze blow over the land Let the breeze blow over the ocean Let the red-tipped dawn come with a sharpened air. A touch of frost, a promise of a glorious day.
--	---

### 1. Apologies Ngā Whakapāha

At the close of the agenda no apologies had been received.

### 2. Declarations of Interest Ngā Whakapuaki Aronga

Members are reminded of the need to be vigilant and to stand aside from decision making when a conflict arises between their role as an elected representative and any private or other external interest they might have.

### 3. Confirmation of Previous Minutes Te Whakaāe o te hui o mua

That the minutes of the Waipuna Halswell-Hornby-Riccarton Community Board meeting held on [Thursday, 13 April 2023](#) be confirmed (refer page 6).

### 4. Public Forum Te Huinga Whānui

A period of up to 30 minutes will be available for people to speak for up to five minutes on any issue that is not the subject of a separate hearings process.

#### 4.1 Birthright Canterbury Trust

Representatives from Birthright Canterbury Trust will update the Board regarding the programmes and services the Trust provides to the community.

#### 4.2 Community safety concerns in the Wigram area

Plivia Alaba, local resident, will address the Board regarding community safety concerns in the Wigram area.

#### 4.3 Kāinga Ora development at Copper Ridge, Halswell

Caroline Burt, local resident, will address the Board regarding the Kāinga Ora development at Copper Ridge, Halswell.

#### 4.4 Kāinga Ora development at Copper Ridge, Halswell

Jules Atkinson, local resident, will address the Board regarding the Kāinga Ora development at Copper Ridge, Halswell.



## **5. Deputations by Appointment Ngā Huinga Whakaritenga**

Deputations may be heard on a matter or matters covered by a report on this agenda and approved by the Chairperson.

There were no deputations by appointment at the time the agenda was prepared.

## **6. Presentation of Petitions Ngā Pākikitanga**

There were no petitions received at the time the agenda was prepared.

## Waipuna Halswell-Hornby-Riccarton Community Board OPEN MINUTES

**Date:** Thursday 13 April 2023  
**Time:** 4.30 pm  
**Venue:** Horoea Room, Rārākau: Riccarton Centre,  
199 Clarence Street, Christchurch

### Present

Chairperson	Helen Broughton
Deputy Chairperson	Marie Pollisco
Members	Sarah Brunton
	Henk Buunk
	Gamal Fouda
	Tyla Harrison-Hunt
	Andrei Moore
	Debbie Mora
	Mark Peters

Matthew McLintock  
Manager Community Governance Team  
941 6231  
Matthew.McLintock@ccc.govt.nz  
[www.ccc.govt.nz](http://www.ccc.govt.nz)

To watch the meeting live, or a recording after the meeting date, go to:

[https://www.youtube.com/channel/UCQN\\_yNuZzfRhDJ2scAEjCvA](https://www.youtube.com/channel/UCQN_yNuZzfRhDJ2scAEjCvA)

To view copies of Agendas and Minutes, go to:

<https://www.ccc.govt.nz/the-council/meetings-agendas-and-minutes/>



**Part A Matters Requiring a Council Decision**

**Part B Reports for Information**

**Part C Decisions Under Delegation**

**Karakia Tīmatanga:** Led by Andrei Moore

The agenda was dealt with in the following order.

## **1. Apologies Ngā Whakapāha**

**Part C**

**Community Board Decision**

There were no apologies.

## **2. Declarations of Interest Ngā Whakapuaki Aronga**

**Part B**

Marie Pollisco declared an interest in Item 11 - Waipuna Halswell-Hornby-Riccarton 2022-23 Board Projects and Discretionary Response Fund Applications and took no part in the Board's discussion or voting on this item.

Mark Peters declared an interest in part of Item 11 and took no part in the decision on the allocation of funds towards the costs of experts to support the Waipuna Halswell-Hornby-Riccarton Community Board's submission on Plan Change 14.

## **3. Confirmation of Previous Minutes Te Whakaāe o te hui o mua**

**Part C**

**Community Board Resolved HHRB/2023/00015**

That the minutes of the Waipuna Halswell-Hornby-Riccarton Community Board meeting held on Thursday, 9 March 2023 be confirmed.

Mark Peters/Gamal Fouda

**Carried**

## **4. Public Forum Te Huinga Whānui**

**Part B**

### **4.1 Kennedys Bush Road Visibility**

Jeannie Matthews spoke on behalf of Kennedys Bush Road Neighbourhood Association regarding Kennedys Bush Road visibility.

Ms Matthews said residents are concerned about the lack of visibility on Kennedys Bush Road particularly for vehicles exiting and entering residences located on or near bends. She showed a series of photographs highlighting the lack of visibility at a number of points on the road.

Ms Matthews advised that residents are seeking the Council's advice on addressing this and consider that the installation of a convex mirror on the roadside could help.

After questions from members, the Chairperson thanked Ms Matthews for her presentation.

**Part B**

That the Waipuna Halswell-Hornby-Riccarton Community Board:

1. Refers the issues raised in the public forum presentation on Kennedys Bush Road Visibility to staff for investigation and requests advice on options to improve visibility on Kennedys Bush Road, particularly for vehicles exiting and entering driveways, including the feasibility of installation of a mirror on the roadside.

**Attachments**

- A Kennedys Bush Road Neighbourhood Association - Presentation

**4.2 Waterloo and Gilberthorpes Roads Safety**

Russell Wills, local resident, addressed the Board regarding safety concerns on Waterloo and Gilberthorpes Roads and outlined the history of dealings he has had with the Board over these concerns.

Mr Wills noted that the roads carry a lot of traffic, including trucks and that there are varying speed limits. He is particularly concerned for the safety of children travelling to and from schools in the vicinity. He also noted that the road surface is degraded raising further safety concerns.

Mr Wills acknowledged that some improvements have been made in parts, including outside Hornby High School but considers that wider improvements are required and should be implemented without delay.

After questions from members, the Chairperson thanked Mr Wills for his presentation.

Debbie Mora left the meeting at 4.45pm and returned to the meeting at 4.46pm.

**4.3 Greater Hornby Residents' Association update**

Marc Duff, Greater Hornby Residents' Association Chairperson, updated the Board on the group's activities.

Mr Duff noted at the outset, the success of the road safety improvements made outside Hornby High School.

Mr Duff showed a PowerPoint presentation outlining the activities undertaken by the Residents' Association including, the Christmas Fun Day, Summer with your neighbours events, St Patricks Day Disco and Easter Hunt. He noted upcoming events of a Can Drive and ANZAC day celebration.

After questions from members, the Chairperson thanked Mr Duff for his presentation.

**Attachments**

- A Greater Hornby Residents' Association - Presentation

**5. Deputations by Appointment Ngā Huinga Whakaritenga**

**Part B**

### 5.1 Relocation of bus stop 38215 at 59 Amyes Road Report

Lu Liu, local resident, addressed the Board regarding the proposed Relocation of bus stop 38215 at 59 Amyes Road Report (Item 9 of these Minutes refers).

Ms Liu noted that the reason for relocation of the bus stop is because a new driveway is being installed at 59 Amyes Road and to avoid the risk of conflict between buses and vehicles using the driveway. Ms Liu considers that the proposed relocation will only transfer the risk of vehicle conflict to the driveway of her property at 57a Amyes Road noting that both young and elderly residents live there, creating additional risk.

After questions from members, the Chairperson thanked Ms Liu for her presentation.

## 9. Relocation of bus stop 38215 at 59 Amyes Road

### Board Comment

Staff in attendance spoke to the accompanying report.

The Board also took into consideration the deputation from Lu Liu (Item 5.1 of these minutes refers).

In response to questions from Board members staff advised that the bus stop infrastructure (bus stop and seat) could be repositioned within the recommended road markings to be located further away from 57A Amyes Road than originally proposed.

**Community Board Resolved HHRB/2023/00016 (Original Officer recommendations accepted without change)**

### Part C

That the Waipuna Halswell-Hornby-Riccarton Community Board approve:

1. Pursuant to Clause 7 of the Christchurch City Council Traffic and Parking Bylaw 2017 and as shown on Attachment A (Plan TG135669, Issue 1, dated 13/9/2022):
  - a. That a bus stop be installed on the northern side of Amyes Road commencing at a point 294.5 metres west of its intersection with Trevor Street and extending in a north westerly direction for a distance of 14 metres.
  - b. That the stopping of vehicles is prohibited at all times on the northern side of Amyes Road commencing at a point 308.5 metres west of its intersection with Trevor Street and extending in a north westerly direction for a distance of 12 metres.
2. That any previous resolutions pertaining to traffic controls made pursuant to any bylaw to the extent that they are in conflict with the traffic controls described in 1. are revoked.
3. That these resolutions take effect when the traffic control devices that evidence the restrictions described in 1. and 2. are in place (or removed, in the case of revocations).

Andrei Moore/Debbie Mora

**Carried**

## 6. Presentation of Petitions Ngā Pākikitanga

### Part B

There was no presentation of petitions.



## 7. Correspondence

**Community Board Resolved HHRB/2023/00017 (Original Officer recommendation accepted without change)**

### Part B

That the Waipuna Halswell-Hornby-Riccarton Community Board:

1. Receives the correspondence from the Greater Hornby Residents' Association acknowledging the Board's support of its recent Summer with your neighbours events.

Mark Peters/Sarah Brunton

Carried

## 8. Safety Improvements: Halswell Junction Road / Hamill Road / Alvaston Drive

**Community Board Resolved HHRB/2023/00018 (Original Officer recommendations accepted without change)**

### Part C

That the Waipuna Halswell-Hornby-Riccarton Community Board pursuant to Section 334 of the Local Government Act 1974:

1. Approves the scheme design as detailed on plan TG144342 in Attachment A to the agenda report.

Debbie Mora/Andrei Moore

Carried

## 10. Kyle Park - Orion easements over reserve - 197 Waterloo Rd

**Community Board Resolved HHRB/2023/00019 (Original Officer recommendations accepted without change)**

### Part C

That the Waipuna Halswell-Hornby-Riccarton Community Board:

1. Subject to the consent of the Minister of Conservation, approves pursuant to Section 48 of the Reserves Act 1977, the grant of the easements to Orion over the indicative area in the aerial plans on Page 3 section 5.10 of the report on the meeting agenda (or such area as defined by survey) over Kyle Park legally described as Section 1 SO 542208 on Record of Title 927557
2. Recommends that the Chief Executive, using the Council's delegated authority from the Minister of Conservation, consents to the granting of the easements.
3. Authorises the Property Consultancy Manager, should the easements be granted with the consent of the Minister of Conservation, to finalise documentation to implement the easements.

Mark Peters/Debbie Mora

Carried

## 12. Waipuna Halswell-Hornby-Riccarton Community Board Area Report - April 2023

**Community Board Resolved HHRB/2023/00020 (Original Officer recommendation accepted without change)**

### Part B

That the Waipuna Halswell-Hornby-Riccarton Community Board:

1. Receives the Waipuna Halswell-Hornby-Riccarton Community Board Area Report for April 2023.

Helen Broughton/Andrei Moore

Carried

The meeting adjourned at 5.59pm and reconvened at 6.04pm.

## 11. Waipuna Halswell-Hornby-Riccarton 2022-23 Board Projects and Discretionary Response Fund Applications Staff Recommendations / Ngā Tūtohu

That the Waipuna Halswell-Hornby-Riccarton Community Board:

1. Approves an allocation of \$2,000 from its 2022-23 Discretionary Response Fund to the 2022-23 Waipuna Halswell-Hornby-Riccarton Youth Development Fund.
2. Approves an allocation of \$2,000 from its 2022-23 Discretionary Response Fund to the 2022-23 to the Waipuna Halswell-Hornby-Riccarton Off the Ground Fund.
3. Approves a grant of \$4,500 from its 2022-23 Discretionary Response Fund to Birthright Canterbury Trust toward Social Worker Wages.
4. Approves a grant of \$1,500 from its 2022-23 Discretionary Response Fund to Southern United Hockey Club Incorporated towards the Training and Equipment Funding Project.
5. Approves a grant of \$2,000 from its 2022-23 Discretionary Response Fund to the Chinese Joyful Club towards the Senior Group Programme.
6. Approves a grant of \$600 from its 2022-23 Discretionary Response Fund to Greater Hornby Residents Association Inc toward Youth Community Discos.
7. Approves a grant of \$400 from its 2022-23 Discretionary Response Fund to Halswell Toy Library Incorporated towards the Halswell Toy Library Open Day.

Notes:

- a. The purpose of the Discretionary Response Fund is to assist community groups with emergency or unforeseen situations. Applications will support community-focused projects that contribute to the strengthening of community wellbeing in the Christchurch city area.
- b. The Community Board has the delegation to resolve to make a grant of up to \$20,000 from the Discretionary Response Fund towards the costs of experts to support the Waipuna Halswell-Hornby-Riccarton Community Board's submission on Plan Change 14.

- c. Any decision, however, must be taken within the purpose and criteria of the Discretionary Response Fund, with all practicable options available identified and with sufficient time given for that information to be received and considered.

### Board Comment

Members noted staff advice that subsequent to the report being drafted, additional Youth Development Fund applications had been approved and further depleted the fund. Members considered an allocation of \$4,000 would be appropriate in the circumstances.

The Board discussed a possible allocation of funds towards the costs of an expert/s to support the Board's submission on the Council's Plan Changes 14 and 13, and noted staff advice that the Local Government Act 2002 and other legislation requires that decision making must take into account all options and that sufficient time is given for that information to be received and considered.

### Community Board Resolved HHRB/2023/00021

#### Part C

That the Waipuna Halswell-Hornby-Riccarton Community Board:

1. Approves an allocation of \$4,000 from its 2022-23 Discretionary Response Fund to the 2022-23 Waipuna Halswell-Hornby-Riccarton Youth Development Fund.
2. Approves an allocation of \$2,000 from its 2022-23 Discretionary Response Fund to the 2022-23 to the Waipuna Halswell-Hornby-Riccarton Off the Ground Fund.
3. Approves a grant of \$4,500 from its 2022-23 Discretionary Response Fund to Birthright Canterbury Trust toward Social Worker Wages.
4. Approves a grant of \$1,500 from its 2022-23 Discretionary Response Fund to Southern United Hockey Club Incorporated towards the Training and Equipment Funding Project.
5. Approves a grant of \$2,000 from its 2022-23 Discretionary Response Fund to the Chinese Joyful Club towards the Senior Group Programme.
6. Approves a grant of \$600 from its 2022-23 Discretionary Response Fund to Greater Hornby Residents Association Inc toward Youth Community Discos.
7. Approves a grant of \$400 from its 2022-23 Discretionary Response Fund to Halswell Toy Library Incorporated towards the Halswell Toy Library Open Day.

Helen Broughton/Gamal Fouda

**Carried**

### Community Board Resolved HHRB/2023/00022

That the Waipuna Halswell-Hornby-Riccarton Community Board:

1. Acknowledges staff advice that the Local Government Act 2002 and other legislation requires that decision making must take into account all options and that a staff report is normally provided in such instances, but concludes that it has sufficient information available at the current meeting to consider and make a decision on the allocation of funds towards the costs of external experts (non-conflicted) to support the Board's submission on Plan Changes 14 and 13.
2. Approves an allocation of up to \$20,000 from its 2022-23 Discretionary Response Fund to be used towards the costs of an expert/s to support the Board's submission on the Council's

Plan Changes 14 and 13. Prior to any appointment the name of any prospective expert and estimated costs to be advised to the Board members for comment.

The division was declared **carried** by 5 votes to 2 votes the voting being as follows:

**For:** Helen Broughton, Sarah Brunton, Henk Buunk, Gamal Fouda and Debbie Mora

**Against:** Tyla Harrison-Hunt and Andrei Moore

Helen Broughton/Gamal Fouda

**Carried**

Andrei Moore and Tyla Harrison-Hunt requested that their votes against the resolutions be recorded.

Tyla Harrison-Hunt left the meeting at 6.50pm and returned to the meeting at 6.51pm.

Marie Pollisco left the meeting at 6.59pm.

Debbie Mora and Gamal Fouda left the meeting at 7.17pm.

### 13. Elected Members' Information Exchange Te Whakawhiti Whakaaro o Te Kāhui Amorangi

Members exchanged information on the following topics:

- Signage requesting that dogs be kept on a leash has been erected at Te Kura by a member.
- A notice of motion has been proposed to the Council requesting that Elected Members be advised of all temporary road closures.
- A community safety meeting is being hosted by a Board member at Te Hāpua: Halswell Centre on 9 May 2023.
- The Owaka building opening at Knights Stream School was recently held.
- The Halswell Toy Library Opening day will be held on Saturday 15 April 2023.
- A member spoke about their involvement in community issues.
- It was noted that there a number of water leaks in the Riccarton area. While some have been addressed, some are ongoing.
- There has been concerns expressed about the safety in the vicinity of Harrington Park, Riccarton.
- Developers are looking at options with regard to redevelopment of the Antonio Hall site.
- There has been an occupation of part of the former Addington Saleyards site by a group of homeless persons.
- Waka Kotahi and Kiwi Rail are being engaged regarding a number of issues in Hornby.

#### Attachments

- A Photo - Te Kuru
- B Photo - Antonio Hall
- C Photo - Addington Saleyards

- D Elected Members' presentation

**13.1 Condition of Marshs Road, Halswell**

A series of photographs were shown by a member depicting the degraded condition of Marshs Road, Halswell. Members agreed to request staff advice on any planned resurfacing of the road.

**Part B**

That the Waipuna Halswell-Hornby-Riccarton Community Board:

1. Requests staff advice on the condition of Marshs Road, Halswell and any resurfacing planned to be undertaken.

**Attachments**

- A Photos - Marshs Road, Halswell

**Karakia Whakamutunga:** Led by Andrei Moore

**Meeting concluded at 7.33pm.**

**CONFIRMED THIS 11TH DAY OF MAY 2023**

**HELEN BROUGHTON  
CHAIRPERSON**



## 7. Proposed Road Names - 430 Sparks Road

Reference / Te Tohutoro: 23/281508

Report of / Te Pou Paul Lowe, Manager Resource Consents (Paul.Lowe@ccc.govt.nz)  
Matua:

General Manager / Mary Richardson, General Manager Citizens & Community  
Pouwhakarae: (Mary.Richardson@ccc.govt.nz)

### 1. Purpose of Report Te Pūtake Pūrongo

- 1.1 The purpose of this report is for the Waipuna Halswell-Hornby-Riccarton Community Board to approve the proposed road names at 430 Sparks Road, Halswell.
- 1.2 The report is staff generated resulting from a naming request received from the subdivision developer.

### 2. Officer Recommendations Ngā Tūtohu

That the Waipuna Halswell-Hornby-Riccarton Community Board:

1. Approves the following new road names for 430 Sparks Road (RMA/2022/485)
  - a. Road 2 - Eccles Place

### 3. Detail Te Whakamahuki

#### Introduction Te Whakatkinga

- 3.1 A road naming request has been submitted by Patterson Pitts on behalf of the developer. A preferred name and alternative names, have been put forward by the developer for the roads.
- 3.2 The recommended road names have been checked against existing road names in Christchurch and bordering districts, for duplication, alternative spelling, or other similarities in spelling or pronunciation to avoid the potential for confusion. The proposed names are considered sufficiently different to existing road names.
- 3.3 The recommended road names have been checked against the Council's Roads and Right-of-Way Naming Policy dated 2 November 1993 and are considered to be consistent with this policy except as outlined below.
- 3.4 The recommended road names have also been checked against the Australia and New Zealand Standard AS/NZS 4819:2011 Rural and Urban Addressing. The names are considered to be consistent with the Standard unless otherwise stated below.
- 3.5 Under the Roads and Right-of-Way Naming Policy, the names considered must be requested by the developer. There is not an ability to consider alternative names without first checking whether there are any duplications or similarities with other road and right-of-way names.
- 3.6 Consultation has been undertaken with Land Information New Zealand who have raised no concerns with the proposed road names.
- 3.7 The names requested have been accompanied by an explanation of the background to the names, which is summarised below, along with correspondence with the applicant.

#### Assessment of Significance and Engagement Te Aromatawai Whakahirahira

- 3.8 The decisions in this report is of low significance in relation to the Christchurch City Council's Significance and Engagement Policy.

- 3.9 The level of significance was determined by the number of people affected and/or with an interest.
- 3.10 Due to the assessment of low significance, no further community engagement and consultation is required.

### Proposed Names

- 3.11 The proposed roads are shown in **Attachment A**.
- 3.12 Road 1 is a continuation of the existing Glendore Drive.
- 3.13 Road 2 - Preferred name: Eccles Place  
John Eccles Ferguson was a previous owner on the land in the 1870's and 1880's. Ferguson and Robert Rainey later held mortgage for Frank Birdling, who owned the land, in 1907.

### Alternative Names

- 3.14 Gillam Place - Frank Gillam Birdling (1865-1939) was a previous owner of the land in the 1910s. Birdling settled in the area in the 1840s.
- 3.15 Broker Place - Reginald Eugene Broker was a previous owner on the land in the 1950s.

## Attachments Ngā Tāpirihanga

No.	Title	Reference	Page
A 	RMA/2022/485 - Proposed Road Naming Plan - 430 Sparks Road	23/109690	17

## Confirmation of Statutory Compliance / Te Whakatūtutanga ā-Ture

Compliance with Statutory Decision-making Requirements (ss 76 - 81 Local Government Act 2002).

- (a) This report contains:
- (i) sufficient information about all reasonably practicable options identified and assessed in terms of their advantages and disadvantages; and
  - (ii) adequate consideration of the views and preferences of affected and interested persons bearing in mind any proposed or previous community engagement.
- (b) The information reflects the level of significance of the matters covered by the report, as determined in accordance with the Council's significance and engagement policy.

## Signatories / Ngā Kaiwaitohu

<b>Authors</b>	Leashelle Miller - Planning Technician Paul Lowe - Manager Resource Consents
<b>Approved By</b>	John Higgins - Head of Planning & Consents Mary Richardson - General Manager Citizens & Community

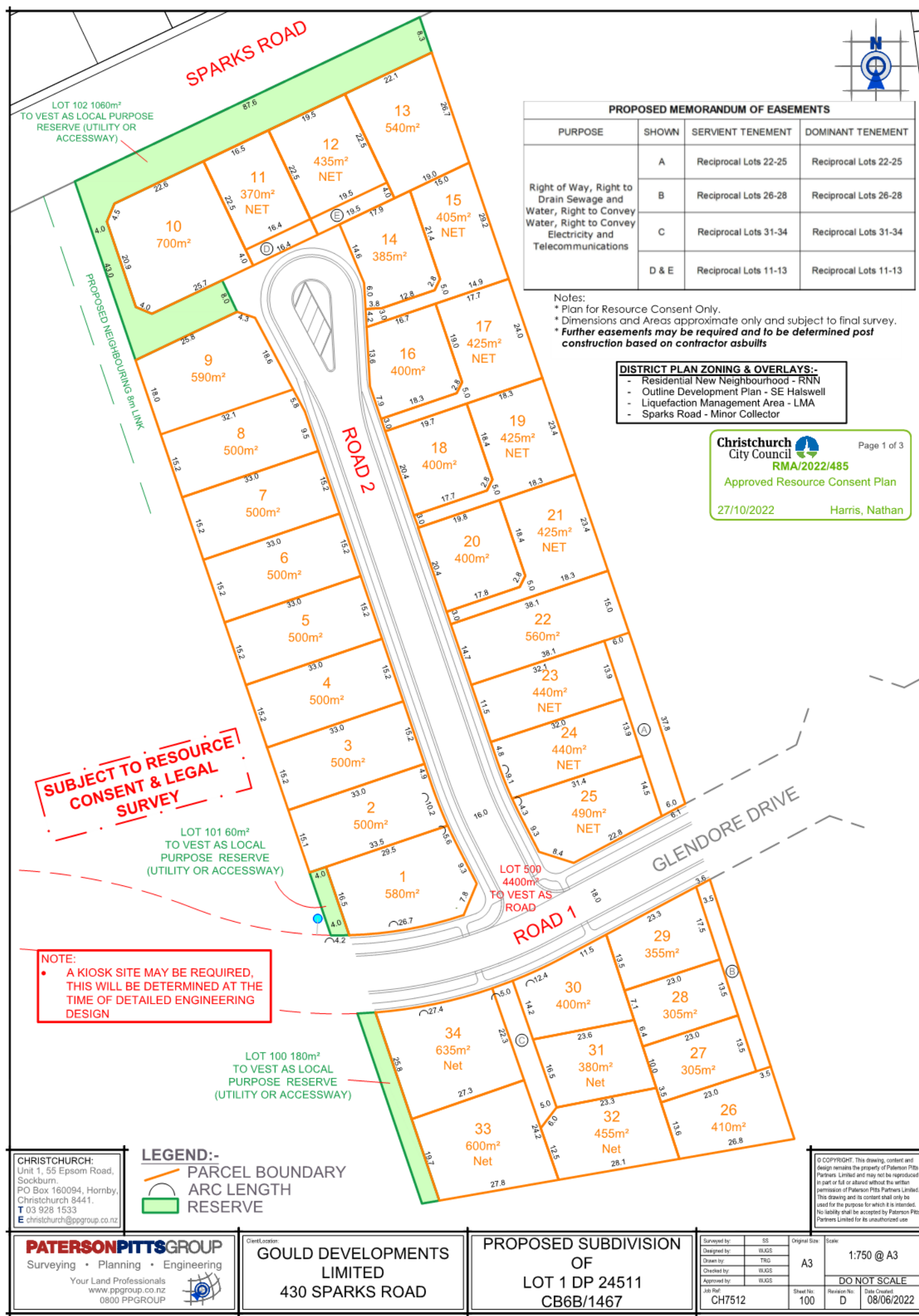



## 8. Waipuna Halswell-Hornby-Riccarton 2023-25 Community Board Plan

Reference / Te Tohutoro: 23/606796

Report of / Te Pou  
Matua: Marie Byrne, Community Development Adviser,  
(marie.byrne@ccc.govt.nz)

General Manager /  
Pouwhakarae: Mary Richardson, General Manager Citizens & Community  
(Mary.Richardson@ccc.govt.nz)

### 1. Purpose of the Report Te Pūtake Pūrongo

- 1.1 The purpose of this report is for the Waipuna Halswell-Hornby-Riccarton Community Board to adopt its 2023-25 Community Board Plan.
- 1.2 This report is staff generated.
- 1.3 The decision in this report is of low significance in relation to the Christchurch City Council's Significance and Engagement Policy.

### 2. Officer Recommendations Ngā Tūtohu

That the Waipuna Halswell-Hornby-Riccarton Community Board:

1. Adopts the Waipuna Halswell-Hornby-Riccarton 2023-25 Community Board Plan as attached to the report on the meeting agenda.

### 3. Reason for Report Recommendations Ngā Take mō te Whakatau

- 3.1 The purpose of the Waipuna Halswell-Hornby-Riccarton Community Board Plan (refer **Attachment A**) is to identify the Board's vision and strategic priorities for the 2023-2025 term.
- 3.2 The Community Board Plan will inform the Board's strategic decision-making, and its influence of Council decision-making processes such as the Long Term Plan.





### 4. Context / Background / Te Horopaki

- 4.1 In line with the Council's Community Outcomes and Strategic Priorities, the Board identified its priorities under the four community outcomes:
  - A collaborative confident city
  - A green, liveable city
  - A cultural powerhouse city
  - A thriving prosperous city
- 4.2 The Community Board Plans also align with the pillars of the Council's Strengthening Communities Together Strategy:
  - People
  - Place
  - Participation



- Preparedness
- 4.3 A Community Board Plan is a three-year plan that sets out the community board's vision and priorities for the local community.
- 4.4 Each plan identifies up to nine priorities, which the board will focus on during their term. For each priority, the plan includes:
- Why the project matters
  - What actions the Board will take
  - How the Board will measure its success
- 4.5 The nine Waipuna Halswell-Hornby-Riccarton priorities are:
- Advocate for a fenced dog park for the Halswell Ward
  - Advocate for safe, accessible pedestrian connections to significant community destinations in the Halswell Ward
  - Support initiatives that provide safe recreations spaces and opportunities for youth in Halswell to come together
  - Advocate for the development and implementation of a Hornby Masterplan
  - Advocate for the revitalisation of greenspaces in the Hornby ward including the increase of tree canopy in the ward
  - Support the transition of the Hornby Community Care Centre to full ownership for the Hornby Community Care Trust
  - Advocate for liveable neighbourhoods in the Riccarton Ward
  - Support initiatives that provide for social cohesion, community connectedness and safety in the Riccarton Ward
  - Support initiatives that provide things to do, places to go for youth in the Riccarton Ward.
- 4.6 The draft Waipuna Halswell-Hornby-Riccarton 2023-25 Board Plan priorities opened for community feedback via the Council's Have Your Say website from 8 March 2023 and closed on 26 March 2023.
- 4.7 A total of 80 submissions were received on the Board's draft priorities. An analysis and summary of these submissions is attached.

## Attachments Ngā Tāpirihanga

No.	Title	Reference	Page
A  	Community Board Plans 2023-25 - Waipuna FINAL	23/621092	22
B  	Draft 2023-25 Community Board Plan Priorities -Waipuna Halswell Hornby Riccarton submission summary	23/455257	39

In addition to the attached documents, the following background information is available:

Document Name - Location / File Link
Not applicable

## Confirmation of Statutory Compliance Te Whakatūtutanga ā-Ture

Compliance with Statutory Decision-making Requirements (ss 76 - 81 Local Government Act 2002).

(a) This report contains:

- (i) sufficient information about all reasonably practicable options identified and assessed in terms of their advantages and disadvantages; and
- (ii) adequate consideration of the views and preferences of affected and interested persons bearing in mind any proposed or previous community engagement.

(b) The information reflects the level of significance of the matters covered by the report, as determined in accordance with the Council's significance and engagement policy.

## Signatories Ngā Kaiwaitohu

<b>Author</b>	Marie Byrne - Community Development Advisor
<b>Approved By</b>	Matthew McLintock - Manager Community Governance Team John Filsell - Head of Community Support and Partnerships

# Waipuna Halswell-Hornby-Riccarton **Community Board Plan 2023–25**



Raraka Riccarton Centre

# Contents

From the Chair..... 3

About local boards and our plans..... 3

Christchurch City Council’s Strategic Framework..... 4

Strengthening Communities Together Strategy..... 5

Waipuna Halswell-Hornby-Riccarton Community Board area..... 6

Key statistics..... 7

Our vision..... 8

Our priorities..... 9

Community board funding..... 15

Your local board members..... 16





## From the Chair



On behalf of the Waipuna Halswell-Hornby-Riccarton Community Board, I am proud to present our 2023-2025 Community Board Plan.

Community board plans guide the board in prioritising its work in the community over the next few years. This plan has been shaped by conversations with our community and the priorities listed in the plan reflect the issues that residents, community groups and Christchurch City Council staff have brought to our attention.

While the community board will continue to deal with any issue that comes to our attention, the board's plan prioritises the key outcomes that we wish to achieve over the next three years. I would like to thank everyone who gave feedback to help inform this plan.

It remains our focus to enhance the social, environmental and economic well-being of citizens in the Waipuna Halswell-Hornby-Riccarton Community Board area. We are particularly mindful of the impacts of the increased development, intensification and population changes in the southwest areas of Christchurch. We will continue to proactively address and respond to issues as they arise.

The Waipuna Halswell-Hornby-Riccarton Community Board is very conscious of the impact of rate rises on our residents. As a result of this, we are very mindful of where your money is spent. A large number of our residents sent us a clear message that we need to be spending on getting our key infrastructure working well before spending on 'nice to haves'. Keeping this in mind, we are confident that the priorities we have identified in this plan can be achieved with very little financial impact.

We look forward to working alongside our local community to achieve our vision for this area.

Helen Broughton, Chairperson

### About local boards and our plans

Community boards were created by the local government reforms in 1989.

Approximately 110 community boards now operate in both urban and rural areas within local authorities throughout New Zealand. They carry out functions and exercise powers delegated to them by their councils.

There are six community boards within the Christchurch City Council area.

Local body elections for community board members and councillors are held every three years.



3 Waipuna Halswell-Hornby-Riccarton Community Board Plan 2023-25

### The community board's main role is to:

- Represent and advocate for the interests of its community.
- Consider and report on all matters referred to it by the council, or any matter of interest to the board.
- Maintain an overview of council services in the community.
- Prepare an annual submission to the council for expenditure within the community.
- Communicate with community organisations and special interest groups within the community.

### Community board plans

Community board plans are developed every three years and outline the board's key priorities for their elected term. They also indicate how the board will work in partnership with the local community to achieve the council's community outcomes.

A key part of the development of the plan is engagement with the local community and key stakeholders to ensure that the board's priorities reflect the needs and desires of local residents, community groups and businesses in our board area.



# What is important to us?

A big picture view of the what the Council is aiming to achieve for our community

## Our focus this Council term 2022–2025

### Draft Strategic Priorities



Be an **inclusive and equitable city** which **puts people at the centre** of developing our city and district, prioritising wellbeing, accessibility and connection.



**Champion Ōtautahi-Christchurch** and collaborate to build our role as a leading New Zealand city.



**Build trust and confidence** in the Council through meaningful partnerships and communication, listening to and working with residents.



**Reduce emissions** as a Council and as a city, and invest in **adaptation and resilience**, leading a city-wide response to climate change while protecting our indigenous biodiversity, water bodies and tree canopy.



**Manage ratepayers' money wisely**, delivering quality core services to the whole community and addressing the issues that are important to our residents.



Actively balance the needs of **today's residents** with the **needs of future generations**, with the aim of leaving no one behind.

## Our goals for this Long Term Plan 2024–2034

### Draft Community Outcomes



#### Collaborative and confident

Our residents have the opportunity to actively participate in community and city life, have a strong sense of belonging and identity, and feel safe.



#### Green and liveable

Our neighbourhoods and communities are accessible and well connected, supporting our goals to reduce emissions, build climate resilience and protect and regenerate the environment, especially our biodiversity, water bodies and tree canopy.



#### A cultural powerhouse

Our diverse communities are supported to understand and protect their heritage, pursue their arts, cultural and sporting interests, and contribute to making our city a creative, cultural and events 'powerhouse'.



#### Thriving and prosperous

Our city is a great place for people, business and investment where we can all grow our potential, where enterprises are innovative and smart, and where together we raise productivity and reduce emissions.

## Our intergenerational vision 2022–2052

A place of opportunity for all.

Open to new ideas, new people,  
new investment and new ways  
of doing things – a place where  
anything is possible.



Ngāi Tahu has rangatiratanga over its takiwā – the Council is committed to partnering with Ngāi Tahu to achieve meaningful outcomes that benefit the whole community

## Te Haumako Te Whitingia Strengthening Communities Together Strategy

In 2022, the Council reflected on the 2007 Strengthening Communities Strategy, which made it clear that people value diversity, collaboration, being connected and building capability for the future.

We cannot address the many complex social issues that face our city on our own but can help to develop and nurture networks and bring resources and people together so that collectively we can achieve more.

We know that communities want us to focus more on impact and outcomes, with more emphasis on collaboration and partnership. They want transparency and accountability with measurable goals and actions so we know what's working and what isn't.

We believe this refreshed strategy delivers on this.

The strategy has been organised around four pillars that set out the Council's commitment to working alongside the community over the next ten years.

### Strategy Pillars

Te Tāngata People	Whenua Place	Te Mahi Participation	Te Takatū Preparedness
Actively promote a culture of equity by valuing diversity and fostering inclusion across communities and generations.	Support and help build connections between communities to foster a sense of local identity, shared experience and stewardship.	Residents and groups in the wider community are socially and actively engaged and able to initiate and influence decisions affecting their lives.	People feel safe in their communities and neighbourhoods and work together to understand, adapt and thrive in the context of change and disruption.

The Waipuna Halswell-Hornby-Riccarton Community Board is committed to working alongside our local communities to achieve the goals of the strategy. The four pillars above guide us in our decision-making and advocacy on behalf of our residents.

You can view a copy of the Strengthening Communities Together Strategy on the Council's website [here](https://ccc.govt.nz/the-council/plans-strategies-policies-and-bylaws/strategies/strengthening-communities-together-strategy).  
(ccc.govt.nz/the-council/plans-strategies-policies-and-bylaws/strategies/strengthening-communities-together-strategy)





## Waipuna Halswell-Hornby-Riccarton Community Board area

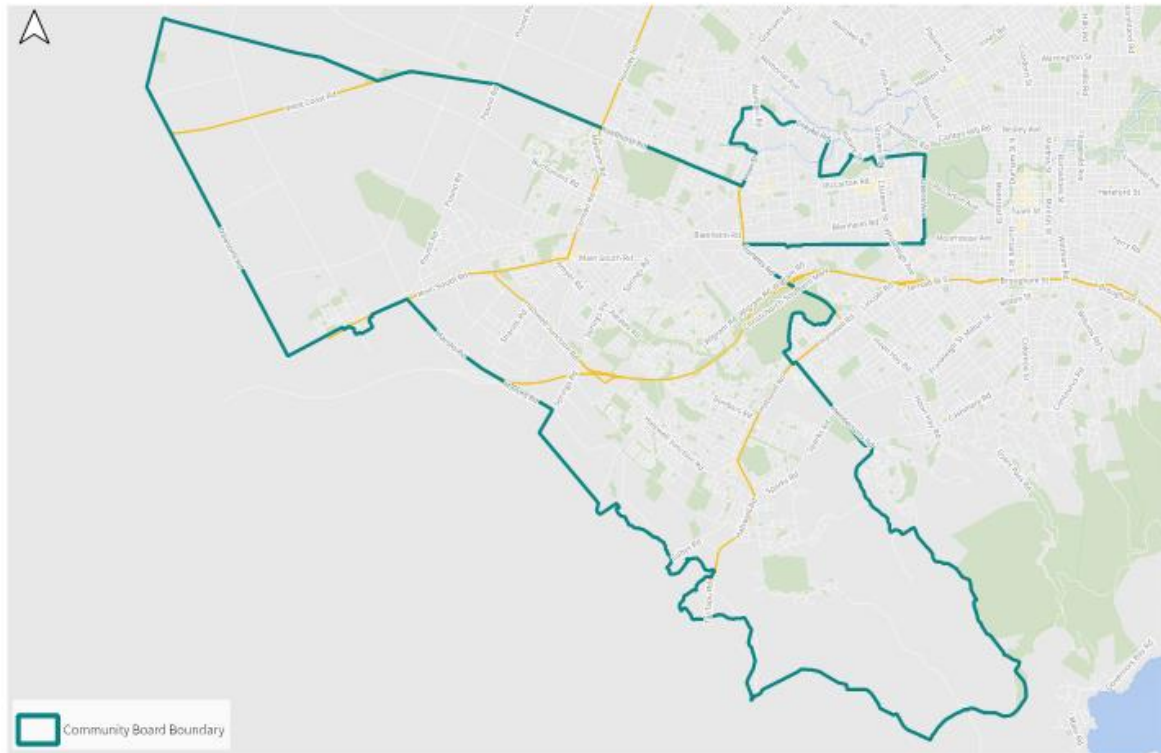

## Key statistics

This section provides an overview of key statistics for the Waipuna Halswell-Hornby-Riccarton Community Board area. Please note all figures are sourced from the 2018 Census of Population and Dwellings.



Population:  
**71,950**



Median age:  
**34.1** years



Median personal income:  
**\$34,700**

### Ethnicity

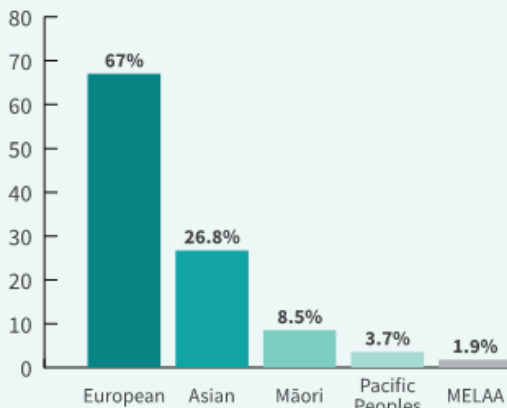

Occupied private dwellings:  
**63%**



Rented dwellings:  
**37%**



Born overseas:  
**34.5%**

### Key facilities and amenities

- 3 Council libraries: Te Hāpua Halswell Centre, Upper Riccarton Library and Hornby Library
- 3 Council service centres: Hornby, Rārākau: Riccarton Centre and Te Hāpua Halswell Centre
- 353 Council Reserves (853 hectares)
- 10 Council-owned social housing complexes with 215 units
- 28 schools: 20 primary, 1 intermediate, 4 secondary, 2 composite (Year 1-13), 1 special
- 8 Industrial Parks: Waterloo Business, Innovation, Yaldhurst, Wigram, Glassworks, Hornby, Mandeville, Sockburn
- 4 cemeteries – 1 Council (Yaldhurst), 3 church owned (Halswell, Templeton, Upper Riccarton)
- Approximately 9,200 businesses employing 35,000 people (2021)
- Transport: 2 Passenger Transport Hubs: Riccarton Bus Lounges and Christchurch Railway Station Major Cycleway routes: Little River Link, Nor'West Arc, Quarryman's Trail, South Express, Uni-Cycle
- Canterbury University
- 2 Corrections Residential Facilities – Christchurch Men's and Christchurch Women's Prisons
- Multiple major sport and recreation amenities: Canterbury Agricultural Park, Denton Park, Halswell Domain, Halswell Quarry Park, Ngā Puna Wai Sports Park, Riccarton House and Bush, Riccarton Racecourse, Ruapuna Motorsport Park
- Retail Precincts: Bush Inn Shopping Centre, Dressmart Shopping Centre, The Hub Shopping Centre, The Landing Shopping Centre, Tower Junction Shopping Centre, Westfield Riccarton, retail precincts in Church Corner, Halswell and along Riccarton, Main South, Carmen and Blenheim Roads
- Major tourist attractions: Airforce Museum, Halswell Quarry Park, Kate Sheppard House, Riccarton House and Bush
- Heritage sites: three Ngā Tūrangā Tūpuna, 26 significant heritage sites, eight war memorial sites

## Our vision

“

The Waipuna Halswell-Hornby-Riccarton Community Board is committed to creating a thriving, connected and inclusive community, where sustainability and the well-being of residents are a priority.

”

### Vision statements

The Waipuna Halswell-Hornby-Riccarton Community Board values:

- A strong local identity that embraces multiculturalism, fostering a vibrant and inclusive environment.
- A community where the views, interests, needs and aspirations of all residents are at the heart of the Board's decision-making.
- A decision-making process that is open and transparent enabling residents to understand and engage in the process.
- A safe, accessible and sustainable transport network providing efficient mobility within and beyond our area.
- Prioritising the safety and well-being of all community members, with a strong sense of community connections.
- Developing a connected Board area that promotes healthier lifestyles utilising high-quality public spaces and inclusive access to parks and green spaces for all.
- Supporting the physical, social, and emotional well-being of all residents by fostering a range of activities that bring people together.
- Working collaboratively with stakeholders and local organisations to create an inclusive and safe community.

In addition to our priority projects identified in this plan, the board will continue to advocate strongly through submissions to the Council's Annual Plan and Long Term Plan for increased budgets for road, footpath and park maintenance.

The Board is also committed to supporting residents in the Board area with concerns that Plan Change 14 Housing and Business Choice implications will have on liveability in their neighbourhoods.



Halswell Quarry



## Our priorities *(not in any particular order)*

### Halswell – Advocate for a fenced dog park for the Halswell Ward

#### Why this matters

There are no fenced areas in the south-west of the city where dog owners can exercise their dogs off-leash in a dedicated space that allows dogs to socialise and play in a safe and controlled environment. This is particularly important for residents who may not have access to large open spaces or have large enough yards for their dogs to play in.

#### What the board will do

- Advocate for a fenced dog park for the Halswell ward through the 2024-34 LTP process (noting it was removed from the 2021-31 LTP).
- Request staff investigate and report back to the Board appropriate sites for a fenced dog exercise area.
- Request that funding in the current LTP for a fenced dog park in the Halswell ward be moved forward.

#### We will measure our success by:

- Findings of an investigation and report on potential sites for a fenced dog park being provided to the Board.
- Funding for a fenced dog park being available in the LTP 2024-34.

#### Strengthening Communities Together Strategy Pillars:

People ✓ Place ✓ Participation ✓  
Preparedness ✓



Westlake Reserve

### Halswell – Advocate for safe, accessible pedestrian connections to significant community destinations in the Halswell Ward

#### Why this matters

Halswell is a rapidly developing part of the city, as various sub-divisions have taken shape, a number of footpaths that abruptly end have been installed by developers. While there is a long-term plan to join these footpaths into the wider network, there are a number of sites where connections are required sooner rather than later for safe and accessible pedestrian connections, along with safe crossing facilities (particularly around schools), to significant community destinations in the Halswell Ward.

#### What the board will do

- Identify locations where safe and accessible pedestrian connections are required.
- Advocate for safe and accessible pedestrian connections to be installed.
- Advocate for funding to complete safe and accessible pedestrian connections, along with safe crossing facilities (particularly around schools), to significant community destinations in the Halswell Ward.

#### We will measure our success by:

- Funding for safe and accessible pedestrian connections, along with safe crossing facilities (particularly around schools), to significant community destinations in the Halswell Ward secured in the LTP 2024-34.
- Installation of footpaths.

#### Strengthening Communities Together Strategy Pillars:

People ✓ Place ✓ Participation ✓  
Preparedness ✓

## Halswell – Support initiatives that provide safe recreation spaces and opportunities for youth in Halswell to come together

### Why this matters

Halswell is a rapidly growing area where a range of new subdivisions have been built in the past few years and where more subdivisions are being built. Halswell has a number of Primary Schools, but does not have a High School. There are no plans by the Ministry of Education to build a High School in Halswell. Young people are required to travel out of the ward to attend school, sometimes from Year 7 onwards; it is important for the Community Board to support initiatives in Halswell that provide safe recreation spaces and opportunities for youth to come together.

### What the board will do

- Encourage, catalyse and support initiatives in Halswell that provide safe recreation spaces and opportunities for youth to come together.
- Collaborate with local organisations to support for youth activities in the area.
- Advocate for youth spaces and recreational spaces that can be enjoyed by young people.
- Advocate for things to do and places to go that provide positive engagement opportunities for youth.

### We will measure our success by:

- The number of initiatives and activities for young people, supported, encouraged or catalysed by the Board that promote positive values and healthy behaviours.
- The revitalisation will support the goals of the Ōtautahi Christchurch Climate Resilience Strategy and the Ōtautahi-Christchurch Urban Forest Plan.

#### Strengthening Communities Together Strategy Pillars:

People ✓ Place ✓ Participation ✓  
Preparedness ✓



Knight Stream Skate Park



## Hornby – Advocate for the development and implementation of a Hornby Masterplan

### Why this matters

Hornby is a well-established and well-loved community where, over time, a range of developments have occurred independently of each other. With the development of the Matatiki Centre and the implementation of major cycle routes to connect the community, it is timely to develop a masterplan to ensure the community is well connected and that any future developments are well thought out.

### What the board will do

- Request that a master planning process is initiated for Hornby, commencing with the area around the Hornby Hub business environs.
- Work with planners and developers to implement elements of the masterplan.
- Work with agencies and community partners to develop hubs of connectedness in Hornby starting with a pedestrian link between the Hornby Mega Centre and Hornby Hub on Main South Road.

### We will measure our success by:

- The development of a masterplan.
- Community involvement in the master planning process.
- Planners and developers using the masterplan as a guiding document.

#### Strengthening Communities Together Strategy Pillars:

People ✓ Place ✓ Participation ✓  
Preparedness ✓



Hornby Hub

11 Waipuna Halswell-Hornby-Riccarton Community Board Plan 2023–25

## Hornby – Advocate for the revitalisation of greenspaces in the Hornby Ward including the increase of the tree canopy in the ward

### Why this matters

Urban trees are a key tool to help us meet the challenge of our climate and ecological emergency. They are central to enhancing our wellbeing and the pleasantness of our urban environment as well as providing a network of habitat for other wildlife.

Hornby is a ward with a low percentage of tree canopy (less than 5% in many areas) compared to other areas of the city. This is not equitable. With the city's urban forest not spread across all communities evenly, the benefits are not able to be shared by everyone to the same extent.

### What the Board will do

- Advocate that Hornby be an area that is prioritised through the Urban Forest Plan.
- Advocate for funding to plant more trees and enhance biodiversity in Hornby.
- Work alongside community partners to encourage community initiatives to plant trees and revitalise greenspaces.
- Encourage developers to plan developments around trees.
- Advocate for the creation of a Hornby bush area(s)

### We will measure our success by:

- Increased tree canopy.
- Number of trees planted.
- Greenspaces revitalised.

#### Strengthening Communities Together Strategy Pillars:

People ✓ Place ✓ Participation ✓  
Preparedness ✓



Kyle Park



### Hornby – Support the transition of the Hornby Community Care Centre to full ownership for the Hornby Community Care Trust

#### Why this matters

With the existing Library in Hornby soon to move to a new space in the Matatiki Centre, there is an opportunity to collaborate with and support a well-established community trust in Hornby to create a community space for local residents to enjoy and utilise for years to come.

Working alongside the Hornby Community Care Trust to successfully transition into a larger space, will build their capacity and capability to collaborate and partner with the Council and other community stakeholders to address some of the many complex social issues that face our city. This will then lead to an increase in community connectedness and social capital in the Hornby area.

#### What the board will do

- Support the Hornby Community Care Trust's request to Council for the gifting of ownership of the library in Goulding Avenue to the Trust that will enable them to autonomously operate the facility.
- Advocate to the Council that the library building is gifted in a good, well maintained state.
- Support the Trust to engage the community in the transition process, including sharing information and updates on the progress of the transition to ensure that the new space is responsive to the needs of the community.
- Support the Trust with any strategic planning and needs assessment resourcing that can identify challenges and opportunities associated with the transition, as well as an assessment of the potential impact on the community.

#### We will measure our success by:

- Funding is secured that provides a successful transition.
- Ownership of the building is vested in the Trust.
- Additional community collaborations are developed that support the Trust to successfully manage and operate the facility.

#### Strengthening Communities Together Strategy Pillars:

People ✓ Place ✓ Participation ✓  
Preparedness ✓



Hello Hornby

## Riccarton – Advocate for liveable neighbourhoods in the Riccarton Ward

### Why this matters

The Riccarton ward is made up of a range of different neighbourhoods many of which are juxtaposed. There are neighbourhoods of the well-established and historic as well as the newly intensified; there is a contrast of top end real estate and affordable rental accommodation – as well as everything in between.

As such, Riccarton faces a variety of challenges regarding housing in the area. Anecdotal evidence and census data shows that a large number of houses are of low quality. Current intensification level bring the challenge of more people using the existing social infrastructure, additional parking on streets and changes to the character of the area.

Riccarton faces increasing heights and densities through proposed plan changes which will increase the above pressures. The Board will advocate to preserve existing communities and promote quality living standards in more intensified areas. Riccarton should be a community that is liveable and vibrant for all.

### What the board will do

- Advocate for, and assist Riccarton residents to participate effectively in the proposed district plan intensification processes as well as long term and annual plan engagement opportunities.
- Support initiatives that improve living standards in rental accommodation, particularly for student and migrant populations.
- Seek to investigate parking management options that can address parking congestion on the streets.

### We will measure our success by:

- Number of initiatives underway that improve living standards in rental accommodation and neighbourhoods, particularly for student and migrant populations.
- Riccarton residents feel supported by the Board in their advocacy for amendments to the proposed District Plan changes.
- Parking congestion around the area is addressed.

#### Strengthening Communities Together Strategy Pillars:

People ✓ Place ✓ Participation ✓  
Preparedness ✓

## Riccarton – Support initiatives that provide for social cohesion, community connectedness and safety in the Riccarton Ward

### Why this matters

Riccarton is a multi-cultural community with both a well-established and a transient population. The Board will look to initiate, collaborate and partner with other agencies in providing initiatives that provide for social cohesion, community connectedness and safety in the Riccarton Ward.

### What the board will do

- Support community-led initiatives that promote social cohesion, community connectedness, and safety.
- Foster partnerships and collaborations between community-based organisations, government agencies, and businesses.
- Encourage civic engagement by promoting opportunities for community members to participate in local decision-making.
- Advocate for maximising the use of Council facilities such as the Upper Riccarton Library, Rārākau: Riccarton Centre and Waimairi Road Community Centre as well as community provided facilities

### We will measure our success by:

- Number of programmes supported.
- Increase in Riccarton residents who report a sense of safety and connectedness.
- Number of participation opportunities in annual plan, board forums and submissions to Council consultation.

#### Strengthening Communities Together Strategy Pillars:

People ✓ Place ✓ Participation ✓  
Preparedness ✓



Riccarton Connect Event



### Riccarton – Support initiatives that provide things to do, places to go for youth in the Riccarton ward

#### Why this matters

Providing safe recreation spaces and activities for young people is essential for promoting physical and mental health, fostering social connections, providing positive outlets for energy and creativity, reducing anti-social behaviour, and investing in the future of the community.

#### What the board will do

- Collaborate with local organisations that work with young people to investigate options for positive youth spaces and places in the Riccarton area - including the creation of safe recreation spaces for youth to come together.
- Support initiatives that provide for positive youth activities
- Support the development of existing public spaces that will provide outlets for young people to be safe in with a sense of belonging.

#### We will measure our success by:

- The number of youth initiatives supported.
- The creation of youth spaces that provide things to do and places to go.

#### Strengthening Communities Together Strategy Pillars:

People ✓ Place ✓ Participation ✓  
Preparedness ✓



Riccarton Basketball

## Community board funding

In Christchurch, community board funding is allocated to each board based on population and equity. The NZ Deprivation Index is the tool used to measure the equity portion of the allocation. The Council uses the formula of 60% population and 40% equity when determining the allocations to each board.

The community board has three funding schemes available for allocation each year. In the 2022-23 funding year, there was a total funding pool of \$653,308. It is anticipated that there will be a funding pool of \$637,356 for the 2023-24 year.

### Strengthening Communities Fund

An annual contestable funding round – opens in March/April each year, providing funding for the period of 1 September to 30 August each year.

The purpose of this fund is to support community-focused organisations whose projects contribute to the strengthening of community wellbeing in the Christchurch city area.

Successful organisations will be those which demonstrate they are sustainable, strategic, community-focused groups which have a significant presence within their community of benefit. Successful projects will also clearly demonstrate their contribution to the council's funding outcomes and priorities. Organisations must be able to demonstrate their ability to contribute towards their project(s) and not rely on council funding as their sole source of funding.

### Discretionary Response Fund

Open for applications all year – 1 July to 30 June.

The purpose of this fund is to assist community groups where the project and funding request falls outside other council funding criteria and/or closing dates. This fund is also for emergency funding for unforeseen situations.

Community board projects (events and awards) are also funded from this fund.

### Youth Development Fund

The purpose of the Youth Development Fund is to celebrate and support young people living in the Waipuna Halswell-Hornby-Riccarton Community Board area by providing financial assistance for their development. The community board also seeks to acknowledge young people's effort, achievement and potential excellence in the community.

The community board will consider applications for the following activities:

- Personal Development and Growth - For example leadership training, career development, Outward Bound, Spirit of Adventure, extra-curricular educational opportunities.
- Representation at Events - Applicants can apply for assistance if you have been selected to represent your school, team or community at a local, national or international event or competition. This includes sporting, cultural and community events.

### Off the Ground Fund

- The Off the Ground Fund is a funding avenue from which community can access up to \$400 to help fund getting a project or initiative 'off the ground', removing the barrier of a more official and lengthy application process. The process involves a simple one page application form which include details on what the idea is about.

If you want to know more about the board's community funding, please contact one of the staff below:

- Bailey Peterson Community Development Adviser  
bailey.peterson@ccc.govt.nz
- Marie Byrne Community Development Adviser  
marie.byrne@ccc.govt.nz
- Helen Miles Community Recreation Adviser (2023)  
helen.miles@ccc.govt.nz
- Sam Savage Community Recreation Adviser (2024-5)  
sam.savage@ccc.govt.nz



Culture Galore



## Your local board members



**Helen Broughton**

Chairperson  
Riccarton Ward  
Mobile: 027 640 4935  
Email: [helen.broughton@ccc.govt.nz](mailto:helen.broughton@ccc.govt.nz)



**Marie Pollisco**

Deputy Chairperson  
Halswell Ward  
Mobile: 021 0901 4149  
Email: [marie.pollisco.cbm@ccc.govt.nz](mailto:marie.pollisco.cbm@ccc.govt.nz)



**Sarah Brunton**

Hornby Ward  
Mobile: 021 022 17483  
Email: [sarah.brunton@ccc.govt.nz](mailto:sarah.brunton@ccc.govt.nz)



**Henk Buunk**

Hornby Ward  
Mobile: 027 372 3338  
Email: [henk.buunk@ccc.govt.nz](mailto:henk.buunk@ccc.govt.nz)



**Gamal Fouda**

Riccarton Ward  
Mobile: 022 044 0718  
Email: [gamal.fouda@ccc.govt.nz](mailto:gamal.fouda@ccc.govt.nz)



**Debbie Mora**

Halswell Ward  
Mobile: 022 371 9687  
Email: [debbie.mora@ccc.govt.nz](mailto:debbie.mora@ccc.govt.nz)



**Tyla Harrison-Hunt**

Councillor  
Riccarton Ward  
Mobile: 021 276 7682  
Email: [tyla.harrisonhunt@ccc.govt.nz](mailto:tyla.harrisonhunt@ccc.govt.nz)



**Andrei Moore**

Councillor  
Halswell Ward  
Mobile: 027 632 5823  
Email: [andrei.moore@ccc.govt.nz](mailto:andrei.moore@ccc.govt.nz)



**Mark Peters**

Councillor  
Hornby Ward  
Mobile: 028 409 5615  
Email: [mark.peters@ccc.govt.nz](mailto:mark.peters@ccc.govt.nz)

The Waipuna Halswell-Hornby-Riccarton Community Board meets on the second Thursday of each month at 4.30pm in the Horoeke Room, Rārākau: Riccarton Centre, 199 Clarence Street, Riccarton.

These meetings are open to the public and livestreamed. Agendas and minutes for each meeting can be found on the Council's website at [www.ccc.govt.nz](http://www.ccc.govt.nz)

If you would like speaking rights at a Board meeting please contact us on **03 941-5108**.



## Draft 2022-5 Waipuna Halswell-Hornby-Riccarton Community Board Plan Feedback Analysis

### The consultation process.

Submitters were asked to provide comments on the nine priorities detailed in the draft plan. There was also a further question asking for other feedback.

80 submitters provided feedback to the Draft 2022-25 Waipuna Halswell-Hornby-Riccarton Community Board Plan (including a late submission from Halswell Residents Association).

The names and wards of the submitters is listed below. Seven of these indicated they represented an organisation and 71 commented on an individual capacity. The breakdown of wards that submitters live in (or represent) is as follows.

- Halswell – 60
- Hornby - 10
- Riccarton - 4
- Cashmere - 1
- Spreydon - 1
- Metropolitan Organisation - 2
- Unknown - 2

ID#	Name	Ward	Organisation	ID#	Name	Ward	Organisation
1	Arthur McGregor	Hornby		45	Amy Collins	Halswell	
2	Jono de Wit	Riccarton		46	Leanne Mahon	Halswell	
3	Ruby Beaumont	Hornby		47	N/A	Unknown	
4	Marc Duff	Hornby		48	Jo Johns	Halswell	
5	ROSS Allan HOULISTON	Hornby		49	Douglas Bull	Halswell	
6	Kate Cleverly	Halswell	Halswell Community Project	50	Rosa Bellolio	Halswell	
7	Susan Ward	Riccarton	La Vida Youth Trust	51	Jacqueline Browb	Halswell	
8	Peter Carey	Riccarton	Riccarton Leagues Club	52	Luke Brown	Halswell	
9	Rachael Hemmer	Hornby		53	Lucy Love	Halswell	
10	Hana	Halswell		54	Li Shawn Lim	Halswell	
11	Kim Moss	Hornby		55	Jess Ellis	Halswell	
12	Marcus Clyne	Halswell		56	Andrew Ellis	Halswell	
13	Ben Larter	Halswell		57	Ged robinson	Halswell	Taitā Whetū waitaha athlete support programme
14	John Logue	Halswell					
15	Ben Wiles	Halswell					

1

ID#	Name	Ward	Organisation	ID#	Name	Ward	Organisation
16	Sarah Taylor	Riccarton		58	Leticia Wiltshire	Halswell	
17	Sian Troath	Halswell		59	Francesca Brown	Halswell	
18	Nic Love	Halswell		60	Nicola Gibbons	Halswell	
19	Rebecca Jacka	Halswell		61	Rachel Welbeloved	Cashmere	
20	Pip Hough	Halswell		62	Ben Sewell	Halswell	
21	Marie France Abanalo	Halswell		63	Blake Hansen	Halswell	
22	David McCormick	Halswell		64	Hayley	Halswell	
23	Tracilee Irving	Halswell		65	Anna Smith	Halswell	
24	Zelda Yates	Halswell		66	Steve	Halswell	
25	Katie Macbeth	Hornby		67	Ash	Halswell	
26	Lauren Moore	Halswell		68	Sarah Friston	Halswell	
27	Rebecca Dent	Halswell		69	Kelsey craver	Halswell	
28	Patricia Bartlett	Halswell		70	Jade	Unknown	
29	Clara Watson	Halswell		71	Miriam Irving	Halswell	
30	Alicia Harbison-Price	Halswell		72	Michael Alan Mora	Hornby	
31	Matt Rhodes	Halswell		73	Carena parish	Halswell	
32	Ella Murray	Halswell		74	NORM WILLIAMS	Hornby	HORNBY COMMUNITY PATROL
33	Laura Tarrant	Halswell		75	Anna Bleyendaal	Halswell	
34	Diana kidd	Halswell		76	jess watson	Halswell	
35	Els	Halswell		77	Marie Gray	Hornby	
36	Lisa Wright	Halswell		78	Marie Gray	Metro	Summit Road Society (secretary)
37	Alan Mears	Halswell		79		Metro	Opawaho Heathcote River Network
38	stacey puha	Halswell		80	David Hawke	Halswell	Halswell Residents Association
39	L. Janks	Halswell					
40	Caroline May	Spreydon					
41	Abby Kennedy	Halswell					
42	Sophie Morton	Halswell					
43	Damien Upton	Halswell					
44	Hannah	Halswell					



### Analysis of feedback received by priority

The comments have been analysed into three fields as follows;

- Agree (indicating unqualified support)
- Partially Agree (agreeing with conditions)
- Don't Agree (indicating it should not be a priority)

The numbers in the left hand column indicate the submitter ID number from the above table. Comments are provided as given. Apart from spelling corrections there has been no editing.

*Halswell: Advocate for a fenced dog park for the Halswell ward.*

#### Why this matters:

There are no fenced areas in the south-west of the city where dog owners can exercise their dogs off-leash in a dedicated space that allows dogs to socialise and play in a safe and controlled environment. This is particularly important for residents who may not have access to large open spaces or have large enough yards for their dogs to play in.

#### What the board will do:

- Advocate for a fenced dog park for the Halswell ward through the 2024-34 LTP process (noting it was removed from the 2021-31 LTP).
- Request staff investigate and report back the Board appropriate sites for a fenced dog exercise area.
- Request that funding in the current LTP for a fenced dog park in the Halswell ward be moved forward.

#### We will measure our success by:

- Findings of an investigation and report on potential sites for a fenced dog park being provided to the Board.
- Funding for a fenced dog park being available in the LTP 2024-34

#### Comments

1	Yes please this would be great!
2	I support this, please make it nice and usable for people not taking dogs for walks too.

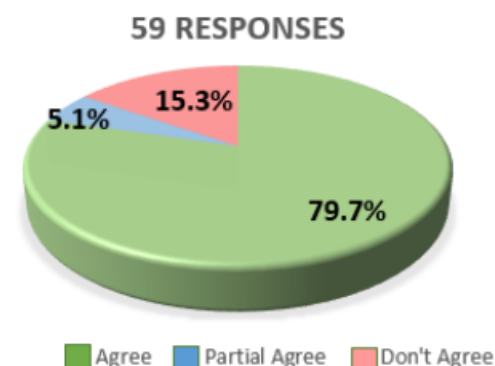

4	It would be great to look at a Dog Park area in Hornby first as Halswell already has the Quarry while the Riccarton Ward has the luxury of Hagley Park
6	Fully support a fenced Dog park - particularly if it is more than just a fenced paddock. Dogs need places to explore as well as run so water, trees etc are an important part of the design / concept. There should also be a separate area for small dogs
9	Absolutely support this 100%
11	Completely agree with this priority. As a dog owner myself, there are no safe spaces in Waipuna Halswell Hornby Riccarton areas. Our areas are constantly expanding and we are running out of areas where we can exercise our companions. Streets are becoming more narrow with more traffic, footpaths are not being developed in some streets, parks and recreation areas while allowed to exercise our dogs, there is the potential for mishaps.
12	Seems reasonable, I would strongly prefer it to be in addition to, not at Halswell Quarry Park
13	Happy to support.
15	I agree with this priority. The dog park should not involve fencing off part of the Quarry - it is important that we retain some larger open spaces within the Quarry.
16	Is this really the top priority for Halswell? A dog park above making sure that Halswell is a safe and welcoming place to be? I would have thought that a dog park would be a 'nice to have' thing rather than essential - especially as Victoria Park is not that far away. If this is what the Board thinks Halswell needs the most then you should all resign and let us elect people who really understand Halswell.
17	I support this priority
18	I think this is very important. Regularly use the quarry for many years and the issues with dogs are getting out of control. Regularly see dogs swimming in the conservation area pond and have had our pram/baby jumped on by dogs multiple times in the "leashed areas". There doesn't seem to be any enforcement from CCC (regularly a dog off lead around the caretakers shed, presumably a worker) so people seem to just do as they please without the risk of a fine. Sounds like any new park would be quite a few years away so it would be good to see some enforcement in the meantime to make the quarry a safe and enjoyable place for all.
19	My dog needs this! But priority #2 for me, after safe travel to school for my children.
20	This would be a great asset to our city and we are so pleased to hear it will not be connected to fencing the quarry.
22	There are currently none within Christchurch, but there is now Kakaha Park Dog Park within 7 minute drive from Halswell Quarry. Owners need to learn to have control of their dogs. We walk our dog on the lead everyday around the Quarry and stay away from the off lead areas and find we still find way too many owners who just let their dogs off the lead. A fenced dog park area won't change this. Our dog had a dog have a go at it, I kicked the dog away and the owner said "sorry he's not normally like that". How about you put the dog on the lead like the Quarry Track is meant to be.
23	This is a nice to have but there are many green space areas where you can take dogs.
24	Agree with this priority
25	I wholeheartedly support any plan to provide a fenced dog park in the Halswell area. The eastern side of town has many options and we have none.
29	I think this should be a main priority. I personally am not a dog person, and don't really like walking through the quarry. The number of dog attacks reported in the Halswell Community Group Facebook page is concerning, and I think it would be much better if there was a dedicated fenced dog park for people to exercise their dogs off leash

4

30	Agreed! The lack of fenced dog parks means dogs and their owners are clashing with others without dogs who want to use recreational spaces like the quarry.
31	I fully support this as a priority.
33	I think a dog park is a great idea for those interested however I also think it is important to enforce a on leash on footpaths rule as have had many close encounters with dogs off leash roaming with my dog on leash who's reactive. Or a ribbon or something people can acknowledge to stay away from said dog due to reactivity or medical reasons etc.
34	I think it's a great idea to have a meeting place for our pups, big and small.
35	I wouldn't like to see a fence in the quarry as it will disrupt the easy access for walking and enjoying the space
36	I think this should be high priority given the significant population growth in Halswell since the earthquakes. Would also love to have a separate fenced dog park for small dog breeds.
37	Not a particularly high priority
38	I personally don't like dog parks as we've had several incidents with our dog being attacked before. but if some are keen to have this then I don't mind, but it really depends where it is planned to be and how much it will cost.
39	Yes, please follow through re: a fenced in site for dog, and dog owners consenting to being off lead. In tandem, could you possibly initiate some sort of compliance/ ((I hate to use the word enforcement) for the rules of Halswell Quarry Park. Perhaps even more visible, larger, and more emphatic signage near ALL the parking areas. thank you
40	YES much needed, the lack of fencing keeps me away. See Victoria Dog park, such an asset, Halswell would be a sort after destination for dog owners if this was the case. The lack of fencing is unsafe for both humans and dogs
41	I think this is of huge importance as many dogs currently are using spaces not intended for this for this particular use. A safe, fenced off place is well needed.
42	Big fan of this one
44	Absolutely a priority. There needs to be a safe space for all dogs, being small and big. Therefore a big and small fenced dog park needs to happen.
45	I think this is a great idea, especially with the growth locally.
46	Would be great to have a fenced dog park and agility area separating small dogs from big dogs. Ensuring that the gate will still be securely shut when we get strong winds.
47	I am a dog owner and do not see this as a priority. I would not take my dog there. The Hornby initiative to increase tree canopy would be time better spent for Halswell given the amount of trees lost to development. It would also recognise in a very small way the climate emergency we are facing.
48	Definitely lower priority for us even though we do have a dog. Prefer money go to safer school crossings and sidewalks etc
49	I've never had an issue or seen issues at Halswell quarry. I think it gets blown all out of proportion on Facebook so this is not a priority for me.

50	I cannot see how this is a priority- the other two points are far more important
53	While there is a designated dog park many are not following the rules for each defined space. Many dog owners let their animals off the lead outside of the dog park making Halswell quarry no longer safe for the rest of the community. Regardless of the trust the dogs owner has in it you can never be certain how an animal will react to others. Halswell has many young families which are impacted by how others are using this space. Myself, I have a young son 6 months old. Several times I have been jumped on Carrying him leaving marks on his legs, also while pregnant. We have been having a picnic and several dog have run over to us. Often the owns response is 'friendly' or sorry they are just a puppy. I'm sorry but I'm in a space I should be comfortable with my family and not worrying about dog attacks or just playing resulting in harm. I love dogs and grew up with many but I also acknowledge their unpredictable behavior and the respect they need when around children. Over the last five years this has become more and more of an issue and will continue with the growth of Halswell. Many families have dogs and should have a space for them to run their animals however not at the risk of my child. Unfortunately you cannot have a family friendly and dog park zone all in one. I know several bikers going to the mountain bike tracks have also been bitten. Lastly I would like to say this may not have been an issue if the rules were enforced. It would not take long for word to get around that you can only have dogs off lead in designated areas.
58	Totally support this. The amount of unrestrained dogs at the quarry is ridiculous
59	Yes as long as the fenced dog park is well designed (eg planting/paths, large enough in size etc to minimise dog aggression).
60	This is a great idea, it would provide a canine recreation area where dogs can be off-leash away from cyclists (as in the quarry) and from childrens play equipment (as in the domain)
61	I think this is a great idea, it would be awesome to be split into 2 spaces for large & small dogs
62	Definitely a long-term plan item...
64	Split the park into two (big dogs, small dogs). Kakaha dog park in Prebbleton is a perfect example.
65	Sounds great but please don't make Halswell quarry dog area lead only, I have a very active dog and this is the only large area where he is safe to run and play. We have walked there every morning for 3 years with no issues. Although I agree with policing the hill walk etc for off lead dogs
67	Many dog owners simply don't have control over their dogs. One of the reasons we purchased in Halswell was to be close to the quarry with our dog. my partner simply doesn't walk our dog their anymore as we have had multiple unsafe interactions with uncontrollable dogs. I watched a big dog bowl a lady over their yesterday while she as walking her little dog. If we had the option to be segregated by size, it would help the problem.
68	No issues, would be happy to support.
69	I think Halswell needs another safe and dog friendly option.
70	Awesome idea
71	This is needed in this part of Christchurch - we are far from both The Groynes and the Beaches and our well behaved dogs need a space for a safe opportunity to run free, train and socialise as well as a space so that others have an opportunity to feel less afraid that they will encounter a dog on a walk of their own. I believe this is an important priority for our area.
72	Consider CCC owned land in Cars Road by the Gokart Track.



73	Having been bit by a dog when riding back from MTB area towards car park, I am keen for fencing. If not a fully fenced area, perhaps a fence to protect cyclists would be a good start as the dog that bit me (not badly or malicious) was really more interested in the bike.... Dogs and bikes never really mix well, yet we have situated them right next to each other...
76	A fenced dog park would be great. I have two dogs and drive to either Rolleston or The Groynes as I find a fenced area gives me more confidence. I especially like how The Groynes have different fenced off zones which makes it easier if there are a lot of dogs there, eg big vs small or confident vs shy dogs, its an added bonus to be able to move to another area within the park.
77	There is already a big dog park at Halswell Quarry. I appreciate it's not fenced and it sounds like that's an issue for some. But even in a fenced dog park, dogs need to be under effective control and come where called. My dog died earlier this year but before then, I walked her daily, sometimes twice a day. I had no shortage of places to take her. I certainly never thought there was a need for a fenced dog park in the area. I think Halswell has more urgent priorities.
79	We support this worthy priority. 2. With the advent of the Eastmans Wetland retention basins, there will soon be a whole ecosystem of wildlife finding habitat to live in and breed in this region. It is likely that at-risk species of birds will be amongst this group. It will be vital that dogs are strictly "on leash only", if allowed at all, in this wetland. 3. As a means of curtailing the motivation of dog-owners to allow their pets to run free off-leash in the wetlands, the importance of providing an accessible, suitably sized, well-fenced and interesting dog-exercise area cannot be under-estimated.
80	<p>We think the "measure of success" of "inclusion in the 2024-34 LTP process" is too timid. The need is right now, and we have done the consultation for you. We recently ran a survey on the need for a fenced dog park in Halswell.</p> <p>With over 570 respondents, the survey found:</p> <ol style="list-style-type: none"> <li>1. Uncontrolled dogs are a problem around Halswell (agree 57%)</li> <li>2. There is not enough enforcement of dog control requirements in parks &amp; greenspace around Halswell (agree 53%; neutral 25%; disagree 21%)</li> <li>3. There is a need for a fenced Halswell dog park (agree 72%; disagree 19%)</li> <li>4. A dog park should have separate areas for large &amp; small dogs (agree 73%)</li> <li>5. Access should be prior booking (disagree 79%)</li> <li>6. If a fenced dog park goes ahead, present unfenced dog area at Halswell Quarry should be on-leash only (agree 39%, disagree 48%). <ol style="list-style-type: none"> <li>ii. As noted above, City Council has collected (and continues to collect) a large amount of money from subdivision developers for community facilities, then is spending the money elsewhere. A fenced dog park for Halswell would be a quick and easy spend for some of this money.</li> <li>iii. The measure of success needs to be amended from "Funding for a fenced dog park being included in the LTP 2024-34" to "Funding for a fenced dog park being included in the first two years of the LTP 2024-34". <ol style="list-style-type: none"> <li>b. There is no need to "ask council staff to investigate appropriate sites".</li> <li>i. We will tell you right now that there is a site in Carrs Road, where the greyhound track was formerly located. This site is already used informally by dog owners. Save money on the "investigation" and book in Carrs Road.</li> <li>ii. Furthermore, City Council chose to sell other land it owns around Halswell, thereby constraining its choice. There is not actually that much to investigate.</li> <li>c. It is really important for Community Board to understand that this is more than a facility for Halswell dog owners. i. Running the survey on the need</li> </ol> </li> </ol> </li> </ol>

7

 for a fenced dog park in Halswell, an immediate piece of feedback was why we restricted our interest to dog owners living in Halswell. This particular person drives to Halswell 5-8 times a week, to exercise her dog at Halswell Quarry.

*Halswell: Advocate for safe, accessible pedestrian connections to significant community destinations in the Halswell Ward.*

Why this matters:

Halswell is a rapidly developing part of the city, as various sub-divisions have taken shape, a number of footpaths that abruptly end have been installed by developers. While there is a long-term plan to join these footpaths into the wider network, there are a number of sites where connections are required for safe and accessible pedestrian connections, along with safe crossing facilities (particularly around schools), to significant community destinations in the Halswell Ward.

What the board will do:

- Identify locations where safe and accessible pedestrian connections are required.
- Advocate for safe and accessible pedestrian connections to be installed.
- Advocate for funding to complete safe and accessible pedestrian connections, along with safe crossing facilities (particularly around schools), to significant community destinations in the Halswell Ward.

We will measure our success by:

- Funding for safe and accessible pedestrian connections, along with safe crossing facilities (particularly around schools), to significant community destinations in the Halswell Ward secured in the LTP 2024-34
- Installation of footpaths.

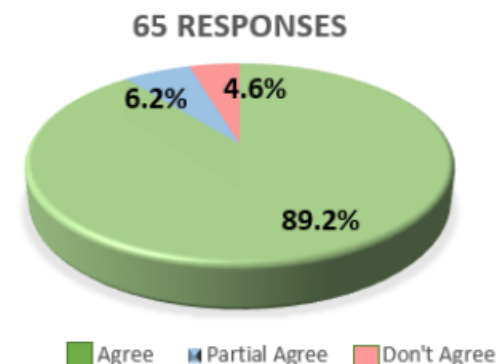



Comments

1	Yes this is a good idea, but for cycling also please
2	This is critical and needs to be a high priority and try to complete it more quickly. Would be good if lessons can be learnt for future developments too, make sure footpaths and safe crossings are always built.
4	Well done excellent priority - question why not number one
6	Fully support this. The number of major roads dissecting the community make accessing places difficult for anyone in the community who is not so independent or mobile - particularly young people and our older folk
7	A definite need, one minute you are walking on a safe footpath, next minute you are just on dirt/grass walking on the side of the road. I feel very unsafe walking my two little grandsons to preschool and the park etc. When a developer, develops land they should be expected to install a new footpath outside there subdivision and connect it to the next available one.
9	I support this one too.
11	Agree, but developers should also be held accountable. In my area its taken at least 7 years for footpaths to be completed.
12	Very much my top priority. Cycle commuting (as well) from Halswell is important to me - I commute (when it's not raining) approximately 8km to work by bike, and I notice that where there are good connections (pedestrian and cycle), people really use them. This would be my top priority.
13	Completely support this. - Dunbars Rd needs dedicated shared use of footpath between Dunbars overbridge & Halswell Rd as it is unsafe to cycle on the road along here due to lack of space - Halswell Rd from Aidanfield Rd to Dunbars Rd needs an actual footpath for pedestrians. As people are using this but are having to either walk on road or thru grass. - Sparks Rd from end of seperated existing cycle/pedestrian thru to Halswell Road needs a footpath. - Dunbars Rd needs safe access for pedestrians moving across as the roundabout at McMahon is an accident waiting to happen.
14	Item two safe crossing facilities I tried unsuccessfully to have this issue addressed some years ago regarding the bus stop opposite Aidanfield Drive and the retirement village. There is NO pavement and NO safety island like there is further down the main road towards the schools and shopping centre. This is a stretch of road where speed could be a problem for elderly or infirm crossing at this point, particularly in winter. Maybe you would have more luck than me, but I won't hold my breath !!
15	This is a really important priority. Halswell has all these new, small subdivisions that aren't connected by a footpath. Sutherlands Road is a good example; people have to walk on either the grass or in the road (which is 60kph) to walk from one subdivision or another or to school. This is very unsafe. In winter when the grass is muddy, people walk in the road which is dangerous. The speed limit on Sutherlands should be lowered too. Also, Sutherlands has no connecting footpath on Sparks to get to the shops. The council absolutely needs to make adding the missing

10

	infrastructure around Halswell a top priority. After all, all the new residents have paid CCC their development contributions and deserve some sort of minimum standard of basic infrastructure like at least one footpath.
16	This is more like it - would also support prioritising other types of accessibility in and around Halswell as well as with other parts of the city (and Lincoln and Prebbleton). Building on cycle connections. Bus connections into the area.
17	I support this priority - footpaths and safe crossings are very important. If possible, surely some would be possible to do in conjunction with improved cycleways as well
18	Yes this is a great idea, would also be good to see the cycleways linked up. Currently on sparks road where quarryman diverts to milns Park there is a 200m stretch with no lane, followed by a short stretch of cycle lane, then no lane again for a few hundred metres, then cycle lane again. Seems like developers only do the bit in front of their subdivision and no one thinks about the rest.
19	Whincops Road is incredibly dangerous and my primary school age children cross it to travel to and from school. Traffic calming measures are desperately needed in Longhurst. #1 priority for me and my whānau.
20	We have a running group in Halswell that currently has 199 members and at least 30 main runners. Our group would really appreciate safer crossing and running routes.
22	Why is it just footpaths? There are multiple places that subdivisions have occurred on roads with 6m pavements and then the section outside the subdivision is widened by the developed but the road on other side is still 6m. Sutherlands Road is a prime example of this. Let's make the neighbour safe and accessible for all.... not just pedestrians. Connecting from Muirhill Road to Quarryman's trial by foot or bike is a joke.
23	This has my support and would be my top priority for Halswell
24	Agree
26	Please can you put a turning arrow from Sparks road into Halswell Road as there have been so many near misses with cars turning left and not seeing pedestrians. A lot of children use this intersection and I personally was nearly hit last night crossing the road when I had the green man as a car didn't look before turning. This would make this intersection a lot safer.
27	This would be great.
29	I also think that this should be a main priority. Along Sparks Road particularly.
31	I support this priority.
32	Yes I think need to link up all the paths along sparks road the section between butcher and where the cycle path starts, there are lots of new foot paths going in with the new subdivisions but would be lovely if they all connected
33	Good idea to ensure all walkways are safe especially for our children to help teach road safety.
34	I have seen on so many occasions children having near misses near Oaklands school and the round about on Dunbar's. And we have only been living here 2 years. People speed and the crossings are dangerous

11

35	Great plan
36	This is very important. I walk around Halswell frequently, so definitely support this.
37	Absolutely essential. Footpaths are shocking in general and a Health and Safety hazard in specific locations
38	This is a good idea, but again, it will depend on what is planned and where it is planned and the cost
39	yes yes yes yes. safer road crossing access. more bike lanes and clearly marked There is an area on Halswell Junction Road , going SE, just past Oldham Terrace, where HJR curves and there is no safe lane for bicycles. And drivers cut into the small bike lane to negotiate their curve. It has helped that the speed limit has been reduced.
41	Hugely important considering that many young families are now in Halswell, and moving through the subdivisions/walking the neighborhood is tricky with busy roads and lack of footpaths.
42	Big fan of this one
43	So many footpaths to nowhere that need to be linked. Wigram Road is just one example. The cycleway should be on side and the pedestrian on the other. Also remove the cycle lanes on the road for the overpass as the footpath is already marked as such
44	Footpaths should be accessible and safe. Where is Sutherlands Road footpath to make it safe for all? Council has gone the water way walk however it's not safe to get to it. Why would you have the entry where it is when it's dangerous to get to?
45	I agree with this idea as Sparks Road is getting busier and busier and lacks footpaths in parts.
47	Support this
48	Love this
49	I would also like the extension of the quarryman's cycleway to Sutherlands road and even Halswell junction road included in this
50	Very important and needed- Halswell has become a very busy place and needs safe ways for pedestrians
51	Yes big priority for us, we can't easily get our preschool children to school and preschool without crossing sparks road or walking through the mud. Really appreciate this being a focus and getting some resolutions fast
52	Every morning I push my two kids in a double stroller to Halswell Quarry Preschool along Sparks road from Shorthorn lane. There is ~50m of unpaved soil that turns to a mud bath in wet weather that needs gum boots to navigate (and completely clogs up the stroller from functioning well). From April through to October it becomes particularly dangerous for pedestrians, from road traffic, during the morning and afternoon commute times. This is due to poor light and visibility, wet weather, high winds and Sparks road being a main arterial route. The current crossing between shorthorn lane and Macarthey Ave is not big enough to safely accommodate a double stroller as it is the length of the steel barrier when you're in the middle of the busy road. When it's 7:30am in the middle of a wet winter, it's too risky to be trying to cross sparks road without a set of lights - especially with a double stroller and a couple of kids <3yrs old. Certainly a nerve wracking time as a parent. There needs to be paved footpaths the entire way.

53	As a mum, it can be very challenging carrying out several right turns out of Halswell. Often cars are traveling too fast and with increasingly busy roads due to growth this will only get worse. This also means pedestrians are becoming increasingly at risk and should be able to get to some of the great facilities without being at risk.
55	Absolutely, the intersection at Halswell Road and Halswell Junction (next to the vet/butcher) needs to be prioritised for pedestrians. The “give way” is dangerous, there is a large electrical box that obscures the view of both cars and pedestrians. Drivers swing around to turn left off Halswell Road heading towards Sparks, often they don’t indicate and so many children are crossing there to head down to Halswell school. Another ‘walking man’ or at the very least a zebra crossing here is needed.
56	The crossing at Halswell Rd and Sparks Rd is totally unsafe for so many kids going to school that way. In particular, the left turn into Sparks Rd from Halswell Rd is the most unsafe. There would be many simple solutions here (pedestrian crossing, better signage) or even better, a redesign of that intersection to allow safer foot/bike/scooter traffic. The outcome would be many more people being more active, more often, by choosing the route to Halswell School.
57	It's really important than we sort our sparks road and Halswell road intersection on the way to school. It's needs to be much safer for our kids
58	Well overdue
59	Yes but Shared bike and pedestrian wherever possible - the safe bike access in Halswell is still poor or is there then disappears like pedestrian paths.
60	Yes, this should be a priority, especially to encourage safe travel to schools. For example, Seven Oaks school currently has no footpaths to the entrance which is a hazard for the school children.
61	There is a need for the bike path to go down Henderson’s Rd to Cashmere Rd
62	Absolutely support this! Missing footpaths are all too common around Halswell. They worry about building houses and roads, and forget the rest!
63	Footpaths from Halswell Downs (Sutherlands Road), to the Halswell shops to complete that area. So many people are walking along the grass verge.
64	A safe cross zone from Scott Park onto Revell St when accessing Oaklands School needs urgent attention.
66	This should be a key priority. Council is taking additional rates from new housing developments but many are stranded in terms of connecting footpaths to other new or existing housing. Sutherlands Road, Cashmere Road and Milns Roads are all good examples of sections of footpaths that are stranded and not connected to other sections of footpaths
67	100% the developers need to ensure they are putting pedestrian connection plans in place with the council to connect facilities to their development sites. Sparks road is a clear and shocking example of this.
68	As a runner and a leader of a running group, it can often be difficult to find routes which have footpaths all the way. I also walk with my children a lot and some places it is just too unsafe to go as there is no path.
69	Not a priority
70	Super important, especially for people who are blind, elderly ect.



71	Safe and accessible pedestrian paths and crossing are essential for a thriving community. There is much development in our area and it is very important work is fully completed for our community.
73	Halswell School crossing seems dangerous. As parent helper on road patrol, the right turn from Larsen is still problematic, particularly when cars heading towards the city wave them through (they wouldn't know it's left hand turn only from that direction).
75	Sparks road is full of missing parts of footpath. I live near a newly laid dual path (shorthorn lane) that ends abruptly, providing no safe walking access from my home unless I cross the road., which also ends if heading east. I enjoy walking in my neighbourhood but as it gets darker at night I feel less safe to do so due to no safe footpaths and lighting to make walking an appealing form of exercise
76	Hugely important to keep our children safe
77	I am in full support of this priority. There are areas where footpaths end unexpectedly and the only option is to walk on the road. There is an urgent need to complete the pedestrian network and ensure safe crossing points especially around schools and other areas children go eg parks, community venues, shops.
80	<p>a. Nice priority, but lacks specifics. We live here and know our area, so let's go for some specifics:</p> <ul style="list-style-type: none"> <li>i. Crossing Halswell Junction Road is a nightmare, but separates people living to its south from important community facilities such as the supermarket, Te Hāpua, Halswell Pool etc and from bus stops.</li> <li>ii. Ensign Street is a rat-runner's paradise. It is too busy!</li> <li>iii. Crossing Dunbars Road to Oaklands School is hopeless. The lack of safe crossing forces caregivers to drive their children to school, making the problem worse.</li> <li>iv. Crossing Whincops Road to Knights Stream School feels unsafe. The planned installation of traffic-calming ramps and platforms does not address the issue of too much traffic, much of it from Selwyn District.</li> </ul> <p>b. The priority also accepts traffic levels as inevitable, without seeking to manage these and thereby do away with the need for band-aids such as pedestrian refuges etc.</p> <ul style="list-style-type: none"> <li>i. City Council uses Waka Kotahi One Network Framework Classification. It needs to put in place infrastructure (such as modal filters) that minimises outside through-traffic (eg, from Selwyn District) on local roads and puts it on minor arterial and arterial roads.</li> </ul> <p>Finally, City Council has watched this issue develop over many years and has done little. The time to act is now. Specific projects need to be in the 2024-2034 LTP, and Community Board will have failed its community if this is not done. Community Board will have failed its community if this is not done.</p>

*Halswell: Support initiatives that provide safe recreation spaces for youth, and opportunities for them to come together.*

Why this matters:

Halswell is a rapidly growing area where a range of new subdivisions have been built in the past few years and where more subdivisions are being built. Halswell has a number of Primary schools, but does not have a High School. There are no plans by the Ministry of Education to build a High School in Halswell. Young people are required to travel out of the ward to attend school, sometimes from Year 7 onwards, as such it is important for the Community Board to Support initiatives in Halswell that provide safe recreation spaces and opportunities for youth to come together.

What the board will do:

- Encourage, catalyse and support initiatives in Halswell that provide safe recreation spaces and opportunities for youth to come together.
- Partner with local organisations to support for youth activities in the area.
- Advocate for youth spaces and recreational spaces that can be enjoyed by young people.
- Advocate for things to do and places to go that provide positive engagement opportunities for youth.

We will measure our success by:

- The number of initiatives and activities for young people, supported, encourage or catalysed by the Board that promote positive values and healthy behaviours.

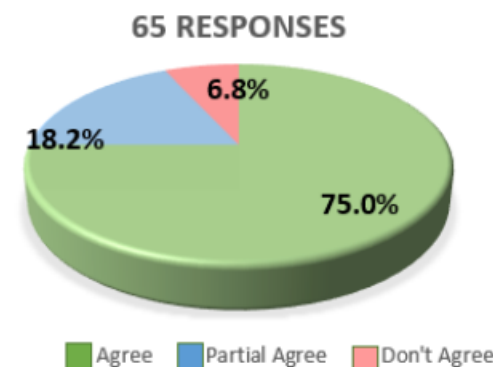

Comments

2	I support this.
4	Engaging the disengaged Youth is crucial to overcoming some of our current issues.
6	Fully support this initiative. Halswell Community Project have recognised the need for young people to develop a sense of belonging to the community they grew up in and are working towards having youth workers in every primary school. Many spaces in Halswell such as playgrounds are suitable for younger children rather than older children / youth.
7	Yes, use your weight to push for a high school to be built in Halswell.
10	Agree.
11	Agree
12	Seems reasonable. The healthy behaviours is a good thing!
13	Support this and creating activities/resources that keep young people busy and keep them out of trouble.
15	I agree with this priority.
16	Agree. Its really hard to get young people together in Halswell without a High School in the area - kids go to so many different schools.
17	I support this priority
18	No
19	Safe travel is more urgent in my opinion in the short term but this is really important longer term, to help reduce crime, increase rangatahi happiness, improve mental health and community cohesion. #3 but important.
20	We are raising our child in Halswell and it would be amazing to have access to youth services that are local when he is a teen
22	Look overseas and see what others are doing. Defining Youth would be helpful.
23	This needs to be part of a bigger Government response and I don't think Councils should have to bear the costs for this.
24	This is an essential component, there re limited places for our youth.
26	This is a great idea
27	This would be great!! I learnt in psychology courses that antisocial behaviours decrease when people have things they value in their lives. I would love to see value being added for youth to encourage pro social behaviour and recreation. Hopefully this decreases the amount of stolen cars that are frequently reported in the Halswell community Facebook group. Please consult with the youth on what they would like, and consider social safety eg for minority populations like LGBTQIA+ and non-white people.
28	Could a basketball hoop, or 2, be erected around the Domain playground area? It is a really great playground.
29	I think that any initiatives should be youth led, and that the board should only take a supportive role in these initiatives.
30	Public transport is heavily used by students commuting out to high schools and I think the provided school bus should be reviewed to see if it's meeting these commuter's needs.

16



	Te Hāpua: Halswell Centre, Upper Riccarton Library, and Hornby Library are key assets for meeting this priority. Tūranga has librarians specialising in youth engagement as well as a youth worker. Employing specialist staff like this could improve the libraries' ability to offer programming and services for youth and engage with schools and youth agencies.
33	Unsure if this will work but I like the idea.
34	A hub where they can play indoor games in a safe environment
35	Great plan
36	Completely agree as a Mum of five children aged 7-16.
37	A " nice to have "
38	this sounds like a good idea but I would like to know more details before agreeing to this
39	Let us hear some specific suggestions. The visibility of social media/FB pages do seem to indicate a degree of theft/crime. I wonder if some input from the police about actual vs. perceived amount of incidences .
41	Our children are the future and therefore need to feel welcome and safe within our community. This would be amazing for our teenagers in particular who often seek out somewhere they feel they belong.
45	Kids in sport, stay out of court. Busy young people engaging in recreation can only be positive for or community.
48	Love this but would need to know a lot more about the long term oversight of something like this
49	I'm not too sure how the community board could do this. Events in the domain in summer could be good but will be competing with other suburbs for events. Outdoor cinema? Needs more fleshing out about how this is actually implemented.
50	Very needed- crime has increased as those youths don't have a space to enjoy safely without being in trouble
57	We have an area which is going to be filled with teenagers soon and we don't have enough areas for them. It's important we think about spaces that suit this age group
59	Yes
62	Definitely support this! Especially if it means reducing the chance of Graffiti.
64	More basketball half courts, and outdoor fitness circuits in Halswell.
67	No High School in Halswell nor plans for this to happen in the next 10 years blows my mind. The MOE must not have enough information here, it just makes no sense. Halswell, Knightstream, Oakland's, and now one in the new condensed housing zone off Halswell road! But still no High School. If I'm to send my kids to a High School outside my residential area, It won't be Hillmorton.
68	Support
70	Another great idea.
71	YES!!! We need our Youth to be invested in the area and understand what living in a strong community means.
72	Halswell does already have adequate spaces and facilities for young people compared to Hornby.
73	Oh yes please!! Also something that encourages older generations and youth to work together on projects.... Both these groups could benefit from each other if done well

17

77	Yes I am in full support of this priority although it is a bit woolly. I would encourage the community board to identify 2-3 concrete initiatives to focus on and advance over this term.
80	<p>The measure of success “The number of initiatives and activities for young people, supported, encouraged or catalysed by the board that promote positive values and healthy behaviours” is evasive and ducks the issue.</p> <p>i. Let’s cut straight to the point here. City Council has consented a large number of houses in an arc from Country Palms through to Hendersons Road, and provided no community facilities – for young people or anyone else.</p> <p>ii. As noted above, City Council has collected (and continues to collect) a large amount of money from subdivision developers for community facilities, then is spending the money elsewhere.</p> <p>iii. Under-investment in on-the-ground facilities costs our people, both as individuals losing their way and as anti-social behaviour. The issues we see at Riccarton bus super-stop are a good example of this. Presently, City Council is content to let the volunteer and charitable sector deal with this issue. It needs to do more to own the problems it creates. Rather than “support initiatives” City Council therefore needs to build facilities. Here’s an idea: build a BMX track in in Ōtūmata Reserve close to Halswell Quarry Park. This would help out the people living in the new areas of Halswell.</p> <p>v. The “measure of success” needs to be amended to read: “Funding for youth facilities in Halswell being included in the first two years of the LTP 2024-34”. We have already identified a location to Community Board, in Ōtūmata Reserve close to Halswell Quarry Park.</p>

*Hornby: Advocate for the development and implementation of a Hornby Masterplan.*

Why this matters:

Hornby is a well-established and well-loved community where, over time, a range of developments have occurred independently of each other. With the development of the Mataiki Centre and the implementation of major cycle routes to connect the community, it is timely to develop a masterplan to ensure the community is well connected and that any future developments are well thought out.

What the board will do:

- Request that a master planning process is initiated for Hornby, starting with the area around at the Hornby Hub.
- Work with Planners and Developers to implement elements of the masterplan.
- Work with community partners to develop hubs of connectedness in Hornby.

We will measure our success by:

- The development of a masterplan
- Community involvement in the master planning process.
- Planners and Developers using the masterplan as a guiding document.

Comments

1	Yes this is a good idea. Hornby Hub is a car-riddled mess that is unpleasant to visit and some joined up thinking would be very valuable.
2	Seems a bit vague and not clear if there will be funding for implementing any elements of the master plan.
4	What a waste of time and money that will delay things getting done. We know the issues Hornby has, Hornby is well connected as per the vision workshops held with the groups - this seems to be totally ignored. Just get on GET DONE off the list rather than wasting doing a plan as the priority.

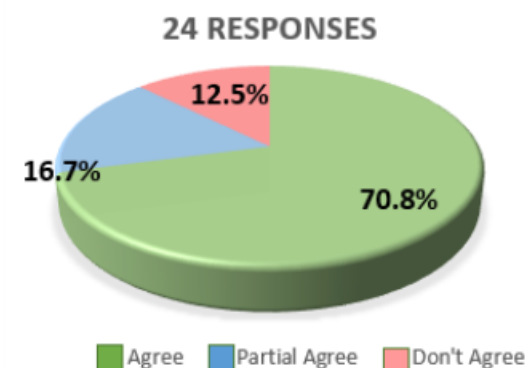

5	This location has S.H.1 dissecting the shopping centre along with Shands Rd to the motorway and a train track. Pedestrian safety should be a priority here, as it is lacking in accessibility both to cyclists and more importantly pedestrians. A cycleway / footpath could be built on the north side of Main Sth. Rd to the rail underbridge then through to Wigram and Nga Wai Puna Wai.
6	Totally support this - the growth and development of Halswell has shown what happens when developers are allowed to build without a master plan! A lack of planning leads to social isolation
8	Yes, Hornby has struggled to maintain an attractive profile and work here will help transport and people wanting to live and work there.
9	Please add light rail! We have the lines, let's use them.
10	This is great. There are too many divisions and some groups are doing the same thing although well intended.
11	Agree with an addition to implement this within the term or at least begin implementing it. This is not a new issue for Hornby and one that has been raised countless times over the years. Hornby is a main thoroughfare, extremely busy, and extremely dangerous. We are expanding in this particular area with businesses and retailers and there is no safe way for residents to access the full spread of what Hornby has to offer.
12	Hornby is a mish-mash-mess of things that aren't well connected. I think that this is a necessary thing to do, sooner rather than later!!!
16	Just as we were getting it right - another wishy washy priority. A masterplan - what will that do - just another talkfest about what could be done - not actually doing something. I would have thought that with the current state of the economy making sure that Hornby people have a decent standard of living would be up there priority wise if not top.
17	Excellent - as long as it is future oriented, rather than merely trying to fix existing problems. Needs to be future proofed as well - for increased population and development, and climate change (eg focus on cycleways and public transport).
22	Every ward should be provided with a Masterplan.
37	Long overdue
39	I don't know much about this. But I do think administrative and political agencies are going to HAVE to draw up, and define and have true and honest measurable outcomes for any grand ideas. We have all had too much words words words for policy, and seem to omit direct action.
43	Get another on / off ramp onto the motorway by Awatea Road
49	Masterplans are struggling to get funding. How will this be prioritised by council?
62	Agreed! As a semi-regular user of Hornbys facilities, a co-ordinated approach would be best.
68	Support
72	Yes I agree. This is urgent to make Hornby Hub area operate smoother and safer.
74	This initiative will be a positive move to regeneration of "Community". This will assist in addressing some of the root causes to the social issues that we are currently experiencing.
77	Yes I support a master plan process and in particular the involvement of the community. Get the community together prior to the master plan process started to share an idea then use this as the foundation to build the master plan.



*Hornby: Advocate for the revitalisation of greenspaces in the Hornby Ward including an increase in tree canopy*

Why this matters:

Urban trees are a key tool to help us meet the challenge of our climate and ecological emergency. They are central to enhancing our wellbeing and the pleasantness of our urban environment as well as providing a network of habitat for other wildlife.

Hornby is a ward with a low percentage of tree canopy (less than 5% in many areas) compared to other areas of the city. This is not equitable. With the city's urban forest not spread across all communities evenly, the benefits are not able to be shared by everyone to the same extent.

What the board will do:

- Advocate that Hornby be an area that is prioritised through the Urban Forest Plan.
- Advocate for Better off support funding to plant more trees and enhance biodiversity in Hornby.
- Work alongside community partners to encourage community initiatives to plant trees.
- Encourage Developers to plan developments around trees.

We will measure our success by:

- Increased tree canopy
- Number of trees planted

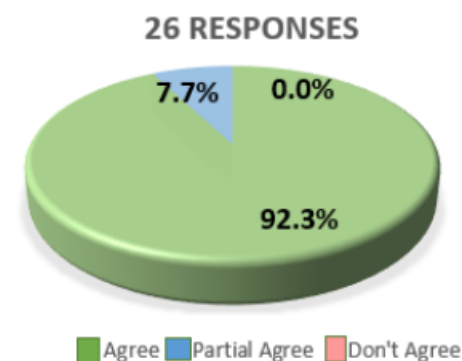

Comments

1	Yes I support this, and would like to see more street trees in particular making the area more pleasant to walk and cycle around during warm weather.
2	I strongly support this, getting more trees planted in this area is important.
3	Please consider focusing on native trees. And consider the location of the trees with respect to existing infrastructure, particularly with regards to water pipes as some trees can cause significant damage to these.
4	Would like to see this more detailed and that for one the Hornby Bush raised by the GHRA five years ok is something the board will do. Funding of groups to plant trees should look to have one established in Hornby working in with the schools we are currently seeing funding going to groups that are planting in areas with a high canopy involving private or single-sex schools only.
5	The Recreational Parks in the industrial zone such as Waterloo Rd / Halwyn Dr should be planted out with shrubs / trees as these would have a fairly good public safety factor after dark, with no reason to visit these locations in these hours, while providing an inviting spot for workers to enjoy their lunches.
6	Hornby definitely needs more trees and greenspaces
8	Agree, more trees are required
9	This should be top priority. I fully support this.
11	Agree. Hornby Ward has the lowest tree canopy in our city and CCC and developers are cutting down trees without fulfilling the duty to replace them. We need to ensure that as part of this plan we look to prioritise native species as there are many complaints from residents about certain species. This will also encourage our native birds/wildlife to return/flourish. Thoughts need also to be cast around how will the Council maintain these trees - or will they be forgotten about and frustrate residents in 20-50 years time and then residents need to fight for years to have the canopy reduced of specific trees (canopy reduction rather than 'topping' which is more extreme and has significant risks for the health of trees.
16	Don't disagree that keeping the greenspaces and increasing trees is important - but more important than improving the standard of living, of safety?
17	I support this priority
19	Super super important for health, mental health, cooling in a warming world and biodiversity.
22	Follow the tree plan.... why even consult.
27	I support this!! Especially considering that areas with trees are better off in hotter temperatures, and with climate change increasing, we need more trees. Please also consider the type of trees. Can we think about supporting food security by planting fruit producing trees (not just pollen trees because hayfever sucks bad enough as it is), or NZ native trees that used to grow in the area before deforestation. Natives are almost all evergreen too so that would be good to reduce leaves in drains.
30	Tree planting is essential for improving our environment and mitigating the effects of climate change.
33	Brilliant idea!! Should have been done sooner!

37	Should have been done 10 years ago
49	Great idea. There are some very sad tree-free pocket parks in the area.
60	This is a great idea. It would be great to have priority given to native tree varieties
61	We need more trees everywhere
62	Completely support this!!!
68	Support
72	Agree.
74	I support this as Hornby is currently "Barren" due to many industrial developments that have no trees nor the requirement to plant them.
77	I would like to see 25% canopy in Hornby. It is pretty shameful how little tree canopy there is and many missed opportunities. And where there is green space, it tends to be grass. I would like to see 1) the council acquiring extra land in Hornby for green space, 2) increased street trees, 3) increased planting in parks and reserves (especially natives), 4) the establishment of mini forests and 5) at least one larger bush block in the Hornby area. If we want to bring our native birds, insects and lizards back to Hornby we need habitat for them. I think some of the Awatea stormwater basins could be planted as wetlands - this would provide habitat for native fauna and hold more water. It is also possible to build in walking tracks so recreational access is maintained. Aside from Kyle, Denton and Warren Parks, there are hardly any parks, let alone places for native bush - the Council does needs to acquire more land for green space.
79	We generally support this worthy priority. We encourage the Community Board to prioritize the margins of Haytons Stream for planting, not only as a means of increasing the canopy cover in fulfillment of the Urban Forest Plan but as a means of focusing the attention of the residents and the business community on the health of this much maligned waterway which continues to show high levels of contamination. We suggest that the Community Board adds the following bullet-point to the list of "What the Board will do": "Encourage community initiatives to plant native vegetation to enhance the environmental values of Haytons Stream."

*Hornby: Support the transition of the Hornby Community Care Centre to full ownership by Hornby Community Care Trust.*

Why this matters:

With the existing Library in Hornby soon to move to a new space in the Matatiki Centre, there is an opportunity to collaborate and partner with a well-established community trust in Hornby and create a community space for local residents to enjoy and utilise for years to come.

Supporting the Hornby Community Care Trust to successfully transition into a larger space will build their capacity and capability to collaborate and partner with the Council to address some of the many complex social issues that face our city and to increase community connectedness and social capital in the Hornby area.

What the board will do:

- Support the Hornby Community Care Trust's request to Council for the gifting of ownership of the library in Goulding Avenue to the Trust.
- Advocate to the Council that the library building is gifted in a good, well maintained state.
- Support the Trust to engage the community in the transition process, including sharing information and updates on the progress of the transition to ensure that the new space is responsive to the needs of the community.
- Support the Trust with any strategic planning and needs assessment resourcing that can identify challenges and opportunities associated with the transition, as well as an assessment of the potential impact on the community.

We will measure our success by:

- Funding is secured that provides a successful transition.
- Ownership of the building is vested in the Trust.
- Additional partnerships are developed.

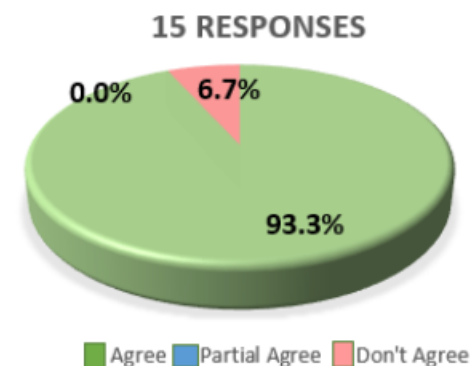



Comments

2	I support this.
4	Fully support but hope the Hornby Community Care Centre is left to operate as its own and without intervention from the City Council and can set its own direction
5	Very important as this building was allowed to fall into a poor state of repair under Council governance.
6	Halswell Community Project have recently taken ownership of the old library building as the Halswell Community Hub and fully support this for the Hornby Community Trust also
9	I fully support this also, it's an important space - needs to stay in community control.
10	Agree
11	Agree. Our community needs more safe spaces for local residents to enjoy that also offers relevant services. It is also important that should the Council gift this without cost, that the premises are gifted in a reasonable condition which would not financially disadvantage the Trust by having to make repairs.
16	Great idea. The Hornby Community Centre do great things for people in the community and giving more space is so important. This is more like it - he tangata, he tangata, he tangata.
23	Great Initiative. It has my support
49	Support
62	Nil. Too many Maori names.
68	Support
72	This has been the intention for many years and needs to happen now, in conjunction with the opening of the new Matatiki Hornby Centre.
74	Absolutely support this initiative as It will provide a facility that has both the space and location to enable use by a large number of community organisations.
77	Yes I support this priority, we need more community spaces like this and I would like to see it available for other community groups to use too.

*Riccarton: Advocate for liveable neighbourhoods in the Riccarton Ward.*

**Why this matters:**

The Riccarton ward is made up of a range of different neighbourhoods many of which are juxtaposed. There are neighbourhoods of the well-established and historic as well as the newly intensified; there is a contrast of top end real estate and affordable rental accommodation – as well as everything in between.

As such, Riccarton faces a variety of challenges regarding housing in the area. Anecdotal evidence and census data shows that a large number of houses are of low quality, while intensification brings the challenge of more people using the existing social infrastructure, additional parking on streets and the change to the character of the area.

The Board accept that all areas change over time and therefore will proactively advocate for these changes to be positive and lead to liveable neighbourhoods.

**What the board will do:**

- Advocate for and assist Riccarton residents to participate effectively with the district plan and proposed changes to intensification.
- Support initiatives that improve living standards in rental accommodation, particularly for student and migrant populations
- Seek to investigate parking management options that can address parking congestion on the streets.

**We will measure our success by:**

- # of initiatives underway that improve living standards in rental accommodation and neighbourhoods, particularly for student and migrant populations
- The percentage of Riccarton residents who feel supported by the Board in their advocacy attempts around the District Plan.
- Parking congestion around the area is addressed.

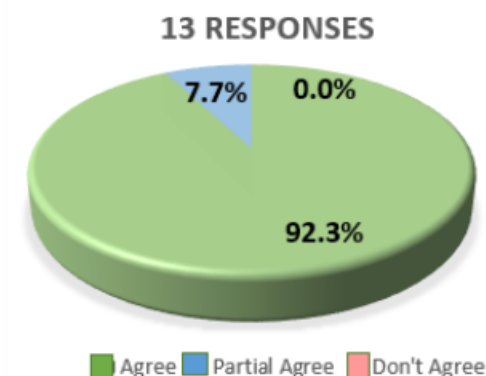

Comments

1	The best way to address parking congestion is through improving public and active transport options. In particular, ensuring that public transport is reliable and frequent. The proposed turn-up-and-go service would help make a substantial difference here.
2	I disagree with the way the community board has approached the Draft Housing and Business Choice Plan Change. I live in Riccarton ward in a house which should have been much more affordable and I strongly support PC14 except some of the qualifying matters. I do not support the Riccarton Bush interface QM because I think that area is perfectly located for more homes to be built there. It is close to Riccarton centre and the public transport on Riccarton Road. I think the community board is only focusing on the people who already own houses rather than the younger people who want the option of affordable homes in Riccarton. We need to embrace being one of biggest town centres in Christchurch and the housing density that will come with that, not become a centre of nimbys.
4	Riccarton is unique and you have nailed it with this priority. Well done to the elected members from this area
6	Fully Support this
7	Looks like you have this sorted/covered
8	Reducing car use is the only real way of addressing this. Covered cycle ways would ideally help but these are not realistic at present so cheap public transport, subsidised electric bike purchases, etc. might help?
10	I used to live in this ward, in a rental. Some of the places for rent are unhealthy, dingy and unsafe.
16	Agree with this. Improving living standards - all about people. Don't totally agree with all of the intensification concerns - but understand them. Liveability should also be conditions of the streets, tidiness, cutting down on furniture dumping and instilling a sense of ownership so people care.
27	Students struggle a lot financially and with wellbeing, as the recent enquire into student wellbeing shows. We shouldn't have to resort to low quality homes which are not supportive of health, to get by financially. I support increased living standards for students, and migrants.
30	Riccarton has a large low-income community who are vulnerable to being exploited. Education and support is key to ensuring they know their housing rights. Streets also need to be safer - and slower. Main South Road is a secondary access point for 4 schools and has several rest homes and preschools along it.
49	Riccarton needs intensification. Great public transport and retail options close by.
77	I do support the intention of this priority to create liveable neighbourhoods. I support opportunities for residents to participate in the democratic process and to support the living standards in rental accommodation. And I acknowledge that parking congestion is a concern for many and I know myself how difficult to find a park anywhere near the university. But I would hate to see the community board just focus on parking management. Instead, I would like to see a focus on engaging with local community groups and schools and working towards a variety of options so that people can walk, bus, bike, scooter and so forth - can you reword this objective to be more positive and more holistic. We also need to deal with the harsh reality that our transport emissions need to halve by 2030. We all need to reduce our driving there is no getting around that. How can the community board help make this happen?

*Riccarton: Support initiatives that provide for social cohesion, community connectedness and safety in the Riccarton Ward.*

Why this matters:

Riccarton is a multi-cultural community with both a well-established and a transient population. The Board will look to initiate, collaborate and partner with other agencies in providing initiatives that provide for social cohesion, community connectedness and safety in the Riccarton ward.

What the board will do:

- Support community-led initiatives that promote social cohesion, community connectedness, and safety.
- Foster partnerships and collaborations between community-based organizations, government agencies, and businesses.
- Encourage civic engagement by promoting opportunities for community members to participate local decision-making.

We will measure our success by:

- Number of programmes supported
- Increase in Riccarton residents who report a sense of safety and connectedness.
- Number of participation opportunities in annual plan, board forums and submissions to Council consultation

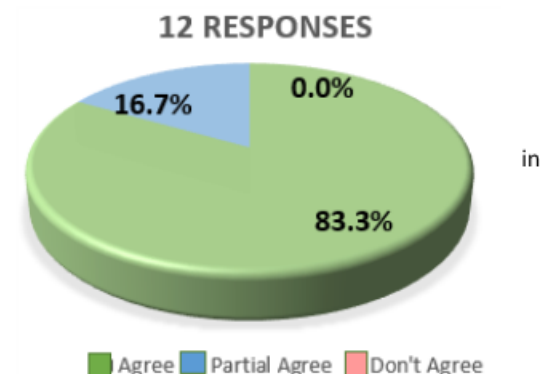



Comments

2	This is a bit vague, I would like more specifics but generally support this.
4	Feeling safe is a factor for all residents and well done to Riccarton for making this a priority
6	Connectedness is the key to social cohesion in any community so fully support this
7	Thanks for backing what is already operating well and encouraging us to expand into what the community needs
8	This one seems difficult to quantify and harder to measure. I think having some tighter measures might help but one incident, even if realtively rare, can having people feel "unsafe" even though they are really no less safe than before.
10	Agree
16	Great priority. All about people. Making sure that the migrant communities feel part of the area they live in - good to see this. Having hubs where people feel they can go - not just physical buildings but also spaces - not enough park spaces for people to 'bump' into others. Need more like Harrington Park, Picton Reserve, Middleton Park. Mona Vale, Hagley Park and Riccarton Bush are sometimes too far for young families to go to if they don't have a car. Too many busy streets to try and cross.
27	This sounds good. I think connection and contact with people who at first glance seem different to oneself helps to decrease racism (provided minority populations are supported and feel safe in the interactions).
30	Upper Riccarton Library should be more utilised as a location by Council to deliver events that connect the community.
49	Good.
72	Grow Neighbourhood Support Groups.
77	I support this priority but again it is a bit woolly. I would like to see the community board proactively identify some specific initiatives to achieve this, in conjunction with the community, and work towards making them happen.

*Riccarton: Support initiatives that provide things to do, places to go for youth in the Riccarton ward.*

Why this matters:

Providing safe recreation spaces and activities for young people is essential for promoting physical and mental health, fostering social connections, providing positive outlets for energy and creativity, reducing anti-social behaviour, and investing in the future of the community.

What the board will do:

- Collaborate with local organisations that work with young people to investigate options for positive youth spaces and places in the Riccarton area - including the creation of safe recreation spaces for youth to come together.
- Support initiatives that provide for positive youth activities
- Support the development of existing public spaces that will provide outlets for young people be safe in with a sense of belonging.

We will measure our success by:

- The number of youth initiatives supported
- The creation of youth spaces that provide things to do and places to go,

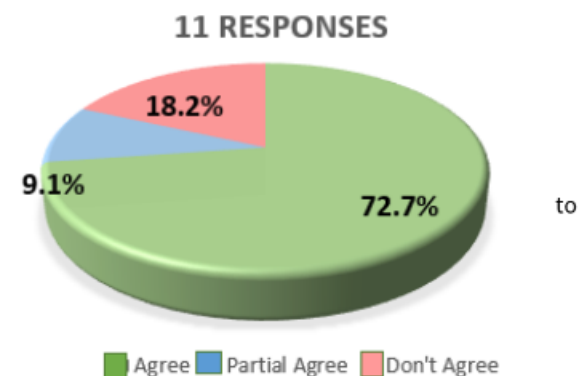

Comments

2	Greater maintenance on things like basketball courts/cricket nets in parks would be good for this.
4	This like what Halswell is proposing should be a priority across all the wards in this Community Board. It is a crucial priority and disappointing to see Hornby have no priority for the youth.
6	A cohesive approach is vital to help young people connect with each other and the resources in their community so fully support this Working closely with Wharenui Sports Centre
7	Great priority
8	How much youth are actually resident there in Riccarton, seems mostly students, young, mobile workers and middle-class, older residents in the more affluent parts? I suspect any youth problem comes from those travelling from other areas around the city.
10	Agree
16	This should be the top priority for Riccarton. When the bus lounge and the mall are the only places for young people to go and do anything - then there's no wonder there are the issues that we see there. Why not get young people in the area to design spaces and programmes?
27	Very good!! Please consult with the youth on what they would like, and consider social safety eg for minority populations like LGBTQIA+ and non-white people.
30	Upper Riccarton Library requires venue space, budget, and staffing to support youth activities. Matatiki Hornby Centre and Te Hāpua will have/has a makerspace and it would be awesome if Upper Riccarton had one too.
49	There is a huge amount for youth to do in Riccarton. This is where most youth travel to spend time! Would be better to see a stronger focus on non car modes to ease congestion and parking issues.
77	Yes I support this priority but similar to the Halswell comments, would like to see something more concrete. The board needs to report back via the newsletter and minutes on progress and the identification of some concrete initiatives they have identified to support.

*Other Feedback/Suggestions:*

1	This all looks great!
4	All the very best for the next three years, love the Riccarton and Halswell priorities but question the main one for Hornby and would like to have seen more people and well-being focus as one of its priorities - community is about people.
7	Thanks for all you do to make our community better and more inclusive and connected
10	Halswell: Don't forget the one side of Hendersons Rd. We are the forgotten street it seems. The increased population has caused increased traffic, and less green spaces/walkways. There should be more traffic lights at intersections such as Halswell Rd and Hendersons Rd, and also a pathway on the other end of Hendersons Rd towards Sparks Rd. Instead, cars are parked on the grassy area. The school zones are confusing and unfair for some parents (why are we suddenly Hillmorton/Rowley and why can't we go to Hoon Hay School or Wigram or Halswell for example?) We are sometimes Hoon Hay, sometimes Halswell, but we vote for Halswell and not Spreydon so maybe it should officially change?
12	Great set of things to aspire to.
13	Would like to see speed reduction measures put in place in Cassinia Gardens. The street has become much busier with the completion of infill housing in Aidenfield. With the previous removal of Stallion Ave access, Cassinia traffic has drastically increased. Large number of cars turn off Dunbars Rd at speed and accelerate thru what is a chicane for a short distance to Burbank Drive creating a hazard.
16	A reminder - He tangata, he tangata, he tangata. Keep this at the forefront - making sure that people have a decent standard of living, are safe, able to connect with others and feel that they belong. See this in the Riccarton ones - but less in the Halswell and Hornby ones.
17	It would be great to also see a focus on public transport - I'm aware this isn't necessarily in your remit, but whatever can be done from this level should be. Even where there are useful bus routes, they are infrequent and unreliable, making it very hard to get around, and discouraging people from being able to rely on public transport. This should, for instance, be a part of the Hornby master plan
22	Why are three totally different wards be consulted / feedback together?



30	Disclosure - I work for libraries (previously as a Youth Librarian) and I would love to have the support and funding of council to improve our services to youth and community.
48	Youth spaces and pedestrian crossings etc are most important to our family
54	Please continue to increase safety around neighbourhood. I have no kids and no pets so I only want my house safe and secure and no break ins please
77	<p>I think the community board plan is just not ambitious enough.</p> <p>1) where is the action on climate change? how will the community board support our communities to halve our emissions by 2030. It is going to be really tough and the community board has an important role as both a leader and advocate for the community. For instance, can the community board lead a project working with local schools on lowering transport emissions?</p> <p>2) aside from advocating for more greenspace and more trees in Hornby, where is the action on increasing biodiversity? We need wetlands and bush areas not just single trees. Fantails are now back in Hornby but we have no hope of getting bellbirds and kererū without restoring habitat. It takes 5+ years to restore a wetland and 30+ years to restore a forest. We need to get cracking - don't let this term pass you by. We saw some flooding around the Runway last year despite the stormwater basins. Look for opportunities to improve resilience and biodiversity at the same time.</p> <p>3) there are major gaps in the bike network on this side of town. I try to bike short journeys but often it's just not safe. For example, I needed to travel from Wigram to Hei Hei recently and I ended up taking the car because I could not identify a safe bike route. I would like to see the Community Board take an active role in advocating for safe bike routes between main community destinations. People should be able to get from A to B without being scared to death a car will take them out. Focus on the schools first then the wider community. I see Amyes Road junction is on the CCC annual plan for feedback, yes this is a very dangerous intersection for everyone. Cars, pedestrians and bikes. It needs urgent improvement.</p>
78	<p>The Summit Road Society is a grassroots conservation charity based in Christchurch. The Society was formed in 1948 to further the vision of Harry Ell to preserve and protect the Port Hills and provide for public access. We own and manage four reserves on the Port Hills and also lead the backyard and community project 'Predator Free Port Hills'. We have had a long and close relationship with the Christchurch City Council, in particular with the Port Hills Ranger Service.</p> <p>We have focused on the Halswell ward for this submission, given the Summit Road Society's mandate is the Port Hills. We note that the priorities for the Halswell Ward include the establishment of a fenced dog area, safe pedestrian routes and youth recreation spaces. We would like to see this expanded to include the following priorities:</p> <ul style="list-style-type: none"> <li>• the biodiversity of the Port Hills is maintained and enhanced</li> <li>• recreational access to the Port Hills is supported and promoted.</li> </ul>

	<ul style="list-style-type: none"> <li>• green spaces improve individual and community wellbeing.</li> </ul> <p>This would provide clear support for efforts to restore native bush and wetlands for example in Halswell Quarry and along the Cashmere Stream, and for predator control initiatives such as Predator Free Port Hills and trapping in reserves.</p> <p>The Society launched Predator Free Port Hills in November 2016 and we now have 1500 households trapping on the Port Hills. In addition to the biodiversity benefits, we are seeing a number of benefits for communities. Our programme relies on local connections, neighbours talking to neighbours. The public are excited and enthused about the notion of taking personal action to bring back our native birds, lizards and invertebrates.</p> <p>As a result of this enthusiasm, Predator Free Halswell have established trapping lines at Halswell Quarry and other local sites in conjunction with Christchurch City Council. Being outside in nature and participating in efforts to restore it is good for people and it is good for the community. Zealandia's Centre for People and Nature in Wellington conducted a survey of 1200 Wellington city residents. They found that levels of depression, anxiety and stress are lower in people who spent more time in natural spaces. They found even greater benefits amongst people who take part in predator trapping. This group had lower levels of depression and stress, and greater feelings of social cohesion. We also want to highlight two important initiatives.</p> <ol style="list-style-type: none"> <li>1. Pest Free Banks Peninsula. The Summit Road Society is a partner in this programme alongside the Council and several others. It is an ambitious and aspirational programme that aims to eradicate pests and predators from the Peninsula and the Port Hills by 2050.</li> <li>2. Te Kākahu Kahukura, a landscape-scale restoration project on the Southern Port Hills to restore and connect 1000ha of native bush.</li> </ol> <p>As a grassroots organisation, we know that the winds of change are here. Halswell and Kennedys will be important suburbs in both initiatives, both in terms of engaging the urban population and providing a buffer zone to the wider Peninsula. We would welcome the support of the Community Board in making this happen.</p>
79	<p>Thank you for the opportunity to make a submission on the 2023 Plan for the Waipuna Halswell-Hornby-Riccarton Community Board.</p> <p>The Ōpāwaho Heathcote River Network recognises the important and developing role that the Community Boards play in helping residents to inform and participate meaningfully in local government decision-making. We wish to assist the Community Boards in the Ōpāwaho Heathcote River catchment to develop the level of participatory democracy experienced by residents, and to help residents feel empowered to be part of their communities. The Ōpāwaho Heathcote River, including many of its tributaries, has some of the poorest water quality in the city of Christchurch. At the same time, the river has been designated a Site of Ecological Significance in the City Plan.</p>
80	<p>Broadly speaking, we support these priorities. However, it is important to note:</p> <ul style="list-style-type: none"> <li>• There are lots of people living in Halswell, and more arriving all the time. We think that both Community Board and City Council forget this. City Council has collected (and continues to collect) a large amount of money from subdivision developers for community facilities, then is spending the money elsewhere. A good example is the aquatic centre in Hornby, which is too far away and too hard to get to for people living in</li> </ul>

	Halswell. The priorities are well founded but their proposed execution is too timid
--	--



## 9. Halswell-Hornby-Riccarton 2022-23 Discretionary Response Fund Applications - Otautahi Eritrean Association Incorporated and Hornby Community Patrols Inc

Reference / Te Tohutoro: 23/554582

Report of / Te Pou Marie Byrne, Community Development Adviser  
Matua: (marie.byrne@ccc.govt.nz)

General Manager / Mary Richardson, General Manager Citizens & Community  
Pouwhakarae: (Mary.Richardson@ccc.govt.nz)

### 1. Purpose of Report Te Pūtake Pūrongo

- 1.1 The purpose of this report is for the Waipuna Halswell-Hornby-Riccarton Community Board to consider an application for funding from its 2022/23 Discretionary Response Fund from the organisations listed below.

Funding Request Number	Organisation	Project Name	Amount Requested	Amount Recommended
00065472	Otautahi Eritrean Association Incorporated	Eritrea Independence Day Celebration	\$2,000	\$2,000
00065512	Hornby Community Patrols Inc	Patrol Gazebo	\$3,505	\$3,505

- 1.2 There is currently a balance of \$47,538 remaining in the fund.

### 2. Staff Recommendations / Ngā Tūtohu

That the Waipuna Halswell-Hornby-Riccarton Community Board:

- Approves a grant of \$2,000 from its 2022-23 Discretionary Response Fund to Otautahi Eritrean Association Incorporated towards the Eritrean Independence Day Celebration.
- Approves a grant of \$3,505 from its 2022-23 Discretionary Response Fund to Hornby Community Patrols Inc towards the Patrol Gazebo project.

### 3. Key Points Ngā Take Matua

#### Strategic Alignment Te Rautaki Tīaroaro

- 3.1 The recommendation is strongly aligned to the Strategic Framework and in particular the strategic priority of enabling active connected communities to own their future. It will provide a strong sense of community and belonging as well as safe and healthy communities.

#### Decision Making Authority Te Mana Whakatau

- 3.2 The Community Board has the delegated authority to determine the allocation of the Discretionary Response Fund for each community
- 3.2.1 Allocations must be consistent with any policies, standards or criteria adopted by the Council
  - 3.2.2 The Fund does not cover:



- Legal challenges or Environment Court challenges against the Council, Council Controlled organisations or Community Board decisions
- Projects or initiatives that change the scope of a Council project or that will lead to ongoing operational costs to the Council (though Community Boards can recommend to the Council that it consider a grant for this purpose).

### Assessment of Significance and Engagement Te Aromatawai Whakahirahira

- 3.3 The decisions in this report are of low significance in relation to the Christchurch City Council's Significance and Engagement Policy.
- 3.4 The level of significance was determined by the number of people affected and/or with an interest.
- 3.5 Due to the assessment of low significance, no further community engagement and consultation is required.

### Discussion Kōrerorero

- 3.6 At the time of writing, the balance of the 2022-23 Discretionary Response Fund is as below.

Total Budget 2022/23	Granted To Date	Available for allocation	Balance If Staff Recommendation adopted
\$242,693	\$195,155	\$47,538	\$42,033

- 3.7 Based on the current Discretionary Response Fund criteria, the applications listed above are eligible for funding.
- 3.8 The attached Decision Matrix provides detailed information for the applications. This includes organisational details, project details, financial information and a staff assessment.

### Attachments Ngā Tāpirihanga

No.	Title	Reference	Page
A 	Waipuna Halswell-Hornby-Riccarton Community Board 2022-23 Discretionary Response Fund Decision Matrix: Otautahi Eritrean Association and Hornby Community Patrol	23/606814	78

### Confirmation of Statutory Compliance Te Whakatūturutanga ā-Ture

Compliance with Statutory Decision-making Requirements (ss 76 - 81 Local Government Act 2002).

(a) This report contains:

- sufficient information about all reasonably practicable options identified and assessed in terms of their advantages and disadvantages; and
- adequate consideration of the views and preferences of affected and interested persons bearing in mind any proposed or previous community engagement.

(b) The information reflects the level of significance of the matters covered by the report, as determined in accordance with the Council's significance and engagement policy.

Signatories Ngā Kaiwaitohu

Authors	Bailey Peterson - Community Development Advisor Marie Byrne - Community Development Advisor Helen Miles - Community Recreation Advisor
Approved By	Matthew McLintock - Manager Community Governance Team

## 2022/23 DRF HALSWELL-HORNBY-RICCARTON DECISION MATRIX

### Priority Rating

One	Meets all eligibility criteria and contributes <b>significantly</b> to Funding Outcomes and Priorities. Highly recommended for funding.
Two	Meets all eligibility criteria and contributes to Funding Outcomes and Priorities. Recommended for funding.
Three	Meets all eligibility criteria and contributes to Funding Outcomes and Priorities but to a lesser extent than Priority 2 applications. Not recommended for funding.
Four	Meets all eligibility criteria and has minimum contribution to Funding Outcomes and Priorities / Insufficient information provided by applicant (in application and after request from Advisor) / Other funding sources more appropriate. Not recommended for funding.

00065472	Organisation Name	Name and Description	Total Cost	Contribution Sought Towards	Staff Recommendation	Priority
	Otautahi Eritrean Association Incorporated	<b>Eritrea Independence Day Celebration</b> Split HHR 50% / FWH 50% Otautahi Eritrean Association Incorporated is seeking funding towards holding an event to celebrate Eritrea's Independence Day. The event will take place on May 24, 2023, to commemorate Eritrea's Independence Day. This date is significant to Eritreans around the world, as it marks the day when Eritrea gained independence from Ethiopia in 1991.	\$ 5,620 <b>Requested</b> \$ 4,000 (71% requested)	Entertainment - \$1,000 Sound System & Photography - \$500 Equipment - \$1,500 Volunteer Event Expenses - \$1,000	<b>\$ 2,000</b> That the Waipuna Halswell-Hornby-Riccarton Community Board approves a grant of \$2,000 from its 2022-23 to the Otautahi Eritrean Community Incorporated towards the Eritrean Independence Day celebration.	<b>1</b>

<b>Organisation Details</b> Service Base: Council facility Legal Status: Incorporated Society Established: 1/08/2022 Target Groups: Community Development Annual Volunteer Hours: 200 Participants: 150  <b>Alignment with Council Strategies</b> <ul style="list-style-type: none"> <li>Strengthening Communities Together Strategy</li> <li>Multicultural Strategy</li> <li>Our Heritage - Our Taonga Strategy</li> </ul> <b>CCC Funding History</b> Nil	<b>Other Sources of Funding</b> Funds on hand <b>Staff Assessment</b> This project is recommended as a Priority One due to its strong alignment with both the Strengthening Communities Together Strategy pillars and the Multicultural Strategy. Otautahi Eritrean Association Incorporated (OEA) is made up of Eritrean refugees living in Christchurch. Many of these community are recent arrivals to the city having spent a number of years of their lives in refugee camps. The ability to celebrate Eritrea's Independence Day is an opportunity to connect with their cultural heritage and feel a sense of belonging in their new home. It is also a chance for them to share their culture with the wider community, and to demonstrate the positive contributions that refugees can make to society. OEA believes that this event will help to build confidence and resilience among their members, and provide them with a platform to celebrate their identity as Eritrean New Zealanders. The event will feature traditional Eritrean food, music, and dance performances and be held in one of Council's community facilities. Rationale for recommending a grant of \$2,000 from the Waipuna Halswell-Hornby-Riccarton Community Board's Discretionary Response Fund is that: <ul style="list-style-type: none"> <li>The project develops the strength of the Eritrean community to provide connections for their refugees and address issues of social exclusion through celebrating their heritage, aligning with the People Pillar in the Strengthening Communities Together Strategy.</li> <li>The project encourages Eritrean community members, as new New Zealanders to create and sustain a sense of local identity and belonging, aligning with the Place Pillar in the Strengthening Communities Together Strategy.</li> <li>The project aligns strongly with Goal 4 of the Multicultural Strategy, Otautahi, Christchurch is a city of cultural vibrancy, diversity, inclusion and connection, supporting and giving greater exposure to the cultural and linguistic diversity of the city.</li> <li>The project celebrates the social heritage of the Eritrean Community, connecting to Council's Heritage Strategy's kaupapa of weaving our stories together, making a stronger cultural 'rope' and showing respect for all cultures.</li> </ul> Waimaero Fendalton-Waimairi-Harewood Staff Recommendation: \$2,000
--	--

## 2022/23 DRF HALSWELL-HORNBY-RICCARTON DECISION MATRIX

### Priority Rating

One	Meets all eligibility criteria and contributes <b>significantly</b> to Funding Outcomes and Priorities. Highly recommended for funding.
Two	Meets all eligibility criteria and contributes to Funding Outcomes and Priorities. Recommended for funding.
Three	Meets all eligibility criteria and contributes to Funding Outcomes and Priorities but to a lesser extent than Priority 2 applications. Not recommended for funding.
Four	Meets all eligibility criteria and has minimum contribution to Funding Outcomes and Priorities / Insufficient information provided by applicant (in application and after request from Advisor) / Other funding sources more appropriate. Not recommended for funding.

00065512	<b>Organisation Name</b> Hornby Community Patrols Inc	<b>Name and Description</b> <b>PATROL GAZEBO</b> Hornby Community Patrol is seeking funding assistance towards the purchase of a gazebo that will be able to be used at the community events that the organisation supports.	<b>Total Cost</b> \$ 3,505 <b>Requested</b> \$ 3,505 (100% requested)	<b>Contribution Sought Towards</b> Equipment - \$3,505	<b>Staff Recommendation</b> <b>\$ 3,505</b> That the Waipuna Halswell-Hornby-Riccarton Community Board approve a grant of \$3,505 from its 2022-23 Discretionary Response Fund to Hornby Community Patrol towards the Patrol Gazebo Project	<b>Priority</b> <b>2</b>
----------	--	--	---	---	---	-----------------------------

<b>Organisation Details</b> Service Base: 7-9 Tower Street, Hornby Legal Status: Charitable Trust Established: 8/02/2008 Target Groups: Health & Wellbeing Annual Volunteer Hours: 3600 Participants: 50  <b>Alignment with Council Strategies</b> <ul style="list-style-type: none"> <li>Strengthening Communities Together Strategy</li> </ul> <b>CCC Funding History</b> 2021/22 - \$3,125 (Volunteer Recognition, Communications and Insurance) DRF 2020/21 - \$2,030 (Volunteer Recognition and Communications) DRF	<b>Other Sources of Funding</b>  <b>Staff Assessment</b> Hornby Community Patrol operates as "eyes and ears" for and with New Zealand Police and the community to create a safer community environment. While a core aspect of their work is undertaken through patrolling the streets of their catchment area, they also have a community engagement component at community events. The organisation's volunteers currently have no protection from the sun or rain when participating in or supporting community events. The gazebo will not only provide shelter at these events but also serve as a marketing tool for the recruitment of prospective new members. Recent events that the Patrol has supported was Hello Hornby and a local Hornby Christmas event. When supporting the events they provide forms of community service for the event. This has included operating a "lost child" site. One particular initiative that the Hornby Patrol operates is a secure number plate service. Patrol member can replace number plate screws with tamper proof screws that prevent the theft of number plates. This service is provided at a low cost that covers the price of the screws. This has proved popular at events and well-populated carparks. The Patrol are seeking funding for a robust gazebo which will stand up to more extreme weather conditions. It includes costs for screen printing and accompanying side walls. The rationale for recommending a grant of \$3,505 to Hornby Community Patrol from the 2022-23 Waipuna Halswell-Hornby-Riccarton Discretionary Response Fund towards the purchase of a patrol gazebo is that: <ul style="list-style-type: none"> <li>The project aligns with Council's Resilient City Community Outcome through addressing a strong sense of community as well as safe and healthy communities.</li> <li>The project aligns with the people, places and preparedness pillars of the Strengthening Communities Together Strategy.</li> <li>A gazebo will enable their presence at the events they attend to be significantly more visible which in turn will assist with attracting new members.</li> </ul>
---	---





## 10. Waipuna Halswell-Hornby-Riccarton Community Board Area Report - May 2023

Reference / Te Tohutoro: 23/559183

Report of / Te Pou  
Matua: Matthew McLintock, Manager Community Governance Team,  
mattthew.mclintock@ccc.govt.nz

General Manager /  
Pouwhakarae: Mary Richardson, General Manager Citizens & Community  
(Mary.Richardson@ccc.govt.nz)

### 1. Purpose of Report Te Pūtake Pūrongo

This report provides the Board with an overview on initiatives and issues current within the Community Board area.

### 2. Officer Recommendations Ngā Tūtohu

That the Waipuna Halswell-Hornby-Riccarton Community Board:

1. Receives the Waipuna Halswell-Hornby-Riccarton Community Board Area Report for May 2023.

### 3. Community Support, Governance and Partnership Activity

#### 3.1 Community Governance Projects

Activity	Detail	Timeline	Strategic Alignment
Springlands Reserve Trapping Project	Funding was allocated towards the Springlands Reserve Trapping Project from the 2022-23 Off the Ground Fund.	Completed	Te Haumoko Whitingia Strengthening Communities Together.

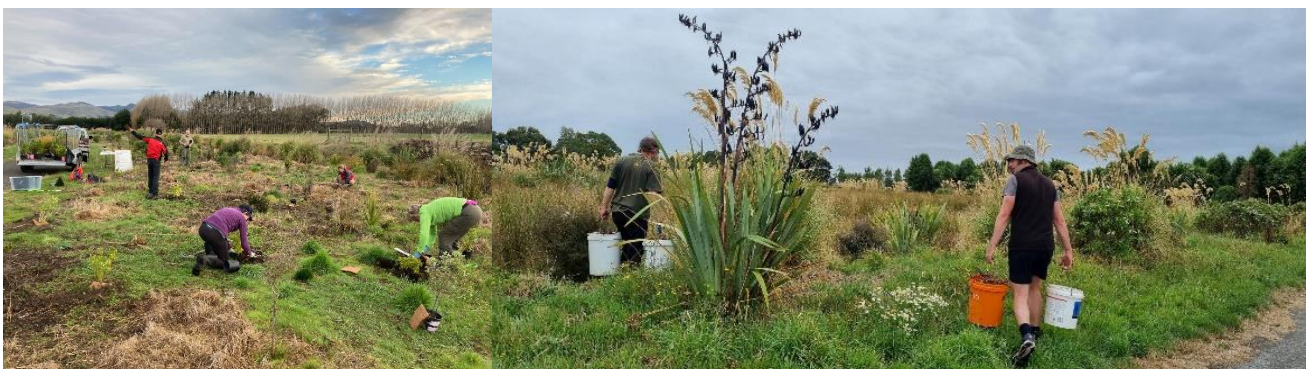

*"At Springlands/Quaifes Rd Reserve in Halswell we have a small but dedicated group of volunteers who meet up approximately every six weeks to do planting and maintenance work in the reserve. On top of this we have a small trapping project, with 20 traps set up. Since we set the traps up just over a year ago we have had over 250 catches, including several mustelids. We are really grateful for the*

*support from the Council's Off the Ground Fund to allow us to purchase bait and lures to ensure an ongoing supply for these traps. Without this the traps wouldn't be any use! We also used some of the money to purchase some components for the next lot of approximately 20 traps that we will be making up to expand the trapping network within the reserve. A big thankyou also to our fantastic community ranger Holly Whitaker who has been really supportive of this project." – Project Volunteer*

### ANZAC Day Services

Board members attended the following local ANZAC day services and laid commemorative wreaths on behalf of the Board:

- 20th Battalion Association Commemoration ANZAC Service, Jane Deans Close, Riccarton.
- Halswell ANZAC Service, Halswell Memorial site.
- Hornby ANZAC Service, War Memorial site in the grounds of Hornby Primary School.
- UCSA hosted ANZAC Service, University of Canterbury.
- Templeton RSA ANZAC Service, Templeton.
- Wigram ANZAC Service, Wigram Air Force Museum.



### Walking Festival

The Walking Festival was held from Saturday 8 April to Sunday 23 April 2023 supported by many volunteers, sponsors, and supporters who all contributed to the event's success.

The Festival featured some fantastic highlights, including new walks such as Discovering the Fairies at Bottle Lake Forest, Adventure Avenue Wander, and Te Ara Ihutai Wheelie Wander, as well as some old favourites like Gruffalo and If You're a Kiwi and You know it Storywalk.



The partnerships with over 30 groups and collaboration with the Libraries and the Parks team were vital in creating safe, fun-filled walks for all ages and abilities. The walks not only contributed to people's wellbeing but created great memories whilst highlighting the available spaces and places around Canterbury to walk and play for the community. A number of the Festival photos are on the [Facebook page](#).

Sponsors included Christchurch Adventure Park, Plains FM Radio, Selwyn District Council, Visit Waimakariri, Active Canterbury, Mountain Safety Council, and INaturalist. Their contributions helped make the Festival possible and were invaluable to its success.

### Wycla Hoops

On ANZAC Day afternoon, a highly successful basketball three on three competition event was organised by the Gaitors Basketball Club and supported by the Council community recreation team, the Youth & Cultural Development Trust, and Papuni Boxing Ōtautahi Trust. Eight teams competed in the competition for Rangatahi (youth) aged between Year 7 and Year 10, and it was open to both female, male and mixed teams.

The event had a great community feel, with parents supporting their rangatahi (youth) and helping with the smooth running of the event. In addition, the Youth Development Trust provided music and a barber, adding to the festive atmosphere.

The winning team was an all-girls team, showcasing their excellent skills and teamwork throughout the competition. The event was an overall success, promoting community engagement and showcasing the talents of young basketball players.



## 3.2 Community Funding Summary

3.2.1 For information, a summary is provided on the status of the Board's 2022-23 funding as at April 2023 (refer **Attachment A**).

3.2.2 **Youth Development Fund** – Under authority delegated by the Board the following allocations were made in April 2023:

- \$500 to Adele Dunning towards participating in the Irish Dancing Australian International Oireachtas in Sydney, Australia.
- \$500 to Zoe Dunning towards participating in the Irish Dancing Australian International Oireachtas in Sydney, Australia.
- \$400 to Cameron Jones towards attending Blake Inspire for Sailors programme in Auckland.

3.3 **Participation in and Contribution to Decision Making**

3.3.1 **Report back on other Activities contributing to Community Board Plan [for items not included in the above table but are included in Community Board Plan]**

- **Draft Community Board Plan**

Consultation for the Board's Draft Community Board Plan was open for feedback from 8 March 2023 to 26 March 2023. A total of 80 Submissions were received.

The Community Board Plan will be considered at the meeting on 11 May 2023.

3.3.2 **Council Engagement and Consultation.**

- **Draft Annual Plan 2023/24**

The Draft Annual Plan 2023/24 was open for feedback between 10 March 2023 and 10 April 2023. Pursuant to a delegation from the Board the Chairperson and Deputy Chairperson, in consultation with Board members, drafted and approved the attached submission (**see Attachment B**) that was lodged by the closing date.

- **Our proposed Housing and Business Choice Plan Change (PC14) and Our proposed Heritage Plan Change (PC13) consultation.**

Consultation on the Proposed Housing and Business Choice Plan Change (PC14) and Heritage Plan Change (PC13) closed on 3 May 2023.

The Proposed Housing and Business Choice Plan Change (PC14) Plan will bring the District Plan in line with the government direction that has been given via the National Policy Statement-Urban Development and the Resource Management (Enabling Housing Supply and Other Matters) Amendment Act to enable more development in the city's existing urban footprint.

The Heritage Plan Change (PC13) provides for eleven new residential heritage areas across the city identified for protection in the District Plan to recognise Ōtautahi Christchurch's special identity and about 60 buildings, items and building interiors to the Schedule of Significant Historic Heritage.

- **Start Work Notices** – Various Start Work Notices have been sent to the Board throughout the month. All city-wide start work notices can be found at: <https://ccc.govt.nz/transport/works>.

## 4. Advice Provided to the Community Board

4.1 **Traffic Safety Concerns in the vicinity of Villa Maria College, Upper Riccarton**

Following public forum presentations from staff and student representatives of Villa Maria College and a local resident at the Community Board meeting on 12 April 2022 the Board requested that staff engage with Villa Maria College, residents and the Ilam Upper Riccarton

Residents' Association and provide advice on traffic safety and parking on streets in the vicinity of Villa Maria College on Brodie Street, including but not limited to:

- a. The provision of a pedestrian crossing facility in the vicinity of 5-15 Brodie Street,
- b. A reduction of the speed limit on Brodie Street.
- c. A reduction of the speed limit on Peer Street.
- d. A review of parking restrictions and the demarcation of parking spaces on Brodie Street (parking ticks).
- e. Safe travel to and from Villa Maria College.

Staff subsequently met with school staff and student representatives on site and investigated the concerns of all road users and potential treatments to address these concerns and have provided the attached memorandum (**Attachment C**) in response to the Board's request.

The following improvements are to be implemented:

- The speed limit along Brodie Street is planned to be reduced to 30 kilometres per hour as part of improving safety around schools in the city.
- A variable 30 kilometres per hour speed limit during school hours is planned for the sections of Peer Street and Yaldhurst Road adjacent to Villa Maria College.
- The permanent speed limit outside school hours along Yaldhurst Road is also proposed to be dropped to 50 kilometres per hour (currently 60 kilometres per hour) through the Waka Kotahi Interim Speed Management Plan.
- At this stage, the new speed limits at these locations are programmed to be implemented in 2023/2024.
- Additional parking ticks have been arranged to be painted up to the existing speed hump (accessway of 60 Brodie Street) along the eastern side of Brodie Street.

In response to the concerns regarding parking on both sides of the road narrowing visibility and accessibility, staff advise that the Christchurch Suburban Parking Policy recommends restricting parking along one side of the road if the road width is seven metres or less. Brodie Street is over eight metres wide. Based on the exiting scenario and road geometry staff consider, no stopping restrictions are not currently warranted at this location and note removal of on street parking spaces could present a visually wide carriageway thereby increasing the chances of vehicles travelling at inappropriate speeds.

It is noted that as a consequence of boundary changes made as part of the representation review these streets are no longer within the Board area.

#### 4.2 **Parking at Aidanfield Drive/Donovan Place**

At its meeting on 28 June 2022, the Board requested staff investigate parking in the vicinity of the Aidanfield Drive and Donovan Place intersection and the first bend on Donovan Place, and provide advice on possible parking restrictions. Staff have provided the following response:

"Donovan Place is a quiet low volume low speed cul de sac. It has been visited on six occasions including morning, mid-morning, afternoon, late afternoon, and evening over various days. No traffic or parking issues were observed during these visits. No further action recommended at this point in time. Staff would be happy to revisit the situation if there was a significant change in traffic and parking demand, and regularly occurring issues."

#### 4.3 **Extension of no stopping lines - Corner of Hansons Lane and Arthur Street**



At its meeting on 12 July 2022, the Board requested staff to investigate parking in the vicinity of the Hansons Lane and Arthur Street intersection and provide advice on possible extension of the no stopping lines. Staff have investigated on site and provided the following response:

The extent of permanent no stopping lines at the intersection is adequate. During peak school times there is a part time no stopping restriction in place. The issue appears to be one of non-compliance, with vehicles choosing to stop in the part time no stopping restrictions. It appears to be that this non-compliance is causing the traffic issues, rather than a need for additional no stopping restrictions. This location has been a problem for many years and there are regular complaints to Parking Compliance. Staff will update the Board on the situation at the May briefing, where an alternative proposal will be presented for feedback.

#### 4.4 **Traffic congestion on Sparks and Hendersons Roads**

At its 6 September 2022 meeting the Board requested that that staff investigate traffic congestion on Hendersons and Sparks Roads at peak times and provide advice on measures that can be implemented to relieve the congestion. Staff have investigated on site during the morning peak time and have also previously used the intersection on a number of occasions and have provided the following response:

Google Maps traffic flow data has been checked and discussed with other staff. Current intersection phasing appears to be working well with the vast majority of vehicles on Hendersons Road (south) clearing through the intersection in one phase. Should issues develop regularly, staff can reassess the phasing of signals to see if this can assist.

#### 4.5 **Condition of the former Addington saleyards site**

At its meeting on 9 March 2023 the Board requested staff advice:

- On the overgrown condition of the former Addington saleyards site (25 Deans Avenue) and any measures that can be undertaken to address this.
- On the rubbish and other material that is apparently being dumped on the former Addington saleyards site (25 Deans Avenue) and the Riccarton Baptist (Church site 80 Rattray Street) and any measures that can be undertaken to address this.

Staff have advised that it is the responsibility of the property owner to manage security of property and removal of rubbish. Only if it becomes a health and safety issue will the Council get involved.

#### 4.6 **Matatiki: Hornby Centre Request for Proposal for cafe and Progress Update**

Attached is a memorandum from staff (**Attachment D**) advising that the request for proposal process for the café space at Matatiki: Hornby Centre is getting underway with public tenders being sought to lease and operate a café located in the heart of the Matatiki: Hornby Centre.

Tender proposals opened on Wednesday 3 May and will close midday Wednesday 14 June, 2023.

The library wing of the centre is almost enclosed, with the majority of cladding and windows now in place. All main superstructure elements in the pool hall have been installed and the roof system over this space is about to commence.

#### 4.7 **Hornby Community Patrol**

Hornby Community Patrol is a volunteer organisation operating as the “Eyes and Ears” of the community for the Police and citizens. The organisation patrols the areas of Sockburn,

Templeton, Prebbleton, Halswell, Broomfield, Hei Hei, Islington, Wigram, Park House and Hornby.

For the Board's information, below are the Hornby Community Patrol statistics for March 2023:

4.8





Vehicle related :	60	Special service:	82	Graffiti:	22
Com service hrs:	23	Property damage:	13	People related:	20
Number of 3ws:	108	Schools patrolled :	32	Property related:	39
No. patrol hours:	201	Km's:	1422	No. patrols:	29

#### Customer Service Requests/Hybris Report

For the Board's information, attached is a copy of the April 2023 Hybris Report (refer **Attachment E**).

The report provides an overview of the number of Customer Service Requests that have been received, including the types of requests being received and a breakdown of how they are being reported.

### Attachments Ngā Tāpirihanga

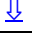
No.	Title	Reference	Page
A 	Waipuna Halswell-Hornby-Riccarton Community Board Funding Update - April 2023.pdf	23/616629	88
B 	Board submission - Draft Annual Plan 2023-24	23/617296	93
C 	Internal or External Memos Traffic Safety Concerns in the vicinity of Villa Maria College, Upper Riccarton 30 April 2023 Report	23/493769	97
D 	Internal or External Memos Matatiki: Hornby Centre RFP for cafe and progress update 31 May 2023 Report	23/658433	100
E 	Halswell-Hornby-Riccarton Hybris Report - April 2023	23/649615	102

### Signatories Ngā Kaiwaitohu

<b>Authors</b>	Helen Miles - Community Recreation Advisor Noela Letufuga - Support Officer Faye Collins - Community Board Advisor Bailey Peterson - Community Development Advisor Marie Byrne - Community Development Advisor
<b>Approved By</b>	Matthew McLintock - Manager Community Governance Team John Filsell - Head of Community Support and Partnerships

	Waipuna Halswell-Hornby-Riccarton Community Board Funding 2022-23		
2022-23	Discretionary Response Fund	Allocated	Funds Remaining
2/08/2022	2022-23 SCF Allocation	\$155,989	
17/08/2022	2021-22 DRF Carryover and other fund carry over	\$85,204	
10/01/2023	Return of 2022-23 YDF grant - Hornby High School	\$1,000	
23/02/2023	Return of 2022-23 YDF grant - Ocean Simard	\$500	
	<b>Total DRF Fund</b>	<b>\$242,693</b>	
2/08/2022	Board Project - Culture Galore 2023	\$12,000	
2/08/2022	Allocation to 2022-23 Swimming Accessibility and Activation Fund	\$10,000	
2/08/2022	Board Project - Community Service & Youth Service Awards and Community Pride Garden Awards	\$7,500	
2/08/2022	Allocation to 2022-23 Youth Development Fund	\$7,000	
2/08/2022	Board Project - Community Leadership Opportunities	\$4,500	
2/08/2022	Board Project - Summer with your Neighbours	\$4,500	
2/08/2022	Board Project - Engaging with the Community	\$4,000	
2/08/2022	Allocation to 2022-23 Off The Ground Fund	\$2,000	
2/08/2022	Board Project - 2023 Anzac Day Expenses	\$1,500	
16/08/2022	Moral Compass Trust towards the Outdoor Education and Mentoring for Youth project.	\$7,000	
16/08/2022	Halswell United Association Football Club Incorporated for Football Development Manager Wages.	\$5,000	
16/08/2022	Greater Hornby Residents' Association Inc. towards the Noddy Train project.	\$4,000	
6/09/2022	Halswell Bowling Club Incorporated towards the Green Development Project.	\$15,000	
6/09/2022	American Football Canterbury Incorporated towards the AFC Youth, Varsity and Senior Season.	\$2,000	
6/09/2022	Avon Sequence Dancers towards Another Year of Avon Sequence Dancing.	\$900	
20/09/2022	Canterbury Muslim Community Trust towards the Kids Afterschool Programme project.	\$6,000	
20/09/2022	Rewi Alley Chinese School Trust towards wages in delivering the Chinese School Saturday programmes and parent support programmes	\$12,000	
20/09/2022	Riccarton Leagues Club Incorporated towards the painting of its clubrooms.	\$8,000	
10/11/2022	Burnside West Christchurch University Cricket Club Inc towards Grounds maintenance equipment for Burnside Park.	\$4,000	
10/11/2022	Hornby Rugby Football Club Inc towards the Clubrooms Manager project.	\$4,000	

10/11/2022	Greater Hornby Residents' Association Inc towards Community events and ongoing administration costs.	\$6,000	
10/11/2022	Kennedys Bush Road Neighbourhood Association Inc towards the Annual Christmas party.	\$350	
15/12/2022	Riccarton Park Menzshed Trust towards the Riccarton Park Menzshed Trust Establishment Project.	\$10,000	
15/12/2022	Canterbury Malaysian Society Incorporated towards administration and cultural events expenses.	\$3,500	
15/12/2022	FC Twenty 11 Inc. towards the delivery of the Riccarton Sports Hub Multi Sport Festival.	\$650	
15/12/2022	Church Corner Residents' Association towards set up costs.	\$500	
15/12/2022	Allocation to 2022-23 Youth Development Fund.	\$3,000	
15/12/2022	Allocation to 2022-23 Off The Ground Fund.	\$2,000	
9/02/2023	Bhutanese Society of Canterbury NZ Incorporated towards the Fun Day Out event.	\$1,500	
9/02/2023	Oak Development Trust towards the Development of Riccarton Hub Website and further digital communication in Riccarton project.	\$4,955	
9/03/2023	Halswell United Association Football Club Incorporated towards the Halswell United E-Sports project.	\$5,000	
9/03/2023	Canterbury Westland Kindergarten Assn (Kidsfirst) - McKenzie (34) towards the outdoor sun safe area project.	\$1,800	
13/04/2023	Allocation to 2022-23 Youth Development Fund	\$4,000	
13/04/2023	Allocation to 2022-23 Off The Ground Fund	\$2,000	
13/04/2023	Birthright Canterbury Trust toward Social Worker Wages.	\$4,500	
13/04/2023	Southern United Hockey Club Incorporated towards the Training and Equipment Funding Project.	\$1,500	
13/04/2023	Chinese Joyful Club towards the Senior Group Programme.	\$2,000	
13/04/2023	Greater Hornby Residents Association Inc toward Youth Community Discos.	\$600	
13/04/2023	Halswell Toy Library Incorporated towards the Halswell Toy Library Open Day.	\$400	
13/04/2023	Board Allocation - Costs of expert advice to support the Board's submission on the Council's Plan Changes 14 and 13.	\$20,000	
		<b>\$195,155</b>	<b>\$47,538</b>
<b>2022-23</b>	<b>Youth Development Fund</b>	<b>Allocated</b>	<b>Funds Remaining</b>
2/08/2022	Discretionary Response Fund Allocation	\$7,000	
15/12/2022	Discretionary Response Fund Allocation	\$3,000	
13/04/2023	Discretionary Response Fund Allocation	\$4,000	
	<b>Total YDF Fund</b>	<b>\$14,000</b>	
9/08/2022	Burnside West University Cricket Club Incorporated on behalf of Ben Hooker towards the Cricket Development Tour to be held in India.	\$175	
9/08/2022	Mikayla Cooper towards participating in the Hip Hop International World Champs to be held in Phoenix, Arizona, USA.	\$500	

9/08/2022	Zachary Hannen towards attending the International Sports Academy at Andrews Osborne to be held in Willoughby, Ohio, USA.	\$500	
9/08/2022	Thomas MacGibbon towards participating in the Asia Pacific Canoe Sprint Cup to be held in Japan.	\$500	
9/08/2022	Natasha MacGibbon towards participating in the Asia Pacific Canoe Sprint Cup to be held in Japan.	\$500	
9/08/2022	Tamsyn Campbell towards participating in the Commonwealth Fencing Championships in England.	\$300	
18/08/2022	Christchurch Girls High School towards Medha Baadkar to participate at the National Readers Cup in Auckland.	\$250	
18/08/2022	Templeton Primary School towards two Kī o Rahi teams to participate at the Koru Games in Selwyn.	\$480	
25/08/2022	Liliana Gunther towards competing in the FIG Trampoline World Age Group Competition to be held in Sofia, Bulgaria.	\$500	
15/09/2022	Jaimee Seddon towards competing in the Canoe Polo New Zealand Secondary School Championships in Hawkes Bay.	\$300	
28/09/2022	Hornby High School towards the senior basketball team to participate in the Basketball National Championships to be held in Palmerston North.	\$1,000	
7/10/2022	Cashmere High School Board of Trustees on behalf of Ben Higgins, Rio Mahauariki and Thomas Vossler towards participating in the Australian School Volleyball Championships to be held in Brisbane, Australia	\$900	
21/11/2022	Middleton Grange School (Board of Trustees) on behalf of Micah Pomare and Zach Prince towards participating in the Get2Go Adventure Race to be held on Great Barrier Island.	\$300	
21/11/2022	Lia Manning towards participating in the Show Case National Dance Competition to be held on the Gold Coast, Australia.	\$500	
1/02/2023	Ocean Simard towards participating in the World Under 24 Ultimate Frisbee Championships 2023 to be held in London.	\$500	
23/02/2023	Anna Lee School of Dance on behalf of Frequency Hip Hop Crew towards, Charlize Wilson, Keisha Jones and Sydney Guo to participate in the Hip Hop International NZ Nationals to be held in Auckland.	\$900	
23/02/2023	Matt Cleverly to participate in the South Island Long Course Swimming Championships in Invercargill.	\$300	
15/03/2023	Ocean Simard towards participating in the Ultimate Frisbee Under 24 training camp in Auckland.	\$300	
15/03/2023	Amber Hill towards participating in the Girls Brigade Awesome Leadership Course in Auckland.	\$300	
24/03/2023	Hillmorton High School on behalf of Keegan Macklin and Holly Brown towards participating in the Vex Robotics World Championships to be held in Texas, USA.	\$995	
21/04/2023	Adele Dunning towards participating in the Irish Dancing Australian International Oireachtas in Sydney, Australia.	\$500	



21/04/2023	Zoe Dunning towards participating in the Irish Dancing Australian International Oireachtas in Sydney, Australia.	\$500	
21/04/2023	Cameron Jones towards attending Blake Inspire for Sailors programme in Auckland.	\$400	
		<b>\$11,400</b>	<b>\$2,600</b>
<b>2022-23</b>	<b>Off the Ground Fund</b>	<b>Allocated</b>	<b>Funds Remaining</b>
2/08/2022	Discretionary Response Fund Allocation	\$2,000	
15/12/2022	Discretionary Response Fund Allocation	\$2,000	
13/04/2023	Discretionary Response Fund Allocation	\$2,000	
	<b>Total OTG Fund</b>	<b>\$6,000</b>	
10/08/2022	Greater Hornby Residents' Association towards the Youth Disco Project.	\$400	
10/08/2022	Yao Tong (Tanya Tong) towards the Chinese Parenting Group, Parenting Courses.	\$400	
8/09/2022	New Zealand International Students Association Incorporated towards the 2022 NZISA Wellbeing Roadshow.	\$400	
8/09/2022	Jennifer Tregurtha towards the Springlands Reserve Trapping Project.	\$370	
7/10/2022	Nicole Whalley towards the Awatea Green get to know your neighbours event.	\$200	
24/11/2022	South West Ministries Trust trading as Living Waters Christian Centre towards the Halswell Twilight Christmas Market.	\$230	
19/12/2022	Mesoumeh Sadat towards the women's only rock climbing activity.	\$400	
19/12/2022	Rowland Brown towards Have a go pickle ball sessions.	\$200	
1/02/2023	Lai Wang towards Mandarin Classes.	\$400	
14/03/2023	Andrew Yip towards the Oaklands Primary School Guardians Meet and Greet event.	\$400	
14/03/2023	Halswell Community Project towards the Adoptee Support Group project.	\$400	
		<b>\$3,800</b>	<b>\$2,200</b>
<b>2022-23</b>	<b>Swimming Accessibility and Activation Fund</b>	<b>Allocated</b>	<b>Funds Remaining</b>
2/08/2022	Discretionary Response Fund Allocation	\$10,000	
	<b>Total SAA Fund</b>	<b>\$10,000</b>	
21/11/2022	Nepal New Zealand Friendship Society of Canterbury Incorporated towards Women's only swimming lessons.	\$1,000	
21/11/2022	Halswell Community Project Inc towards the Celebrate Halswell Fun Day.	\$750	

21/11/2022	Riccarton Community Church Trust towards its Riccarton Youth Community Pool Party.	\$600	
		<b>\$2,350</b>	<b>\$7,650</b>

**SUBMISSION TO:** Christchurch City Council  
**ON:** Draft Annual Plan 2023-24  
**BY:** Waipuna Halswell-Hornby-Riccarton Community Board  
**CONTACT:** Faye Collins  
Community Board Adviser  
[faye.collins@ccc.govt.nz](mailto:faye.collins@ccc.govt.nz)

## 1. INTRODUCTION

- 1.1. The Waipuna Halswell-Hornby-Riccarton Community Board ("the Board") appreciates the opportunity to make a submission on the Draft Annual Plan 2022-23 ("the Plan").
- 1.2. The Board wishes to be heard in support of its submission.
- 1.3. The Board's submission below includes responses to the specific questions posed in the consultation documents together with general comments at the end.

## 2. SUBMISSION

Proposed changes to revenue, spending and borrowing:

### Capital Endowment Fund

- 2.1. The Board supports the proposal to use one million dollars from the Council's Capital Endowment Fund for grants that are normally funded by rates; thereby reducing the rates increase facing ratepayers for 2023/24.

### Rates

- 2.2. The Board accepts that in the current economic climate the proposed average rates increase of 5.68% for 2023/24 is realistic.
- 2.3. The Board recognises that it is a difficult task to balance expenditure against revenue/ borrowing to meet the costs of maintaining and developing the city, particularly in these uncertain times with supply issues and rising costs, while keeping rates at a level that is affordable to residents.
- 2.4. While the Board appreciates and supports the initiatives taken to restrict rate increases, it is aware that many residents are currently suffering significant financial hardship and that any rates increase will only add to this. The Board therefore urges the Council to provide support where possible for those struggling to pay increased rates. In addition to the rates remission policy, consideration could be given to payment schemes, deferral etc. and to take all necessary steps to increase awareness of the options for payment of rates and any assistance available.

Business Differential on the General Rate

- 2.5. The Board supports the proposal to adopt a changed business differential on business properties of 2.22 to scale up the contribution that business properties make to general rates. The change will mean that the business sector as a whole will pay the same proportion of overall rates that it currently does. The Board considers without the change to the business differential the latest property re-valuation will result in a disproportionate burden of the rates increases falling on residents.

Extending the City Vacant Differential Rating

- 2.6. The Board notes the proposal to extend the use of City Vacant Differential rating to commercial areas in New Brighton, Lyttelton, Sydenham and Linwood Village from 1 July 2024. While the Board supports in principle incentives to develop vacant land, it does not consider it is appropriate to comment on the specific proposal that will affect only areas outside the Board boundaries.

Uniform General Annual Charge

- 2.7. The Board notes that the current Uniform General Annual Charge of \$145 is one of the lowest in New Zealand and supports the proposed increase to \$153. Taking into account the rates assistance available to low income residents, the Board does not consider that it is necessary to adopt a lower Uniform General Annual Charge of \$50.

Excess Water Supply Targeted Rate

- 2.8. In its submission on the Long Term Plan the Board opposed the proposal to introduce an excess water use charge for households that use more than 700 litres of water per day, on the basis that the Board considers that setting a per household "limit" for water is inequitable and could result in large households' legitimate water use for daily activities such as bathing and washing clothes being constrained while neighbouring small households are free to squander water. The Board fully supports the Council's aim to limit water use at peak demand times, and to reduce water wastage; however, it considers that this aim could be more equitably achieved by other means.
- 2.9. The Board is aware of residents' concerns about excess water use charges, but understands that the matter cannot be revisited via the Annual Plan, but may be reconsidered as part of the next Long Term Plan consideration. In the meantime the Board supports the proposal to **increase the allowance of water from 700 litres to 900 litres per day before charging for excess water supply** starts from 1 July 2023 to lessen the impact of the charges.

Capital Programme

- 2.10 The Board appreciates the Council's continued investment in the Waipuna - Halswell, Hornby, Riccarton Board area and is particularly excited at the prospect of the opening of the Matatiki Hornby Centre.
- 2.11 In its submission on the 2022-23 Annual Plan the Board pointed out the need for the **Amyes Awatea and Springs intersection improvement to be advanced**. This was originally proposed prior to the 2011 earthquake, but was reprogrammed to start in 2025. The Board is grateful that this Plan makes provision for this important work to commence in the 2023-24 financial year.
- 2.12 The Board notes that this work will facilitate travel from Halswell to Hornby to maximise the use of the new Matatiki Hornby Centre once it is open and encourages the Council to undertake further study of the of the roading network in and around Hornby to identify improvements that can be made. The Board has recently consulted on its Community Board Plan including a proposed priority to "advocate for the development and implementation of a Hornby Masterplan." Hornby carries a large number of Heavy Vehicles as the commercial area is alongside the residential area.
- The Board also brings to Council's attention **the lack of a footpath on the northern side of the Main South Road**, where Countdown and other shops are situated. This is a situation that needs to be rectified.
- The Board considers that a Hornby Masterplan is critical.
- 2.13 With regard to the remaining capital projects within Board area the Board supports their inclusion and asks that **no changes** be made to the programme.
- 2.14 In its submission on the 2022-23 Annual Plan the Board advocated for provision for the **creation of a fenced dog park in the Halswell area**, noting that the project was a Board priority in the Community Board plan. The Board is disappointed that there has been no provision for a dog park and points out that it has recently consulted on its Community Board Plan for the coming term that includes a proposed priority to "*Advocate for a fenced dog park for the Halswell Ward*". 49 submissions in support of a Board priority to advocate for a fenced dog park in the Halswell area were received.

General Comments

- 2.15 Waipuna - Halswell, Hornby, Riccarton, is facing the challenges of growth, Halswell through ongoing subdivisions and Riccarton and Hornby through central government mandated intensification proposals. Of particular concern is the six storied development proposed around large commercial centres. These issues will need to be addressed through the Independent Hearings Panel.



### 3. CONCLUSION

- 3.1. The Board requests that the Council takes into consideration the above submission on the Draft Annual Plan 2023-24.



Helen Broughton

Chairperson Waipuna Halswell-Hornby-Riccarton Community Board

Dated 5 April 2023.

Memos



# Memo

Date: 12/04/2023  
From: Gautham Praburam, Traffic Engineer  
To: Waipuna Halswell-Hornby-Riccarton Community Board  
Cc:   
Reference: 23/493769

## Traffic Safety Concerns in the vicinity of Villa Maria College, Upper Riccarton

### 1. Purpose of this Memo

- 1.1 This technical memorandum has been written in response to an action memo from the Waipuna Halswell-Hornby-Riccarton Community Board, dated 12/04/2022.
- 1.2 The Community Board requested that staff engage with Villa Maria College, residents and the Ilam Upper Riccarton Residents' Association and provide advice on traffic safety and on street parking in the vicinity of Villa Maria College on Brodie Street, including but not limited to:
  - The provision of a pedestrian crossing facility in the vicinity of 5-15 Brodie Street,
  - A reduction of the speed limit on Brodie Street.
  - A reduction of the speed limit on Peer Street.
  - A review of parking restrictions and the demarcation of parking spaces on Brodie Street (parking ticks).
  - Safe travel to and from Villa Maria College.
- 1.3 The information in this memo is not confidential and can be made public if needed.

### 2. Background and Introduction

- 2.1 Staff and student representatives of Villa Maria College addressed the Waipuna Halswell-Hornby-Riccarton Community Board on 12/04/2022 regarding traffic safety concerns in the vicinity of Villa Maria College and the safety risks faced by students during school start and finish times. They requested speed limit reductions and measures to improve safety for pedestrians (especially school students) in the adjoining roads.
- 2.2 A local resident also addressed the Community Board in that meeting regarding traffic safety concerns along Brodie Street. Apart from supporting the school's concerns, the resident also spoke about issues caused due to parked cars along Brodie Street. The resident requested reviewing the existing parking restrictions and also parking ticks along Brodie Street to clearly demarcate the on-street parking spaces.
- 2.3 Council staff met with school staff and student representatives on site. Council staff investigated the concerns of all road users and potential treatments to address these concerns.

Memos



### 3. Staff responses and actions

- 3.1 **The provision of a pedestrian crossing facility in the vicinity of 5-15 Brodie Street,**
- The speed limit along Brodie Street is planned to be reduced to 30km/hr (explained below). This would improve the safety for pedestrians around this location thereby removing the need for a separate crossing facility.
- 3.2 **A reduction of the speed limit on Brodie Street.**
- As part of improving safety around schools, speed limit reductions are programmed around all schools in the city. A 30 km/hr permanent speed limit is proposed for the entire length of Brodie Street.
- 3.3 **A reduction of the speed limit on Peer Street.**
- A variable 30km/hr speed limit during school hours is also planned for the sections of Peer Street and Yaldhurst Road adjacent to Villa Maria College.
  - The permanent speed limit outside school hours along Yaldhurst Road is also proposed to be dropped to 50 km/hr (currently 60 km/hr) through the Waka Kotahi Interim Speed Management Plan.
  - At this stage, the new speed limits at these locations are programmed to be implemented in 2023/2024.
- 3.4 **A review of parking restrictions and the demarcation of parking spaces on Brodie Street (parking ticks).**
- Time restricted parking of various levels are already present along Brodie Street. On street parking spaces without any time restrictions are also available along this street. Having such variety of restrictions provides parking opportunities to various road users (residents and short / long term visitors) along Brodie Street. So, any further time restricted parking along this street is not warranted.
  - Parking ticks are already present along the western side of Brodie Street up to number 55 (which is located immediately next to the existing speed hump). Along the eastern side, parking ticks are present up to the school's car park entry / exit. Additional parking ticks have been arranged to be painted up to the existing speed hump (accessway of 60 Brodie Street) along the eastern side of Brodie Street as well.
  - In response to the concerns regarding parking on both sides of the road narrowing visibility and accessibility, the Christchurch Suburban Parking Policy recommends restricting parking along one side of the road if the road width is 7m or less. Brodie Street is over 8m wide. Based on the existing scenario and road geometry, no stopping restrictions are not currently warranted at this location. Removal of on street parking spaces could present a visually wide carriageway thereby increasing the chances of vehicles travelling at inappropriate speeds.
- 3.5 **Safe travel to and from Villa Maria College.**
- The school also raised some concerns regarding the Yaldhurst Road / Brodie Street intersection when staff met their representatives on site. This intersection is controlled and operated by Waka Kotahi NZ Transport Agency and their staff have already been in touch with the school regarding this.
  - Apart from this, the other treatments / measures discussed above will contribute to safe travel to and from Villa Maria College.

Memos



#### 4. Conclusion

The treatments and speed limit change proposals discussed above would improve road safety for all road users at this location. The school, resident and the Ilam & Upper Riccarton Residents Association have been notified regarding this.

#### Attachments Ngā Tāpirihanga

There are no attachments to this memo.

#### Signatories Ngā Kaiwaitohu

<b>Authors</b>	Gautham Praburam - Traffic Engineer Gemma Dioni - Senior Transportation Engineer
<b>Approved By</b>	Katie Smith - Team Leader Traffic Operations

Memos



# Memo

Date: Wednesday 3 May  
From: Nigel Cox, Head of Recreation, Sports and Events  
To: Waipuna Halswell-Hornby-Riccarton Community Board  
Cc:   
Reference: 23/658433

## Matatiki: Hornby Centre RFP for cafe and progress update

### 1. Purpose of this Memo

- 1.1 The purpose of this memo is to inform the Waipuna Halswell-Hornby-Riccarton Community Board that the request for proposal (RFP) process for the café space at Matatiki: Hornby Centre is getting underway, and to provide an update on how construction is progressing on site.
- 1.2 The information in this memo is not confidential and can be made public.

### 2. Café RFP process update

- 2.1 Christchurch City Council is seeking public tenders to lease and operate a café located in the heart of the Matatiki: Hornby Centre, which is currently under construction at Kyle Park in Hornby.
- 2.2 The café space within Matatiki: Hornby Centre is available for lease by way of a public tender.
- 2.3 The space available for lease consists of a prep kitchen and café located in the reception area of the new centre. Indoor and outdoor customer seating is also included.
- 2.4 The site would suit ready-to-serve menu options such as (but not limited to) sandwiches, salads, baked goods, barista-made coffee, and cold drinks.
- 2.5 The request for proposal (RFP) documents are available to download via the Government Electronic Tender Service (GETS) website.
- 2.6 Tender proposals will open Wednesday 3 May and will close midday Wednesday 14 June, 2023.
- 2.7 A staff lead evaluation panel will review, seek any necessary clarifications, and evaluate the proposals. A recommendation will then be presented to the Community Board at the September or October meeting.
- 2.8 The RFP is being advertised on Trade Me. A Newsline story is scheduled for release on Wednesday 3 May, highlighting the RFP process and providing a high-level update on construction progress for the public.

### 3. Progress update

- 3.1 The library wing is almost enclosed, with the majority of cladding and windows now in place. All main superstructure elements in the pool hall have been installed and the roof system over this space is about to commence.



Memos



- 3.2 The Establishment/Operational readiness workstream is also gaining momentum as we start to plan for procurement of IT, furniture and other fit out items. Staff are also planning to engage with the local community to gather insights to inform the development of programmes and services that meet the community's needs. We will also be informing the community about employment opportunities that are available at Matatiki: Hornby Centre.

Attachments Ngā Tāpirihanga

No.	Title	Reference	Page
A	Newsline Council seeks cafe operator for new facility	23/207163	

Signatories Ngā Kaiwaitohu

<b>Authors</b>	Emma Hyde - Communications Advisor Brayden Barnett - Project Manager Grant McIver - Leasing Consultant
<b>Approved By</b>	Nigel Cox - Head of Recreation, Sports & Events

## Ticket Report

01 04 2023 - 30 04 2023

### Halswell-Hornby-Riccarton

Tickets Reported in April 2023

2576

# Reported Tickets last ...

Status as of Report Date

Open

784

Closed/Resolved

1792

Channels

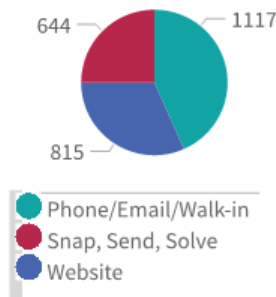

Currently Open Tickets\*

3529

# Open Tickets all

9

avg open ticket age (days)

25% of open tickets are less than 24 days old

50% of open tickets are less than 89 days old

75% of open tickets are less than 250 days old

\*Open as of report date, reported all time

Top 15 Incident Categories

● Halswell ● Hornby ● Riccarton

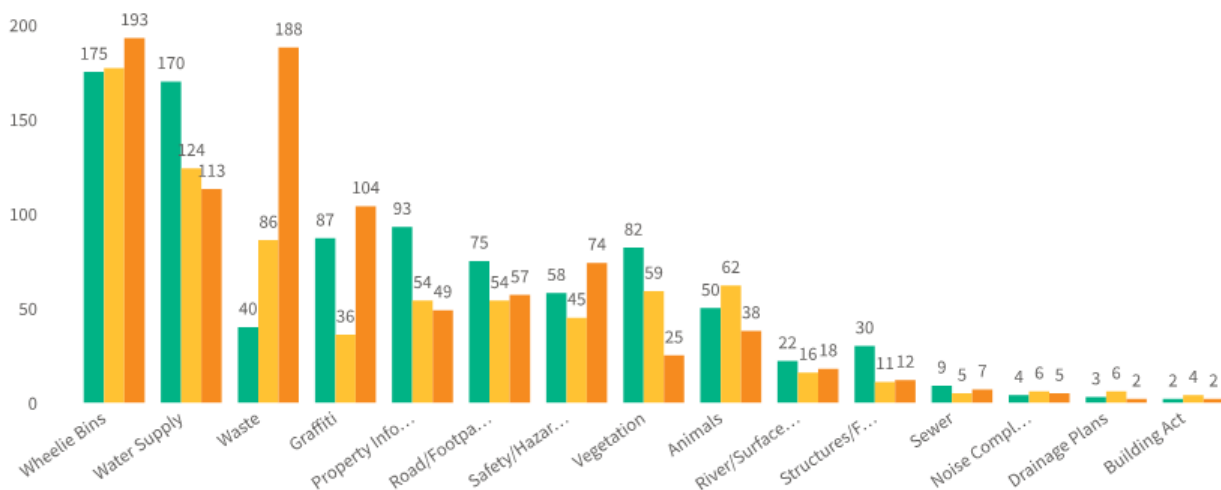

Top 10 Object Categories

# Tickets	ObjectCategory
280	Litter
230	Water Leak
227	Graffiti
191	Bin Not Collected
151	Damaged Bin
75	Residential LIM
71	Trees
69	Water Supply
66	Missing Bin
62	New Service

Report date:  
01 May 2023

## 11. Waipuna Halswell-Hornby-Riccarton Community Board - Community Service and Youth Service Awards 2023

Reference / Te Tohutoro: 23/582759

Report of / Te Pou Noela Letufuga, Support Officer

Matua: noela.letufuga@ccc.govt.nz

General Manager / Mary Richardson, General Manager Citizens & Community

Pouwhakarae: (Mary.Richardson@ccc.govt.nz)

### 1. Purpose of Report Te Pūtake Pūrongo

- 1.1 The purpose of this report is to present the Community Service and Youth Service Award 2023 nominations to the Waipuna Halswell-Hornby-Riccarton Community Board for consideration.

### 2. Staff Recommendations / Ngā Tūtohu

That the Waipuna Halswell-Hornby-Riccarton Community Board:

1. Confers Community Service and Youth Service Awards on the nominees listed on the Summary of Nominations 2023 (separately circulated).
2. Delegates authority to the Board Chairperson and Deputy Chairperson to accept any late applications received from other Community Boards.
3. Has the names of successful nominees released after the Board's Community Service Awards 2023 function. Names of unsuccessful nominees will be kept confidential.

### 3. Context/Background Te Horopaki

#### Issue or Opportunity / Ngā take, Ngā Whaihua rānei

- 3.1 The Christchurch City Council created Community Service and Youth Service Awards as a way to thank and honour those who, by their demonstrated commitment and example, inspire others to engage in volunteer service. Recognising and honouring community-focused initiatives sets a standard for service, encourages a sustained commitment to civic participation, and inspires others to make service a central part of their lives.
- 3.2 There has been promotion of the awards scheme through Council media releases, local newspaper advertisement and the Council's social media networking avenues. In addition local community groups, including residents' associations, have been sent information seeking nominations for Community Service and Youth Awards for 2023.
- 3.3 The service undertaken should be of a voluntary nature. A paid employee may be eligible where the work undertaken is beyond the scope of that person's normal job description and the nominee has spent some of their own non-work time in the project. In this circumstance either one of the nominators should be an employer who states that the work is outside of normal work or a supporting letter supplied from an employer stating the same. Please find the Guidelines information attached (refer **Attachment A**).
- 3.4 People will be eligible for Community Service Awards in the area that they do the work in, however, if the work is for a metropolitan organisation that covers more than two Board areas then the nomination shall be considered in the community board area that the nominee does the majority of their voluntary work.

- 3.5 Service recognised may include work in the following areas: youth, older persons, education, cultural, church, recreation, sport and community service sectors.
- 3.6 Individuals shall be eligible to receive only one Community Service Award for the same voluntary work.
- 3.7 Nominations can be forwarded to this Board from another Community Board if they deem that the nomination is more suitably considered by this Board. Details of such nominations may be received as late applications for consideration. Bearing this in mind the Board may wish to put in place measures to meet this contingency. These nominations could be considered by the Board Chairperson and Deputy Chairperson.

#### **Strategic Alignment/ Te Rautaki Tīaroaro**

- 3.8 Like most Community Board initiated projects, this project aligns to the Council's commitment to achieving the outcome of the city enjoying strong communities.

#### **Decision Making Authority / Te Mana Whakatau**

- 3.9 The decision-making authority is the Waipuna Halswell-Hornby-Riccarton Community Board.

#### **Assessment of Significance and Engagement / Te Aromatawai Whakahirahira**

- 3.10 The decision(s) in this report is of low significance in relation to the Christchurch City Council's Significance and Engagement Policy.
- 3.11 The level of significance was determined by the number of people affected and/or with an interest.
- 3.12 Due to the assessment of low significance, no further community engagement and consultation is required.

#### **Discussion / Kōrerorero**

- 3.13 A matrix detailing the nominations received for consideration is circulated separately as **Attachment B**.
- 3.14 Nominations were open from Friday 3 March to Friday 31 March 2023. Four nominations for Youth Service Awards and fifteen nominations for Community Service Awards, including one community group, have been received this year.
- 3.15 Historically the Community Board has followed a practice of conferring Community Service Awards to people or organisations where the service length for which the person/organisation nominated was approximately five years or more. The exception to this is for Youth Service Awards. The staff recommendation reflects this previous approach, however it is the Board's decision if they wish to follow this.
- 3.16 After the Community Board has made its decision, the award recipients will be notified and invited to a function for the presentation of the Community and Youth Service Awards.

## **Attachments Ngā Tāpirihanga**

No.	Title	Reference	Page
A 	Community Service Awards 2023 - Guidelines	23/583142	106
B	Halswell-Hornby-Riccarton Community Service Awards 2023 - Summary of nominations ( <i>Under Separate Cover</i> ) - <b>CONFIDENTIAL</b>	23/621124	

### Confirmation of Statutory Compliance Te Whakatūtutanga ā-Ture

Compliance with Statutory Decision-making Requirements (ss 76 - 81 Local Government Act 2002).

(a) This report contains:

- (i) sufficient information about all reasonably practicable options identified and assessed in terms of their advantages and disadvantages; and
- (ii) adequate consideration of the views and preferences of affected and interested persons bearing in mind any proposed or previous community engagement.

(b) The information reflects the level of significance of the matters covered by the report, as determined in accordance with the Council's significance and engagement policy.

### Signatories Ngā Kaiwaitohu

<b>Author</b>	Noela Letufuga - Support Officer
<b>Approved By</b>	Matthew McLintock - Manager Community Governance Team



# Community Service Awards 2023

## Nomination guidelines

Community Service Awards are awarded to individuals and groups in recognition of significant voluntary service.

### PLEASE NOTE

Participating Community Boards this year are Waihoru Spreydon-Cashmere-Heathcote, Waipuna Halswell-Hornby-Riccarton, and Waitai Coastal-Burwood-Linwood  
Community Boards **not** participating this year are Te Pātaka o Rākauhautū Banks Peninsula, Waimāero Fendalton-Waimairi-Harewood, and Waipapa Papanui-Innes.

**Youth Service Awards\*:** Community Boards participating this year are Waihoru Spreydon-Cashmere-Heathcote, Waitai Coastal-Burwood-Linwood and Waipuna Halswell-Hornby-Riccarton

- The service undertaken should be of a voluntary nature. A paid employee may be eligible where the work undertaken is beyond the scope of that person's normal job description and the nominee has spent some of their own non-work time in the activity. In such a case, one of the nominators should be an employer of the nominee, who states that the nominee's work/activity went beyond the requirements of routine work by providing a supporting letter to that effect.
- The Community Service Awards recognise voluntary efforts in the following areas: youth, older adults, education, culture, church, recreation, sport, community service fields.
- People will be eligible for Community Service Awards in the area/suburb that they do the work in. If the work is for an organisation that covers more than two board areas, then the nomination shall be considered in the board area that the nominee does the majority of their voluntary work.
- Nominations must be submitted on the official nomination form that is available at [ccc.govt.nz/csa](http://ccc.govt.nz/csa)
- The nomination form must be signed by two nominators and both nominators should be aware of the details of the nomination.
- Any community organisation, club or society may make a nomination. Two executive officers of the organisation should sign the nomination and record their title of office.
- Letters of support or evidence supporting the work can also be submitted with the nomination. It is highly recommended to supply as much detail as possible to support the nominations. Length and type of service is particularly helpful.
- The more information you are able to supply in support of the nomination, the greater the assistance for the community boards in assessing the nominations.
- The length of voluntary work shall be considered alongside the nature of the work undertaken.
- Community Service Award nominations are considered and decided by community boards.
- Individuals shall be eligible to receive only one Community Service Award for the same voluntary work. This does not apply if a recipient has received a Youth Service Award.
- Community Service Awards are presented to recipients at functions hosted by the local community boards.

**\*Youth Service Awards** are presented by the Waihoru Spreydon-Cashmere-Heathcote, Waitai Coastal-Burwood-Linwood and Waipuna Halswell-Hornby-Riccarton Community Boards only, in recognition of significant voluntary service carried out by residents aged 25 years or under. These awards are to recognise individual effort rather than that of a whole group or organisation.

## 12. Elected Members' Information Exchange Te Whakawhiti Whakaaro o Te Kāhui Amorangi

This item provides an opportunity for Board Members to update each other on recent events and/or issues of relevance and interest to the Board.

### Karakia Whakamutunga

Unuhia, unuhia Unuhia ki te uru tapu nui Kia wātea, kia mā mā, te ngākau, Te tinana te wairua i te ara takatā Koia rā e Rongo, whakairia ake ki runga Kia tina! TINA! Hui e! TĀIKI E!	<i>Draw on, draw on, Draw on the supreme sacredness To clear, to free the heart, the body and the spirit of mankind Rongo, suspended high above us (i.e. in 'heaven') Draw together! Affirm!</i>
--	--

## 13. Resolution to Exclude the Public

*Section 48, Local Government Official Information and Meetings Act 1987.*

I move that the public be excluded from the following parts of the proceedings of this meeting, namely items listed overleaf.

Reason for passing this resolution: good reason to withhold exists under section 7.

Specific grounds under section 48(1) for the passing of this resolution: Section 48(1)(a)

### Note

Section 48(4) of the Local Government Official Information and Meetings Act 1987 provides as follows:

“(4) Every resolution to exclude the public shall be put at a time when the meeting is open to the public, and the text of that resolution (or copies thereof):

- (a) Shall be available to any member of the public who is present; and
- (b) Shall form part of the minutes of the local authority.”

This resolution is made in reliance on Section 48(1)(a) of the Local Government Official Information and Meetings Act 1987 and the particular interest or interests protected by Section 6 or Section 7 of that Act which would be prejudiced by the holding of the whole or relevant part of the proceedings of the meeting in public are as follows:

ITEM NO.	GENERAL SUBJECT OF EACH MATTER TO BE CONSIDERED	SECTION	SUBCLAUSE AND REASON UNDER THE ACT	PLAIN ENGLISH REASON	WHEN REPORTS CAN BE RELEASED
11.	WAIPUNA HALSWELL-HORNBY-RICCARTON COMMUNITY BOARD - COMMUNITY SERVICE AND YOUTH SERVICE AWARDS 2023				
	ATTACHMENT B - HALSWELL-HORNBY-RICCARTON COMMUNITY SERVICE AWARDS 2023 - SUMMARY OF NOMINATIONS	S7(2)(A)	PROTECTION OF PRIVACY OF NATURAL PERSONS	TO PROTECT THE PRIVACY OF THE NOMINEES AND THE CONFIDENCE OF THE NOMINATION PROCESS. NAMES OF UNSUCCESSFUL NOMINEES WILL BE KEPT CONFIDENTIAL.	NAMES OF SUCCESSFUL NOMINEES WILL BE RELEASED FOLLOWING THE COMMUNITY SERVICE AWARDS FUNCTION 2023.