

Waihoru

Spreydon-Cashmere-Heathcote Community Board

MINUTES ATTACHMENTS

Date: Thursday 15 June 2023
Time: 4 pm
Venue: Boardroom, Beckenham Service Centre,
66 Colombo Street, Beckenham

TABLE OF CONTENTS	PAGE
4.1. Public Forum - Transport Issues in Hoon Hay Area	
A. Item 4.1 Public Forum - Hoon Hay Community Association - Better Road Safety Report.....	3
4.2. Public Forum - Coastal Pathway - Art Sculpture	
A. Item 4.2 Public Forum - Pacific Fleet Windsurfing presentation.....	30
5.1. Deputations by Appointment - Len Lye sculpture in Scott Park alongside the Coastal Pathway	
A. Item 5.1 Deputation - Coastal Pathway Group presentation	33
4.3. Public Forum - Proposed basketball half-court at Cornelius O'Connor Reserve	
A. Item 4.3 Public Forum - Manuka Rangatahi Rōpū presentation.....	42
B. Item 4.3 Public Forum - Letter of Support from Addington Farm.....	50
C. Item 4.3 Public Forum - Letter of Support from Addington Neighbourhood Association Incorporated.....	51
D. Item 4.3 Public Forum - Letter of Support from Addington Te kura Taumatua.....	52
E. Item 4.3 Public Forum - Letter of Support from Cross Over Trust	53
F. Item 4.3 Public Forum - Letter of Support from Hillmorton High School - Tigers Sport.....	54
G. Item 4.3 Public Forum - Letter of Support from Manuka Cottage	55
H. Item 4.3 Public Forum - Letter of Support from St Mary the Virgin Parish, Addington	56

Better Road Safety In Hoon Hay Petition

Report by Hoon Hay Community Association

From late 2022, residents continuously raised with Hoon Hay Community Association (HHCA) the issues relating to road safety in the area. The safety concerns also became evident at our local events, such as our Halloween Kids Night each October. Feedback poured in online to HHCA, which sparked our organisation to begin looking into this issue.



In early 2023, HHCA presented to the Spreydon-Cashmere-Heathcote Community Board on the need for a pedestrian island on Hoon Hay Road between Sparks Rd and Mathers Rd. One of our committee members told their story of being almost run over. The Community Board passed a motion to investigate a pedestrian/traffic island being placed in this stretch of road which was a massive achievement, however we knew the work wasn't over yet.

For about six weeks in February to April 2023, HHCA collected signatures and suggestions to its petition on Better Road Safety in Hoon Hay, both online and at in-person events. This culminated with a residents' meeting on the subject, with more feedback collected.

Summary of Results

129	100%	99.2%
Petition Signatures	Support for Better Road Safety	Support for a Pedestrian Crossing/Island on Hoon Hay Road between Mathers Road & Sparks Road**

****NB:** There was some confusion by the question drafting, as the petition asked for support for a pedestrian crossing. HHCA supports an island and meant for the wording to reflect this, but it has been interpreted as a zebra/pedestrian crossing by some. In general, the feedback supports a pedestrian island, but not a zebra crossing due to potentially causing more traffic issues.

Major Themes

- Excessive speed
- Lack of traffic calming measures
- Road layout changes needed
- Poor road maintenance
- Lack of pedestrian islands and crossings
- Anti-social road behaviour
- Lack of visibility
- Improve cycling infrastructure and public transport accessibility
- Lack of road signs (for speed and school zones)
- Lack of enforcement and patrols in area
- Poor footpath maintenance

Summary of Improvements Suggested by Signatories

Signatories were asked for their recommendations of improvements for better road safety in Hoon Hay. The full summary of suggestions is in Appendix 1. While not all signatories provided suggestions, the collation of suggested improvements from the petition, our residents meeting and online feedback is below:

- 1 Create safer pedestrian crossings on Hoon Hay Road and provide islands or refuges near schools and preschools such as Hoon Hay School, Te Kōmanawa Rowley School, Spreydon School, Our Lady of Assumption School and Pennylane Early Childhood Centre. A need to be strategic about placement was recommended.
- 2 Make road layout changes and improve road safety measures at specific locations to address speed issues, skidding, and anti-social road behavior, specifically on sites such as Victors Road, Newland Street, Kevin St, Cedars St, Maryhill Ave, Wyn St, Herdman Street, Redgrave Street, Mathers Road, Tankeville St, Rowley Ave, Hendersons Road, and Rose St. Specific suggestions included:
 - a. the use of speed bumps or islands along Victors Road, Hendersons Road, Downing St, Dalkeith St, Samuel St, Upland Rd, and other roads/corners (including small side streets) that are often targeted by speeding and boy racers;
 - b. a right turning arrow from Rowley Ave onto Halswell Road;
 - c. Traffic lights from Hendersons Road onto Halswell Road;
 - d. Convert Maryhill Ave into two culdersacs to avoid cars in the intersection;
 - e. Install a safe pedestrian crossing or refuge at the Rose St and Hoon Hay Rd intersection;
 - f. Address issues at the Tankerville and Mathers Rd intersection due to the narrowing of the road by the barrier garden;
 - g. Consider a pedestrian crossing on Mathers Road, near Tankerville Road;
 - h. Narrow many residential roads; and
 - i. Alter the carparks on Mathers Road by the park to be along the park rather than cars sticking out onto the road to allow safe passage by other vehicles.
- 3 Increase visibility at areas such as the Wyn St and Maryhill Ave intersection and Cedars St and Kevin St road (with the latter, potentially adding yellow lines to stop parking by the park on the corner).
- 4 Lower speed limits across the area. In particular, extend school speed zones and reduce speed limits during school hours, particularly in areas with multiple schools. There were support for 30km zones in many places, especially main commuting areas for school children. Extending the 40km zone was also recommended.
- 5 Use methods such as no parking zones near bus stops and schools to improve visibility for buses and ensure safer access for users who currently feel unsafe crossing the road.
- 6 Consider the possibility of one way roads/lanes - the block of Herdman Street, Redgrave Street, Mathers Road, and Rowley Ave was specifically noted for this.

- 7 Enhance cycling infrastructure by adding cycle lanes on Hoon Hay Road, Hendersons Road and other spots, with a focus on visibility for cyclists. The changes down McBeath Street were commended as a great change already made.
- 8 Increase signage and lighting for good visibility i.e. increase the presence of night lights, install speed signs with good visibility to remind people of the 50kmph speed limit, consider placement of road signs in general
- 9 Enforce speed limits, discourage reckless driving, and increase police patrols to reduce dangerous behavior. Installing speed or CCTV cameras was suggested.
- 10 In addition to pedestrian islands, evaluate the feasibility of implementing traffic lights and zebra crossings at critical intersections.
- 11 Address footpath concerns, such as maintaining footpaths to improve overall road safety and removing power poles obstructing footpaths where narrow.
- 12 Encourage the development of light rail as an alternative transportation option.
- 13 Repair potholes, deal with curbing and channelling that makes turning into streets less smooth, place reflector panels on flower beds, and address specific concerns raised by residents.
- 14 Address reckless driving behaviour such as motorcyclists without helmets, dirt bikers driving through Hoon Hay Park, and speeding road users.
- 15 Make drivers more aware of children and pedestrians to avoid issues at driveways from fast cars.
- 16 Enforce parking rules or implement more spots where no parking is allowed- i.e. the 10 minute zone outside the Lewis St shops as cars obscure the view for road users, roads were parents parking reduces road use, Kevin St/Cedars St corner.

Personal Stories of Road Safety Issues

The residents of Hoon Hay have shared their personal experiences and concerns regarding road safety issues in their neighborhood. While HHCA considered summarising these stories, instead we thought it better that you hear a selection of stories below. All stories can be found listed in Appendix 1.

"At the moment we need to travel the opposite way to preschool to cross the road as there are no child safe crossings further down hoon hay road near Lewis road."

"We've had multiple issues of skids on Newland St and Victors Rd, resulting first in one of our cars being crashed into by a skidding car, then months later watching a car spin out from a skid and crash in the exact same spot as last time (luckily the car wasn't there that time). We know from our neighbours that it is an issue and property damage has occurred to fences and hedges. It's getting upsetting and making us feel unsafe in our area."

"I have had a near miss with my daughter on her balance bike when trying to cross the road."

"Crossing Hoon Hay Rd near Rose St is always a hairy experience, particularly with children. It is a busy intersection with cars turning in lots of directions, plus poor visibility due to cars parked in order to access the shops on Hoon Hay Rd opposite Rose St, as well as for sports at Centennial Park."

"The amount of near misses that occurs at the Rowley Ave, Halswell Road intersection I am surprised we haven't had any serious accidents. The housing intensification going in to Halswell puts more pressure on Halswell and Sparks Road."

"I walk my granddaughter to Pennylane. Crossing hoon hay road with a small child is terrifying"

"Almost knocked off bike multiple times on the corner of Lewis and Wyn Street due to cars cutting the corner as they turn into Lewis Street."

"My three children walk, scooter or bike to hoon hay primary. Most days they will have someone exit a driveway in front of them, a parent drive in the footpath in front of them while u-turning, or have to walk on the road to avoid a car parked in the footpath. The wide radius curves where samuel and gainsborough streets meet wyn street makes it hard to cross safely."

"There are constantly cars speeding down Dalkeith where I live at all hours of the day. There are lots of children during the day and it is concerning to hear cars going exceedingly fast. I feel speed bumps would force them to slow down."

"It is very scary walking my child across Mathers rd in the mornings to get to spreymon school. It is a very busy road at that time and I would like my child and other spreymon school children to feel safer crossing the road."

"We lay in bed at night waiting for the sound of a crash as certain cars are traveling over 100km often at night. We also worry as our neighbors fence is too high next to our drive so we don't see people on the footpath until we are out of the driveway"

"Don't think there is ever a night goes by without someone using Hoon Hay Rd as a race track."

Next Steps

HHCA is now presenting this report to the Spreydon-Cashmere-Heathcote Community Board so it has the details of all the road safety issues faced by residents in the area. In particular, HHCA calls on the Spreydon-Cashmere-Heathcote Community Board to take action on the 16 recommendations made.

HHCA has already met with Megan Woods, MP for Wigram, and plans to meet with Tracey McLellan, MP for Banks Peninsula. HHCA would also welcome any engagement from other agencies such as Waka Kotahi, NZ Police and others who work on this issue.

Appendix 1: Petition Entries

Note that names, addresses, emails and HHCA membership questions have been omitted.

	Do you support improving road safety in Hoon Hay?	Do you support adding a pedestrian crossing on Hoon Hay road between Mathers Road and Sparks Road?	What other improvements do we need to make our roads safer?	Share your story - Any personal experience that demonstrates the need for improved road safety in Hoon Hay.
1	Yes	Yes	No parking zones near bus stops so that the buses see people waiting. Safer ways to cross the road - Hoon Hay Road is so dangerous and no safe way to cross to bus stops if needed.	
2	Yes	Yes		
3	Yes	Yes	Road layout changes on Victors Road and Newland St (particularly on the corner) to avoid the speed issues down Victors and the skids/anti social road users constantly using the corner.	We've had multiple issues of skids on Newland St and Victors Rd, resulting first in one of our cars being crashed into by a skidding car, then months later watching a car spin out from a skid and crash in the exact same spot as last time (luckily the car wasn't there that time). We know from our neighbours that it is an issue and property damage has occurred to fences and hedges. It's getting upsetting and making us feel unsafe in our area.
4	Yes	Yes	The crossing or an island across or close to the preschool/schools down hoon hay road towards sparks road.	At the moment we need to travel the opposite way to preschool to cross the road as there are no child safe crossings further down hoon hay road near Lewis road.
5	Yes	Yes	Safer ways to get to bus stops	

6	Yes	Yes	Speed bumps on victors road to stop boy racers	There have been several instances of boy racers speeding up victors road and doing burnouts/skids on the corner of victors and Newland st. One of them nearly wrote off our flatmates car parked on the road outside our house. I reckon a couple of speed bumps or narrow sections would put a stop to this.
7	Yes	Yes	Making the block consisting of Herdman Street, Redgrave Street, Mathers Road and Rowley Ave safer - even if one way lanes are an option. There have been too many instances of cars speeding in excess, burnouts, reckless use of motorcycles without wearing helmets, and other reckless driving. This has occurred as children walk home from school.	My whanau and I have had to endure reckless driving over the past three years. Having lived in the area since the early 1990s, I can say that the area has deteriorated, and that includes reckless and dangerous driving. It's not just speeding; it's also excessive revving and toxic smoke from burnt tyres. My elderly mother, wife, preschool daughter and baby son deserve better. All ongoing complaints have ended with organisations and key individuals entering a cycle of referral (to each other).
8	Yes	Yes	A crossing on Mathers rd for Spreydon school	
9	Yes	Yes	Keep idiots off the road.	Nearly got run over by a car that overtook one which had slowed down to let me and my wife cross.
10	Yes	Yes	Cycle lanes on hoon hay road, speed bumps/traffic limit and better visibility on wyn/maryhill intersection during busy before and after school times	Fast drivers and very busy on hoon hay rd, hard for my children to cross the road, feels dangerous.
11	Yes	Yes	Right hand turn from Rowley Ave onto Halswell Road.	The amount of near misses that occurs at the Rowley Ave, Halswell Road intersection I am surprised we haven't had any serious accidents. The housing intensification going in to Halswell puts more pressure on Halswell and Sparks Road.

12	Yes	Yes	A pedestrian Refuge on Mathers Road outside Spreydon School, slower speed limits.	After school it is a dangerous game for children to get home, crossing Mathers Road and Hoon Hay Road poses a huge risk, Too often I have seen children running between moving cars to cross the road.
13	Yes	Yes	I find speed is an issue could they lower the speed limit	
14	Yes	Yes	An island or narrowing of the corner of Victors Road and Newland street to stop cars doing burnouts.	We have witnessed three accidents at the corner of Victors road and Newland street. These are boy racers taking the corner too fast or doing burnouts. It has resulted in a car going through the neighbours hedge into the side of her garage, other neighbour had a car go through their brick fence and into their front bedroom and a car mounted the curb and drove away on the rims of their tyres gouging the road. There have been more we have been told about.
15	Yes	Yes	More night lights	I think more lights on the road will help to prevent night crime
16	Yes	Yes	Speed signs perhaps, painted cycle space down hoon hay rd	Everyday I see drivers go through red lights, speed down hoon hay rd, I've seen a car go 80km+ and pass another car down there during the day. Drivers get impatient when there's no space to go around a right turning driver.
17	Yes	Yes	We need a pedestrian and/or cycle crossing across Hoon Hay Road. There are great cycleways on the Spreydon Domain side of Hoon Hay road which can be tricky to get to when Hoon Hay Road is busy. Enforce the 10min parking outside a Sharkey's on Hoon Hay road - the cars parked there block the view down Hoon Hay Road and make turning out of Lewis Street really dangerous.	Almost knocked off bike multiple times on the corner of Lewis and Wyn Street due to cars cutting the corner as they turn into Lewis Street.

			Love the changes down McBeath Street to make areas safer for cyclists.	
18	Yes	Yes	30kmh limit everywhere, make people change their fences so they don't run over children on the footpath when they exit their driveways, ban u turns outside the school gate, especially when it requires driving over the footpath, maybe just ban cars from the middle section of Maryhill ave altogether (i.e. convert it to 2 cul-de-sacs), enforce people parking their cars half up on the footpaths, every bus stop pair on hoon hay rd should have a safe pedestrian crossing nearby, most residential roads need to be narrowed, curve radii are way too big so you can't see oncoming traffic when you are crossing the road, extend the cycle lanes on hoon hay road, better maintained footpaths	My three children walk, scooter or bike to hoon hay primary. Most days they will have someone exit a driveway in front of them, a parent drive in the footpath in front of them while u-turning, or have to walk on the road to avoid a car parked in the footpath. The wide radius curves where samuel and gainsborough streets meet wyn street makes it hard to cross safely.
19	Yes	Yes		People go too fast on hoon Hay road heading towards Lincoln road by maryhill ave - I've nearly been hit there a couple of times
20	Yes	Yes		<p>We, along with a number of other families, come out of Lewis Street needing to cross Hoon Hay road to get across to Pennylane preschool, usually at peak times of traffic. This is a treacherous crossing with a slow moving toddler. A median crossing large enough for a pram is very much needed here.</p> <p>Given all of the side streets that have Lewis street as their entry to Hoon Hay road & the corresponding bus stop, I often see young people trying to cross at the lewis st/hoon hay road intersection to get home after catching the bus. I worry for the safety of young ones</p>

				crossing in particular, who tend to be higher risk takers.
21	Yes	Yes	Drivers need to concentrate	I don't have any but my ten year old grandson needs to be safe
22	Yes	Yes		
23	Yes	Yes	Crossing by the school in Mathers road	I walk my granddaughter to Pennylane. Crossing hoon hay road with a small child is terrifying
24	Yes	Yes	Moving the car parks on Mathers Road alongside Hoon Hay Park sideways rather than sticking out into the road so that vehicles can safely travel through, especially on the weekends.	
25	Yes	Yes	Improved safety for school students crossing Mathers Rd at intersection with Tankerville Rd	<p>Note: I asked my husband and 3 teenage children for their thoughts on this question, and everyone in our family came up with the same 2 issues.</p> <p>Issue 1: Intersection Mathers/Tankerville My 3 children, who attend Hillmorton High School, have all repeatedly told me (over the last 5 years) that there are safety issues for school students crossing Mathers Rd at the intersection with Tankerville Rd. A lot of the time, they are dependent on a car driver stopping to let them across, to be able to cross there. There is no pedestrian crossing, so drivers are not required to stop. Many students cross the road here to get to school, e.g., those who use the path through Hoon Hay Park that comes out opposite Tankerville Rd.</p> <p>Issue 2: Crossing Hoon Hay Rd, particularly near Lewis St and Smartlea St We strongly believe there needs to be a safe crossing point here.</p>

				<p>I think it would ideally be as close as possible to both Lewis St and Smartlea St.</p> <p>Personal experiences:</p> <ul style="list-style-type: none"> - Walking to/from preschool and other places with pre-school children and having to cross Hoon Hay Rd near Smartlea St. I could do it fine with the kids in the stroller but when I had older preschoolers on a running bike/bike (or walking), it wasn't very ideal at all. Sometimes I would wait for quite a while for a gap in the traffic that was big enough that I was confident to cross with my 3 or 4 year-old. Even then it often felt uncomfortable and unsafe. Similar issues when my kids were primary school age - the shortcut across the Smartlea St bridge is one we have used often and crossing Hoon Hay Rd has been the one negative part of that route. - One of my kids wanting to walk to school (Hillmorton High School) with a friend. Both lived south of Smartlea St (but north of Sparks Rd), but on opposite sides of Hoon Hay Rd. They wanted to walk to school together but there was no safe/easy place to cross Hoon Hay Rd in the right place, at a peak traffic time. They were year 7 at the time, so still reasonably young and short. - I know children who had to cross Hoon Hay Rd to go to Hoon Hay School, who had to either take a longer route to school or cross in a place with safety issues. - Biking myself and needing to cross Hoon Hay Rd to get into Smartlea St in the mornings on my way to work (I was coming along Hoon Hay Rd from Maryhill Ave). At peak times, this often involved a bit of a wait and going through a narrow gap in traffic. I also had to
--	--	--	--	---

				<p>choose between crossing to the middle of the road initially and then waiting in the middle of the road for a gap in the oncoming traffic (which felt very unpleasant) or waiting for a gap in the traffic from both directions at once (which could take a long time at peak times). As an adult, this felt like an uncomfortable and unpleasant place to cross at peak times - and I am a confident cyclist. I would not let my young kids cross there in the same way. I used to regularly take this route at peak times; I no longer go to work that way now but still use the route at other times.</p> <p>Other reasons why I believe a safe crossing is needed near Lewis St/Smartlea St:</p> <ul style="list-style-type: none"> - Lewis St is a major entry/exit point for people living in that part of Hoon Hay. Smartlea St is commonly used, not only by residents but also by people using the bridge at the end of Smartlea St. This has been a commonly used shortcut for pedestrians and cyclists for a long time. Now, we also have a major cycleway there. Smartlea St would be the logical entry point to that cycleway for many people living in Hoon Hay. - For people using the bus stops near there, it is some distance to the nearest easy/safe crossing point, especially at peak traffic times. This is particularly important for people with mobility impairments, travelling with young children, etc.
26	Yes	Yes	Lower speed limits	
27	Yes	Yes		A pedestrian crossing on Hoon Hay Rd near to Lewis St would enable safe access to the shops on Lewis St and the Penny Lane Childcare

				Centre and would link up with the only way across Heathcote River (for walking and biking) at the end of Smartlea St which is also the only route from Hoon Hay Rd through to Lyttleton St between Halswell Rd and Sparks Rd.
28	Yes	Yes		
29	Yes	Yes		
30	Yes	Yes		
31	Yes	Yes		
32	Yes	Yes		
33	Yes	Yes	Lower speed and cycle way	
34	Yes	Yes		
35	Yes	Yes		General difficulty crossing Hoon Hay Road with a toddler
36	Yes	Yes		I avoid walking my kids to preschool because we can never cross the road safely and that's close enough to preschool.
37	Yes	Yes		
38	Yes	Yes		
39	Yes	Yes	More pedestrian crossings	
40	Yes	Yes	Cycleways	
41	Yes	Yes		Very busy road! Difficult to get across to drop my child at Pennylane preschool

42	Yes	Yes		
43	Yes	Yes	Slowing down on Hoon hay - would be worth considering lights	
44	Yes	Yes		It can be stressful driving out of Penny Lane ELC everyday. You need to watch the traffic coming along hoon hay road. I am concerned that a car/truck could accidentally crash into me when I am leaving the ELC.
45	Yes	Yes	Safer crossings!! Especially near schools, daycares and on busy roads!!	We just can't cross the road!!!!
46	Yes	Yes	Safer crossing	
47	Yes	Yes		
48	Yes	Yes		
49	Yes	Yes	More 50km speed limit signs. A lot of people speed down Hoon Hay Road.	I pick my toddler up from daycare on Hoon Hay road twice a week. Sometimes it takes me a good 5 minutes to safely cross the road with my toddler.
50	Yes	Yes		I have one child at Pennylane and the other at Spreydon School. I see families trying to get across the road (myself included if I can't get a park at preschool) with kids and school bags etc. in tow. It adds extra stress to already busy times of the day for young families!
51	Yes	Yes		A crossing is really needed and would encourage more cycling and walking. It's so hard to cross hoon hay road in peak traffic. I drop my children at penny lane pre-school. I have had a near miss with my daughter on her balance bike when trying to cross the road.

52	Yes	Yes	<p>Speed limit needs to be reduced to 30 km/h on Leistrella Rd/Rydal St as this is a major commuting way for Hoon Hay Primary students.</p> <p>A safe crossing needs to be installed near to the Hoon Hay/Rose Str intersection. The intersection itself is highly dangerous in its current layout and it is very difficult for people to safely reach Pioneer park and/or commute to Cashmere High School across this intersection. This is compounded by the row of shops attraction pull-in/pull-out traffic.</p> <p>If/once Leistrella Rd is through-connected to Cashmere Rd its entrance from Hoon Hay needs to be treated similar to Kaiwara/Blakinston and Mavin to discourage through traffic and make it safer for pedestrians to cross the intersection area.</p>	<p>I have had several close calls with inattentive drivers and/or too fast vehicles when navigating the Hoon Hay/Rose Str intersection as pedestrian/cyclist. In 2020 a cyclist was killed at this intersection and it is just a matter of time for this to happen again.</p>
53	Yes	Yes	Remove the power poles which are in the footpath on sparks road and victors road	
54	Yes	Yes		
55	Yes	Yes	A road crossing thingy by blakiston and the weird private street like by the bus stop sorta it's hard to cross the road in the morning walking to cashmere high	I almost got hit by a bus crossing the road lol
56	Yes	Yes		Road is too narrow, it holds up the traffic when people trying to make turn to entering their home.
57	Yes	Yes		
58	Yes	Yes		

59	Yes	Yes	Mathers & Hoon Hay corner is becoming quite busy especially when wanting to turn right from Mathers onto Hoon Hay Rd. Domain Terrace has become too narrow since cycle lanes were put in and on street parking on Domain Terrace.	
60	Yes	Yes	<p>[Redacted name and address] will happily fully support better road safety in and around Hoon Hay. We have concerns at the T Intersection of Tankerville Road and Mathers Road.</p> <p>When turning right from Tankerville Road onto Mathers Road, in our opinion the barrier garden placed parallel to the Hoon Hay Park is making Mathers Road rather narrow to make a right turn safely. This is made worse when there are vehicles parked facing towards Hoon Hay Road.</p> <p>While we realise the barrier is to protect angled parked vehicles, would it work better if made slightly narrower and moved a few metres towards Fusilier Street?</p> <p>Another concern when driving along Mathers Road from Hoon Hay Road the above- mentioned barrier at times makes it difficult to proceed when traffic is driving towards Hoon Hay Road.</p> <p>Being pedestrians, we find trying to cross Halswell Road from Tankerville Road most difficult to get to the bus stop.</p> <p>We also regularly use Domain Terrace to visit our doctor. Since the cycle way has been installed it has become difficult to use Domain Terrace specially when there are vehicles parked on both sides. Perhaps narrow the cycle way. In our opinion it does not have a heavy cycle loading.</p>	

			<p>We have family we regularly visit in Stable Lane (off Domain Terrace). We find turning into Stable Court Lane off Domain Terrace quite difficult. The curbing and channelling have not been lowered to make for a smooth crossing. Could this be attended to? We trust you find these ideas helpful. Regards Colin & Win Loach</p>	
61	Yes	Yes	<p>The traffic light of Hoonhay rd and sparks rd causes a lot of traffic build with no separate left turning lane, seen a lot of crazy moments as people rush through orange/red lights</p>	
62	Yes	Yes	<p>Another crossing between Sparks road and Rose street, actually I would be for several more pedestrian and bike crossings all down hoon hay road. I see people all the time trying to cross with little ones. Also improved cycleways through Hoon hay. Many kids bike to Hillmorton high with no decent cycleways. Hoon Hay as a suburb in general needs to be less focused on single-occupancy vehicles and make space for pedestrians, public transport and bikes, particularly bigger roads like Hoon Hay road.</p>	<p>We have had to wait a long time to cross Hoon Hay road near Rose Street, it is dangerous without a crossing for little kids and people on bikes. We nearly have to run to cross safely, cars are going far too fast and visibility is poor because of on-street parking. Finding a cross walk to cross would add half an hour to the journey, this is not equitable. Lincoln road is also really dangerous at the top of Hoon hay. There needs to be better crossings for bikes and pedestrians trying to get to kura and work.</p>
63	Yes	Yes	<p>Speed bumps on roads such as Hendersons Road to slow cars down. We often see cars going at the speed of in excess of 80km/hr.</p>	<p>As above. As Halswell Road/ Lincoln road is getting busier, Hendersons Road and sparks roads, and hoon hay roads are getting used to by pass and traffic is increasing. Cars are driving in crazy speeds on wide roads such as Hendersons Road and sparks road. We are skid marks and there was an incident of car driving into a fence of a house. Too dangerous for everyone esp kids in the area.</p>

				Also clear road line on Mathers road would be good, current line on the road make some cars drive in the middle of the lane.
64	Yes	Yes		
65	Yes	Yes	A traffic island on Hoon Hay road near Rose St	Crossing Hoon Hay Rd near Rose St is always a hairy experience, particularly with children. It is a busy intersection with cars turning in lots of directions, plus poor visibility due to cars parked in order to access the shops on Hoon Hay Rd opposite Rose St, as well as for sports at Centennial Park. I would love to see something to keep pedestrians crossing around here safe - whether it's a traffic island or pedestrian crossing.
66	Yes	Yes		
67	Yes	Yes	Policemen	
68	Yes	Yes	A school crossing for Spreydon school on Mathers Rd by their Mather Rd entrance	It is very scary walking my child across Mathers Rd in the mornings to get to Spreydon school. It is a very busy road at that time and I would like my child and other Spreydon school children to feel safer crossing the road.
69	Yes	Yes	A pedestrian crossing at the end of Maryhill Ave, sparks road side for Hoon Hay school children crossing the street. A set of lights at the intersection of Halswell and Hendersons Road, trying to turn there is often dangerous in peak traffic.	I've seen too many people hooning up to that corner and nearly wiping out young children trying to cross the road, people are aware the children are there but often don't stop to ensure safety.
70	Yes	Yes	Lower speed limits on all the side streets	Too many near misses of accidents - car on car and pedestrians

71	Yes	Yes	Better speed humps on Rowley ave they still speed over them now . Reduced speed for the streets and right outside the school on Rowley ave and the early childhood /kindergarten on Mathers road	Rowley ave and Redgrave streets are subject to burn outs a lot . They speed up and down the area I'm worried that someone will loose control and crash .
72	Yes	Yes		When my son was about 5 years old, he tripped crossing Hoon Hay Rd in the way to school and banged his face, resulting in a bleeding nose. I had to make myself super wide and wave down traffic while trying to pull my bleeding, crying 5 year old to his feet and finish crossing the road. He was terrified that we would be hit by a car! Another time, I was in a wheelchair after foot surgery, and had to take the bus to and from work. I had to take the bus past my house, all the way to Wigram, and back again , adding an extra 30 minutes to my trip, so I could get off the bus on my side of the road, as it was impossible to cross Hoon Hay Rd in front of the community center in a wheelchair.
73	Yes	Yes	Speed cameras on Hoon Hay Road, speed is a huge issue during dark hours	We lay in bed at night waiting for the sound of a crash as certain cars are traveling over 100km often at night. We also worry as our neighbors fence is too high next to our drive so we don't see people on the footpath until we are out of the driveway
74	Yes	Yes		Halswell Rd is super busy especially morning making it difficult for road users turning right from Rowley Avenue
75	Yes	Yes		
76	Yes	Yes	Bike lane down Henderson's Rd from Sparks to Princess Margaret	

			Hospital, so many people bike this way and is far too narrow especially on the corner!	
77	Yes	Yes	Something to stop people speeding down Henderson Rd end of Rowley Avenue due to being close to the shops and multiple bus foot traffic is plentiful.	Hoon Hay generally has heavy foot traffic, with the majority being young kids, with close to 10 preschools, primary schools, and high schools in or near this suburb. I feel it is important for drivers in high traffic or near schools/shops/parks to be reminded of their surroundings that are more visible if it be pedestrian crossing or road bumps.
78	Yes	Yes	Bus stops down sparks road between hoonhay and Henderson's.	
79	Yes	Yes	Anything that stops people using it as if they are at Speedway	Don't think there is ever a night goes by without someone using Hoon Hay Rd as a race track.
80	Yes	Yes		Continued investment in cycling infrastructure. The painted cycle lanes on Hoon hay road appear out of and disappear into nowhere. While there is a parallel cycleway on streets to the east there is no access to it between Lincoln road and rose street. Cyclists are vulnerable to impatient motorists. The council is not able to deal with impatience but it can engineer safer solutions, remove on street parking and lower speed limits.
81	Yes	Yes		
82	Yes	Yes	There also needs to be a crossing on Hoon Hay Rd down by Rose St, it is so difficult for children to cross the road to get to school, Pioneer etc.	In particular coming back from football it can take up to 10 minutes to get across the road on a Saturday morning. My son also has great difficulty getting across the road to get to school (Cashmere HS)

83	Yes	Yes	More judder bars for side streets	Usually late at night we get alot of fast louder style cars coming down our st
84	Yes	Yes	Pedestrian crossing across hoon hay road, at the junction with Rose street. There are shops and bus stops here, lots of people / kids crossing the road and near misses! Also, speed bumps at the top of Kaiwara street - there are speed bumps from halfway down, but still people speeding up the top of the street where there aren't any.	
85	Yes	Yes		
86	Yes	Yes	Maybe more police patrols at night around our local streets to reduce young racers who are often speeding and doing burnouts and donuts.	
87	Yes	Yes	Some more zebra crossings as Hoon hay school is around so children need to be safe	
88	Yes	Yes	Possibly speed bumps down some of the streets.	There are constantly cars speeding down Dalkeith where I live at all hours of the day. There a lots of children during the day and it is concerning to hear cars going exceedingly fast. I feel speed bumps would force them to slow down.
89	Yes	Yes	It's a very high use road and the condition of it needs to be maintained.	
90	Yes	Yes	Some centre islands would be handy. Hoon hay Road is long and straight and cars travel fast. And would help pedestrians get to and from OLA and Hoon Hay. Aside from just a crossing. The corner between Maryhill and muirson is busy and it's dangerous	Witnessed so many close calls. Muirson, traffic is usually backed up in the morning so cars usually sneak out to turn right, sitting amongst backed up cars, nudging out in the hope someone coming from BP down hoon hay will stop.

			getting out of Muirson and Maryhill. These are both busy intersections. Maryhill onto Hoon Hay Road is essentially a blind corner. It's especially dangerous turning out of there around school pickup for OLA and Hoon Hay.	And Maryhill is just a gamble as to whether something, and what is, and how fast someone is, coming around the corner. Especially dangerous trying to cross with young kids on scooters to get to Hoon Hay, OLA and Cherry's. So many young kids access these facilities via Maryhill. Something definitely needs to be done!
91	Yes	Yes	More island crossings, especially across Lincoln Road near the Tankerville Road intersection as so many kids get off the bus and then it is dangerous to cross the main road in rush hour traffic so an island crossing would be very helpful.	
92	Yes	Yes		Cars parking right up to the local dairy on the footpath at McCarthy St, which makes it difficult for people like myself in scooters, prams and wheelchairs to get past safely or to access the shops. This has been an ongoing concern as driver has been distracted that instead of reversing out, car went forward but luckily it was stopped in time.
93	Yes	Yes		
94	Yes	Yes	Either lowering the speed to 40 around our streets or putting in speed bumps down Wyn and Maryhill as people drive so quickly with children crossing for school	Something needs to be done about the Lewis Street corner on a daily occurrence I got to turn right on Wyn towards Downing and almost get hit in my car as people cut the corner
95	Yes	Yes		
96	Yes	Yes	Speed bumps on Downing Street, Dalkeith St, Samuel St etc. Cars go racing down those streets. The noise is disruptive to residents and	Our cat and our neighbour's cat have both been hit by cars on Downing Street.

			many pet cats have been injured or killed by speeding vehicles.	
97	Yes	No	<p>Stop parents parking on both sides of murison street to pick up children as unsafe and creates a single lane road on a busy street and you can't see.</p> <p>I don't support another crossing as there is lights on corner where schools are of hoon hay road and sparks road and also crossing on sparks road outside hoon hay school. There is also a crossing further down by dpredon school. The road is already backlogged in morning with cars as hoon hay is a main thoroughfare road</p>	
98	Yes	Yes	<p>I support a pedestrian crossing on Hoon Hay Rd between Mathers and Sparks but I think better option would be a couple of crossings like the ones on Hoon Hay Rd between Mathers and Halswell Rds. They have a protected small island in the middle of Hoon Hay Rd so when crossing you only have to be concerned with traffic coming from one direction. I understand that the zebra-style crossing forces the traffic to stop if someone is waiting to cross but this could be unreasonable for traffic flow. Perhaps another option could be to have lights at the Lewis/HoonHay Rds intersection.</p>	
99	Yes	Yes	Encourage light rail development	I have to use a walker now to cross the road and sometimes motorists are unkind
100	Yes	Yes	Lights at tankerville and Lincoln/halswell	
101	Yes	Yes	Assess zones around schools	Outside the schools at pickup/drop off is scary concerning the speed of some drivers with inadequate

				crossings for pedestrians and also unsafe parking
102	Yes	Yes	Making speed signs more visible and more signs along the roads.	Lots of speeding and inconsideration for people.
103	Yes	Yes	Traffic lights plus zebra crossings	Experienced the lack of road safety all the time unfortunately
104	Yes	Yes	Zebra crossings, pedestrian safe crossings, road signs etc	Yes! Especially when trying to cross roads with an animal or pram. People don't slow down or give way. Plus the crossing on Hoon Hay rd and between Mathers/Sparks road, was nearly hit by a car!
105	Yes	Yes	More pedestrian crossings or pedestrian refuges	It is difficult to find a place to cross the road during busy times
106	Yes	Yes	Add speed cameras, or CCTV traffic cameras between Mathers road and the Lincoln Rd traffic lights, as there is a frequent late night speeding, dangerous driving and burn-outs between Mathers and Upland Rd. Or, speed bumps put on the Spreydon school side of Upland Road to deter racers and reduce daytime speed near school.	Have heard a lot of late night hooning and skids up and down the road between Mathers and Upland Rd, once resulting in a car smashing into the metal bars on the crossing near Upland road then screeching off down the road. We've also had a young local driver who repeatedly swings around the corner too fast and has once spun wide and hit a parked car before speeding off again. Lots of kids crossing the road along that stretch of road, as there is an intermediate and high school there, so drivers need to slow down!
107	Yes	Yes	A pedestrian crossing and lights at Hoon Hay Rd and Rose Street would make it much safer for everyone to cross the road	I have three young boys, and it is so hard to try and cross the road around Hoon Hay Rd and Rose St with the little ones in tow
108	Yes	Yes	Traffic calming and/or speed bumps to stop boy racers using some of the back roads as race tracks.	Most days I hear multiple cars race past (I would estimate 60 - 80 km/h) along Downing Street. We have a 11 month old who is just starting toddling and we are having to put up a gate on our drive, this keeps him in but it shuts our neighbors out which is sad.

109	Yes	Yes	A crossing island on lyttelton st before lincon rd	So many hillmorton kids crossing and no where for them to get across lots of turning traffic on neville and Edinburgh and all the kids trying to get through to domain. Busy street, kids often making crossing mistakes and not checking behind them for turning traffic ect.
110	Yes	Yes		My son was nearly struck by a driver as we crossed the road near Bencard Street. People speed along there.
111	Yes	Yes	Lower the speed limit on Hoon Hay Road - 50kmh is too fast for such a busy road with four schools nearby. The trucks rumble past at such speed they literally shake our house!	With the continuous line of traffic, cars pulling out from side streets and cyclists, it's almost impossible to cross Hoon Hay Road in the morning to get to the bus stop.
112	Yes	Yes	Reduced speed zones during school drop off / pick up hours given how many schools are in the area	I often walk a section of hoon hay road to drop my son off to preschool (1 block) he often scooters or bikes. It is really hard to communicate with him to slow down or stop on this road as the traffic is so loud. One day I was telling him to stop as a car was reversing out and he stopped right in the drive way of where it was reversing. Luckily the car saw him. I also feel anxious crossing Hoon Hay road with a pram or when he is on his bike especially around the corner near maryhill ave. Cars go so quickly around there.
113	Yes	Yes		People doing u turns in cars when bikes are approaching
114	Yes	Yes	We are concerned about the speed and volume of traffic. Add more road crossings, there aren't enough and there is fast traffic	
115	Yes	Yes	A pedestrian crossing would make it safe for people crossing the road especially children. Maybe reduce speed limits too.	Yes off late people have not been driving responsibility for example, not indicating when turning

116	Yes	Yes	Extending the 40km school zone further down Hoon Hay Rd	
117	Yes	Yes	Lower speed	Boy racers
118	Yes	Yes	Lower speed limits near schools and community centres	It's very tricky to cross the road near Maryhill and across Hoon Hay Road at rush hour - dangerous for kids
119	Yes	Yes	Have marked crossings so cars know to stop	Yes trying to cross at the islands in the middle of the road with kids is very scary
120	Yes	Yes	Safety crossings	No safe crossings on Hoon Hay road for children
121	Yes	Yes	I do support the pedestrian crossing however with the traffic volume, a crossing should have a centre island with enough room for several people. Lowering speed limits past congested areas with fixed camera to patrol. Avoid raising and lowering speed limits unnecessarily.	Yes. Because it is so difficult to turn right off Mathers Rd due to the amount of traffic these days, I bypass and use Cedar/Kevin Street and turning around Hoon Hay Park children's playground. The corner is slow and tight. Just this morning a vehicle approaching ran wide. Prominent signs are necessary with dotted yellow lines for no parking beside the playground. Road narrows to make it worse and 2 storey house on the corner parks (long term) a vehicle on the road. This is a dangerous example of traffic engineering.
122	Yes	Yes	I support the pedestrian crossing maybe a little way north of the intersection with Lewis St. Repair all pot holes. Put no parking signs on Hoon Hay Rd close to Mathers Rd.	Kevin St, where it runs past Hoon Hay Park and around the bend into Cedars St. If waiting to turn from Waters St into Cedars St, particularly a right hand turn towards the park, there are some dangerous issues. People coming towards you from Kevin/Cedar are often travelling very fast. I would like to see a 15kmph sign from just beyond where Newland St turns into Kevin St, and no parking signs on both sides of the road

123	Yes	Yes	The crossing at Hoon Hay School is great.	
124	Yes	Yes	Reducing the speed limit on Hoon Hay road	Crossing the road and having cars speed up.
125	Yes	Yes	Reducing the speed limit on Hoon Hay road	Some scary moments crossing the road due to heavy traffic
126	Yes in the area of Lewis / Hoon Hay Road, Alternatively pedestrian refuges in the stretch of road named above.	Yes	Install reflector panels on the flower beds in Mathers Road between tankerville and redgrave street, this was request was made to Jeremy Reid CCC Parks division in january but nothing has happened.	Yes during the winter months when the sportsfields at Hoon Hay Park in Mathers Road and fully utilised on Saturday Mornings from 8:30 onwards. It is dangerous driving in Mathers road between Fusilier and Tankerville with Parallel parking on one side of the road, and angle parking on the opposite side of the road. If you meet a car coming towards you it is almost impossible to get through the clear space and if you meet a bus it is impossible to pass. Another danger is young sports players walking out from between cars, the way to resolve the problem would be to have a no parking restriction on the parallel parking side of the street as was enforced when the Pacific 3 series event was held over 2/3 days in November 2023. This event set a precedent that made for much safer traffic movement. Side streets of Redgrave, Fusilier st plus Martell and Hussar place as well as waters, kevin, cedars and downing streets would still provide sufficient parking spaces for sports attendees.
127	Yes	Yes	With Regards to the corner of Mathers & Hoon Hay road and the increasing volume of traffic in the area, this intersection is a bottleneck at peak traffic times especially with school pick ups and drop offs. Traffic lights would help regulate traffic flow.	Yes when turning right from Lewis street into Hoon Hay Road, Cars parked on Hoon Hay road from the corner of Lewis street to approx Hoon Hay road block a drivers view of what vehicles are coming along hoon hay road heading to sparks road. By putting in yellow lines between Sharkeys bar to no hoon

				hay road there would be unrestricted views of cars coming up on Hoon Hay Road.
128	Yes			
129	Yes	Yes	Speed restrictions around the schools	Busy around schools





Pacific Fleet Windsurfing is a community sports club that provides windsurf training and access to windsurfing equipment for people of the Pacific. The club was formed by members of the Christchurch windsurfing community who share a vision of getting more children of Māori and Pacific descent out on the water to experience the mental wellness and physical enjoyment that windsurfing can provide. The members are committed to working to get kids back into nature where they belong for mental health.

Our Mission

Create a 'one of a kind' windsurf club experience that exceeds member expectations by offering the highest levels of service, and social activities in a comfortable, relaxed atmosphere.

Our Values

Respect, Honesty, Commitment, Drive, Camaraderie, Support of one another, Mental Wellness, Fun and Enjoyment.

Our Vision

Strive to be the Club by which other clubs in our field are measured.



We have recently become aware of the proposed Len Lye sculptural installation for Scott Park, and became a little concerned when we heard that the project has a large footprint. Accordingly, we felt it would be timely to make contact to seek information on how the Scott Park redevelopment might impact on our current activities. We have several questions as follows:

- *Will the installation mean a change to the number of available carparks?*
- *Will there be any changes to our ability to access the area with trailers re transport of boards and equipment?*
- *Will there be any changes with regard to our ability to access the water?*
- *Anything else that you can think of that we will need to do differently in terms of our operation at Scott Park as a result of the proposed changes to the area?*

We are keen to work with you to ensure that our operations can continue unhindered, without impacting on your plans for the area.



Te Ihutai Coastal Pathway

Community
Board Deputation
15th June 2023

Hanno Sander
Tim Lindley

www.ccp.org.nz

info@ccp.org.nz



Our Journey so far...

- Goal: Pathway for Everybody
- Look and Feel that is of this place
- Restore landscape & protect estuary
- First priority was pathway
- Now in position to make it special



Our Mission:

The purpose of the Christchurch Coastal Pathway Group is to promote and facilitate the creation and use of an international-standard coastal pathway from Ferrymead to Scarborough Beach, Sumner for the benefit of the people and city of Christchurch.



Making it Special

- Community planting sessions
- Furniture & signage
- Events
- Engaged Matapopore to design artwork
- Supported 3 sculptures along pathway
 - Pou at entrance of Ihutai by Fayne Robinson
 - Flight by MPCC by Llew Summers
 - Third sculpture is today's topic



Len Lye

- One of NZ most famous artists, born in Lyttelton 1901, died 1980
- Painter, Writer, Theorist, Teacher, Film maker, Sculptor
- Exhibits all over the world including Museum of Modern Art in NYC, New Plymouth, but none on South Island
- Water Whirler on Wellington waterfront
- Wind Wand on New Plymouth Pathway



“Grass”

“This quiet, gentle work is reminiscent of breezes fanning the marram grasses along the shorelines of New Zealand.”

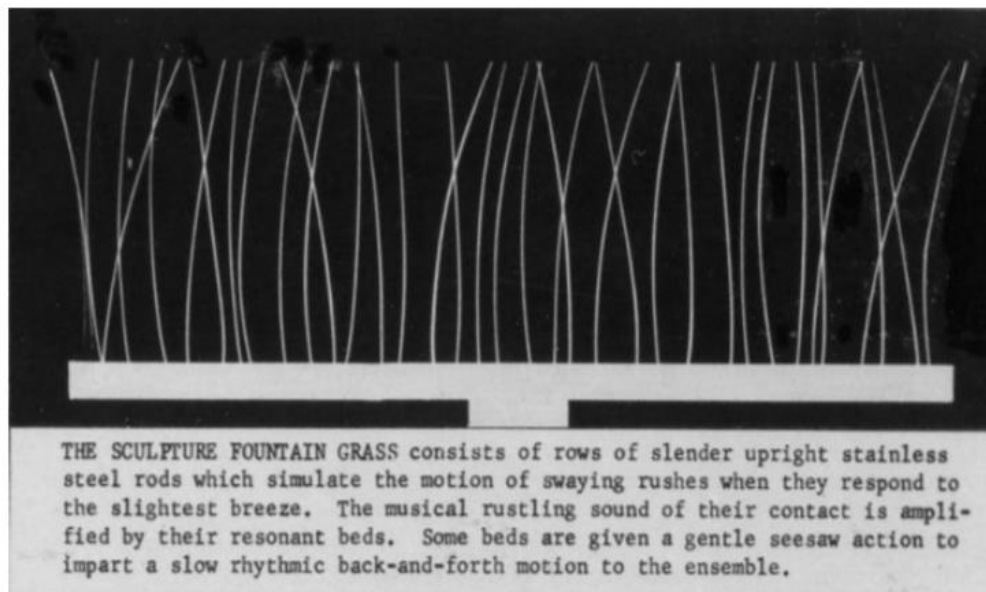
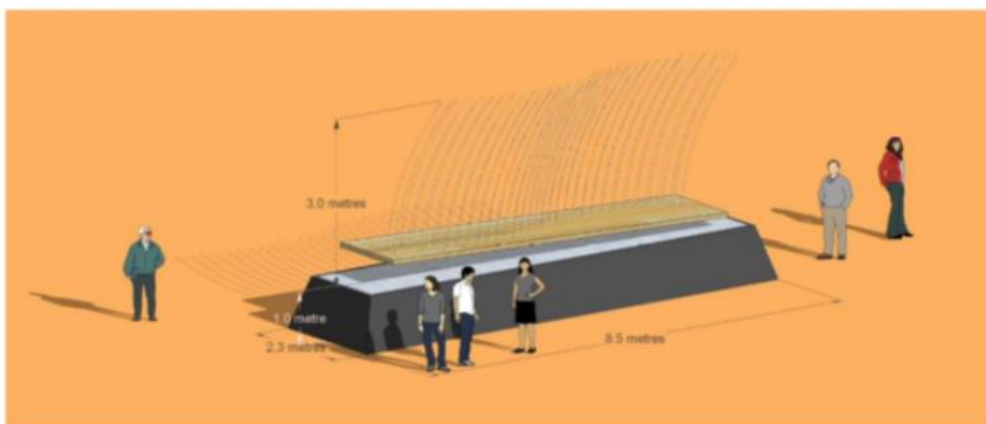

THE SCULPTURE FOUNTAIN GRASS consists of rows of slender upright stainless steel rods which simulate the motion of swaying rushes when they respond to the slightest breeze. The musical rustling sound of their contact is amplified by their resonant beds. Some beds are given a gentle seesaw action to impart a slow rhythmic back-and-forth motion to the ensemble.

Collaboration with the Department of Mechanical Engineering, University of Canterbury.

- Professor Shayne Gouch has built a number of large Len Lye sculptures
- His team of students are designing and building “Grass” as a “final year” project- goal is to complete this December
- Costs for materials to be shared between University and Coastal Pathway Group

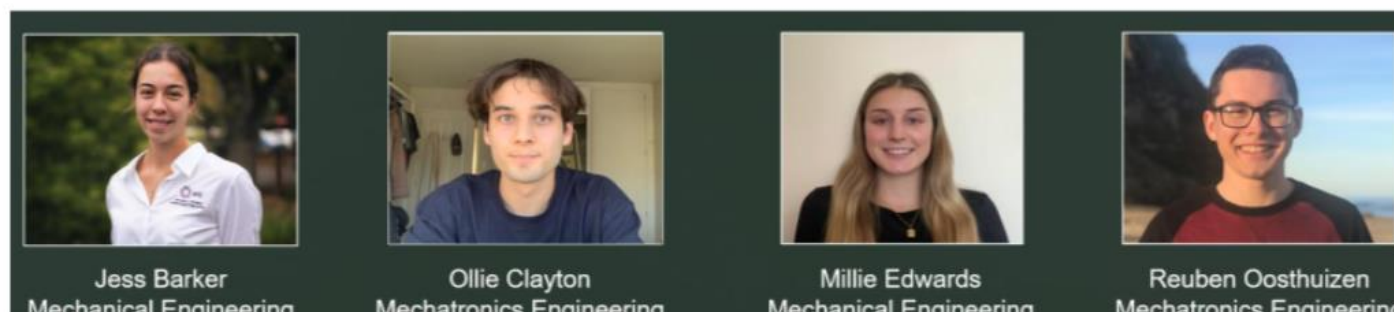

Scott Park- now



Scott Park Concept Plan



Landscape Concept

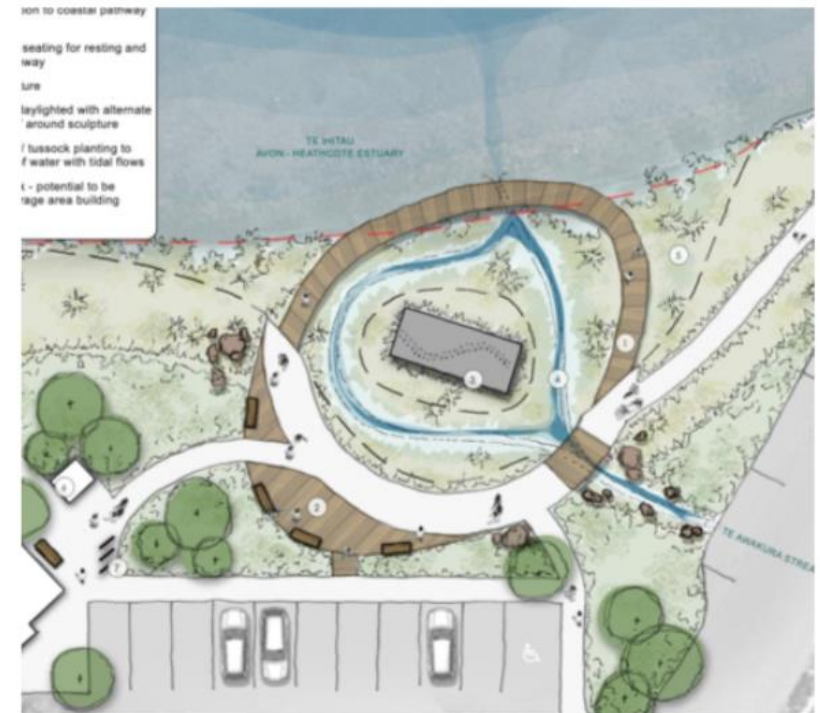

Ko wai mātou? Who are we?
...
Manuka Rangatahi

whakatauki that guide this kaupapa



Brougham Street - SH76



Cornelius O'Connor Reserve



Organisations who have formally expressed support for this initiative



Request for support & prioritisation of funding

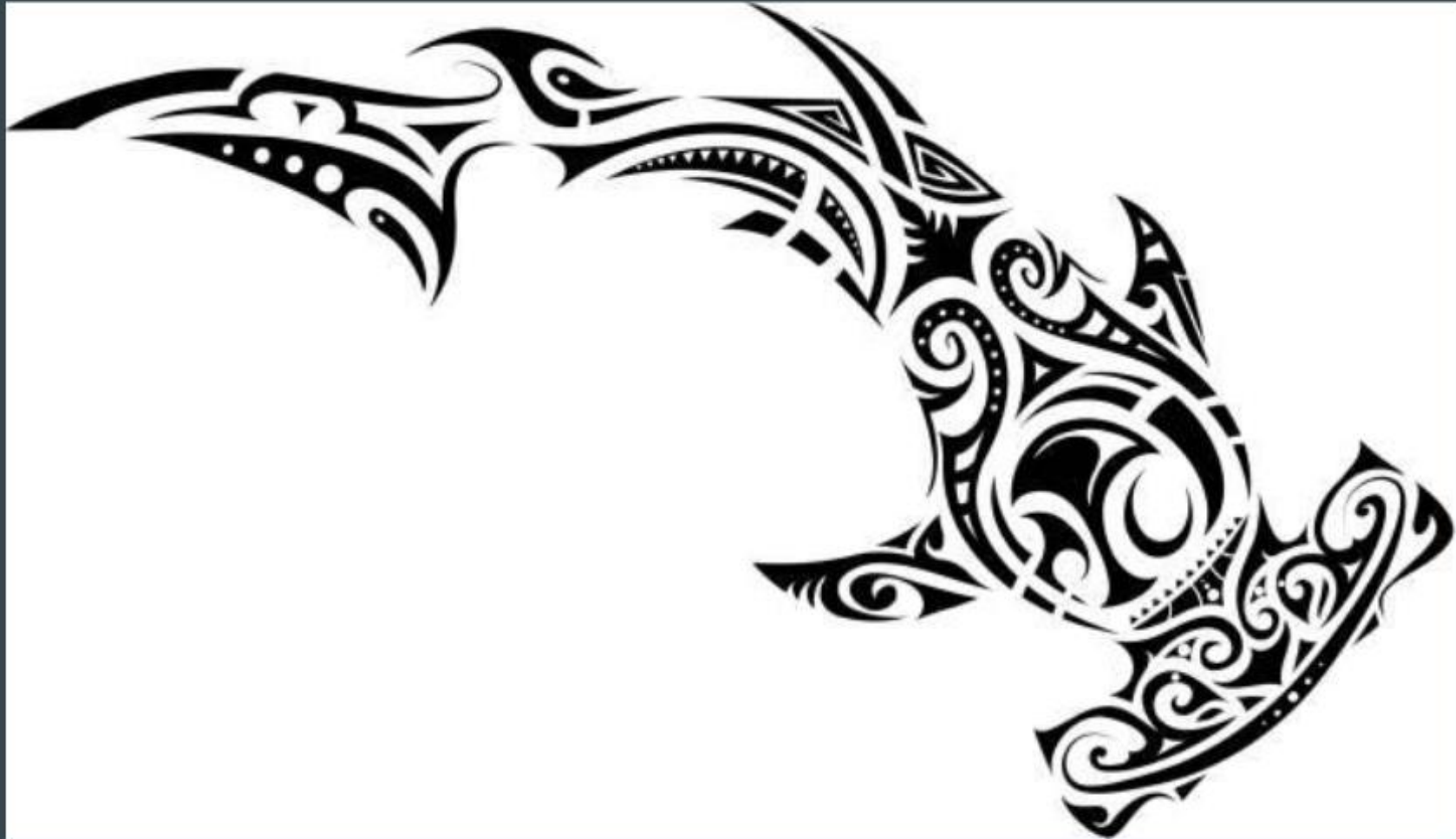



Addington Farm - Community Garden,
31 Parlane Street,
Addington,
Christchurch 8024.
14th June, 2023

To Callum Ward,
The Chairperson ,
Waihoru Spreydon-Cashmere-Heathcote Community Board,
Beckenham Service Centre,
66 Colombo Street, Beckenham
Christchurch 8154

Kia ora Callum,
We would like to express the support of our organisation for Manuka Rangatahi Rōpū's proposal to apply for funding for a half-sized Basketball Court at the Cornelius O'Connor Reserve in Addington.

Addington Farm has a vision to see the people and place of Addington thriving in tumanakō. We recognise that there is significant value in the project proposed by the rangatahi. We can see that it would support our young people to thrive & it would support them to grow in tumanakō.

Ngā mihi nui,
Sean Pawson
Chairperson of Addington Farm Board of Trustees.



Addington Neighbourhood Association Incorporated,
21 Church Square ,
Addington,
Christchurch 8024.
14th June, 2023

Callum Ward,
The Chairperson ,
Waihoru Spreydon-Cashmere-Heathcote Community Board,
Beckenham Service Centre,
66 Colombo Street, Beckenham
Christchurch 8154.

We would like to express the support of our organisation for Manuka Rangatahi Ropu's proposal to apply for funding for a half-sized Basketball Court at the Cornelius O'Connor Reserve in Addington

There have been long-term, ongoing issues with out-of-control youth behaviour in Addington and a Community Safety meeting was held in November of last year to discuss the problem. The issue has previously been raised at a number of Addington Neighbourhood Association meetings and was discussed at length at that public November Community Safety meeting. Some of the issues raised related to theft of property and cars, vandalism, assaults and threatening behaviour, which the Police seem to be unwilling or unable to deal with.

This proposal for a half-sized basketball court has been suggested to Wilby le Heux, a Manuka Cottage volunteer youth worker who has been engaging with local youth, as a way of keeping youth involved and occupied in the community in a positive way, both now and in the future. A similar proposal was apparently put to the Spreydon-Cashmere Community Board several years ago.

Yours sincerely

Cathy O'Malley (Chairperson)

Gareth Wright (Secretary)

Graham Robinson (Treasurer)



22 Brougham Street
Addington
Christchurch 8024
Ph 03 3662909
office@addington.school.nz

15 June, 2023

Ki te Waihoru Spreydon-Cashmere-Heathcote Community Board, Tēnā koutou katoa.

I am writing to express my support for the Mānuka Rangitahi 1/2-court basketball project proposal.

The Cross Over Trust Primary Project has been active for over a decade at Addington Te Kura Taumatua, with the aim of supporting people to develop a thriving, woven community. The boys of Mānuka Rangitahi went to school in Addington, and it has been great to see them staying in our community and looking for ways to see our community thrive. We particularly enjoyed having them involved in coaching and supporting the children's touch rugby teams.

As you know, the Addington community is disconnected due to the physical barriers of Moorhouse Ave and Brougham St. Donte and his friends from Mānuka Rangatahi have identified a lack of facilities for young people between these two barrier roads. The proposed basketball 1/2 court would benefit local families and rangatahi, being easily accessible and providing opportunities for skills development, friendship & fun.

Addington Te Kura Taumatua supports the initiative proposed by Donte & the Mānuka Rangatahi team. We believe it will have positive impacts for youth, families, and adults in our community.

Ngā mihi,



Jo Robertson

School-Community Liaison
The Primary Project
Addington Te Kura Taumatua



Cross Over Trust

244 Lyttleton street
Spreydon, Christchurch 8024
P.O Box 33-048 Barrington
Christchurch 8244

Kia ora Waihoru Community Board,

We are writing to you to show our support for the 1/2-court basketball project proposal.

Cross Over Trust has been running for over 30 years in our communities and we continually strive to uphold and develop our vision of "Thriving Woven Communities" and our mission of "Growing resilient children of youth and character". With the hard mihi of our staff and many volunteers, we serve the young people in our area.

Donte and his friends from Manuka Rangatahi had identified that there was a great opportunity to build a court that was accessible to local rangatahi. The nearest publicly accessible basketball courts are some distance away and involve crossing Morehouse Avenue (4 lanes) or Brougham Street (State Highway 76).

Proximity matters significantly to Addington rangatahi as they often do not have available vehicle transportation. The proposed basketball 1/2 court would benefit hundreds of local rangatahi as it would provide positive opportunities for skills development, friendship & fun.

The cross-over trust board supports the initiative proposed by Donte & the Manuka Rangatahi crew. We support the initiative as it will positively impact rangatahi in the wider Addington area.

Nga mihi

Rachael Green
Board of Trustees Chair
Cross Over Trust





9th June 2023

Tena Koutou Waihoru Community Board,

Hillmorton High School - Tigers Sport are writing to you to show our support for the 1/2-court Basketball project proposal.

We are the local high school in the area in which many students who live in Addington attend. Tigers Sport was established for the provision and administration of sport at Hillmorton High School. In the 21st century educational climate the demands on resources; financial, human and physical, have been such that the provision of sporting opportunities has been adversely affected. The Tigers Sport Committee fulfils a governance role at Hillmorton and is focused on increasing the participation rates of youth in sport and to improve the performance of the school teams on a local, regional and national level. Simply our motto is 'Play and Excel'.

Donte and his friends from Manuka Rangatahi had identified that there was a great opportunity to build a court that was accessible to local rangatahi. The nearest publicly accessible basketball courts are km's away and involve crossing Morehouse Avenue (4 lanes) or Brougham Street (State Highway 76).

It is pleasing to see students taking the initiative with projects like this as it reinforces the importance of active play. Many physical, social and mental/emotional benefits come from rangatahi being active and it reduces the likelihood of them being engaged in anti-social behaviours. We as a school and committee strongly encourage the community board to support our young people. This space reinforces the values of turangawaewae and whanaungatanga providing authentic ways in which rangatahi can potentially model kaitiakitanga in the community. They are our future leaders.

Proximity matters significantly to Addington rangatahi as they often do not have available vehicle transportation. The proposed basketball 1/2 court would benefit hundreds of local rangatahi as it would provide positive opportunities for skills development, friendship & fun.

Ngā mihi nui

Matt Sharr - sharrm@hillmorton.school.nz 021 715 579

Director of Sport

Tigers Sport - Hillmorton High School

**Te Kura Tuarua o Horomaka
Hillmorton High School**

Tankerville Road, P O Box 33-115, Christchurch 8244, New Zealand
T: 64 3 338 5119 F: 64 3 338 1609 E: admin@hillmorton.school.nz W: www.hillmorton.school.nz



15 June, 2023

To the Waihoru Spreydon-Cashmere-Heathcote Community Board,

We are writing to express our support for the Mānuka Rangitahi 1/2-court basketball project proposal.

Mānuka Cottage has existed for 30 years with the purpose of encouraging and supporting a strongly connected community. For the last few years we have been pleased to host youth work in our facility, with that becoming a more formal partnership this year with Wilby Le Heux as a Mānuka volunteer leading Mānuka Rangitahi.

The Mānuka Rangatahi team have identified a lack of facilities for young people in the Addington community as an opportunity to be addressed. Basketball is a very popular sport, but the only basketball courts in the neighbourhood are across the main highways of Brougham St and Moorhouse Ave. Having a basketball court within our neighbourhood would be of huge benefit for local families and rangatahi, providing opportunity for positive peer interactions, as well as bringing people in to an under-utilised area. We believe that this will have positive flow ons for the safety the wider community.

At our meeting on Monday, Mānuka Governance Board agreed to support this initiative proposed by Donte and the Mānuka Rangatahi team. We are excited by the opportunity it presents for supporting a connected community. As the planned court is right beside our facility, we would like to be included in the design phase as much as possible

Ngā mihi,



Jo Robertson
Acting Chair
Core Governance Team
Manuka Cottage
Addington Community House Incorporated



**St Mary the
Virgin**

CHURCH SQUARE,
CHRISTCHURCH
Postal: 21 Church Square,
Addington, Christchurch 8024
Email: anglicanstmary@gmail.com
Facebook: St Marys Addington
Web: stmarysaddington.org

14th June 2023

Waihoru-Spreydon-Cashmere-Heathcote Community Board

Re: Manuka Rangatahi Ropu proposal.

We at Saint Marys Anglican Church, wish to express our support for the proposed 1/2 court to be located in the Cornelius O'Connor Reserve.

At the Community Safety meeting held on 30th of November 2022, organised through the Addington Neighbourhood Association, the significant issue of youth problems in our increasingly high-density housing areas was raised and as such the noticeable symptoms of alienation, detachment being witnessed within the Addington Community.

Our community feels that there is a lack of sporting facilities in Addington and with the Addington "Magpies" Rugby League team moving from Addington Park to Domain Terrace, a loss of an identifiable pathway for young people to connect to was mostly removed.

The initiative proposed by Donte Tekii of a half court being placed at the Cornelius O'Connor contains a number of positive aspects for our community.

1. Our Suburb needs sources of connections and places to gather, especially for young people. With the loss of the "Magpies" Rugby League team there is no other sports teams and only limited green space
2. The proposed location would be easy for pedestrian access (not too far to walk to)
3. Would be located in a lovely space with minimal noise disruption to residential properties with the industrial area across Harman Street
4. The location of the children's play area and Manuka Cottage adds to the supervisory aspects of the placement.
5. This proposal would encourage residents to exercise while engaging in an enjoyable activity and developing new skills

With Manuka Cottage also supporting this project, we at Saint Mary the Virgin parish, hope that this project will be considered favourably by members of the Community Board.

Yours sincerely



Rev'd Helen Roud
Vicar
St Mary the Virgin, Addington



Gail Collier
People's Warden

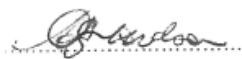

Allan Hudson
Vicar's Warden