



Hearings Panel
MINUTES ATTACHMENTS

Date: Monday 4 July 2022
Time: 9.00am
Venue: Duvauchelle Treated Wastewater Options,
Committee Room 2, Level 2, Civic Offices, 53 Hereford
Street

TABLE OF CONTENTS	PAGE
6. Hearing of Submission / Ngā Tāpaetanga	
A. Presentation - 46914 Akaroa Golf Club	3
B. Presentation - 46777 Kevin Simcock.....	19



Akaroa Golf Club strongly
supports Option 1

The beneficial reuse of
the Duvauchelle
wastewater on the
Akaroa Golf Course

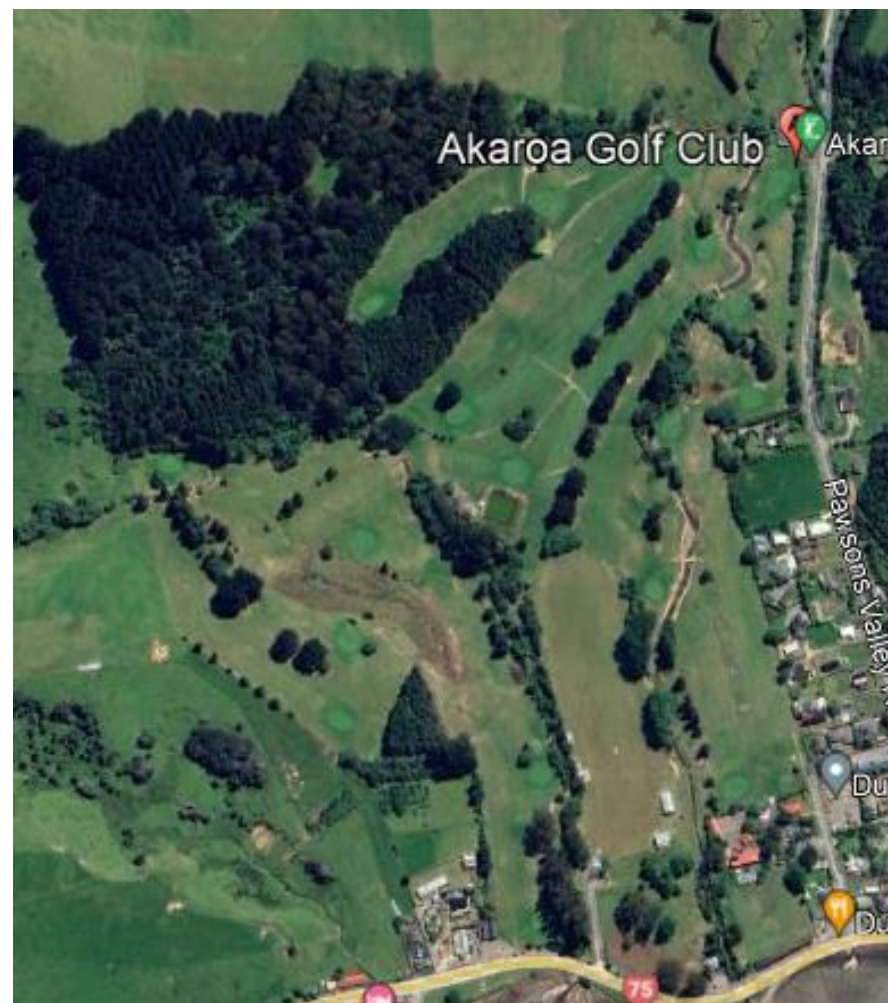

Who Are we?

Kevin Simcock : Convenor of the Wastewater Sub Committee

Ken Elliott : Club Captain Akaroa Golf Club

Option 2

- The Golf Club does not support Option 2
- It is not a beneficial reuse
- It degrades the land

Option2 is a Bad Choice

Beca have noted in their reports that with the lower standard of treatment proposed for Option 2 it will require "managed access"

This is not appropriate for designated recreational land

Collecting golf balls from those areas will carry health risk.

Option 2 must at least allow for full treatment of the wastewater as for Option 1. This increased cost makes it similar to Option 1.



Why Choose Option 1

- Social and Economic Wellbeing
- The Golf Course and Club are vital assets in the Banks Peninsula and Christchurch community

Akaroa Golf Club in the Community

- Annual Charitable Tournaments raise more than \$20,000 per year for community projects.
- Akaroa Golf Club runs raffles at the Club and the Duvauchelle Hotel. The annual spend with the local butcher is more than \$12,000 with additional spend for other prizes at other outlets in Akaroa .
- Akaroa Golf Club is noted in NZ Golf publications as a “Hidden Gem”. This attracts visitors to the area who stay in local accommodation and spend at local restaurants, shops and bars.



Akaroa Golf Club in the Community

- There are 30 junior (under age 20) members in the Club. It is an important outlet for the younger members of the Peninsula Community.
- The Golf Club building is used by local organisations such as the Bridge Club, Yoga Classes, Community Meetings, Weddings, Funerals. It has the size, heating and facilities to properly service these organisations and events.
- The Golf Club works closely with the annual Duvauchelle A&P show.

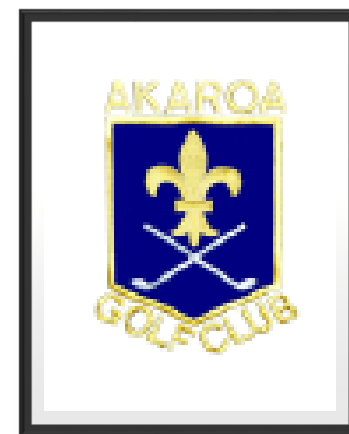

Akaroa Golf Club and the Environment

- Environmental Wellbeing
- Reusing the wastewater on the golf course provides an opportunity to enhance the environment

Enhancing the Environment

- The water take from the stream will be much reduced allowing for increased summer flows and a better quality water all year round. This will enhance the fish and plant life in the stream.
- Planting on the course using natives (already tested with the Duvauchelle wastewater) will encourage and feed the local bird life.
- The management of water through drainage and planting will improve the playing standard of the golf course and properly manage the overland flow to adjacent properties.



The Concept



a wetland aesthetic..

- To out of play / existing low lying areas to in essence, 'lift the playing corridors'

What this looks like on the ground?

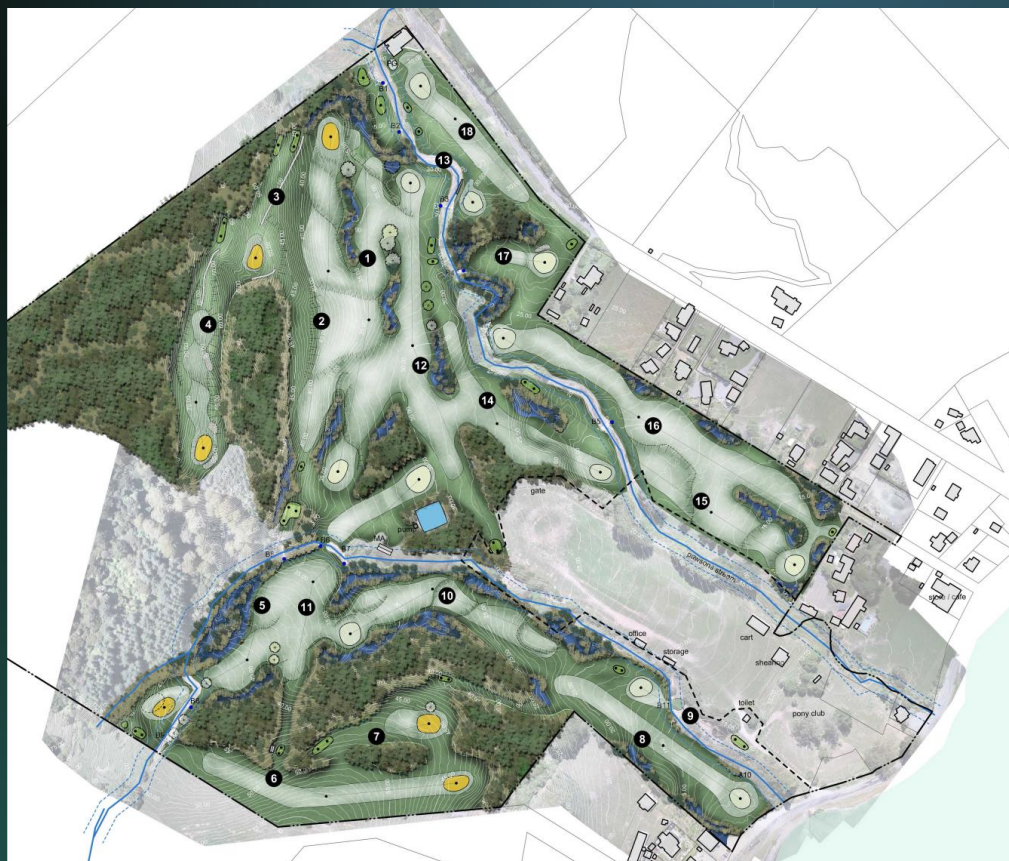

The Hidden Gem just gets better

All year round controlled irrigation

Considerable extra planting

Drainage improvements that will address existing issues with neighbouring residential properties and the schools.

Akaroa Golf Club and Culture

- Cultural wellbeing
- Reusing the Duvauchelle wastewater on the golf club land addresses important cultural issues with the local Iwi and preserves a key part of the Banks Peninsula history

The Cultural Issues

- The golf club has existed since 1822 (100 years this year).
- The course has developed over the years through the volunteer work of the community. There is so much history in what has been achieved.
- The land on which the course is based was purchased by the Akaroa District Council specifically for the golf course use.
- Taking the wastewater from the harbour environment and putting it on the golf course creates an opportunity for a win - win. Cleaner harbour - Better Golf Course



Conditions : Promises made to the Club

- ▶ More mowing equipment to manage the significant increased grass and plant growth.
- ▶ A shed to house the required equipment.
- ▶ Additional staffing to enable the mowing and management of the planting to be done.
- ▶ Treatment of the wastewater to the highest appropriate standard, with monitoring to ensure the standard is met.
- ▶ Development of the course to address the drainage and design issues that would compromise the success of the wastewater reuse.
- ▶ A 33 year extension to the golf club's lease.

We Must Do Option 1

- ▶ It betters the Community
- ▶ It creates a better Environment
- ▶ Ensures Sustainability of the golf course and its immediate Environment
- ▶ Cost effective relative to other options when the appropriate treatment standard is applied to option 2.

Questions



Submission



Duvauchelle Wastewater on Akaroa Golf Course



Written Submission

- Focuses on the issues associated with the well beings
- Economic
- Social
- Environmental
- Cultural



Option 2 is Not a Choice

- As proposed the land will be degraded by adding the wastewater
- It will require managed access
- This is not acceptable in land designated for Recreational Use
- It is even more unacceptable in land that currently has free and open access for us poor golfers looking for our golf balls.



Option 1 Has so Much Going For It

- Removing the discharge to the harbour of relatively poorly treated wastewater will enhance that environment.
- A good golf course will become a better golf course
- The longevity of the golf course and club (already 100 years old) will be assured.
- The stream environment will be improved.
- The increased native planting will enhance the bird life.



Important Considerations

- The golf club must be provided with the resources to manage the increased grass and planting growth.
- The course upgrades must be completed true to the standard of the course.
- The partnership golf club and Christchurch City Council must remain consistent with the assurances to date.
- The wastewater treatment standard must not be compromised.



The Detractors

- Climate change is a reason to do this. Water on the Peninsula will be a valuable resource with the predicted climate change
- Having the wastewater on the land means any negative effects can be observed and remediated. Out to sea and out of mind is not a long term sustainable solution
- Using wastewater for irrigation on golf courses is not new technology. It is done overseas and particularly along the Gold and Sunshine Coasts on many courses.
- This is an opportunity for an exemplar project. Let's fly high and be proud of doing something special for ours and ultimately the NZ community.