

**Waikura/
Linwood-Central-Heathcote Community Board
AGENDA**

Notice of Meeting:

An ordinary meeting of the Waikura/Linwood-Central-Heathcote Community Board will be held on:

Date: Wednesday 31 March 2021
Time: 4.30pm
Venue: The Board Room, 180 Smith Street,
Linwood

Membership

Chairperson	Alexandra Davids
Deputy Chairperson	Michelle Lomax
Members	Sunita Gautam
	Yani Johanson
	Darrell Latham
	Tim Lindley
	Jake McLellan
	Jackie Simons
	Sara Templeton

25 March 2021

Arohanui Grace
Manager Community Governance, Linwood-Central-Heathcote
941 6663
arohanui.grace@ccc.govt.nz
www.ccc.govt.nz

Note: The reports contained within this agenda are for consideration and should not be construed as Council policy unless and until adopted. If you require further information relating to any reports, please contact the person named on the report.

To view copies of Agendas and Minutes, visit:
<https://www.ccc.govt.nz/the-council/meetings-agendas-and-minutes/>



Developing Resilience in the 21st Century

Strategic Framework

Whiria ngā whenu o ngā papa,
honoa ki te maurua tāuiki

Bind together the strands of each mat and join
together with the seams of respect and reciprocity

Ōtautahi-Christchurch is a city of opportunity for all

Open to new ideas, new people and new ways of doing things – a city where anything is possible

Principles

Being open,
transparent and
democratically
accountable

Promoting
equity, valuing
diversity and
fostering inclusion

Taking an inter-generational approach
to sustainable development,
prioritising the social, economic
and cultural wellbeing of
people and communities
and the quality of the
environment, now
and into the
future

Building on the
relationship with
Te Rūnanga o Ngāi Tahu
and the Te Hōnonga-Council
Papatipu Rūnanga partnership,
reflecting mutual understanding
and respect

Ensuring
the diversity
and interests of
our communities
across the city and the
district are reflected in
decision-making

Actively collaborating and
co-operating with other
local, regional
and national
organisations

Community Outcomes

Resilient communities

Strong sense of community
Active participation in civic life
Safe and healthy communities
Celebration of our identity
through arts, culture, heritage,
sport and recreation
Valuing the voices of all cultures
and ages (including children)

Liveable city

Vibrant and thriving city centre
Sustainable suburban and
rural centres
A well connected and accessible
city promoting active and
public transport
Sufficient supply of, and
access to, a range of housing
21st century garden city
we are proud to live in

Healthy environment

Healthy water bodies
High quality drinking water
Unique landscapes and
indigenous biodiversity are
valued and stewardship
exercised
Sustainable use of resources
and minimising waste

Prosperous economy

Great place for people, business
and investment
An inclusive, equitable economy
with broad-based prosperity
for all
A productive, adaptive and
resilient economic base
Modern and robust city
infrastructure and community
facilities

Strategic Priorities

Enabling active
and connected
communities
to own their future

Meeting the challenge
of climate change
through every means
available

Ensuring a high quality
drinking water supply
that is safe and
sustainable

Accelerating the
momentum
the city needs

Ensuring rates are
affordable and
sustainable

Ensuring we get core business done while delivering on our Strategic Priorities and achieving our Community Outcomes

Engagement with
the community and
partners

Strategies, Plans and
Partnerships

Long Term Plan
and Annual Plan

Our service delivery
approach

Monitoring and
reporting on our
progress

Part A	Matters Requiring a Council Decision
Part B	Reports for Information
Part C	Decisions Under Delegation

TABLE OF CONTENTS

Karakia Timatanga	4
C 1. Apologies / Ngā Whakapāha.....	4
B 2. Declarations of Interest / Ngā Whakapuaki Aronga	4
C 3. Confirmation of Previous Minutes / Te Whakaāe o te hui o mua	4
B 4. Public Forum / Te Huinga Whānui.....	4
B 5. Deputations by Appointment / Ngā Huinga Whakaritenga	4
B 6. Presentation of Petitions / Ngā Pākikitanga.....	4

STAFF REPORTS

C 7. Greening the East Draft Development Plan	9
B 8. Elected Members' Information Exchange / Te Whakawhiti Whakaaro o Te Kāhui Amorangi.....	25

Karakia Whakamutunga

Karakia Timatanga

1. Apologies / Ngā Whakapāha

At the close of the agenda no apologies had been received.

2. Declarations of Interest / Ngā Whakapuaki Aronga

Members are reminded of the need to be vigilant and to stand aside from decision making when a conflict arises between their role as an elected representative and any private or other external interest they might have.

3. Confirmation of Previous Minutes / Te Whakaāe o te hui o mua

That the minutes of the Waikura/Linwood-Central-Heathcote Community Board meeting held on [Wednesday, 17 March 2021](#) be confirmed (refer page 5).

4. Public Forum / Te Huinga Whānui

A period of up to 30 minutes will be available for people to speak for up to five minutes on any issue that is not the subject of a separate hearings process.

5. Deputations by Appointment / Ngā Huinga Whakaritenga

Deputations may be heard on a matter or matters covered by a report on this agenda and approved by the Chairperson.

There were no deputations by appointment at the time the agenda was prepared.

6. Presentation of Petitions / Ngā Pākikitanga

There were no petitions received at the time the agenda was prepared.

Waikura/ Linwood-Central-Heathcote Community Board OPEN MINUTES

Date: Wednesday 17 March 2021
Time: 4.30pm
Venue: The Board Room, 180 Smith Street,
Linwood

Present

Chairperson	Alexandra Davids
Deputy Chairperson	Michelle Lomax (via audio/visual link)
Members	Sunita Gautam
	Yani Johanson
	Darrell Latham
	Tim Lindley
	Jake McLellan (via audio/visual link)
	Jackie Simons

Arohanui Grace
Manager Community Governance, Linwood-Central-Heathcote

941 6663

arohanui.grace@ccc.govt.nz

www.ccc.govt.nz

To view copies of Agendas and Minutes, visit:
www.ccc.govt.nz/the-council/meetings-agendas-and-minutes/

- Part A** **Matters Requiring a Council Decision**
Part B **Reports for Information**
Part C **Decisions Under Delegation**
-

Karakia Timatanga:

The agenda was dealt with in the following order.

1. Apologies / Ngā Whakapāha

Part C

Community Board Resolved LCHB/2021/00027

That an apology for absence from Sara Templeton be accepted.

Sunita Gautam/Jackie Simons

Carried

2. Declarations of Interest / Ngā Whakapuaki Aronga

Part B

Tim Lindley declared an interest in Item 7 - of Briefings 95 Main Road, Redcliffs resource consent and took no part in the Board's discussion on this item.

3. Confirmation of Previous Minutes / Te Whakaāe o te hui o mua

Part C

Community Board Resolved LCHB/2021/00028

That the minutes of the Waikura/Linwood-Central-Heathcote Community Board meeting held on Wednesday 3 March 2021 be confirmed.

Jackie Simons/Michelle Lomax

Carried

4. Public Forum / Te Huinga Whānui

Part B

There were no public forum presentations.

5. Deputations by Appointment / Ngā Huinga Whakaritenga

Part B

There were no deputations by appointment.

6. Presentation of Petitions / Ngā Pākikitanga

Part B

There were no presentation of petitions.

7. Briefings

Community Board Resolved LCHB/2021/00029

Part B

That the Waikura/Linwood-Central-Heathcote Community Board:

1. Notes the information supplied during the Briefings on Environment Canterbury Long Term Plan 2021-2031 and 95 Main Road, Redcliffs resource consent.

Sunita Gautam/Jackie Simons

Carried

8. External Organisation Representation - Summit Road Society

Officer Recommendation / Ngā Tūtohu

That the Waikura/Linwood-Central-Heathcote Community Board:

1. Appoints a Board member to replace Jackie Simons as the Community Board Representative on the Summit Road Society.

Community Board Resolved LCHB/2021/00030

Part C

That the Waikura/Linwood-Central-Heathcote Community Board:

1. Receives the report External Organisation Representation – Summit Road Society.

Jake McLellan/Tim Lindley

Carried

9. Elected Members' Information Exchange / Te Whakawhiti Whakaaro o Te Kāhui Amorangi

Part B

The Board exchanged information on the following:

- The Board were advised that there had been concerned noted by a community member on the steelwork of the Canterbury Yacht Club's Boat shed that is currently being built in Moncks Bay.
- The Estuary Trust has obtained funding for a shellfish count survey. The count will be progressed shortly.
- The Board were advised that the planting at the side of the Ferrymead Bridge was now well established.
- A report entitled: Future Streets Aranui Community Insights 2019 was tabled for the Board's information.

Attachments

- A Elected Members Exchange: Future Streets Aranui Community Insights March 2019 - 3 March 2021

Karakia Whakamutunga:

Meeting concluded at 5.52pm.

CONFIRMED THIS 31st DAY OF MARCH 2021.

ALEXANDRA DAVIDS
CHAIRPERSON

Unconfirmed

Item 3 - Minutes of Previous Meeting 17/03/2021

7. Greening the East Draft Development Plan

Reference / Te Tohutoro: 21/314545

Report of / Te Pou
Matua:

Michelle Lomax, Chairperson
Waikura/Linwood-Central-Heathcote Community Board and Inner
City East Revitalisation Project Greening the East Working Party

General Manager /
Pouwhakarae:

Mary Richardson, General manager, mary.richardson@ccc.govt.nz

1. Purpose of the Report / Te Pūtake Pūrongo

- 1.1 The purpose of this report is for the Community Board to adopt the Greening the East Development Plan (Plan). This report has been written by staff following a request by the joint Waikura/Linwood-Central-Heathcote Community Board and Inner City East Revitalisation Project Greening the East Working Party at a working party meeting on March 11 2021.
- 1.2 The decision in this report is of low significance in relation to the Christchurch City Council's Significance and Engagement Policy. This is because the adoption of the Plan will not commit the Board of the Council to any actions or expenditure, instead it will inform Board priority setting, a Board submission to the LTP and ongoing discussions with staff over the prioritisation of work programmes already included within the draft LTP.

2. Officer Recommendations / Ngā Tūtohu

That the Waikura/Linwood-Central-Heathcote Community Board:

1. Adopts the Greening the East Development Plan attached to this report as Attachment A.
2. Notes that the adoption of the Greening the East Development Plan does not automatically commit the Waikura/Linwood-Central-Heathcote Community Board or the Council to the implementation of the plan and that implementation will be undertaken as and when resources permit over time.

3. Reason for Report Recommendations / Ngā Take mō te Whakatau

- 3.1 Through a co-design process and local community engagement the Joint Waikura/Linwood-Central-Heathcote Community Board and Inner City East Revitalisation Project Greening the East Working Party have developed the Plan.
- 3.2 The Plan supports a vision that adults and children have multiple opportunities to connect to and be enriched by the green, biodiverse and healthy neighbourhood of the Inner City East/Linwood, while discovering the natural and cultural heritage and its unique character.
- 3.3 The Greening the East Development Plan is an outcome of the Waikura/Linwood-Central-Heathcote Community Board Plan 2020-22 priority project; Greening the inner city east – Greening the concrete jungle.
- 3.4 Due to the level of community engagement and co-design process followed the Plan is an effective representation of both community and council's view.
- 3.5 Projects covered by the Plan are currently being implemented using resources set aside in the 2018/28 Long Term Plan. Further projects can be delivered using resources already set aside in work programmes of the Parks and Transport Units.

4. Alternative Options Considered / Ētahi atu Kōwhiringa

- 4.1 The alternate option is that the Waikura/Linwood-Central-Heathcote Community Board does not adopt the Plan. This is not recommended as the Plan is considered robust, realistic, effectively co-developed with community and a number of non-aspirational projects able to be implemented.

5. Detail / Te Whakamahuki

- 5.1 The Waikura/Linwood-Central-Heathcote Community Board Plan 2017-2019 included a desired outcome for a green city that enhances health and well-being including local parks, clean rivers, an enhanced estuary and community gardens.

A specific outcome measure was: Significant tree planting takes place on road frontages in the inner city east between Barbados Street and Linwood Avenue.

In January 2019 the Community Board reaffirmed that this was one of its main priorities for the year and set aside money from its Discretionary Response Fund to support the project.

A joint community board-staff workshop in March 2019 decided that the objectives in the community board plan would best be achieved, within the available resources, by concentrating immediate efforts on berm planting in the area bounded by Avonside Drive, Linwood Avenue, Cashel Street, and Fitzgerald Avenue.

The Council's Annual Plan 2019-20 reaffirmed the availability of \$20,000 originally set aside in the 2018-19 Annual Plan for "greening the east".

Over the summer months of 2019/2020, the Green Spaces Group (a sub-group of the Inner City East (ICE)/Linwood Revitalisation Plan Working Group) held a series of community engagement events, identifying community use, concerns and aspirations of the ICE green spaces.

- 5.2 The Joint Waikura/Linwood-Central-Heathcote Community Board and Inner City East Revitalisation Project Greening the East Working Party is made up of four community board members, three members representing the Inner City East Revitalisation Project, and up to two members of the public chosen for their particular interest and expertise. The working group is also supported by key council staff and community governance.
- 5.3 The decision affects the Central ward of the Waikura/Linwood-Central-Heathcote Community Board.

6. Policy Framework Implications / Ngā Hīraunga ā- Kaupapa here

Strategic Alignment / Te Rautaki Tīaroaro

- 6.1 This project meets the following Community Outcomes; Resilient communities, Liveable city and Healthy environment and the Strategic Priority of Enabling active and connected communities to own their future.
- 6.2 This report supports the [Council's Long Term Plan \(2018 - 2028\)](#):
- 6.2.1 Activity: Community Development and Facilities
- Level of Service: 4.1.27.2 Community development projects are provided, supported and promoted. - Community Board plans are developed and implemented.

Policy Consistency / Te Whai Kaupapa here

- 6.3 The decision is consistent with Council's Plans and Policies.

Impact on Mana Whenua / Ngā Whai Take Mana Whenua

- 6.4 The decision does not involve a significant decision in relation to ancestral land or a body of water or other elements of intrinsic value, therefore this decision does specifically impact Mana Whenua, their culture and traditions. This is because the adoption of the Plan will not commit the Board of the Council to any actions or expenditure, instead it will inform Board priority setting, a Board submission to the LTP and ongoing discussions with staff over the prioritisation of work programmes already included within the draft LTP.

Climate Change Impact Considerations / Ngā Whai Whakaaro mā te Āhuarangi

- 6.5 There are no Climate Change impacts to be taken into consideration in adopting this plan.

Accessibility Considerations / Ngā Whai Whakaaro mā te Hunga Hauā

- 6.6 There are no Accessibility considerations to be made in adopting this plan.

7. Resource Implications / Ngā Hīraunga Rauemi

Capex/Opex / Ngā Utu Whakahaere

- 7.1 There are no costs in adopting this plan. This is because the adoption of the Plan will not commit the Board of the Council to any actions or expenditure, instead it will inform Board priority setting, a Board submission to the LTP and ongoing discussions with staff over the prioritisation of work programmes already included within the draft LTP.

Other / He mea anō

- 7.2 Projects covered by the Plan are currently being implemented using resources set aside in the 2018/28 LTP. Further projects can be delivered using resources already set aside in work programmes of the Parks and Transport Units and included in the draft 2021/31 LTP. The Board intends to use this Plan to underpin its submission to the 2022 - 2032 Long Term Plan to fund identified projects over and above current levels of service.

8. Legal Implications / Ngā Hīraunga ā-Ture

Statutory power to undertake proposals in the report / Te Manatū Whakahaere Kaupapa

- 8.1 The statutory power to undertake the proposal derives from Council's Status and Powers in S12 (2) of the LGA 2002.

Other Legal Implications / Ētahi atu Hīraunga-ā-Ture

- 8.2 There is no legal context, issue or implication relevant to this decision because the adoption of the Plan does not commit the Board or the Council to any actions over current agreed levels of service in the 2018/28 LTP. Where needed Council's Legal Services Unit will review any proposed agreements that may arise out of the implementation of the Plan; for example partnership agreements with community organisations.
- 8.3 This report has not been reviewed and approved by the Legal Services Unit

9. Risk Management Implications / Ngā Hīraunga Tūraru

- 9.1 The principal risk to Council and the Board is assumption that the Board's adoption of the Plan is effectively committing to some/all the actions and projects contained therein.
- 9.1.1 This could be caused by community expectation derived through, in part, the extensive Plan co-development process.

- 9.1.2 This risk can be partially mitigated by a clear note accompanying the resolution and ongoing communication by elected members and staff that the Board is approving a Plan and not committing to implement all the actions contained therein.

Attachments / Ngā Tāpirihanga

No.	Title	Page
A ↓	Draft Greening the East - Development Plan	13

In addition to the attached documents, the following background information is available:

Document Name	Location / File Link

Confirmation of Statutory Compliance / Te Whakatūturutanga ā-Ture

Compliance with Statutory Decision-making Requirements (ss 76 - 81 Local Government Act 2002).

(a) This report contains:

- (i) sufficient information about all reasonably practicable options identified and assessed in terms of their advantages and disadvantages; and
- (ii) adequate consideration of the views and preferences of affected and interested persons bearing in mind any proposed or previous community engagement.

(b) The information reflects the level of significance of the matters covered by the report, as determined in accordance with the Council's significance and engagement policy.

Signatories / Ngā Kaiwaitohu

Authors	Liz Beaven - Community Board Advisor Rochelle Faimalo - Community Development Advisor
Approved By	John Filsell - Head of Community Support, Governance and Partnerships

Greening the East Plan

—





Contents

Introduction.....	2
Timeline	3
Vision.....	3
Guiding Outcomes	3
Proposed Actions	4
Proposed Actions: Connect	5
Proposed Actions: Enrich	6
Proposed Actions: Discover	9
Next Steps.....	9

Introduction

There is a lack of green space and tree coverage in the Inner City East/Linwood neighbourhood. Further intensification is making this situation worse.

Numerous studies reveal high stress environments and low density green spaces are linked to poor ecological health and reduced human well-being outcomes¹. Little consideration has been given to the effects of this on the Inner City East/Linwood community despite, and in the face of, continued intensification.

A Joint Working Party of community members and the Linwood Central Heathcote Community Board, tasked with improving the situation and changing this scenario for the community, have come together to develop the Greening the East Plan. This Plan seeks to develop tangible solutions to the problems faced by the community and

take opportunities to increase green space and tree coverage in the neighbourhood. The Plan contains: a vision, guiding outcomes and an action list. It proposes an integrated approach to Greening the East, and is the basis for submission to the Christchurch City Council Long Term Plan, to seek funding for implementation.

The role of the Greening the East Plan is to guide the development and enhancement of green spaces within the project area (Figure 1) while giving consideration to the numerous heritage values and associations within this boundary.

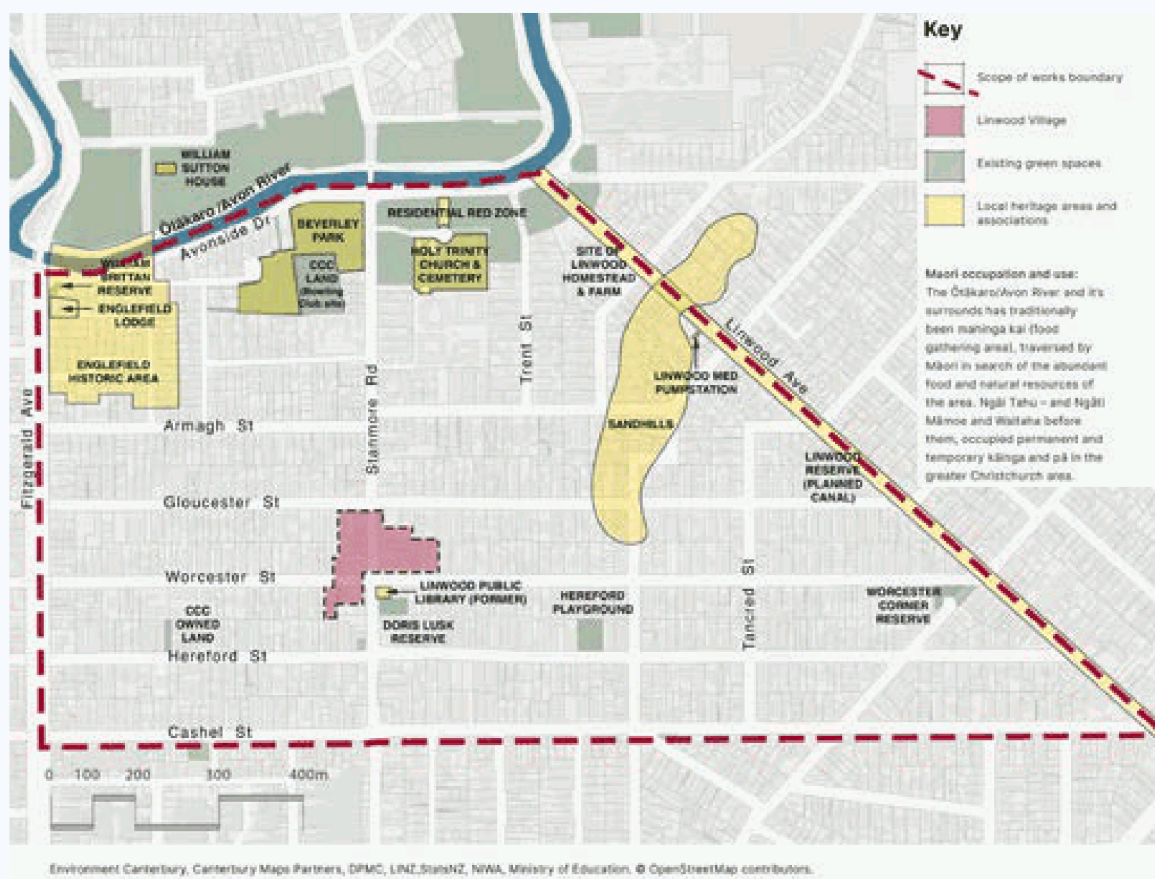

Figure 1: Boundary of Greening the East Plan – with local heritage values and associations.

¹Souter-Brown, G. (2014) Landscape and Urban Design for Health and Well-Being, Routledge: USA and Canada.

Timeline



Figure 2: Greening the East timeline.

Guiding Outcomes

Three guiding outcomes inform the actions of the Plan – **Connect, Enrich and Discover**.



Connect

Connections link ecological communities and people throughout the Inner City East/Linwood area through a network of street trees and indigenous planting. With improved shade, shelter, habitat, amenity and opportunities for interaction, the Inner City East/Linwood area will contain a healthy green environment that integrates natural, recreational, and socio-cultural functions.



Enrich

All parks, reserves and green spaces in the Inner City East/Linwood are high-quality, and enable residents to actively participate in their creation, stewardship, programming and use. The environment promotes health and wellbeing, is equitable and accessible, safe to access and use, family-friendly and helps to build a valued, vibrant, inclusive and caring community.



Discover

The green environment is integrated into and celebrates the rich natural and cultural heritage unique to this place through creative forms of interpretation.

Vision

Adults and children have multiple opportunities to connect to and be enriched by the green, biodiverse and healthy neighbourhood of Inner City East/Linwood, while discovering the natural and cultural heritage of the area and its unique character.

The Greening the East Plan is integral to achieving this vision. The following guiding outcomes and programme of actions will inform future development in the area.

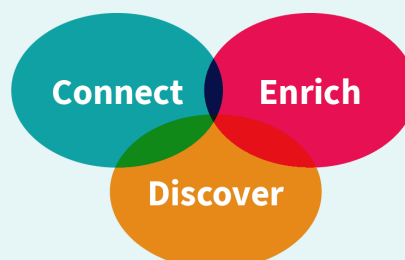

Proposed Actions

These actions aim to improve the quantity, quality and connection between green spaces in the area. Figure 3 and the associated tables below identify proposed actions relating to the three guiding outcomes of **Connect**, **Enrich** and **Discover**. Further investigation is required to feed into the programme and process, to cost and implement the Plan. However, the actions proposed reflect the engagement over the past three years with local community members who have informed these actions. This engagement was through a range of events, questionnaires, and anecdotal feedback. It has helped to articulate the problems and identify opportunities and solutions.

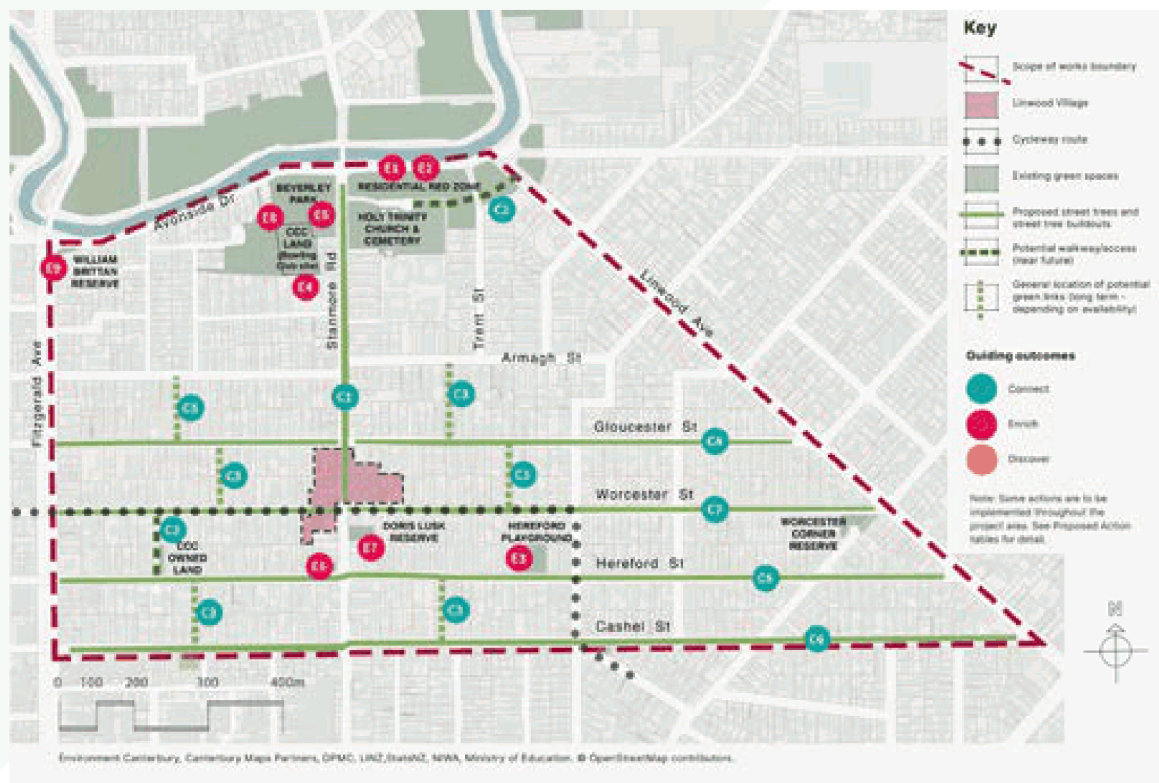

Figure 3: Existing Inner City East/Linwood green spaces and proposed actions relating to the following tables.

Proposed Actions: Connect

Key	Issue/Opportunity	Proposed Action
C1.	Stanmore Road connects Linwood Village to the Ōtākaro/Avon River, yet it is an unappealing streetscape for walking and drawing people to and from the river corridor.	Develop a green corridor from Linwood Village to the Ōtākaro/Avon River along Stanmore Road.
C2.	Long street blocks reduce walkability and limit connections to greenspaces.	Explore short term options to formalise public walkways on existing Council land and negotiate access with adjacent landowners where possible.
C3.	Long street blocks reduce walkability and limit connections to greenspaces.	Create green north-south linkages to the Ōtākaro/Avon River to improve walkability and connection to greenspaces through property purchases.
C4.	Gloucester Street: Opportunity to improve the walkability, amenity and provide for shade and ecological health through street trees and planting.	Create street buildouts along Gloucester Street that integrate multiple amenity values: large street trees, traffic calming, seating, planting, storm water treatment, play element, and interpretation. Explore Tactical Urbanism approaches and encourage residents to care for these places long term. Incentivise private front yard plantings.
C5.	Hereford Street: Opportunity to improve the walkability, amenity and provide for shade and ecological health through street trees and planting.	Create street buildouts along Gloucester Street that integrate multiple amenity values: large street trees, traffic calming, seating, planting, storm water treatment, play element, and interpretation. Explore Tactical Urbanism approaches and encourage residents to care for these places long term. Incentivise private front yard plantings.
C6.	Cashel Street: Inconsistent street tree planting within berms = low aesthetic appeal and little shade.	Infill gaps in existing berms with street trees to improve tree canopy coverage in the area.
C7.	Worcester Street: Inconsistent street tree planting within berms = low aesthetic appeal and little shade.	Infill gaps in existing berms with street trees to improve tree canopy in the area and strengthen the aesthetic and ecological values of Rapanui cycleway.
Throughout	Low biodiversity and ecological values within streetscape across Inner City East/Linwood	Explore opportunities to improve bio-diversity and encourage greater habitat for birds and insects throughout the Inner City East/Linwood. Create ecological corridors of native planting in both planted and unplanted areas (e.g. infiltrate existing grass berms and roundabouts with micro-niche inserts of native grass).

Item C5: Tactical urbanism is about testing ideas in the urban realm – exploring how our cities can become more liveable and safe through temporary activations. Hypothetical improvements can be tested with low-cost materials, smaller scales, and set time frames used to advantage. It explores the possible, before long-term changes are made permanently, allowing the public to feed into, and become familiar with, the design of their urban spaces. Concepts can be measured by their performance in a real-life context, and adjusted accordingly with minimal expenditure and risk.

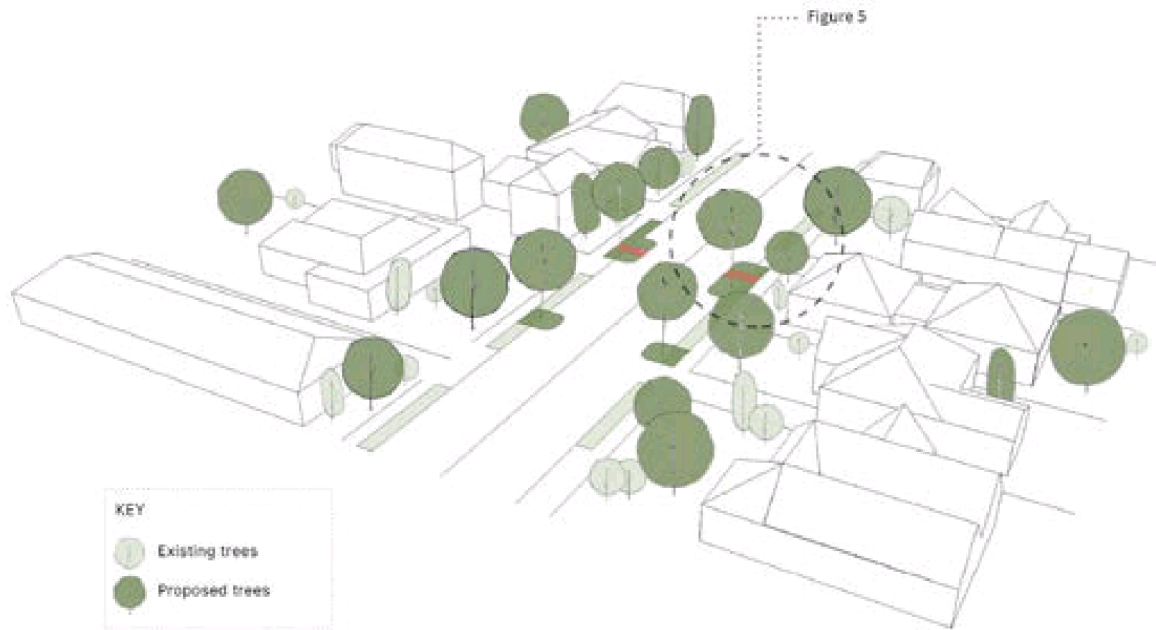

Figure 4: Create street build outs alongside private property planting for greater tree canopy coverage.

Proposed Actions: Enrich

Key	Issue/Opportunity	Proposed Action
E1.	<p>Inner City East/Linwood area is under-represented in terms of public green spaces and opportunities for children's play.</p> <p>A high percentage of children in the eastern part of the project area have no access to a play area within 500m walking distance from their homes.</p>	<p>Create an ecologically rich green space suitable for walking and children's play in the Residential Red Zone land immediately south of the Ōtākaro/Avon River.</p> <p>Co-design this area with local residents and children.</p> <p>Implement a planting programme with local community members.</p>
E2. and throughout	<p>Residential Red Zone:</p> <p>Opportunity to activate land alongside Avonside Drive within the Scope of Works boundary.</p> <p>Opportunity to improve biodiversity of existing parks and reserves in Inner City East/Linwood.</p>	<p>Supplement existing tree planting in this part of the Residential Red Zone and other parks within the Development Plan boundary with well-designed/considered patches of eco-sourced native plant species.</p> <p>Select species that provide habitat relevant to local ecosystems and that provide stepping stones for birds and insects (within a 10 minute walk or .5km from each residence).</p> <p>Adopt the spirit of joint Council/community initiatives, such as that carried out for the Heritage Rose Garden in Beverley Park (Englefield Residents Association coordinated sponsorship of different rose varieties while Council implemented the landscaping).</p> <p>Integrate planting with play opportunities for children, including nature play (see Action E3 below).</p>

E3.	<p>Hereford Playground:</p> <p>Poor design and safety concerns of this play area are causing people to feel trapped and unsafe.</p> <p>Existing vegetation at the front boundary fence obscures views into the park.</p>	<p>Integrate nature play activities into new playground design.</p> <p>Remove and replace front fence with post and chain fencing; install picnic table and bench seats towards front of playground.</p> <p>Remove (or trim back) existing plants and improve sightlines.</p>
E4.	Former Linwood Bowling Club site.	Encourage the Council to develop green space plans for this area aligned with Action E1 above.
E5.	Renewal of Beverley Park playground.	Co-design this renewal with the Inner City East/Linwood community (including current users) to better understand existing use and how design could more appropriately support the health and wellbeing of people in the neighbourhood.
E6.	Stanmore Road/Hereford Street pocket park is non-descript and currently used as a 'waiting room' for drug activity. As an entrance or 'welcome' to Linwood Village, the space lacks cues as to its role in the community.	Co-design this pocket park with the Inner City East/Linwood community (including current users) to better understand existing use and how park design could more appropriately support the health and wellbeing of people in the neighbourhood.
E7.	<p>Doris Lusk Reserve:</p> <p>Seating is uncomfortable, tucked away and not conducive to socialising.</p> <p>Existing sign is very faded.</p>	<p>Install comfortable seating in the Reserve. Carefully select locations that relate to the new children's artwork, scheduled for implementation in 2021.</p> <p>Replace faded sign.</p>
E8.	Access between Beverley Park and the Heritage Rose Garden is narrow and the adjacent Bowling site is now vacant.	Investigate how widening access between these two green spaces might improve the experience for local community.
E9.	William Brittan Corner: maintenance required.	Repaint picket fence, tree and plant maintenance.
Throughout	Opportunity to encourage private property tree planting to increase tree canopy, green spaces, biodiversity and habitat across the Inner City East/Linwood neighbourhood.	<p>Prepare a robust community communication strategy and programmes to encourage/sponsor private property owners to plant native trees suited to the local ecosystem in their front yard.</p> <p>Investigate Citizen Science programmes (e.g. Trees Atlanta) for inspiration and effectiveness – aim for 30% tree canopy coverage</p>
Throughout	Lack of quality play opportunities within walking distance from the homes of children and young people.	<p>Integrate nature play into new and existing parks involving local children in co-design activities.</p> <p>Create family friendly streets and playful walking routes for caregivers and young children. For example, explore opportunities to create green bumping spaces through seating, paving and playful elements that relate to the unique character of Inner City East/Linwood (see Table 3: Discover).</p>

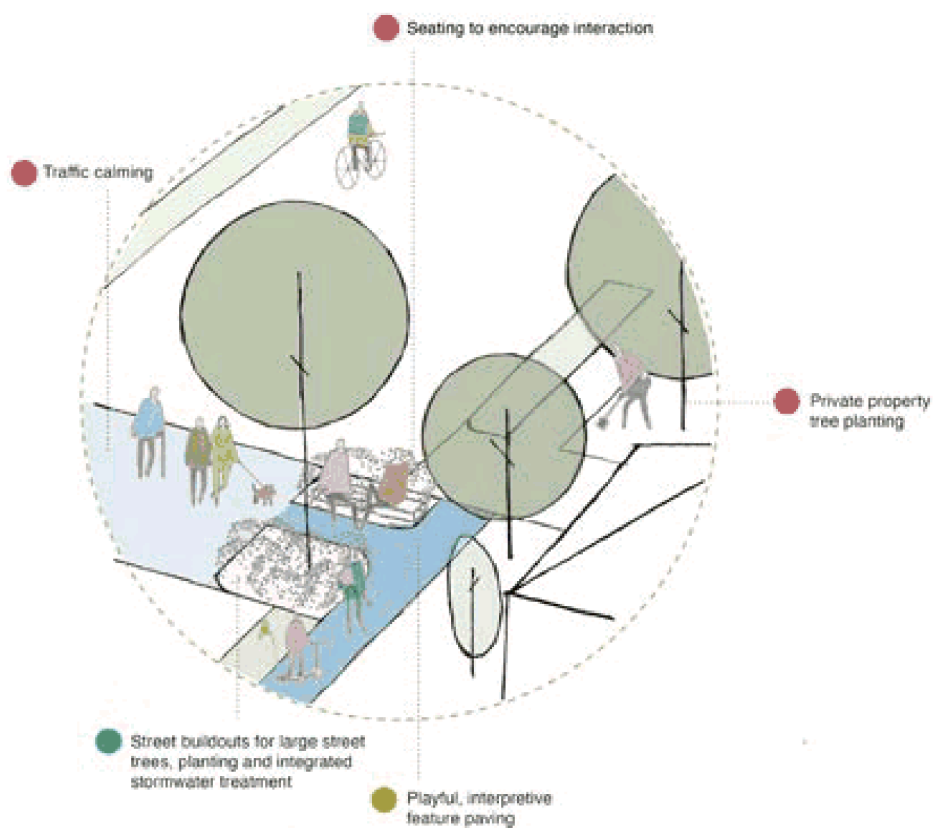

Figure 5: Sketch illustrating how proposed actions can achieve multiple values across the Guiding Outcomes of Connect, Enrich, Discover (see Proposed Action Tables).



Proposed Actions: Discover

Key	Issue/Opportunity	Proposed Action
Throughout	Lack of interpretation and visibility of the rich natural and cultural heritage of Inner City East/Linwood green spaces.	<p>Create a co-ordinated wayfinding strategy (e.g. signage, public art, brochures, QR codes and apps). Integrate natural, Māori and European narratives.</p> <p>Complement local artworks as part of the wayfinding strategy.</p> <p>Integrate signage sympathetically with surroundings (e.g. materiality, scale, colour, siting, etc).</p> <p>Engage local iwi to ensure Māori place names and references are used appropriately on all signage.</p> <p>Identify existing signs for retention or removal as part of consultation with partners, local community and stakeholders.</p> <p>Provide maps to communicate distances and journey length. Information of buildings, street features, landmarks, districts and connecting routes should be used on signage to complement distances.</p>
Throughout	Little evidence of natural habitat and vegetation to support biodiversity within local ecosystems.	<p>Improve the legibility of natural ecosystems by providing ecosystem maps and plant species lists that are suitable for local soils (tie into communication strategy for private property planting).</p> <p>Highlight Māori names of plants and their meanings to tie into Citizen Science communication strategy.</p> <p>Strategically locate hardwood native trees in the area to celebrate natural and cultural heritage. Their distinctive forms provide visibility and legibility of original vegetation in the area.</p>
Throughout	Opportunity to install public art alongside traditional forms of interpretation to reinforce local character as a less literal form of information sharing.	Integrate natural and cultural history narratives into children's play as part of walkable, family friendly streets, footpaths, parks and playgrounds.
Throughout	Complement way-finding and heritage interpretation with other initiatives adjacent to Inner City East/Linwood.	Engage with key stakeholders to ensure heritage interpretation proposals complement initiatives in surrounding neighbourhoods.

Next Steps

- Advocate for Long Term Plan Funding
- Prepare detailed action plans
- Implement actions

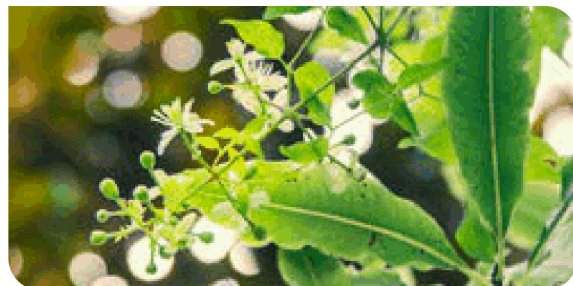

Greening the East Plan

ccc.govt.nz

Contributors: The Greening the East Working Party, Council, and Gather Landscape Architecture.

Christchurch
City Council 

8. Elected Members' Information Exchange / Te Whakawhiti Whakaaro o Te Kāhui Amorangi

This item provides an opportunity for Board Members to update each other on recent events and/or issues of relevance and interest to the Board.